

*Leica*  
Geosystems



# DISTO™ Plan App

## Sketch Plan

- when it has to be right

*Leica*  
Geosystems

# Sketch Plan Overview

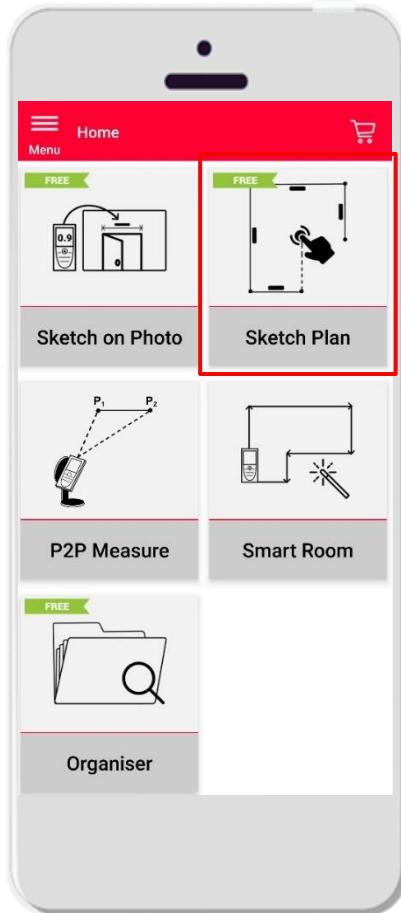

- Create precise floorplans or any other situation plan
- Features:
  - Automatic snapping
  - Auto-scale
  - Add doors, windows and wall openings
  - 3D view
  - Export in jpg, pdf and CAD format (2D/2D+Height)

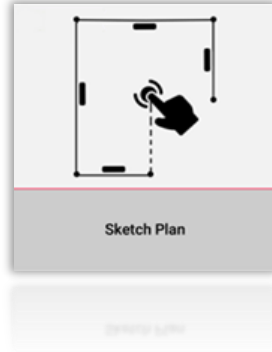

# Sketch Plan

## How to start

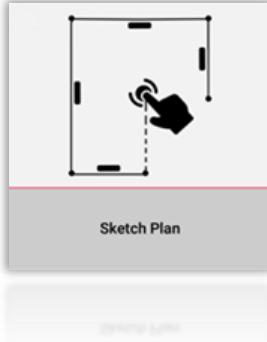

- Connect your DISTO™ with the DISTO™ Plan App



- Read also our training materials about **How to connect** to learn how to connect with your device
- Sketch on Photo is also compatible with older devices featuring Bluetooth v4.0 (X4, D510, D810 etc.)

See also our videos about:

- How to connect Leica DISTO™ D1/D110/D2 with a phone/tablet
- How to connect Leica DISTO™ X3/X4 with iPhone/iPad
- How to connect Leica DISTO™ X3/X4 with Android phone/tablet
- How to connect Leica DISTO™ D5/X6 with iPhone/iPad
- How to connect Leica DISTO™ D5/X6 with Android phone/tablet
- How to connect Leica DISTO™ D510 with a phone/tablet
- How to connect Leica DISTO™ D810 touch/S910 with a phone/tablet
- How to connect Leica DISTO™ S910 in WiFi with iPhone/iPad
- How to connect Leica DISTO™ S910 in WiFi with an Android phone/tablet

- when it has to be **right**

**Leica**  
Geosystems

# Sketch Plan

## How to transmit measurements from DISTO™

There are two ways to transfer measurements from DISTO™:

1. With red “ON/DIST” button on the device
  2. With red “ON/DIST” button on the screen (not available for DISTO™ D510)
- All the measurements will be displayed on the stack bar in the app

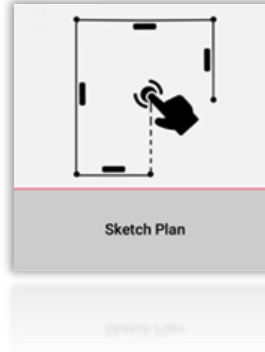
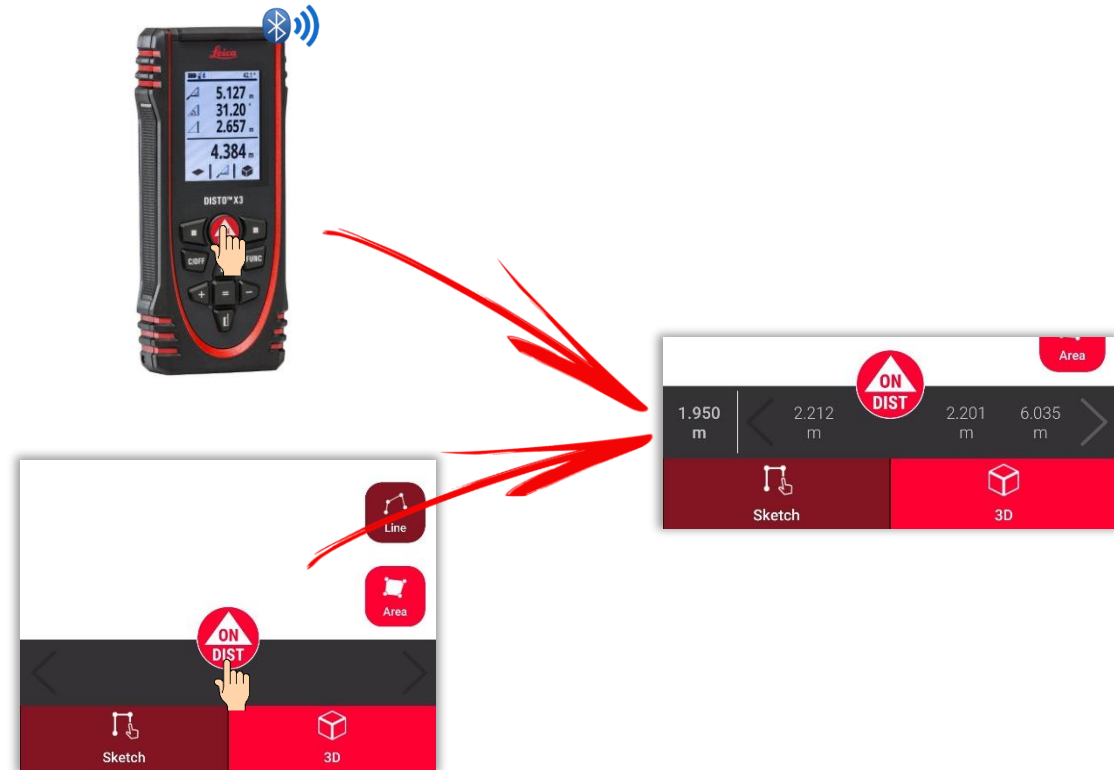

- when it has to be right

# Sketch Plan

## How to sketch a line

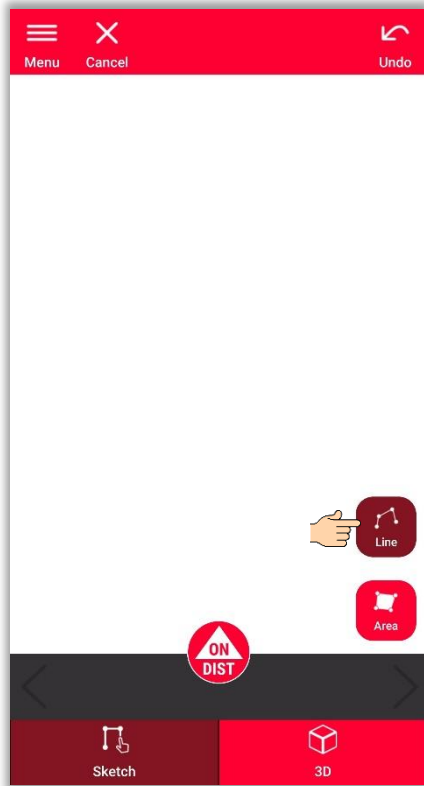
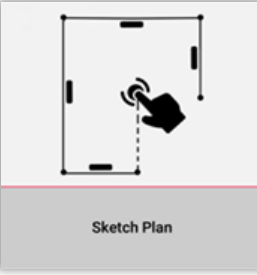

Tap on the "Line" button to select it

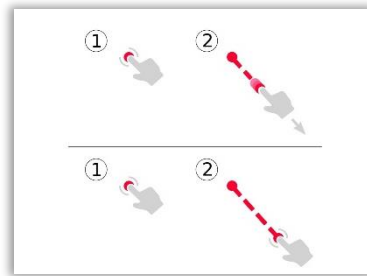

Tap and swipe or tap and tap to draw a line

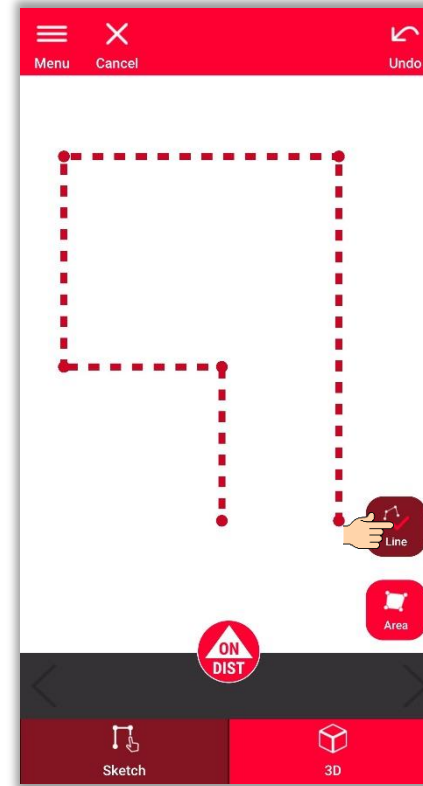

Press again the button to finish the line

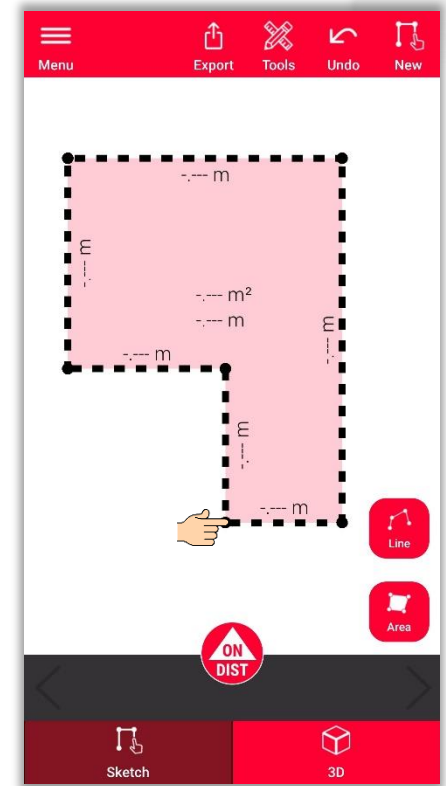

Line finishes automatically when connecting it to the start point

# Sketch Plan

## How to sketch an area

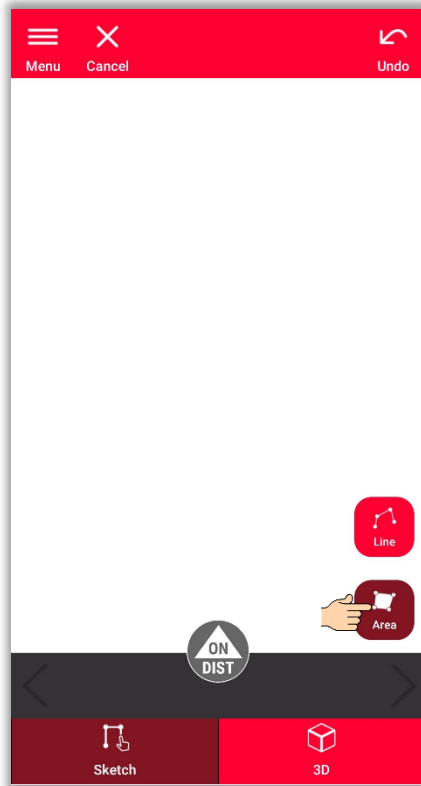
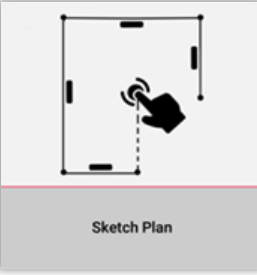

Tap on the "Area" button to select it

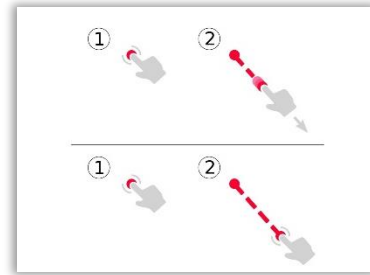

Tap and swipe or tap and tap to draw a line

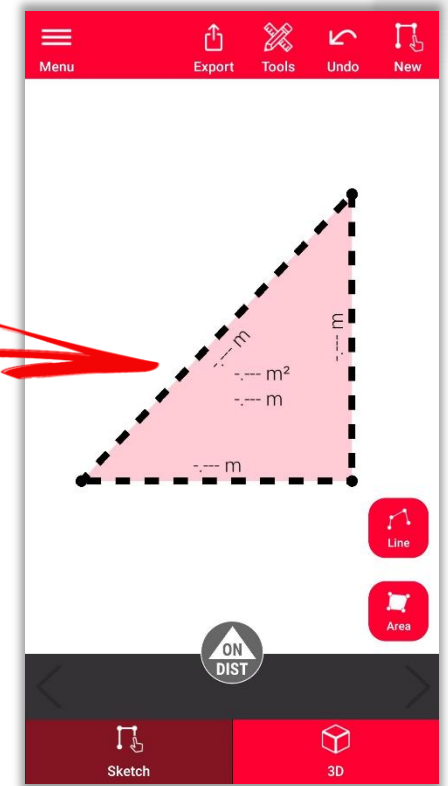
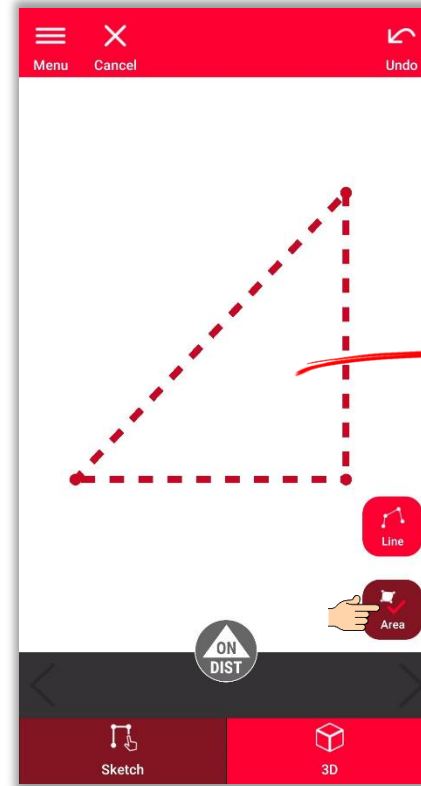

To create an area, tap at least three points on the screen  
Tap "Area" button again to finish defining the area

# Sketch Plan

## How to use snapping

- **Snapping** helps with drawing more precisely by automatically correcting the position of drawn points and lines
- In DISTO™ Plan App there are several snapping methods applied:

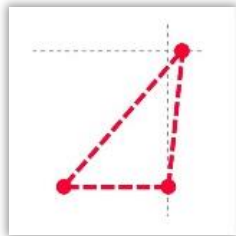

Perpendicular correction

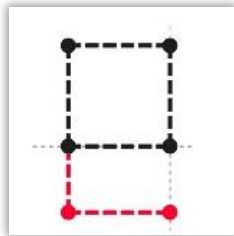

Parallel correction

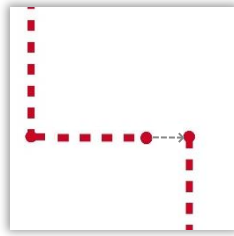

To Point correction

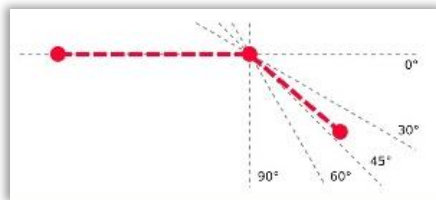

Angle correction

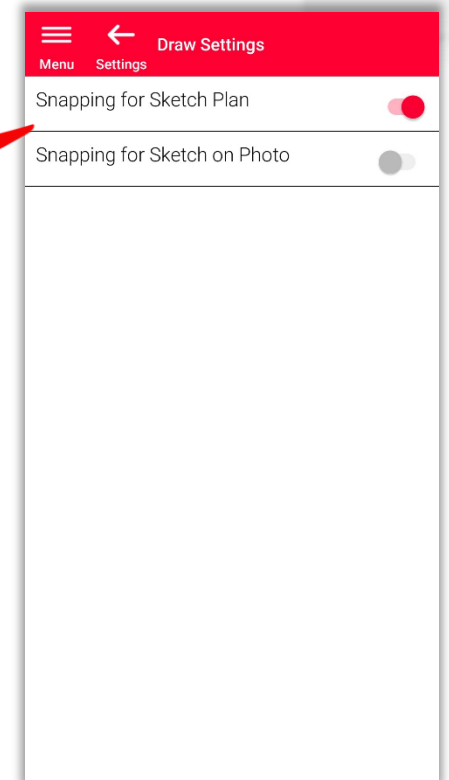
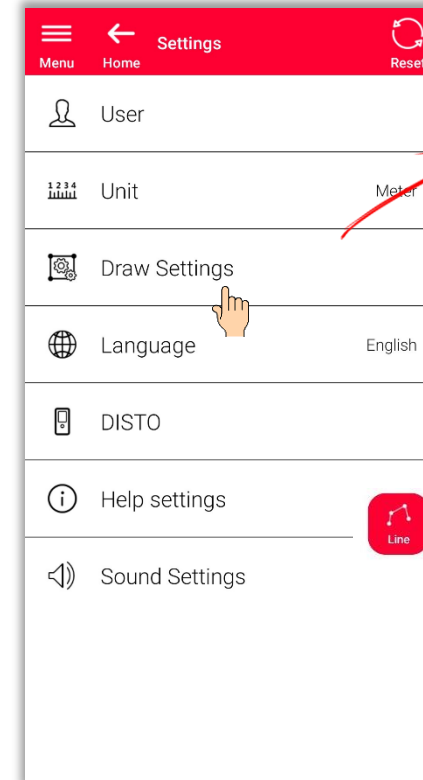
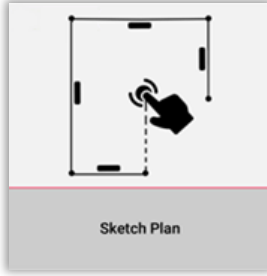

To turn the snapping ON or OFF go to **Settings** and open the **Draw Settings** menu

# Sketch Plan

## How to edit

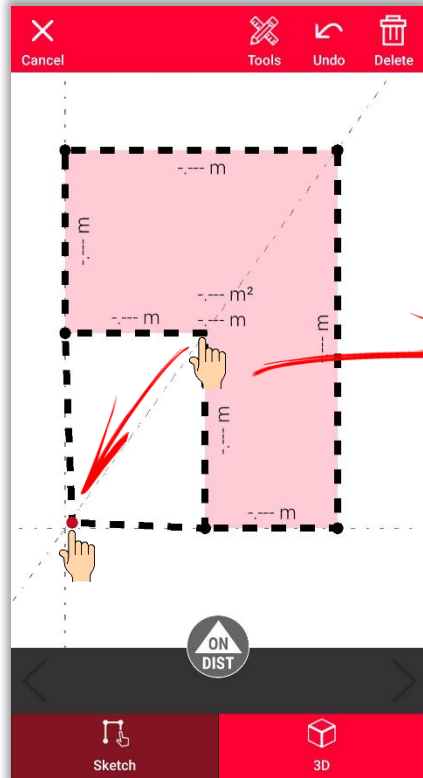
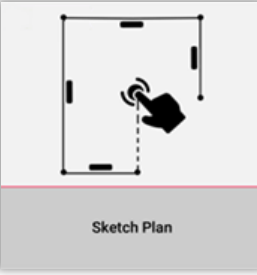

Long tap on a point and drag it, to move the corner of the room

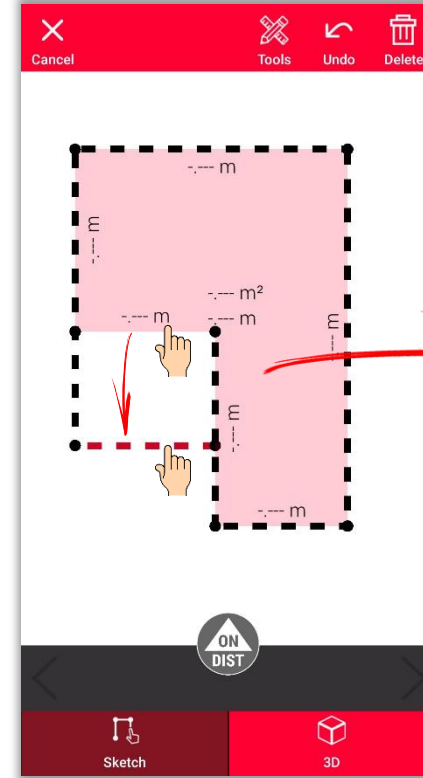
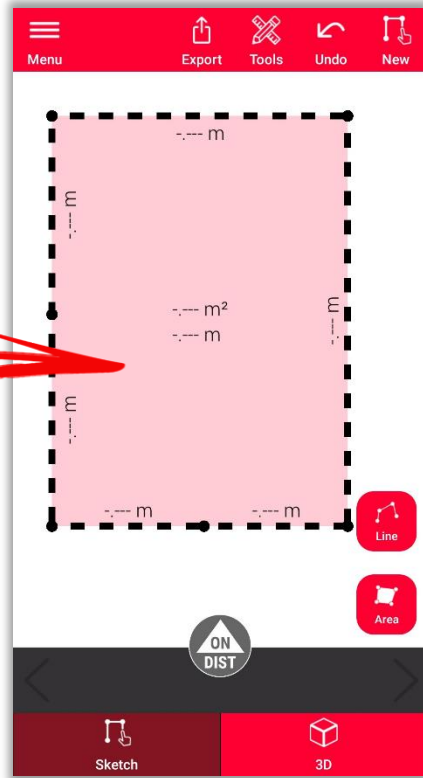

Long tap on a line and drag it, to move the wall

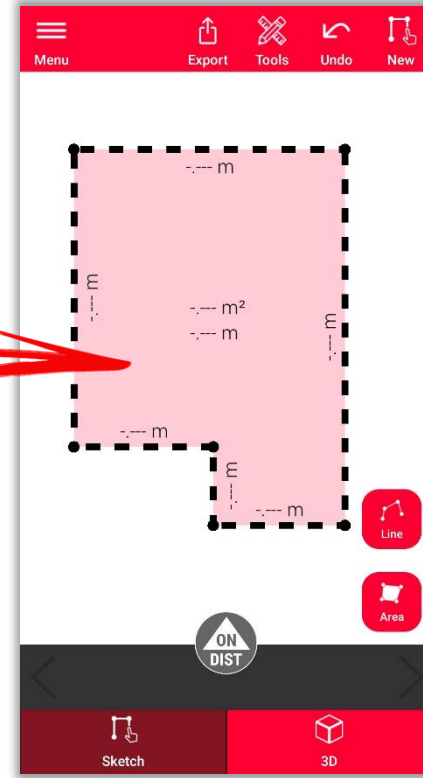

- when it has to be right



# Sketch Plan

## How to sketch

Use **Intersect** or **Hidden corner** tools to calculate not visible points

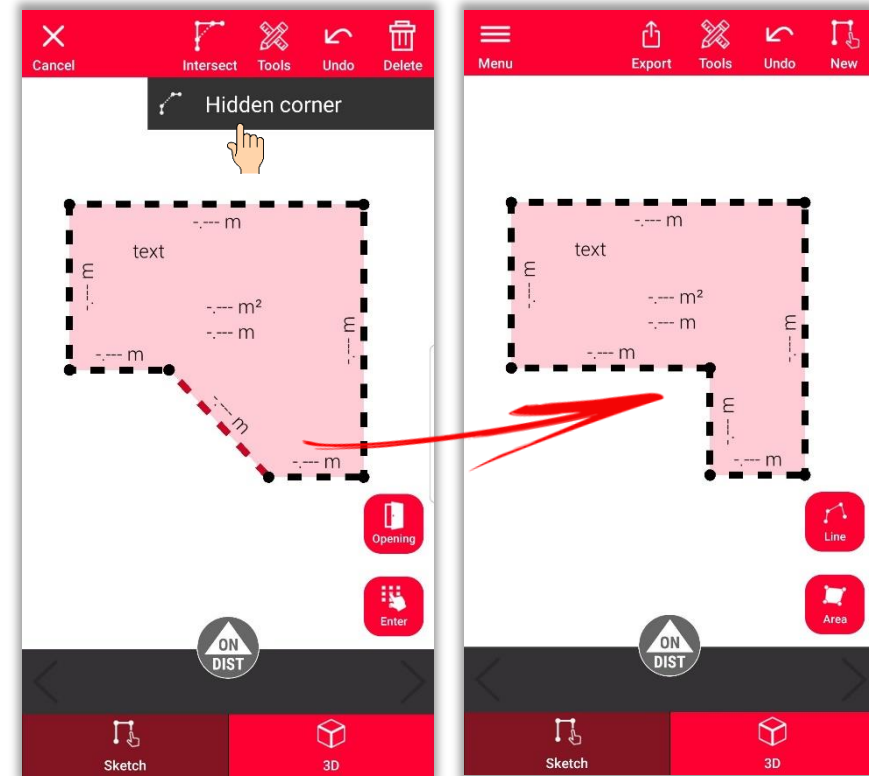
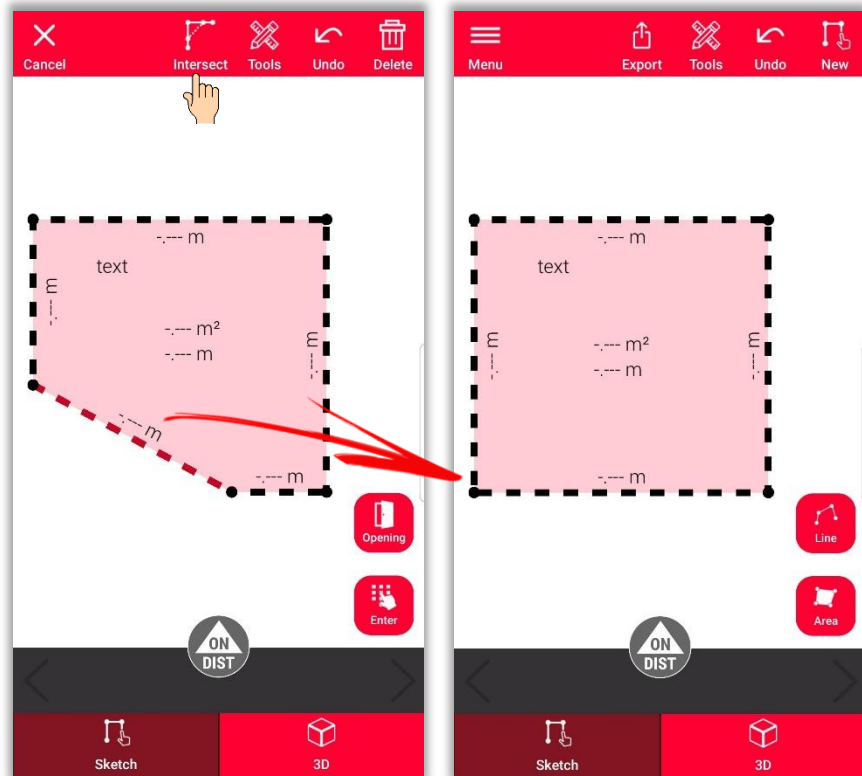
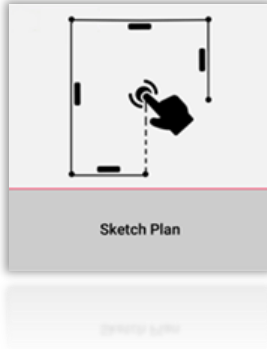

- when it has to be right

# Sketch Plan

## How to add measurement to a line

There are few ways to add new measurements to the sketch:

1. Select a line and Enter the length



Sketch will be automatically re-scaled and adjusted to the measurements

Calculated values will be displayed in brackets

The area and circumference will be displayed in the centre of the area

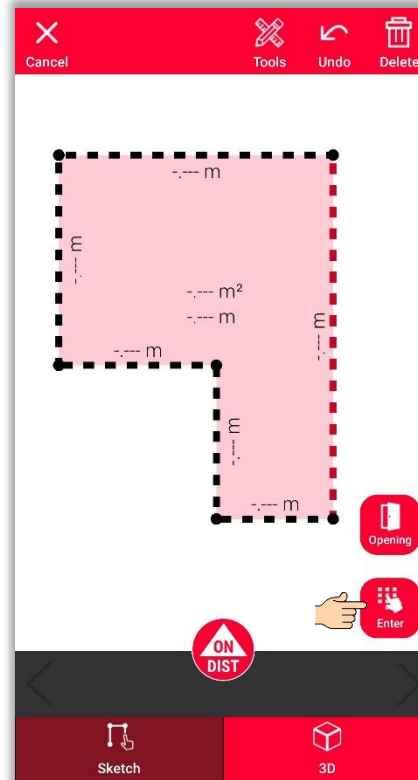

Enter length

 m

Enter the length of the line

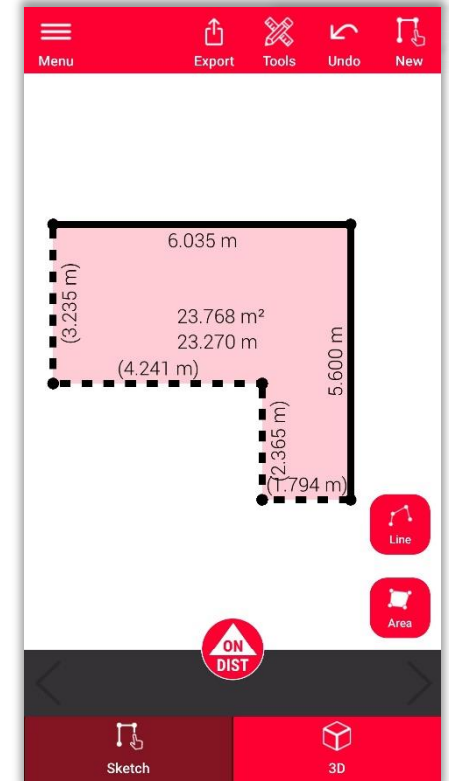

Measured lines will not be displayed as dashed lines anymore

- when it has to be right

# Sketch Plan

## How to add measurement to a line

There are few ways to add new measurements to the sketch:

1. Select a line and Enter the length
2. Select a line and select a measurement from the stack bar

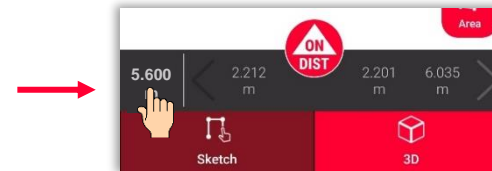
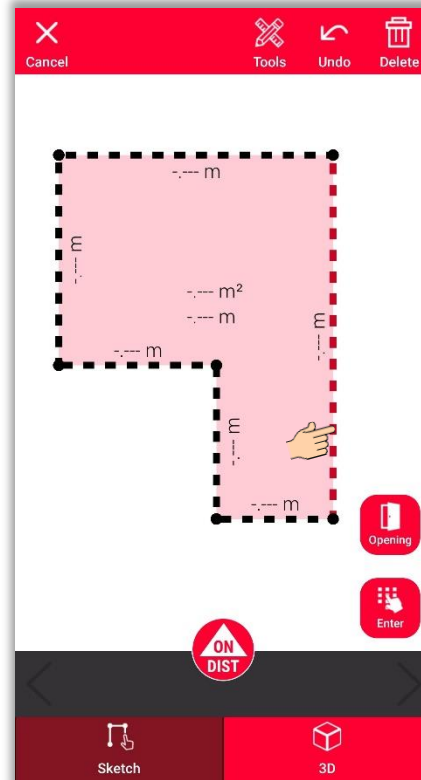

Measurement will be transmitted to the selected line

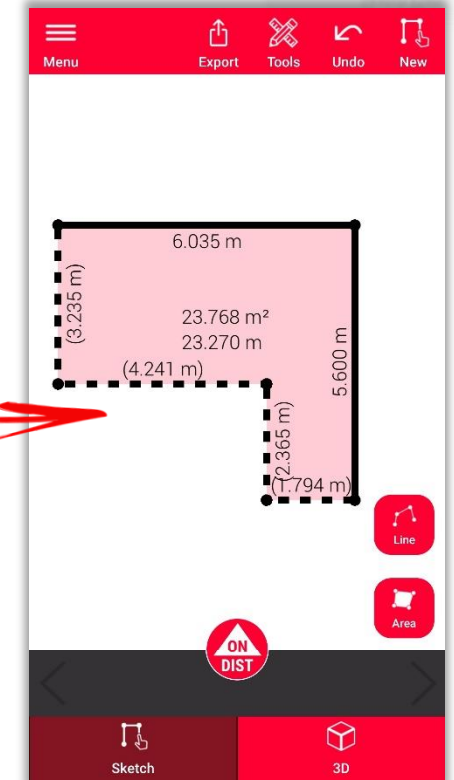

# Sketch Plan

## How to add measurement to a line

There are few ways to add new measurements to the sketch:

1. Select a line and Enter the length
2. Select a line and select a measurement from the stack bar
3. **Select a line and measure it with DISTO™ using red 'ON/DIST' button on the device or the screen**

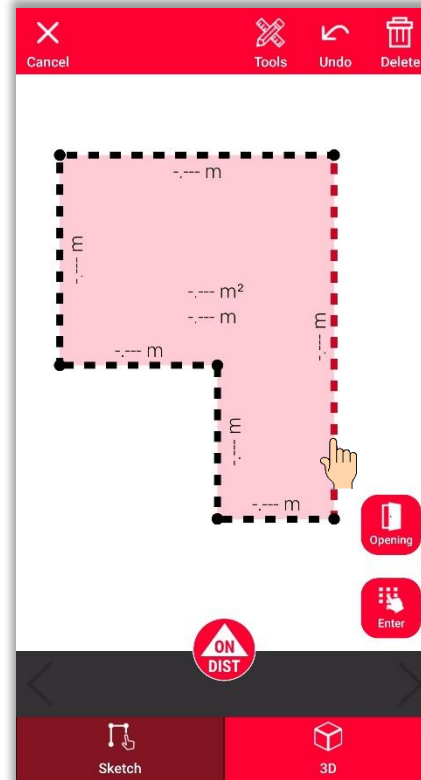

Measurement will be transmitted to the selected line

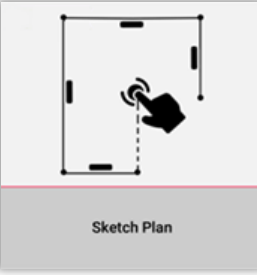
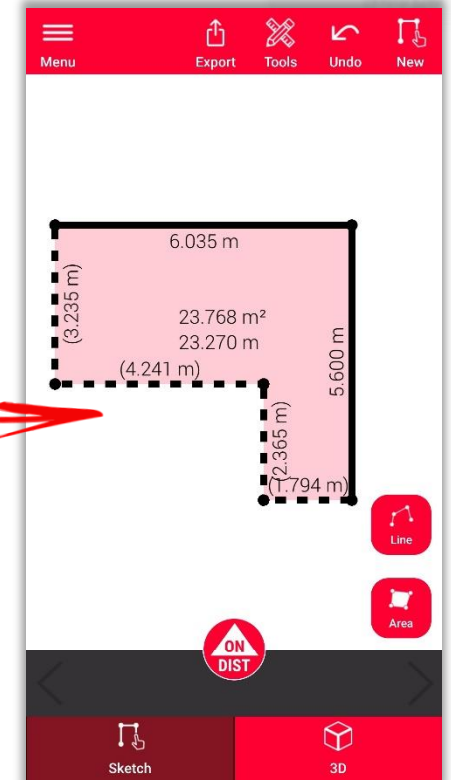

# Sketch Plan

## How to measure

There are few ways to add new measurements to the sketch:

1. Select a line and Enter the length
2. Select a line and select a measurement from the stack bar
3. Select a line and measure it with DISTO™ using red 'ON/DIST' button on the device or the screen
4. Drag and drop a measurement to a line



Use 'ON/DIST' button to measure and transmit the measurements to DISTO™ Plan App

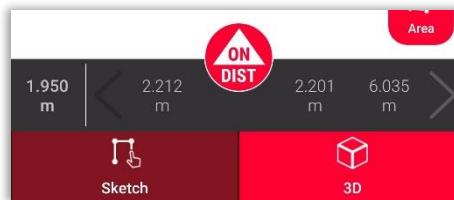

Measured distances will appear in the app

Drag and drop a measurement to a line

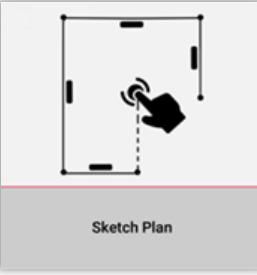
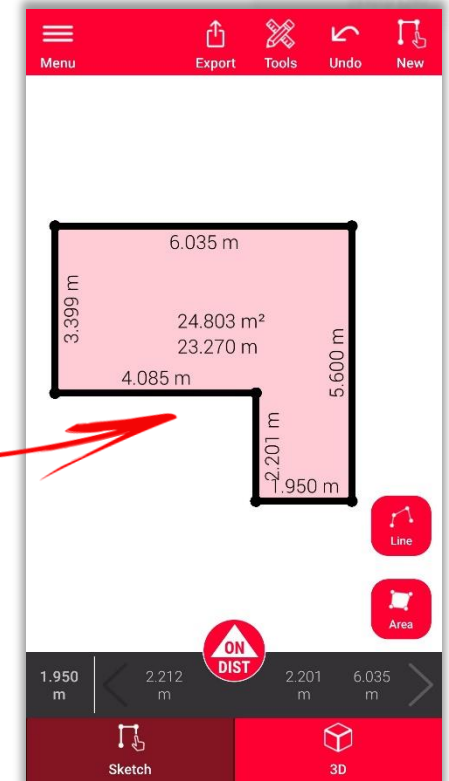
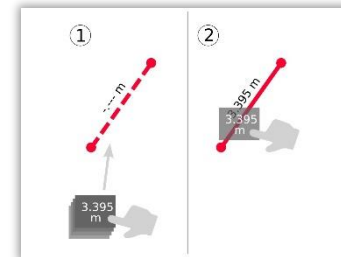

# Sketch Plan

## How to add Openings

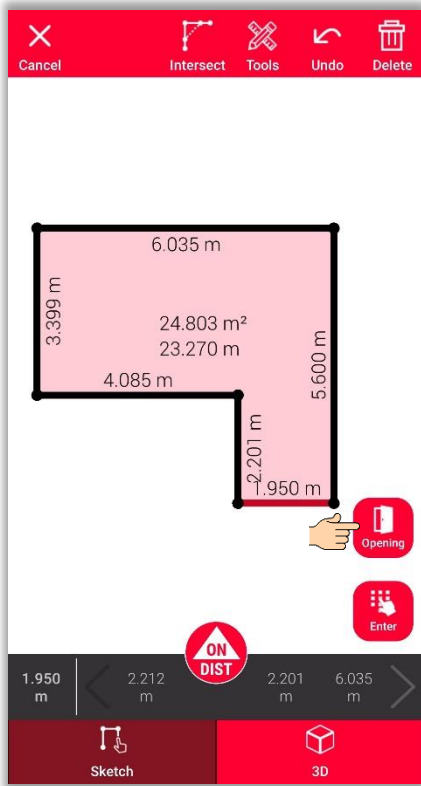
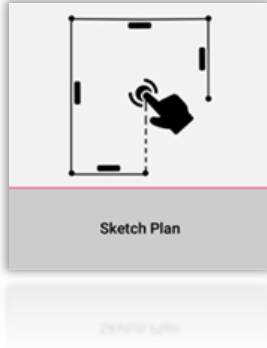

Select a line and use the “Opening” button to add doors or windows

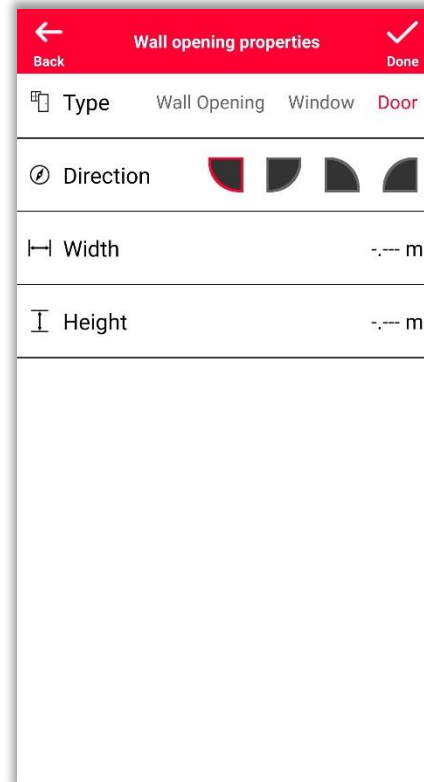

Modify **Type**, **Direction**, and **Dimensions** of the opening

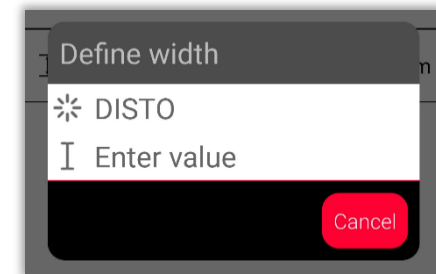

It is possible to measure the dimension with the DISTO™ or enter it manually

- when it has to be right

# Sketch Plan

## How to position Openings

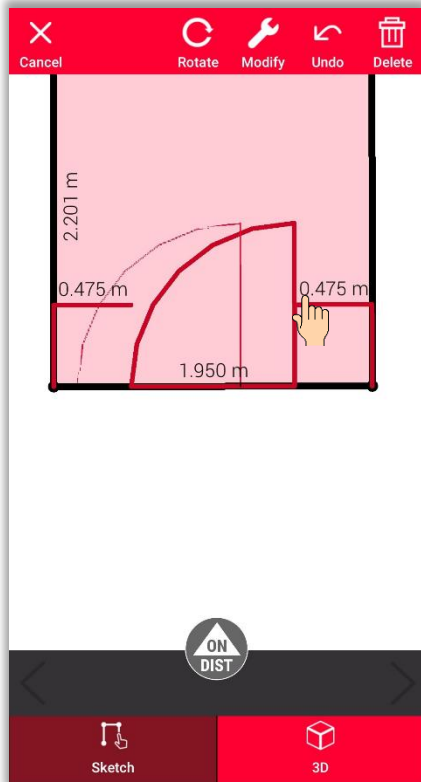

Long press on the **Opening** and move it, to change its position

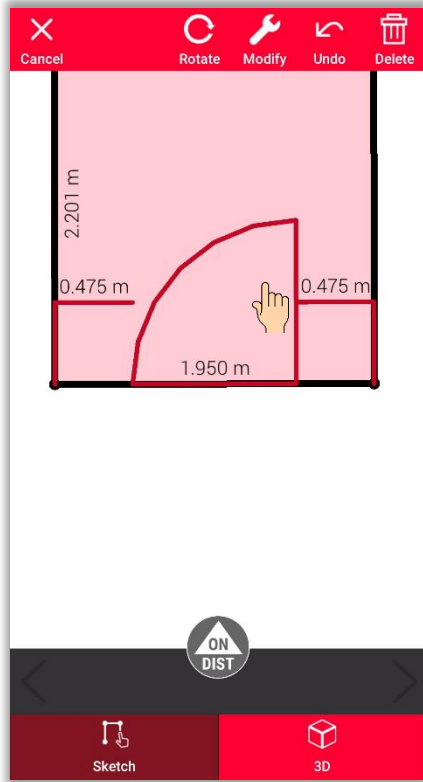

Or tap on the dimension to change it

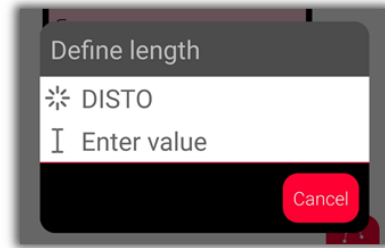

It is possible to measure the dimension with the DISTO™ or enter it manually

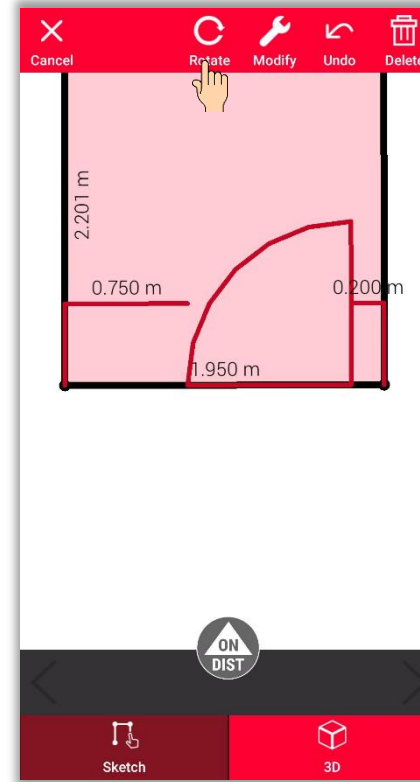

Use "Rotate" button to change the direction of the Opening



# Sketch Plan

## How to define a Room Height

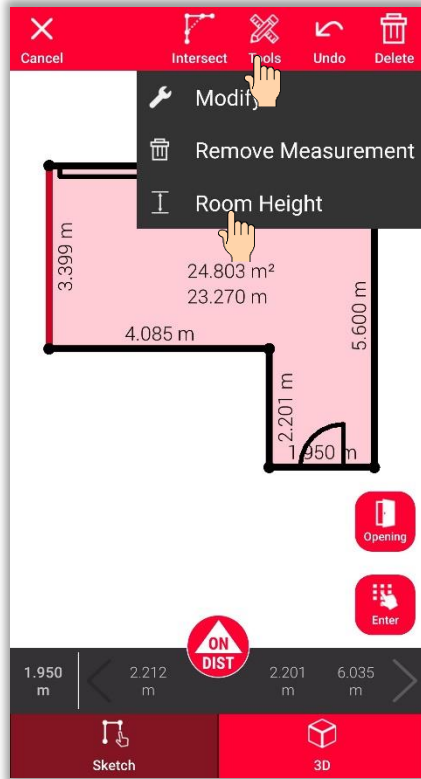
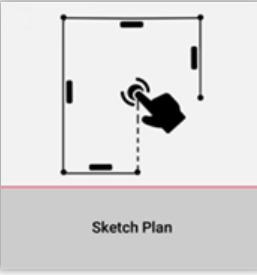

Select a wall and find the **Room Height** in Tools

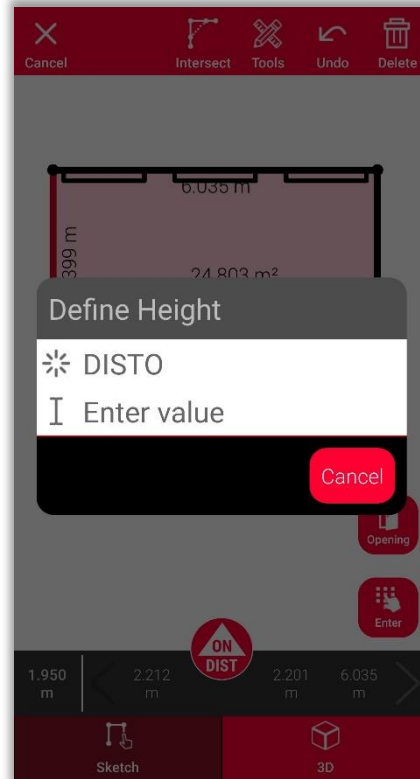

Choose the method of defining the room height

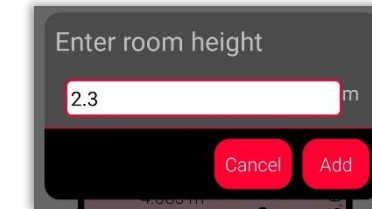

Measure room height using **DISTO™** or **Enter** it manually

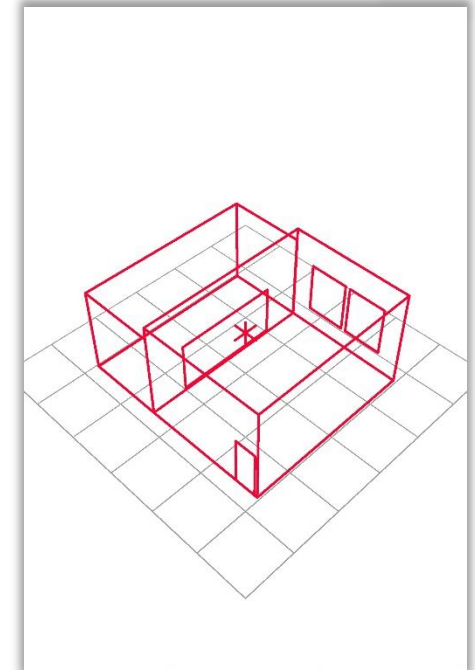



# Sketch Plan

## How to use Tools

- Add **Texts** and **Markers** to create quick notes and annotations
- Move sketch to **Projects** and add **Tags** to better organise

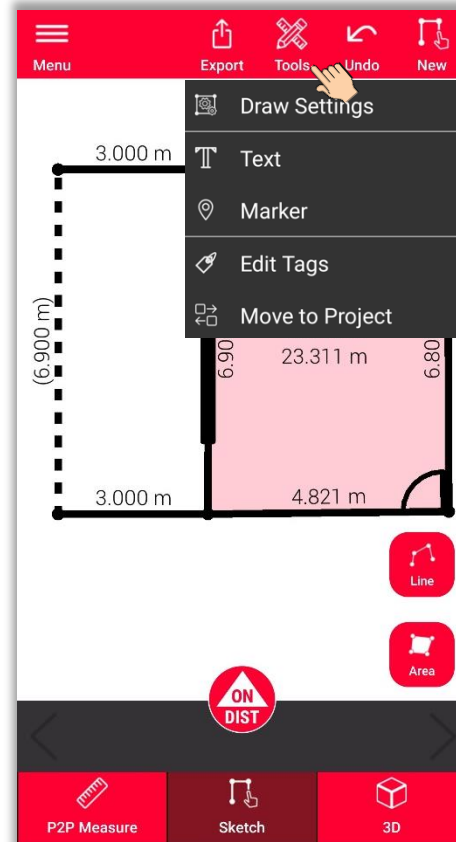

After selecting the tool  
click on the screen to add  
**Text** or **Marker**

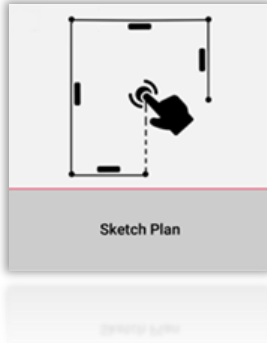
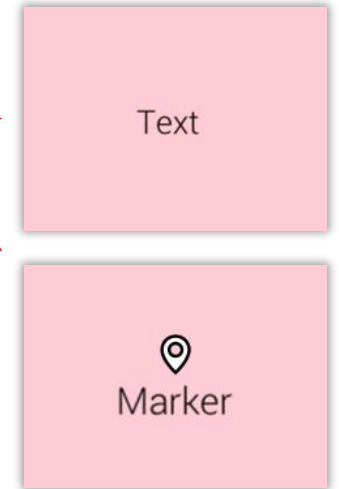

- when it has to be right

# Sketch Plan

## How to use 3D view

- In the **3D view** you can see a 3D representation of measured room
- You can easily zoom and rotate the view
- You can switch the view any time you want

Top

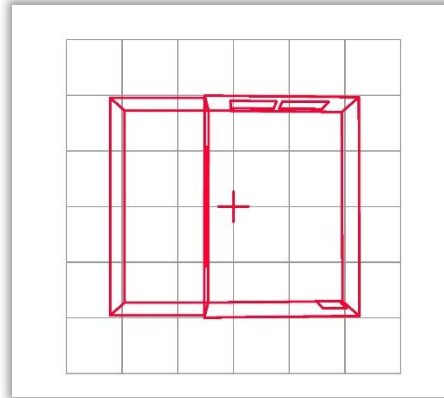

Front

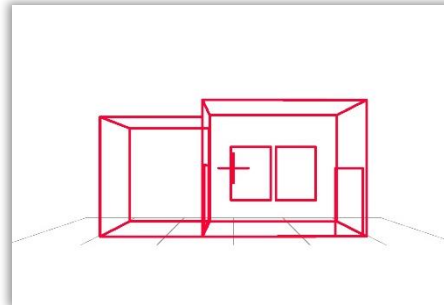

Side

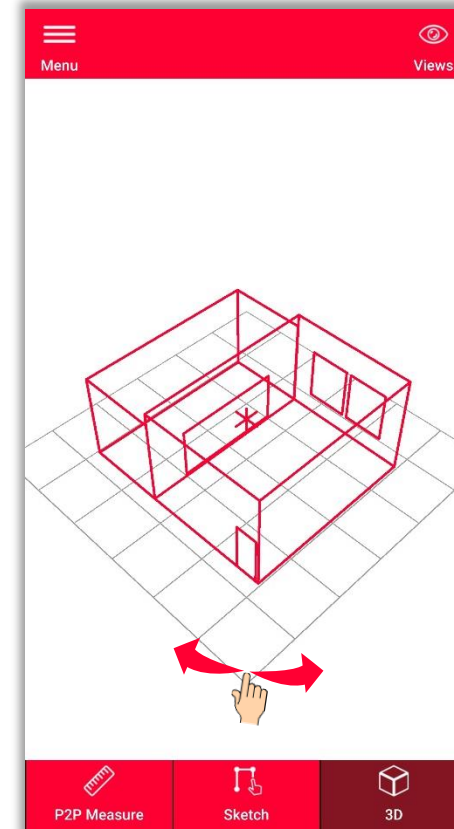
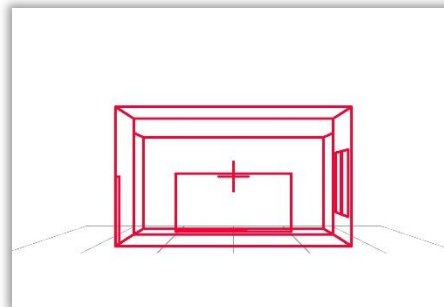

Perspective



Sketch Plan

- when it has to be right

# Sketch Plan

## How to Export

Export your plan in multiple formats:

- JPG

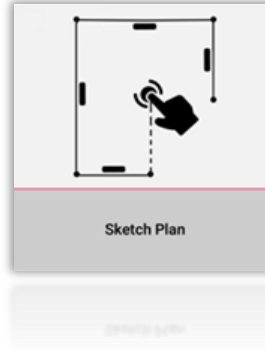
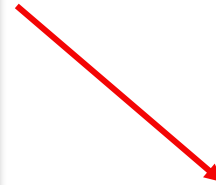
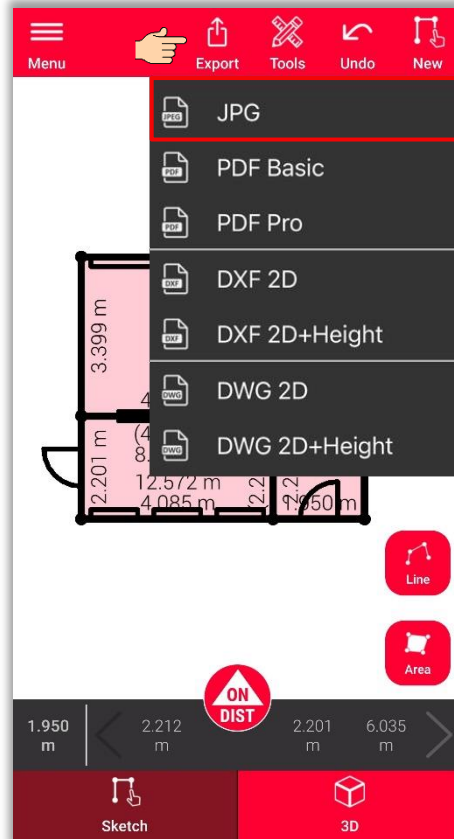

- when it has to be right



# Sketch Plan

## How to Export

Export your plan in multiple formats:

- JPG
- PDF Basic
- PDF Pro  
Only available with a valid subscription

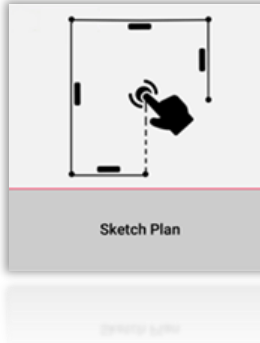
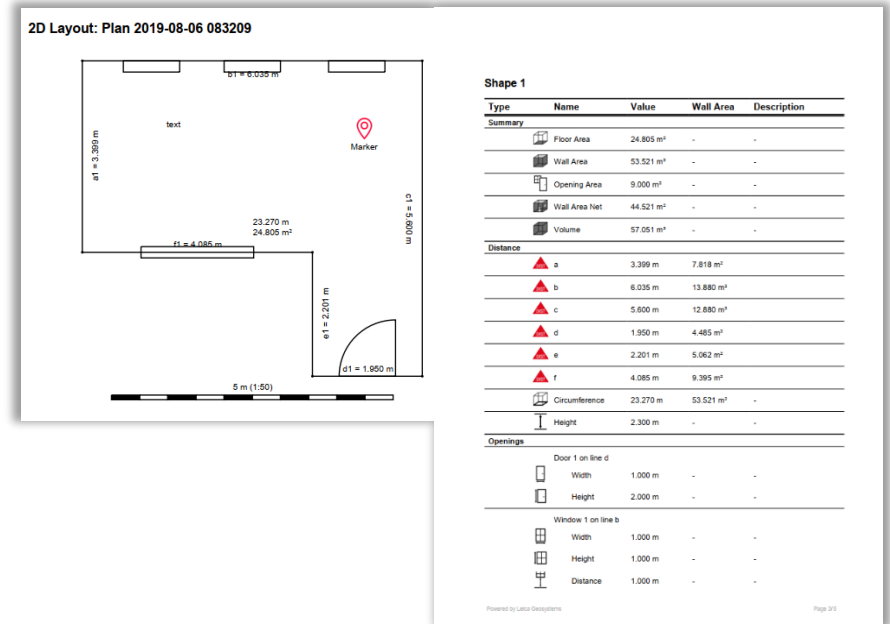
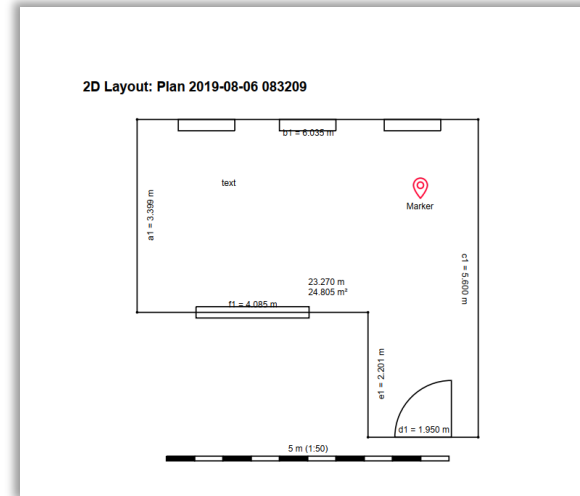
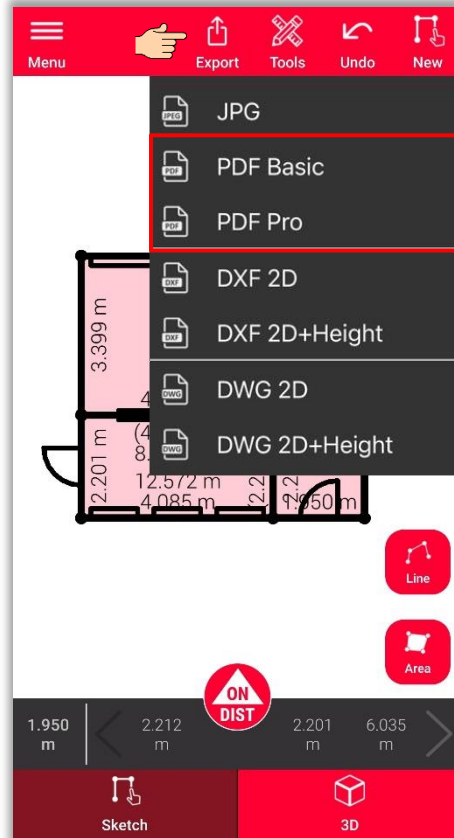

- when it has to be right

# Sketch Plan

## How to Export

Export your plan in multiple formats:

- JPG
- PDF Basic
- PDF Pro
- 2D DXF
- 2D DWG

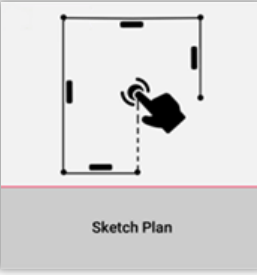
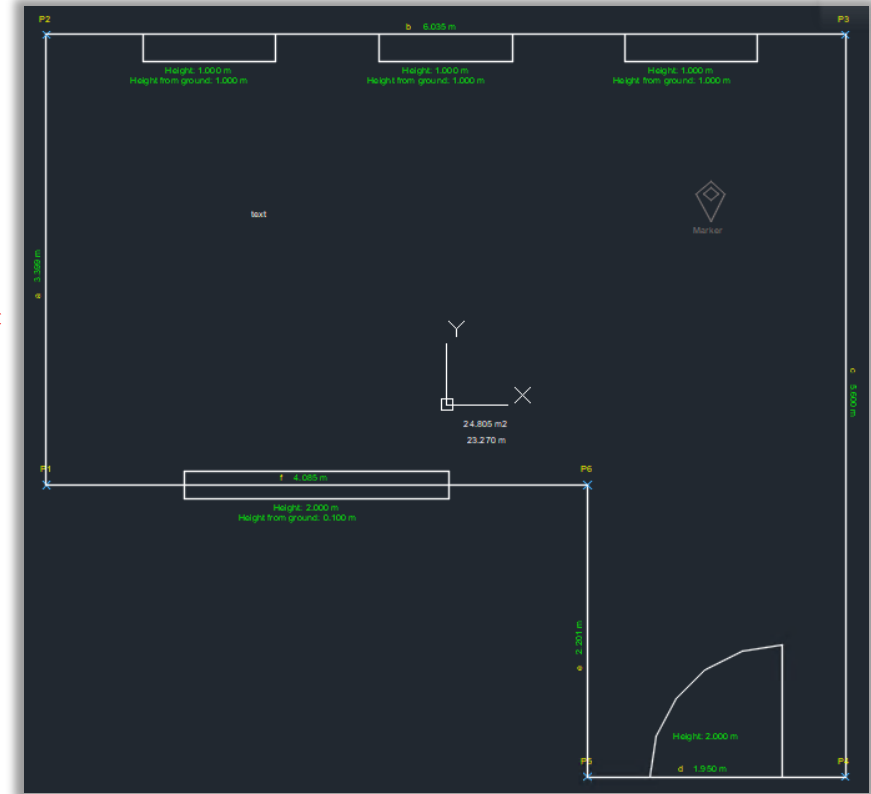
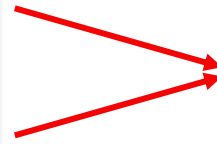
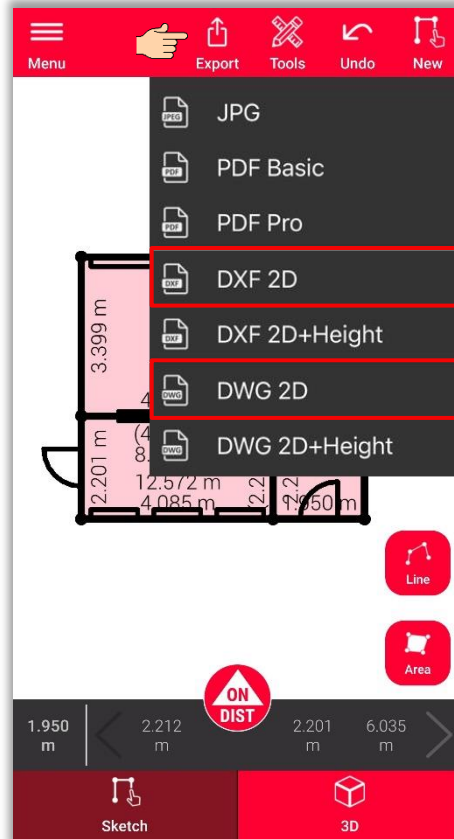

# Sketch Plan

## How to Export

Export your plan in multiple formats:

- JPG
- PDF Basic
- PDF Pro
- 2D DXF
- 2D DWG
- **2D+Height DXF**
- **2D+Height DWG**

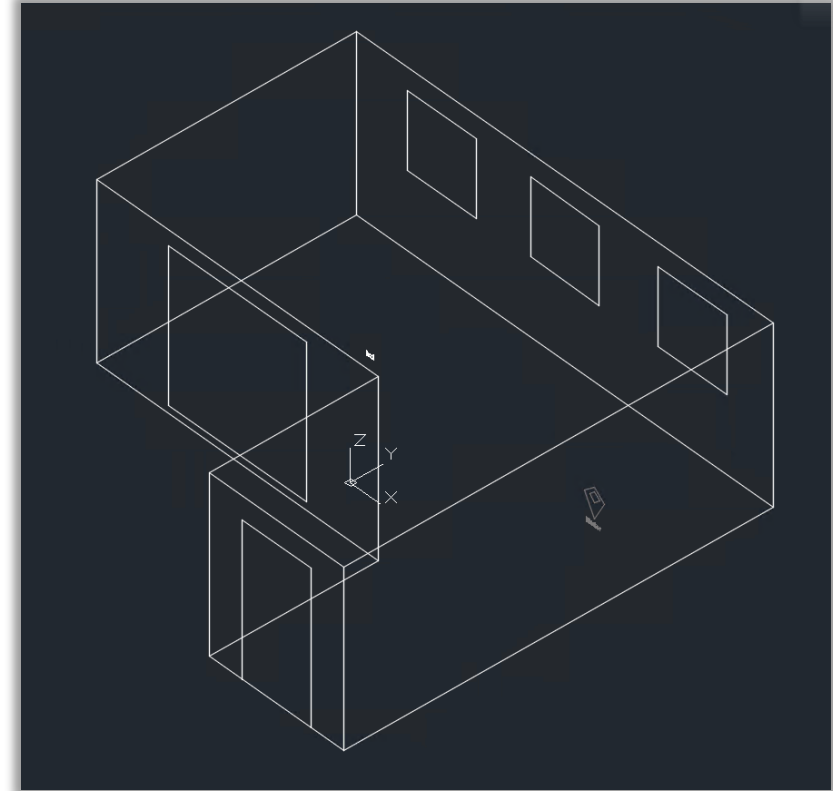
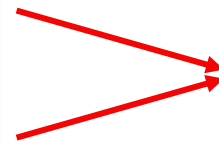
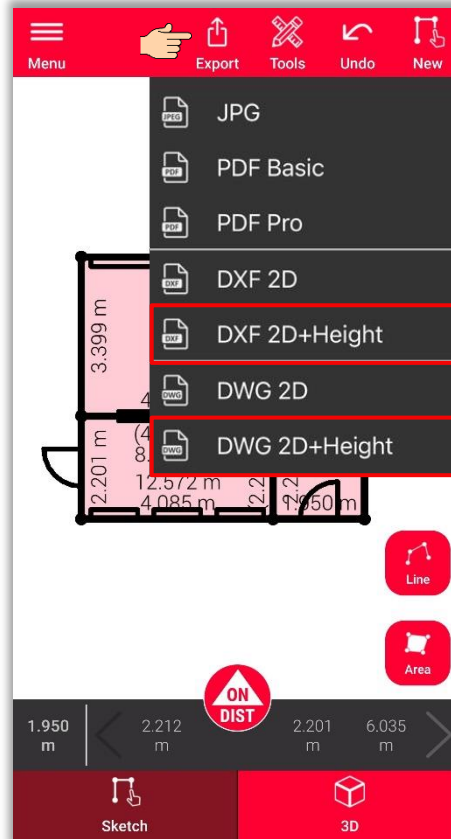

- when it has to be right

*Leica*  
Geosystems



# DISTO™ Plan App

## Sketch Plan

- when it has to be right

*Leica*  
Geosystems