

# Latitude

A shelving system made to stay and designed by Carsten Jörgensen 2017

Latitude is made of 70% recycled aluminum beer or soft drink cans collected all over Europe and recycled in Switzerland.

Latitude are anodized in a black and nature surface-treatment in a Swiss anodizing factory a few kilometers from the aluminum factory.

You can place the anodized aluminum shelvings in Kitchens - Entrances - Offices - Bathrooms - Bedrooms - Storage Rooms where the walls are flat and does not show a too rough and uneven surface.

Latitude are available in 4 basic length: 300mm - 500mm - 600mm - 800mm. It measure 139mm deep and 139mm high.

Included by each shelving size is: 1 adjustable triple hook. 2 Flathead Screws with wall plugs. 2 distance rubber rods.

For installation you simply have to follow the instructions shown on the following pages.

To maintain the shelves so that they will stay for many years please follow these few advices:

Squeeze one or two drops of mild dishwashing detergent into a cup of water. Apply the soapy water to a sponge or a soft kitchen towel and clean the aluminum vigorously. Anodized aluminum requires a gentle touch and a gentle cleaning solution, as many harsh cleaning products will react with the aluminum. After the washing with the detergent you can rinse the anodized aluminum surface with clean water and then dry it with towels.

If you have any questions to maintenance and installations please do not hesitate to call or write us at this address.

madetostay  
Carl Henkel GmbH  
Brändistrasse 18  
CH -6048 Horw  
Switzerland  
Phone + 41 - 41 - 412 1226  
Email: [info@carlhenkel.com](mailto:info@carlhenkel.com)  
[www.madetostay.com](http://www.madetostay.com)

What you can get:



What you need:

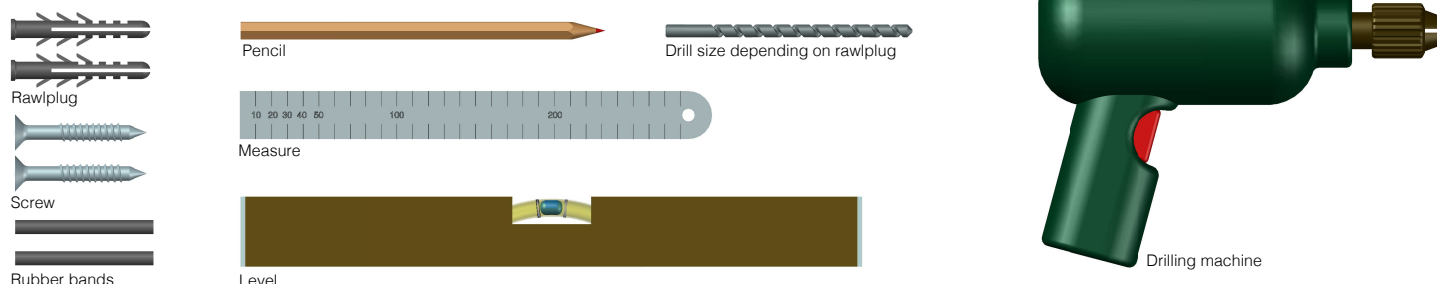

What you should know before starting:

Mounting your Latitude shelf on the wall depends on what kind of wall it is supposed to be attached to. In most cases wall plugs is required with the right dimension of the screws. They must be dimensioned according the material of your wall. Please ask for advice in your local hardware store. They will be able to assist you in finding the right wall plug and screws. You must inform what kind of wall material and that the screw head must be as shown below with a max screw head diameter not exceeding 12 mm and not smaller than 8 mm. The enclosed Rawlplug and Screws you can use for wall type 2) - 4) - 5)



## 1) Dry Walls:

This type of walls is mostly made from porous material and we therefore recommend using a wall plug suitable for such walls. See drawing.

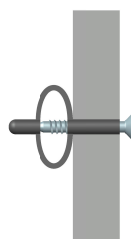

## 3) Concrete & Gypsum walls:

Concrete & Gypsum walls can easily be destroyed if using wrong fasteners. These types of walls are often found in newer buildings. It is required to make use of special fasteners (See drawing), which will displace the weight around the drilled hole to prevent the wall brakes. Please ask your hardware store for help.

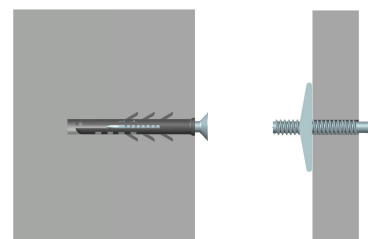

## 2) Brick and Solid Concrete Walls:

Make sure that you drill holes in the bricks and not in the sealer surrounding the bricks. Make use of wall plugs specifically for brick and/or solid concrete walls. *The enclosed wall plugs can be used for both bricks and some concrete wall types.*

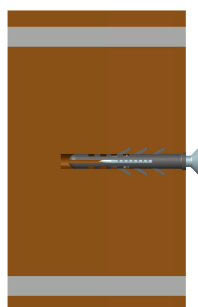

## 4) Aerated concrete & hollow blocks:

When mounting to aerated concrete walls, a wall plug is needed. Be aware that concrete walls can be thin.

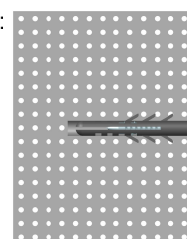

## Note:

*Please note that if installing your latitude in your kitchen or your bathroom plastered with tiles we suggest that you do not drill the holes in the sealer around the tile or close to the edge since ceramics easily splinter! Make use of drills specific made for tiles and do not force drilling by exert an unnecessarily high pressure!*

## 5) Wood:

When mounting your product to a wooden surface, screws specific for wood are required.



Some easy principals:

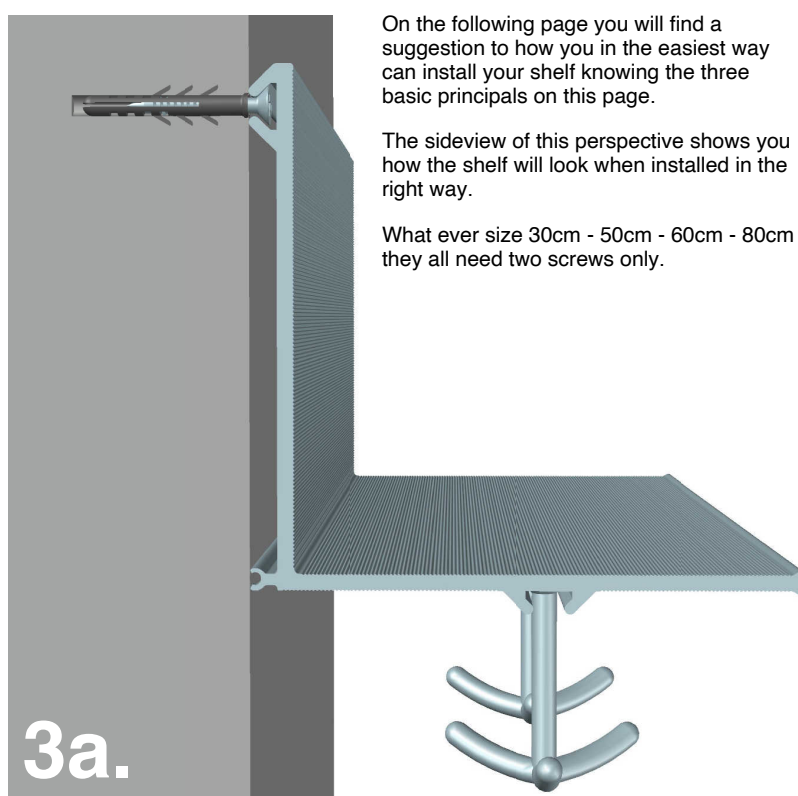
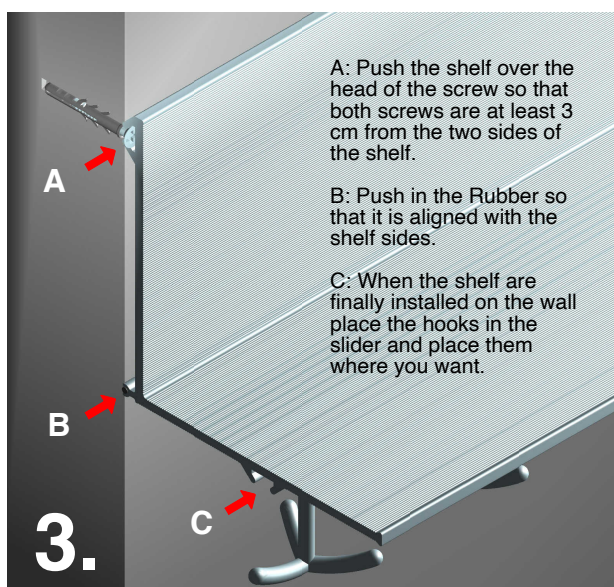
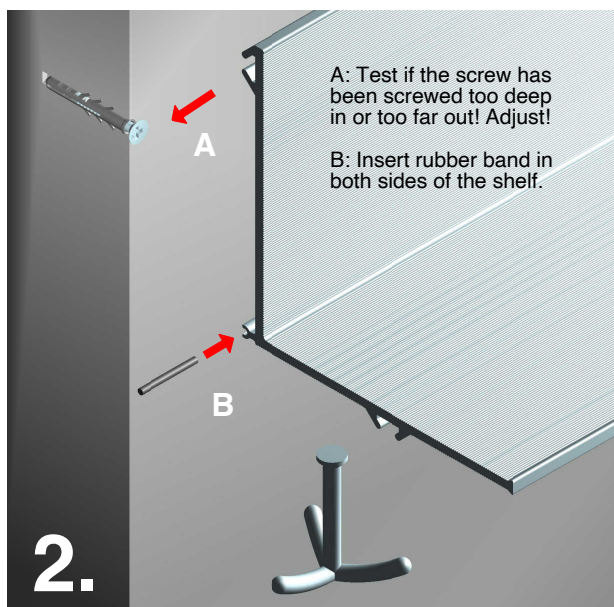
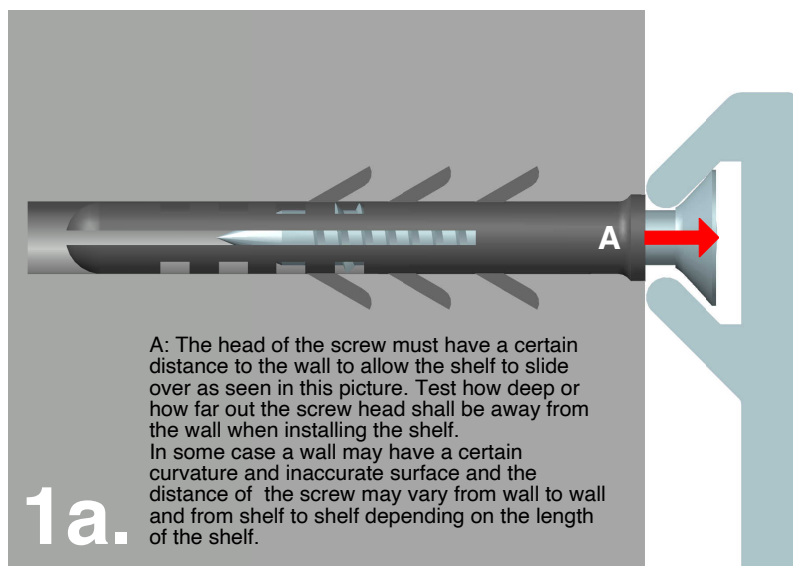
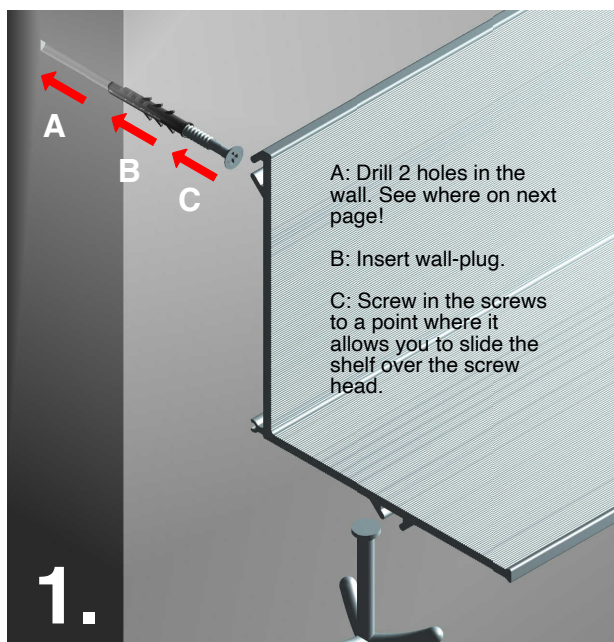

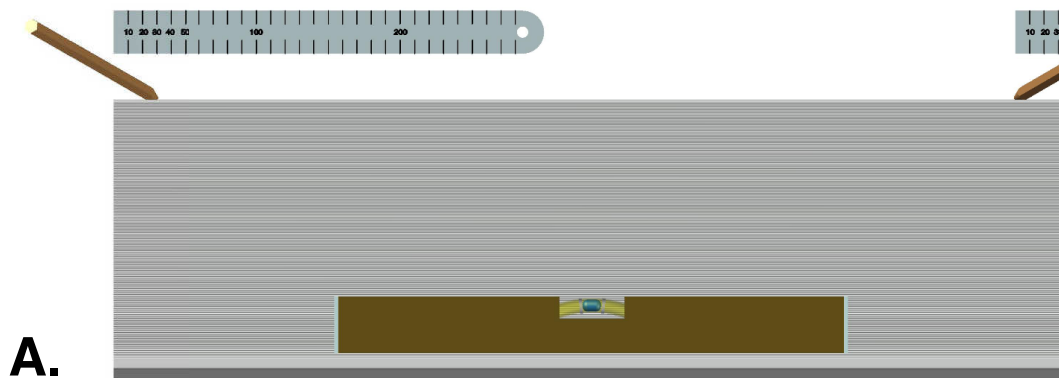

**A) Marking:**  
Place the leveller on your shelf and hold the shelf on the wall you want to place it. Measure minimum 3cm and maximum 5cm in from each side of the shelf. Make a precise marking on the wall where you have to drill the holes for the screws.  
It might make sense to be two persons. One to keep the shelf in level and to measure and make the marks.

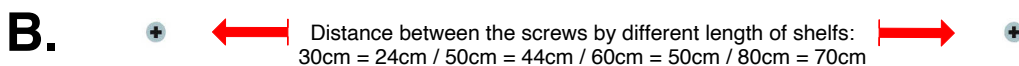

**B) Drilling - Insert raw-plugs - screw:**  
Drill as precise as you can considering the type of wall you are drilling into.  
Insert the raw-plugs and screw in the screws to a distance that makes it possible to push the shelf over the screw-head. If too tight unscrew a bit. If too loose tighten.

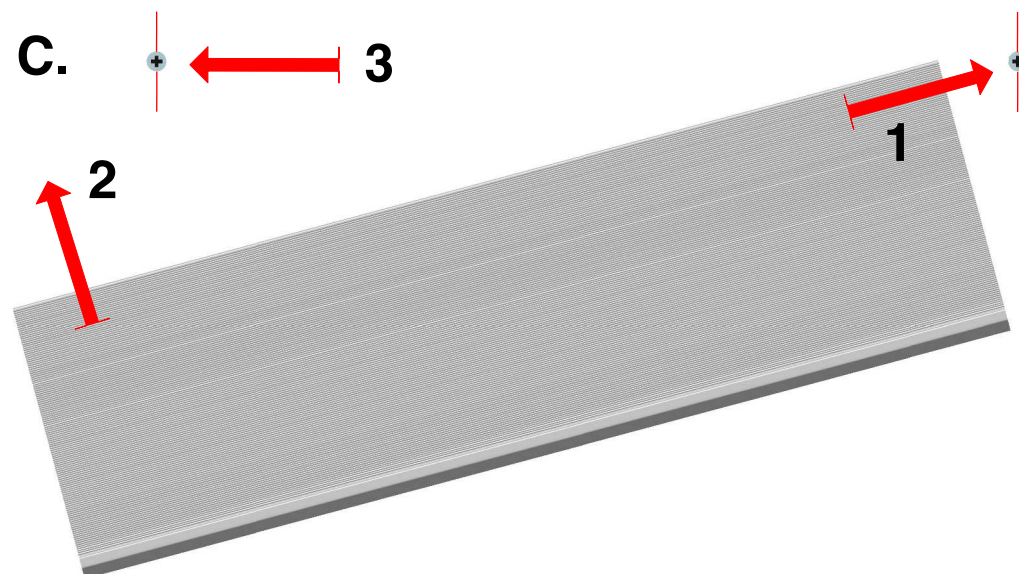

**C) Installing:**  
1) Push the shelf over the right side screw head until a point that the screw is about 4-5cm into the slide.  
2) Now turn up the other end of the shelf to a point align with the left side screw.  
3) Now push the shelf over the left side screw.

Now check if your shelf hangs stable on the wall.

Do not make use of any tools - such as hammers - to install the shelf in its final position. Instead loosen or tighten the screws accordingly.

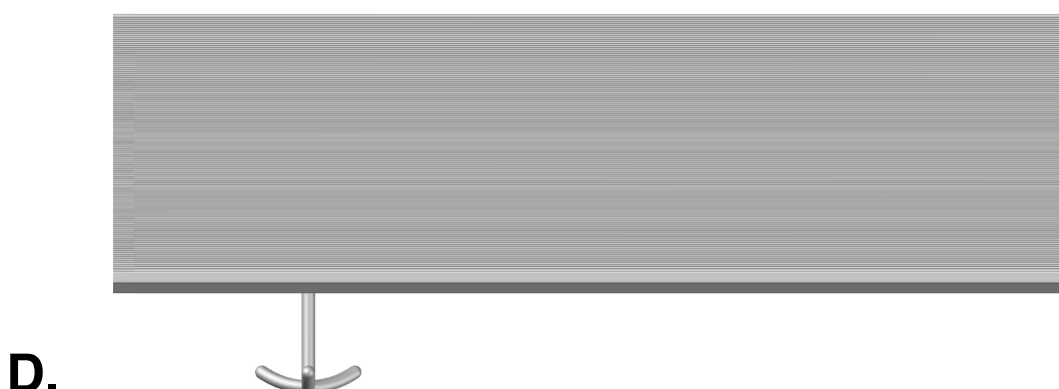

**D) Installed:**  
Please check if the two screws are tight enough and are situated in the same distance from each side of the shelf.