

RGB+CCT Knob Remote

Model No.: K6

Product Feature

- Brightness and color temperature adjustable
- 2.4GHz wireless transmission technology
- Support MiBoxer/Mi-Light 2.4G series
- Control distance: 30m
- Supports saving 4 scene/ 4 Zone presets (up to 4 presets can be saved)
- Supports matching multiple devices and can control multiple devices at the same time



Product Parameter

Product Name:	RGB+CCT Knob Remote	Working temperature:	-10~40°C
Model No.:	K6	EMC standard(EMC):	ETSI EN 301 489-1 V2.2.3 ETSI EN 301 489-3 V2.3.2
Working voltage:	3V(AAA*2PCS)	Security Standard(LVD):	EN 61347-2-11: 2001+A1: 2019 EN 61347-1: 2015+A1:2021 EN 62493:2015+A1:2022
Standby consumption:	20μA	Radio equipment(RED):	ETSI EN 300 400 V2.2.1
Transmission:	6dBm	Certification:	CE、EMC、LVD、RED
Protocol:	2.4GHz RF		
Modulation:	GFSK		
Control Distance:	30M		

Size



Function

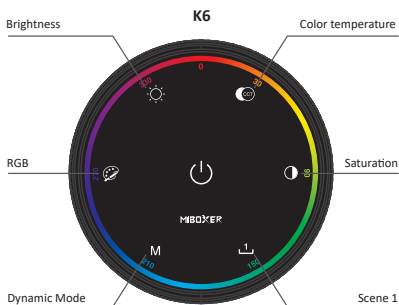

Short press it and rotating the remote to dim brightness, range from 1% to 100%



Short press it and rotating the remote to adjust color temperature, the range from 2700K to 6500K



Short press it and rotating the remote to change saturation, range from 0.00-1.00



Short press it and rotating the remote to change RGB, range from 0-359 (LED screen display the figure)

Setting CCT:



Press + button 3 seconds simultaneously to enter into mini CCT setting , with a minimum adjustable value of 1800K.



Press + button 3 seconds simultaneously to enter into Max CCT setting , with a minimum adjustable value of 10000K.



Reminding Lo- if it's low battery

M



Total 9 dynamic modes

Short press one time to select dynamic mode,
short press continuously to switch next dynamic mode

Scenes mode

Short press: Activate scene

Long press 3 seconds: Save the current lighting state/
(the light flashes one time slowly once completed successfully).

Link/Unlink

Link controller must link with remote before using it

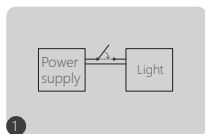

Turn off light 10 seconds and
turn on again



Short press "  " 6 times within 3
seconds



Link is done once light flashes
3 times slowly



Link is failed if light doesn't flash, please repeat above steps
(Attention: can not link again if remote already finished linking)

Unlink

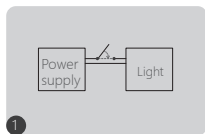

Turn off light 10 seconds and
turn on again

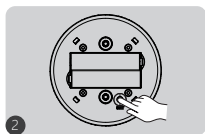

Short press "SET" 5 times within
3 seconds



Link is done once light flashes
10 times quickly



Unlink is failed if light doesn't flash, please repeat above steps
(Attention: no need to unlink if the light never be linked)

Installation

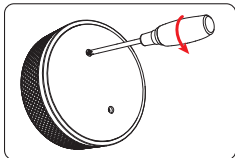

1. Loosen the screws and open the battery cover.



2. Put 3V(AAA*2) battery into it

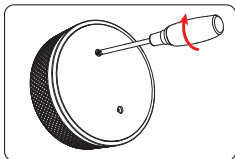

3. Cover it with the battery cover and tighten the screws.

Attention:

1. To control MiBoxer/Mi-Light 2.4G series products, Please refer to the product manual for compatibility.
2. Don't use it in humidity or high temperature area, please take out battery if don't use it frequently and keep it in dry or static electricity area
3. Don't use it near metal or strong magnetic area, it will affect signal and lost distance.

