

Din Rail 5 in 1 LED controller (Zigbee 3.0 + 2.4G)

Model No.:TZ5

Features

- Zigbee 3.0 + 2.4Ghz wireless transmitting
- Compatible with standard 35mm universal rail
- 16 million colors adjustable, Saturation, RGB, Brightness, color temperature adjustable
- Built-in 18 dynamic mode with jumping, gradually changing(only for 2.4G remote control)
- Auto-forwarding: Automatically forward the remote control signal to another controller, making the remote control distance infinite
- Automatic synchronization: The same dynamic mode is automatically synchronized, so that the mode is always consistent
- Have DND function, usually used in power failure area and save power
- Support TUYA SMART app control (Zigbee 3.0 gateway is needed)
- Support third party voice control like Alexa, Google assistant, Yandex Alice (Zigbee 3.0 gateway is needed)



Parameters

Name: Din Rail 5 in 1 LED controller	Working Temperature: -10~40℃
Model No: TZ5	EMC Standard (EMC): ETSI EN 301 489-1 V2.2.3(2019-11) ETSI EN 301 489-3 V2.3.2 (2023-01)
Input Voltage: DC12~24V	
Output Current: 12A/ Channel	Safety Standard (LVD): EN 61347-1: 2015+A1: 2021 EN 61347-2-11: 2001+A1:2019
Total Output: Max 20A	
Protocol: Zigbee 3.0 + 2.4G	Radio Equipment (RED): ETSI EN 300 328 V2.2.2 (2019-07)
Control Distance: Zigbee: 50m(Open Area) RF: 30m	Certification: CE, EMC, LVD, RED
IP Rating: IP20	

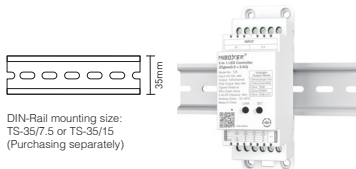
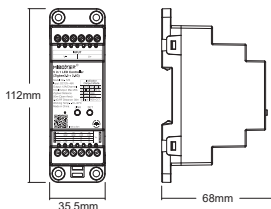

Connection Diagram

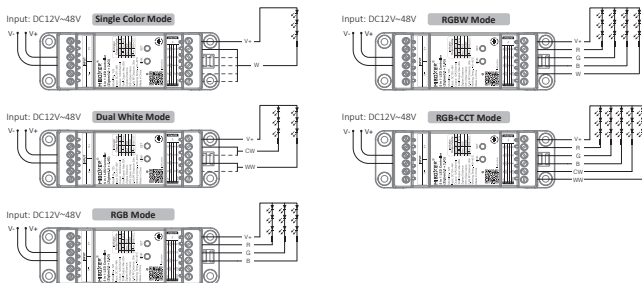

Setting Output Mode

Output mode is related with connected led lights

Solution: short press " SET " to switch mode (attention: it will step out automatically without any operation within 3 seconds)



Indicator Output Mode	
1	White Single Color
2	Yellow Dual White
3	Red RGB
4	Green RGBW
5	Blue RGB+CCT

Application Diagram

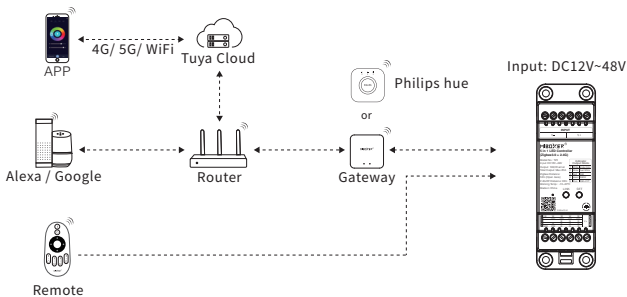

Compatible with these 2.4G RF remote controls (Purchased separately)

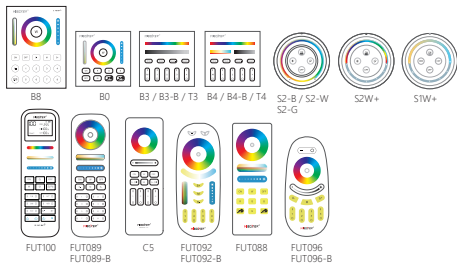

2.4G RF Remote control instruction

Linking Code Instructions

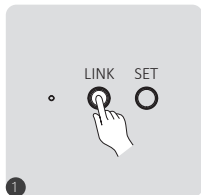

Short press "Link" button once



Short press " I " button 3 times within 3 seconds.



Lights blink 3 times slowly means linking is done successfully.



Linking failed if light is not blinking slowly, Please follow above steps again. (Note: Light that have linked can't link again)

Unlinking Code Instructions

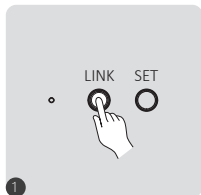

Short press "Link" button once



Short press " I " button 5 times within 3 seconds.



Lights blink 10 times quickly means unlinking is done successfully.



Unlinking failed if light is not blinking quickly, Please follow above steps again. (Note: Light haven't linked that don't need to unlink)

Dynamic mode table selection (only for remote control)

Select dynamic mode table 1:

While the light is in static mode, short press “**S+**” button 5 times quickly until blue light flashes 3 times slowly, static mode is activated successfully.

Select dynamic mode table 2:

While the light is in static mode, short press “**S-**” button 5 times quickly until yellow light flashes 3 times slowly, static mode is activated successfully.

Dynamic mode table 1 (default)

Number	Dynamic Mode	Brightness / Saturation / Speed
1	Mardi Gras	Adjustable
2	Automatic color change	
3	Sam	
4	Gemstone	
5	Twilight	
6	American	
7	Fat Tuesday	
8	Party	
9	Slow Color Splash	

Dynamic mode table 2 (need to switch manually)

Number	Dynamic Mode	Brightness / Saturation / Speed
1	Seven colors gradual change	Adjustable
2	White light Gradual change	
3	RGB gradual change	
4	Seven colors jump to change	
5	Jump to change randomly	
6	Red light gradual change +Flash 3 times	
7	Green light gradual change +Flash 3 times	
8	Blue light gradual change +Flash 3 times	
9	White light gradual change +Flash 3 times	

Auto transmitting & Synchronization (only for remote control)

Remote signal auto transmitting

One light can transmit the signals from the remote control to another light within 30m, as long as there is a light within 30m, the remote control distance can be limitless.

Dynamic modes auto synchronization

Multi lights can synchronize if they are in same dynamic mode and linked with same remote (distance between each light is within 30m)

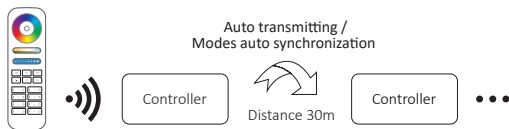

Turn Do Not Disturb mode on and off (ON by default)

Turn on "Do Not Disturb" (applicable to areas with frequent power outages to save energy)

Turn on Do Not Disturb mode:

Short press the "OFF" button 3 times within 3 seconds, and then short press the "ON" button 3 times. The light flashes 4 times to indicate success.

Note: When the lamp is powered on again after a power outage, its status (lights on or off) will remain the same as before the power outage.

Turn off Do Not Disturb mode:

Short press the "ON" button 3 times within 3 seconds, and then short press the "OFF" button 3 times. The light flashes 4 times slowly to indicate successful shutdown.

Note: When the lamp is powered on again after a power outage, its status will be on by default.

Smartphone APP control instruction

Added Zigbee 3.0 gateway into "Tuya Smart" App (please review instruction of Zigbee 3.0 gateway)

- 1). Connect with power supply.
- 2). Pairing network (**attention: factory default is pairing network**).
Way one: Turn off and turn on light 6 times or over 6 times continuously, the light is in breathing status.
Way two: Long press " LINK " key until indicator light flashing.
- 3). Open "Tuya Smart" APP to click Zigbee gateway, then click "Add sub device".
- 4). Click "Indicator is flashing quickly".
- 5). Support APP dimming or group control and etc once added successfully.

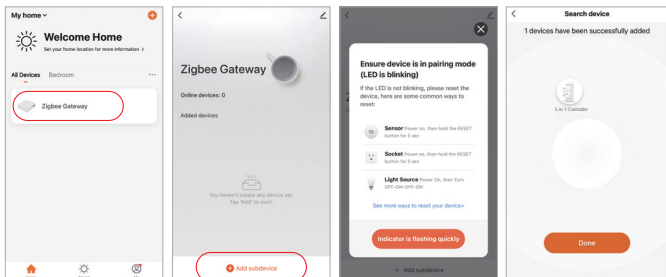

App turn on and off "Do Not Disturb" mode (default activated)

Click the light which need to be set up or group control --- click "More" --- click "Power-on behavior" --- turn on or off

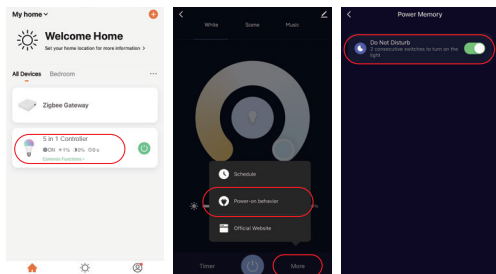

Philips Hue control instruction

Added "Philips Hue" into APP

- 1). Connect with power supply
- 2). Pairing network (**attention: factory default is pairing network**)
Way one: Turn off and turn on light 6 times or over 6 times continuously, the light is in breathing status.
Way two: Long press " SET " key until indicator light flashing.
- 3). Open "Philips Hue" App to click "SETTINGS" and click "Lights"
- 4). Click "+" on the top of right corner
- 5). Click "Search"
- 6). Click "Start configuration", Follow the app instruction to complete configuration

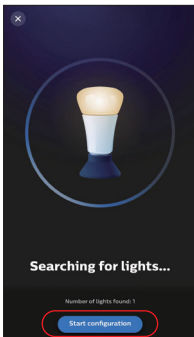
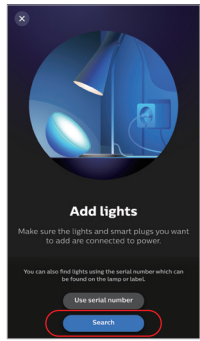
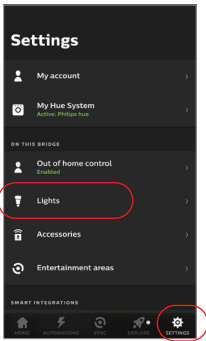

Alexa voice control instruction

1). Alexa control (Audio support Zigbee 3.0 protocol)

You can connect directly if your Amazon ECHO already is built-in zigbee 3.0 protocol, following model with zigbee 3.0 protocol:

Amazon ECHO Plus (2nd Gen), ECHO (4th Gen), ECHO Studio, ECHO Show (2. Gen)

- 1). Connect with power supply
- 2). Pairing network (**attention: factory default is pairing network**)

Way one: Turn off and turn on light 6 times or over 6 times continuously, the light is in breathing status.

Way two: Long press " SET " key until indicator light flashing.

- 3). Say to Amazon ECHO "Alexa, Discover devices"
Wait for a while to discover device, Voice control is activated

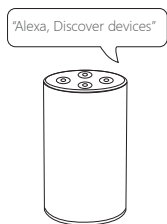

2). Alexa control (Audio don't support Zigbee 3.0 protocol)

Please add device into Miboxer Zigbee 3.0 gateway if your Alexa don't support zigbee 3.0 protocol , then start following steps

- 1). Open Alexa App
- 2). Click "More" on the bottom of right corner
- 3). Click "Skills & Games"

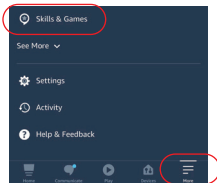

- 4). Click "Q" on the top of right corner
- 5). Type into "Smart life" and search



- 6). Click "Smart Life" skill, follow instruction to finish configuration and start voice control

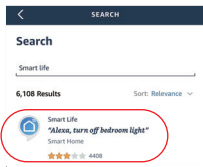

Google Home voice control instruction

Please add device into MiBoxer Zigbee 3.0 gateway ([check details in page 6](#)) and start following steps

- 1). Open Google Home App
- 2). Click “+” on the top of left corner

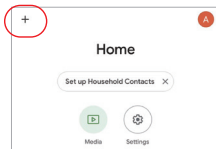

- 3). Click “Set up device”

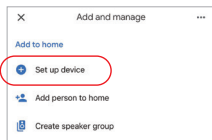

- 4). Click “Works with Google”

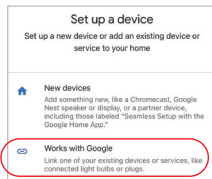

- 5). Click “Q” on the top of right corner
- 6). Type into “Smart life” and search
- 7). “Smart Life” skill, follow instruction to finish configuration and start voice control

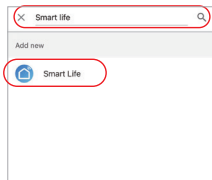

Notice

1. Please check whether the voltage of the power supply is in accordance with the light, and please check the connection of both the cathode and anode, otherwise the light will be broken.
2. Please don't connect wires with power on. Please turn on again only when it is in right connection and no short circuit.
3. Non-professional user cannot dismantle the lighting fixtures directly.
4. Please do not use the light in the place with widely range metal area or strong electromagnetic wave nearby, otherwise, the remote distance will be seriously affected.



Dimmer can not
use in humid area

Made in China