

**BARBECUES : 4 SERIES CLASSIC**  
**LS - LS PLUS - LS G - LD S PLUS - LDSG PLUS**  
**LS D - LS PLUS D - LXS**



**4 SERIES CLASSIC LS**  
**4 SERIES CLASSIC LS PLUS**



**4 SERIES CLASSIC LS G**



**4 SERIES CLASSIC LD S PLUS**  
**4 SERIES CLASSIC LDSG PLUS**  
**4 SERIES CLASSIC LS D**  
**4 SERIES CLASSIC LS PLUS D**



**4 SERIES CLASSIC LXS**

**BARBECUES : 4 SERIES CLASSIC**  
**LS - LS PLUS - LS G - LD S PLUS - LDSG PLUS**  
**LS D - LS PLUS D - LXS**

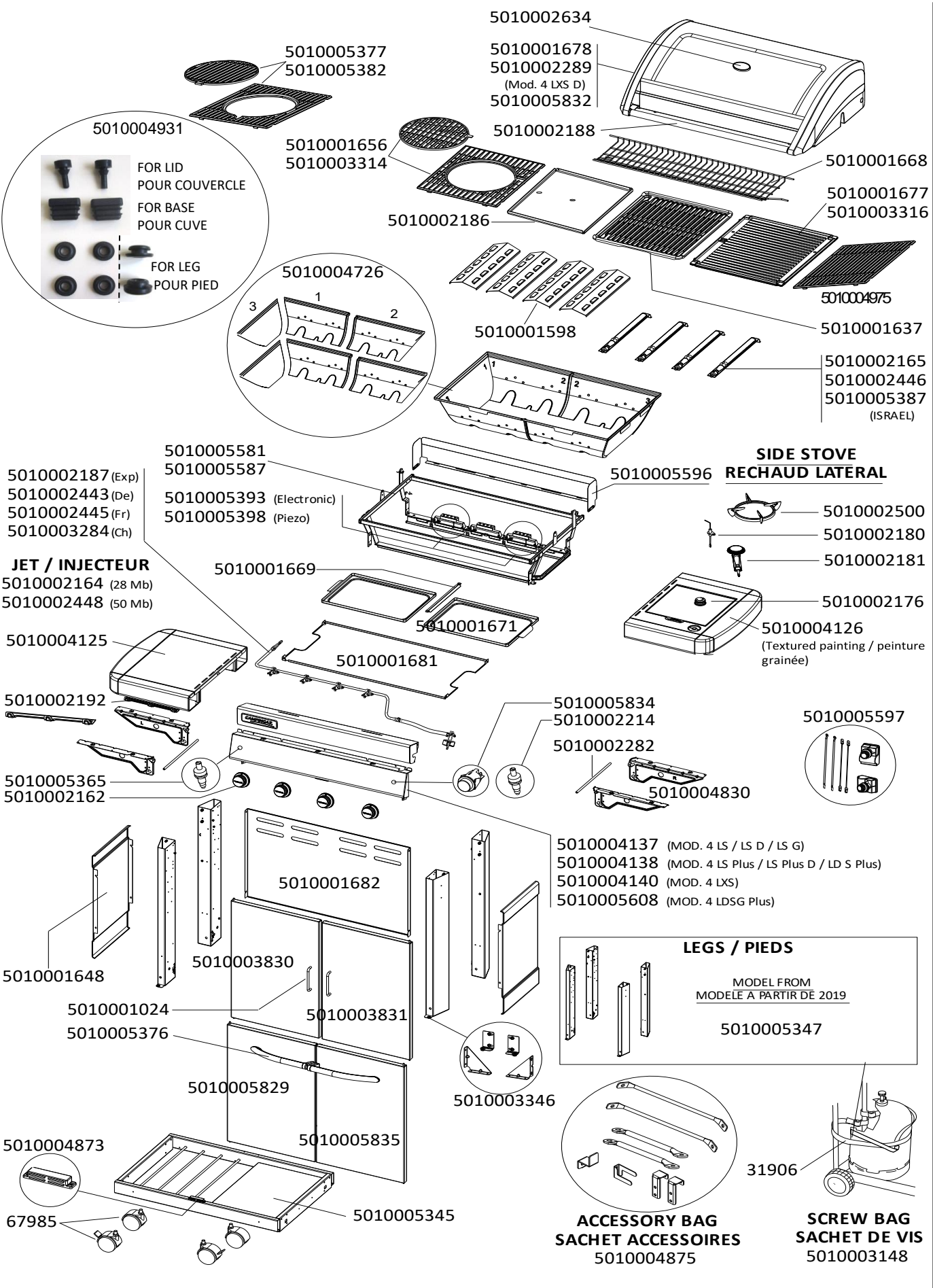

**BARBECUES : 4 SERIES CLASSIC**  
**LS - LS PLUS - LS G - LD S PLUS - LDSG PLUS**  
**LS D - LS PLUS D - LXS**



SPARE PARTS REF.	POINTS	EN DESCRIPTIONS	FR DESCRIPTIONS	4 SERIES CLASSIC	
				LD S PLUS LDSG Plus / LS / LS D / LS G LS PLUS / LS PLUS D	LXS
31906	30	CYLINDER STRAP	SANGLE BOUTEILLE	X	X
67985	90	SET OF WHEELS (x2)	ENSEMBLE ROUES (x2)	X	X
5010001024	40	HANDLE / USTENSIL HOLDER	POIGNEE / PORTE USTENSILE	X	X
5010001598	100	STEEL HEAT DIFFUSER (x1)	DIFFUSEUR DE CHALEUR ACIER (x1)	X	X
5010001637	140	STEEL COOKING GRID - SHINY	GRILLE DE CUISSON ACIER - BRILLANTE	X	
5010001648	60	LEFT OR RIGHT SIDE PANEL (DARK GREY)	PANNEAU LATERAL GAUCHE OU DROITE (GRIS FONCE)	X	X
5010001656	270	ENAMELLED CAST IRON GRID (FRAME + CIRCLE) - SHINY	GRILLE DE CUISSON FONTE EMAILLEE (CADRE + CERCLE) - BRILLANTE	X	X
5010001668	120	WARMING GRID	GRILLE DE MIJOTAGE	X	X
5010001669	30	GREASE DRAWER TENT	TENTE TIROIR RAMASSE GRAISSE	X	X
5010001671	50	GREASE PLATE (x1)	PLATEAU RAMASSE GRAISSE (x1)	X	X
5010001677	320	REVERSIBLE ENAMELLED CAST IRON GRIDDLE - SHINY	PLAQUE DE CUISSON FONTE EMAILLEE REVERSIBLE - BRILLANTE	X	X
5010001678	650	ENAMELLED LID WITH THERMOMETER - LIGHT GREY	COUVERCLE EMAILLE AVEC THERMOMETRE - GRIS CLAIR		X
5010001681	60	HEAT SHIELD	PARE CHALEUR		X
5010001682	110	REAR PANEL	PANNEAU ARRIERE		X
5010002162	70	KNOB (x2)	VOLANT (x2)	X	X
5010002164	30	JET 28Mb	INJECTEUR 28Mb	X	X
5010002165	120	STAINLESS STEEL BURNER 28Mb	BRULEUR INOX 28Mb	X	X
5010002176	40	KIT OF 2 KNOBS FOR SIDE STOVE	KIT DE 2 VOLANTS POUR RECHAUD	X	X
5010002180	40	ELECTRODE FOR SIDE STOVE	ELECTRODE RECHAUD LATERAL	X	X
5010002181	50	SIDE STOVE BURNER	BRULEUR POUR RECHAUD LATERAL	X	X
5010002186	250	THICK STEEL ENAMELLED GRIDDLE - SHINY	PLAQUE DE CUISSON ACIER EMAIL EPAISSE - BRILLANTE	X	
5010002187	240	STOVE GAS PIPE 28Mb (Export)	TUBULURE RECHAUD 28Mb (Export)	X	X
5010002188	60	STAINLESS STEEL HANDLE + INSULATING + ENDS	POIGNEE INOX + ISOLANT + EMBOUTS	X	X
5010002192	40	USTENSIL HOOK	PORTE USTENSILES	X	X
5010002214	80	PIEZO 1 OUTLET	PIEZO SIMPLE	X	
5010002282	30	REINFORCEMENT WIRE SIDE SHELF	FIL RENFORT ETAGERE	X	X
5010002289	750	STAINLESS STEEL LID WITH THERMOMETER	COUVERCLE INOX AVEC THERMOMETRE		X
5010002443	300	STOVE PIPE 50Mb 1/4" (De) - BUTANE AND PROPANE MODELS	TUBULURE RECHAUD 50Mb 1/4" (De) - MODELES BUTANE ET PROPANE	X	X
5010002445	300	STOVE PIPE 28Mb 1/2" (Fr)	TUBULURE RECHAUD 28Mb 1/2" (Fr)		X
5010002446	110	STAINLESS STEEL BURNER 50Mb	BRULEUR INOX 50Mb	X	X
5010002448	30	JET 50Mb - FOR BUTANE AND PROPANE GAS PIPE	INJECTEUR 50Mb - POUR TUBULURE GAZ BUTANE ET PROPANE	X	X
5010002500	50	SIDE STOVE PAN SUPPORT	SUPPORT DE CASSEROLE RECHAUD LATERAL	X	X
5010002634	50	THERMOMETER WITH BEZEL	THERMOMETRE AVEC COUPELLE	X	X
5010003148	60	SCREW BAG	SACHET DE VIS	X	X
5010003284	270	STOVE PIPE 28Mb 1/4" (Ch)	TUBULURE RECHAUD 28Mb 1/4" (Ch)	X	X
5010003314	220	ENAMELLED CAST IRON GRID (FRAME + CIRCLE) - MATTE	GRILLE DE CUISSON FONTE EMAILLEE (CADRE + CERCLE) - MATE	X	X
5010003316	260	REVERSIBLE ENAMELLED CAST IRON GRIDDLE - MATTE	PLAQUE DE CUISSON FONTE EMAILLEE REVERSIBLE - MATE	X	X
5010003346	40	AXLE SUPPORTS FOR DOORS (MOD. 2016 AND AFTER) + 2 CHASSIS SQUARES	SUPPORTS AXE PORTES (MOD. A PARTIR DE 2016) + 2 EQUERRES CHASSIS	X	X

**BARBECUES : 4 SERIES CLASSIC**  
**LS - LS PLUS - LS G - LD S PLUS - LDSG PLUS**  
**LS D - LS PLUS D - LXS**



SPARE PARTS REF.	POINTS	EN DESCRIPTIONS	FR DESCRIPTIONS	4 SERIES CLASSIC	
				LD S PLUS LDSG Plus / LS / LS D / LS G LS PLUS / LS PLUS D	LXS
5010003830	140	LEFT DOOR WITHOUT HANDLE (MOD. FROM 2016) - (LIGHT GREY)	PORTE GAUCHE SANS POIGNEE (MOD. A PARTIR DE 2016) - (GRIS CLAIR)	X	X
5010003831	140	RIGHT DOOR WITHOUT HANDLE (MOD. FROM 2016) - (LIGHT GREY)	PORTE DROITE SANS POIGNEE (MOD. A PARTIR DE 2016) - (GRIS CLAIR)	X	X
5010004125	190	LEFT OR RIGHT SIDE TABLE WITH USTENSIL HOOK - TEXTURED DARK GREY	ETAGERE GAUCHE OU DROITE AVEC PORTE USTENSILES - GRAINE GRIS FONCE	X	X
5010004126	220	SIDE BURNER SHELF W/LID - TEXTURED DARK GREY	ETAGERE RECHAUD LATERAL AVEC COUVERCLE - GRAINE GRIS FONCE	X	X
5010004137	130	TOP + BOTTOM CONTROL PANELS - TEXTURED DARK GREY (MOD.4 LS/LS D/LS G)	CONSOLES HAUT + BAS - GRAINE GRIS FONCE (MOD.4 LS/LS D/LS G)	X	
5010004138	130	TOP + BOT CONTROL PANELS-TEXTURED DARK GREY (MOD.4 LS PLUS/4 LD S PLUS)	CONSOLES HAUT + BAS - GRAINE GRIS FONCE (MOD.4 LS PLUS/4 LD S PLUS)	X	
5010004140	180	TOP + BOTTOM CONTROL PANELS - TEXTURED DARK GREY (MOD.4 LXS)	CONSOLES HAUT + BAS - GRAINE GRIS FONCE (MOD.4 LXS)		X
5010004726	290	KIT OF REMOVABLE PARTS (FIREBOX)	KIT DE PARTIES AMOVIBLES (CUVE)	X	X
5010004830	60	SIDE SHELF SUPPORTS (RIGHT AND LEFT) - TEXTURED DARK GREY	SUPPORTS ETAGERE (DROITE ET GAUCHE) - GRAINE GRIS FONCE	X	X
5010004873	50	MAGNETS (X2)	AIMANTS (X2)	X	X
5010004875	100	ACCESSORY BAG	SACHET D'ACCESSOIRES	X	X
5010004931	50	LID PADS(x2) + BASE CUSHIONS(x2) + LEG GROMMETS(x4)	PATINS COUVERCLE(x2) + BOUCHONS CUVE(x2) + RONDELLES PIED(x4)	X	X
5010004975	190	ENAMELLED CAST IRON COOKING GRID - MATTE	GRILLE DE CUISSON FONTE EMAILLE - MATE	X	
5010005345	260	CHASSIS (MOD. FROM 2019)	CHASSIS (MOD. A PARTIR DE 2019)	X	X
5010005347	280	KIT LEGS (X4) (MOD. FROM 2019)	KIT PIEDS (X4) (MOD. A PARTIR DE 2019)	X	X
5010005365	50	PIEZO DOUBLE	PIEZO DOUBLE	X	
5010005376	120	CHROMED STEEL HANDLE (LEFT OR RIGHT) + SCREWS (MOD. FROM 2019)	POIGNEE ACIER CHROME (GAUCHE OU DROITE) + VIS (MOD. A PARTIR DE 2019)	X	X
5010005377	250	ENAMELLED CAST IRON GRID (FRAME + CIRCLE) - MATTE (MOD. FROM 2019)	GRILLE FONTE EMAILLEE (CADRE + CERCLE) - MATE (MOD. A PARTIR DE 2019)	X	X
5010005382	300	ENAMELLED CAST IRON GRID (FRAME + CIRCLE) - SHINY (MOD. FROM 2019)	GRILLE FONTE EMAILLEE (CADRE+CERCLE) - BRILLANTE (MOD. A PARTIR DE 2019)		X
5010005387	90	STAINLESS STEEL BURNER WITH MESH	BRULEUR INOX AVEC FILTRE ANTI MOUSTIQUES	X	
5010005393	100	KIT OF ELECTRODES + HOUSINGS	KIT ELECTRODES + SUPPORTS		X
5010005398	90	KIT OF ELECTRODES + HOUSINGS	KIT ELECTRODES + SUPPORTS	X	
5010005581	250	BASE FRAME	CADRE SUPPORT DE CUVE	X	
5010005587	250	BASE FRAME	CADRE SUPPORT DE CUVE		X
5010005596	60	WINDSHIELD	PREVENT	X	X
5010005597	180	ELECTRONIC IGNITION SET (2/4 OUTLETS) WITH CONNECTION WIRES	KIT ALLUMAGE ELECTRONIQUE (2/4 SORTIES) AVEC CABLES DE CONNECTIONS		X
5010005608	200	TOP + BOTTOM CONTROL PANELS - TEXTURED DARK GREY	CONSOLES HAUT + BAS - GRAINE GRIS FONCE	X	
5010005829	170	LEFT DOOR WITHOUT HANDLE (TEXTURED DARK GREY)	PORTE GAUCHE SANS POIGNEE (GRAINE GRIS FONCE)	X	
5010005832	570	LID WITH THERMOMETER - BLACK	COUVERCLE AVEC THERMOMETRE - NOIR	X	
5010005834	40	PUSH BUTTON ELECTRONIC IGNITOR (SILVER CAP)	BOUTON POUSSOIR TRAIN D'ETINCELLES (BOUTON ARGENTE)		X
5010005835	170	RIGHT DOOR WITHOUT HANDLE (TEXTURED DARK GREY)	PORTE DROITE SANS POIGNEE (GRAINE GRIS FONCE)	X	