

# HOFTRONIC™

## Wireless Daylight sensor

SKU: 383302



### Wireless daylight sensor

A daylight sensor equipped with an infra-red motion detector. This way the sensor can instantly turn on its light source whenever a moving object comes in range of the motion detector.

### Specifications

Input power: 220-240V AC

Watts: Max. 100 Watt

Detection angle: 120°

Ambient Light: <3 – 2000 LUX (adjustable)

Detection range: 2-10m

Detection of moving speed: 0.6 – 1.5 m/s

Delay time: Min 10sec ±3sec, Max 7min ±2min

Operating temperature: -20° ~ 40° C

### Functions:

- Day & night detectable: The ambient light is easily adjustable. The sensor can work during the day and at night when the "24H" function is switched on. The sensor can also work in less than 5 LUX ambient light when it is set to the "moon" position (minimum).
- Sensitivity adjustable: Fully adjustable; low sensitivity option with 4 meter detection range or high sensitivity option with 10 meter detection range.
- Time delay: It is possible to apply "time delay" via the remote control (see connection diagram).
- Adjust time delay: Can be fully set to your wishes, on the remote control you will find the button "5" and "10" the button 5 provides the lowest adjustable time delay and the button 10 for the highest adjustable time delay, 5 also counts as minus and 10 counts as plus (time).

# HOFTRONIC™

## How to install diagram

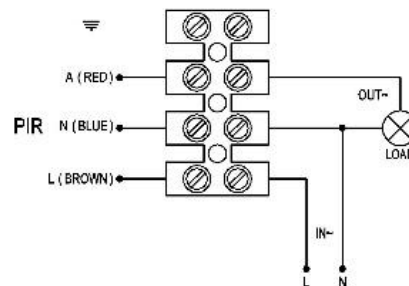

**IMPORTANT: ONLY INSTALL THE SENSOR WHEN THERE IS NO POWER CONNECTED.**

**IMPORTANT: REMOVE THE PLASTIC LID ON THE BOTTOM OF THE REMOTE CONTROL BEFORE USE.**

## How to use diagram

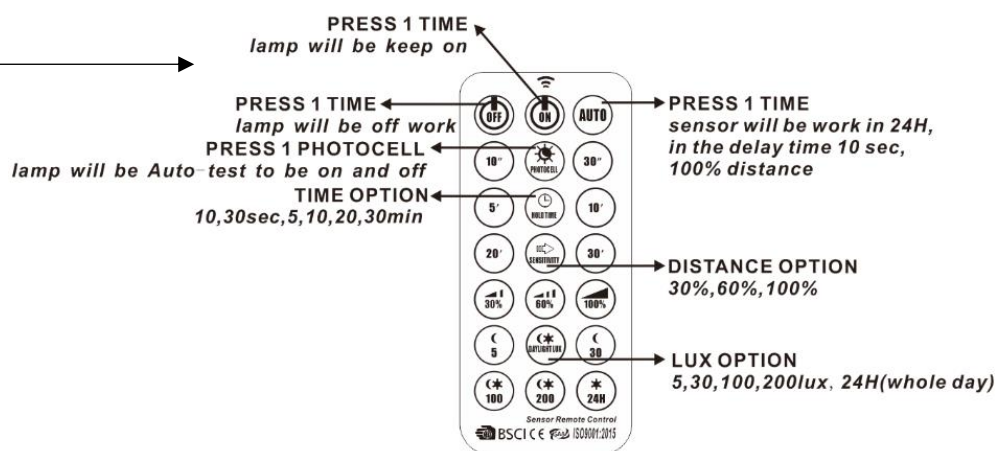

## How to install the sensor

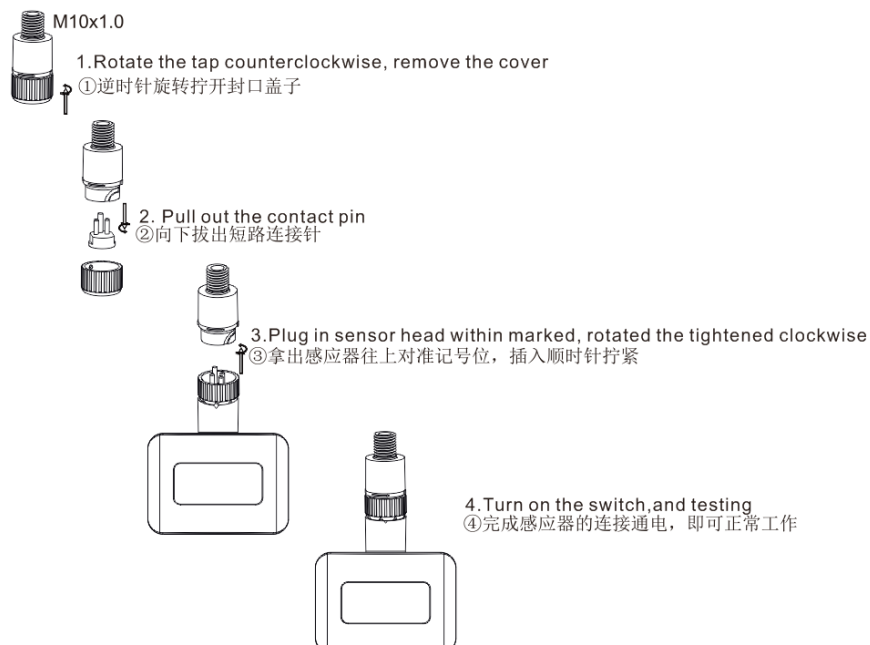

# HOFTRONIC™

## Funcities:

- **AUTO:** The sensor works completely automatic, with a delay time of 10 seconds. With this setting the maximum reachable distance is set as standard.
- **SOS:** This option disables the motion sensor. Using this option will let the sensor explicitly work on its receiving ambient light (adjusted LUX value). In case the receiving ambient light is too low the light source will be turned on, whenever the receiving value ambient light is higher than set the light source will turn off.
- **TIME:** With this option you can set the delay time, with as minimum 10 seconds and as maximum 30 minutes.
- **DISTANCE:** Easily adjust the desired range for the motion detection to work.
- **DAYLIGHT:** With this button you can adjust how much light there is needed for the sensor to turn off its light source. But also the minimum light needed in order for it to turn on its light source. With as minimum 3 LUX & as maximum 2000 LUX.

## Important installation instructions

- The sensor must be installed by a certified electrician.
- Avoid installing on moving objects.
- There must be no moving objects or interfering objects in front of the sensor.
- Avoid installation near sources which can change temperatures such as; Airconditioning / Central heating.

## Problems & Solutions

- I have no power
  - A. Double check if everything is correctly installed. Make sure the cables are installed in the right way blue on blue (ACN), brown on brown (ACL), green yellow on green yellow (EARTH).
  - B Check if the red light in the sensor window react when pushing a button on the remote control.
- The sensor doesn't work correctly.
  - A. Check if there are no interfering or moving objects in front of the sensor.
  - B. Check whether the operating temperature is within the specified range.
  - C. Check whether the signal source is within the specified detection field.
  - D. Check whether there are continuous signals in the detection field