

SERVICE PART GUIDE

2024 Enduro UDH Compatible Seatstay

S245000013



1. SERVICE PART KIT

The Enduro UDH (universal derailleur hanger) compatible seatstay kit includes the following:

PART	DESCRIPTION	QTY	TORQUE	
			Nm	in-lbf
S245000013	STS MY25 ENDURO 29, CARBON SEATSTAY, 12X148 UDH COMPATIBLE - SATIN BLK	1	–	–
	BEARING, BALL, 12MM ID X 21MM OD X 5MM W, DBL SLD	6	–	–
	SPACER, 12MM ID X 18MM OD X 2MM W, 7075-T6	2	–	–
	HORST PIVOT OUTER SPACER ASSY 12X21X2.5	4	–	–
	SPACER ASSEMBLY, 12.1 ID X 17.5 OD X 4 W, 7075-T6	2	–	–
	SPACER ASSEMBLY, 12.1 ID X 20 OD X 3 W, 7075-T6	2	–	–
	HANGER, SRAM UNIVERSAL, REV H	1	–	–

WARNING! This Service Part Guide is intended for professional bicycle mechanics. All assembly of service parts should be carried out by an Authorised Specialized Retailer.



If you are unsure about any of the steps required to complete the installation, contact Specialized Rider Care or visit your local Specialized Authorized Retailer.

2. UDH COMPATIBLE SEATSTAY

Follow the steps in this section to complete the installation of a UDH compatible seatstay on Enduro bicycles between 2020 and 2024.

WARNING! Use a sturdy repair stand to support the bicycle during installation. When placing the frame and/or bicycle in a repair stand, clamp the stand to the seatpost and not the frame. Clamping the frame can cause damage to the frame that may or may not be visible, and can cause you to lose control and fall.

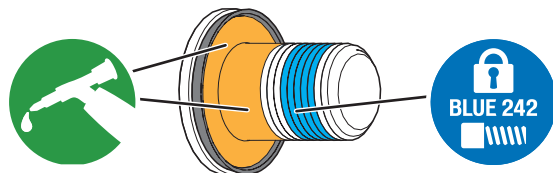

i All pivot bolts are factory treated with a Nylock patch on the threads. If the patch wears off, apply a new coat of Loctite 242, or install new bolts. Only apply grease to the unthreaded portion of the bolt shaft and the inner bolt head surface (highlighted orange).



i Bolts, axles, and spacers with a rubber seal should be installed with the rubber seal facing toward the bearing.



Grease all surfaces that contact inner bearing races before placing the spacers against the bearings. This helps keep the spacers in place when assembling each pivot. Always place the smaller (tapered) surface against the bearing and the wider surface against the frame or stay.

- Remove the rear axle and then the rear wheel.
- Remove the rear derailleur.

- Remove the rear brake caliper from the seatstay.
- Loosen, then remove the chainstay protector bolt (located at the drive side horst pivot).
- Loosen, then remove the dropout bolts.
- Loosen, then remove the seatstay bolts and axles at the upper link.
- Remove the existing seatstay from the bicycle, then get the UDH compatible seatstay ready for installation.

i Be ready to catch loose spacers when removing the dropout bolts, seatstay bolts, seatstay axles, and the seatstay.

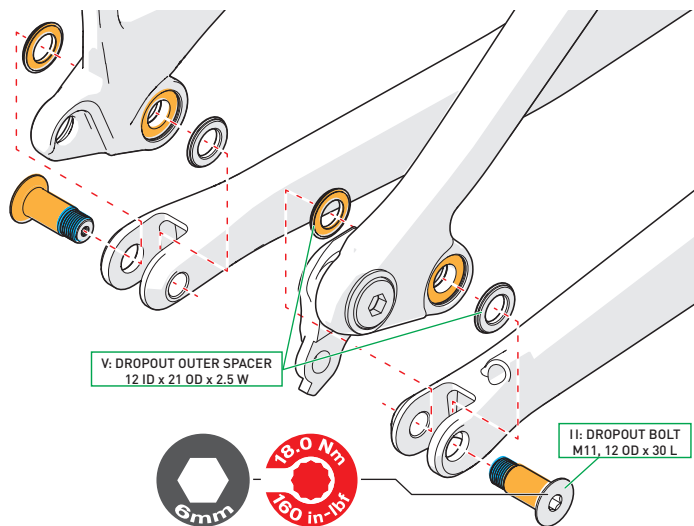

i The UDH compatible seatstay ships factory standard with the bearings and the UDH preinstalled.

- Grease, then place the dropout spacers (V) against the UDH compatible seatstay dropout bearings. Place the smaller tapered surface (rubber seal side) against the bearing.
- Align the seatstay with the chainstay bore, then thread the dropout bolts (II) into the dropouts.
- Using a torque wrench and 6 mm hex bit, torque the dropout bolts to 18 Nm / 160 in-lbf.

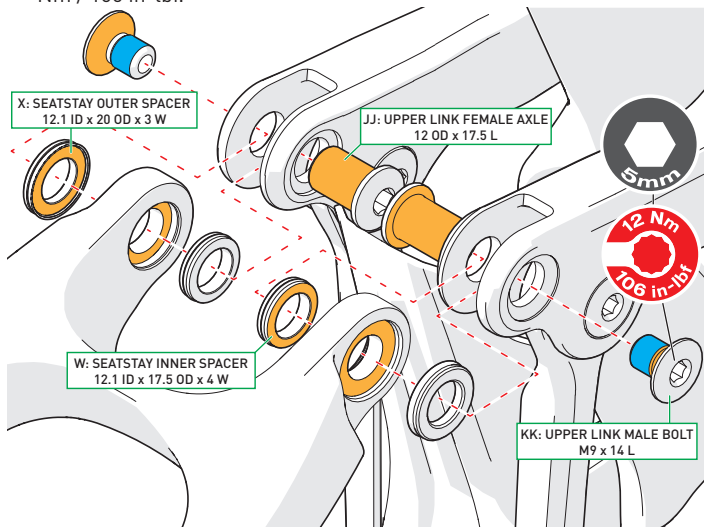

- Grease, then place the inner spacers (W) and outer spacers (X) against the seatstay bearings. Place the smaller tapered surface (rubber seal side) against the bearing.
- Align the seatstay with the upper link.
- Grease, then slide the upper link axles (JJ) into the upper link from the inside, then thread the upper link bolts (KK) into the axles.

- Use a hex key to hold the axles in place, then using a torque wrench and 5 mm hex bit, torque the bolts to 12 Nm / 106 in-lbf.

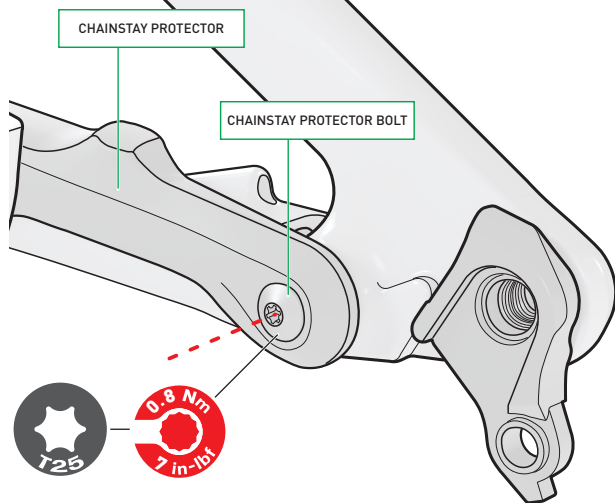

- Thread the chainstay protector bolt through the protector and into the dropout, then using a torque wrench and T25 Torx bit, torque the bolt to 0.8 Nm / 7 in-lbf.

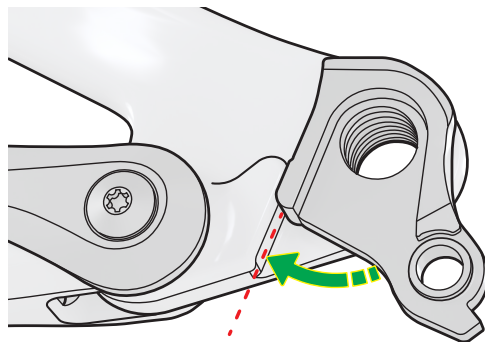

- Install the UDH hanger into the frame dropout rotating it forward until it's completely seated in the hanger pocket and contacts the rotational stop tab.

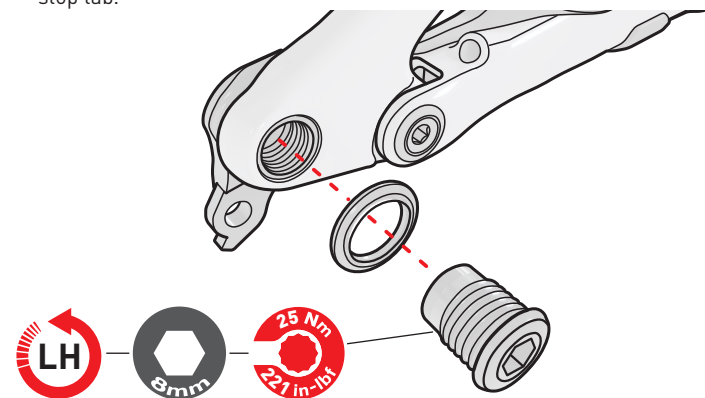

- Install the UDH washer, then thread the UDH bolt through the washer and into the hanger.
- Using a reverse torque wrench and 8 mm hex bit, torque the bolt to 25 Nm / 221 in-lbf. The UDH bolt is left-hand threaded.

i The hanger must be completely seated in the hanger pocket and against the frame stop tab when tightened to the specified torque.

i When not using a UDH refer to the rear derailleur manufacturer's instructions for installation.

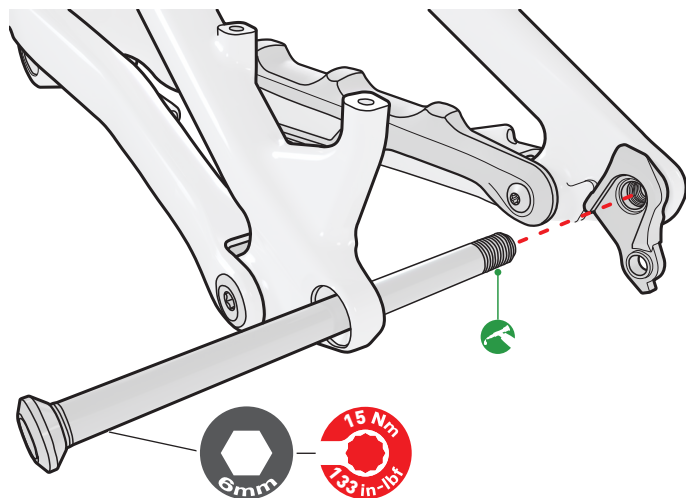

- Apply grease to the rear thru-axle threads, then install the thru-axle and wheel. Using a torque wrench and 6 mm hex bit, torque the thru-axle to 15 Nm / 133 in-lbf.

WARNING! Before your first ride and regularly thereafter, ensure the thru-axle and UDH is torqued to specification, and that the UDH has not moved. Thru-axles and the UDH can loosen over time depending on the type and frequency of use. This is especially true if they were not installed properly. Riding with a loose thru-axle or UDH can result in a loss of control of the bicycle and can cause you to fall.

- Install the rear brake caliper according to the manufacturer's instructions.
- Install the rear derailleur according to the manufacturer's instructions.

SPECIALIZED®

SPECIALIZED BICYCLE COMPONENTS

15130 Concord Circle, Morgan Hill, CA 95037 (408) 779-6229

0000204141 SG R1