



### LEDVION DIMMER:

This RC dimmer has been developed specially for dimmable LED lamps. Additionally, the minimum brightness setting of the dimmer can be adjusted to achieve the optimum dimming range for a particular load. You may need to refer to these instructions if you change your lights to a different type at a later date so please keep them for reference.

### TECHNICAL DATA:

Operating Voltage	220-240V
Frequency	50Hz <sup>£</sup>
Max. light sources	20* (multiple LEDs possible per driver)
Max. number of LED drivers	20*
Maximum load	300W/VA / $P_f \geq 0.90$
Minimum load	3W
Dimming mode	Trailing edge / RC
Control method	Two way
Ambient temperature	$<60^{\circ}\text{C}$ ( $T_{\text{amb}} = 60^{\circ}\text{C}$ )
Dimmable LED lamps	3 - 250W/VA

\* NOTE: When using high quality LED drivers with low inrush currents

### WARNING!

Certain light sources may not behave according to their power rating when used with a dimmer. An overload will result in the safety feature switching the dimmer off. We always recommend to connect under the suggest load.

# Ledvion

## LED DIMMER

Manual for LED dimmer switch

LV10010

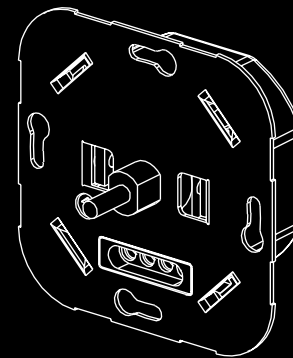

5692 DH Son en Breugel  
Ekkersrijt 4304  
The Netherlands  
[www.ledvion.com](http://www.ledvion.com)



## INSTALLATION:

1. Make sure the electricity is switched off before any operation, connect the wire as shown in the "wire connection".
2. Install the dimmer into the junction box.
3. Switch on electricity, push shaft button to ON or OFF, turn the shaft to dimming brightness. When lamps are flashing, adjust the min setting to the minimum brightness level, make lamps stable.
4. When all settings are finished, you can fit the dimmer in the wall. Cover the frame and the dimmer knob on the dimmer.

\*If the dimmer is overloaded and gets too hot, the dimmer will start the protection function, so the dimmer will stop working. When you solve the issue, 5 minutes later push the rotary to reset the dimmer, dimmer will then work well again

## WIRING CONNECTION:

### ONE-WAY CONNECTION

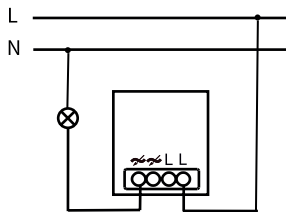

### TWO-WAY CONNECTION

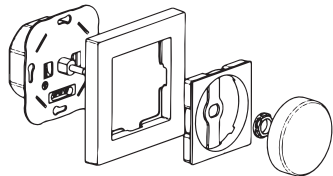
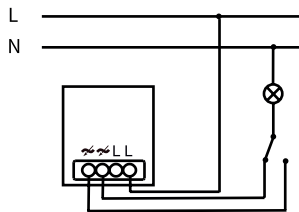

## MIN. BRIGHTNESS SETTING

To set the min. brightness to avoid flickering or satisfied min brightness:

- Ensure the lamp module is switched ON
- Anti-clockwise the Knob
- Clockwise the VR - Variable Resister
- Anti-clockwise the VR to decrease the brightness at the min. & max. point.

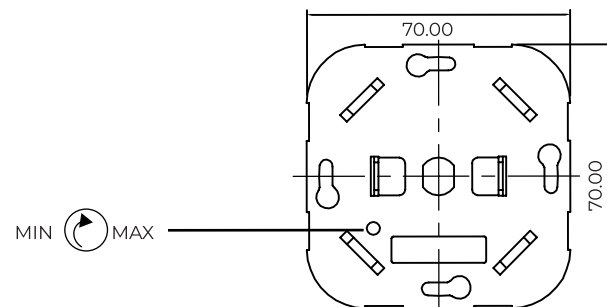

**CE** This device is in compliance with EN 60669-2-1.

Should not be disposed with other household wastes.

This product is not a toy. Keep away from children and animals.

Do not expose this product to moisture, water or other liquids.

Do not attempt to examine or repair this product yourself.

This product is designed for indoor use only. Do not use outside!

