

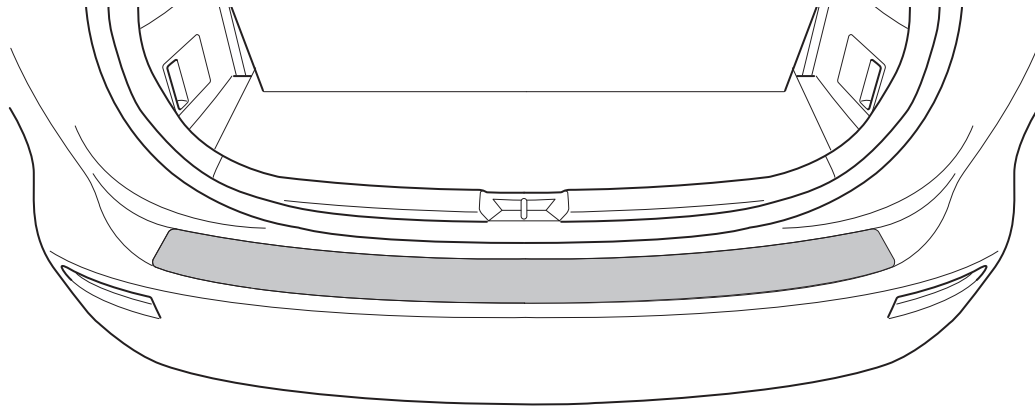

# MAZDA

<b>GB</b> REAR BUMPER FOIL Installation instruction	<b>S</b> SKYDD BAKRE STÖTFÄNGARE Monteringsanvisning
<b>D</b> SCHUTZFOLIE HECKSTOSSSTANGE Einbauanleitung	<b>SF</b> TAKAPUSKURIN SUOJAUS Asennusohje
<b>E</b> PROTECCIÓN DEL PARACHOQUES TRASERO Instrucciones de montaje	<b>CZ</b> OZDOBNÁ FÓLIE NA ZADNÍ NÁRAZNÍK Návod k montáži
<b>F</b> PROTECTION PARE-CHOC'S ARRIERE Notice de montage	<b>H</b> HÁTSÓ LÖKÉSGÁTLO VÉDELEM Beszerelési utasítás
<b>I</b> PROTEZIONE PARAURTI POSTERIORE Istruzioni di montaggio	<b>PL</b> NAKŁADKA OCHRONNA NA TYLNY ZDERZAK Instrukcja zabudowy
<b>P</b> PROTECTOR DO PÁRA-CHOQUES TRASEIRO Instruções de montagem	<b>GR</b> ΠΡΟΦΥΛΑΚΤΗΡΑΣ ΟΠΙΣΘΕΝ Οδηγίες τοποθέτησης
<b>NL</b> BESCHERMING ACHTERBUMPER Inbouw-instructie	<b>RUS</b> ЗАЩИТА БАМПЕРА инструкция по установке
<b>DK</b> BESKYTTELSE BAGESTE KOFANGER Monteringsvejledning	<b>SVK</b> ZADNÁ NÁRAZNÍKOVÁ FÓLIA Návod na inštaláciu
<b>N</b> BESKYTTELSE FOR STÖTFANGAR BAK Monteringsveiledning	



Part Number:	CC29 V4 080	BDA1-V4-080	KR9P-V4-130
	GR5A V4 080	BDA2-V4-080	KJH3-V4-130
	GR6A V4 080	BBP3-V4-080	GJBK-V4-130
	EH14 V4 080	CG16-V4-080	
	DF71 V4 080	BHB6-V4-080	
	GS1D V4 080	KD45-V4-080	
	GS2A V4 080	GHP9-V4-080	
	GS2B V4 080	GHK1-V4-080	
	CD85 V4 080	BJE3-V4-080	
		BJD9-V4-080	
		DC3L-V4-080	
		KD3M-V4-080	
		GSJ1-V4-080	
		GCAG-V4-080	
		BDEN-V4-130	
		BDEL-V4-130	
		DFR5-V4-130	

Date: 26-02-2025 ©

Copyrights MAZDA

Sheet 1 of 6

Expert Fitment Required  
Montage durch Fachwerkstatt erforderlich  
Montaje sólo por el concesionario  
Montage par spécialiste nécessaire  
E' necessario in officina specializzata  
Especialista em montagem requerido  
Montage door vakman nodig  
Montage ved professionelt værksted påkrævet  
Nødvendig med montering fra fagvevkersted  
Verkstadsmontage erfordras  
Asennus tarpeen merkkikorjaamossa  
Montáž ve specializované dílně nutná  
A szereléshez szakműhely kell  
Konieczny montaż przez warsztat specjalistyczny  
Na τοποθεί απο συνεργείο  
Необходима установка специалистами  
Vyžaduje sa odborné vybavenie



- (GB) Location/Position Arrow
- (D) Positionspfeil
- (E) Flecha de posición
- (F) Flèche de Position
- (I) Freccia di posizione
- (P) Flexa de posição
- (NL) Lokatie/Positie pijl
- (DK) Lokaliseringspil
- (N) Posisjonspil
- (S) Positionspil
- (SF) Paikannusnuoli
- (CZ) Šipka na pozici
- (H) Helyzetjelző nyíl
- (PL) Strzałka położenia
- (GR) Βέλος θέσης
- (RUS) Позиция
- (SVK) Šipka polohy

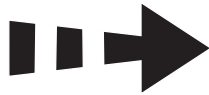

- (GB) Movement Arrow
- (D) Bewegungspfeil
- (E) Flecha de movimiento
- (F) Flèche indiquant sens du vouvement
- (I) Freccia di movimentov
- (P) Flexa de movimento
- (NL) Richtingspijl
- (DK) Bevægelsespil
- (N) Bevegelsespil
- (S) Rörelsepil
- (SF) Liikesuuntanuoli
- (CZ) Šipka pohybu
- (H) Mozgásirányjelző nyíl
- (PL) Strzałka kierunku ruchu
- (GR) Βέλος κίνησης
- (RUS) Стрелка по направлению
- (SVK) Šipka pohybu



- (GB) Warning
- (D) Achtung
- (E) Atención
- (F) Attention
- (I) Attenzione
- (P) Atenção
- (NL) Let op
- (DK) Bemærk
- (N) Pass på
- (S) Varning
- (SF) Huomio
- (CZ) Pozor
- (H) Figyelem
- (PL) Uwaga
- (GR) Προσοχή
- (RUS) Осторожно
- (SVK) Výstraha



- (GB) Throw away
- (D) Entsorgen
- (E) Tratamiento de residuos
- (F) Rebuter
- (I) Smaltire
- (P) Eliminar
- (NL) Weggooien
- (DK) Affald
- (N) Avskaffe
- (S) Ta hand om avfallet
- (SF) Hävittää
- (CZ) Vyhodit
- (H) Távolítsa el
- (PL) Usunąć jako odpad
- (GR) Απόσυρση
- (RUS) Выбросите
- (SVK) Zahodit'

## Spare Part: 4100-77-005

**A**



1x

**B**

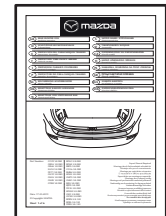

1x

**C**

1x

**D**

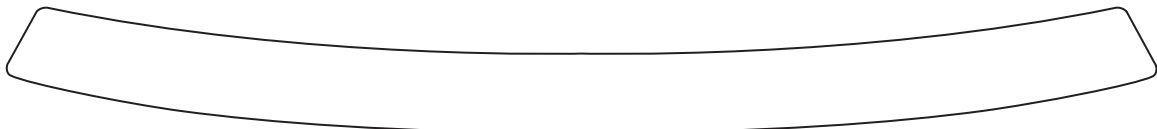
1x

**E**

1x

## Tools & Consumables

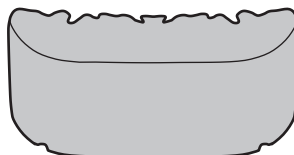
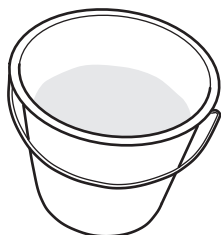

Sprayer

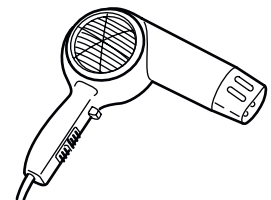

**1**

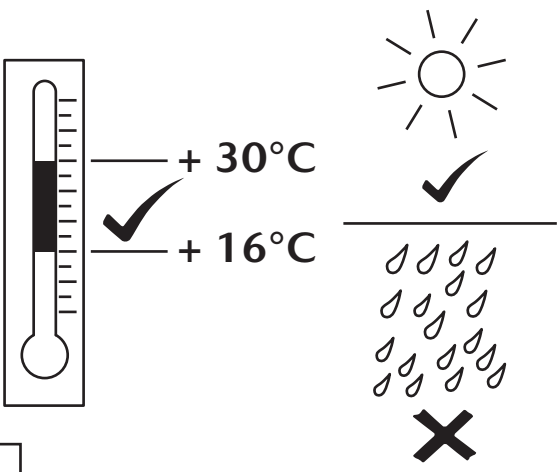

A thermometer shows a temperature of +30°C with a checkmark and a sun icon, and +16°C with a checkmark and raindrops icon. A large 'X' is placed over the raindrops icon.

**2**

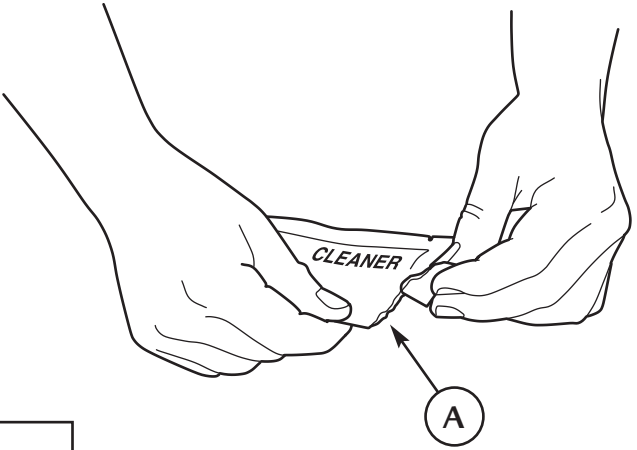

Illustration of hands opening a packet labeled 'CLEANER'. A circled 'A' points to the opening.

**3**

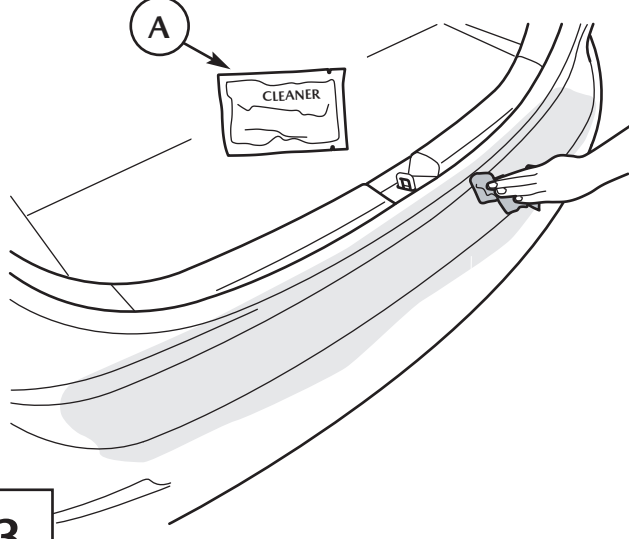

Illustration of a hand applying the cleaner packet (labeled 'A') to the door seal of a car door.

**4**



Illustration of hands pouring soap (labeled 'B') from a packet into a bucket of water from a faucet. A box indicates a ratio of 5L : 1.

**5**

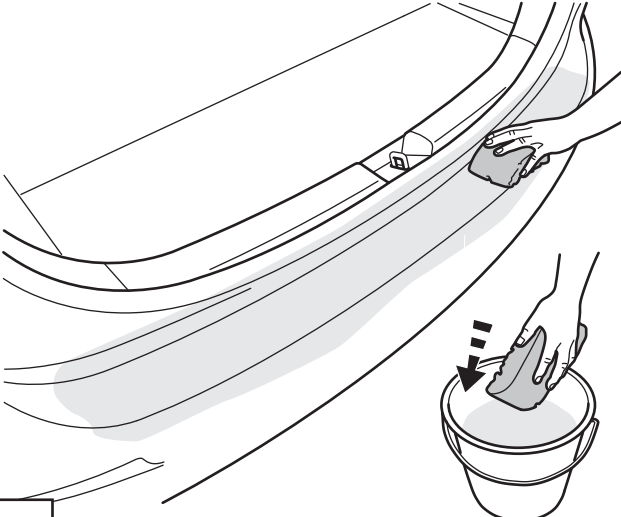

Illustration of a hand dipping a sponge into a bucket of water and then cleaning the car door seal.

**6**

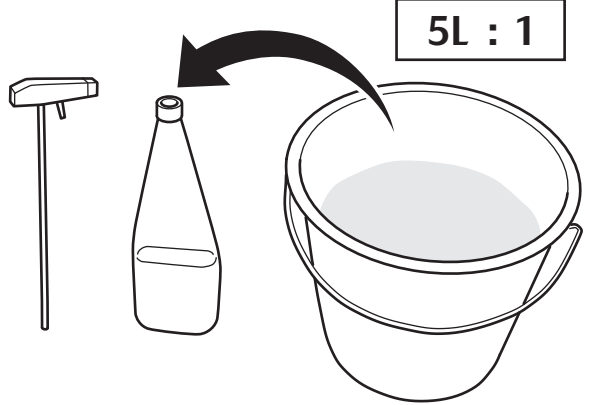
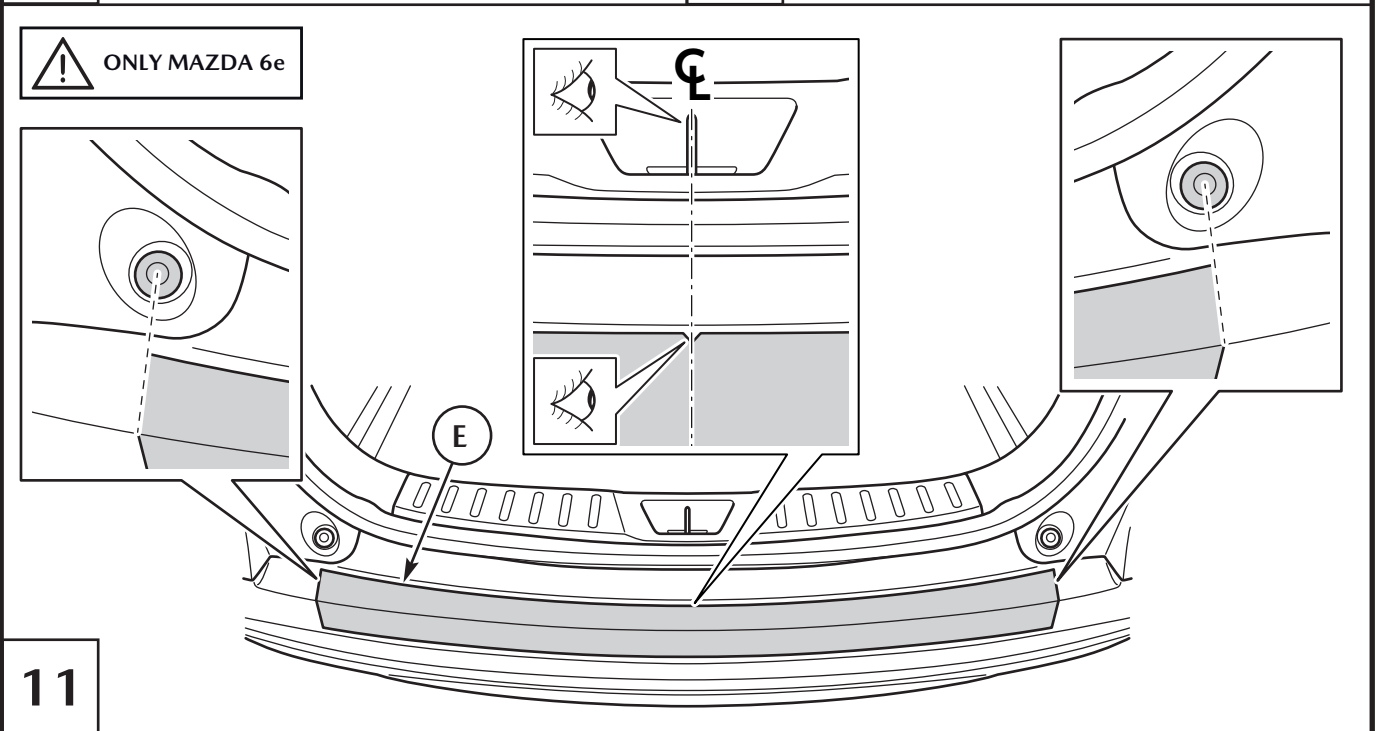
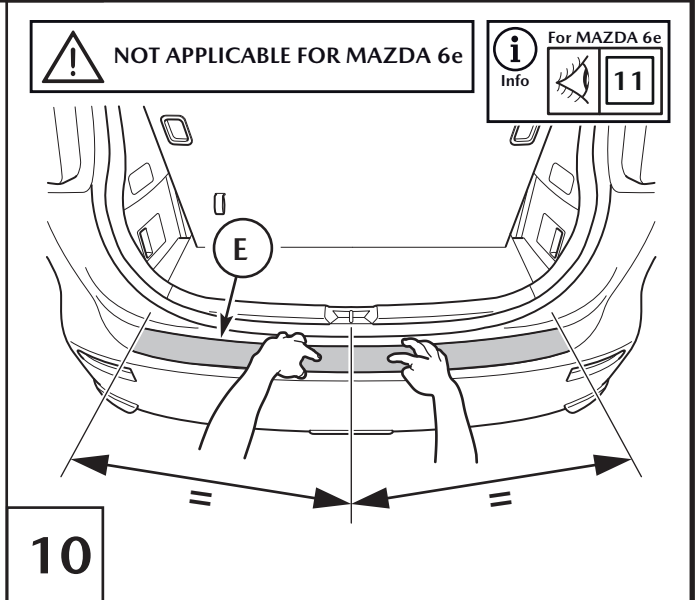
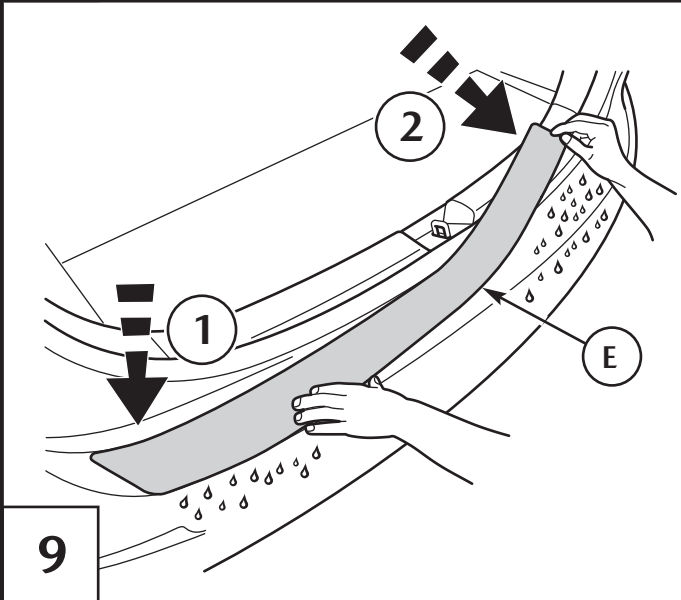
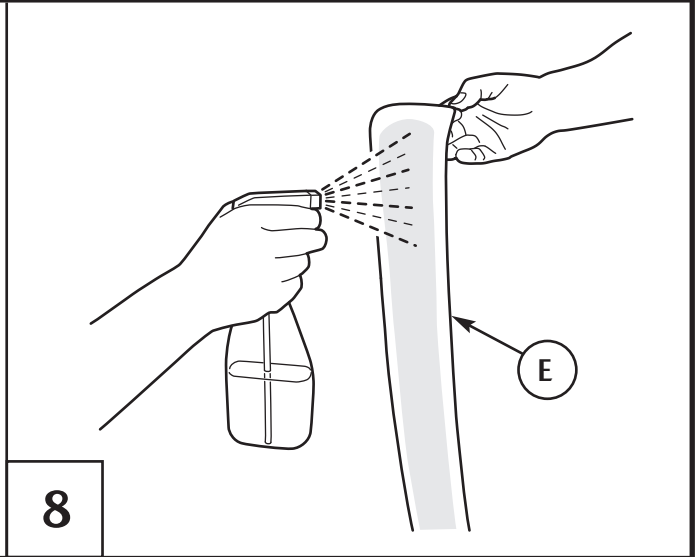
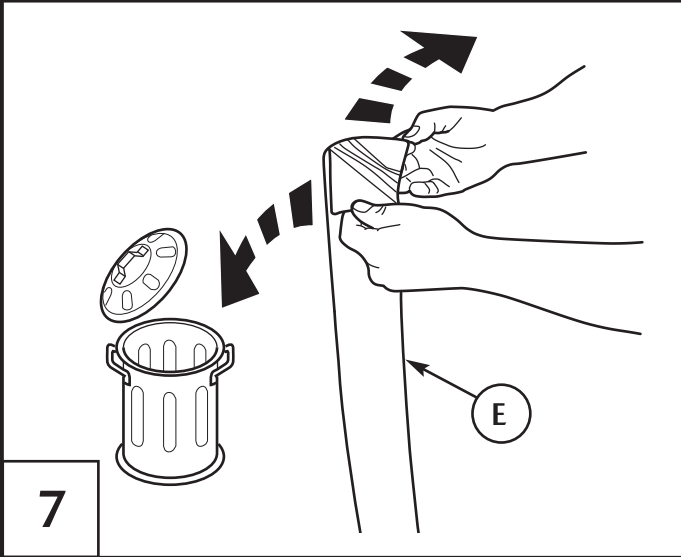
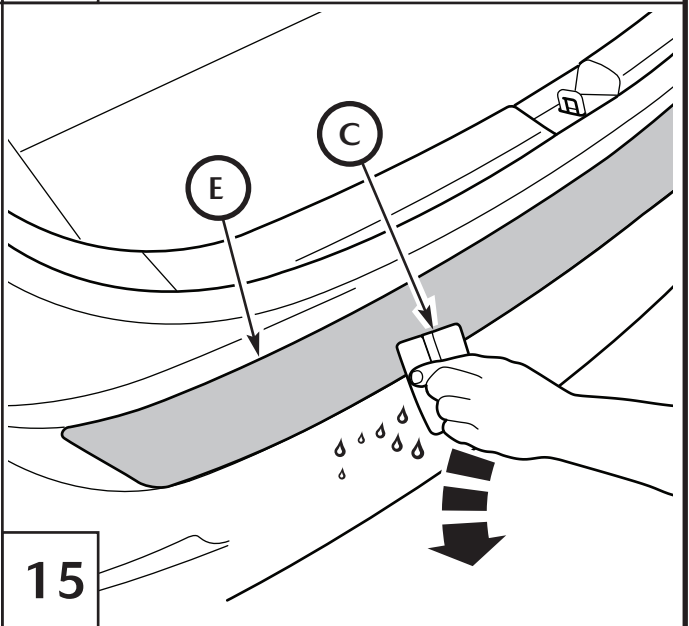
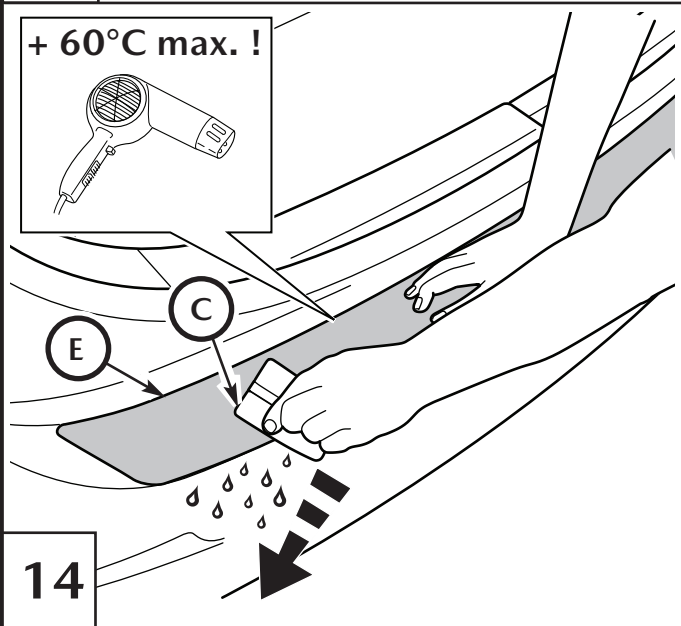
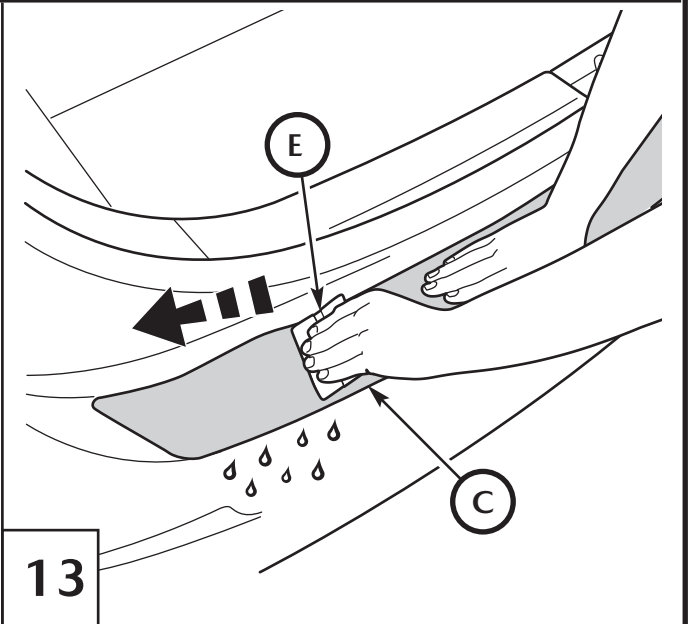
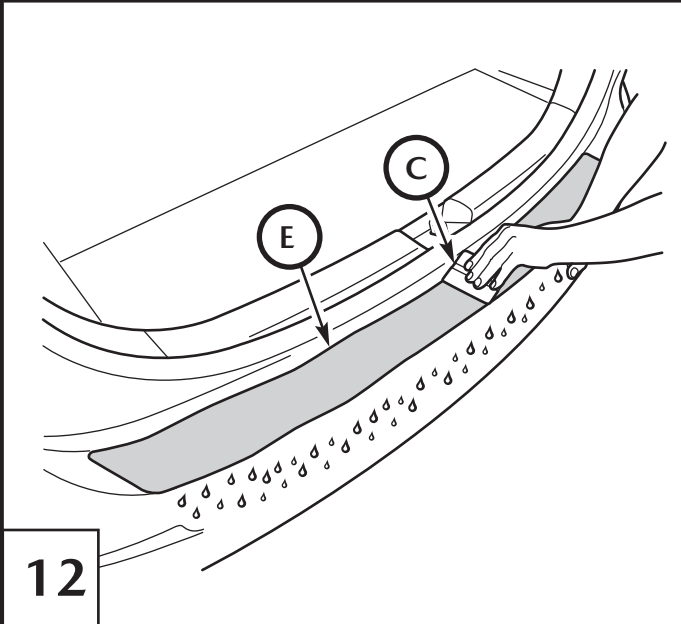
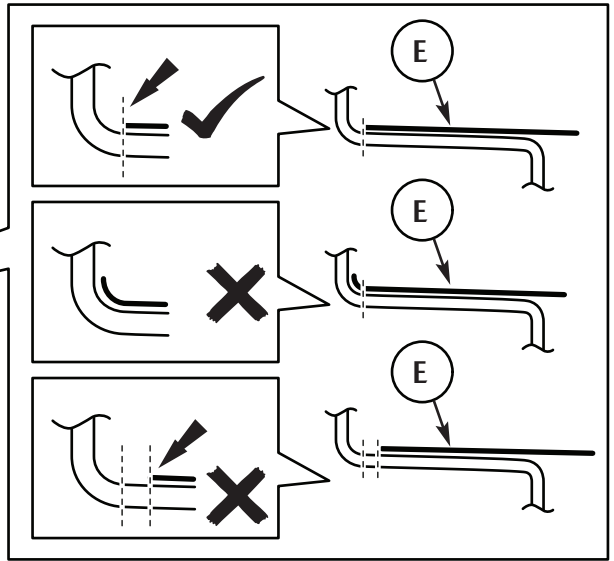
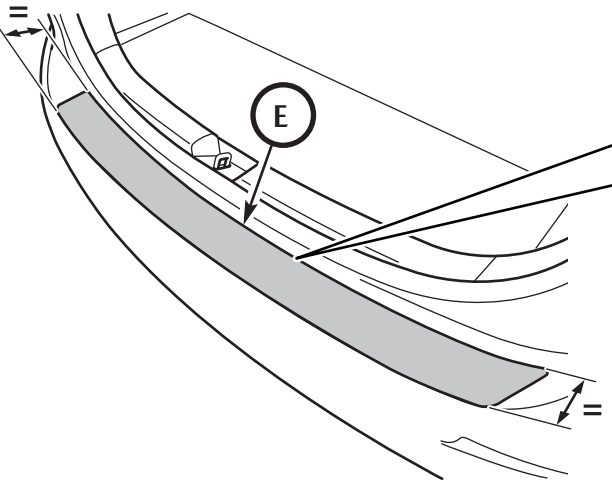
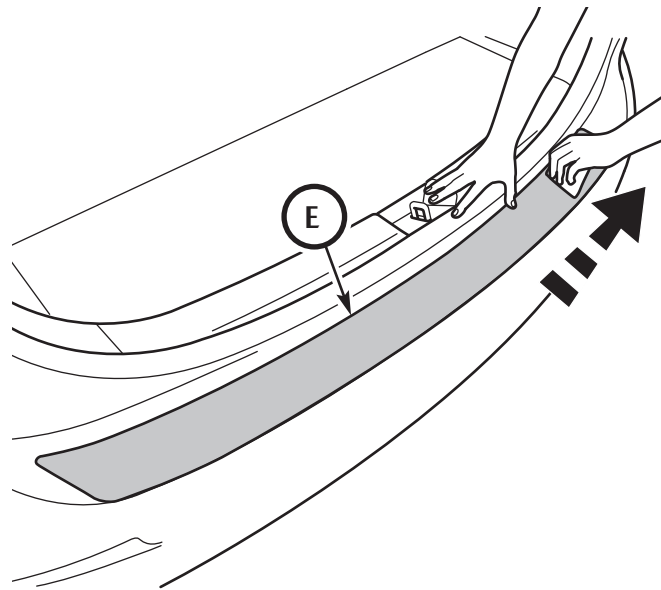
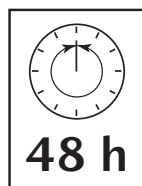
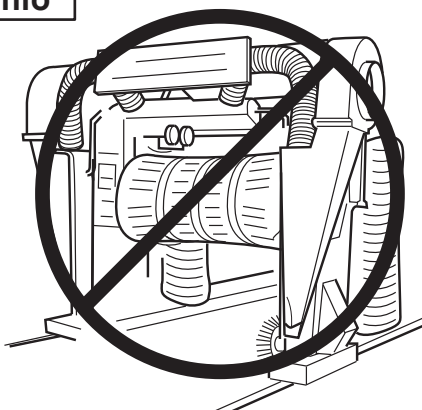
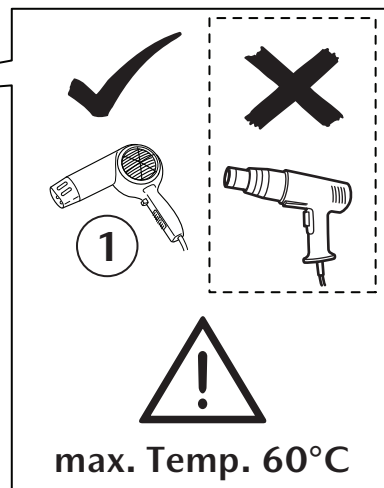
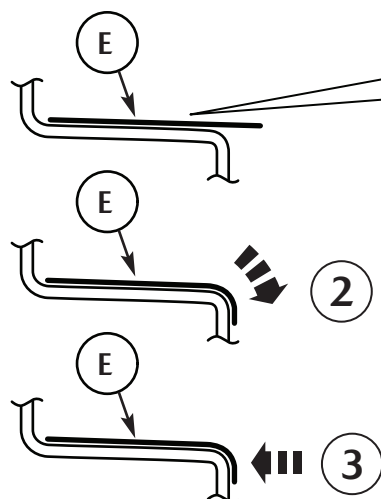

Illustration of a spray bottle being filled with liquid from a bucket. A box indicates a ratio of 5L : 1.



**i**  
Info



**16**

Subject to alternation without notice  
 Technische Änderungen vorbehalten  
 Reservadas modificaciones técnicas  
 Sous réserve de modifications techniques  
 Con riserva di apportare modifiche tecniche  
 Reservamo-nos o direito a alterações técnicas  
 Technische wijzigingen voorbehouden  
 Med forbehold for tekniske ændringer  
 Tekniske forendringer forbeholdes  
 Med reservation för tekniska ändringar  
 Tekniset muutokset pidätetään  
 Technické zmeny vyhrazeny  
 A változtatások technika jogát fenntartjuk  
 Zmiany techniczne zastrzeżone  
 Επιφύλασσόμεθα για αλλαγές  
 Можно изменять без уведомления  
 Technické zmeny vyhradené