

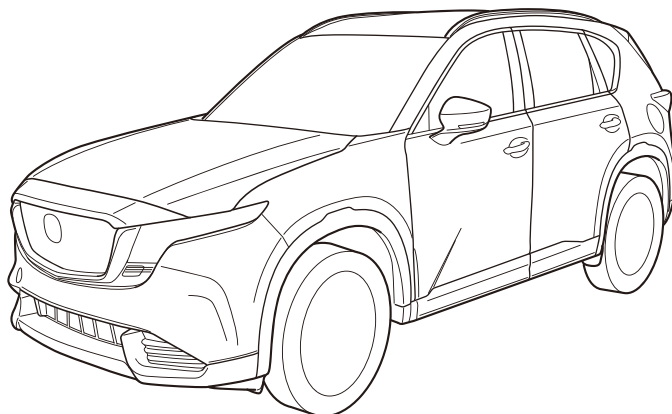

MAZDA

GB REAR SPOILER Installation instruction	S SPOILER BAK Monteringsanvisning
D SPOILER HINTEN Einbauanleitung	SF TAKASPOILERI Asennusohje
E SPOILER TRASERO Instrucciones de Montaje	CZ ZADNÍ SPOILER Návod k Montáži
F PARE-CHOCS ARRIÈRE Instructions de Montage	H HÁTSÓ SPOILER Beszerelési Utasítása
I SPOILER POSTERIORE Istruzioni di Montaggio	PL SPOILER TYLNY Instrukcja zabudowy
P SPOILER TRASEIRO Instruções de Montagem	GR ΣΠΟΙΛΕΡ ΠΙΣΩ Οδηγίες τοποθέτησης
NL SPOILER ACHTER Inbouw-Instructie	RUS ЗАДНИЙ СПОЙЛЕР Инструкцию по установке
DK SPOILER BAG Monteringsvejledning	SVK VZADU SPOJLEROM Návod na inštaláciu
N SPOILER BAK Monteringsveiledning	



MAZDA CX-5

KM01

Part No: **KLBC V4 920**

Date: 24-12-2025

© Copyrights MAZDA

Sheet 1 of 19

Montage in einer Werkstatt mit entsprechend geschultem Personal empfohlen

Montaje sólo por el concesionario

Montage par spécialiste nécessaire

E' necessario in officina specializzata

Especialista em montagem requerido

Montage door vakman nodig

Montage ved professionelt værksted påkrævet

Nødvendig med montering fra fagvejverksted

Verkstadsmontage erfordras

Asennus tarpeen merkkikorjaamossa

Montáž ve specializované dílně nutná

A szereléshez szakműhely kell

Konieczny montaż przez warsztat specjalistyczny

Να τοποθεί απο συνεργείο

Необходима установка специалистами

Vyžaduje sa odborné vybavenie

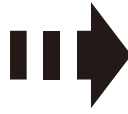

L+R

- (GB) Position arrow
- (D) Positionspfeil
- (E) Flecha de posición
- (F) Flèche de position
- (I) Freccia di posizione
- (P) Seta de posição
- (NL) Pijl positie
- (DK) Position pil
- (N) Posisjoneringspil
- (S) Positionspil
- (SF) Asentoa osoittava nuoli
- (CZ) Šipka pozice
- (H) Elhelyezkedési nyíl
- (PL) Strzałka pozycji
- (GR) Βέλος τοποθέτησης
- (RUS) Стрелка положения
- (SVK) Šipka polohy

- (GB) Movement arrow
- (D) Bewegungspfeil
- (E) Flecha de movimiento
- (F) Flèche de mouvement
- (I) Freccia di movimento
- (P) Seta de movimento
- (NL) Pijl beweging
- (DK) Bevægelse pil
- (N) Bevegelsespil
- (S) Rörelsepil
- (SF) Suuntaa osoittava nuoli
- (CZ) Šipka pohybu
- (H) Mozgási nyíl
- (PL) Strzałka ruchu
- (GR) Βέλος κίνησης
- (RUS) Стрелка движения
- (SVK) Šipka pohybu

- (GB) Same procedure for the left and right side
- (D) Gleiches Vorgehen für linke und rechte Seite
- (E) Mismo procedimiento para el lado izquierdo y derecho
- (F) Procédure identique à gauche et à droite
- (I) Stessa procedura per lato destro e sinistro
- (P) Mesmo procedimento para os lados direito e esquerdo
- (NL) Dezelfde procedure voor links en rechts
- (DK) Samme produkt for venstre og højre side
- (N) Samme prosedyre for venstre og høyre side
- (S) Samma procedur för vänster och höger sida
- (SF) Sama toimenpide vasemmalla ja oikealla puolella
- (CZ) Stejný postup pro levou i pravou stranu
- (H) Azonos eljárás a bal és a jobb oldal esetén egyaránt
- (PL) Ta sama procedura obowiązuje dla lewej i prawej strony
- (GR) Ίδια διαδικασία και για τις δύο πλευρές
- (RUS) Одинаковый порядок действий для левой и правой стороны
- (SVK) Rovnaký postup pre ľavú a pravú stranu



- (GB) Throw away
- (D) Wegwerfen
- (E) Desechar
- (F) Jeter
- (I) Gettare
- (P) Eliminar
- (NL) Weggooien
- (DK) Smid væk
- (N) Kast
- (S) Släng
- (SF) Hävittä
- (CZ) Zahodte
- (H) Dobja el
- (PL) Wyrzucić
- (GR) Απορριψη
- (RUS) Выбросить
- (SVK) Zahodit'

- (GB) Warning
- (D) Warnung
- (E) Advertencia
- (F) Avertissement
- (I) Avvertenza
- (P) Aviso
- (NL) Waarschuwing
- (DK) Advarsel
- (N) Advarsel
- (S) Varning
- (SF) Varoitus
- (CZ) Varování
- (H) Figyelmeztetés
- (PL) Ostrzeżenie
- (GR) Προειδοποίηση
- (RUS) Предупреждение
- (SVK) Výstraha

- (GB) See installation instructions
- (D) Siehe Installationsanleitung
- (E) Ver las instrucciones de instalación
- (F) Se reporter à la notice d'installation
- (I) Vedere le istruzioni di installazione
- (P) Consultar instruções de instalação
- (NL) Zie montageinstructies
- (DK) Se monteringsanvisninger
- (N) Se monteringsinstruksjonene
- (S) Se monteringsinstruktioner
- (SF) Katso asennusohjeet
- (CZ) Viz návod k instalaci
- (H) Lásd: Telepítési utasítások
- (PL) Zapoznać się z instrukcją instalacji
- (GR) Βλ. οδηγίες εγκατάστασης
- (RUS) См. инструкцию по установке
- (SVK) Pozrite si návod na inštaláciu



CLEANER



- (GB) Look
- (D) Schauen
- (E) Mirar
- (F) Verrouiller
- (I) Osservare
- (P) Ver
- (NL) Kijken
- (DK) Se
- (N) Se
- (S) Se
- (SF) Katso
- (CZ) Podívejte se
- (H) Nézzze meg
- (PL) Spójrzec
- (GR) Κοιτάξτε
- (RUS) Контролировать визуально
- (SVK) Pozrieť

- (GB) Wipe clean
- (D) Sauber abwischen
- (E) Limpiar
- (F) Nettoyer en essuyant
- (I) Strofinare
- (P) Limpar com um pano
- (NL) Schoonvegen
- (DK) Visk ren
- (N) Tørk ren
- (S) Torka rent
- (SF) Pyyhi puhtaaksi
- (CZ) Utřete dočista
- (H) Törölje le
- (PL) Wyrzeć do czysta
- (GR) Καθαρισμός
- (RUS) Протереть начисто
- (SVK) Čistiť utieraním

- (GB) Tape up
- (D) Schutzband anwenden
- (E) Cinta
- (F) Coller la bande adhésive
- (I) Applicare nastro
- (P) Utilizar fita adesiva
- (NL) Bevestigen met tape
- (DK) Tape op
- (N) Maskering
- (S) Fäst med tejp
- (SF) Teippaa
- (CZ) Připevněte páskou
- (H) Ragassza be
- (PL) Zakleić
- (GR) Ταβιά
- (RUS) Обмотать лентой
- (SVK) Páskou nahor

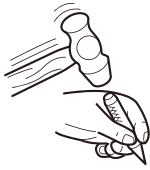

- (GB) Use center punch
- (D) Körnen
- (E) Marcar destornillador
- (F) Marquer au pointeau
- (I) Bulinare
- (P) Marcar con punção de
- (NL) Marcar
- (DK) Centerponsen
- (N) Opmærkning med kørner
- (S) Körning
- (SF) Märkning med körnslag
- (CZ) Merkitse puikolla
- (H) Dűlkovac
- (PL) Kipontozni punktowac
- (GR) Ποντάρισμα
- (RUS) Использовать кернер
- (SVK) Použite stredový razník



- (GB) Use drill
- (D) Bohrer verwenden
- (E) Usar taladro
- (F) Utiliser une perceuse
- (I) Utilizzare il trapano
- (P) Utilizar broca
- (NL) Boor gebruiken
- (DK) Brug bor
- (N) Bruk bor
- (S) Använd borr
- (SF) Käytä poraa
- (CZ) Použijte vrtačku
- (H) Használjon fúrót
- (PL) Użyć wiertła
- (GR) Χρησιμοποιήστε τρυπάνι
- (RUS) Использовать дрель
- (SVK) Použite vrtačku



- (GB) Burr removal
- (D) Entgraten
- (E) Eliminator de rebaba
- (F) Retrait des ébarbures
- (I) Rimozione bave
- (P) Remoção da rebarba
- (NL) Bramen verwijderen
- (DK) Fjernelse af grat
- (N) Fjerning av gradkant
- (S) Avgradning
- (SF) Hio reunat
- (CZ) Odstranění hrubých okrajů
- (H) Forgács eltávolítása
- (PL) Usuwanie zadziorów
- (GR) Αφαίρεση ριγισμάτων
- (RUS) Удалить неровности
- (SVK) Odstránenie drsného okraja



- (GB) See workshop manual
- (D) Siehe Werkstatt-Handbuch
- (E) Ver el manual del taller
- (F) Se reporter au manuel d'atelier
- (I) Vedere manuale di officina
- (P) Consultar manual de oficina
- (NL) Zie werkplaatshandboek
- (DK) Se værkstedsmanual
- (N) Se verkstedmanualen
- (S) Se verkstadshandbok
- (SF) Katso korjausopas
- (CZ) Viz příručka pro dílnu
- (H) Lásd: Szerelési kézikönyv
- (PL) Patrz podręcznik serwisowy
- (GR) Βλ. εγχειρίδιο συνεργείου
- (RUS) См. руководство по ремонту
- (SVK) Pozrite si dielenskú príručku



- (GB) Marking
- (D) Markierung
- (E) Marcado
- (F) Marquer
- (I) Marcatura
- (P) Marcação
- (NL) Markeren
- (DK) Afmærkning
- (N) Merke
- (S) Markering
- (SF) Merkitä
- (CZ) Značení
- (H) Jelölés
- (PL) Oznaczenie
- (GR) Σήμανση
- (RUS) Маркировка
- (SVK) Značkovanie

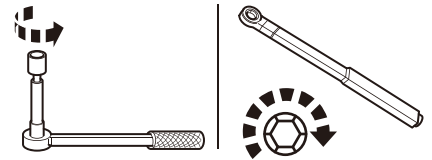

- (GB) Tighten
- (D) Festziehen
- (E) Ajustar
- (F) Serrer
- (I) Serrare
- (P) Apertar
- (NL) Aanhalen
- (DK) Spænd
- (N) Stram til
- (S) Dra åt
- (SF) Kiristä
- (CZ) Upevněte
- (H) Szorítás
- (PL) Dokręcić
- (GR) Σφίξιμο
- (RUS) Затянуть
- (SVK) Utiahnite



- (GB) 2 Man operation Required
- (D) Zwei-Mann-Bedienung erforderlich
- (E) Se requiere el trabajo de 2 operarios
- (F) Manipuler à 2 personnes impérativement
- (I) Necessario intervento di 2 operatori
- (P) Necessária operação com 2 pessoas
- (NL) 2 personen vereist voor dit werk
- (DK) Skal udføres med hjælper
- (N) Nødvendig med to personer
- (S) Medhjälpare krävs
- (SF) Edellyttää 2 käyttäjää
- (CZ) Nutné pracovat ve dvojici
- (H) Az eljárás 2 főt igényel
- (PL) Wymagana obsługa przez 2 osoby
- (GR) Απαιτούνται 2 άτομα για την εργασία
- (RUS) Для выполнения работы требуется 2 человека
- (SVK) Úkon si vyžaduje 2 osoby



A

DESCRIPTION

KLBC V4 920

>TPO<

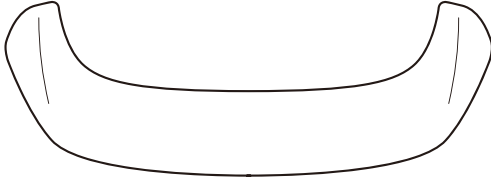

1x

B

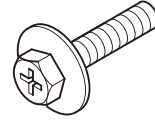

2x

C



1x



1

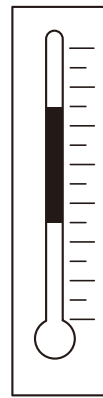

+35°C

+15°C

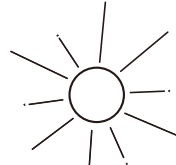

2

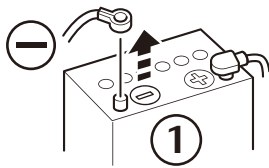

Vehicle front

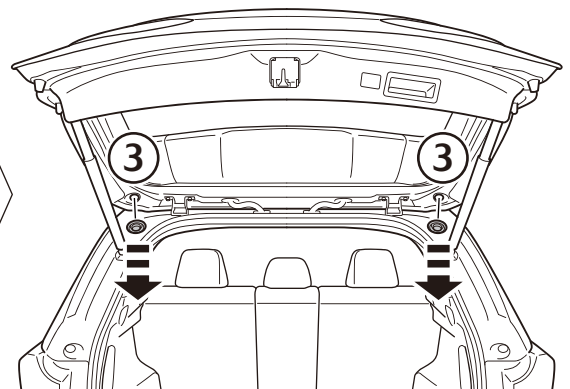
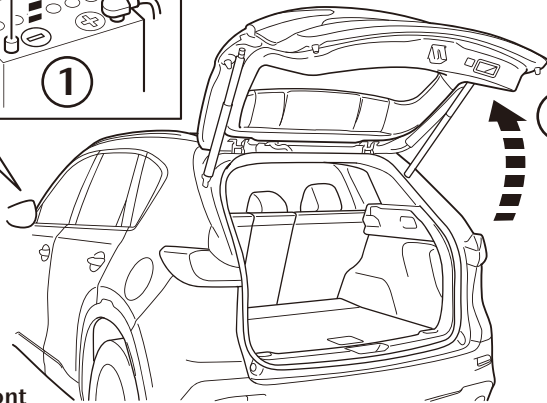

3

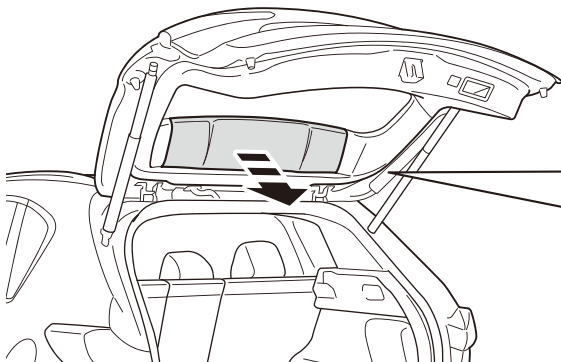

Vehicle front

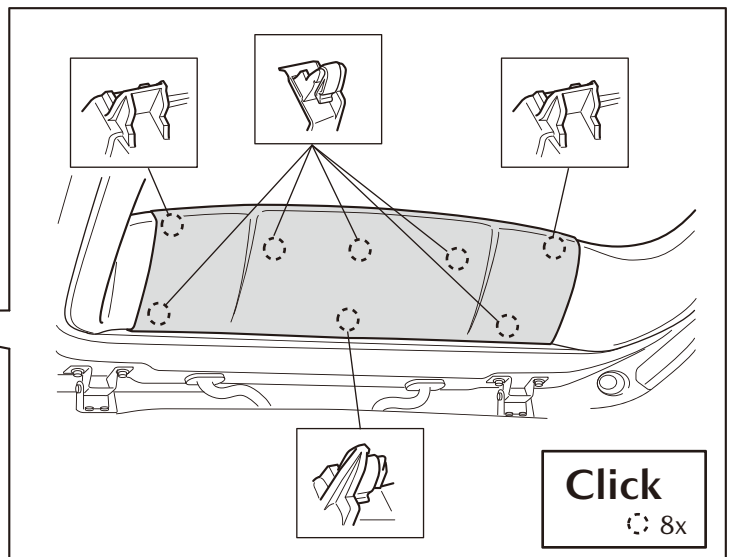

4

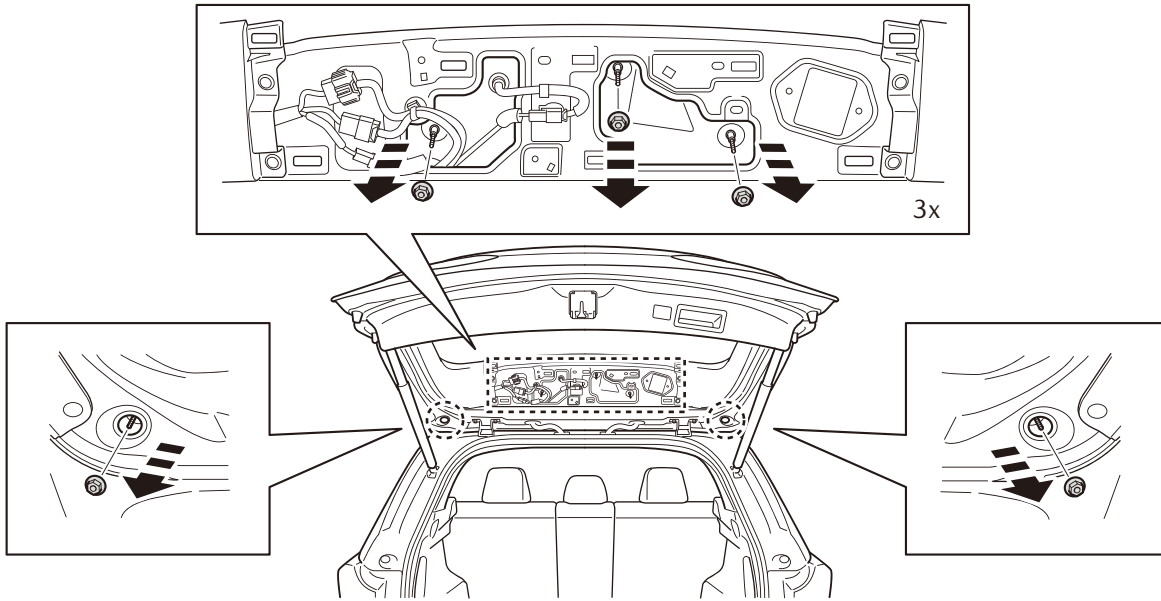

5

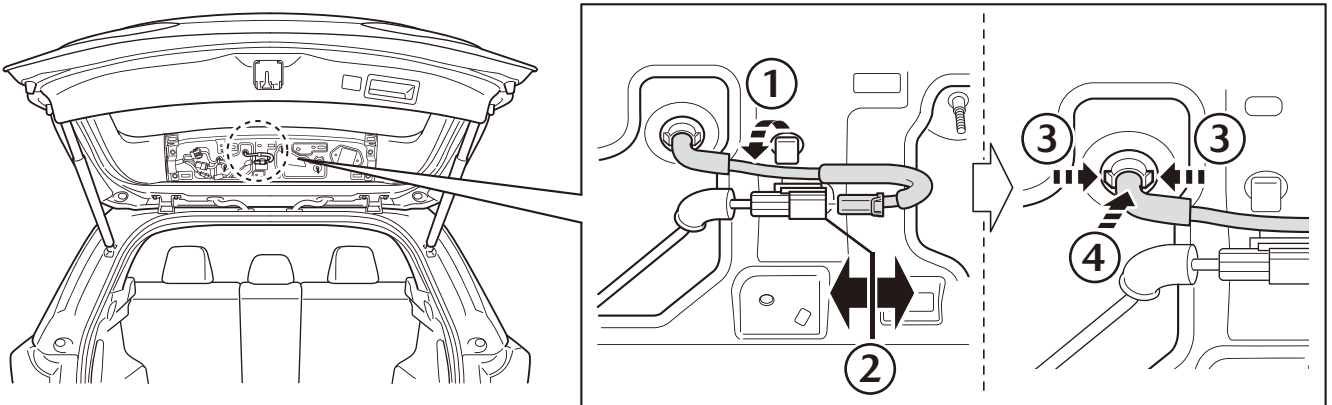

6

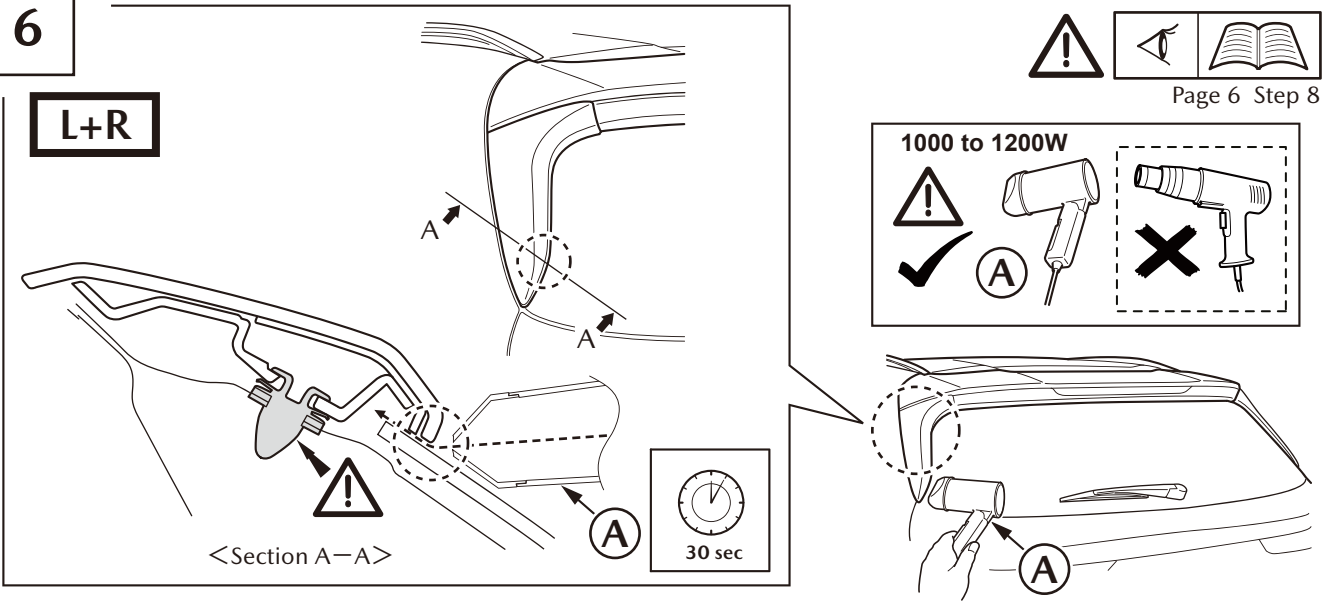



7



L+R

Page 7 Step 9

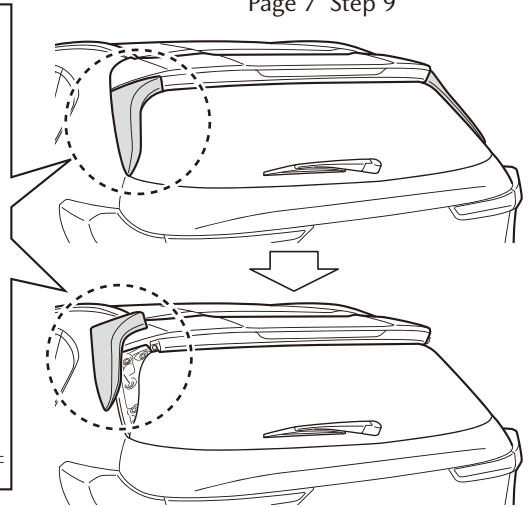
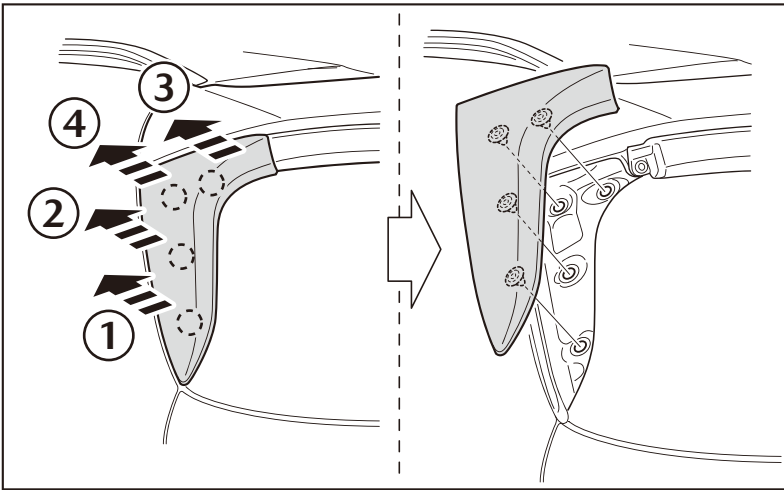

8



Page 7 Step 11&12

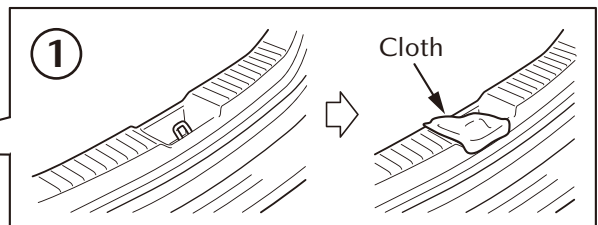
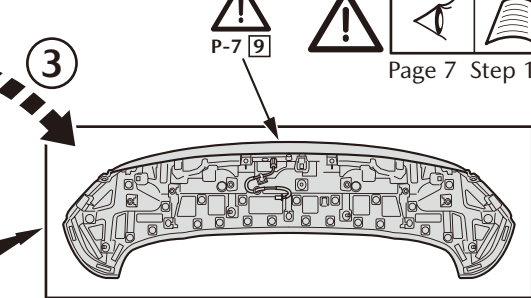
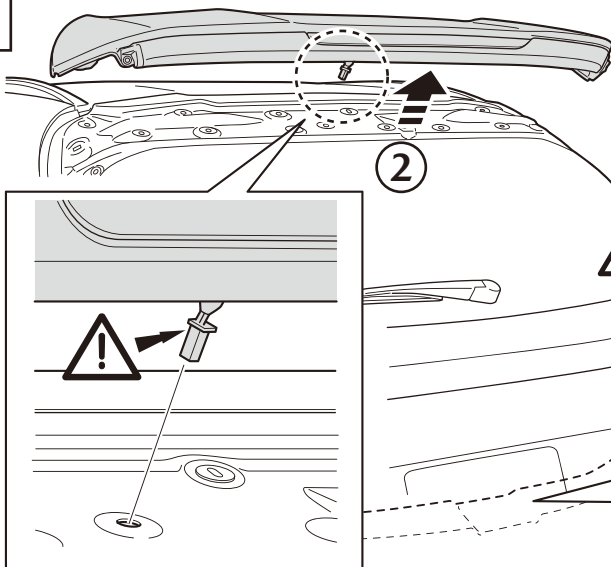

9



Page 8 Step 1&2

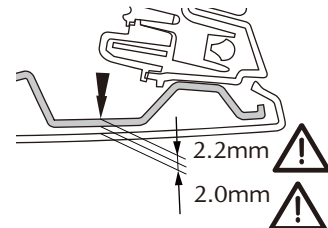
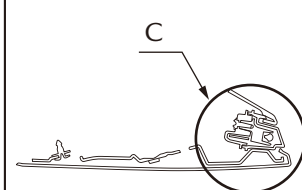
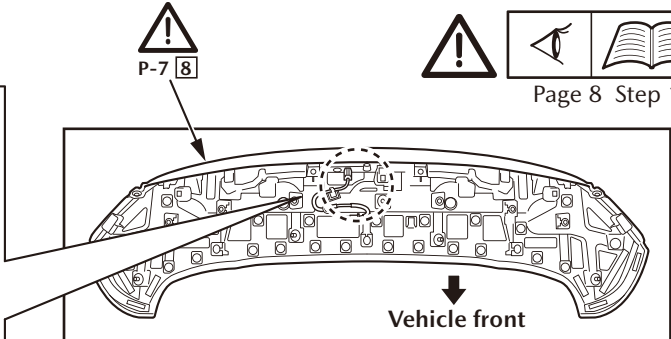
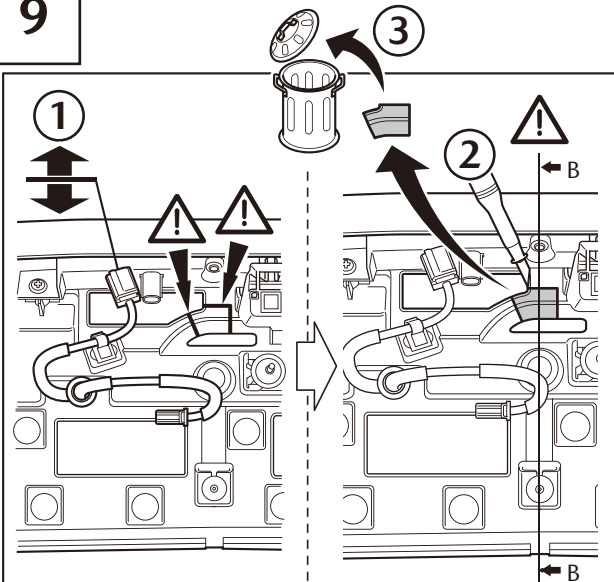



10

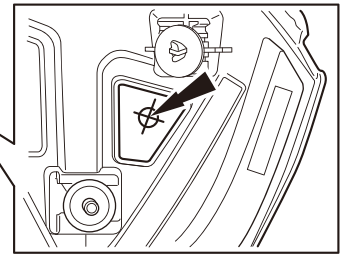
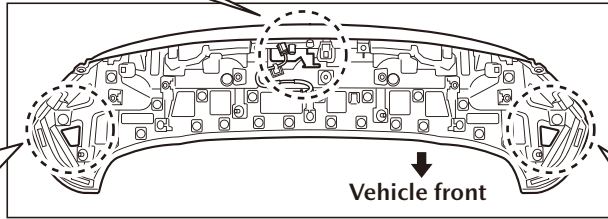
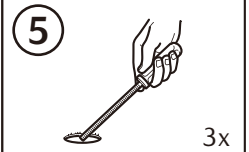
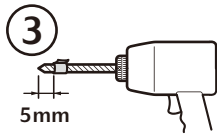
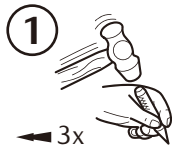
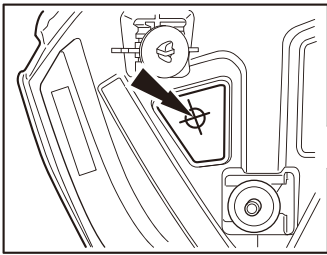
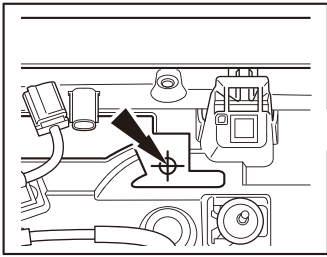

11

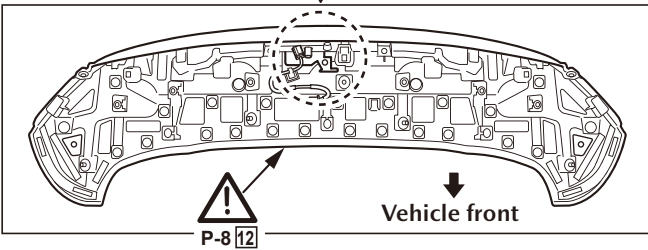
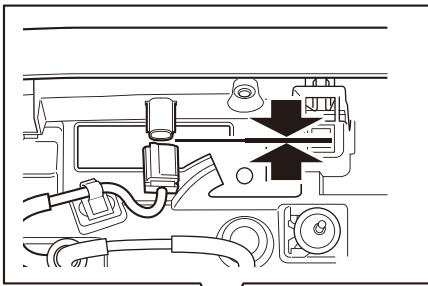

12

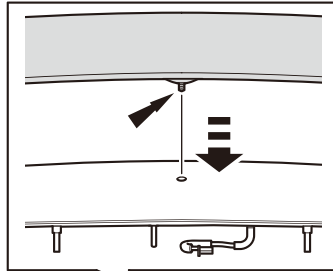

Page 9 Step 1



A



P-8 11

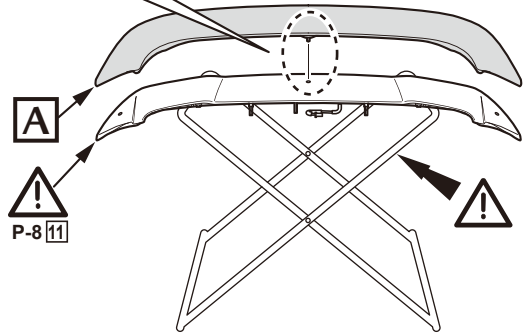

13

A

Vehicle front

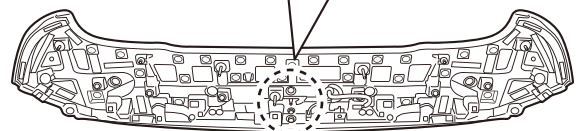
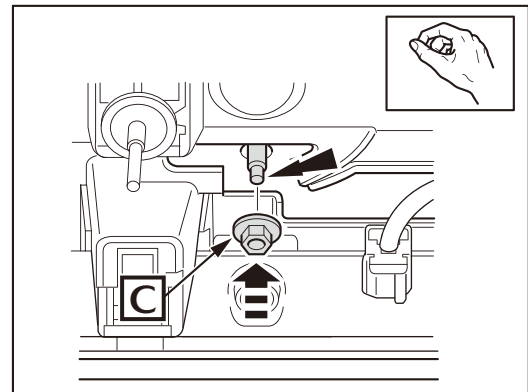
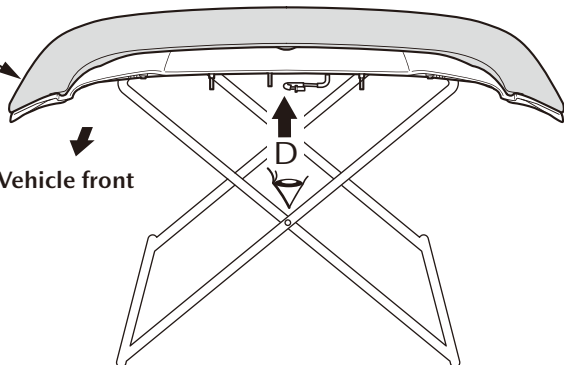

<View D>



14



Page 10 Step 3

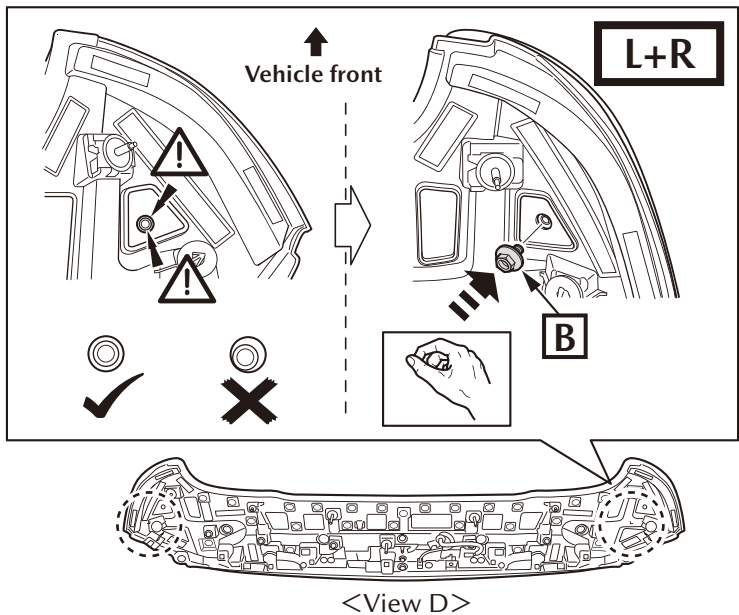
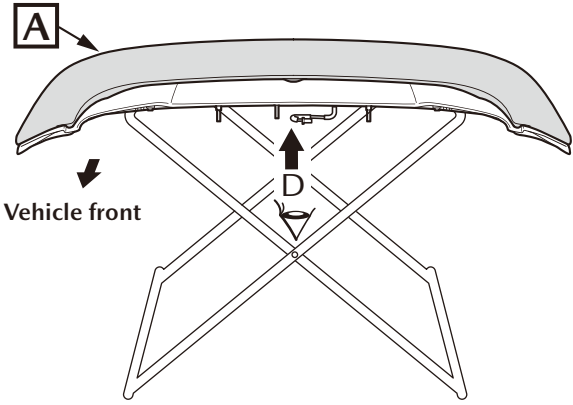

15

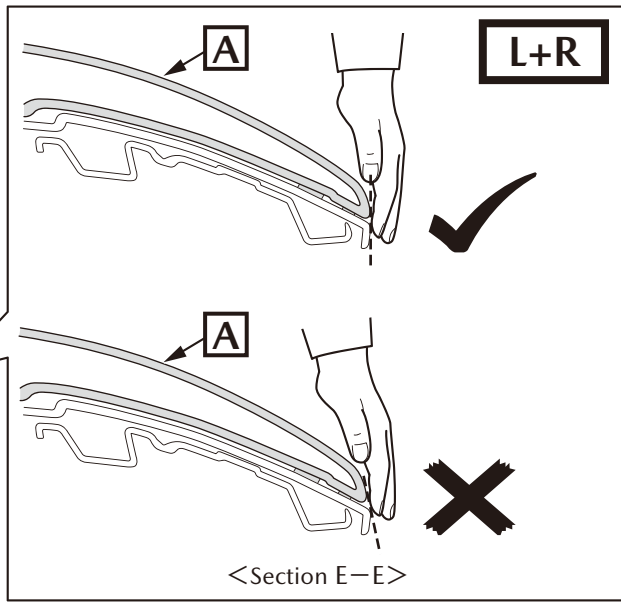
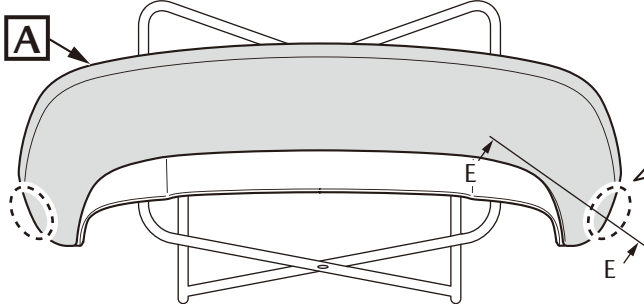

16

L+R

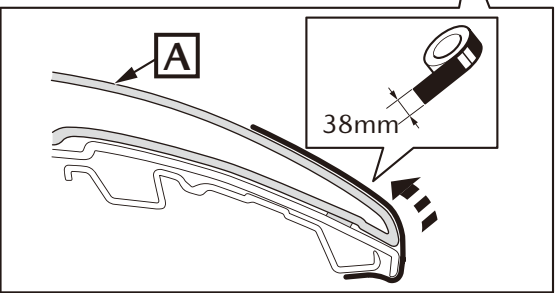
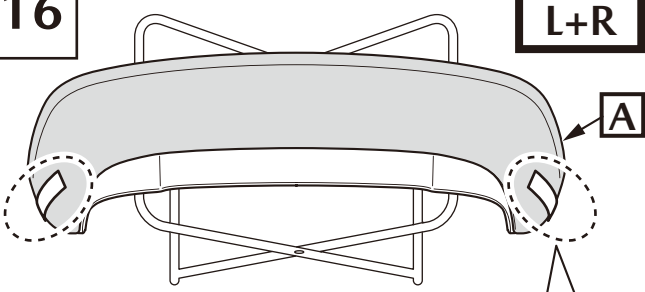

17

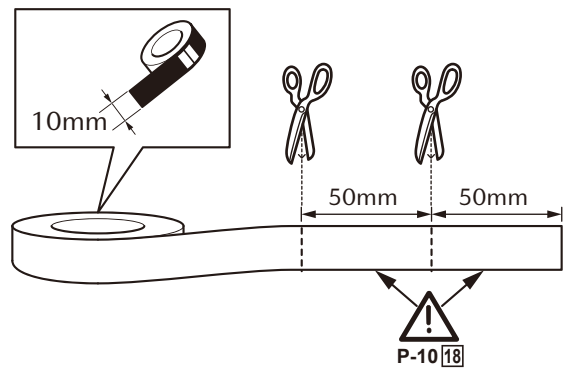



18



L+R

Page 11 Step 6

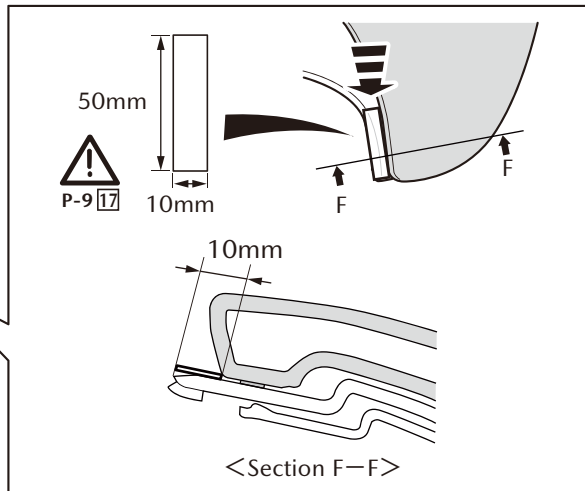
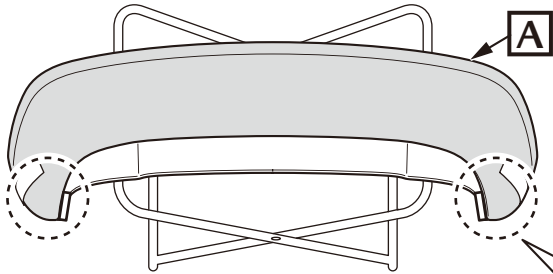

19

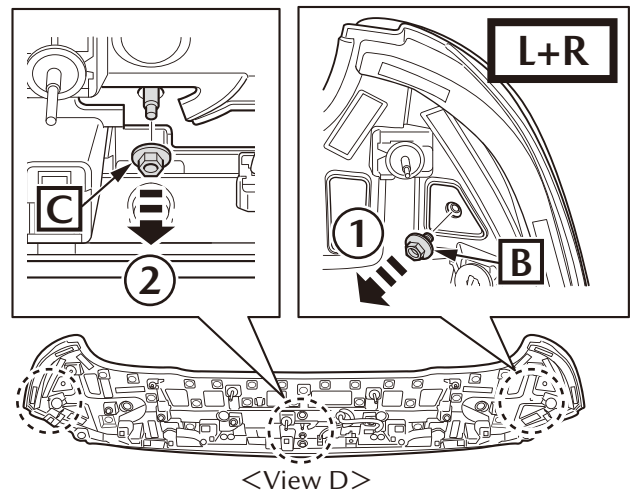
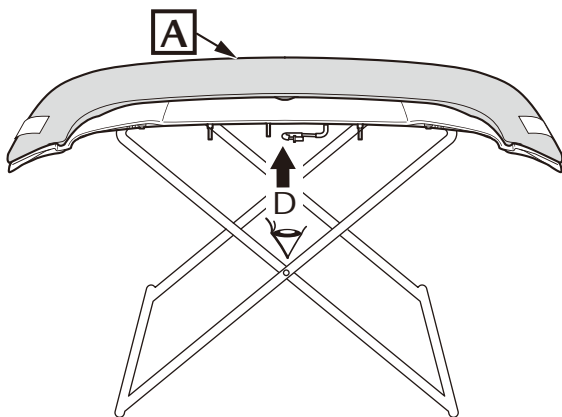

20



Page 11 Step 7&8

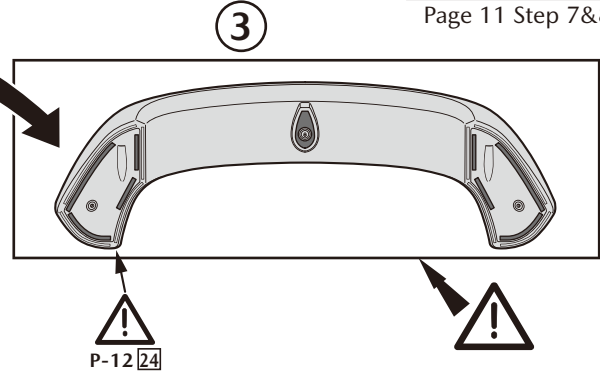
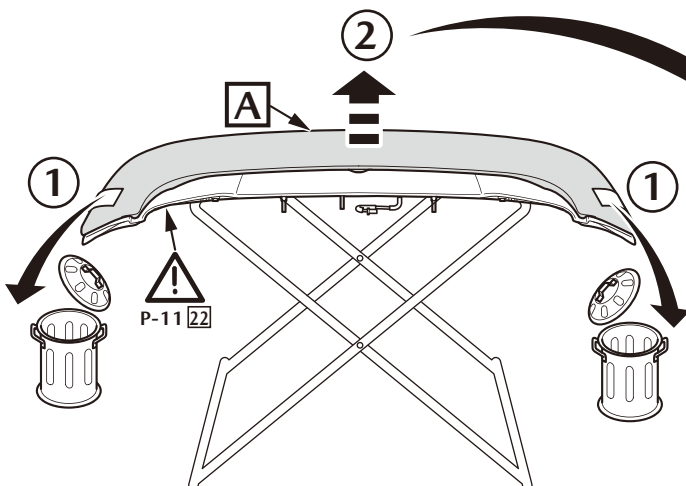



21

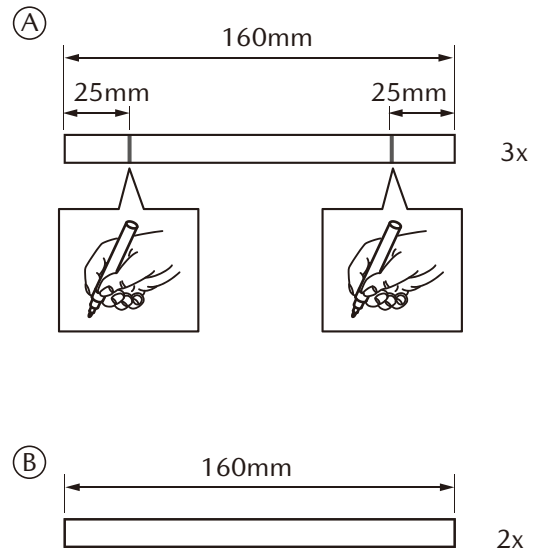
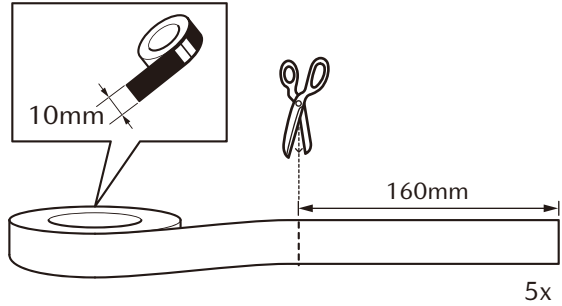

22

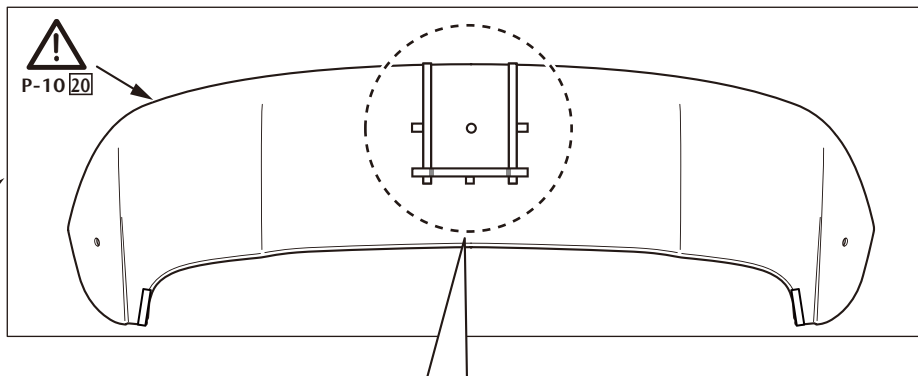

Page 11 Step 2&3

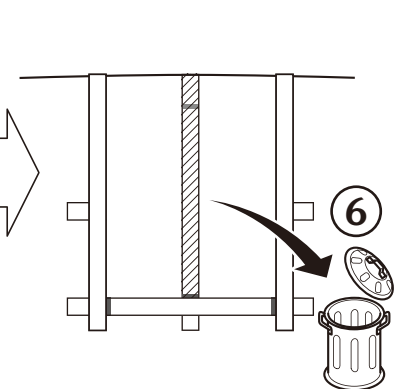
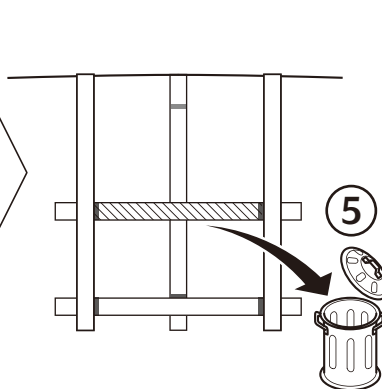
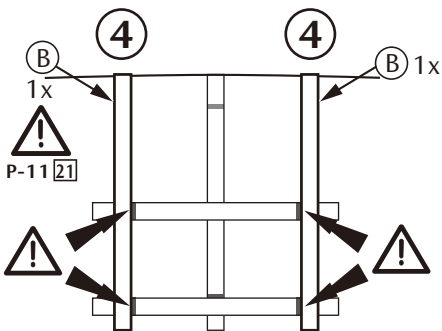
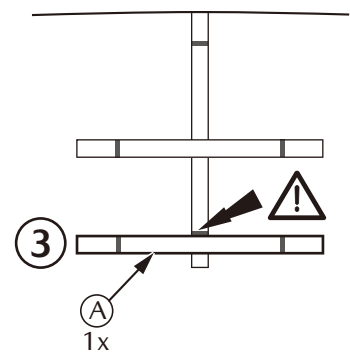
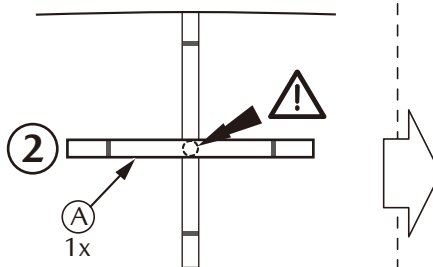
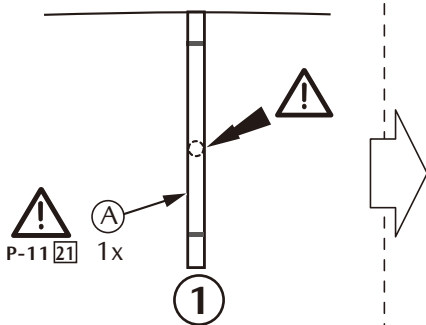

23

① CLEANER	② 2-3 min
------------------	------------------



Page 12 Step 4

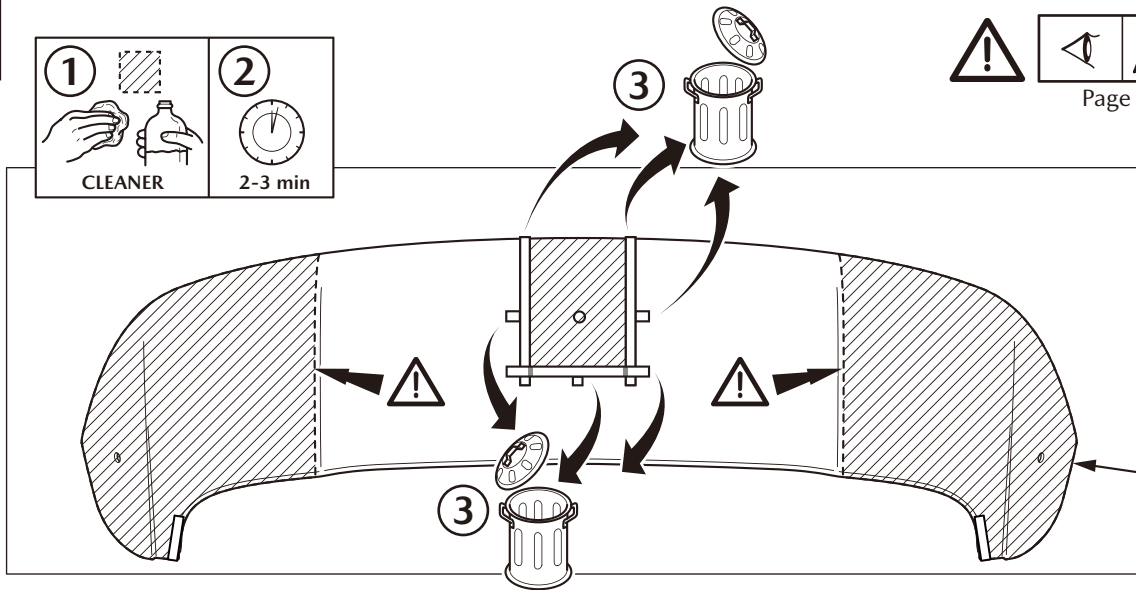

! P-13 26

24

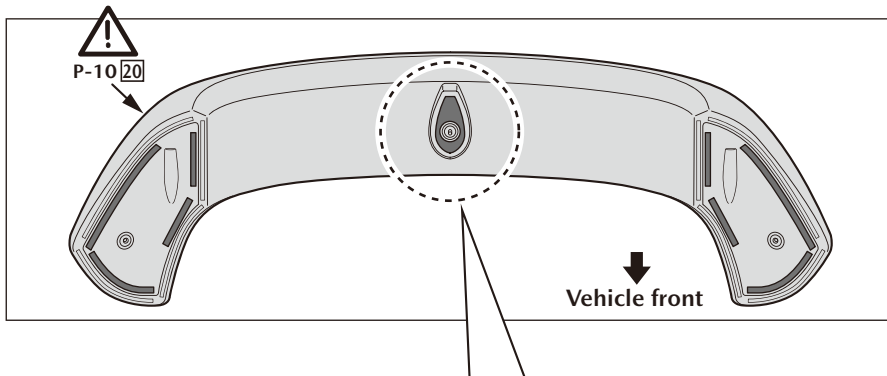

Page 12 Step 5

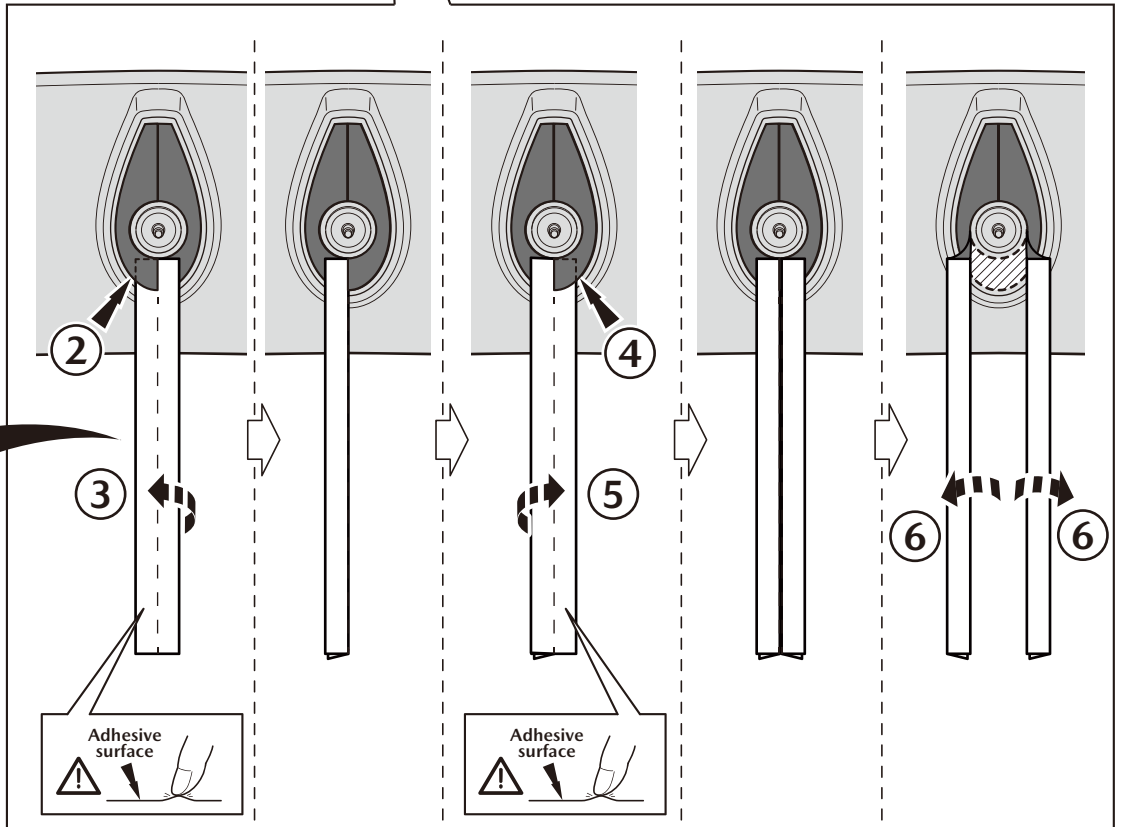
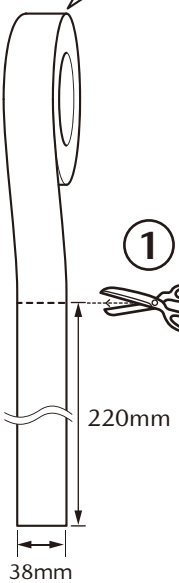
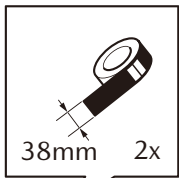

Adhesive surface

Adhesive surface



25

L+R



Page 13 Step 6&7

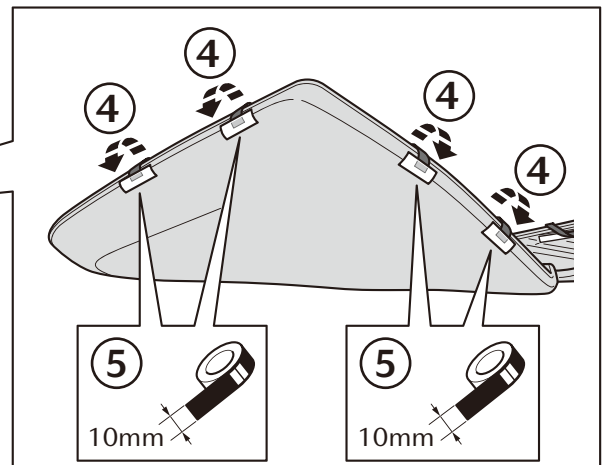
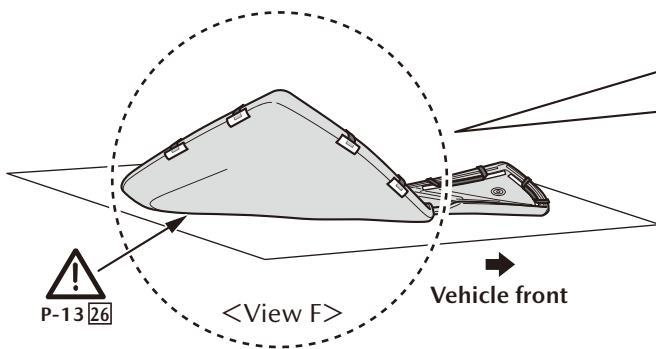
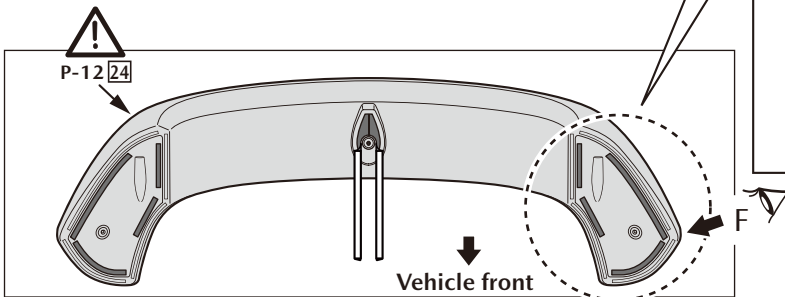
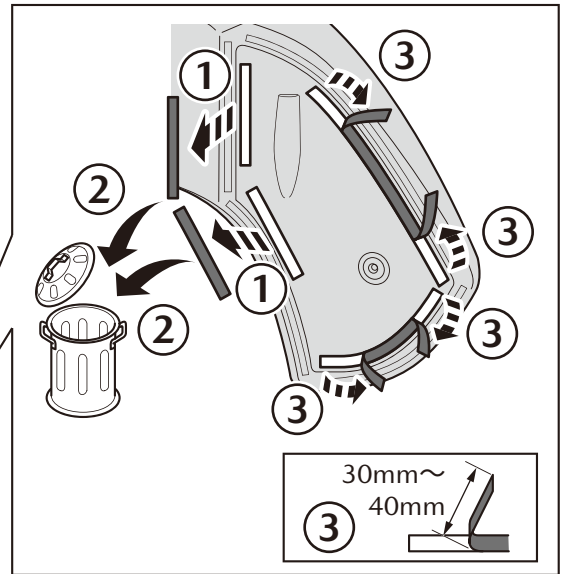

26



L+R

Page 13 Step 1

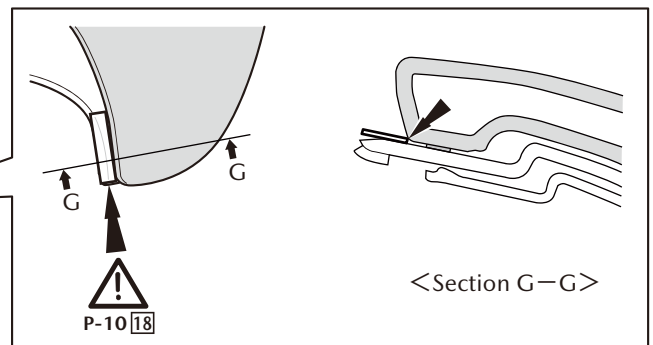
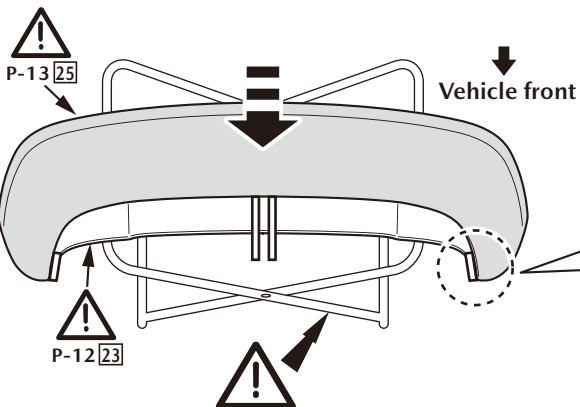



27

L+R

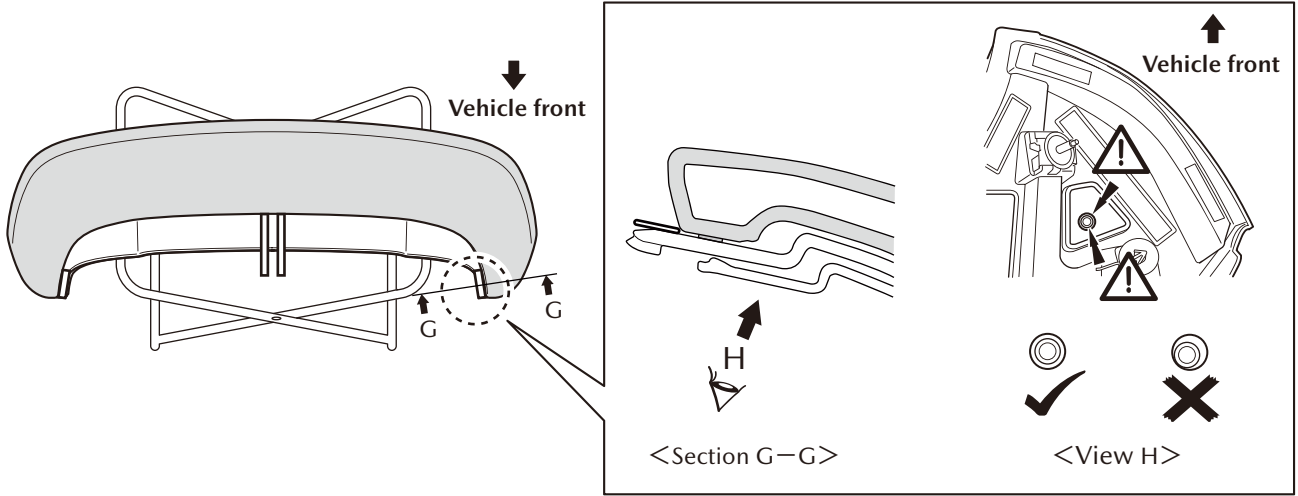

28

L+R

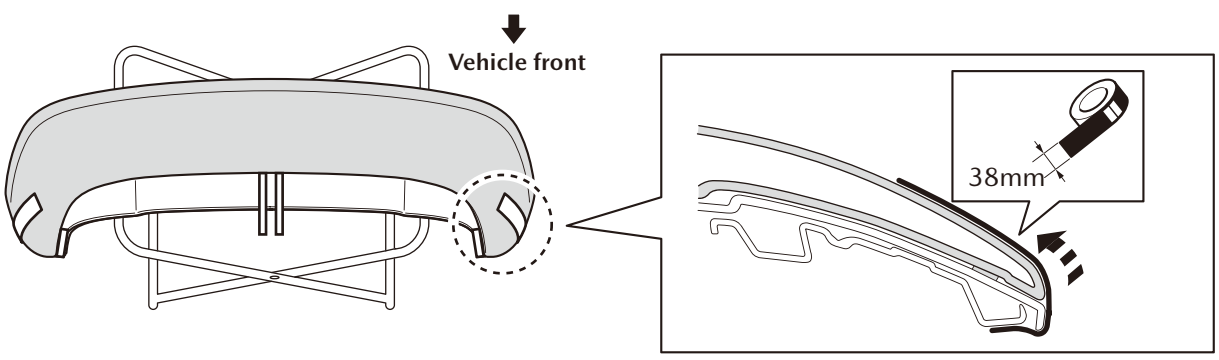
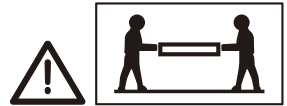

29

L+R

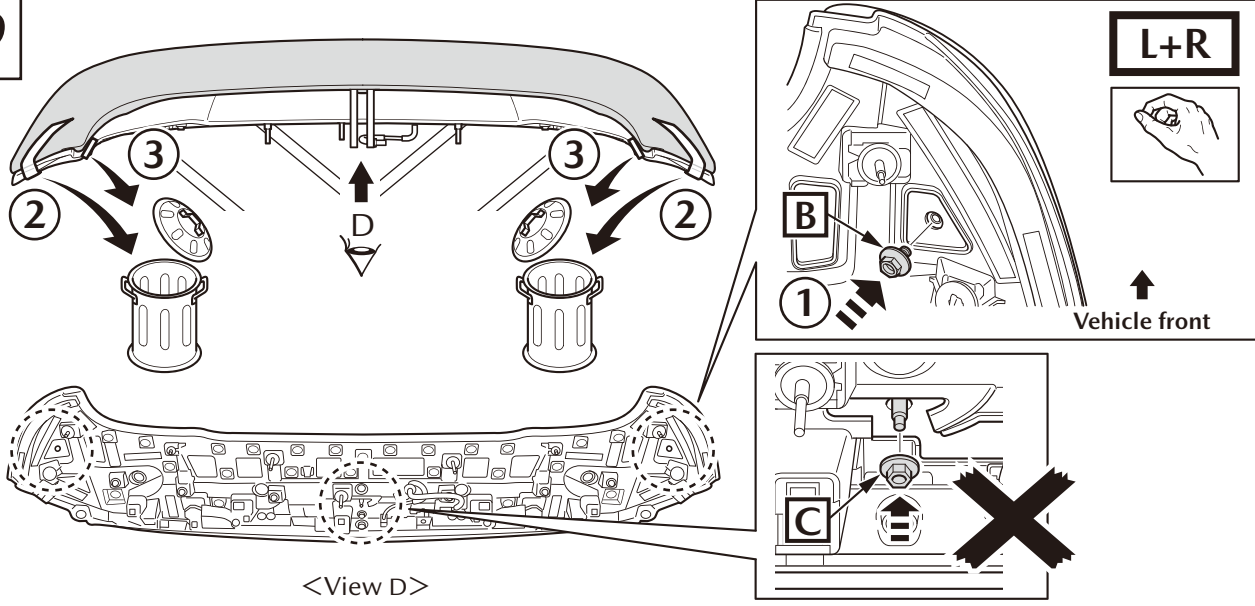



30

L+R

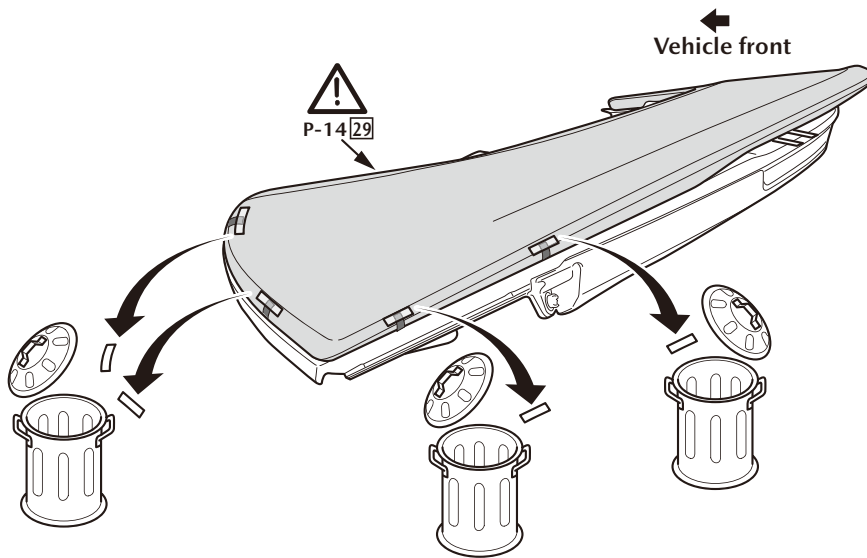

31

L+R

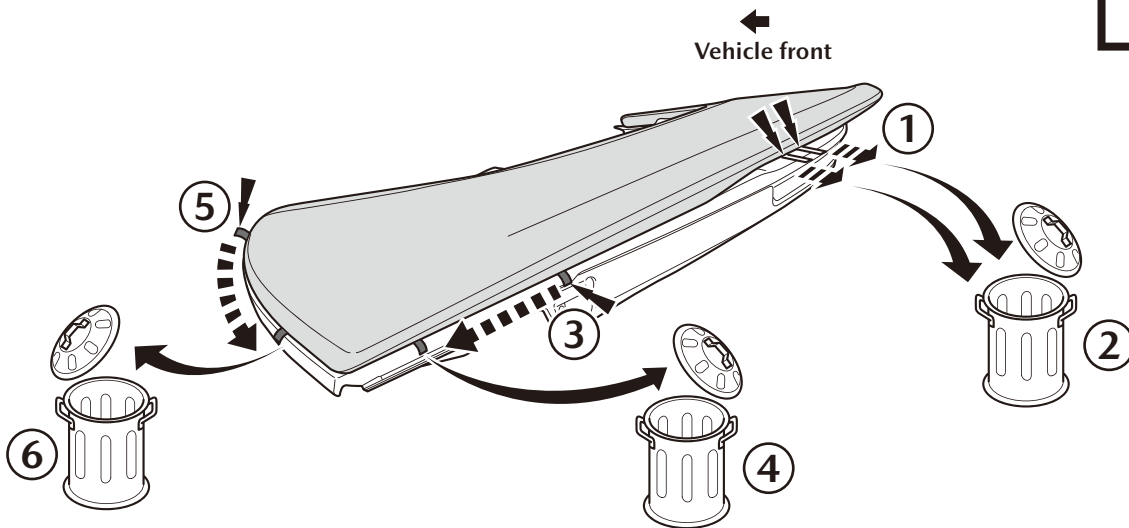

32

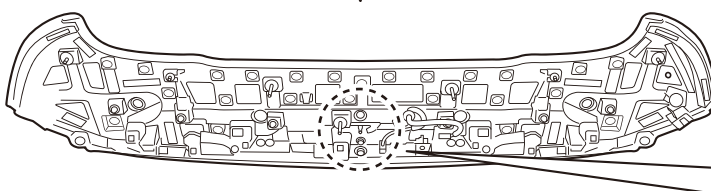
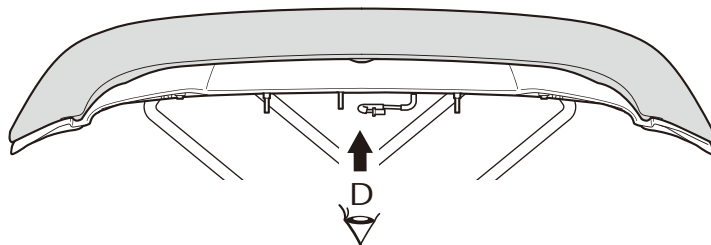

<View D>

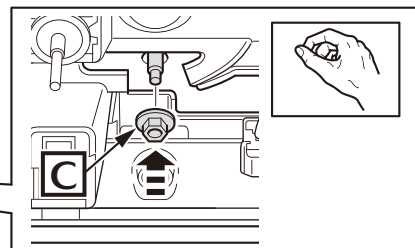



33

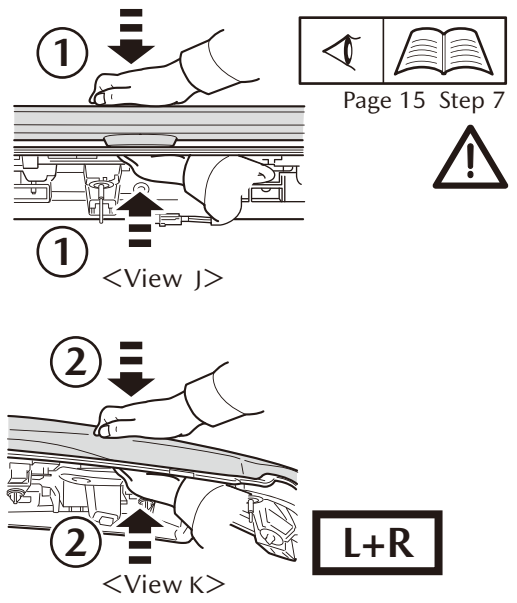
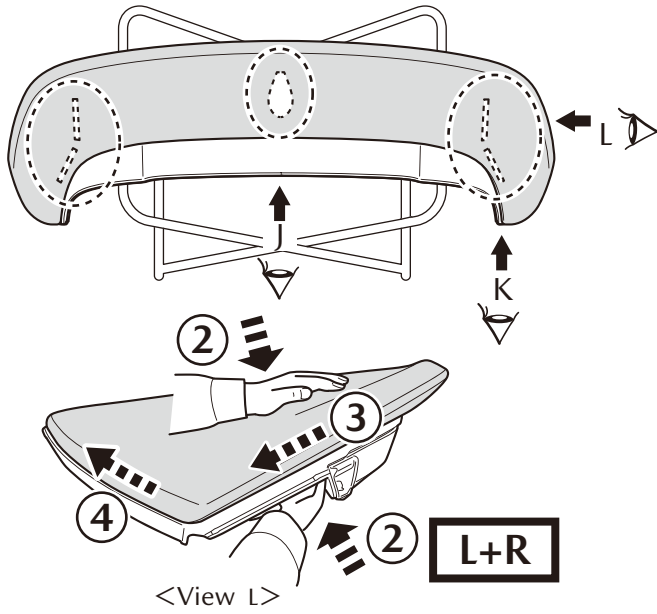

34

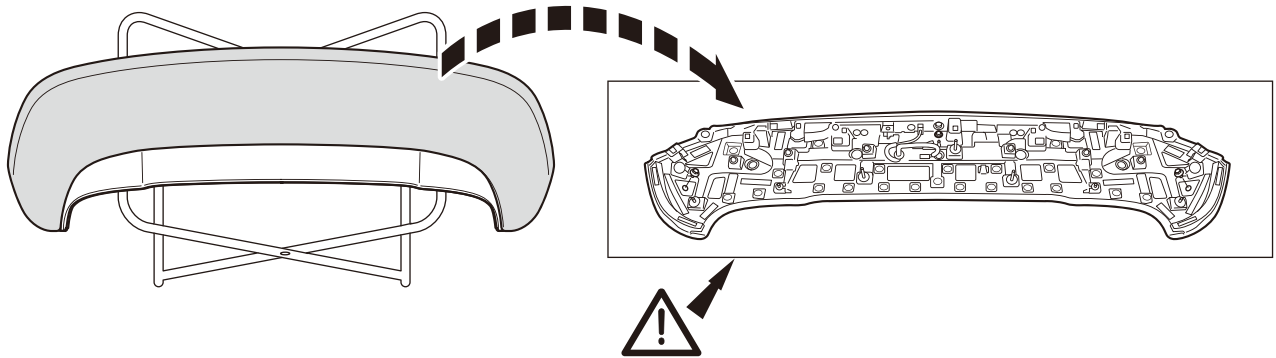

35

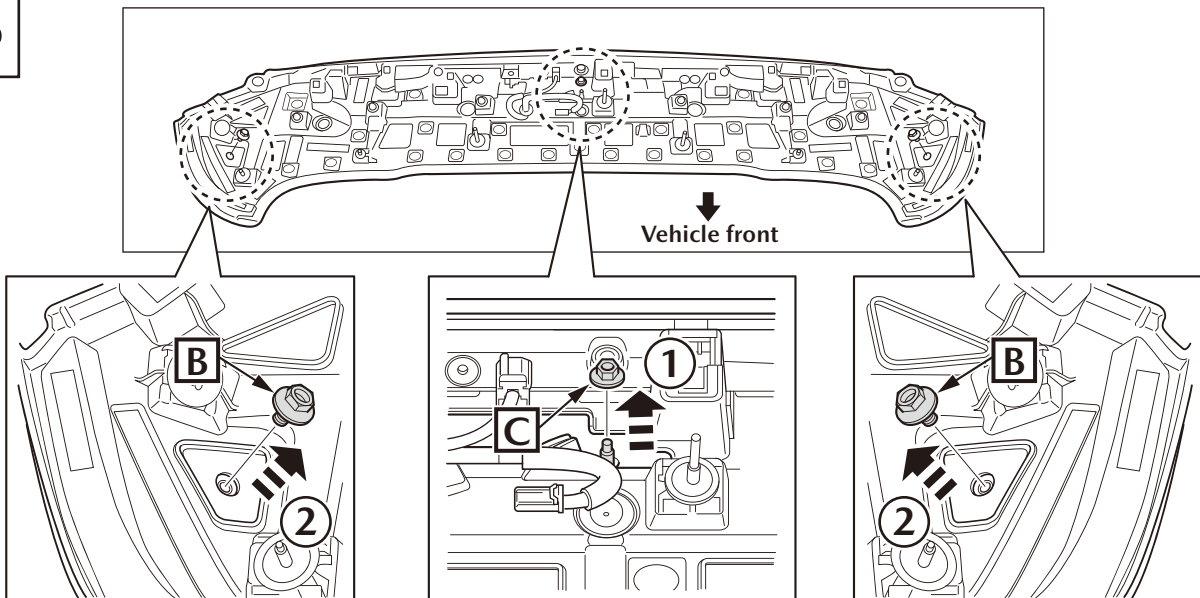

36

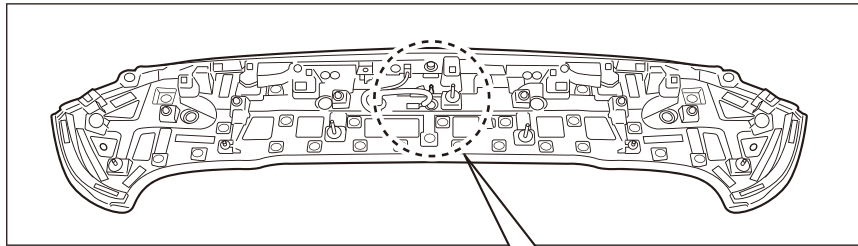

Page 16 Step 9&10

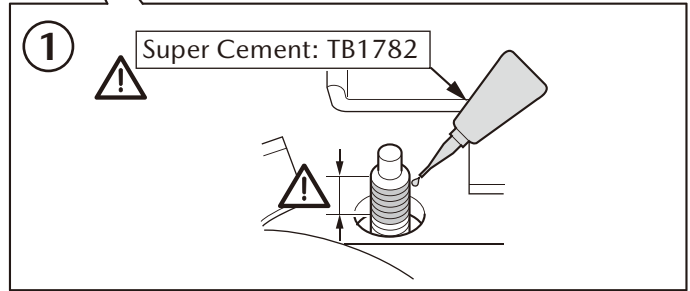
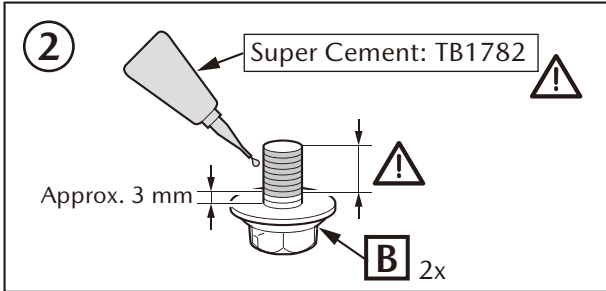

37

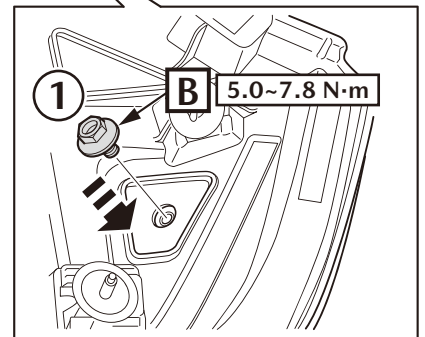
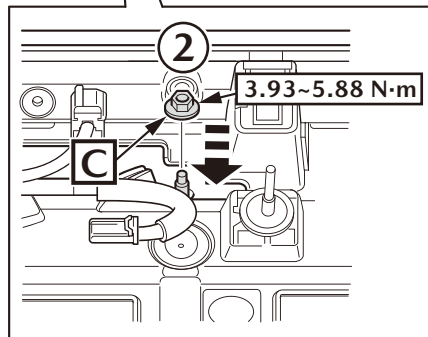
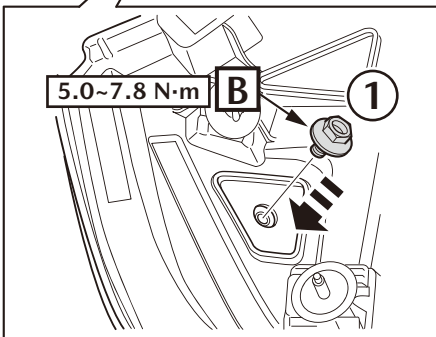
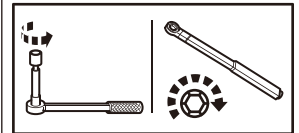
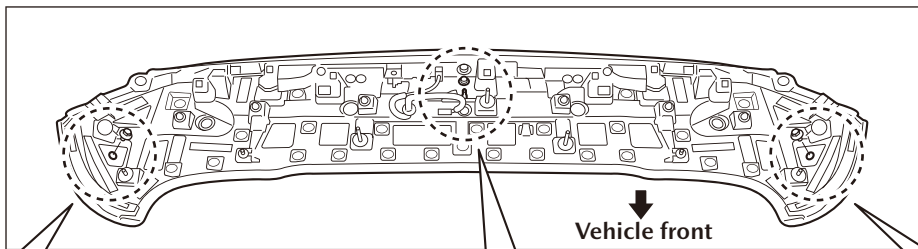

38

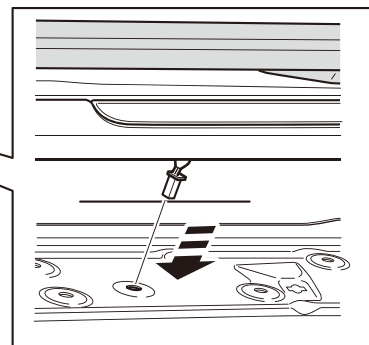
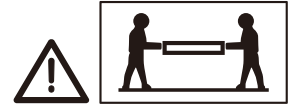
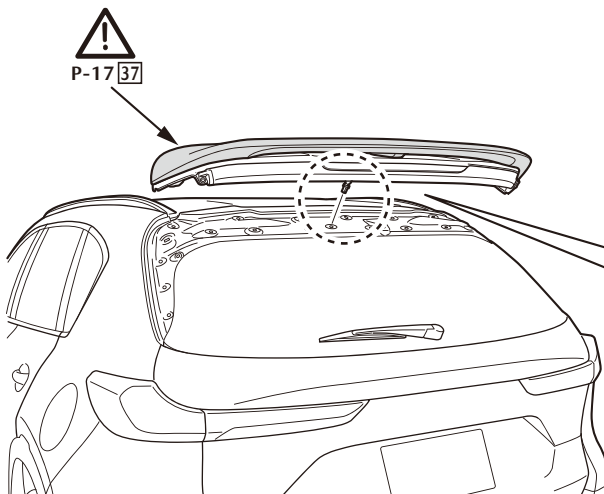



39

L+R

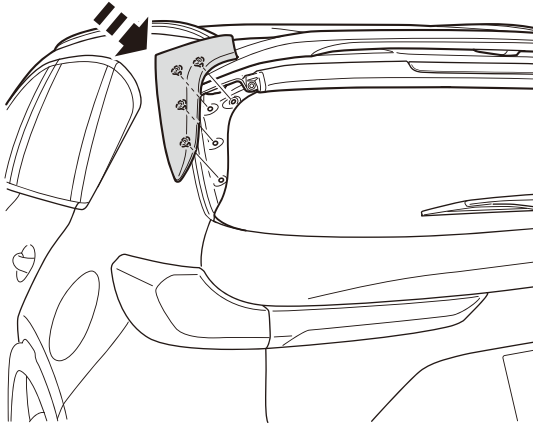

40

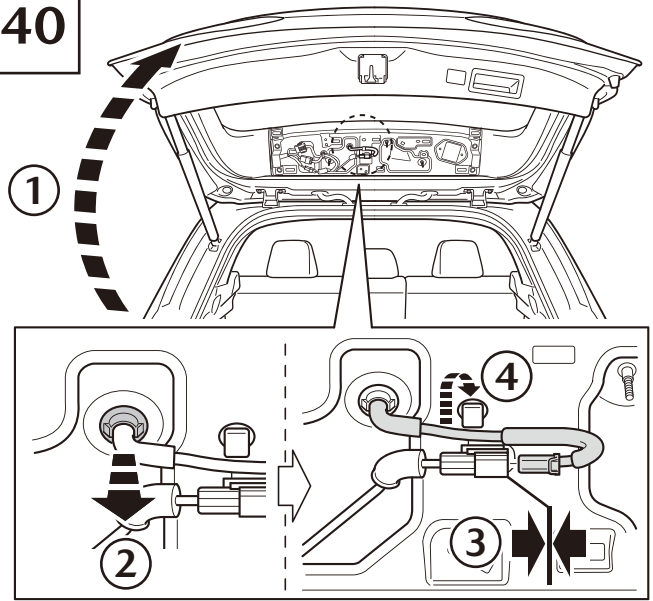

41

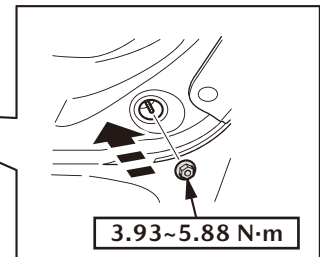
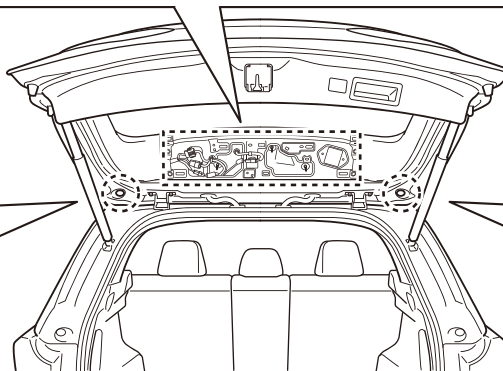
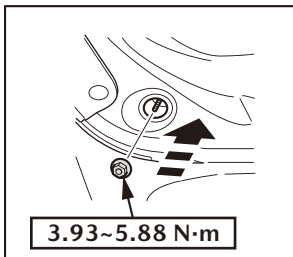
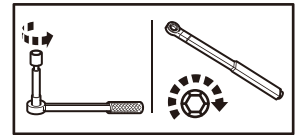
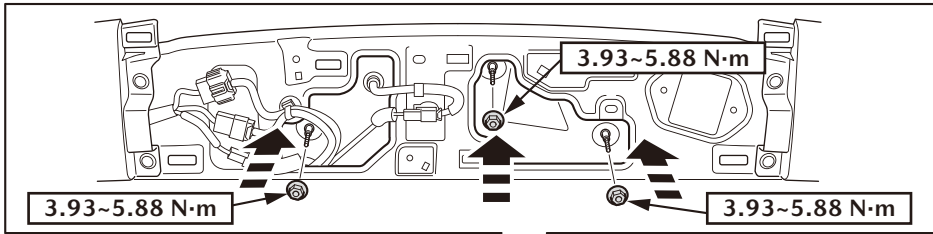

42

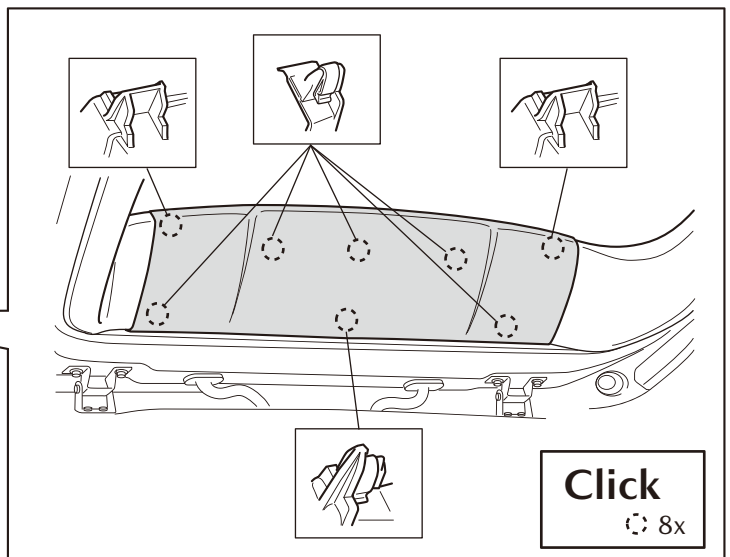
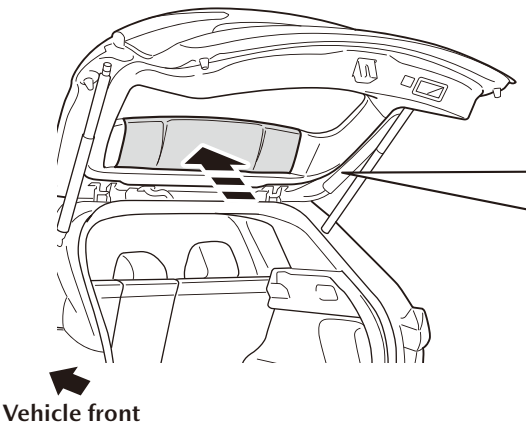



43

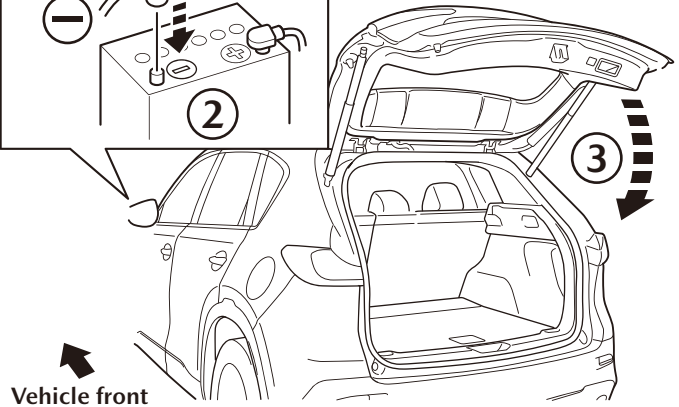
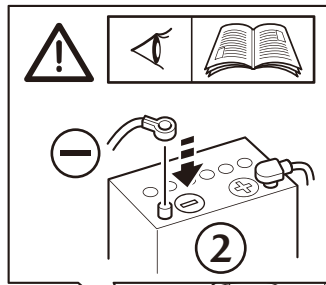
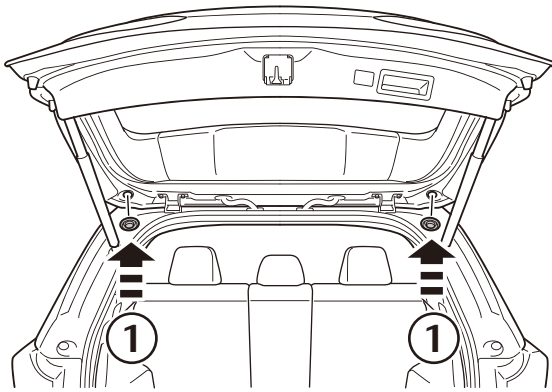

44

