

fullstop[®]
SECURITY

SACACEN

Model. FHL400

ULTRA
Hitch Lock



**PLEASE READ THIS
MANUAL BEFORE
FIRST USE.**

**TIME INVESTED IN
CORRECT FITMENT
IS REPAID IN THE
LEVEL OF SECURITY
THAT IS ACHIEVED.**

User Manual

Rev.A 11-11

by  **purpleline**[®]
design...innovate...improve

Parts Identification

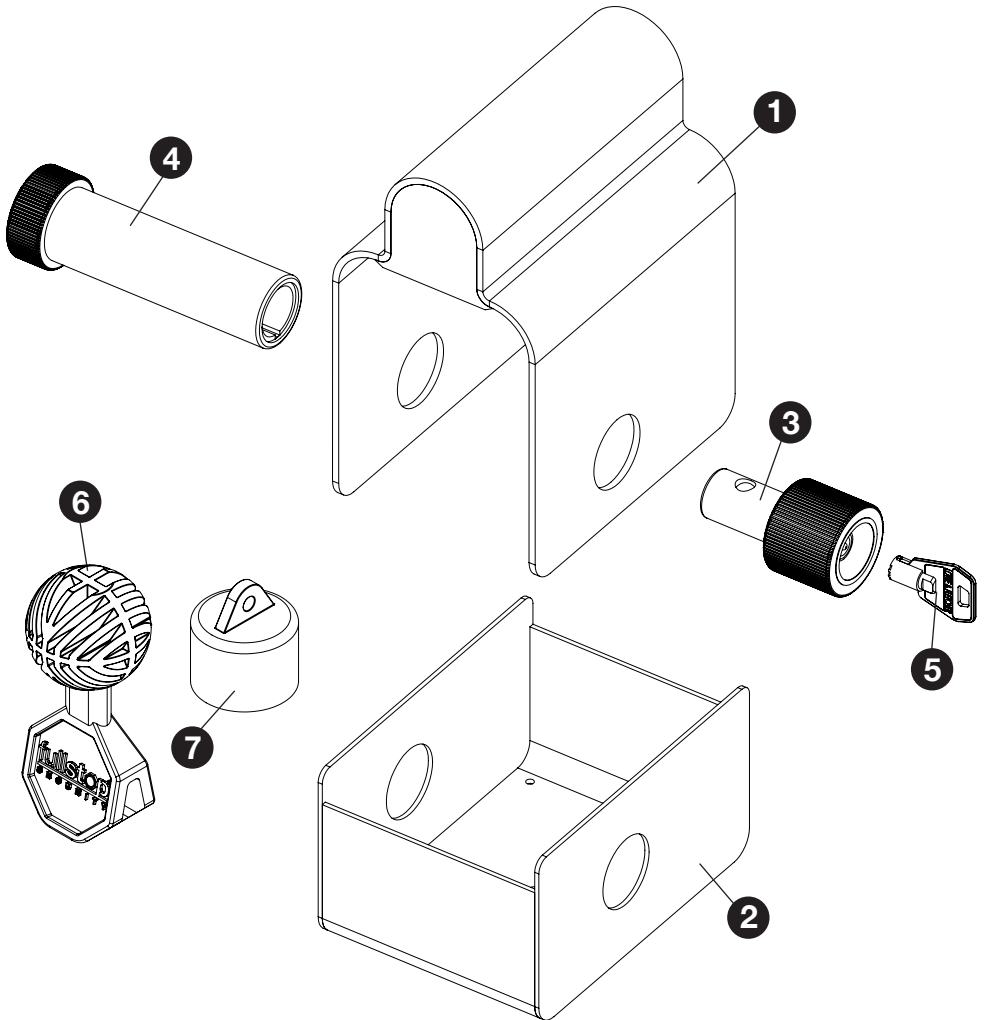

- | | |
|------------------------|------------------|
| 1. Main Body | 5. Key (x2) |
| 2. Base Section | 6. Security Ball |
| 3. Male Lock Portion | 7. Lock Cap |
| 4. Female Lock Portion | |

Please store your keys in a safe place and remember to return your fully completed registration card. Your key number is located on both of the keys supplied and will be required in order to purchase replacement keys.



Installation

The FullStop® Saracen Ultra hitch lock can be fitted when your vehicle is hitched or unhitched, but must not be fitted during transit.

Hitched

Insert key (5) into Male Lock Portion (3), push and turn 90° clockwise to unlock.

If stabiliser is fitted, lift handle to vertical position.

Position the Main Body (1) over the hitch handle ensuring the handle end is recessed fully into the enclosed end of the Main Body (1). Fit the Base Section (2) onto the bottom of the Main Body ensuring the holes line up with each other. Slide the Female Lock Portion (4) through all the holes.

Insert the Male Lock Portion (3) into the Female Lock Portion (4) and turn 90° anti-clockwise to lock.

Fit the protective Lock Cap (7).

If stabiliser is fitted its handle may be pushed back down into position over the hitch lock.

Unhitched

Installation of the Saracen Ultra hitch lock when fitting onto an unhitched caravan, is identical except that the included Security Ball (6) must be inserted into your coupling to inhibit the caravan to be hitched onto a vehicle.

Note

It is highly recommended that a secondary security device (such as a wheel clamp) should be used to inhibit theft by some unconventional form of towing. Visit www.purpleline.co.uk for details of other products in the Fullstop Security range

Maintenance

Fit protective cap to lock barrel to help prevent ingress of dirt or water. Thereafter spray the outside of the lock body with a light oil such as WD-40 or equivalent every sixteen weeks.



Disclaimer

If used properly, your FullStop® product will be an effective deterrent. However, nothing can stop the efforts of the most determined thief, and to this end no liability is accepted for any loss and/or damage caused by any illegal activity including theft or vandalism. Liability also not accepted for any loss and/or damage arising from misuse, unauthorised repair or alteration and failure to follow the user guide directions. No form of consequential loss what so ever will be accepted.



© Copyright 2011. Purple Line Limited.

Web: www.purpleline.co.uk **E-mail:** admin@purpleline.co.uk **Tel:** 01473 601200

Photographs for illustration purposes only. Actual product may differ slightly.

Purple line Limited reserve the right to alter product specification without prior notice.