



TW STEEL®

BIG IN OVERSIZED WATCHES

MULTI FUNCTION AUTOMATIC

INSTRUCTIONS FOR USE OF THE MULTI FUNCTION AUTOMATIC

The Multi Function Automatic takes its energy from the movement which your watch makes on your wrist. The longer you wear the watch, the longer it will store the movements in the form of energy. The maximum reserve amounts to approximately 42 hours. This means that the watch shows the time for up to 42 hours when it is not worn. If you do not wear the watch for some time, or if you start to use the watch again, you can also wind it up by hand to get it started. Do this as follows: unscrew the crown anti-clockwise. Turn the crown clockwise and you wind up the movement.

▼ The power reserve display situated under the 12/O position will increase when you wind up the movement by hand. When the power reserve hits 40, the movement is fully wind up. Then screw the crown back on the case clockwise.

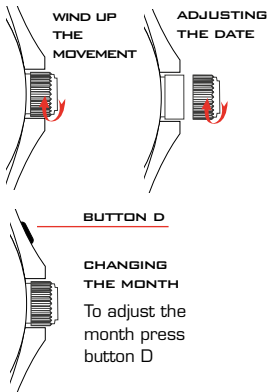

ADJUSTING THE DAY/DATE

The Multi Function Automatic has a rapid date adjustment. This rapid adjustment works as follows: You unscrew the crown from the case by turning it anti-clockwise. You then pull out the crown with one click. When you have reached this position, you can move the date by turning it clockwise. To move the day, turn the crown anti clockwise. Then press the crown towards the case and screw the crown back on the case by turning it clockwise.

▼ We strongly advise you not to change the date between 22.00 and 02.00h. as it can damage the date mechanism.

CHANGING THE TIME/MONTH

You unscrew the crown from the case by turning it anti-clockwise. You then pull out the crown with two clicks. This must be done carefully. You will see that the second hand stops. By turning the crown, you can then set the desired time. To adjust the month press button D.

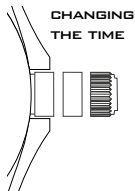

After changing the time, press the crown towards the case and screw the crown back on the case by turning it clockwise.

MAINTENANCE

TW Steel uses the best materials and carries out strict controls before the watch leaves the factory.

The way in which you wear or treat your TW Steel will determine whether the appearance of the watch is maintained in the future, or whether it will deteriorate. In order to enjoy wearing your TW Steel as long as possible, we include a number of tips: If the watch comes into contact with hard or corrosive materials, this can cause damage, which, if it occurs regularly, will become clearly visible in the form of scratches, or in the case of plated models can lead to a

discolouring of the plating. Your watch should be cleaned with a soft cotton cloth that is not impregnated with any cleaning material. Absolutely no cleaning materials should be used. This is particularly important for the plated models. It is advisable to regularly polish your watch with a soft cotton cloth. The watch is a precision mechanical instrument and should be treated as such. Adjusting the time or date, opening or closing the crown, should not be done roughly, but carefully.

TECHNICAL INFORMATION OF THE MULTI FUNCTION AUTOMATIC

- Miyota Multi Function Automatic movement
Cal. 9100 with shock absorber
- 26 jewels
- Reserve energy 42 hours,
with power reserve display
- Winding component runs on ball bearings with
28.800 A/h
- With day, date and month indicator
- Scratchproof sapphire crystal on the
back and the front
- 10 ATM water resistant
- Case and clasp: Solid stainless steel (316L)
- Sandblasted with PVD titanium coating

