

Ledvion

OUTDOOR - SOLAR LED LAMP

ART.NO. LVSI0012 - LVSI0013

Ledvion
Habraken 1205
5507 TB Veldhoven
The Netherlands
www.ledvion.com



**ULTRA-BRIGHT
4W 500LM**



Please follow all instructions to operate.
Save this manual for future reference.

Specification

Product Name	Solar LED Wall Light with Sensor
Power	4W
Brightness	500LM
Lamp Dimension	211.1*140*114.8mm
LEDs	SMD2835*56PCS (Front 54PCS+Back 2PCS)
Li-ion Battery	18650, 3.7V, 2000mAh, 7.4Wh (Replaceable)
Solar Panel	2.4W, DC5.5V, Mono with tempered glass
Working Modes	Two Optional Working Modes
Charging Time	12-15hrs to fully charge
Lighting Time	Sensor Mode: 35hrs+ (based on 300 times of detections) Keep Lighting Mode: 30hrs+ (based on 200 times of detections)
PIR Detection Angle/Distance	120°/ 2-6Mtrs
IP Degree	IP65 Waterproof
Housing Material	ABS+PC, anti-UV
Installation Height	2-4Mtrs
Working Temperature	-20~50°C
Storage Temperature	0~45°C
Warranty	24 months (battery 12 months warranty)
Packing	Colorbox (1*Solar Light, 1*Accessory Bag, 1* Measure Card, 1*User Manual)

Top Features

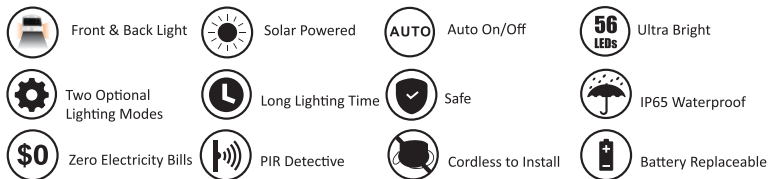

Installation

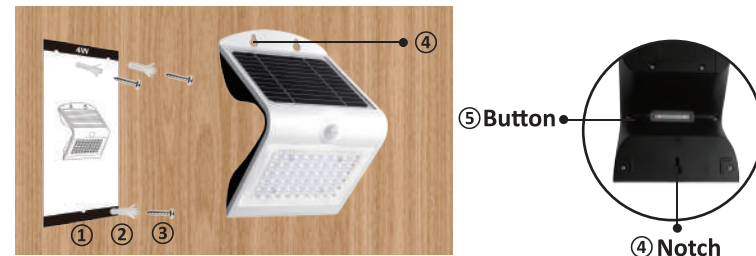

The recommended installation height is 2-4 meters.

- 1 Please use measure card to mark holing positions and drill 3 holes of $\phi 6\text{mm}$.
- 2 Install 3 expansion plugs into the holes.
- 3 Install 3 screws in the expansion plugs, allow the screws to protrude slightly.
- 4 Align the lower notch on the back of the light with the lower screw and align the holes at the top of the light with the upper screws to fix the light well.
- 5 Press the button on the back of the light to turn on the light and select desired working mode.

Packing Content

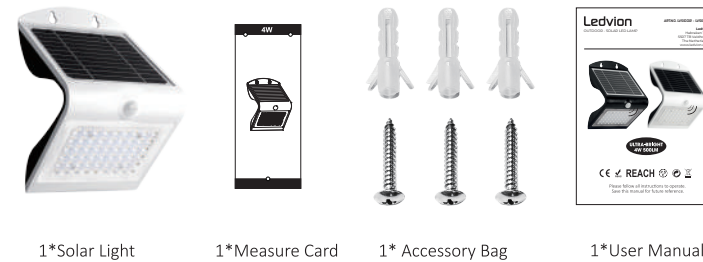

1*Solar Light

1*Measure Card

1* Accessory Bag

1*User Manual

Two Optional Working Modes

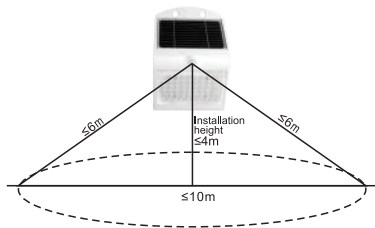
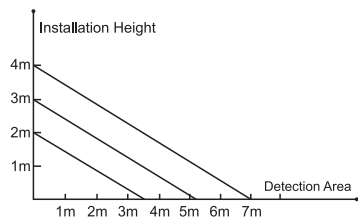

Mode A: Sensor Mode

Press the button 1st time, the back light flashes once, it's Sensor Mode:



When battery power is greater than 30%:

Lamp automatically lights up at night and turns to full brightness when motion is detected within the range of ≤6mtrs, then dims to lower brightness(front light and back light both on) after 20 seconds of no motion.

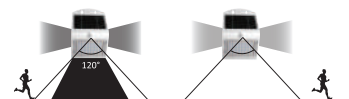

When battery power is less than 30%:

Lamp automatically lights up at night and turns to full brightness when motion is detected within the range of ≤6mtrs, then dims to lower brightness(front light off, only back light on) after 20 seconds of no motion.

Mode B: Keep Lighting Mode

Press the button 2nd time, the back light flashes twice, it's Keep Lighting Mode:

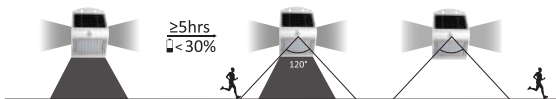

Lamp automatically lights up at dusk and remains 50% brightness.

After 5 hours or when the battery power is less than 30%, it turns to energy saving mode, which is lamp automatically turns to 50% brightness when motion is detected within the range of ≤6mtrs, then dims to lower brightness(front light off, only back light on) after 20 seconds of no motion.

Mode C: Off

Press the button 3rd time, lamp turns off.

Wide Applications

- ☑ Garden
- ☑ Pathway
- ☑ Parking Lot
- ☑ Holiday Resort
- ☑ School
- ☑ Scenic Area
- ☑ Square
- ☑ Villa
- ☑ Entrance
- ☑ Fence
- ☑ Courtyard
- ☑ Balcony
- ☑ Garage
- ☑ Swimming Pool
- ☑ Stairs
- ☑ Farm
- ☑ Pavilion
- ☑ Gate
- ☑ Community Area
- ☑ Patio
- ☑ Hotel

How to replace battery?

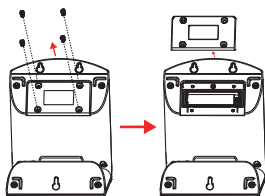

①

Loosen the screws, open battery cover.

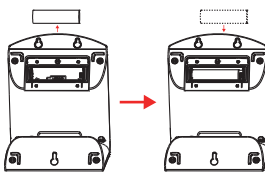

②

Remove old battery, change new battery and connect positive and negative electrode correctly. (18650, 3.7V, 2000mAh, 7.4Wh)

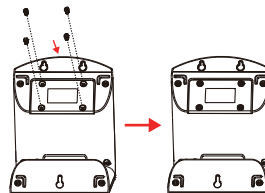

③

Then install back the cover, lock the screws.

Warnings

1. This is a solar powered lamp, please install it in a location where can get enough sunshine.
2. Please note the lighting time depends on sunshine duration & weather & working mode.
3. The lamp will light up automatically at dusk.
4. Built-in intelligent IC is with over-charge, over-discharge and over-voltage protection, safe and durable.
5. The lamp is equipped with an internal Li-ion battery, which is replaceable.
If any need, please contact seller for new battery(18650, 3.7V, 2000mAh, 7.4Wh).
6. If the battery is taken out and put back in or replaced with new ones, please toward the solar panel to sunshine or a strong light to activate the lamp.
7. Non-professionals please do not disassemble the lamp.
8. Please do not dispose the battery with household garbage to avoid explosion.