

V-1230

Releasable Instructions

1. Milling

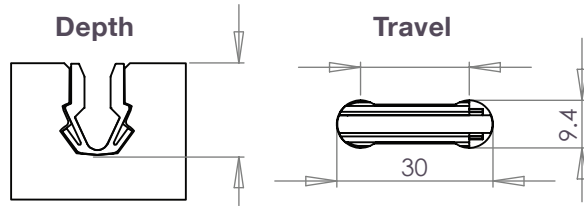
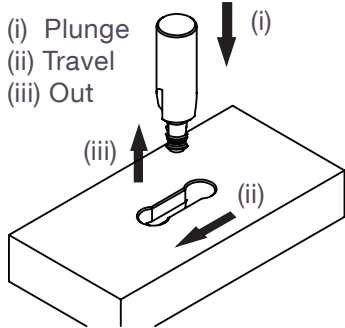

Recommended Spacing

- (a): 35mm to 80mm
- (b): 100mm to 250mm

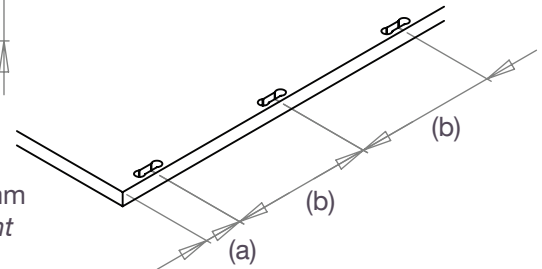

Recommended Settings

Depth: 12.5mm, +/- 0.5mm
Travel Centre to Centre: 20.5mm (min) - 20.7mm
Rotation Speed: CNC speeds vary with different materials. Maximum cutter rotation: 18,000

2. Housing

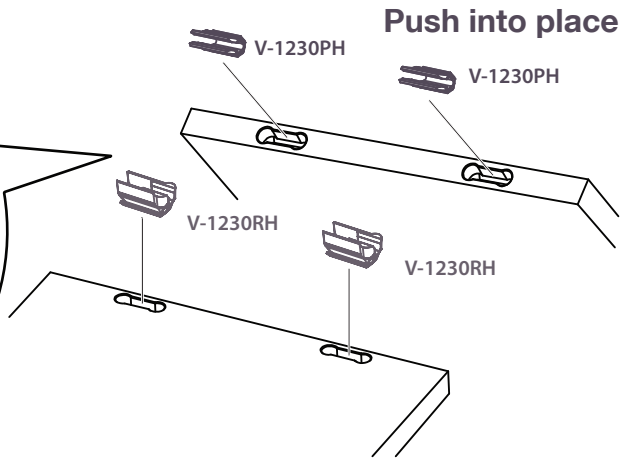
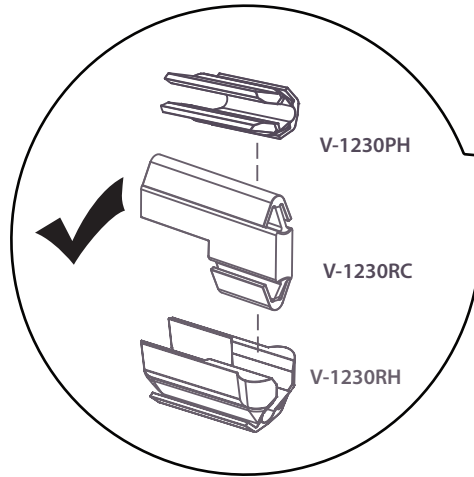
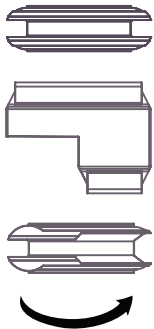

3. Assembly - Simply slide to connect

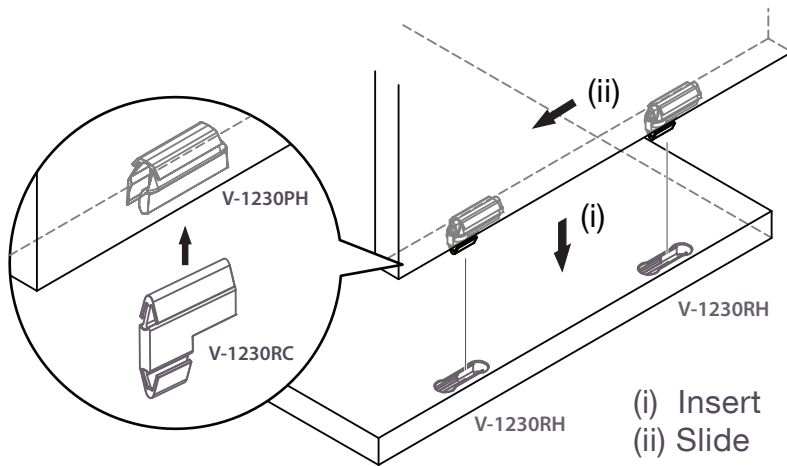

4. Release

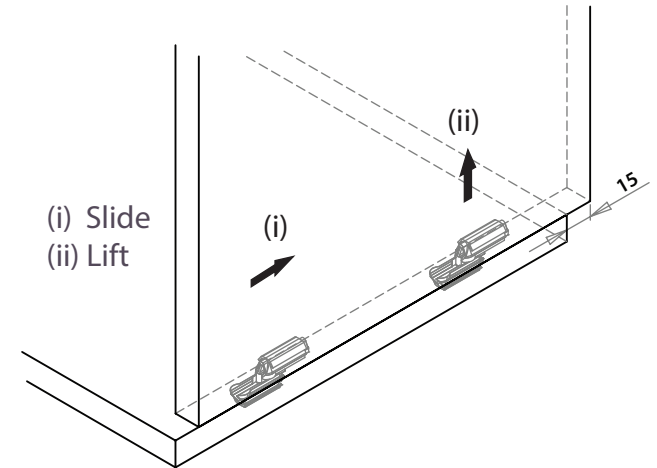

How it works

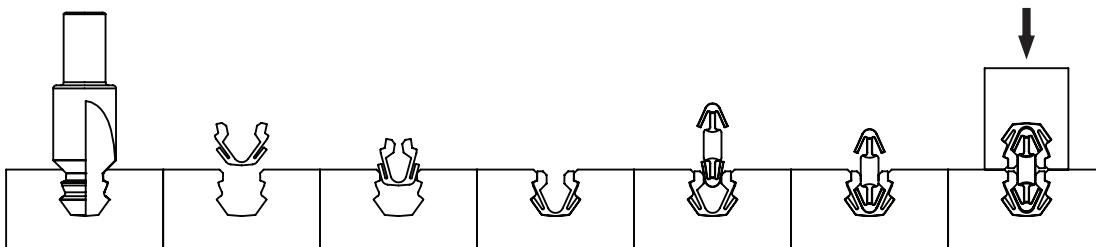

Simply slide to connect

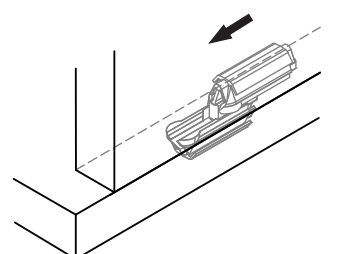

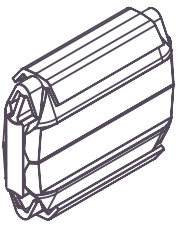

V-1230 Permanent Instructions

1. Milling

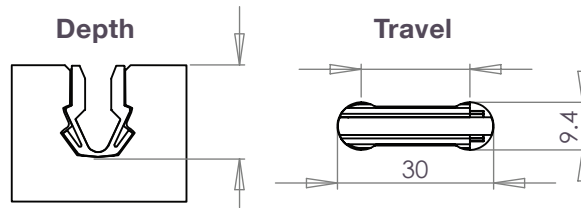
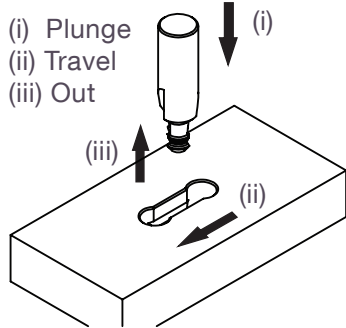

Recommended Spacing

- (a): 35mm to 80mm
- (b): 150mm to 350mm

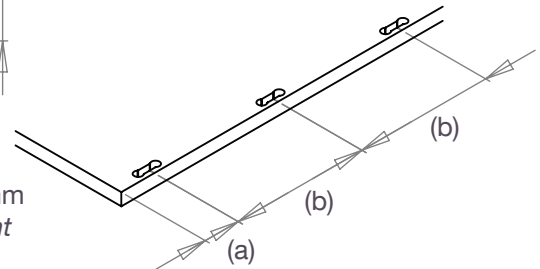

Recommended Settings

Depth: 12.5mm, +/- 0.5mm
Travel Centre to Centre: 20.5mm (min) - 20.7mm
Rotation Speed: CNC speeds vary with different materials. Maximum cutter rotation: 18,000

2. Housing

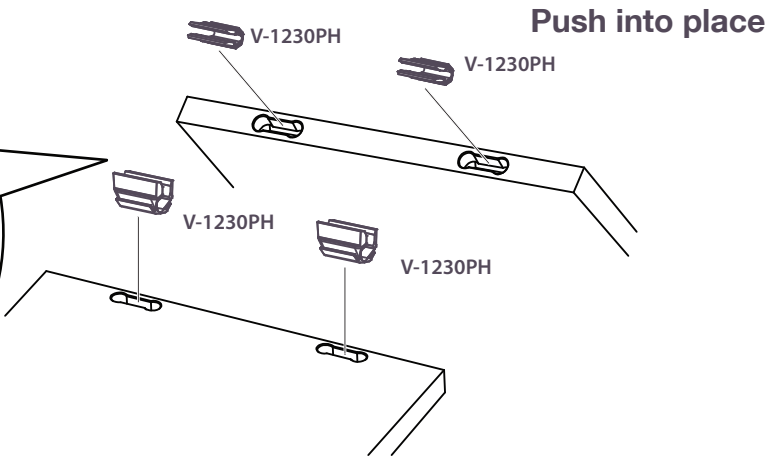
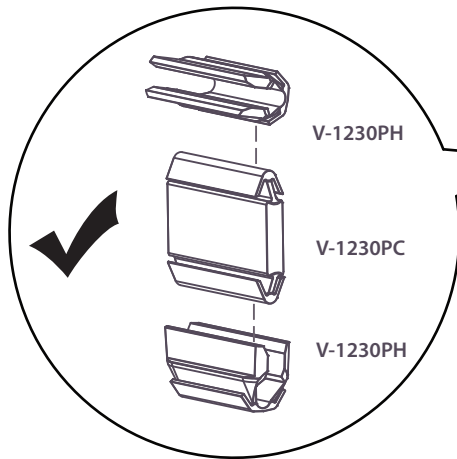

3. Assembly - Simply push into place to connect

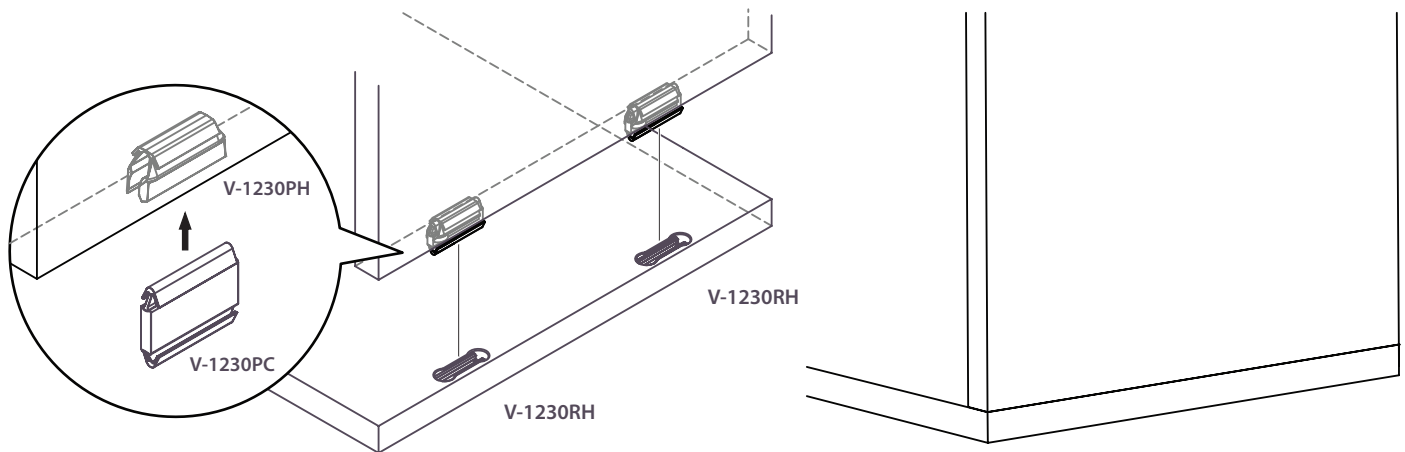

How it works

