

OVVO® V Connection System

V-1230 Permanent Specifications

V-1230 Permanent

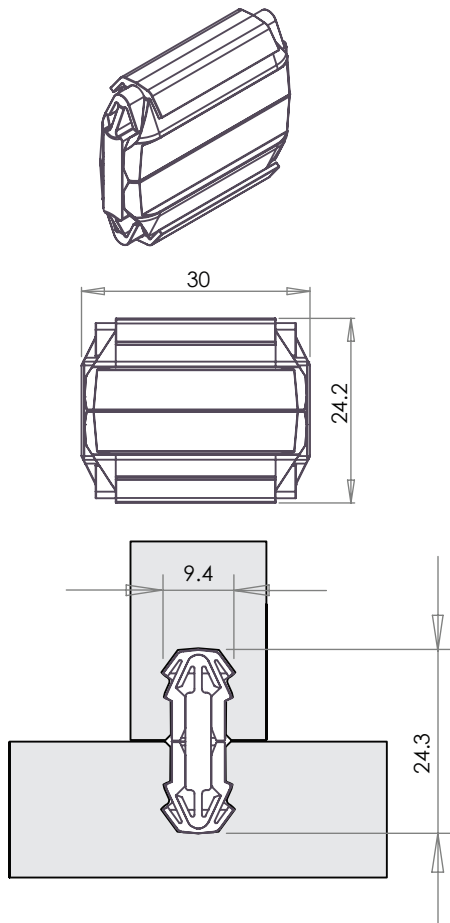

V-1230PH

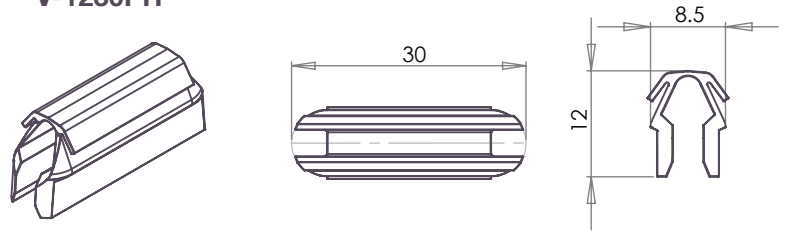

V-1230PC

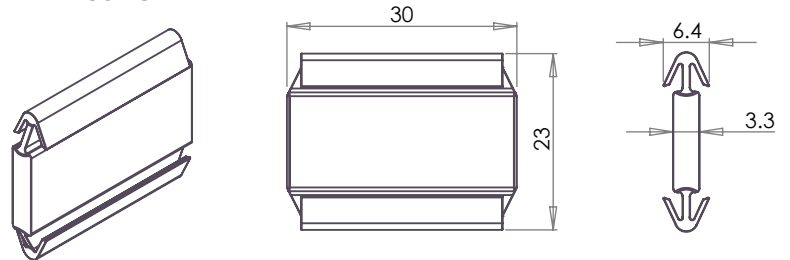

V-1230PH

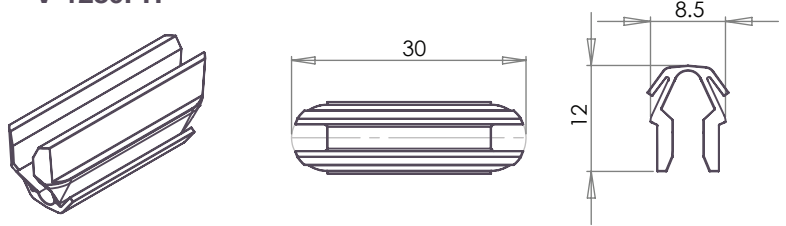

- (i) Plunge
- (ii) Travel
- (iii) Out

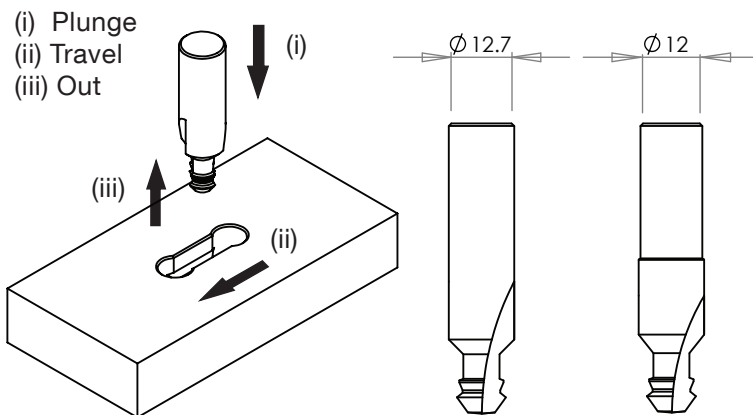

Depth

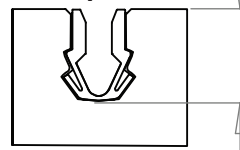

Travel

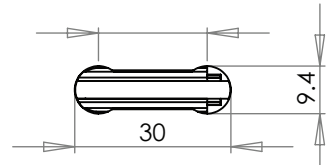

Recommended Settings

Depth: 12.5mm, +/- 0.5mm

Travel Centre to Centre: 20.5mm (min) - 20.7mm

Rotation Speed: CNC speeds vary with different materials. Maximum cutter rotation: 18,000

How it works

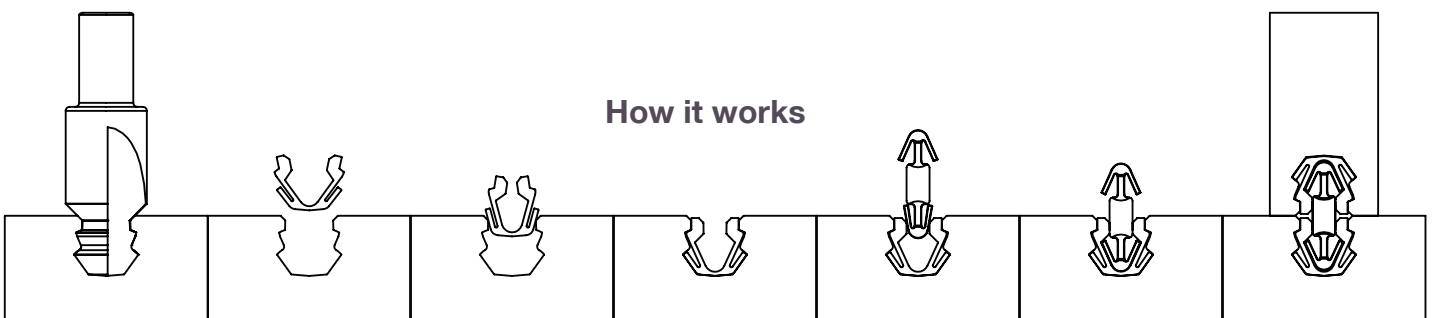

OVVO® V Connection System

V-1230 Releasable Specifications

V-1230 Releasable

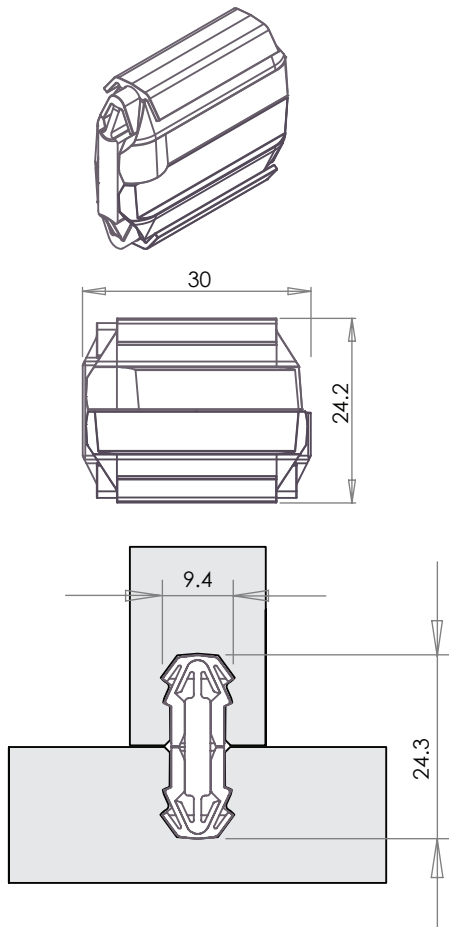

V-1230RH

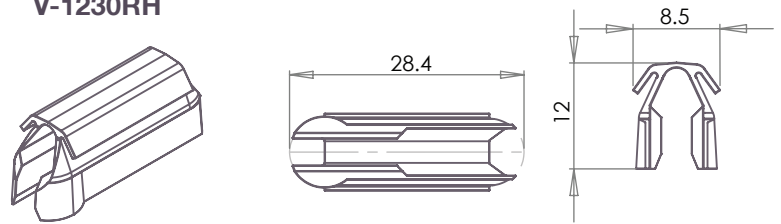

V-1230RC

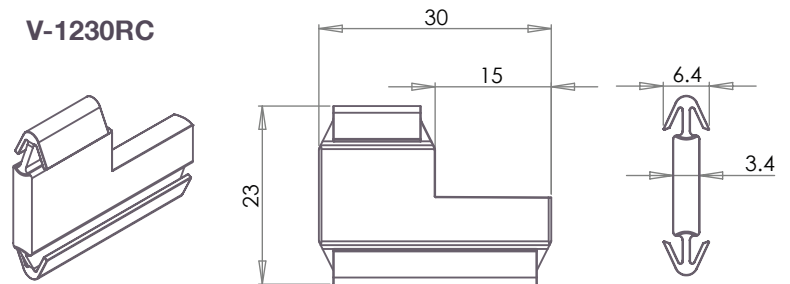

V-1230PH

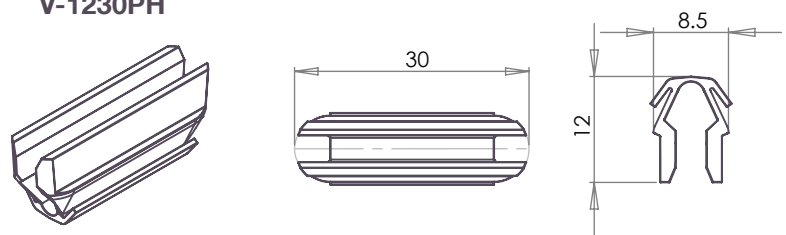

- (i) Plunge
- (ii) Travel
- (iii) Out

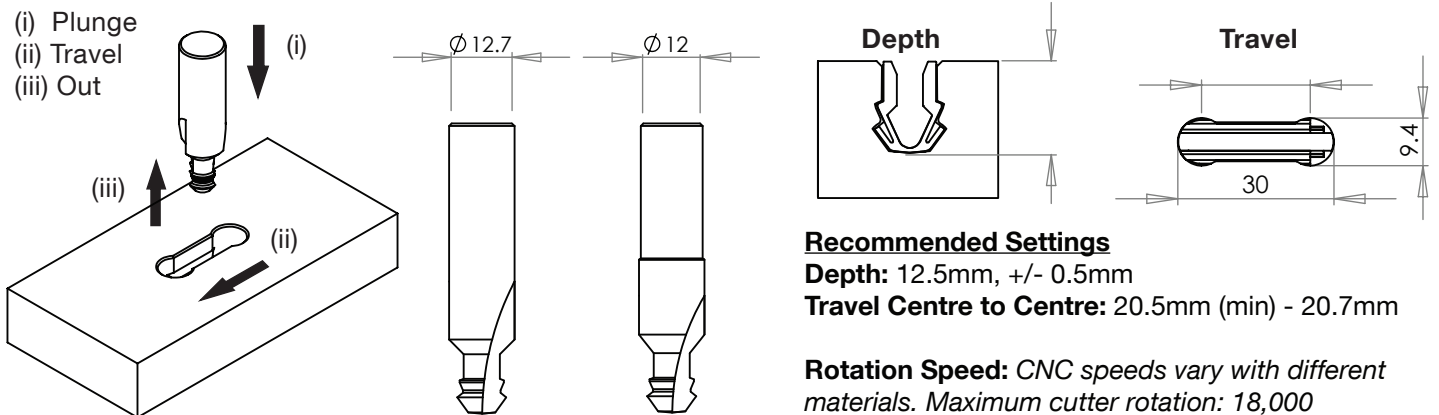

How it works

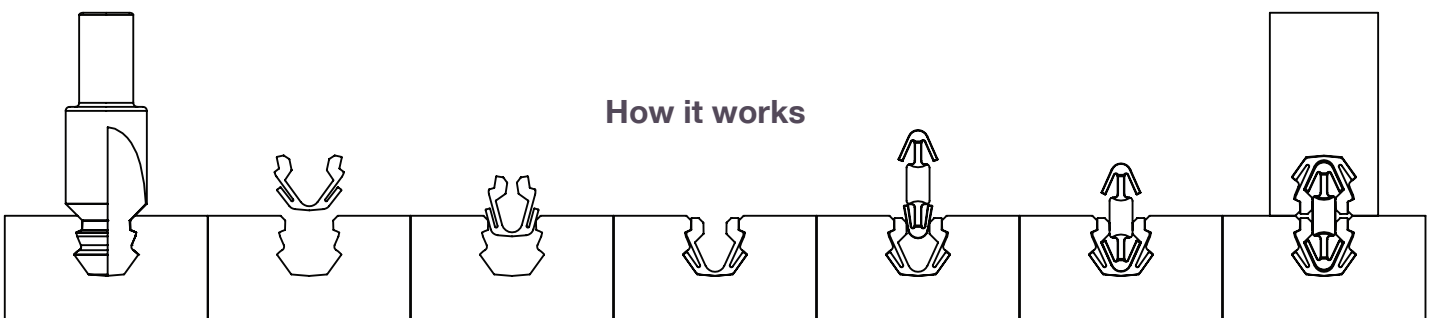

V-1230 Recommended Minimum Board Depth

Recommended minimum board depth or thickness values for the V-1230 will change depending on both the substrate material used as well as the joint angle.



Fig 1



Fig 2

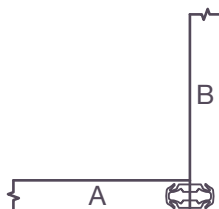

Fig 3

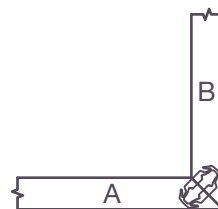

Fig 4

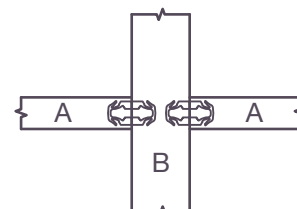

Fig 5

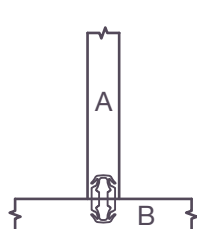

Fig 6

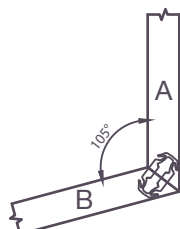

Fig 7

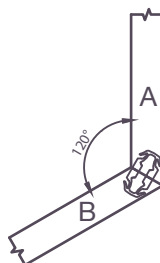

Fig 8

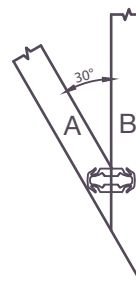

Fig 9

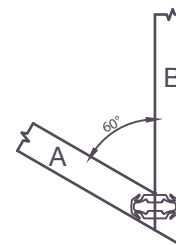

Fig 10

Minimum recommended measurements shown below are categorized according to two distinct groups of board material which share broadly similar connector retention properties.

| HPL, Composite, Solid Surface, Hardwoods, Birch Plywood | | |
|---|------|------|
| | A | B |
| Fig 1 | 12mm | 12mm |
| Fig 2 | 15mm | 15mm |
| Fig 3 | 12mm | 15mm |
| Fig 4 | 15mm | 15mm |
| Fig 5 | 12mm | 30mm |
| Fig 6 | 12mm | 15mm |
| Fig 7 | 16mm | 16mm |
| Fig 8 | 16mm | 16mm |
| Fig 9 | 16mm | 16mm |
| Fig 10 | 16mm | 16mm |

| Particle/Chipboard, Softwoods, MDF | | |
|------------------------------------|------|------|
| | A | B |
| Fig 1 | 15mm | 15mm |
| Fig 2 | 15mm | 15mm |
| Fig 3 | 15mm | 15mm |
| Fig 4 | 15mm | 15mm |
| Fig 5 | 15mm | 30mm |
| Fig 6 | 15mm | 15mm |
| Fig 7 | 16mm | 16mm |
| Fig 8 | 18mm | 18mm |
| Fig 9 | 16mm | 16mm |
| Fig 10 | 18mm | 18mm |

These are guidelines only and OVVO® recommends trial connections be made before going into full production.

OVVO® V Connection System

V-1230 Shear & Tensile

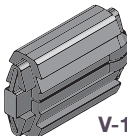
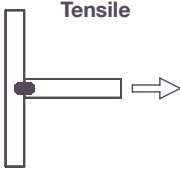
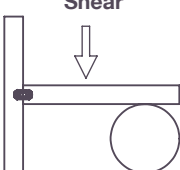
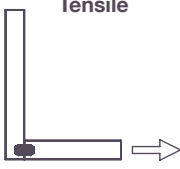
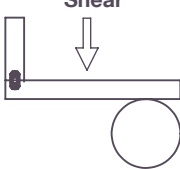
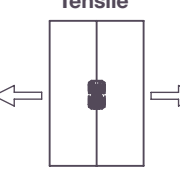
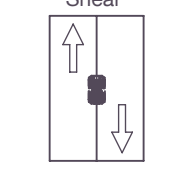
|  V-1230 | 18mm Chipboard | | 18mm MDF | | 18mm Plywood | | 12mm Plywood | | 12mm HPL | |
|---|----------------|------------|-----------|------------|--------------|------------|--------------|------------|-----------|------------|
| | Permanent | Releasable | Permanent | Releasable | Permanent | Releasable | Permanent | Releasable | Permanent | Releasable |
| Tensile  2 x V-1230 per test | 75kg | 62.5kg | 80kg | 50kg | 165kg | 100kg | 90kg | 69kg | - | - |
| Shear  2 x V-1230 per test | 180kg | 155kg | 210kg | 155kg | 570kg | 390kg | 200kg | 130kg | - | - |
| Tensile  2 x V-1230 per test | 47.5kg | 47.5kg | - | - | - | - | - | - | - | - |
| Shear  2 x V-1230 per test | 100kg | 100kg | - | - | - | - | - | - | - | - |
| Tensile  1 x V-1230 per test | 60kg | 35kg | 60kg | 40kg | - | - | 100kg | 50kg | 120kg | 60kg |
| Shear  1 x V-1230 per test | 125kg | 84kg | 165kg | 105kg | - | - | 200kg | 125kg | 275kg | 165kg |

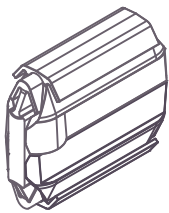

V-1230

Releasable Instructions

1. Milling

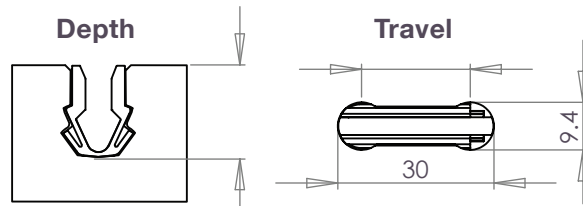
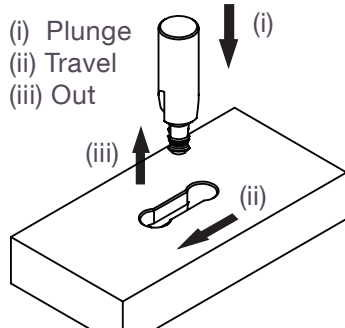

Recommended Settings

Depth: 12.5mm, +/- 0.5mm

Travel Centre to Centre: 20.5mm (min) - 20.7mm

Rotation Speed: CNC speeds vary with different materials. Maximum cutter rotation: 18,000

Recommended Spacing

(a): 35mm to 80mm

(b): 100mm to 250mm

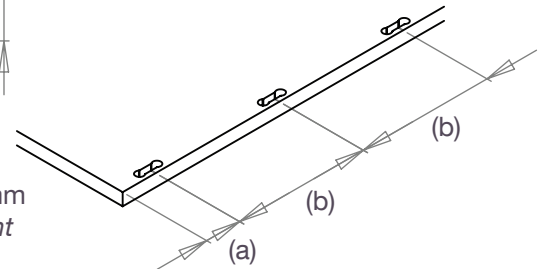

2. Housing

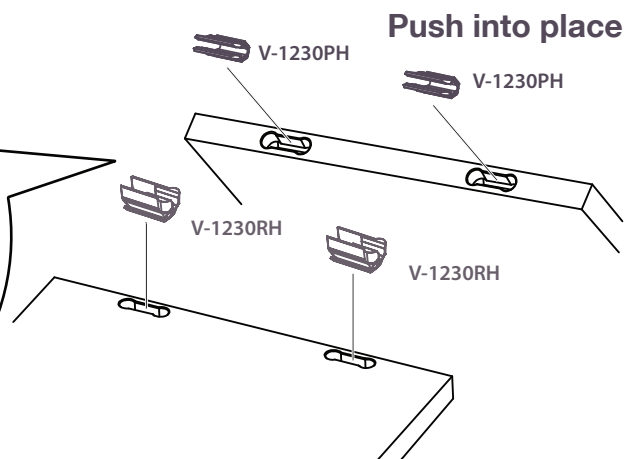
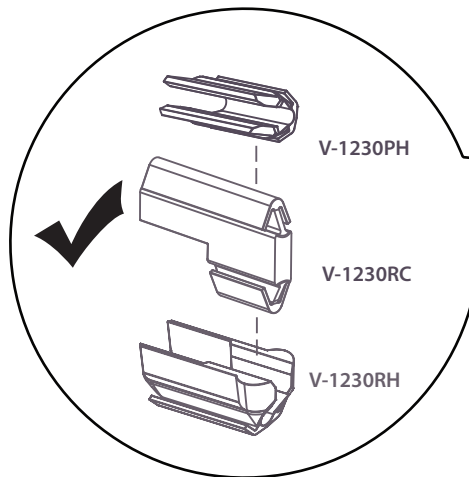
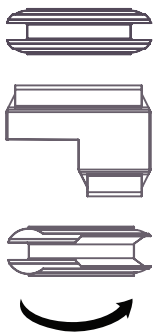

3. Assembly - Simply slide to connect

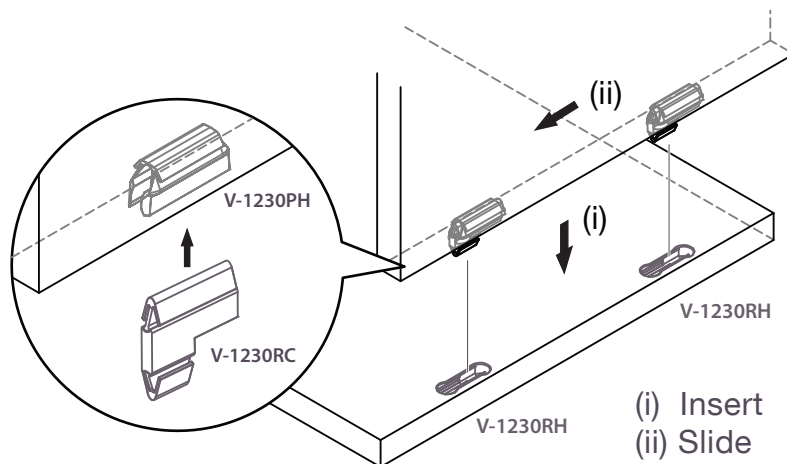

4. Release

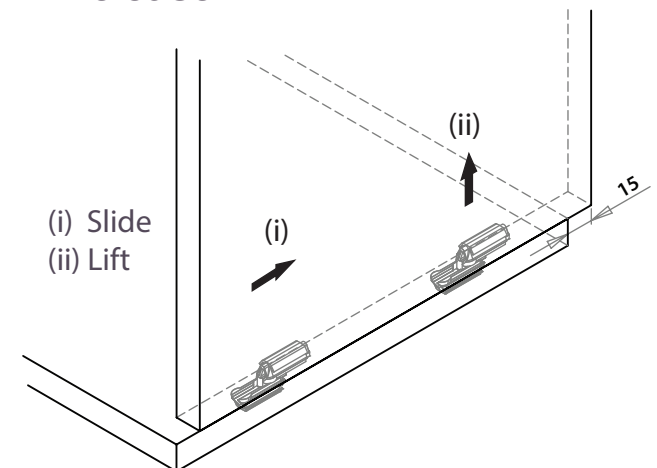

How it works

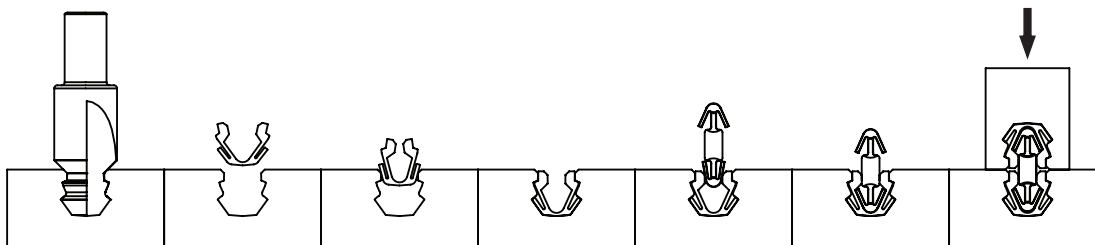

Simply slide to connect

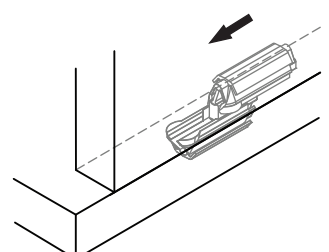

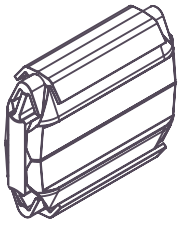

V-1230

Permanent Instructions

1. Milling

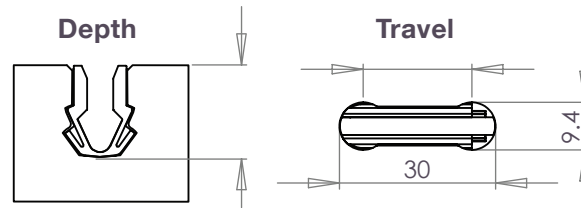
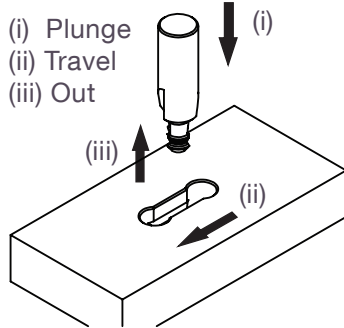

Recommended Settings
Depth: 12.5mm, +/- 0.5mm
Travel Centre to Centre: 20.5mm (min) - 20.7mm
Rotation Speed: CNC speeds vary with different materials. Maximum cutter rotation: 18,000

Recommended Spacing

- (a): 35mm to 80mm
- (b): 150mm to 350mm

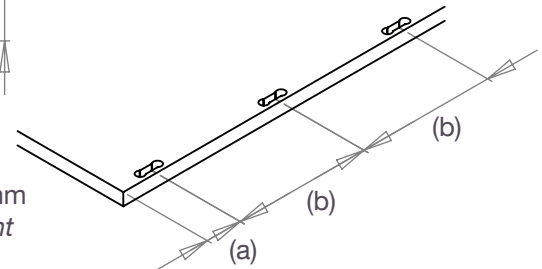

2. Housing

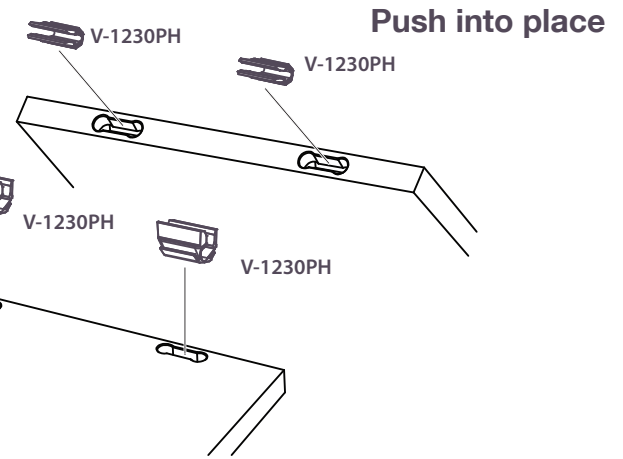
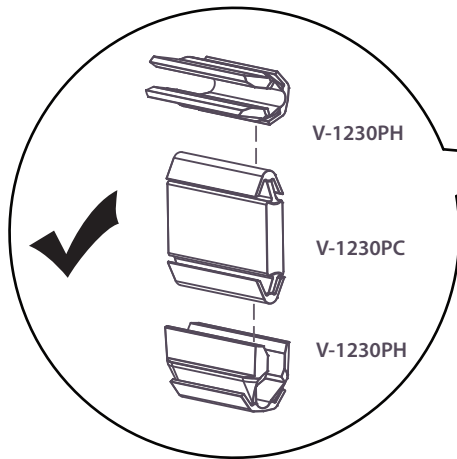

3. Assembly - Simply push into place to connect

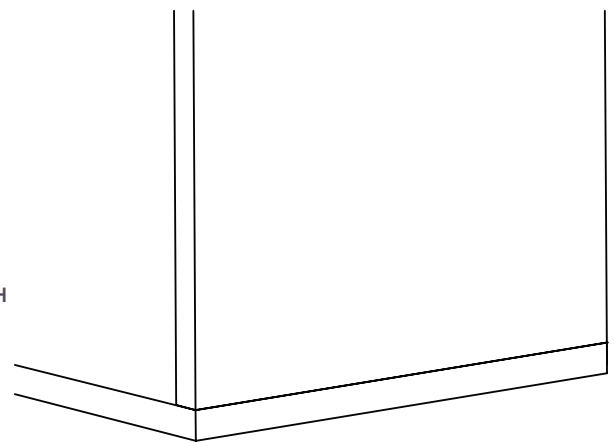
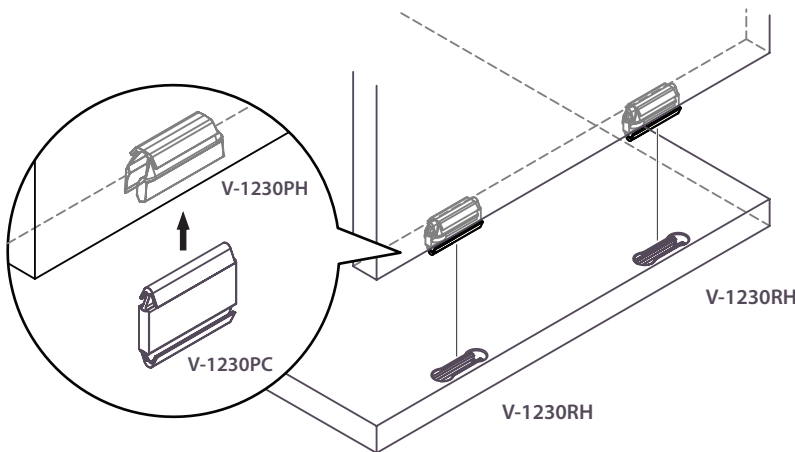

How it works

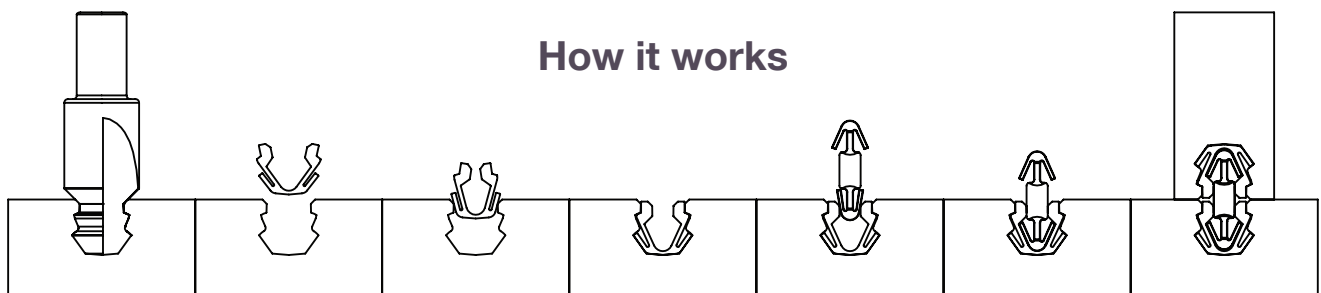

Important! Set Depth Correctly

OVVO® V-1230 Connection System



IMPORTANT! MAKE A TEST
WICHTIG! MACHEN SIE EINEN TEST
IMPORTANT! FAIRE UN TEST
IMPORTANTE! FARE UN TEST
IMPORTANTE! HACER UNA PRUEBA

RECOMMENDED DEPTH TOLERANCES

V-1230

12.5mm, +/- 0.5mm

Set the depth tolerance to 12.5mm and adjust +/- 0.5mm if required

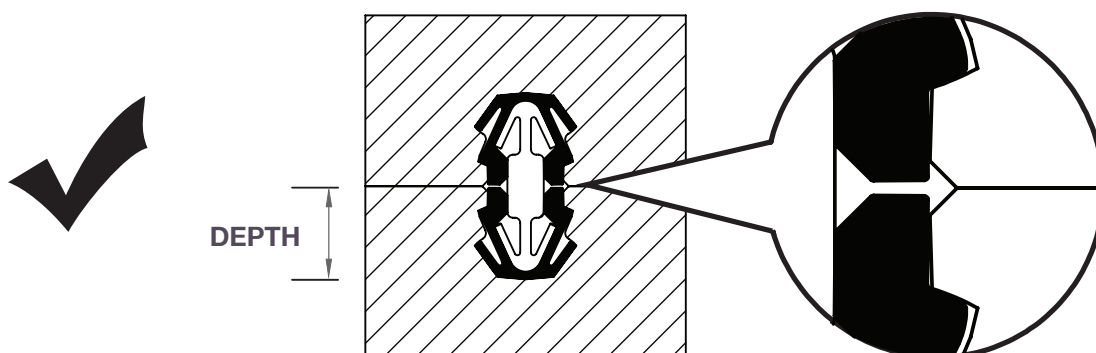

Less than 12mm will create an open joint

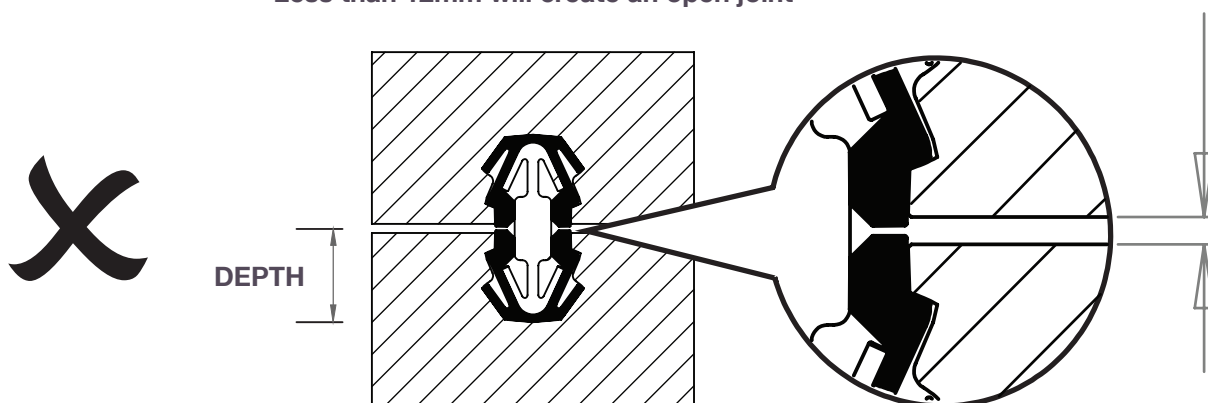

Greater than 13mm connector wing can not lock

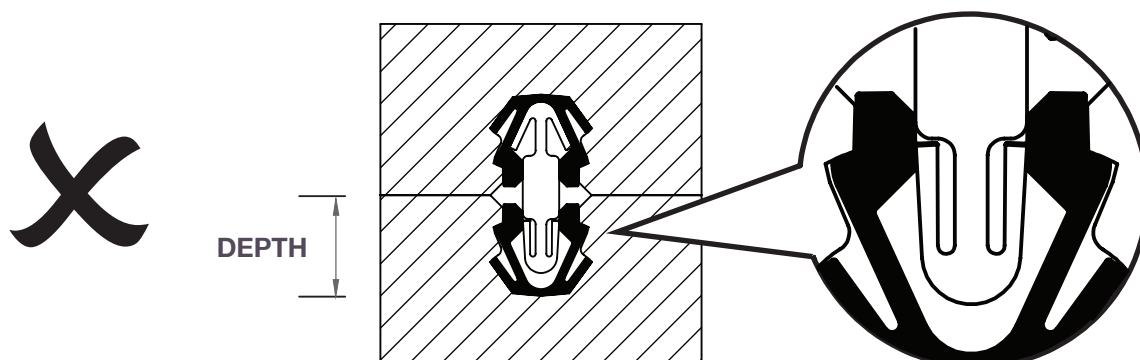

Depth Setting Guide

OVVO® V-1230 Connection System

1. Make a long cut with your tooling. Approximately 200mm long and 12.5mm depth

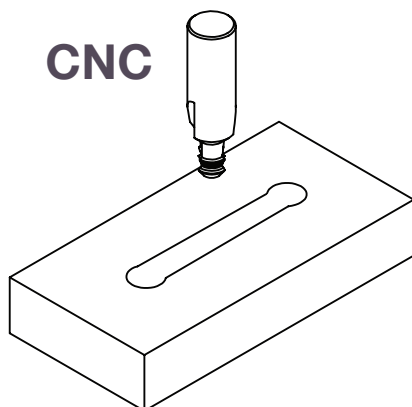

or

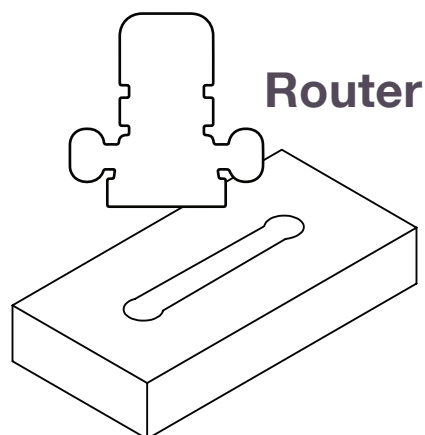

2. Cut in half

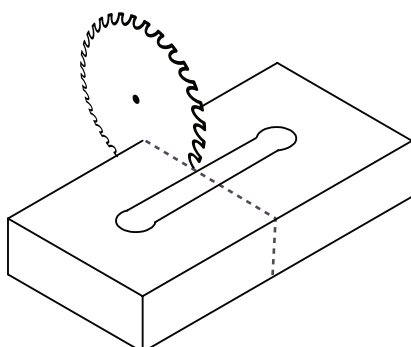

3. Insert Connection Set and check depth.

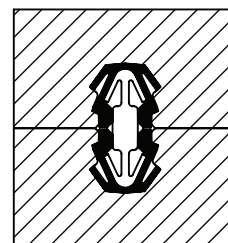

Depth incorrect

Open joint?
Increase depth.

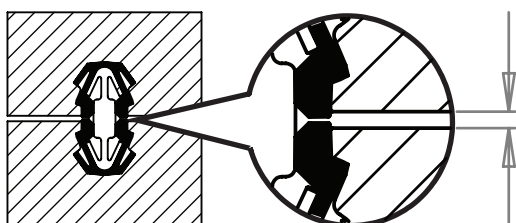

Wings not locking?
Reduce depth.

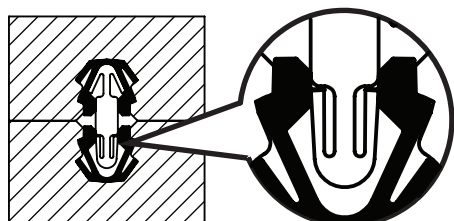

Depth correct

