

See Parts List for a complete listing of optional accessories.

Specifications on this page are subject to change without notice. Every attempt has been made to ensure the accuracy of this drawing; however, Traxxas cannot be held responsible for typographical or other errors.

# SLASH 4x4

## Front Assembly

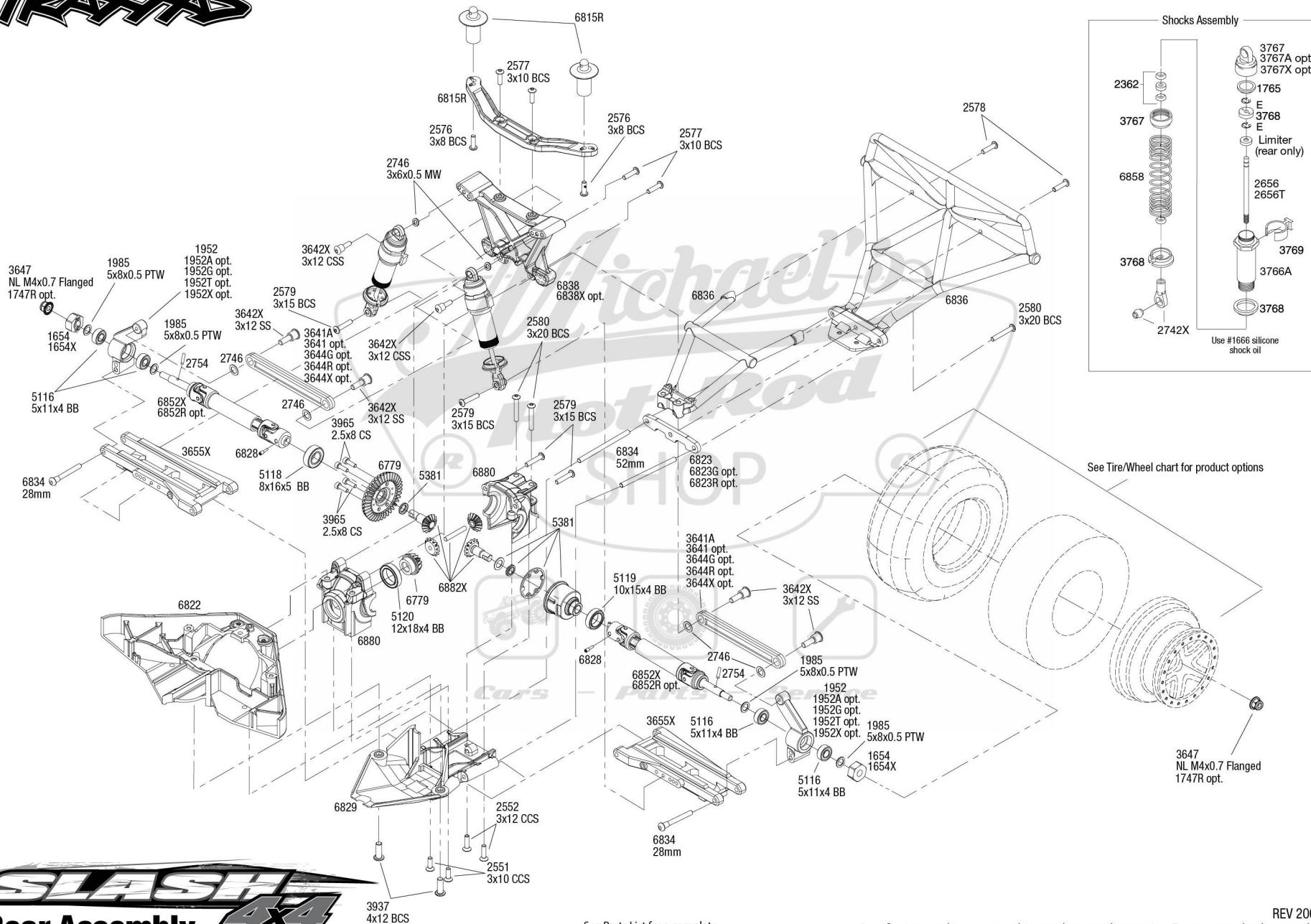



# SLASH 4x4

## Wheel and Tire Chart

### TRAXXAS

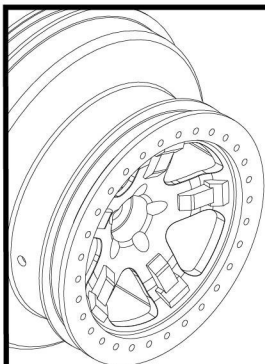

**Traxxas SCT Wheels**

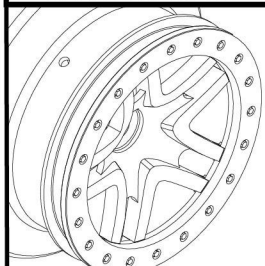

**Split Spoke Wheels**

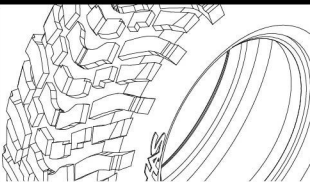
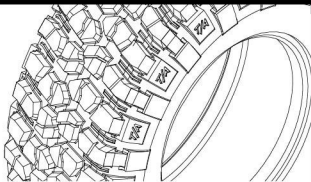
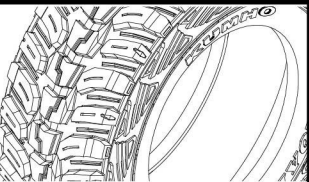
			 Traxxas SCT Tires with Foam Inserts		 BFGoodrich® Mud Terrain™ T/A® Tires with Foam Inserts		 Kumho Road Venture MT tires with Foam Inserts	
			5871	S1 Ultra-Soft Racing Compound 5871R	6871	S1 Ultra-Soft Racing Compound 6871R	6870	S1 Ultra-Soft Racing Compound 6870R
Wheels*			Assembled Wheels and Tires		Assembled Wheels and Tires		Assembled Wheels and Tires	
Traxxas SCT Wheels	Satin Beadlock/ Satin Wheel - Slash Rear or Slash 4x4 Front/Rear	5872	5873†	-	-	-	-	-
	Satin Beadlock/ Satin Wheel - Slash Front	5874	5875	-	-	-	-	-
	Red Beadlock/ Satin Wheel - Slash Rear or Slash 4x4 Front/Rear	5872A	5873A	5873R	-	-	-	-
	Red Beadlock/ Satin Wheel - Slash Front	5874A	5875A	5875R	-	-	-	-
	Black Beadlock/ Satin Wheel - Slash Rear or Slash 4x4 Front/Rear	5872X	5873X	-	5878	-	5880X	-
	Black Beadlock/ Satin Wheel - Slash Front	5874X	5875X	-	5879	-	5881X	-
	Red Beadlock/ Chrome Wheel - Slash Rear or Slash 4x4 Front/Rear	5868	-	-	5867	-	-	-
	Red Beadlock/ Chrome Wheel - Slash Front	5870	-	-	5869	-	-	-
	Green Beadlock/ Chrome Wheel - Slash Front	5866	-	-	5865	-	-	-
	Green Beadlock/ Chrome Wheel - Slash Rear or Slash 4x4 Front/Rear	6875	-	-	6876	-	-	-
Split Spoke Wheels	Orange Beadlock/ Black Wheel - Slash Front	5870X	5864	-	-	-	-	-
	Orange Beadlock/ Black Wheel -Slash Rear or Slash 4x4 Front/Rear	5868X	5863†	-	-	-	-	-
	Black Beadlock/ Satin Wheel - Slash Rear or Slash 4x4 Front/Rear	6872	-	-	6873†	6873X	6874	6874R
	Black Beadlock/ Satin Wheel - Slash Front	5876	-	-	5877	-	5882	5882R
	Red Beadlock/ Chrome Wheel - Slash Rear or Slash 4x4 Front/Rear	6872A	-	-	6873A	6873R	-	-
	Red Beadlock/ Chrome Wheel - Slash Front	5876A	-	-	5877A	5877R	-	-
	Green Beadlock/ Chrome Wheel - Slash Rear or Slash 4x4 Front/Rear Front	6872X	-	-	-	-	-	-
	Satin Beadlock/ Black Wheel - Slash Front	5886	-	-	5885	-	-	-
	Satin Beadlock/ Black Wheel - Slash Rear or Slash 4x4 Front/Rear	5884	-	-	5883	-	-	-
	Blue Beadlock/ Black Wheel - Slash Front	5886A	-	-	5885A	-	-	-
	Blue Beadlock/ Black Wheel - Slash Rear or Slash 4x4 Front/Rear	5884A	-	-	5883A	-	-	-

\* Wheels and/or tires sold in pairs  
†TSM rated



# Transmission Assembly

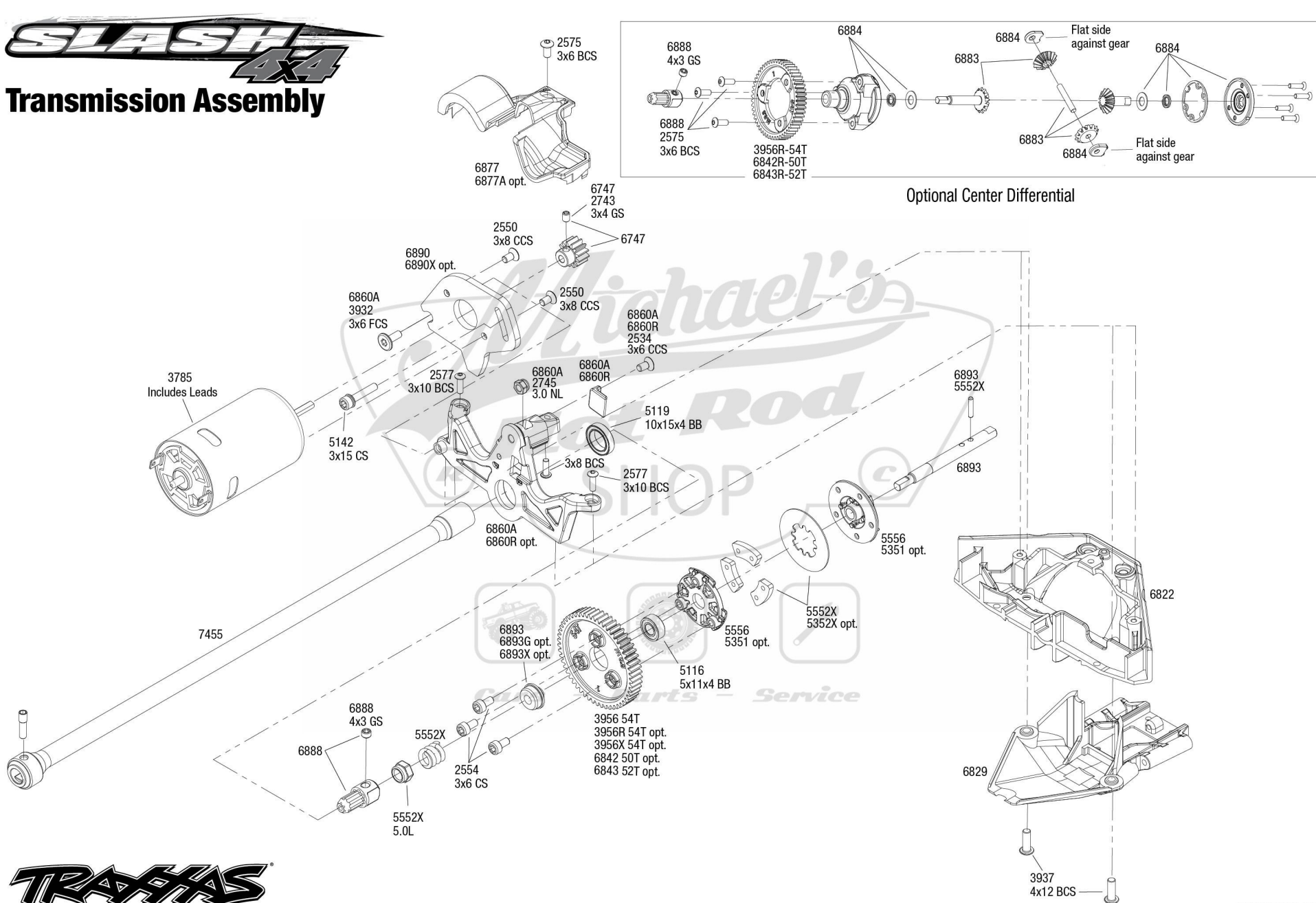

Optional Center Differential



See Parts List for a complete listing of optional accessories.

REV 200807-R09  
Specifications on this page are subject to change without notice. Every attempt has been made to ensure the accuracy of this drawing; however, Traxxas cannot be held responsible for typographical or other errors.

# SLASH 4x4

## Chassis Assembly

TRAXXAS

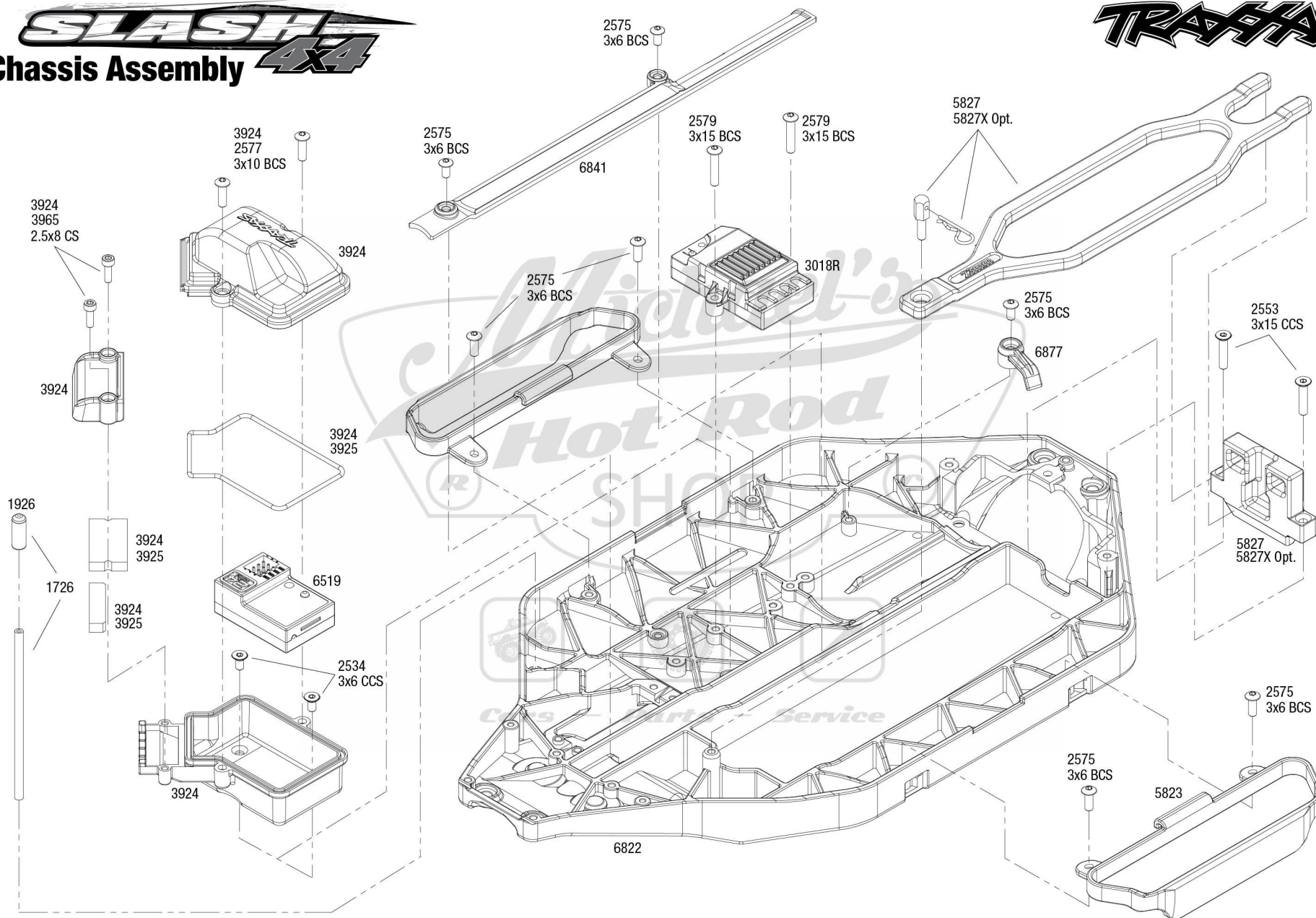

Specifications on this page are subject to change without notice. Every attempt has been made to ensure the accuracy of this drawing; however, Traxxas cannot be held responsible for typographical or other errors.

See Parts List for a complete listing of optional accessories.

REV 200807-R09



**Rear Driveshaft Assembly**  
Available fully assembled as part #6852X

This diagram illustrates the components of a rear driveshaft assembly. The parts are labeled as follows:

- 6828X**: A small pin or bolt used to secure the yoke.
- 6850X**: A yoke or flange component that connects to the axle.
- 6850X**: A universal joint (U-joint) component.
- 6850X**: The main driveshaft tube.
- 6850X**: A second universal joint (U-joint) component.
- 6853X**: A pin or bolt used to secure the second yoke.

The diagram shows the assembly of these components into a complete rear driveshaft unit.

**Front Driveshaft Assembly**  
Available fully assembled as part #6851X

This diagram illustrates the exploded view of the front driveshaft assembly. The components are labeled as follows:

- 6828X**: A small pin or bolt used to secure the yoke.
- 6850X**: The main driveshaft tube, shown in two sections.
- 6854X**: A component, likely a yoke or flange, used to connect the driveshaft to the axle.

The diagram shows the assembly sequence, with the driveshaft tube (6850X) being inserted into the yoke (6854X) and secured with the pin (6828X).

# SLASH 4x4