

## Link Dimensions

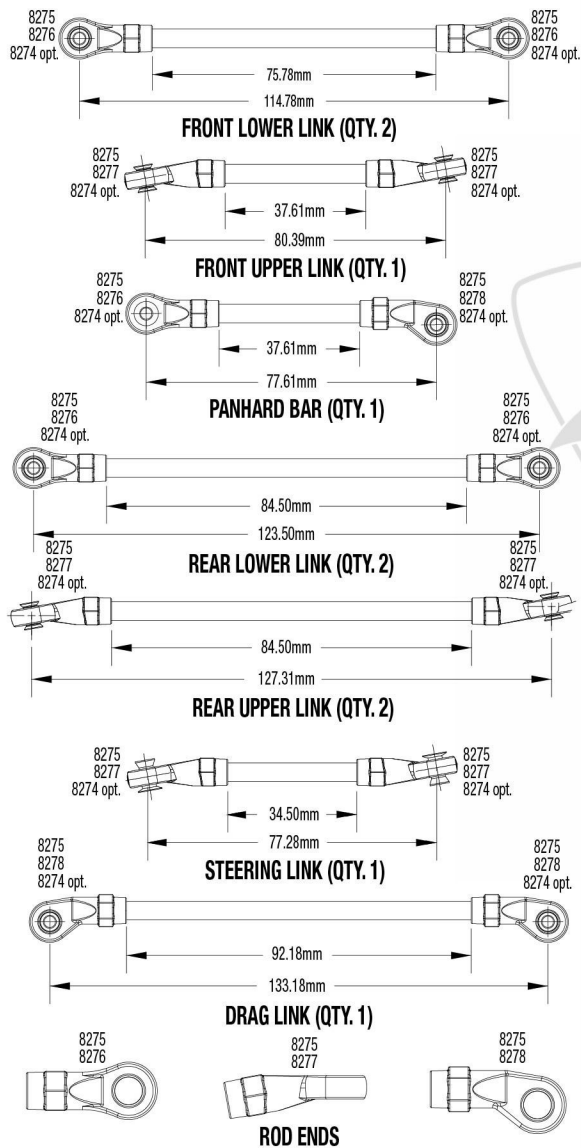

For standard hollow ball replacement, use part #5349.

## Modular Assembly

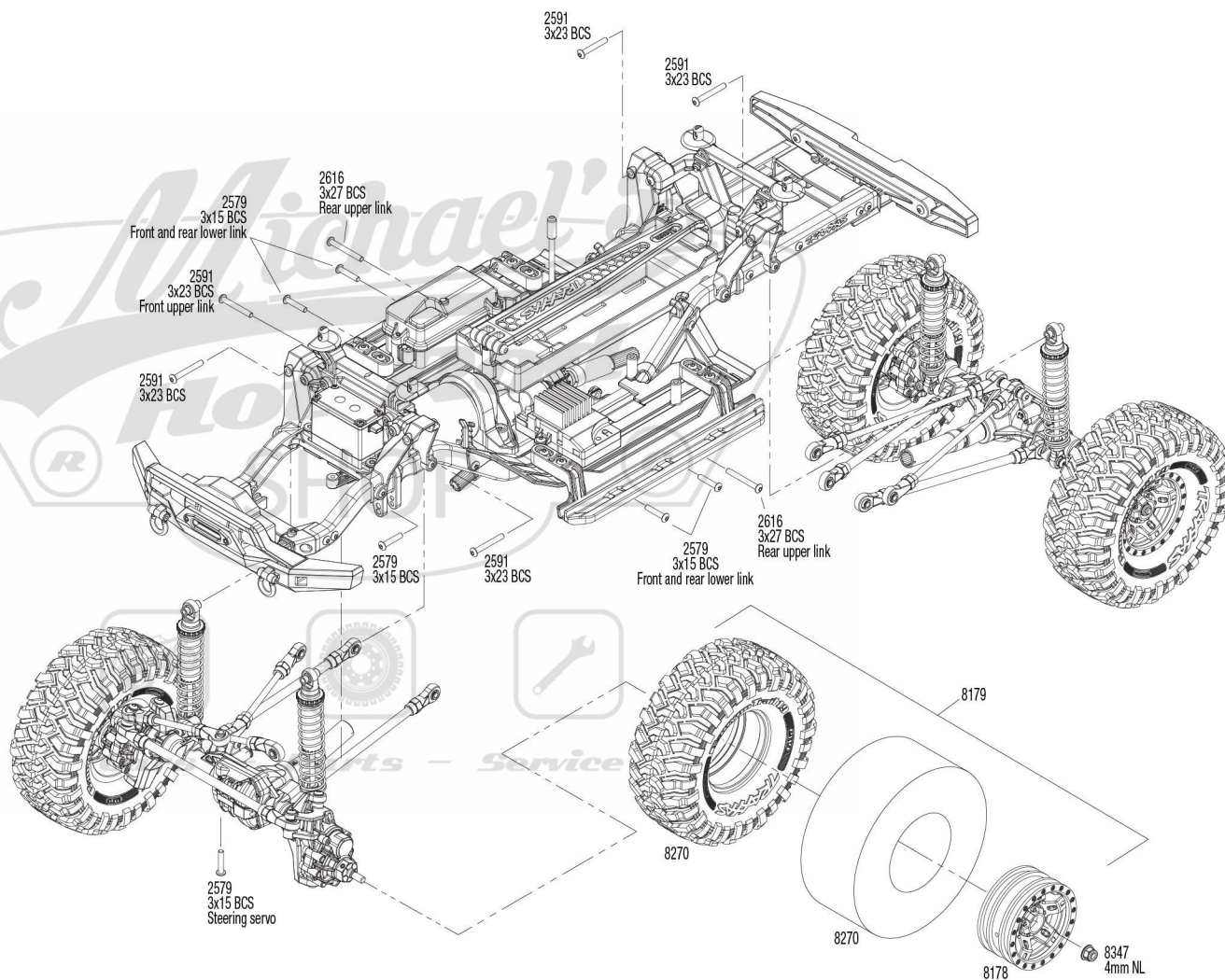

See Parts List for a complete listing of optional accessories.

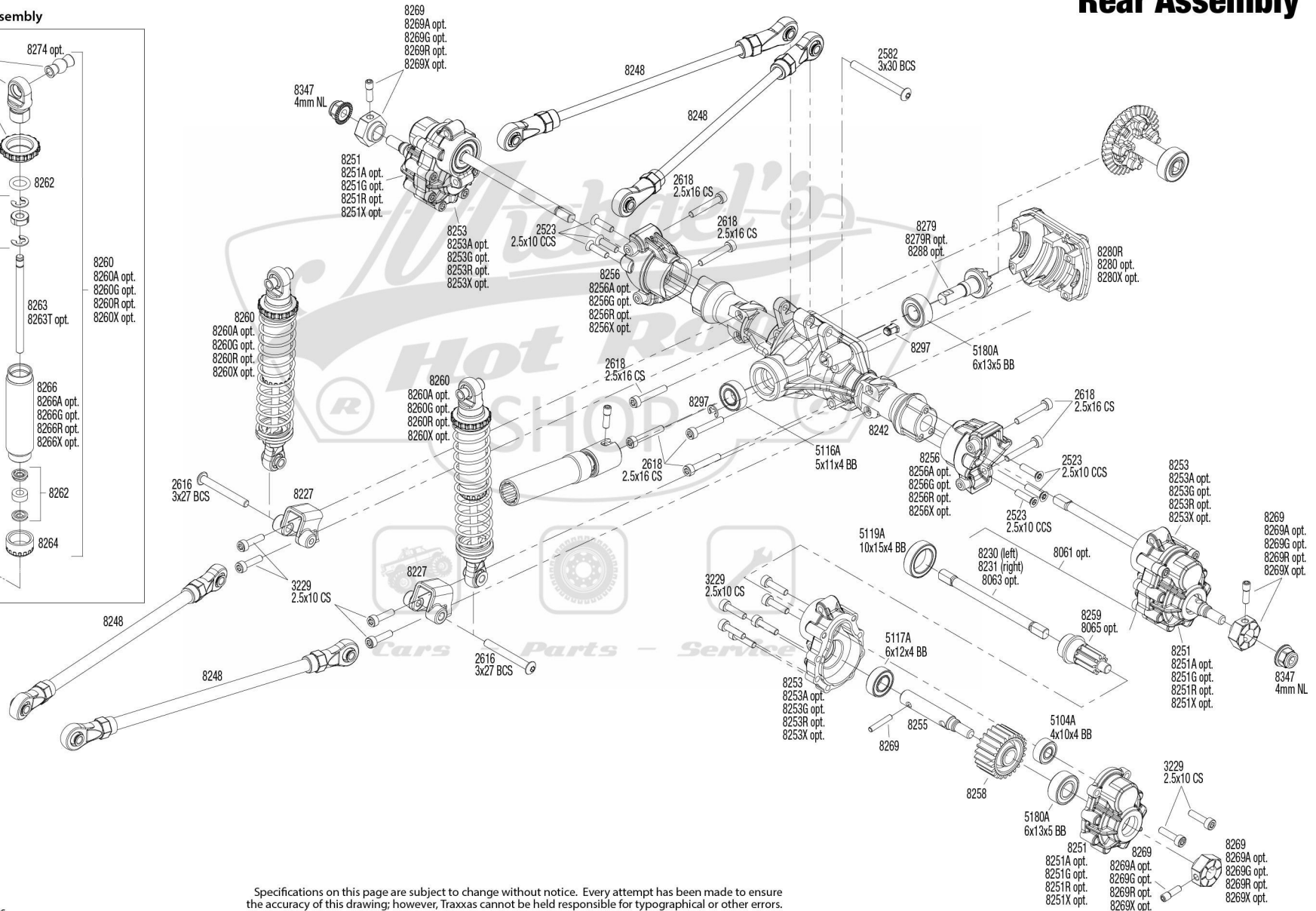



Optional Two-Speed Transmission Conversion Kit available as part #8196



## Transmission Assembly

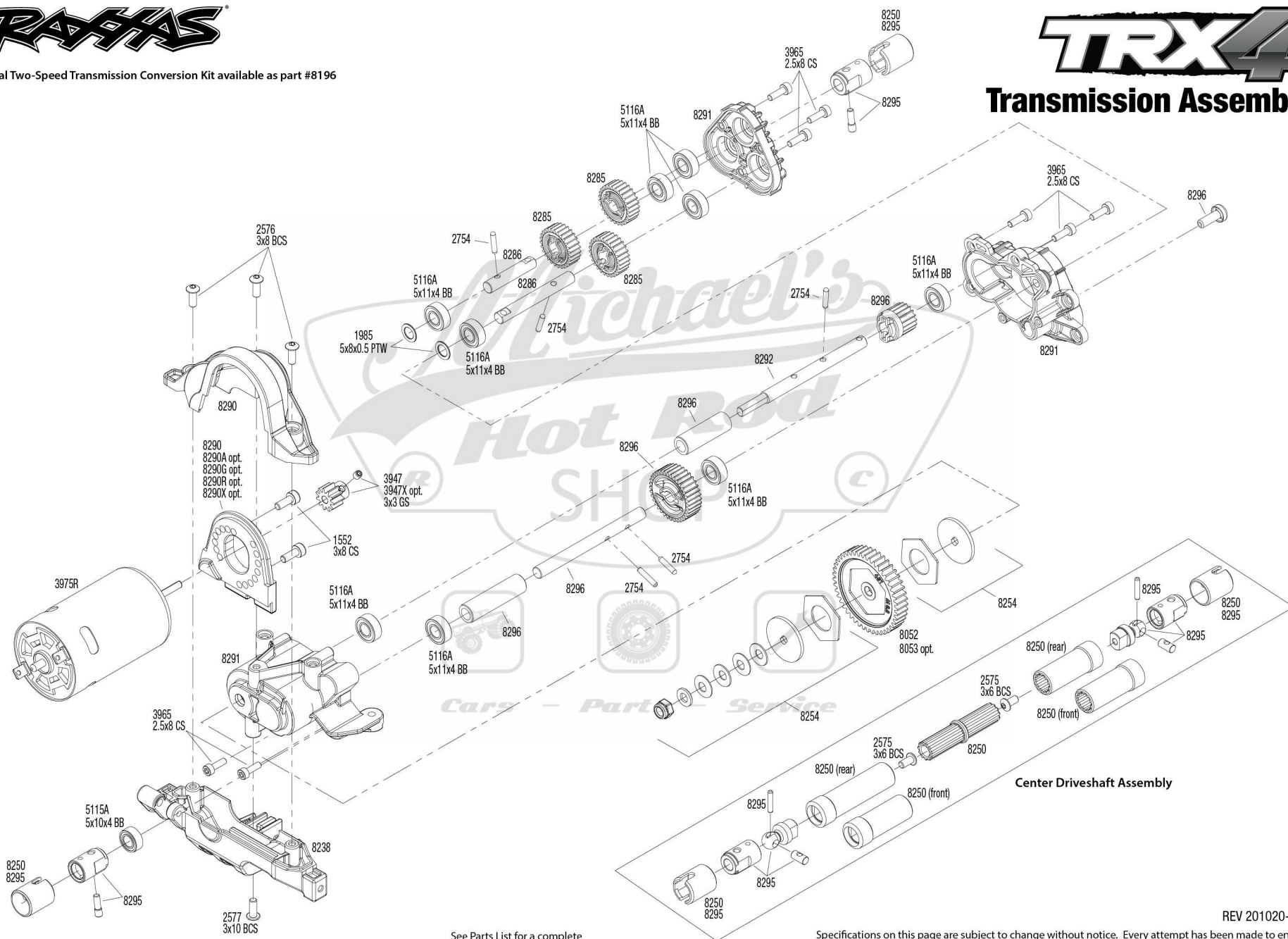

See Parts List for a complete listing of optional accessories.

Specifications on this page are subject to change without notice. Every attempt has been made to ensure the accuracy of this drawing; however, Traxxas cannot be held responsible for typographical or other errors.

REV 201020-R13





# TRX4

## Front Assembly

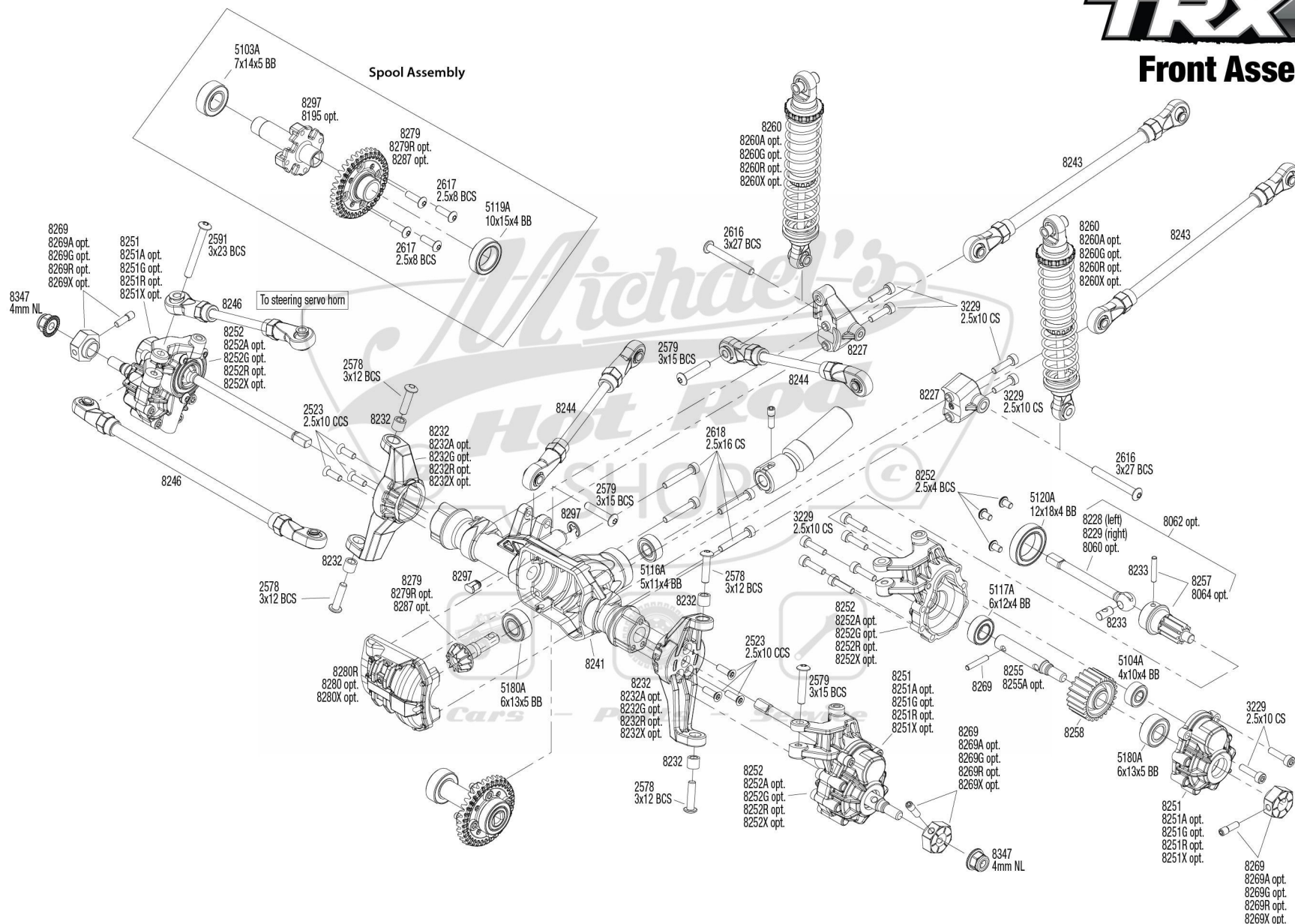

**TRAXXAS**

See Parts List for a complete listing of optional accessories.

Specifications on this page are subject to change without notice. Every attempt has been made to ensure the accuracy of this drawing; however, Traxxas cannot be held responsible for typographical or other errors.

REV 201020-R13