



Versatile manual backpack sprayer with 16 and 20 litre capacity respectively. It includes a selection of nozzles that allows different types of application. Sprayer suitable for use in large gardens.



Advantages

- Robust and resistant stainless steel lance.
- Greater strength and performance to agrochemicals thanks to the robustness of the seal and the stainless steel handle.
- Maintenance without tools.
- Homogeneous treatment thanks to the pressure regulator.
- Possibility of mixing inside the tank thanks to the translucent liquid level indicator.
- Ambidextrous and lightweight keeping the ergonomics.
- Suitable for application of products of natural origin (pelargonicon, acetic, etc...).



Functional information



Stainless steel handle

3-position pressure regulator

Ergonomic and robust clamping nut

Lance/lever support

Integrated system to release the cylinder without emptying

Reinforced chamber with FPM retainer for intensive use

Integrated and comfortable transport handle

Stainless steel lance

Large filling opening

Translucent liquid level indicator

Adjustable padded straps

Technical information

Technical information	EVOLUTION 16 AGRO	EVOLUTION 20 AGRO
HOSE	1,3 m (PVC)	
STANDARD NOZZLES	Metallic adjustable conical	
LANCE	Stainless steel	
USABLE CAPACITY	16 L	20 L
TOTAL CAPACITY	17,7 L	21 L
LITRES/MIN. 1,5 BAR	0,7 l/min	
LITRES/MIN. 3 BAR	1 l/min	
NET WEIGHT	3,62 Kg	3,79 Kg
INTEGRATED SYSTEM TO RELEASE THE CYLINDER WITHOUT EMPTYING	YES	
WIDE FILLER OPENING	YES	
SET OF NOZZLES FOR HERBICIDE AND INSECTICIDE TREATMENTS	YES	
REINFORCED PRESSURE CHAMBER	YES	
TRANSLUCENT LEVEL INDICATOR	YES	
STANDARD ACCESSORIES	Pressure regulator, set of nozzles (herbicide elbow plus fan, mirror and disc nozzles), two seals (1 rubber and 1 synthetic) and a dispenser	
LANCE AND EXTENSIONS	Lance/Lever	
STRAPS	Adjustable and padded	
CHAMBER SEAL	FPM	
PRESSURE REGULATOR	YES (3 positions)	
HANDLE	Stainless steel	

Logistics data

Logistics Data	EVOLUTION 16 AGRO	EVOLUTION 20 AGRO
CODE	8.49.46	8.49.45
EAN	84.14685.20106.5	84.14685.20108.9
CONDITIONING	1 unit	
UNITS PER PALLET	18 units	14 units
DIMENSIONS PER PALLET	1200 X 800 X 1180	1200 X 800 X 1020

MAINTENANCE KITS



PR MAINTENANCE KIT
Reference 8.39.41.870
Keep your sprayer at peak performance. Designed for 12-20 L sprayers.

ROUND SEAL AN-8 No. 101	2.23.15.908	
STAINLESS STEEL BALL Ø 12 No. 119	2.20.08.902	
VITON SEAL No. 120	8.39.11.305	
ROUND SEAL AN-5 No. 136	2.23.15.905	
CHAMBER VALVE No. 365	8.39.41.303	
FILTER WASHER No. 1034	8.49.41.410	



ACCESSORIES

Personalize your sprayer adapting it to your application needs (height, hard-to-reach areas...)



3.2 M TELESCOPIC LANCE
Reference 8.35.40.913
5.4 M TELESCOPIC LANCE
Reference 8.35.40.915



4-HOLE NOZZLE
Reference 8.34.46.801

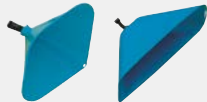

CONICAL HOOD
Reference 8.34.40.872
RECTANGULAR HOOD
Reference 8.34.40.871

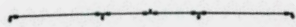

QUADRUPLE BOOM
Reference 8.34.60.870



DOUBLE ADJUSTABLE NOZZLE
Reference 8.34.46.802



PRESSURE REGULATOR (EVOLUTION - AGRO GREEN TYPE)
Reference 8.35.47.870



ANTI-DRIFT NOZZLE (INDUCED AIR) 80°
Reference 8.34.46.814
ANTI-DRIFT NOZZLE (INDUCED AIR) 120°
Reference 8.34.46.804



LOW-VOLUME WEED-KILLERS ELBOW
Reference 8.34.60.935



1 M FIBREGLASS LANCE TUBE WITH COMPLETE ELBOW
Reference 8.34.60.873
1.5 M FIBREGLASS LANCE TUBE WITH COMPLETE ELBOW
Reference 8.34.60.874

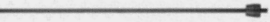

EXTENSION 0.5M
Reference 8.35.40.870



FLEXIBLE DOUBLE NOZZLE
Reference 8.35.40.871



NOZZLE SET
Reference 8.34.46.870



TELESCOPIC EXTENSION
Reference 8.35.40.876

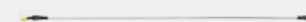

1 M ALUMINIUM LANCE TUBE WITH COMPLETE ELBOW
Reference 8.34.60.871
1.5 M ALUMINIUM LANCE TUBE WITH COMPLETE ELBOW
Reference 8.34.60.872

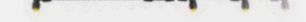

EXTENDIBLE DOUBLE NOZZLE
Reference 8.35.40.872



NORMAL WEED-KILLERS ELBOW
Reference 8.34.60.934

SPARE PARTS

Extend the service life of your sprayer easily replacing parts

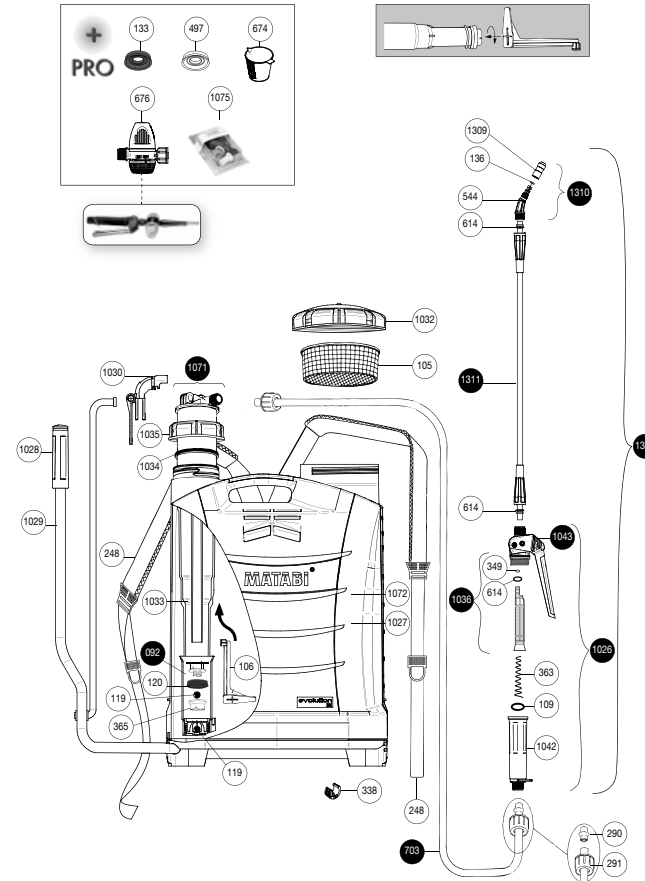

N.	COD.	Q	SPARE PARTS NAME
92	8.39.41.603	1	CYLINDER WITH BALL
105	8.39.18.303	1	FILTER TANK
106	8.39.47.306	1	AGITATOR
109	2.23.15.916	1	ROUND GASKET AN-16
119	2.20.08.902	2	STAINLESS STEEL BALL Ø 12
120	8.39.11.305	1	VITON SEAL
133	8.39.09.306	1	RUBBER SEAL
136	2.23.15.905	1	ROUND GASKET AN-5
248	8.39.41.364	2	STRAP
290	8.38.08.308	2	HOSE BUSHING
291	8.42.02.332	2	NUT
338	8.39.43.327	1	BASE BUSHING
349	2.23.16.903	1	ROUND GASKET AN-3
363	8.39.41.342	1	FILTER SPRING
365	8.39.41.303	1	SEALING VALVE
497	8.39.41.305	1	OPAQUE SYNTHETIC SEAL
544	8.28.40.322	1	SPRAYER
614	2.23.16.908	2	ROUND GASKET AN-8
674	8.39.41.350	1	100 ML DOSER
676	8.34.47.900	1	PRESSURE REGULATOR
703	8.39.18.805	1	COMPLETE HOSE
1026	8.49.41.801	1	COMPLETE HANDLE
1027	8.49.41.850	1	16 L. TANK
1028	8.49.41.307	1	GRIP
1029	8.49.41.802	1	COMPLETE LEVER
1030	8.49.41.811	1	LANCE HOOK
1032	8.49.41.602	1	TANK COVER AND VALVE
1033	8.49.41.302	1	PRESSURE CHAMBER
1034	8.49.41.410	1	LOCKING WASHER
1035	8.49.41.304	1	GUIDE LID
1036	8.49.41.812	1	FILTER WITH GASKET
1042	8.49.41.367	1	GRIP
1043	8.49.41.604	1	HANDLE BODY
1071	8.49.48.814	1	COMPLETE CHAMBER
1072	8.49.48.850	1	20 L. TANK
1075	8.34.46.816	1	NOZZLES SET
1309	8.39.05.016	1	NOZZLE
1310	8.49.45.808	1	COMPLETE ELBOW
1311	8.49.45.828	1	TUBE WITH NUTS
1312	8.49.45.823	1	COMPLETE LANCE
	8.49.46.200	1	INSTRUCTION SHEET
	8.49.45.201	1	PACKAGING
	8.49.46.201	1	PACKAGING