



ORACLE LIGHTING

BRONCO ROOF LIGHT BAR

ORACLE PART #5888-023

INSTALLATION GUIDE

TOOLS NEEDED:
10MM SOCKET
SOCKET WRENCH
SOCKET EXTENSION
13MM WRENCH
PHILLIPS SCREWDRIVER

STEP: 1

WATCH THE VIDEO

SCAN QR OR VISIT:



WWW.VIMEO.COM/ORACLELIGHTS/BRONCOBARLIGHT



REMOVE ACCESSORY COVERS TO LOCATE ACCESSORY NUTS. TWO ON DRIVER SIDE/TWO ON PASSENGER SIDE.

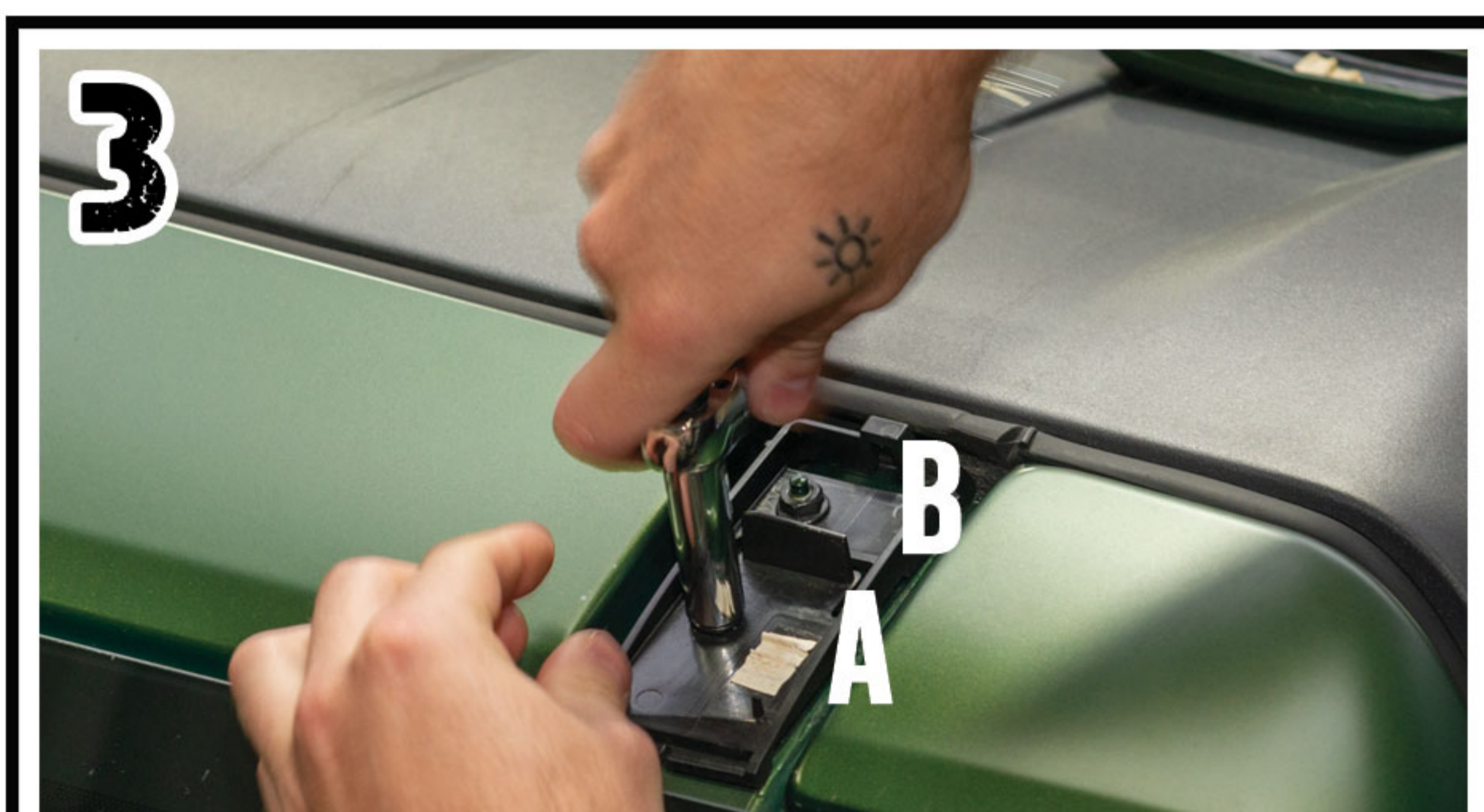

LOOSEN 10MM NUTS. ON DRIVER AND PASSENGER SIDE.



REMOVE THIS PLASTIC PIECE. IT IS NOT NEEDED FOR THE ROOF BAR INSTALL.



RUN LIGHT BAR POWER WIRE UNDER THE HARD TOP AND INTO THE CABIN.



RE-INSTALL FACTORY ACCESSORY NUTS. TORQUE TO SPEC: 60 IN-LB OR 5 FT-LB OF TORQUE.

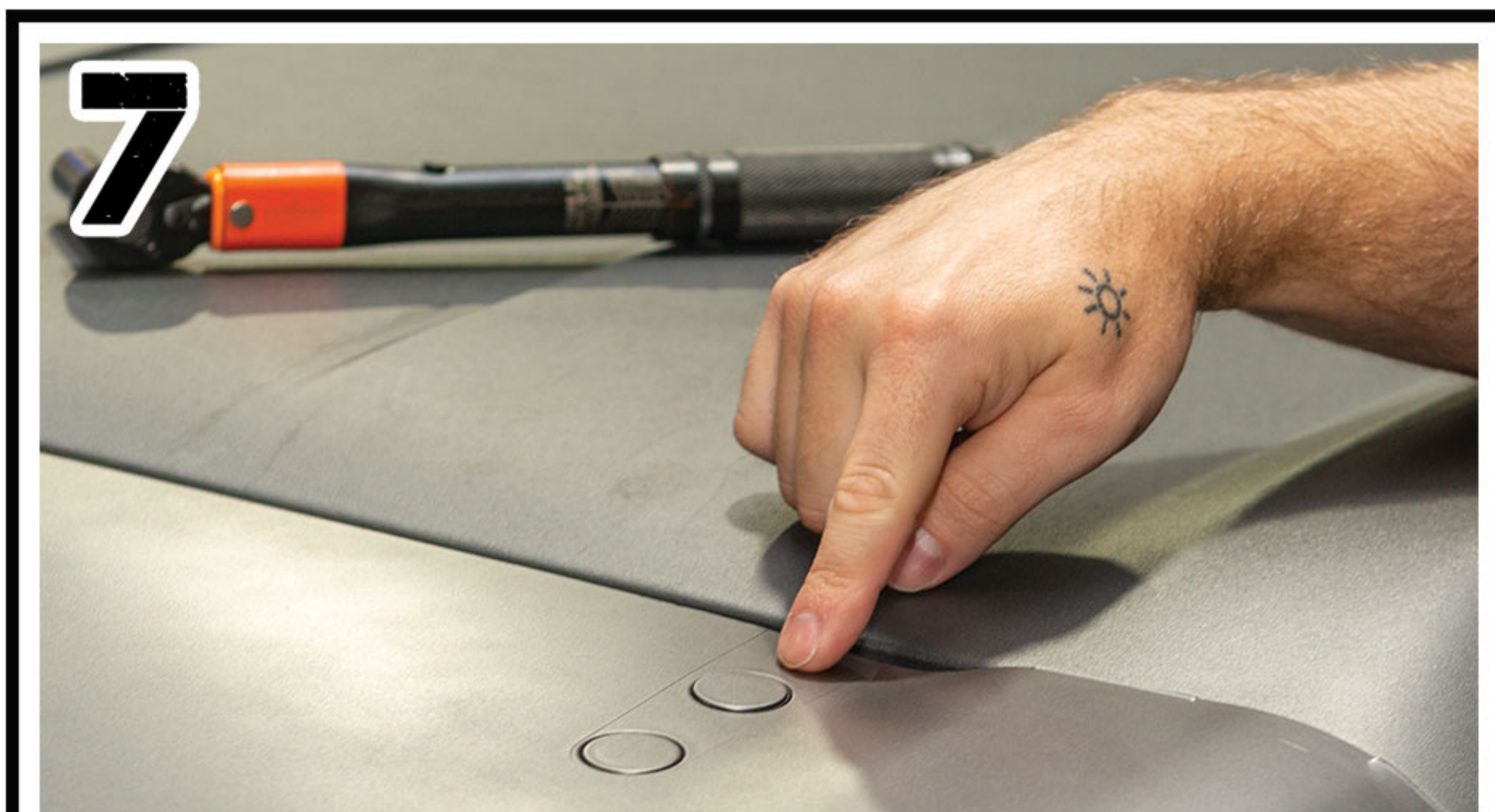

INSERT INCLUDED CAPS TO COVER ACCESSORY NUTS.

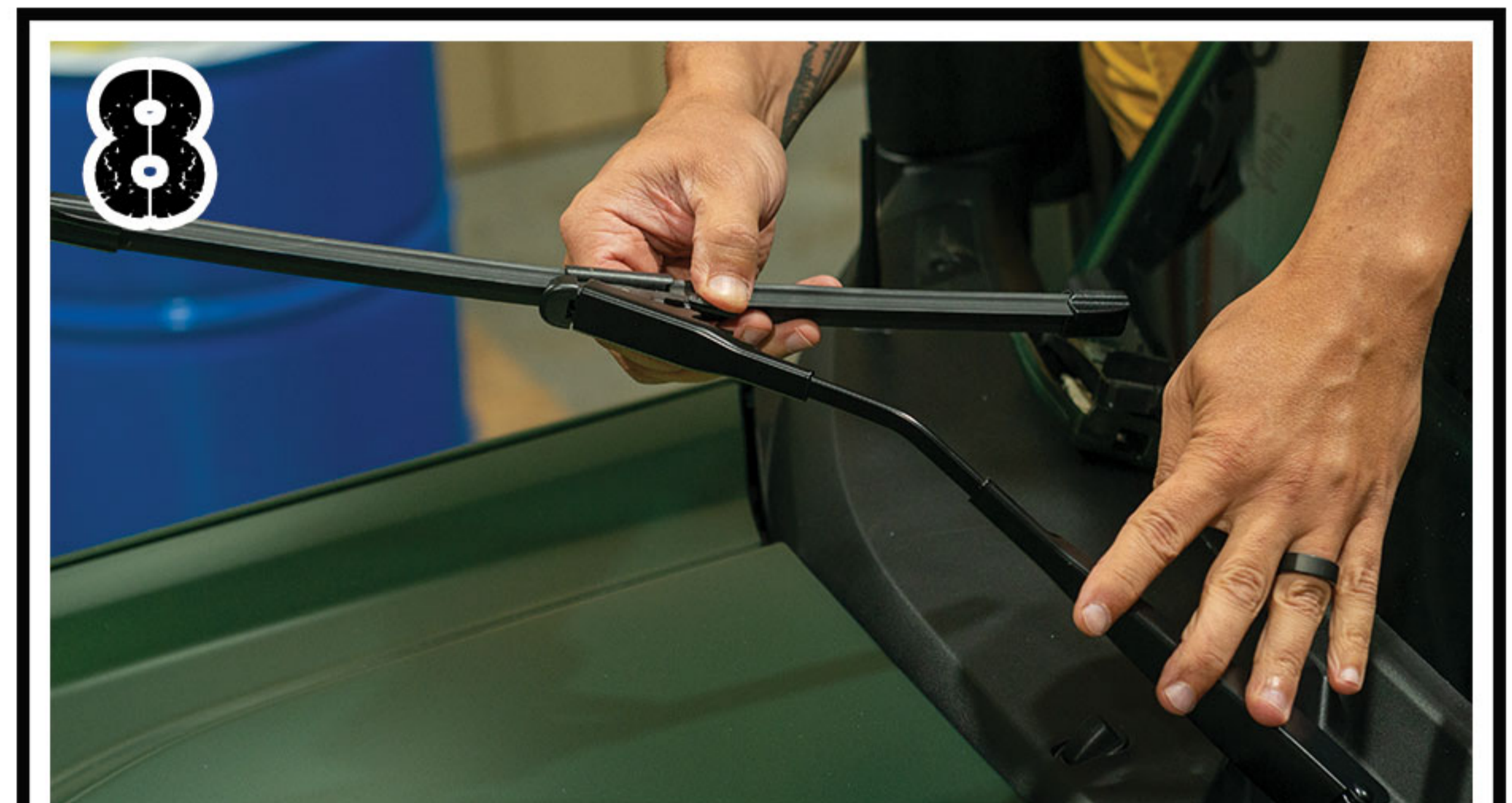

INSTALL NEW WIPER BLADES FOR LIGHT BAR CLEARANCE. CONNECT LIGHT BAR TO AUX SWITCH OR HARNESS.

ORACLE LIGHTING

www.oraclelights.com

© 2024 ORACLE LIGHTING

4401 Division St.
Metairie, LA 70002

FOR ADDITIONAL TECHNICAL SUPPORT PLEASE CALL US 1(800)407-5776



ORACLE LIGHTING

BRONCO ROOF LIGHT BAR

ORACLE PART #5888-023

INSTALLATION GUIDE

TOOLS NEEDED:
10MM SOCKET
SOCKET WRENCH
SOCKET EXTENSION
13MM WRENCH
PHILLIPS SCREWDRIVER

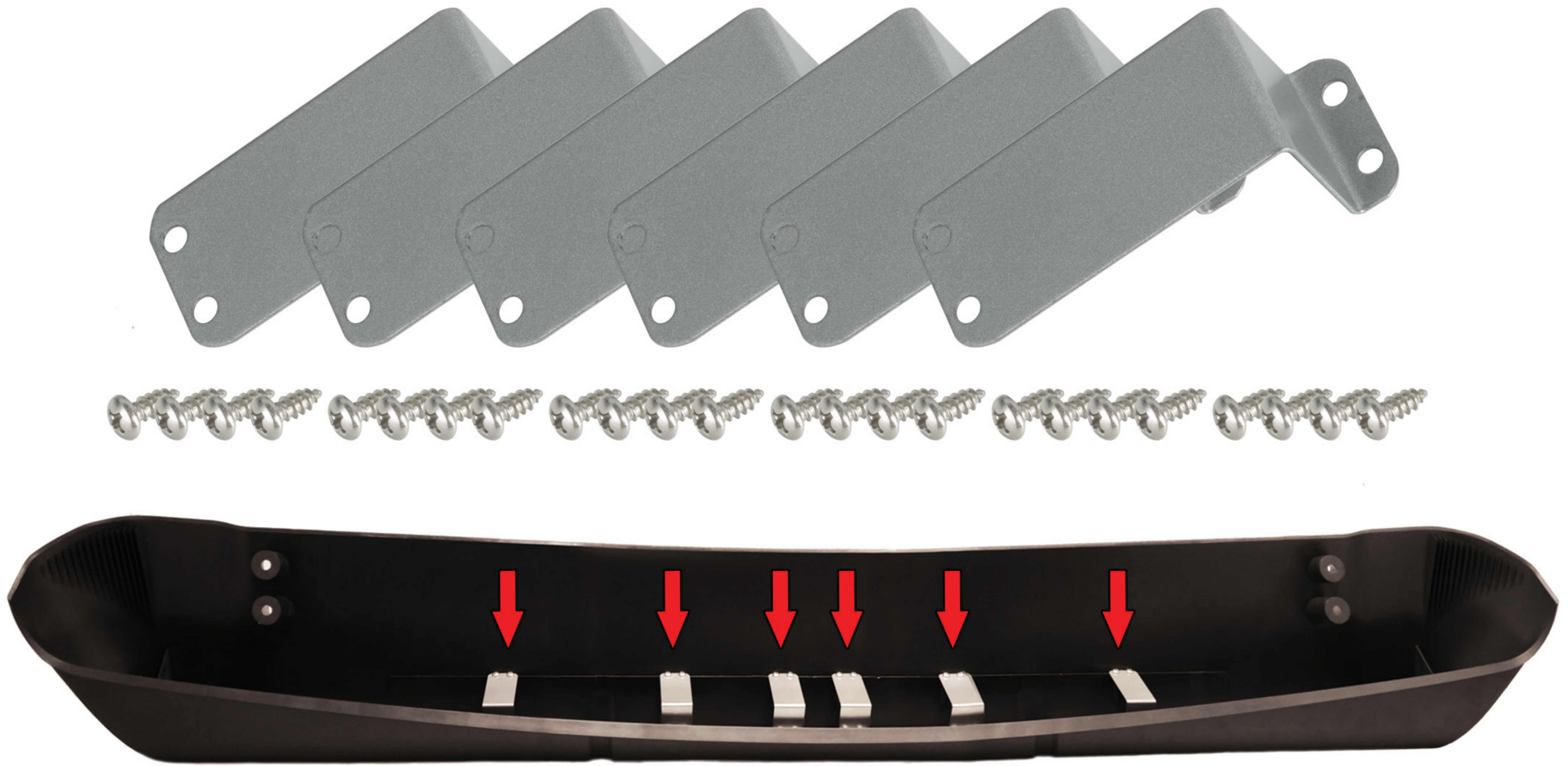

USE THIS IMAGE AS REFERENCE FOR THE PLACEMENT OF THE (6) STEEL TRUSS PLATES.

