

WHEEL BRAKE COMP 1637 500KG UNIT

ETI- No. 811156

(Specify the order with the ETI No.)

AL-KO

Spare Parts

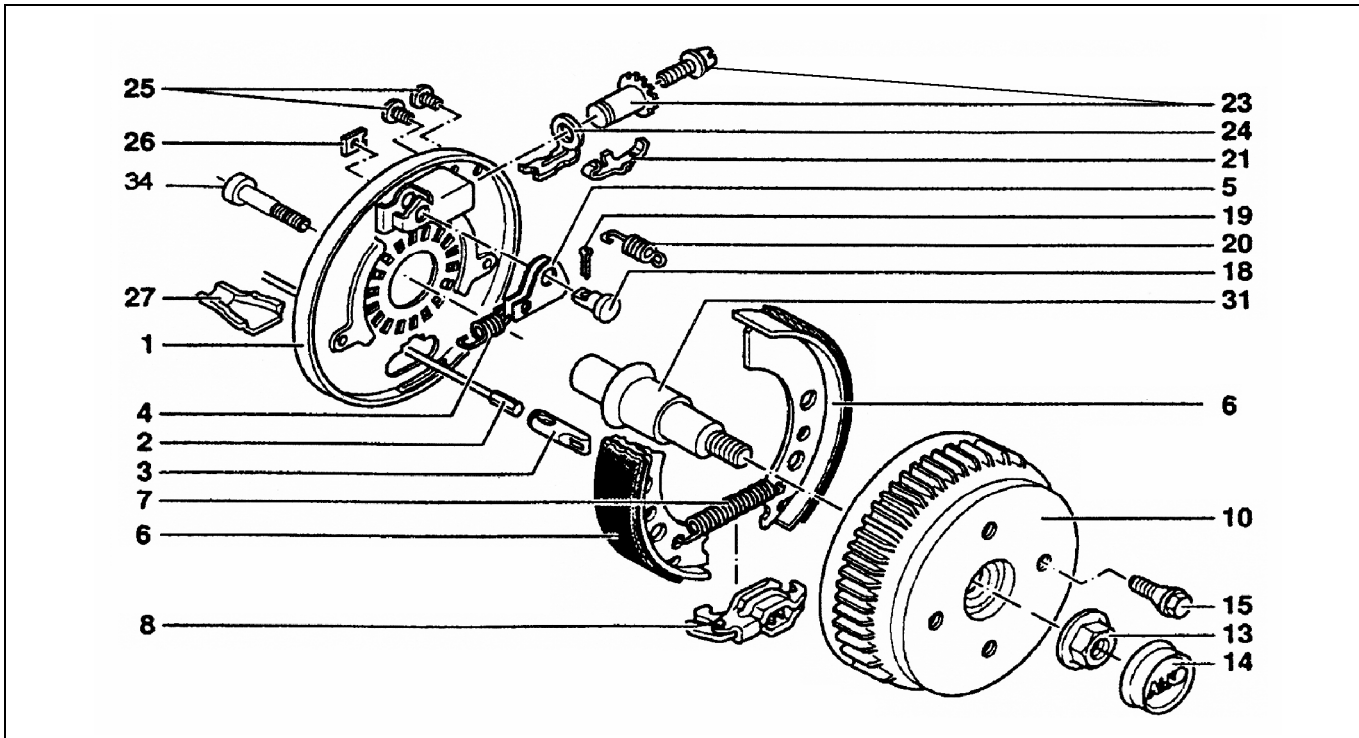

Item	Description	Drawing No.
1	BRAKING PLATE WELDED LEFT	571950
	BRAKING PLATE WELDED RIGHT	571951
2	CONNECTION BOWDEN CABLE	350 247281
		530 247282
		770 247283
		890 247284
		1020 247285
		1130 247286
		1320 247287
		1430 247288
3	CONNECTION EYE	1620 247289
		1790 247290
4	TENSION SPRING LEFT	2188870001
	TENSION SPRING RIGHT	372805
5	AUTO-REVERSE LEVER LEFT	384308
	AUTO-REVERSE LEVER RIGHT	384309
6	BRAKE JAW LEFT	1213888
	BRAKE JAW RIGHT	384296
7	TENSION SPRING	2182150003
8	SPREAD HINGE LOCK	570666
10	BRAKE DRUM CPL. UNIT-BEARING AND LOCKING RING	98x4 M12x1,5 623748
		100x4 M12x1,5 623749
		112X5 M12x1,5 623750

Item	Description	Drawing No.
10	ET-SET BEARING-CIRCLIP-FLANGE NUT	1224800
13	FLANGE NUT	581200
14	CAP	581197
15	WHEEL BOLT	CONUS M 12x1,5 2081670018
		SPHERIC M 12x1,5 2081670020
		SPHERIC M 12x1,5 (R13) 372138
18	BEARING BOLT	368651
19	SPLINT 4x20 DIN 94	700192
20	COMPRESSION SPRING	2088800003
21	FLAT SPRING	581879
22	ADJUSTING BOLT AND	21873708
23	ADJUSTING NUT	
24	COMPRESSION BINDER	581878
25	STOPPER 10x13x11	373245
26	COVER PLATE	2382610002
27	BOWL	371387
31	STUB AXLE	605566
34	HEXAGON SOCKET HEAD CAB SCREW WITH BOLT LOCK	704096

THE RETAIL SALE OF BRAKE JAWS IS NOT PERMISSIBLE BY EU DIRECTIVE FORM 01.OCT.2002!
ATTENTION: POS 7, 20 ,26 ODDLY ORDERABLE OR IN SET BRAKE JAW 1213888 CONTAINED

provided	ETI-No.	changed	Change No.	Reason of the change	Revisions-No.
07.03.97	811156_en	08.02.2010	FREIGABE		A
		02.02.2011 HI	16422	SEE CHANGE NOTICE	B