

The G-50x Arm

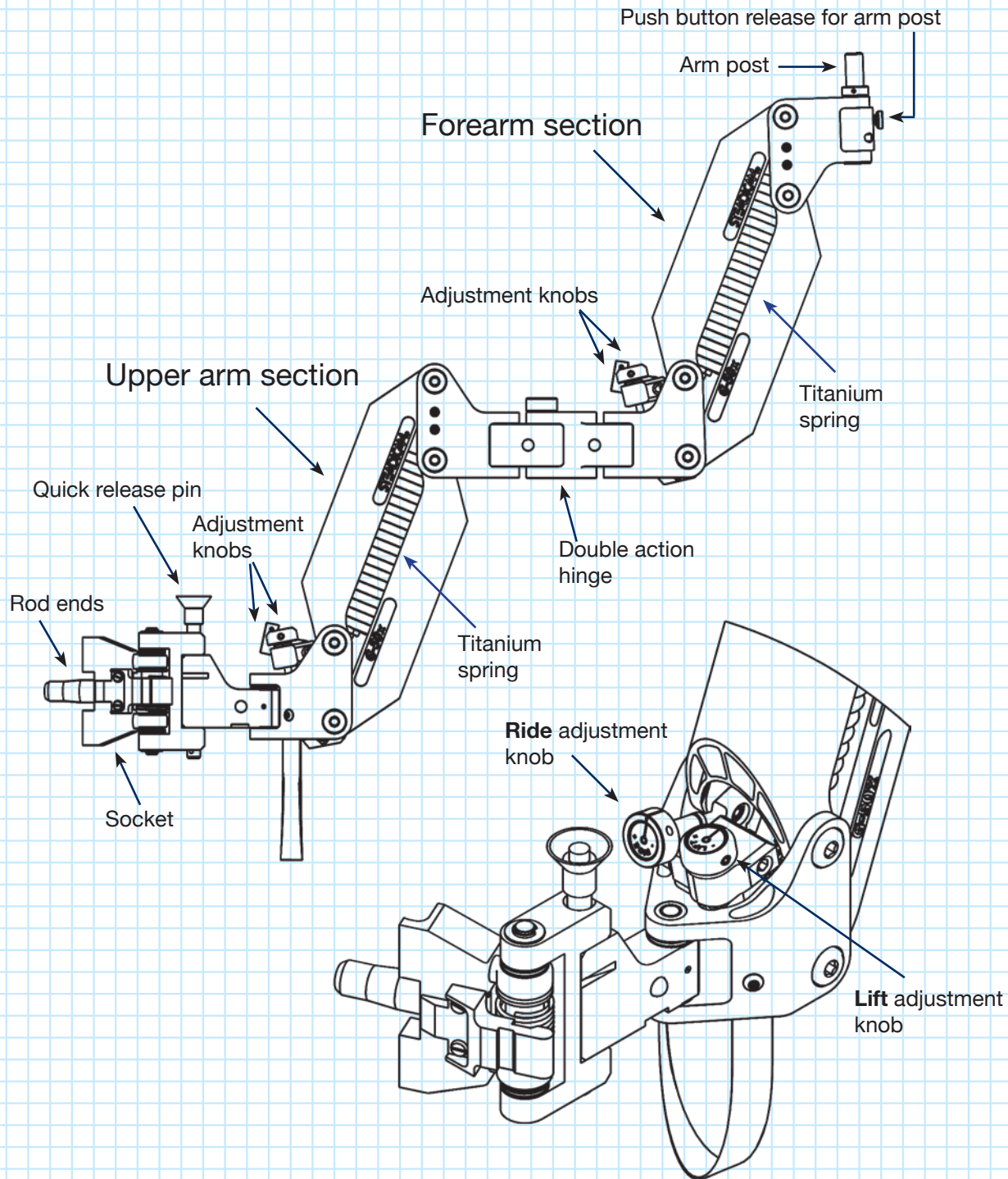

The New Steadicam G-50x Arm

The G-50x is the second release of Tiffen's G-Series arms. The revolutionary, patented Geo spring geometry optimizes performance throughout its lifting range. It tames high/low arm travel with adjustable-length cranks that dynamically rock the spring termination as the arm is boomed up or down. Powered by titanium springs, the G-50x arm smoothly carries any load from 12 to 50 pounds (5.4 to 23 kgs). The all new bearing performance enhancements on the G-50x arm makes even the slowest camera moves ultra smooth.

The design criteria for the G-50x arm:

light weight (8.6 lbs / 3.9 kgs), user-maintainable, and a 29 inch (73 cm) boom range. It has soft bumpers at each end of travel so the arm can be boomed right to its limits without shot-disturbing clunks. The G-50x also has a Ride control that adjusts the iso-elastic™ response of the arm.

G-50x innovations include:

Arm posts are locked in place by a single button, so switching arm posts is quick and easy. Actually, all parameters are user adjustable. This quick-change mechanism also has an adjustable drag for the post's rotation, from completely free to totally locked. Increased structural strength, improved geometry, tough type III hard anodize on the main arm components, and sturdy component design helps provide years of lasting durability.

The net result:

The smoothest, best performing durable arm ever built!

Unparalleled Service and Support:

The new G-50x arm comes with an industry surpassing standard 3-year full parts and labor warranty that includes all components including springs and socket blocks. The transferrable standard warranty also includes one complimentary factory tune-up to insure your arm is performing at its best.

For more information, please go to:

www.tiffen.com/steadicam_g50x_arm.html