



# All-Terrain Cart

ASSEMBLY INSTRUCTIONS



Disc Golf Carts for a better game™

## All-Terrain ASSEMBLY INSTRUCTIONS

### Part I. Attach the Bag Insert

1. Lay frame down and attach velcro backing to underside of frame as shown.

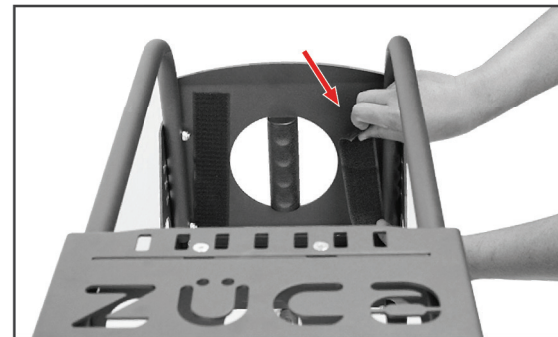

2. Push insert through the front of frame and zip up the zippers on the front metal tubes. (Keep the zipper pull tucked to protect the zipper).

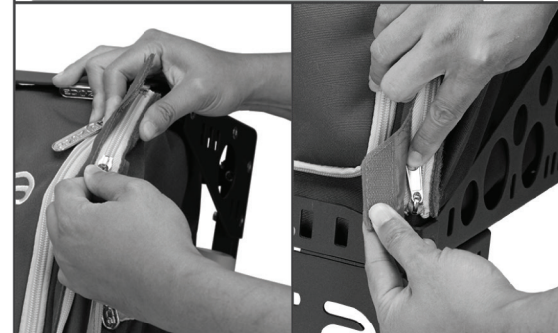

3. Lay frame front side down. Secure the four rear velcro straps as shown.



4. Open the insert to securely push the velcro on top of the insert against the velcro attached to the frame. Pat down the padded floor and zip up the insert. This part is now complete.



### Build the Disc Golf Rack (for Disc Golf Carts)

- Disc Golf Rack includes the following parts:
- 4 x support bars
  - 2 x side walls

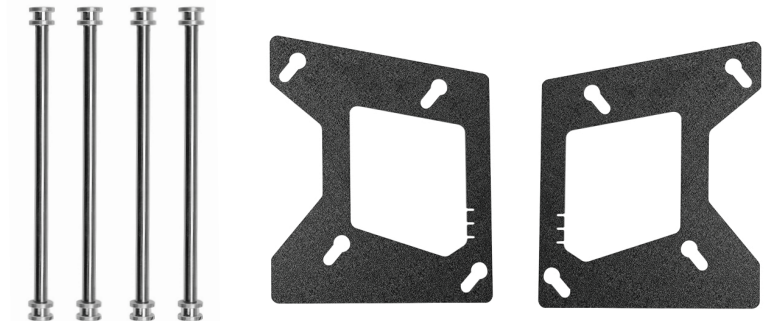

1. You will need to assemble the Disc Golf Rack *inside* the bag. Place side walls inside bag with notches facing toward you.



2. Push all four support bars into place, one at a time, starting from the bottom level.

Note: support bars must “snap” into place to ensure structural integrity.



3. Once assembled, you may begin adding your discs.

Bonus: front notches give you the option of using bungee cords to secure your discs into place.



Disc Golf Carts for a better game™



## Part IV. Attach the Bottle Holder

1. Remove screws from frame and set aside.
2. Attach both bottle holders with the screws from the frame.
3. Adjust the bottle holder to your desired position. Squeeze the holder as shown and turn the adjustment screw to expand the holder. This part is now complete.



## Part II. Attach the Wheel and Axle

1. Remove one axle knob and thread one axle through the wheel.
2. Thread an axle through the spacer.
3. Push the axle through the frame as far as it will go.
4. Thread the axle through the second spacer.

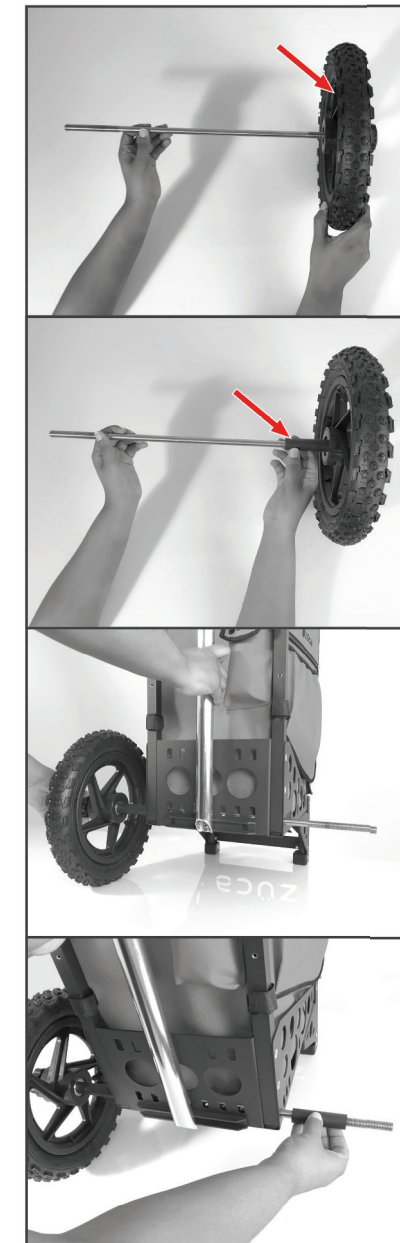

## Part II. Continued

5. Thread the second wheel onto the other end of the axle.



6. Tighten the axle knob by holding both knobs and turning in opposite directions. (see Axle Knob Tip). Once tightened, test out the rotation of the wheels to inspect for equal fluid motion. Repeat if necessary.



### ⚠ Axle Knob Tip

Look for a small bolt hole on the side of the axle knob. Insert the 2.5mm Allen wrench (included) into the bolt hole and firmly turn into place. Repeated over-tightening or tugging will strip the bolt hole. Please turn with care.

## Part III. Adjust the Pole Handle

1. Pull the Pole Handle out completely from the frame by loosening the lower clamp.

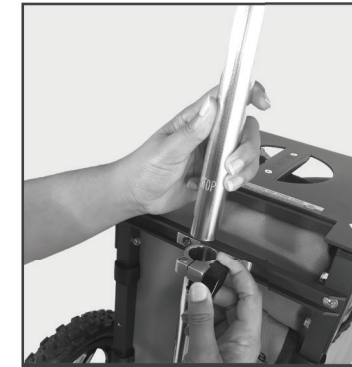

2. Reattach the Pole Handle to adjust the height. Slide the handle to your desired height but do not pass the STOP indicator. Tighten the lower clamp to secure.



3. Release the upper clamp.

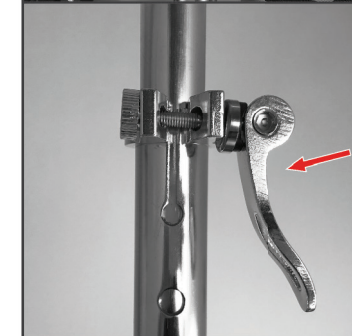

4. Push the button locks to adjust the pole height up or down.

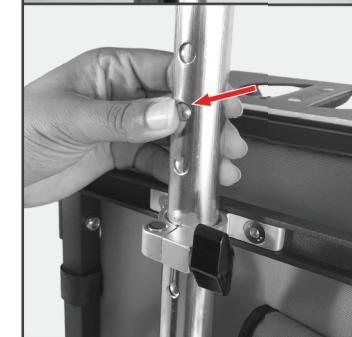

5. Lock down the upper clamp. Finally, add the accessory pouch to complete this part.

