



---

# SMOKEY BANDIT APP

**Manual**



# WIFI Board APP Operational Steps

Android APP:

<http://47.100.254.34/grill/I/SmarterGrill20200121.apk>

OR



Apple APP:

App Store-> Search->  
Type in “Smarter Grill” -  
> Smarter Grill

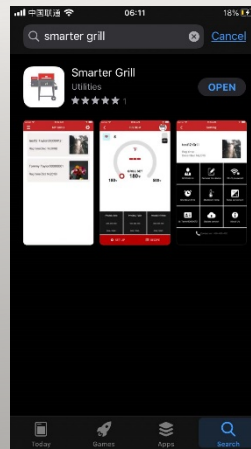

Prerequisites:

Apple device: Iphone 6S above with IOS 13;  
Android device: available for all versions

2.4G Internet available;  
Bluetooth is on;





# WIFI Board APP Operational Steps

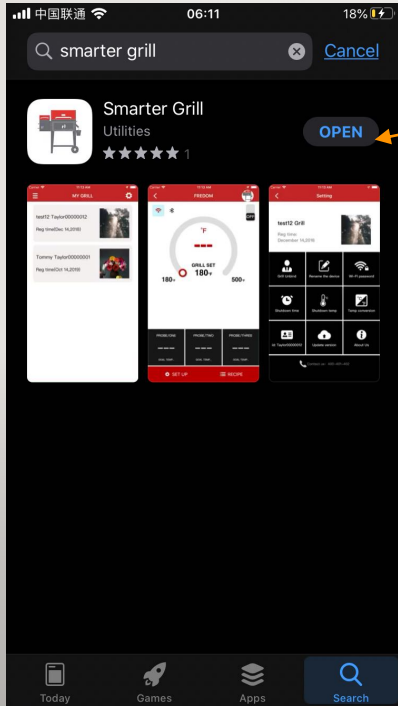

Step 1:  
Open APP

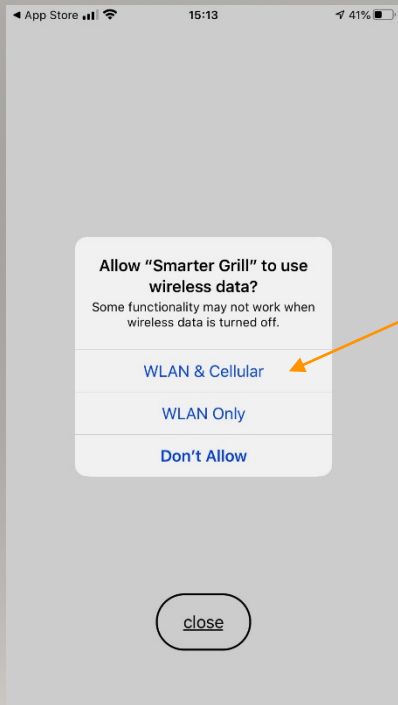

Step 2:  
Select “WLAN& Cellular”



# WIFI Board APP Operational Steps

Log in

User name

Password

☒ Remember the password

Log in

Forgotten your password?

Don't have an account? [Register Now](#)

## Step 3 Log in:

1. Fill in “account name”;
2. Fill in “Password”;

### Note:

If you have no account name yet, go to “Register Now” at the bottom of the page

Regist

\* Username

\* Password

Phone number

\* E-mail

Address

Submit

## Step 3.1 Register process:

1. Account name;
2. Password;
3. Phone number;
4. Email address;
5. Home address;

Press “Submit”

### Note:

\* Is obligated;





# WIFI Board APP Operational Steps

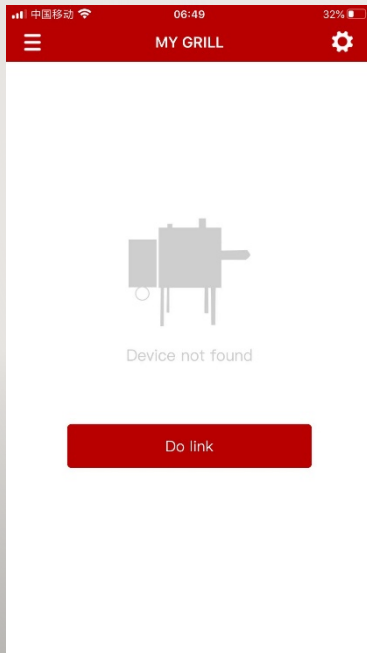

## Step 4 Search new Grill:

1. Click the button at the upper right of the page to search for a new grill;

### Notes:

1. 2.4G WIFI available;
2. Device is connected to WIFI;
3. Bluetooth is switched on;
4. Move your device as close to the controller as possible;

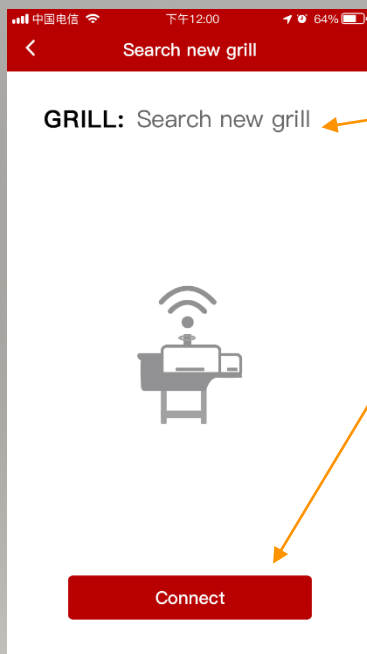

## Step 4 Search new Grill:

2. Grill series number will be shown next to the Grill;
3. Click “Connect” to connect with the router, which is connected to your device;



# WIFI Board APP Operational Steps

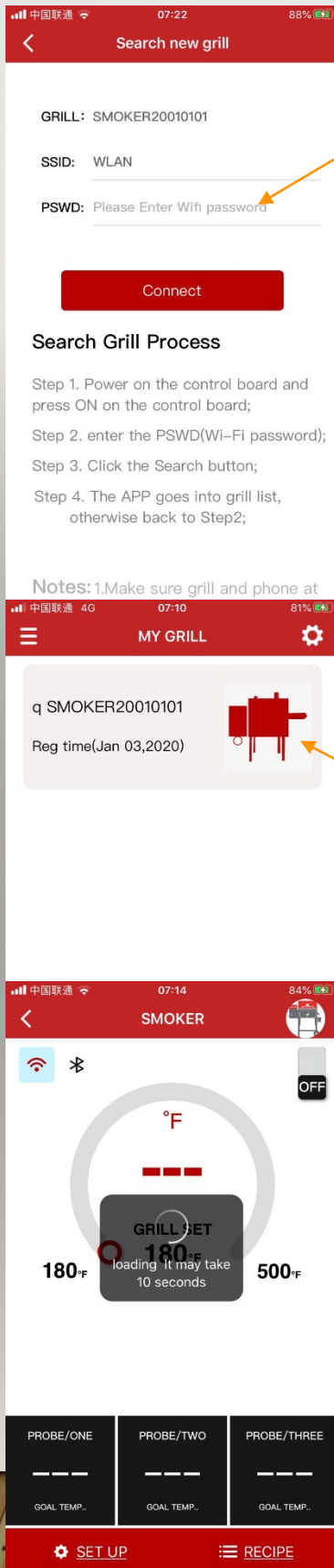

Step 4 Connecting with the Grill:

4. Fill in your password

Notes:

1. SSID will automatically connect with your device if it is connected to the WIFI

Step 4 Connecting with the Grill:

5. List of grill devices

6. Click on the grill emblem

Step 4 Connecting with the grill:

7. Main control panel is loading





# WIFI Board APP Operational Steps

## Grill Settings:

The screenshot shows the 'SMOKER' app interface. At the top, there's a status bar with '中国联通', '07:14', and '84%' battery. Below it, a red header bar contains a back arrow, the title 'SMOKER', and a grill icon. The main area features a large red semi-circular gauge with '°C' at the top, '18' in the center, and 'GRILL SET 220°C' below it. The gauge has a red needle pointing to 18 and a grey needle pointing to 220. To the left of the gauge is '71°C' and to the right is '282°C'. Above the gauge are two icons: a red Wi-Fi icon and a blue Bluetooth icon. To the right of the gauge is a red 'ON' button. At the bottom, there are three black boxes: 'PROBE/ONE' with '000' and '107°C', 'PROBE/TWO' with '---' and 'GOAL TEMP..', and 'PROBE/THREE' with '---' and 'GOAL TEMP..'. A red footer bar contains a gear icon, 'SET UP', a list icon, and 'RECIPE'.

WIFI/ Bluetooth  
RED: ON  
BLACK: OFF

Grill Power  
ON/OFF

Actual Grill  
temperature

Lowest  
temperature  
setting

Highest  
temperature  
setting

PROBE I– 3  
Actual Probe  
Temperature  
Probe setting

APP-Settings

RECIPE setup  
and  
maintenance  
list



# WIFI Board APP Operational Steps

## Recipe Settings:

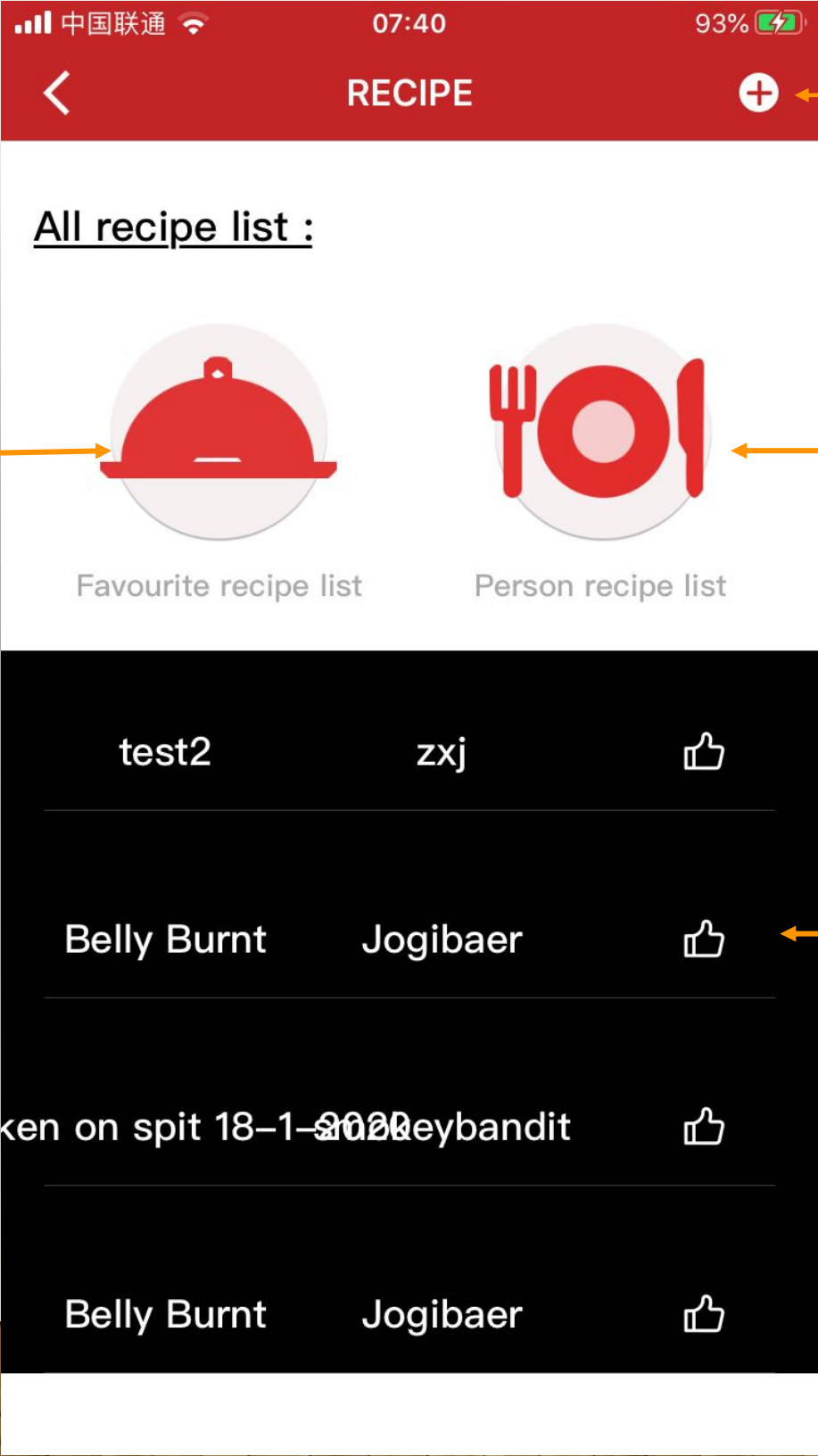

Create a new recipe

Favorite recipes

Self created recipes

RECIPE maintenance list





# WIFI Board APP Operational Steps

Create a new recipe:

The screenshot shows a mobile app interface for creating a recipe. At the top is a red header with a back arrow and the title 'Recipe creation'. Below the header, the 'Creator' is set to 'smokeybandit'. The 'Recipe name' field is empty, with a placeholder text 'Please input name'. Below this is a table with columns 'Step', 'Temp(°C)', and 'Time(M)'. The first row shows '1', '107', and '5'. To the right of the table are red '+' and '-' buttons. At the bottom are two buttons: 'Save' (black) and 'Generate' (red). The bottom of the screen shows a black navigation bar with three icons: a hamburger menu, a circle, and a back arrow.

Step	Temp(°C)	Time(M)
1	107	5

User name

**Creator:smokeybandit**

**Recipe name**

Please input name

Enter the name of the recipe

steps

1

107

5

+ -

Possible to add multiple steps

Grill temperature, is adaptable

Timer, is adaptable

Save your recipe

**Save**

**Generate**

Start the procedure



# WIFI Board APP Operational Steps

## Setup Setting:

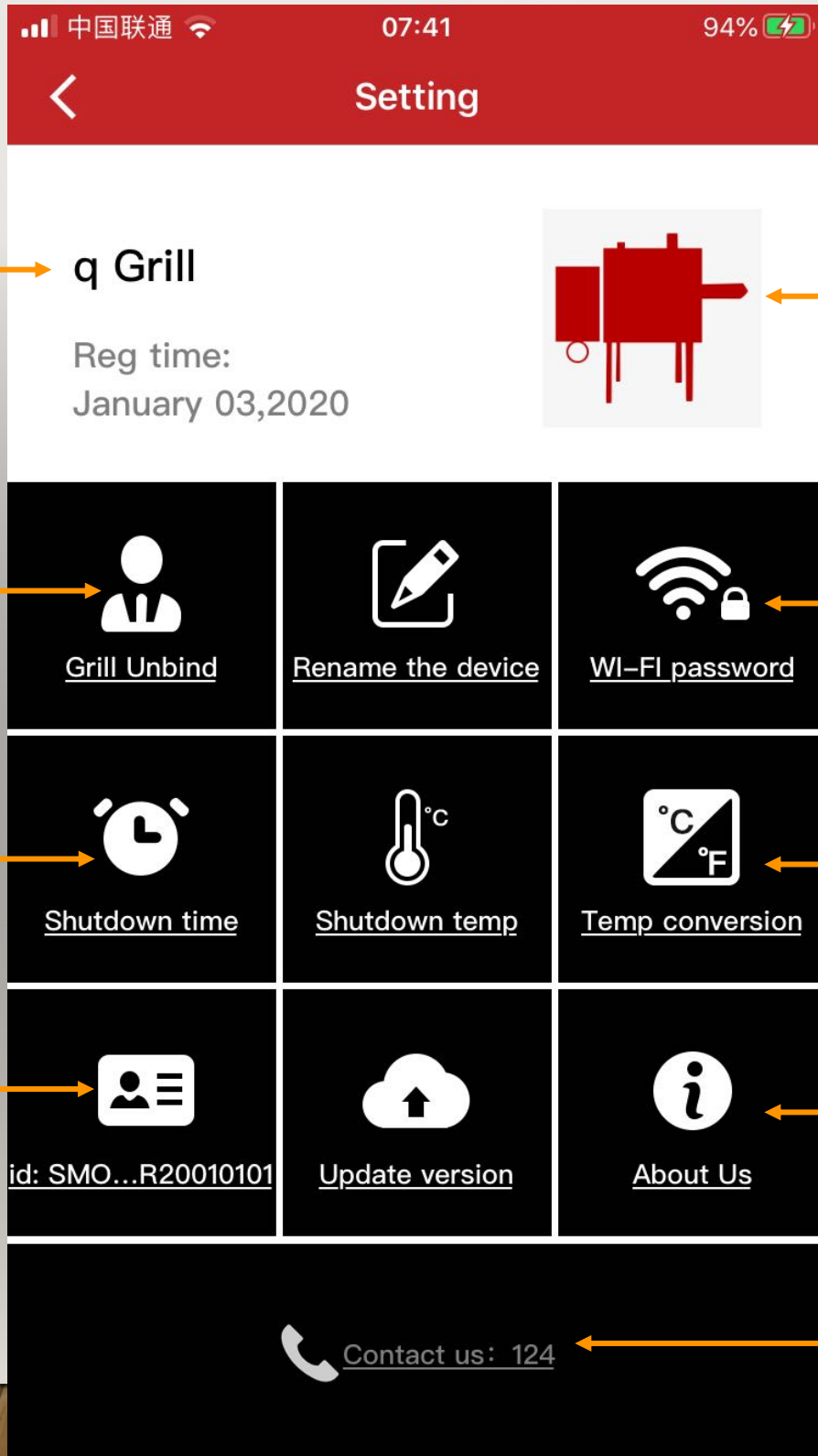

Grill Name → q Grill

Picture can be changed

Remove Grill Or reconnect

Change the WIFI password if the former WIFI password has been changed

Shut down condition setting

Temperature unit switch between C/F

Grill series number information

Company information and service

Company contact