

# Xplore

## Quick Start Guide

### Smart Dashcam

#### / IN YOUR CAR

- 1 Clean the windshield and choose a position where the Dashcam will not block the driver's view. A recommended place is behind the rear view mirror. Place windshield sticker.  
Tip: Put the hexagon mouth of sticker upside-down.
- 2 Insert a Memory Card (SDHC Class 10 or above) into the Dashcam.
- 3 Mount the Dashcam onto the Bracket.

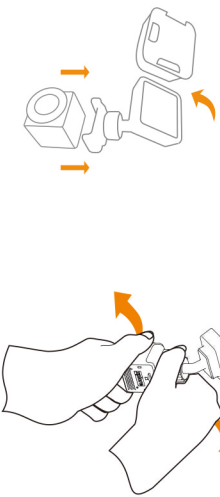

#### / HELLO

Thanks for choosing Xplore Dashcam.

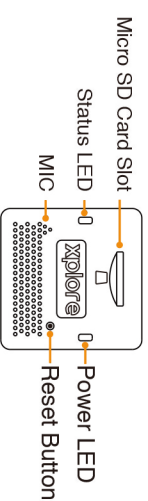

Status LED	Power LED
Recording GREEN	Low Power 10% RED Flash
Recording / Card Error OFF	Low Power 20% RED
Snapshot GREEN Flash	Charging BLUE Flash
WiFi Error RED	Full (Charged) GREEN
GPS Error YELLOW	Upgrading Firmware GREEN Flash
Snapshot Remote Error BLUE	

- 4 Fix the Bracket to the Windshield Sticker.
- 5 Fit the USB Cable to the Bracket and fix Cable in car. (The cable can be hidden and fixed with cable clips if desired).

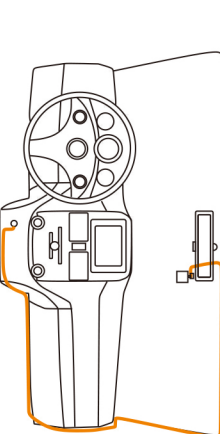

- 6 Plug in the Power Adapter to the car's cigar lighter.
- 7 Insert USB Cable into Power Adapter.
- 8 Your Xplore C1+ is ready to go.

#### / TURN ON AND OFF

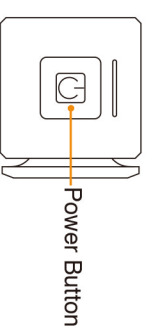

**AUTOMATIC**  
Xplore C1+ Dashcam starts recording when the engine starts, and powers off 20 seconds after the engine stops.

#### MANUAL OVERRIDE

Turn ON: Hold the Power Button for 2 seconds.  
Turn OFF: Hold the Power Button again for 3 seconds.

#### SNAPSHOT MODE

When recording, press the Power Button. Xplore C1+ takes a picture and saves a 12 second video clip.

#### / Xplore C1+ APP

Go to our website at [www.amacam.com](http://www.amacam.com) to download the App, or search for xplorecam on the AppStore or Google Play.

#### / IN THE BOX

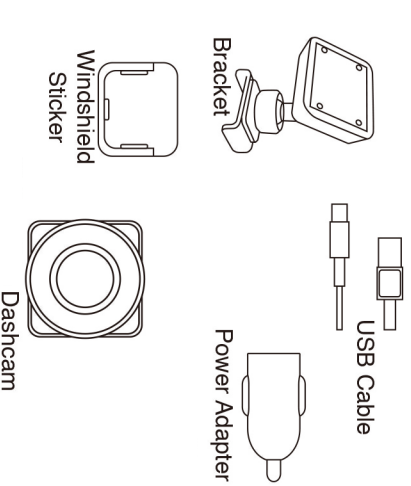

#### / FAQs

- 1 **Dashcam won't record**  
Make sure you are using a SDHC, rapid storage card (Class 10 or above) from an authorized seller. Check if there's enough space on the memory card. Format the card if necessary.
- 2 **Dashcam is hot**  
Heating is normal, and the normal operating temperature is between -20°C and 70°C.
- 3 **Dashcam has crashed**  
Use a paperclip to press the Reset Button.
- 4 **What's the maximum capacity of memory card?**  
**When can a memory card be inserted or removed?**  
32 GB. Insert and remove the memory card when Dashcam is turned off.
- 5 **What's seamless loop recording?**  
When the memory card is full the Dashcam will automatically overwrite from the earliest recording. Protected files and emergency recording will not be overwritten.