

Type 2 to Type 1 Adapter

Safety and usage guidelines

1. In case the adapter is not working properly, stop the session, remove the charging cable from the car and remove the adapter then contact us at: support@cablesolutions.shop or call us at +31(0) 850604784
2. Do not disassemble the product or expose it to liquid, humidity, moisture, or temperatures outside the specified operating ranges of -10° C (50°F) to 50° C (122°F).
3. Make sure the cable is touching the ground with the adapter is used to prevent extra forces pulling on the plug and the adapter.

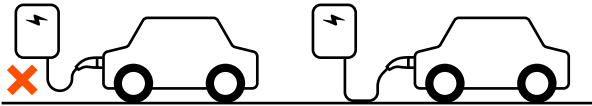

4. If your product is exposed to high external temperatures please remove the adapter from the car and allow temperature to return to the normal operating range -10° C (50°F) to 50° C (122°F).
5. We do not recommend using this adapter in heavy rain conditions

Product size

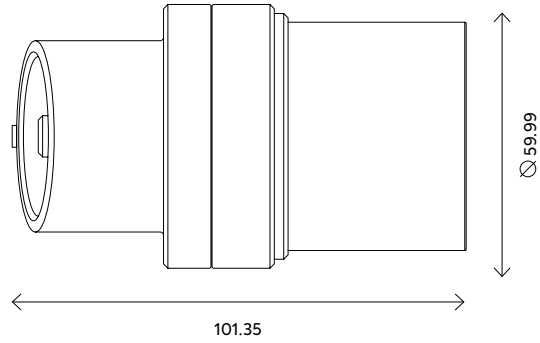

Specifications

Plug Type car side:	IEC 62196-2, Type 1 female
Plug Station side:	IEC 62196-2, Type 2 male
Contacts type 1:	L + N + PE, plus PP + CP
Contacts type 2:	L + N + PE, plus PP + CP (L2 + L3 not connected)
Max nominal current:	32A
Max operation voltage:	250V
Max voltage level:	2000V
Max operating temp.:	-10° C (50°F) to 50° C (122°F).
Safety Compliance:	IEC 62196-2
Size:	101.35mm * 59.99mm
PP pin resistance:	150 Ohm
IP level:	IP55
Material:	ABS+PC (UL94V-0)
Pin Material:	Copper alloy with Nickel Silver plating

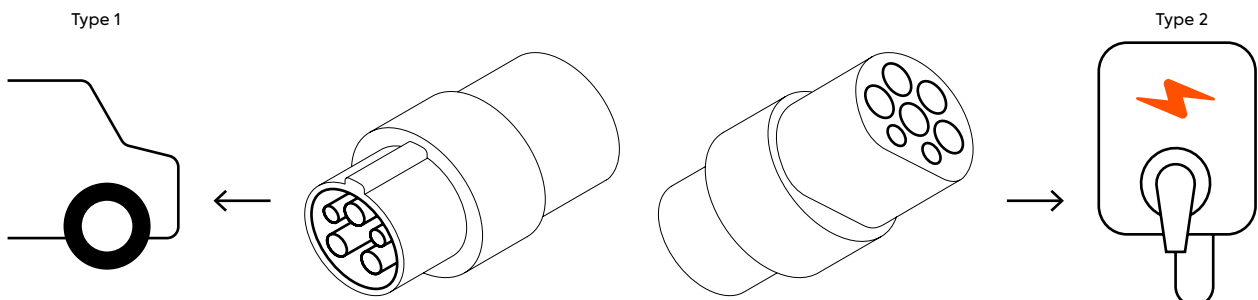



Start charging

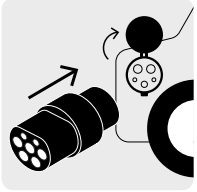

1. When charging, first insert the Type 1 side of the adapter into the charging port of the electric car.



2. Take the type 2 charging plug from the charging station and insert this in the type 2 side of the adapter.



3. In case required by the charging station: Authorize the charging session with your charge card or other authentication token

Stop charging



1. **Stop charging session before unplugging!**

Make sure the charging session is stopped before unplugged the cable or the adapter from the car. Check the car dashboard, the station or the mobile app of the car or station to confirm the session has stopped.

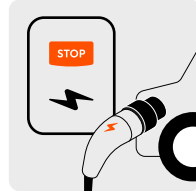

2. Now unplug the charging cable from the adapter and place it back.

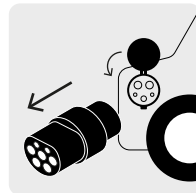
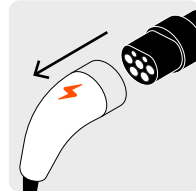

3. Unplug the adapter and close the lid of the charging outlet

Happy travels!

