

Menu turn on/off backup lines



7" TFT LCD COLOR MONITOR



OPERATING INSTRUCTIONS

Please read this instruction manual care fully before operating this device

LCD COLOR MONITOR OPERATING INSTRUCTIONS

1.Apperance and function

■ 7”AHD/CVBS Monitor



- 1.Remote control position
- 2.Decrease button: to decreas brightness contrast,color, etc
- 3.Menu setting the monitor's performance
- 4.Increase button: to increease brightness,contrast,color, etc
- 5.Video1(Camera1:AHD1/CVBS1)/(Camera2:AHD2/CVB S2) switch
- 6.Mirror and non mirror switch
- 7.Parking guide lines ON/OFF
- 8.Power ON/OFF
- 9.Power indicator
- 10.U bracket

LCD COLOR MONITOR OPERATING INSTRUCTIONS

2.Remote controller

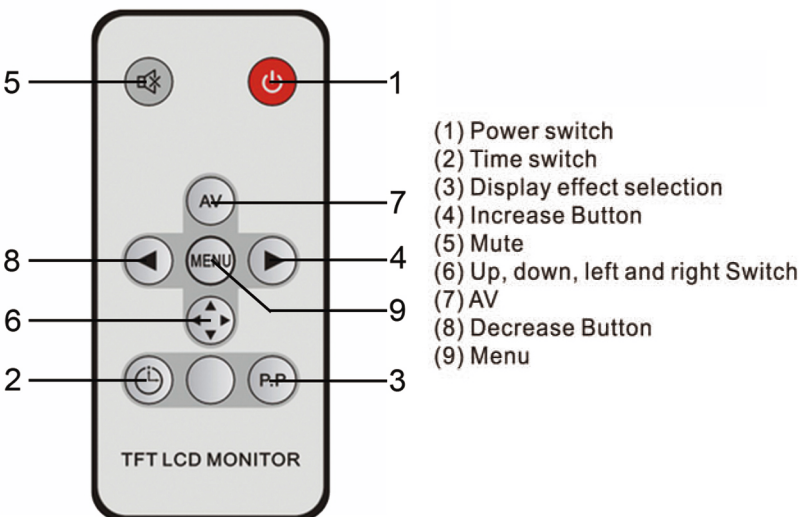

■ Replace the battery of Remote Controller

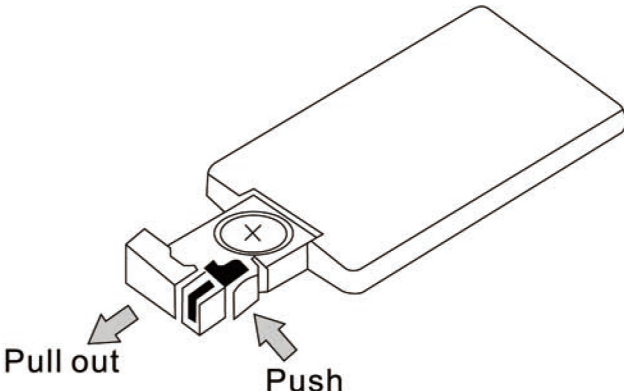

LCD COLOR MONITOR OPERATING INSTRUCTIONS

3.Monitor Standard Installation

● U bracket Installation

1.Remove the screw around the monitor. Put U type bracket to the right place and adjust, prepare 3 screws.(see below pictures)



2.Locking the bracket by screws.Put the monitor into bracket,adjust angle and locking it.(see below pictures)



3.Finish installation.The adjustable angel is forward 30° and backward 30° User can adjust a suitable angle by themselves.(see below pictures)

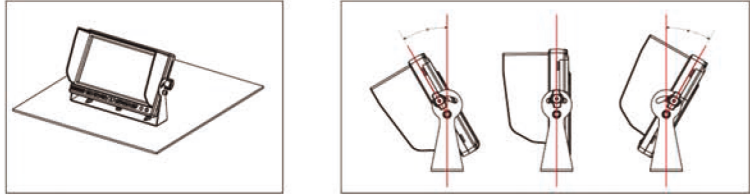

LCD COLOR MONITOR OPERATING INSTRUCTIONS

● Fan bracket installation

1.Firstly please fix the screws with and let fan shaped bracket tight, (see below pictures)

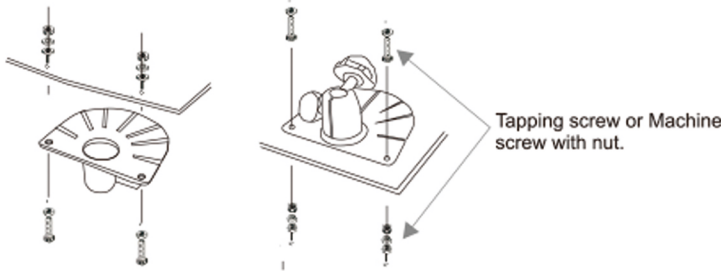

2.Secondly put the metal buckle piece on the top of the fan-shaped bracket into the notch at the back of the monitor.(see below pictures)

3.Move the bracket to the proper location.(see below pictures)

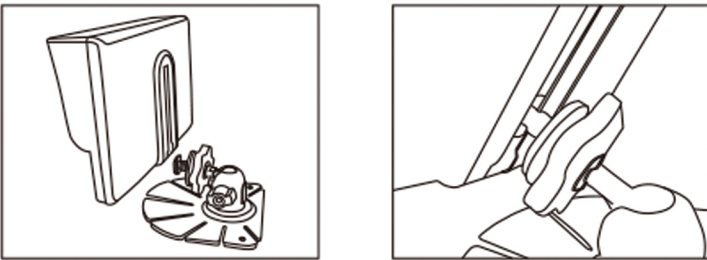

4.To fix the big screws of the bracket until to keep the monitor tight (see below pictures)

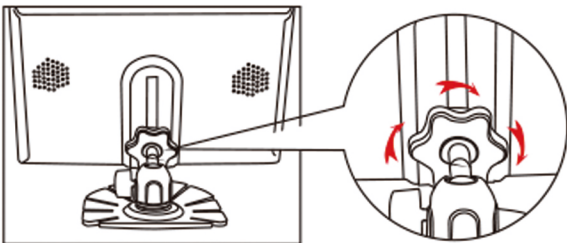

LCD COLOR MONITOR OPERATING INSTRUCTIONS

5.If users want to change the direction or angle of the monitor, firstly to loosen the screws on the bottom of the bracket.Then move the monitor to the desired location then fix the screws on the bottom of the bracket again.(see below pictures)

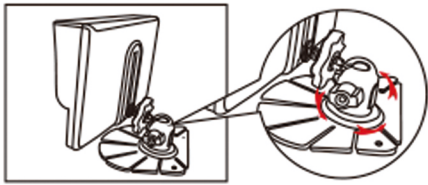

4. Connections

● Connections1

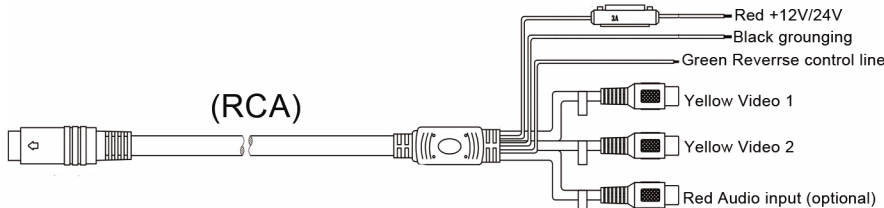

● Connections 2

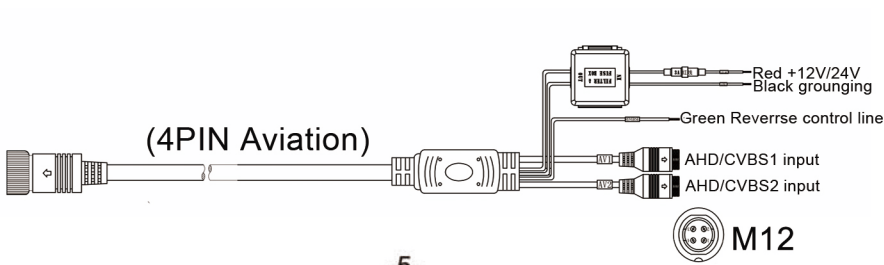

LCD COLOR MONITOR OPERATING INSTRUCTIONS

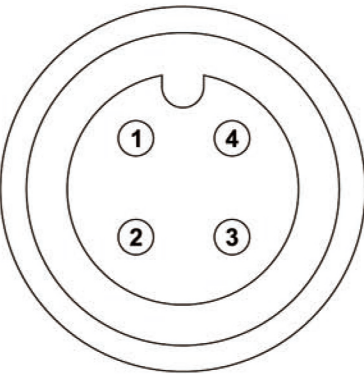

Male:

- 1. Video in(AHD.CVBS)
- 2. Audio in(or Empty)
- 3. Ground out
- 4. Power out+12

5.Parameters:

- Display size: 7"
- Display format:16:9/4:3
- System:NTSC/PAL
- Power supply:DC 9V-36V
- Power:≤ 3W
- Resolution:800*R.G.B*480/1024*R.G.B*600
- Two ways:AHD/CVBS input
- Car reversing function,automatic image switch to V2
- Remote control full function,OSD menu
- Brightness:450cd/m2
- Built in speaker function(optional)
- Contrast,color and brightness adjustable
- Varying languages display