

FLEXIBLE SHAFTS

for wet tube cleaning

Goodway blue flexible shafts are used to connect a cleaning brush or -tool to a rotary tube cleaning machine. Inside the blue casing, a high-quality galvanized steel core is rotating to power the brush or tool. Water is also fed through the shaft to cool the core and flush out the loosened deposits. Available in various lengths and diameters with different brush connections.



Blue flexible shafts are always used with a low temperature water flush.

Tube cleaning applications



Tube heat exchangers



Water-cooled chillers

Use flexible shafts with brushes and tools to remove various deposits in tubes of shell and tube heat exchangers, water-cooled chillers, heat pumps and more.



This operator is cleaning a watercooled chiller. The (blue) flexible shaft is used to rotate the brush inside the tube to remove deposits. At the same time, low pressure water flows through the shaft to flush out loosened deposits, cool the brush, and shaft core.



The other side of the flexible shaft is connected to the Goodway tube cleaning system. The tube cleaner powers the flexible shaft which allows it to rotate, furthermore, the machine feeds water through the shaft so it comes out on the brush side.

More about flexible shafts

Goodway flexible shafts are available in various lengths:

- 3,6 meters (12')
- 5,2 meters (17')
- 7,6 meters (25')
- 10,7 meters (35')
- 13,7 meters (45')
- 15,2 meters (50')

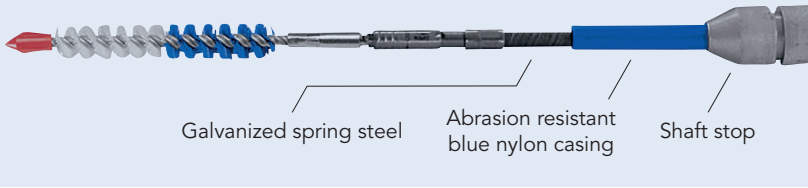

FLEXIBLE SHAFT DIMENSIONS

Shaft no.	Casing O.D.	Tool End Thread
GTC-701	6,4 mm	8-32 female
GTC-702	9,5 mm	1/4-28 female or Quick Connect
GTC-703	12,7 mm	1/4-28 female or Quick Connect
GTC-704	14,3 mm	1/4-28 female or Quick Connect
GTC-720	19,0 mm	1/2-12 female only

- 1 Quick connect only available for GTC-702/703/704 shafts.
- 2 Flexible shafts for the RAM-5 tube cleaner have "R5" in the part number. (Example: GTC-703Q-45-R5)

Example: a "GTC-704-35" shaft has an outer diameter of 14,3 millimeters and a length of 10,7 meters (35'). It has a threaded connection type. In case you would need a quick connect connection type, the correct product code would be "GTC-704Q-35".

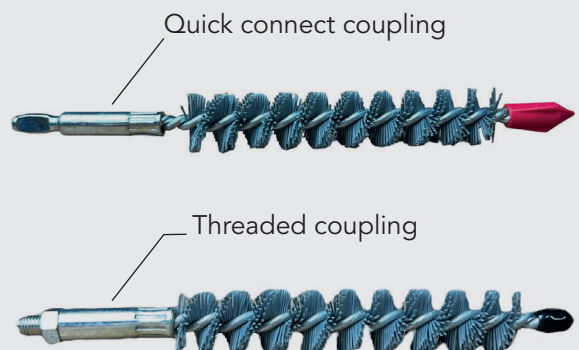
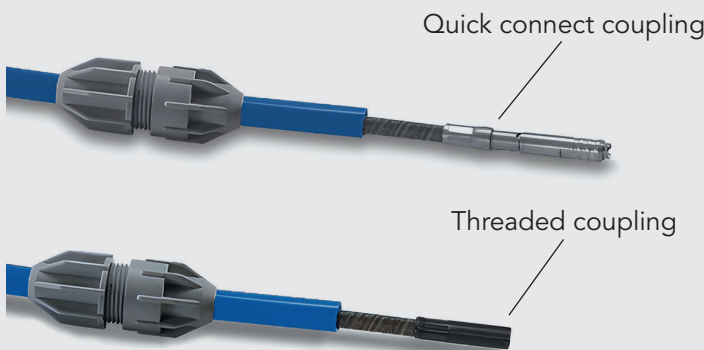

Quick connect versus standard threading

Goodway Benelux offers brushes and flexible shafts with standard threading or with quick connect brush fittings. Quick connect allows for quick changeover of brushes as well as bi-directional rotation, which increases the cleaning effect. All Goodway chiller tube cleaning systems are supplied with a dual foot switch, therefore we recommend using quick connect accessories.

THREADED COUPLING



Note: to order threaded, there is no "Q" in the part number.

QUICK CONNECT COUPLING



Note: to order quick connect, there will be a "Q" in the part number.

Maintenance of flexible shafts

After a wet tube cleaning of (for example) a chiller, some left over water will always remain inside the blue casing. If this water is not removed, it will cause corrosion and oxidation inside the shaft. This ultimately leads to shafts which cannot be used for the next job and/or have a significantly reduced total lifetime. It is therefore important to properly maintain the shafts after cleaning.

Contact Goodway Benelux for the shaft maintenance kit.

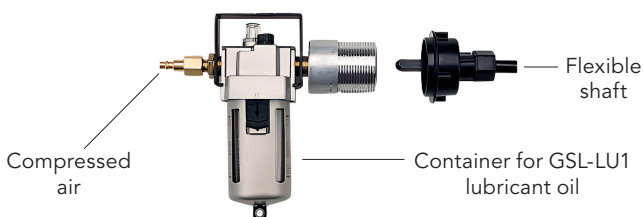

Specifications flexible shafts

Use the flexible shafts in combination with any Goodway tube cleaning system, brush, and tool. Make sure to select the correct flexible shaft for the job. Contact Goodway Benelux for the correct combinations of shafts and brushes.

- High quality flexible shafts for tube cleaning
- Galvanized steel core for optimal performance and lifetime
- With quick connect or threading brush fittings
- For tube I.D.'s 6,4 millimeter and higher
- Simultaneous water flush removes deposits

Goodway flexible shafts

Check out all the Goodway flexible shafts here →

