MANUAL AND INSTRUCTION

WESTBO CARL 95 electric



Westbo of Sweden

Do not install the electric fireplace directly on a carpet or other similar surface that may prevent the air circulation under the product.

After the electric fireplace is turned on and heated, the hot air outlet is at a high temperature. Do not place bedding, clothing, curtains, paper, etc. within 30 cm from the front of the electric fireplace and within 10 cm from the sides and back.

When turning off the electric fireplace and disconnecting the power, first turn off the electric fireplace with the remote control, and then unplug the power cord.

Do not place the electric fireplace in a humid environment, such as a laundry room, bathroom, etc.

When installing an electric fireplace, do not lay cables under carpets or flammables.

When using an electric fireplace near a patient or child, pay attention to safety and take extra care.

You must use a well grounded and fused socket.

When the electric fireplace is in a heated state and objects are covered or covered at the air inlet, the heating components may be overheated. At this time, the product overheat protection function will automatically cut off the input power.

After 8 minutes cooling down it is possible to restart the unit.

When using the cooking plate, the diameter of the bottom of the pot should not exceed 13cm. The electric ceramic cooking plate on the top cannot automatically be turned off by the power.

Please do not leave it on without attention to avoid boiling water overflowing and long term dry burning to cause potential hidden danger.



Westbo of Sweden

Product features

The Westbo Carl is a traditional Swedish cast iron stove.

In the past it was placed in small rooms or workplaces with little space and with the need for warmth. The handy stove is easy to place where the space is limited.

On the electric version the crown of the stove is removable, hiding an electric hot plate, suitable for cooking.

The simulated wood burning is made of environmentally friendly materials.

The surface treatment of sheet metal parts is made of high temperature resistant environmentally friendly plastic powder, and materials used are non-toxic and harmless, and meets the environmental standards.

The flame is realistic, using coated glass tredimensional imaging, with a real sense of presence.

The infrared remote control is used to control each function, and at the same time, the auxiliary sound and light prompt function informs the user of the current working state.

The body of the stove is made from cast iron.



Westbo of Sweden

Unpack the product, take out the top cover, electric ceramic stove, bottom feet and accessories,

Fasten the bottom feet to the bottom of the furnace body with the combination screws allotted.
See the figure below.

How to install

Place the electric fireplace in a safe and suitable location and ensure a distance of more than 30cm from combustible. Plug the power cord into the socket at the bottom of the product to ensure that the power cord is not blocked or crushed.

Plug the power cord into a wall outlet rated min.10A. When you hear a beep, it indicates that the power is on.

The power input method is shown in the following figure.

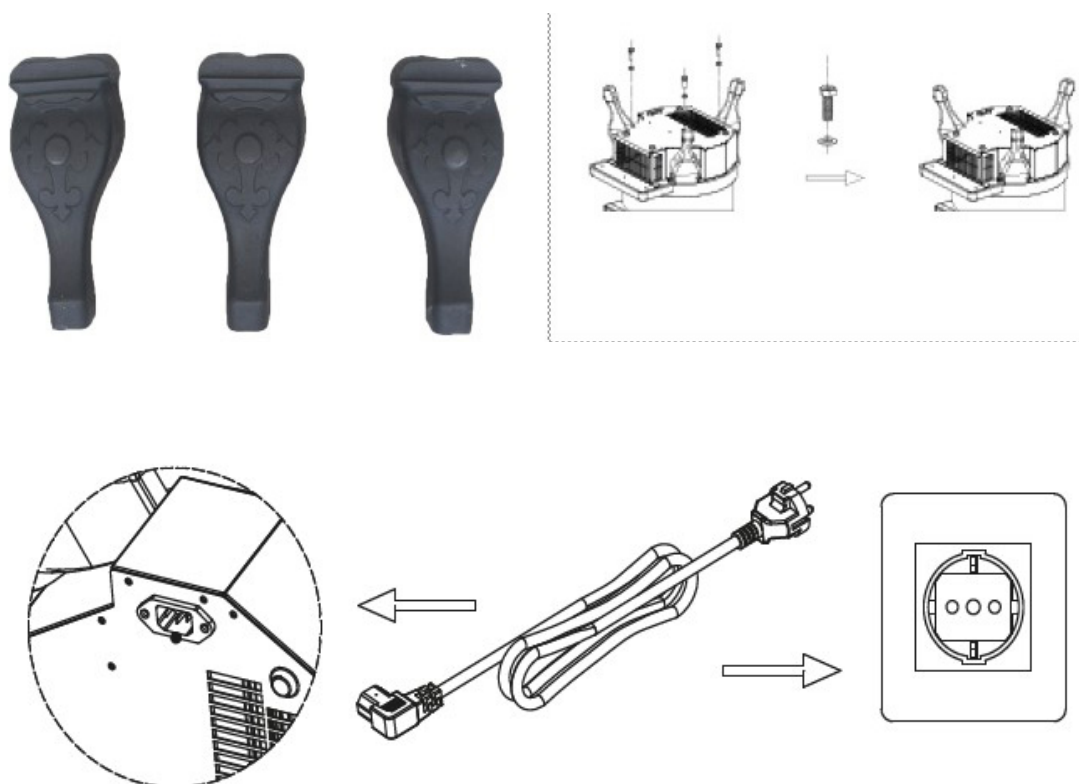

Westbo of Sweden

Remote control function



Turn on/off

Five levels of brightness, adjustment
(5-4-3-2-1, cycle in turn)

Low heat/high heat (press low heat once,
high heat two times, turn off heat three
times).

Heating status display (press this key, the
heating status indicator lights up, and auto-
matically turns off after three seconds)

Heating functions

Place the electric fireplace in a safe and suitable location and ensure a distance of more than 30cm from combustible. Plug the power cord into the socket at the bottom of the product to ensure that the power cord is not blocked or crushed.

Plug the power cord into a wall outlet rated min.10A. When you hear a beep, it indicates that the power is on.

The power input method is shown in the following figure.



Westbo of Sweden

Heating functions

- Low heat: Press the Heater button once, the internal buzzer of the product sounds "beep", the on the flame screen lights up for 3 seconds and then goes out.
- High heat, press the Heater button twice, the product buzzer sounds three "beep", the red light on the flame screen lights up for 3 seconds and then goes out.
- The location of the low heat and high heat indicator lights is shown in the figure below

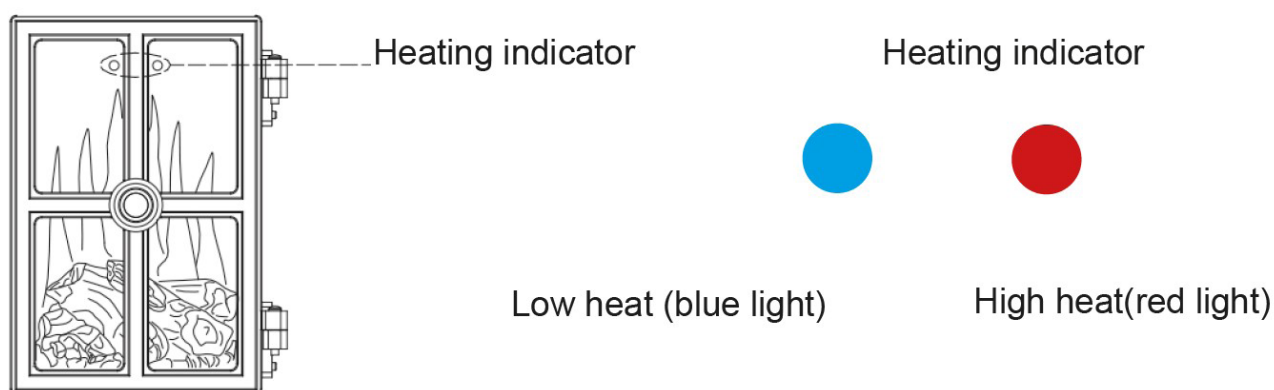

Cooking plate function

When using the cooking plate, the heat function on the stove will automatically go down to "Low Heat" this to prevent the maximum power greater than 2300w

- The cooking plate has five levels of heating the maximum output is 1000w

Note:

Its forbidden to use any other cooking plate than the one provided by Westbo of Sweden.



Westbo of Sweden

Maintenance and repair

1.The product cannot be turned on normally.

- Check whether the power input socket and the power plug are firmly connected to make sure there is power on the socket.

- The electric fireplace is controlled by an infrared remote control. Please check whether the remote-control battery is ok,Battery CR2025

2.The product cannot be turned on normally for heating.

- This electronic fireplace has an overheating protection system. If overheating occurs, the system will turn off the heater. If the heater stops working, please turn off the heater and check whether the air intake and exhaust are blocked.

- Unplug the heater, wait for the heater to cool completely, plug in the power to reset the system, and then try to turn on the electric

Packing list

- Electric fireplace 1 PCS
- Electric ceramic heaters 1 PCS
- Remote control 1 PCS
- Instruction 1 PCS
- Power cable 1 PCS



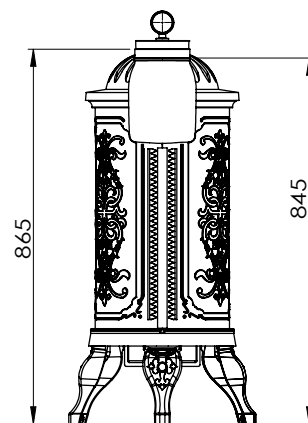
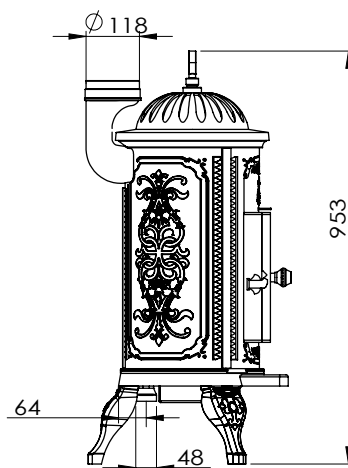
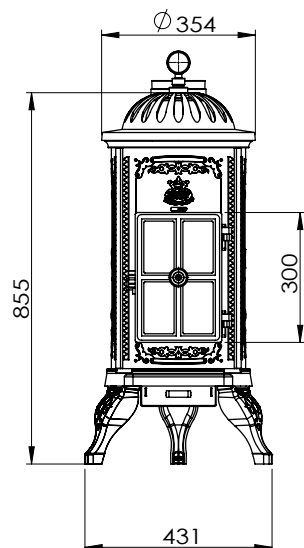

Technical data

Product name	Westbo Carl 95 electric
Weight	50 kg
Height	9530 mm
Width	443 mm
Deep	431 mm
Material	Cast iron
Rated Voltage	AC 230+/-10V
Rated power	1850 W

Westbo of Sweden AB
Industrigatan 8
333 75 Reftele, Sweden

Contact
Tel. +46 371 201 01
info@westbo.net
www.westbo.net



Westbo of Sweden