

byzoo
INNOVATIVE COOKING

WWW.BYZOO-GLOBAL.COM

byzoo
INNOVATIVE COOKING

HORIZONTAL SLOWJUICER

Rhino Series
www.byzoo-global.com



WARNING:

1. To reduce risk of injury, the user must read and understand this instruction manual before using this item. This appliance is intended for domestic use as described and in accordance with this instructions provided in this manual. For indoor use only.
2. Please read these instructions carefully and retain for future use.
3. KEEP THIS PRODUCT OUT OF THE REACH OF CHILDREN.



Big feeding
tube



43 rotations
per minute



Suitable for all kind
of fruits and vegetables



Beautiful
Design



Easy cleaning
system



Quiet
motor

CONTENTS

Contents	1
Dear Customers	2
General Description And Parts Names	3, 4
Warnings And Cautions	5
How To Use And Clean The Appliance	6
How To Use The Appliance	7, 8
Making Pasta, U-Dong, Noodle, Breadstick, Ice Cream Etc.	9
Choosing The Right Strainer	10
Troubleshooting	11
Appliance Specifications	12
Disposal Of Old Electrical & Electronic Equipment	13
Warranty	14

Congratulations on the purchase of your BYZOO RHINO HORIZONTAL SLOWJUICER. Please study these instructions carefully before use, paying special attention to the following guidelines.

Multi-Purpose Juicer and Food Processor

1. Fruit Juice Extractor The BYZOO RHINO HORIZONTAL SLOWJUICER efficiently juices soft and hard fruits.
2. Vegetable Juice Extractor The BYZOO RHINO HORIZONTAL SLOWJUICER juices all kinds of vegetables, including celery, carrots, peppers, radishes, cabbage without destroying the natural flavor and nutrition. Fresh taste, full nutrition are guaranteed with this extraction process.
3. Grass Juice Extractor Wheat grasses, aloe leaves and pine tree leaves are just some of the other natural products which can be juiced with the BYZOO RHINO HORIZONTAL SLOWJUICER. Enjoy the best that nature offers in raw foods of all kinds and juice them for full nutritional benefits.
4. Processing / Chopping Functions The BYZOO RHINO HORIZONTAL SLOWJUICER also chops and processes, providing natural flavor and nutrition from garlic, scallions, red pepper, ginger, radish and many other foods, including herbs and seasonings. Soft foods for special diets for babies and geriatric patients are quick and easy to prepare with the processing strainer.
5. Pasta Maker Make fresh noodles in just minutes with the handy pasta nozzles. See Page 9 for more information.

GENERAL DESCRIPTION AND PARTS NAMES

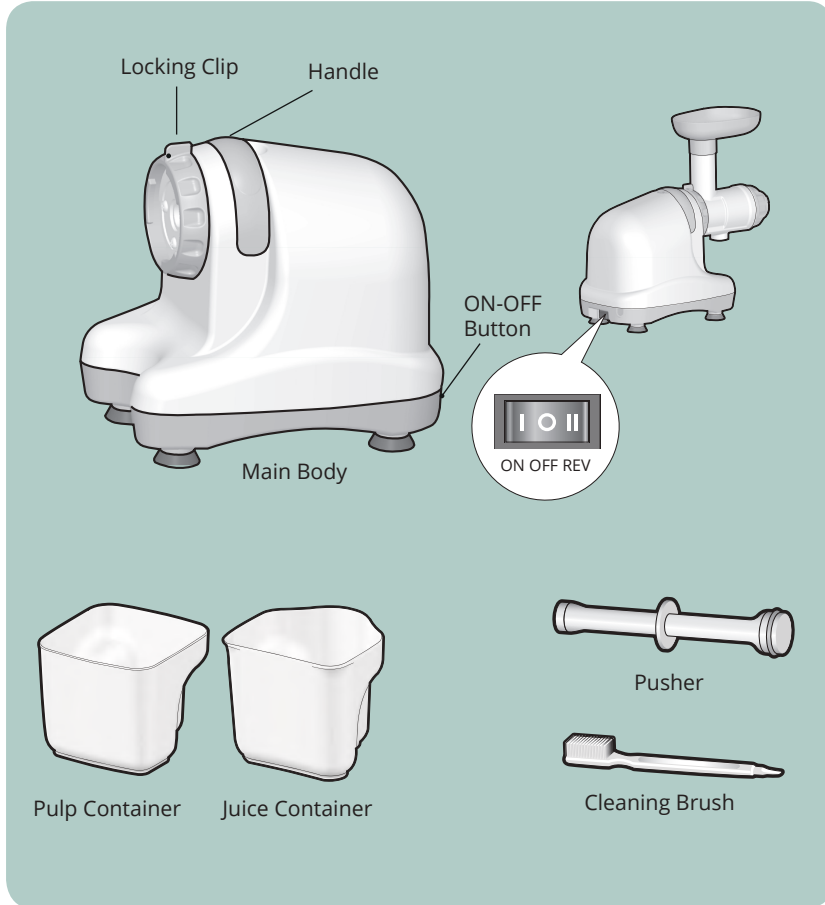

NUMBER OF ATTACHMENTS

1 Main body, 1 Juice container, 1 Pulp container, 1 Pusher, 1 Cleaning brush
 1 Hopper, 1 Drum, 1 Screw, 1 Juicing Strainer, 1 Mincing Strainer, 1 Drum cap
 1 Pulp ejection Cover, 2 Round noodle nozzle, 2 Flat Noodle Nozzle,
 2 Bread Stick Nozzle, 1 Instruction Manual.

GENERAL DESCRIPTION AND PARTS NAMES

Parts for Juicing

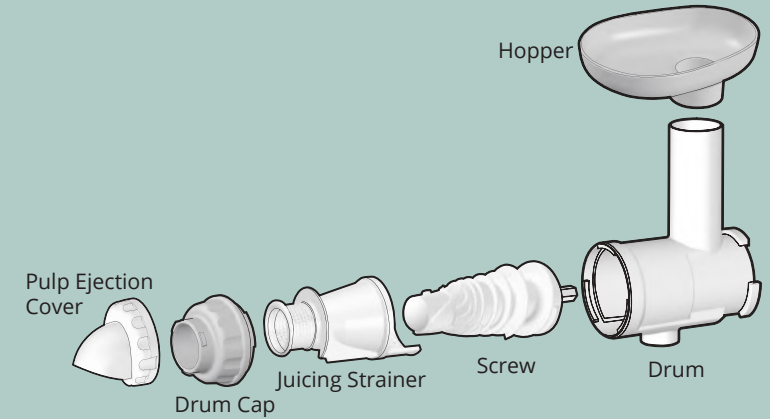

Parts for Mincing

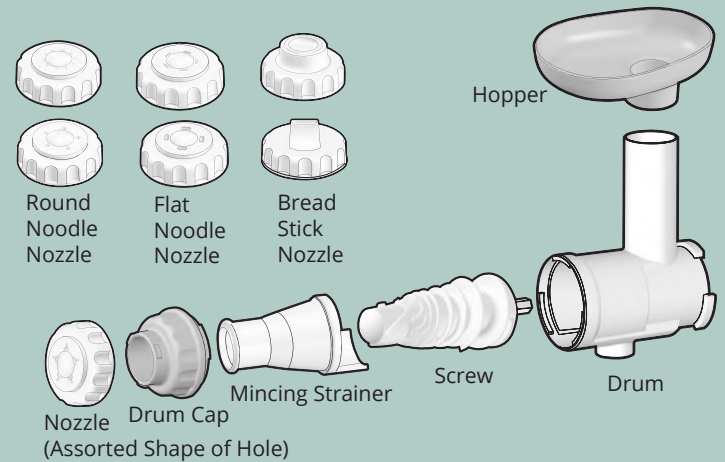

WARNINGS AND CAUTIONS

1. All users of this appliance must read and understand these safety precautions before operating.
2. Do not use other than 220V~240V AC.
3. To protect against risk of electrical shock, do not put the main body in water or any other liquid. Do not plug in or unplug with wet hands. Do not operate the switch with wet hands.
4. For safety, the appliance must be earthed. Do not earth to any gas pipe, plastic water pipe, telephone wire etc.
5. Close supervision is necessary when any appliance is used by or near Children.
6. Unplug from outlet when not in use, before assembling or taking of parts and before cleaning.
7. Place the appliance on a flat and stable surface. Avoid contacting moving parts.
8. Do not operate any appliance with a damaged cord or plug or after the appliance malfunctions, or is dropped or damaged in any manner. Return appliance to the nearest authorized service facility for examination, repair or mechanical adjustment.
9. The use of attachments not recommended or sold by the manufacturer may cause fire, electric shock or injury.
10. Do not let cord hang over edge of table or counter.
11. Always make sure juicer locking clip is locked while juicer is in operation.
12. Be sure to turn switch to off position after each use of your juicer. Make sure the motor stops completely before disassembling.
13. Do not put your fingers or other objects into the juicer while it is in operation. If food becomes lodged in opening, use food plunger or another piece of fruit or vegetable to push it down. When this method is not possible, turn the motor off and disassemble juicer to remove the remaining food.

HOW TO USE AND CLEAN THE RHINO

- 1 While the BYZOO RHINO HORIZONTAL SLOWJUICER can extract juice from unpeeled fruits and vegetables, we recommend you thoroughly wash and peel your fresh ingredients to remove accumulated chemicals.
- 2 Cut fruits or vegetables into small pieces (about 3 to 4cm) so that juice may be extracted more thoroughly.
- 3 Turn on the machine and let it run without interruption until all the juice has been extracted
- 4 If the juicer starts to vibrate slightly during operation, turn off the machine and empty the drum set. Re-assemble and resume normal operation.
- 5 After placing the last piece of fruits or vegetables into the hopper, keep the machine running for a few seconds longer to ensure the machine has extracted the last drops of juice.
- 6 Click [REV] to switch off machine. The motor does not stop immediately for safety reason. Clicking [REV] will slow the motor to a stop.
- 7 Clean drum set after each use of the BYZOO RHINO HORIZONTAL SLOWJUICER.
- 8 Do not operate the machine for more than 30 minutes at a time. Do not operate the appliance when the drum is empty.

CLEANING INSTRUCTIONS

Wash the BYZOO RHINO HORIZONTAL SLOWJUICER's screw and parts in warm, soapy water in your kitchen sink and rinse well. Do not place parts or accessories in a dishwasher or a dish dryer. Do not immerse main body in water or any other liquid, nor rinse it under tap. Always wash the drum set immediately after each use. Without wash-up, remained pulps get dried up and stuck onto it. It make difficult to disassemble or wash them. Also, it may cause degradation in performance.

HOW TO USE THE RHINO

- 1 Connect drum with main body by turning locking clip clockwise (about 60Degree). Place hopper onto guide.

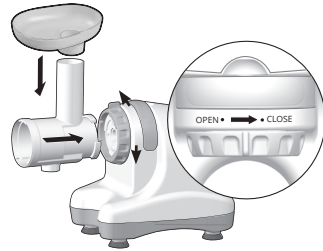

- 2 For juicing function:
Place the screw into the drum. Insert the juicing strainer into the drum. Place the drum cap onto the drum end and turn it counter-clockwise until it clicks firmly into place. Attach pulp ejection cover to the drum end cap.

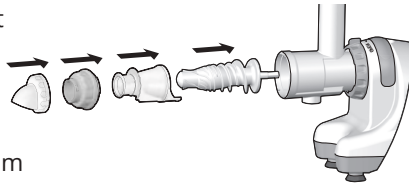

- 3 For mincing function:
Place the screw into the drum. Insert the mincing strainer into the drum. Place the drum cap onto the drum end and turn it counter-clockwise until it clicks firmly into place. If interested in making pasta, u-dong, please process to page 9.

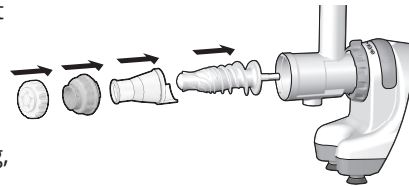

- 4 Place juice container and pulp container under drum set. Plug the power cord into a wall socket and push it tight.

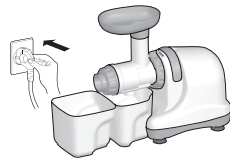

- 5 Press the ON button, Place a few piece of cut fruits or vegetables, one at a time into the guide. Use the pusher to press the fruits or vegetables gently down the guide. Leave the machine on as you feed in the fruits / vegetables.

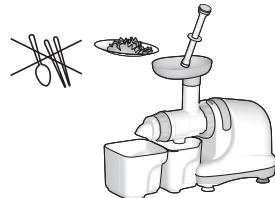

HOW TO USE THE RHINO

- 6 DO NOT place any metal objects into the hopper. If the drum set is plugged or the machine stops operating, press the REV button 2 to 3 minutes and press the ON button again to resume normal operation.

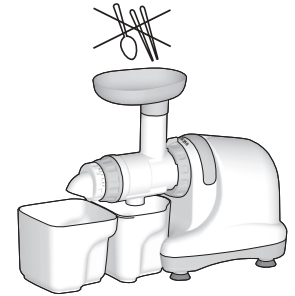

- 7 Switch the juicer OFF before changing accessories or touching any moving parts. Remove the drum set from the main body by turning the locking clip counter-clockwise. Pull the screw forward to disassemble if from the drum set. After juicing, wash all parts in warm soapy water. DO NOT wash any of the juicer accessories in the dishwasher or a dish dryer.

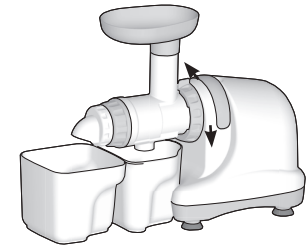

- 8 DO NOT operate the appliance for more than 30 minutes at a time.. As it may cause a motor failure due to over heating. After 30 minutes use, turn off the appliance and allow it to cool down for about 5 minutes then operate it again.

MAKING PASTA, U-DONG, NOODLE, BREADSTICK ETC.

- 1 Open drum cap.
Replace juicing strainer with mincing strainer.
Choose and place the desired nozzle into the front end of the mincing strainer.
Turn drum cap counter-clockwise until it clips firmly into place.

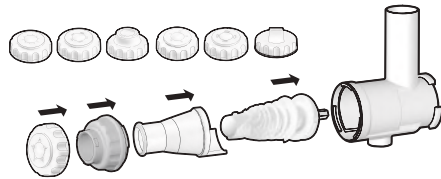

- 2 Sprinkle a small amount of wheat flour on the holding dish, placed under the spout.
Press ON button.
Push pasta dough through the food guide without stopping.

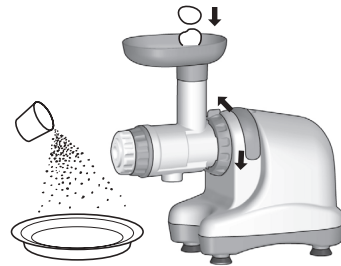

- 3 Use scissors to cut the pasta to desired lengths. Cook according to recipe used.



- 4 Disassemble unit and rinse all parts and accessories first in cold water.
Then wash in warm soapy water in your sink. Do not wash at a high temperature higher than 80 centigrade.
DO NOT put the appliance in a dishwasher, a dryer or a microwave etc.
DO NOT immerse the main body in water or any other liquid, nor rinse it under tap.

CHOOSING THE RIGHT STRAINER

Ingredient	Strainer
Apples, Oranges, Pears, Grapes, Strawberries, Kiwi fruit, Tomatoes, Avocadoes, Aloe plant, Pine tree leaves, Kale, Radishes, Beet, Spinach, Carrots, Yams, Wheat grass	Juicing Strainer
Red/green pepper, Garlic, Ginger, Herbs, Soaked rice and beans, Fresh fish and meat	Mincing Strainer
Pasta, U-dong, Noodle, Breadstick, Ice cream	Mincing Strainer

TROUBLESHOOTING

Check the details below before contacting your BYZOO distributor. If you need information or if you have a problem, please contact the local BYZOO distributor. When applying for after sales service, check the manufacturer's serial No. or barcode.

THE APPLIANCE DOES NOT WORK.

Make sure the power cord is properly plugged in. Check if the appliance has been assembled according to the manual in a proper manner. See the assembly in the manual or consult with the local BYZOO distributor for help. THE DRUM

CAP DOES NOT OPEN.

Is there a lot of pulp left inside the drum? Press [ON] button to discharge internal pulp. Open the drum cap by turning it in a clockwise direction. Do not attempt to open it by force or with too much pressure. If it still does not work following by the above process, contact the local BYZOO distributor.

IT STOPS DURING NORMAL OPERATION.

Have you used heavy loads of ingredient or thick or big ingredients? Read the manual Page 8 and follow [REV] button guideline. If the problem still has not been solved, contact the local BYZOO distributor.

THERE ARE THE GATE MARKS (FORMING MARK) RESULTING FROM THE MOLDING PROCESS.

It is normal part and there is no problem for use.

WHAT IS THE DIFFERENCE BETWEEN JUICING STRAINER AND MINCING STRAINER?

Use juicing strainer with 'small holes' in both ends if you want to make juice. Use the mincing strainer without 'holes' in both ends if you want to make pasta, noodles, breadstick, ice cream etc. Regarding strainer selection for suitable ingredients, read the manual Page 10.

THE DRUM SHAKES WHEN JUICING.

Slight shaking may be occurred due to motor movement. Large or small movements occur depending on the pulp texture of ingredients (hard or tough). It is normal when the screw is rotating. Please note that it is not malfunction. Hard ingredients (e.g: carrots/potatoes/radishes/beetroots,etc) may shake the bowl more than soft and juicy ingredient.

RHINO SPECIFICATIONS

Product Name:	BYZOO HORIZONTAL SLOWJUICER
Model No.:	RHINO
Rated Voltage:	220~240V
Rated Frequency:	50Hz
Rated PowerConsumption:	Max 250W
RPM(Revolutions Per Minute):	43-45RPM
Cord Length:	4.6Ft / 1.4M
Motor:	Induction Motor
Fuse:	5A
Weight:	Aprox 5.6Kgs
Overall Dimensions:	Width 11inch / 28.0cm Length 15.75inch / 40.0cm Height 13.2inch / 33.5cm
Rated Operating Time:	Less than 30 minutes

Due to on-going improvements programme, some specifications may change without notice.

DISPOSAL OF OLD ELECTRICAL & ELECTRONIC EQUIPMENT

Disposal of Old Electrical & Electronic Equipment (Applicable in the European Union and other European countries with separate collection systems).



This symbol on the product or on its packaging indicates that this product (including batteries) shall not be treated as household waste. Instead it shall be handed over to the applicable collection point for the recycling of electrical and electronic equipment. By ensuring this product is disposed of correctly, you will help prevent potential negative consequences for the environment and human health, which could otherwise be caused by inappropriate waste handling of this product. The recycling of materials will help to conserve natural resources.

For more detailed information about recycling of this product, please contact your local Council, your household waste disposal service or the shop or source where you purchased the product.

WARRANTY

10 Years Warranty on Motor, 5 years on parts and Labour

We warrant this BYZOO HORIZONTAL SLOWJUICER to be free of defects: In materials and workmanship while in normal domestic use for a period of five years for plastic parts and the squeezing screw and 10 years on the motor, from the original date of purchase.

If the BYZOO HORIZONTAL SLOWJUICER exhibits a defect while in normal domestic use, within the warranty period, we will either repair or replace the BYZOO HORIZONTAL SLOWJUICER or the defective part free of charge provided that it is delivered by insured carrier, in proper packaging* to your service centre as indicated on the back of the manual as a condition to any warranty service obligation.

This Warranty Does Not Cover:

Damage, accidental or otherwise, to BYZOO HORIZONTAL SLOWJUICER, not caused by any direct defect in factory workmanship or material. Damage due to abuse, mishandling, alteration, misuse, commercial service, tampering, accident, failure to follow care procedures, operating and handling indicated in the operating manual. Damage caused by parts or service not authorised or performed by BYZOO distributors. If your BYZOO HORIZONTAL SLOWJUICER was damaged in shipment to you, immediately report this type of damage to the parcel carrier and have them file an inspection report to contact the distributor from whom you purchased the BYZOO HORIZONTAL SLOWJUICER for further instructions. Do not send your BYZOO HORIZONTAL SLOWJUICER back to the service centre without returning authorization. In no event shall our liability exceed the retail value for the BYZOO HORIZONTAL SLOWJUICER. We make no warranty with respect to parts from a source other than BYZOO distributors. This warranty gives you specific legal rights and you may also have other rights, which vary, from country to country or state to state. In order to get the best use from your BYZOO HORIZONTAL SLOWJUICER, read and follow the instructions in your Instruction Manual.

Sincerely

byzoo

* SAVE ORIGINAL PACKAGING AND SHIPPING BOX.