

TANKKD

A HASTINGS ORIGINAL

Users Manual



Part 1: Installation with only sand filter pump



Placing inlet-outlet connectors:

Place the inlet-outlet pieces in the correct place on the holes you have made or made in the stock tank as shown in the photo above.

The inlet goes at the bottom and the sealing ring is always placed on the inside of the tank.

The outlet goes at the top, also here place the sealing ring also on the inside of the tank.

Place the supply taps at the end of the inlet and outlet.

Connect this, turn off the supply taps, and while you do the rest of the installation, you can already fill your tank.

You just need to use the inlet outlet connectors provided by us, not the ones in the box

2. Sand filter pump installation

The installation of the sand filter pump can be found in the manual supplied by the manufacturer. We list the most important things, so that you can enjoy it quickly.

Remove everything from the box and place the two supplied hoses on the taps on the tank.

Place the pump and sand filter in the desired location and connect the inlet hose to B on the pump. Connect the other hose to A on the sand filter. You can find these letters on the sand filter pump itself. Do not forget to place the supplied sealing rings in order to prevent water leakage to the connections.

Place the filter medium in the sand filter (Glass beads, sand, Polysphere) and close it completely with a screwdriver (cross).

Put everything in the right place and ensure a good connection to the electricity.

Set the sand filter pump to on and the lever to backwash if you are not using polysphere. Then put it on the "play" button and your water will soon flow through the sand filter pump and filter.

We recommend cleaning or replacing your filter medium every month.

PART 2: Installation with heater 39 KW or 19 KW and sand filter pump.

This installation differs slightly from the installation without heater 39 KW or 19 KW.



Placing inlet-outlet connectors:

Place the inlet-outlet pieces in the correct place on the holes you have made or made in the stock tank as shown in the photo above.

The inlet goes at the bottom and the sealing ring is always placed on the inside of the tank.

The outlet goes at the top, also here place the sealing ring also on the inside of the tank.

Place the supply taps at the end of the inlet and outlet.

Connect this, turn off the supply taps, and while you do the rest of the installation, you can already fill your tank.

Then close the supplied bend on the outlet, with Teflon on the thread if necessary, to connect the heat-resistant hose later in the installation.

2. Installation sand filter and stove

Place the pump and sand filter in the desired location and connect the inlet hose to B on the pump.

Place the filter medium in the sand filter (Glass beads, sand, Polysphere) and close it completely with a screwdriver (cross).

Then place on the sand filter on A the other bend supplied.

Do not forget to place the supplied sealing rings in order to prevent water leakage to the connections.

Use Teflon on the thread where you connect the bend to avoid leaks.

Slide the hose clamps over the two heat hoses provided at each end. TIP: Use oil to let it glide smoother

Place one end on the sand filter pump on elbow A, the other end on the bottom opening of the stove. Tighten both of these securely with a wrench until completely tight.

Then place the other heat hose on the bend of the outlet, the other end on the top opening of the heater. Tighten both of these securely with a wrench until it is also completely tight.

With the supply taps you can control the use so that the water flows faster and / or slower to regulate the temperature of your water. In the beginning, set 1 of the 2 taps to a quarter and as the water gets warmer, slowly turn it on until it is fully open.

ATTENTION! ALWAYS TURN ON THE PUMP WHEN USING THE HEATER

PART 3: Installation with heater 39 KW or 19 KW direct.

Placing inlet-outlet connectors:

Place the inlet-outlet pieces in the correct place on the holes you have made or made in the stock tank as shown in the photo above.

The inlet goes at the bottom and the sealing ring is always placed on the inside and outside of the tank.

The outlet goes at the top, also here place the sealing ring on the inside and the outside of the tank.

Place the supplied supply tap at the end of the inlet.

Then connect the supplied pieces to the outlet and the inlet, with Teflon on the thread if necessary, to connect the heat-resistant hose later in the installation.

Make sure the heater is not too far from the tank, maximum 50cm

Always place the 19KW heater lower than the tank, the 39KW may be placed at the same height, to guarantee the natural flow.

Place the hose clamps on both ends of the heat hoses before installing

Place one heat hose on the inlet and bottom opening of the stove and tighten the hose clamps at both ends securely.

Then place the other heat hose on the piece of the outlet, the other end on the top opening of the heater. Tighten both of these securely with a wrench until it is also completely tight.

!!!:

Always put the stove on stable underground

Use dry wood

If you work without a pump there must always be natural circulation, otherwise the stove will overheat, resulting in broken glass or complete collapse of the stove.

Do not leave the stove unattended.

At temp. below zero drain the heaters and pumps (taps are provided on both models).

You must always maintain a good fire to obtain optimal heating.

The heaters can become warm when connected without a pump. Be careful !

The chimney elements are always placed seam on seam and slide together very easily if you place the right sides together. Do not FORCE these.

Always use sealing rings with the coupling pieces!

We supply 3 m heat hose when installed with a pump. If you want longer ones, you can always order extra

EXTERNAL WOOD BURNER FOR HOT TUB SET

1. External wood burner
2. Ash arrester
3. Fireplace grates
4. Connecting clamp for a traction barrier
5. Traction barrier- chimney coupling
6. Chimney 1.0 m – 2 pcs.
7. Rain cap

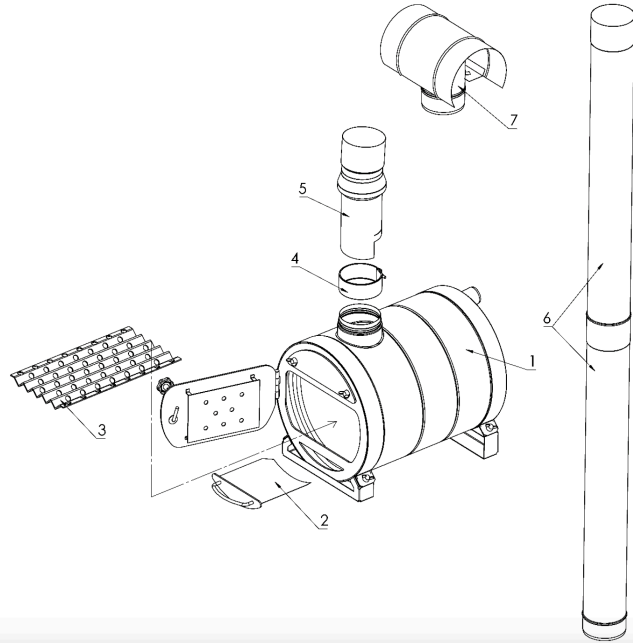

Ideal set up



FAQ:

Use as few chemicals as possible to extend the durability of your tank. If corrosion occurs, you can remove it with mixtane paint, and your tank can withstand it for at least an extra 5 years.

If you are not using your tank for a longer period of time, please empty it and place it with the bottom up.

After all, standing water is not good for the galvanized layer.

If you work with a sand filter pump, set it up daily for at least 4 hours, this can be done manually or via the automatically integrated program (see manual supplied with the relevant sand filter pump)

!! Never leave children unattended.

!! in extreme heat the edges of the stock tank can become warm: Watch out or use pool noodles

When using a combination stove, sand filter pump, always let the pump run during use and until at least 1 hour after the end of the heating session, to prevent overheating of the stove, which leads to damage for which we cannot be held liable.

TANKKD BV is not responsible for any accidents or incorrect manipulation and / or installation of the delivered products.