

# Xplore

## Quick Start Guide Smart Dashcam

### / HELLO

Thanks for choosing Xplore Dashcam.

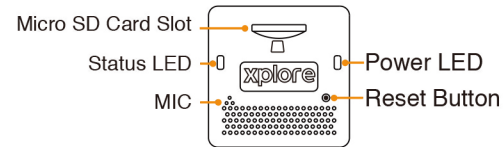

#### Status LED

Recording	GREEN	Low Power 10%	RED Flash
Recording / Card Error	OFF	Low Power 20%	RED
Snapshot	GREEN Flash	Charging	BLUE Flash
WiFi Error	RED	Full (Charged)	GREEN
GPS Error	YELLOW	Upgrading Firmware	GREEN Flash
Snapshot Remote Error	BLUE		

#### Power LED

### / TURN ON AND OFF

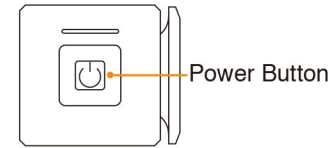

#### AUTOMATIC

Xplore C1+ Dashcam starts recording when the engine starts, and powers off 20 seconds after the engine stops.

#### MANUAL OVERRIDE

Turn ON: Hold the Power Button for 2 seconds.  
Turn OFF: Hold the Power Button again for 3 seconds.

#### SNAPSHOT MODE

When recording, press the Power Button. Xplore C1+ takes a picture and saves a 12 second video clip.

### / IN THE BOX

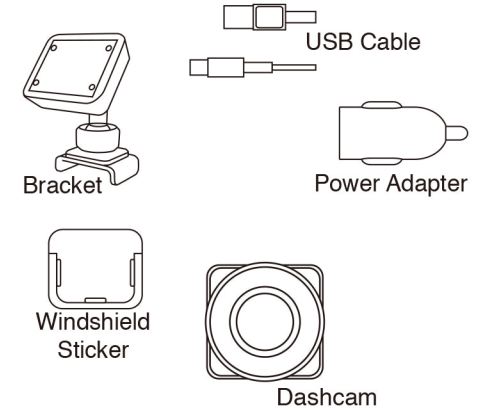

### / IN YOUR CAR

- 1 Clean the windshield and choose a position where the Dashcam will not block the driver's view. A recommended place is behind the rear view mirror. Place windshield sticker.  
Tip: Put the hexagon mouth of sticker upside-down.

- 2 Insert a Memory Card (SDHC Class 10 or above) into the Dashcam.

- 3 Mount the Dashcam onto the Bracket.

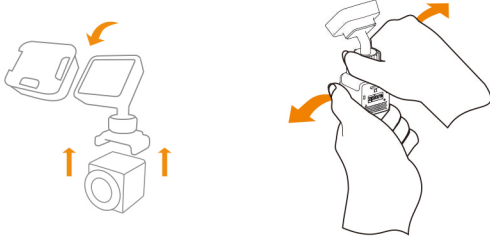

- 4 Fix the Bracket to the Windshield Sticker.
- 5 Fit the USB Cable to the Bracket and fix Cable in car. (The cable can be hidden and fixed with cable clips if desired).
- 6 Plug in the Power Adapter to the car's cigar lighter.
- 7 Insert USB Cable into Power Adapter.
- 8 Your Xplore C1+ is ready to go.

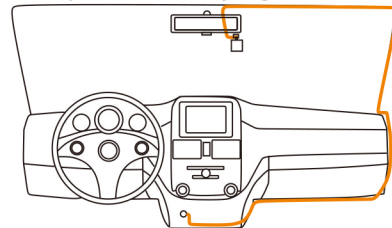

### / Xplore C1+ APP

Go to our website at [www.amacam.com](http://www.amacam.com) to download the App, or search for xploreCam on the AppStore or Google Play.

### / WIFI CONNECTION

Switch on your smartphone's WiFi. Search for SSID 'XPLORE\_xxxxxx' to connect. The initial password is 12345678.

### / FAQs

- 1 **Dashcam won't record**  
Make sure you are using a SDHC rapid storage card (Class 10 or above) from an authorized seller. Check if there's enough space on the memory card. Format the card if necessary.
- 2 **Dashcam is hot**  
Heating is normal, and the normal operating temperature is between -20°C and 70 °C.
- 3 **Dashcam has crashed**  
Use a paperclip to press the Reset Button.
- 4 **What's the maximum capacity of memory card? When can a memory card be inserted or removed?**  
32 GB. Insert and remove the memory card when Dashcam is turned off.
- 5 **What's seamless loop recording?**  
When the memory card is full the Dashcam will automatically overwrite from the earliest recording. Protected files and emergency recording will not be overwritten.