

# Owner's Manual

MS02

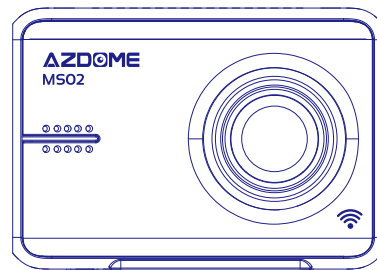

KAKA GROUP LTD  
www.azdome.hk info@azdome.hk  
Address : 1801-1808, HaiYun Building, No. 468, Minzhi Avenue,  
Longhua New District, Shenzhen, China. 518000, CN



**AZDOME**

---

• CONTENT

---

<b>1. INTRODUCTION</b>	02
<b>2. PRODUCT DIAGRAM</b>	03
<b>3. BUTTON FUNCTION</b>	04
<b>4. INSTALLATION GUIDE</b>	05
<b>5. SETTING</b>	06
5.1 VIDEO SETTING	06
5.2 PHOTO SETTING	08
5.3 PLAYBACK SETTING	08
5.4 SYSTEM SETTING	09
<b>6. ABOUT WI-FI</b>	13
<b>7. UPDATING THE FIRMWARE</b>	13
<b>8. WARRANTY &amp; SUPPORT</b>	14

## • 1.INTRODUCTION

Thank you for purchasing AZDOME MS02 Wi-Fi enabled Full HD Digital Vehicle Dash Cam... Besides seamless loop recording it provides high quality image capture & irrefutable evidence for what goes on from the perspective of your dashboard.

### Product Overview:



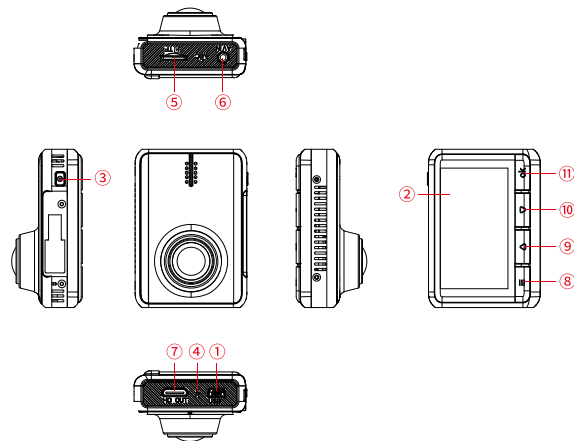

This Product is a leading Full HD Digital Vehicle Black Box Recorder. Equipped with Super-HD 1080P@30fps with Sony IMX 323 Sensor for state of the art low light sensitivity and high dynamic range which allows you to record continuous high-quality video playbacks, it brings phenomenal Full HD resolution videos even at night time without the need for infrared sensors. It has superior night vision technology which captures super low light during night time. It has advanced built-in Wi-Fi, G-Sensor, Emergency Video Lock, Audio Recording, Loop Recording, Motion Detection, 24 Hours Parking Mode (Required with Hardwiring kit) and HD Out. When compared to most dash cam, this exclusive product design provides an elegant appearance, packed with top rated unique features, superb unbeatable video recording and it is very easy to use.

## • 2.PRODUCT DIAGRAM

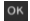

① Mini USB port	② IPSScreen	③ Power	④ Reset
⑤ TF card port	⑥ AV-OUT	⑦ HD Port	⑧ Menu
⑨ Up	⑩ Down	⑪ OK	

### • 3. BUTTON FUNCTION

Button	Function
	Click to confirm a selection
	Page up Turn On/Off Volume( Press&Hold for2 seconds) Capture(Press&Hold for2 seconds)
	Page down Switch Wi-Fi (Press&Hold for2 seconds)
MENU	Mode Switchover Enter setting menu SOS lock file
	Turn On/Off
Reset	Reset

#### Power On

Dashcam will automatically power on and start recording, when start the engine of the car.

You still can press power button which is on the top side of the dashcam.

#### Power Off

When the car' s engine is turned off, the device will automatically turn off within few seconds.

At other times, press and hold the power button for at least 3 seconds to turn off the device.

#### Reset hole

The reset hole is on the left side of the dashcam marked with "R", If crash

happens, please press the reset hole and reconnect the power to restart the device.

### • 4. INSTALLATION GUIDE

1. Turn off the car engine

2. Insert the TF card into the card slot of dash cam

**【Attention】**Please use high-speed SD card (Class10 or above, and Remember to format the SD card with the machine after power on)

3. Fix the dash cam on the front windshield of the car

4. Connect the dashcam USB charging port with the car USB adapter with the charging cable.

**【Attention】**Hide the cable alongside the edge of windshield.

5. Insert the USB adapter into the car cigarette lighter

7. Adjust the lens position to ensure that the lens are level with the ground.

8. Start the engine, dashcam will power on automatically, and then check whether the device is installed correctly.

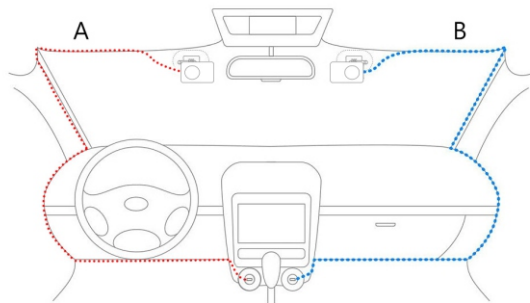

---

## • 5.SETTING

---

### 5.1: Video Setting

To Enter Video Setting:

- Make sure you are under Video Mode
- Press "MENU" button ONCE to enter Video Settings
- Press "DOWN" button to access video settings.
- Now use "UP" or "DOWN" buttons to scroll through > then press "OK" button to enter particular setting > then select the setting you prefer to set > then press "OK" button again to confirm that setting and go back to video settings menu

#### a. Resolution

- 1080P FHD 1920 x 1080 (Default)
- 720P 1280 x 720P
- WVGA 848 x 480
- VGA 640 x 480

#### b. Loop Recording

- Off
- 1 Minute
- 3 Minutes(Default)
- 5 Minutes

#### c. WDR (Wide Dynamic Range)

WDR improves the exposure by taking the combinations of over exposed and under exposed image into one robust wide range of lighting with Higher depth image.

- Off (Default)
- On

#### d. G-Sensor

Off / Low / Medium / High

Default is "Medium"

G-Sensor is a 3-axis impact gravitational accelerometer which is designed to detect physical and gravitational forces on the camera.

While Video is Being Recorded: In the event when G-Sensor is triggered due to physical or gravitational impact force on the camera, the current Loop cycle length of video file will be locked so it will NOT be deleted by Loop cycle function.

CAUTION: In the event of an accident please make sure you retrieve your footage before using your camera again to prevent the loss of important Video file due to the loop cycle function, in case the force was minor which did NOT trigger G-Sensor to lock video file automatically. It is best practice and recommended for you to retrieve all necessary video footage after any event of accident before using your camera to prevent loss of vital video file.

#### e. Exposure

Adjust video exposure setting for either brighter or darker video according to your preference.

- 0.0 (Default) Camera will set exposure automatically.
- -2,-1.7,-1.3, -1.0, -0.7, -0.3, 0.0, +0.3, +0.7, +1.0, +1.3, +1.7, +2

#### f. Motion Detection

- Off (Default)
- On

CAUTION: Motion detection is designed to work only when you are parked and camera/car is NOT moving continuously. NEVER have this feature (Motion Detection) Turned ON during driving. Otherwise you will have missing video seconds.

It is NOT designed to work while driving or commuting.

#### **g. Microphone**

AZDOME MS02 has built in microphone to record audio with video. You can choose to record mute video by choosing OFF. You can also press UP Button to mute/un-mute while video is being recorded.

- Off
- On (Default)

#### **h. Date stamp**

This option allows you to turn On/Off the Date Stamp on the bottom of the video.

- Off
- On (Default)

### **5.2: Photo Setting**

Only Support "Capture Mode" (Press&Hold "Up" button for 2 seconds)

### **5.3: Playback Setting**

To Enter Playback Setting:

- Press & Hold "MENU" button for 2 seconds to enter Playback Mode.
- Press "MENU" button ONCE to enter Play Settings.
- Press "DOWN" button to access Play settings.
- Now use "UP" or "DOWN" buttons to scroll through > then press "OK" button to enter particular setting > then press "OK" button again to confirm that setting and exit to playback settings menu.

#### **a. Delete**

This menu will allow you to delete current video or delete All.

- Delete Current

(Delete current video file on LCD)

- Delete All

CAUTION: These will Delete Entire Video & Photos from Memory card-Except the protected files.

#### **b. Protect**

This feature will allow you make desired changes to saved video & photo files on memory card.

- Lock Current
- Unlock Current
- Lock All
- Unlock All

#### **c. Slide Show**

This feature allows you to view slide show of your captured photo images from memory card.

- 2 Seconds
- 5 Seconds
- 8 Seconds

### **5.4: System Setting**

To Enter Playback Setting:

- Press "MENU" button two times to enter System Settings.
- Press "DOWN" button to access System Settings.
- Now use "UP" or "DOWN" buttons to scroll through > then press "OK" button to enter particular setting > then select the setting you prefer > then press "OK" button again to confirm that setting and go back to System Settings menu.

#### **a. Wi-Fi**

This feature will allow you to turn Wi-Fi broadcast On.

Shortcut: Press&Hold "Down" button for 2 seconds to turn Wi-Fi On/Off

Default Password : 12345678

- On
- Off (Default)

#### **b. Date/Time**

Tap to adjust the value >> tap to next option >> tap to save

#### **c. Auto Power Off**

This feature allows the device to be turned Off automatically based on desired settings below, when video is not being recorded and camera is idle for that amount of time.

- Off (Default)
- 3 Minutes
- 5 Minutes
- 10 Minutes

#### **d. Key Tone**

This feature allows you to turn On/Off camera button's beep sound

- Off
- On (Default)

#### **e. Parking Mode**

NOTE: 24 Hours Parking Mode required a Hardwiring Kit connected Ensure a

Hardwiring Kit connected

- No. Press No, you will return to the setting menu, because the Parking Mode only supported when there's a Hardwiring Kit connected.
- Yes. Press Yes and enter Parking Mode setting, then press Off/On to set the Parking mode Off/On.

After connected a Hardwiring Kit, confirmed Parking mode is "On", the dashcam will be in stand-by mode(on but not recording, even though the car is "Power

Off"). Due to the triggering of G-sensor and Motion Detection, when a motion is detected a 1 Minute normal video will be recorded, when a impact is detected a 1 Minute emergency(locked) video will recorded, after 1 minute dashcam will enter "Screen Saver" mode.

#### **f. Language**

- English (Default)
- French
- Spanish
- Portuguese
- Deutsch
- Italian
- Simplified Chinese
- Traditional Chinese
- Russian
- Japanese
- Thai
- Polish

#### **g. Watermark**

- Off
- On(Default)

#### **h. AV Out**

Here you can choose your TV mode based on your country's AV setting

- NTSC (Default)
- PAL

#### **i. Screen Saver**

By turning ON this feature, the camera will automatically turn the display screen off.

- Off
- 1 Minute
- 3 Minutes(Default)
- 5 Minutes

#### **j. Frequency**

Here you should choose the frequency accordingly to your power supply specification used in your country based on your geographical location.

- 60 Hz - USA-North America
- 50 Hz - Europe- Most Asian Countries (Default)

#### **k. Format**

Performing this operation will format the memory card, deleting all the data. (NOT Retrivable)

It is recommended that you keep an eye on your memory card periodically to make sure recording optimally.

We recommend you format the memory card every 3 months to keep it clean and for smooth operation.

Please note that memory cards have their life span, after so many user of over writing data they will become in operable. When that happens, please replace your memory card.

#### **l. Default Setting**

Here you can restore all the settings to factory default settings.

- Cancel
- OK

#### **m. Version**

Latest version

---

## **• 6. ABOUT WI-FI**

---

### **a. Download the APP**

Search for "AZDOME" in App Store or Google Play Store, and install into your smart phone..

### **b. Connect with Dashcam**

- Press & Hold Wi-Fi button("Up" button) for 2 seconds. Wi-Fi will be switched on.

- CONNECT Wi-Fi

Phone Settings > Wi-Fi > Select dashcam Wi-Fi

Name SSID: Model No\_\*\*\*\*\*

PASSWORD: 12345678

- Open the APP, will connect automatically.
- Disconnect Wi-Fi: Press and hold "Up" button for 2 seconds.

---

## **• 7. UPDATING THE FIRMWARE**

---

The dashcam has the latest firmware installed in the factory. The firmware is updated regularly to introduce new functions and improve the general performance. When the camera is not responding and resetting doesn't help, it is sometimes useful to update to the latest firmware. The latest version of the firmware is available from <https://www.azdome.hk/downloads.html>.

To update the firmware please follow these steps:

Put an empty Micro SD card in your PC and remove all files and folders.

Download the latest firmware, make sure to select the right model.

Put the downloaded file (ending with .bin) on the root of the Micro SD card.

Turn off the dashcam and insert the Micro SD card in the dashcam.

Turn on the dashcam.



The dashcam will update the firmware automatically, this may take a few minutes. Make sure not to turn off the power as this might interfere with the updating process. If the update is successful, the dashcam will power on by itself.

---

#### • 8: WARRANTY & SUPPORT

---

We provide a one year limited warranty for your product from the date of purchase to be free from defects in materials and craftsmanship.

For questions, support, or warranty claims, contact us at [info1@azdome.hk](mailto:info1@azdome.hk)

#### **IMPORTANT:**

Proof of original purchase is required for any warranty service. AZDOME can only provide aftersales service for products purchased directly from AZDOME. If you purchase from our official distributors or dealers, please contact them directly.