

ELECTRIC TOWEL RACK INSTALLATION INSTRUCTIONS

Thank you for choosing to use Funmax Electric Towel Rack series. Before using this product, please read the following product manual carefully. The company has many years of experience in providing high-quality 304 material electric heating towel rack products for users in Europe, Australia, North America and other countries. Since 2014, our electric heating towel rack products have obtained CE, SAA, CQC quality certification. This manual is only applicable to SEASONS series towel rack structure products. The actual product shall prevail, and the pictures are for reference only. If you have any questions in use, please consult our customer service .

Special Note: All contents in this manual have been carefully checked. If there are any printing errors or omissions or misunderstandings in the contents, the company reserves the right to interpret. The products are updated without prior notice.

May Funmax electric heating towel rack bring convenience to your life!

Precautions for safe use:

1. This product is only used for drying and washing textiles such as towels and bath towels. Silk fabrics such as silk scarves and scarves are prohibited from drying.
2. This product must be equipped with a fixed wiring and power cut-off device, and must be connected to an indoor over current protection device;
3. The voltage of the product is 220V-240V,
4. It is forbidden to use this product when the heating element or shell is damaged;
5. The power cord provided by this product is 3 cores, and the product must be grounded to avoid potential safety hazards and dangers;
6. When installing and maintaining the product, it must be powered off;
7. If the internal power cord of the product needs to be changed or the power cord needs to be repaired, it must be replaced by the manufacturer, or replaced by a service agent authorized and approved by the manufacturer to ensure safety and avoid injury;
8. If the external wiring device needs to be repaired, the power supply must be completely cut off;
9. Those without experience in electrical safety operation should use it under the supervision and guidance of professionals and ensure its safety;
10. This product is an electric heating product and cannot be used as a toy by children, and children cannot use this product without parental supervision.

Warning: This product should be installed or used as far away as possible from shower rooms, bathtubs, or places that are easily splashed by water



Installation and Usage Tools:

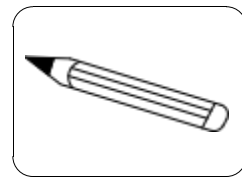

Marker Pen

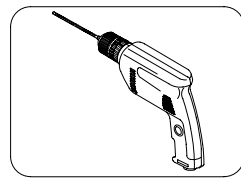

Electric Drill

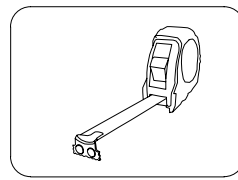

Tape Measure

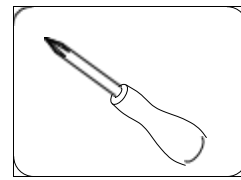

Cross Screwdriver

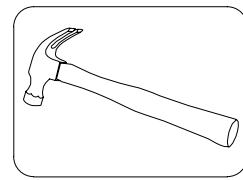

Hammer

model	White colloidal particles(φ 8*40)	Cross recessed pan head tapping screw(ST5*45)	Cross recessed pan head bolt (M5*16)	Cross recessed flat countersunk head bolt(M5*16)	Fixed base
F-CR04P	Five	Five	four	four	one

Note: General installation instructions for rotating models, it is recommended to install at a height of 1200MM from the ground.

Unilateral Hidden Line Installation Schematic Diagram

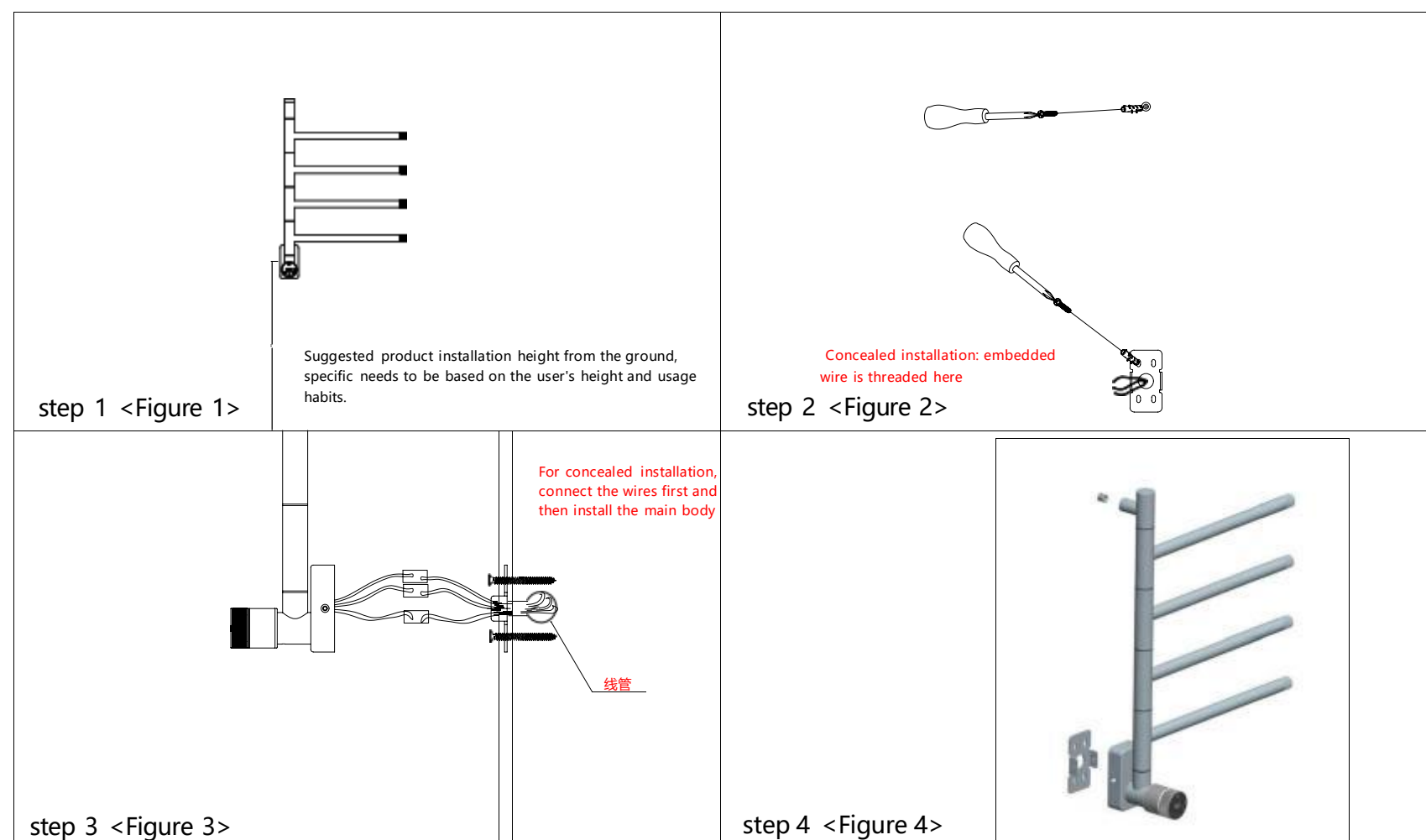

Note: This product is designed for both surface mounting and concealed installation. For concealed wiring, simply cut the power cord and connect the product power cord to the pre-prepared power cord on site.

Step 1:: Select the installation location for the product and position it accurately. Use a hand drill to reserve the hole positions.

(For concealed installation, bury the wire tube before laying the ceramic tiles and leave out the outlet holes. Pay attention to avoid the screws for product fixing to prevent the screws from piercing through the wires)

Step 2:: Place the rubber particles in the pre-drilled installation holes and tighten them with screws. (For concealed installation, pull out the wires before installing and fixing the main body)

As shown in Figure 2

Step 3:: Install the towel rack onto the installed hanging base and lock the base with the dedicated screws of the towel rack body. (For concealed installation, connect the wires first and then install the main body)

As shown in Figure 3

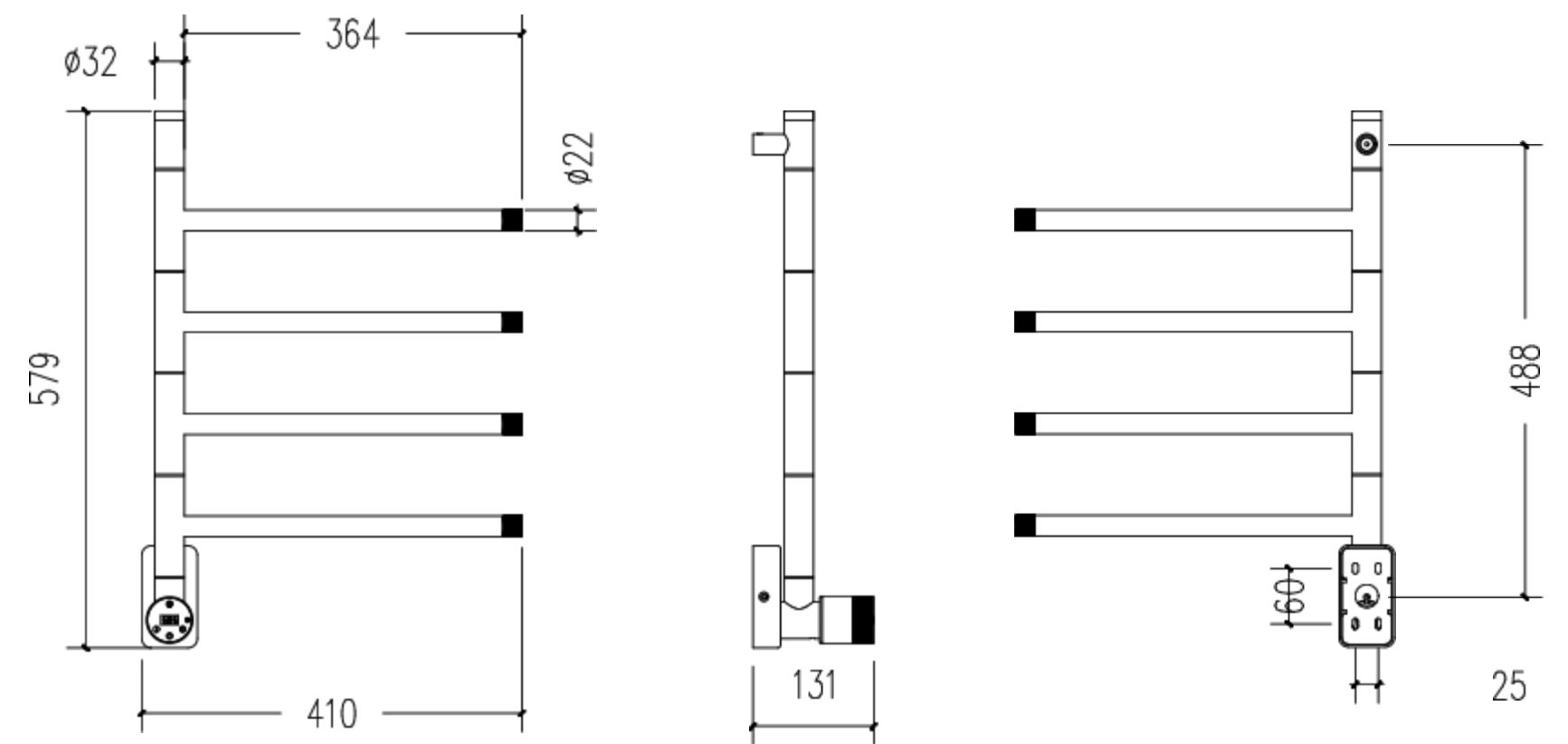

Rotary knobswitch product usage instructions:

1. After power on, press and the device will start working;
2. Press to switch to the temperature adjustment mode (rotate counterclockwise to lower the temperature, rotate clockwise to increase the temperature). Press to switch to the timer mode (rotate counterclockwise to shorten the time, rotate clockwise to extend the time).
3. Press to turn on the automatic mode, set it to 60°, and schedule it to shutdown after 8 hours.

WIFI Connection Instructions:

1. Download the Tuya App on your mobile phone.
2. Turn on the electric towel rack, connect your phone to the wifi, turn on Bluetooth, search for the smart towel rack through Bluetooth. Once connected, open the Tuya App and you can control the electric towel rack via wifi.

Common Faults and Issues, After-sales Service

1、 Common Faults and Issues

Fault phenomenon	Cause Analysis	Fault Elimination
The electric towel rack is not working	The power cord is not connected properly	Please check the connection of the power cord
	The power cord is damaged	Please ask a professional to replace the power cord

2、 Professional Services, Satisfactory After-sales Service

The company offers a 5-year warranty for its products, with a 1-year warranty for rotary switch components. Within the warranty period, if there are quality issues (excluding natural disasters and human damage), the defective products will be replaced free of charge.