

Installation diagram

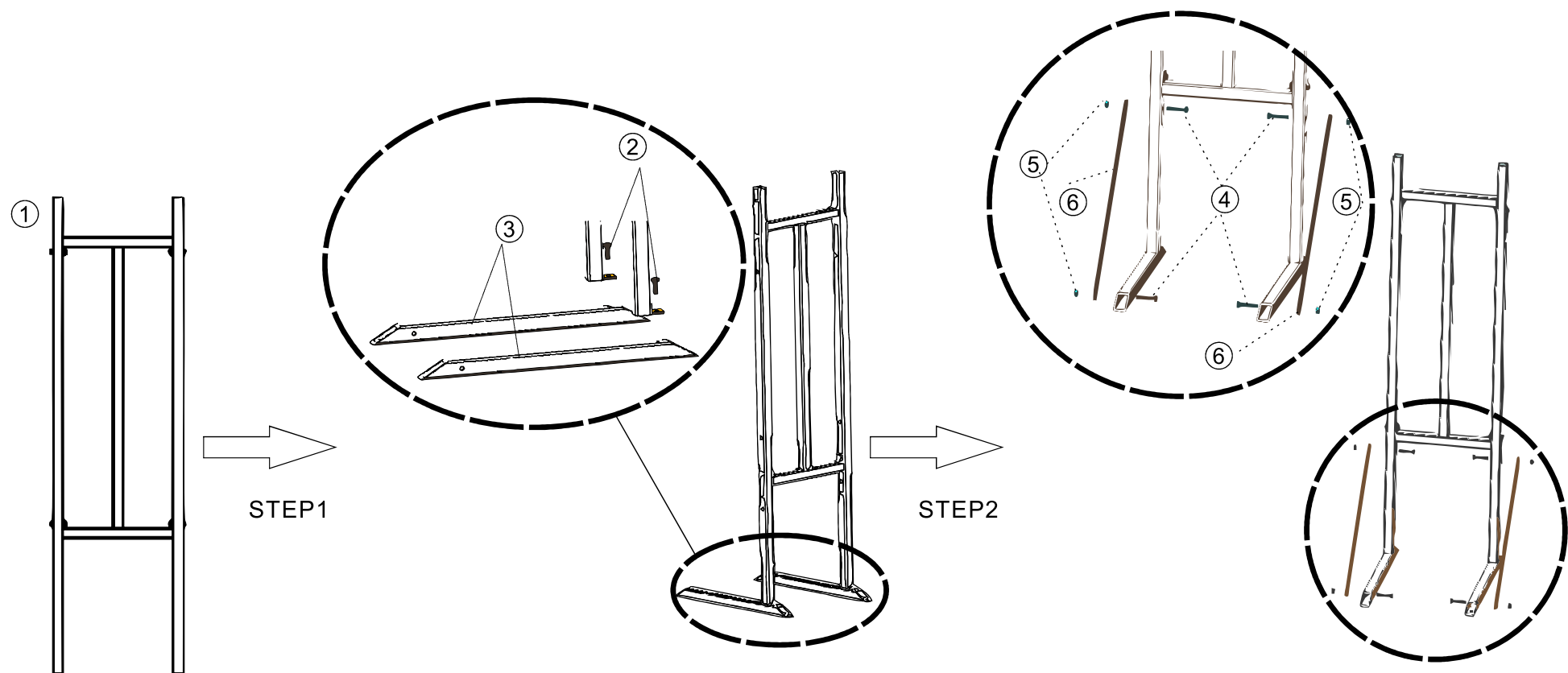

- 1. (Body) X1
- 2. (Screws) FX2
- 3. (Support feet) X2
- 4. (Screws) AX4
- 5. (Nuts) BX4
- 6. (Ribs) X2

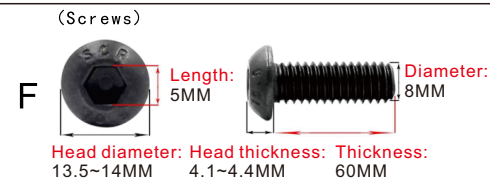
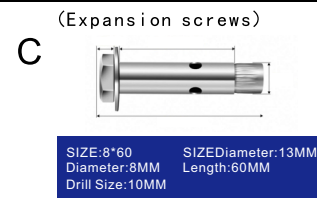
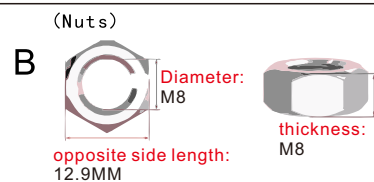
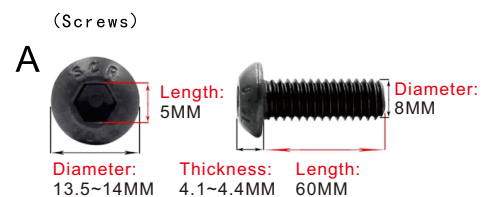

Tooling

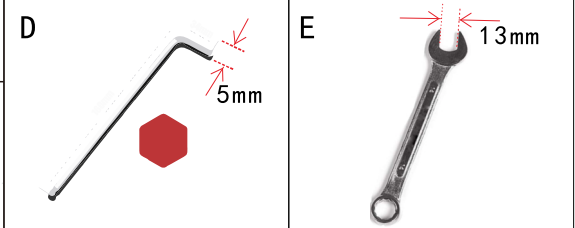

Installation diagram

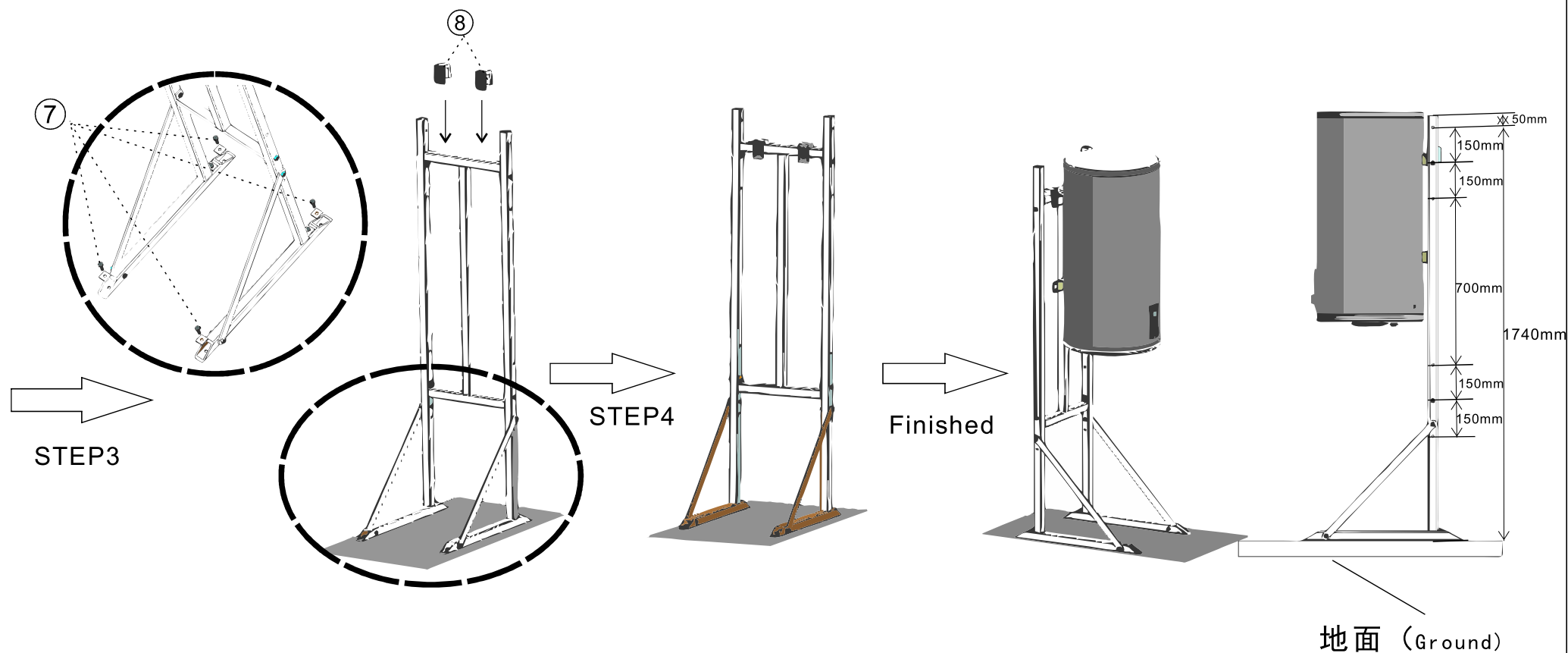

7.(Screws FOR ground)C X4

8.(Hooks)G X2

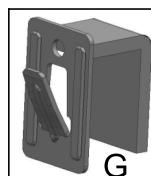

(Screws)

A

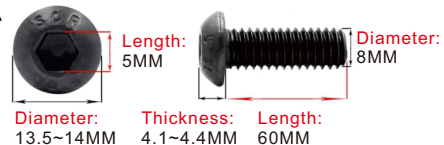

(Expansion screws)

C



SIZE: 8*60
Diameter: 8MM
Drill Size: 10MM
SIZE: Diameter: 13MM
Length: 60MM

(Nuts)

B



(Screws)

F

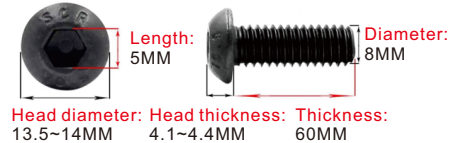

Tooling

D

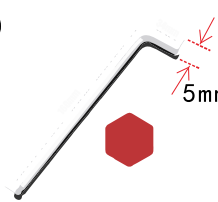

E

