



## The Traditional Kitchen Collection Installation & User Guide

**PERRIN & ROWE**  
MAYFAIR LONDON

### ATHENIAN - E.4370, E.4371, E.4375, E.4376

## Congratulations on the purchase of your Perrin & Rowe kitchen tap!

Correctly installed and with sensible care, it will give many years of trouble free service.

**Before you proceed...** We recommend you engage the services of a registered plumber to install this product.

**Read the instructions and diagrams in this leaflet carefully.**

#### Preparation

##### 1) Flush the plumbing system before installing the tap.

This is to avoid plumbing residues clogging or possibly damaging the ceramic valves. This is especially important where extensive plumbing work has been carried out.

For ease of possible future servicing, we recommend the fitting of conveniently placed isolating valves.

#### Check List

- Temperature of the hot water supply does not exceed 85°C.
- Recommended minimum water supply pressure - 1 bar.
- Rinse product ideal performance obtained with equal hot and cold pressures.
- Recommended maximum water supply pressure - 5 bar.

#### Athenian Sidevalve and Centrebody Assembly - Refer to Figure 1.

- 2) The Centrebody requires a 35mm diameter hole through the surface they are to be installed on. Maximum counter-top thickness 45mm.
- 3) Insert the flexible connections through the hole ensuring that the seal is in place between the centrebody and mounting surface. Connect these to the relevant supply lines.
- 4) From the underside of the counter-top, place the clamp plate on securing stud and using the box spanner supplied, put fixing nut in spanner and tighten until centrebody is held firmly in position. **See Figure 1.**
- 5) For sheet metal sinks, use sink support provided.
- 6) The side valve assemblies require a 30mm diameter hole through the counter-top surface. Hot supply should be on the left when viewed from the front of the fitting.
- 7) Undo and remove cover, handle, rosette, and base seal. Screw backnut and washer fully onto side valve shank.
- 8) From underside pass shank through the hole in the counter-top then screw the rosette with base seal onto shank until the thread can be seen above the rosette.
- 9) Ensure the connection for flexible hose is facing the nozzle and tighten backnut and fibre washer up to the underside of the counter top by hand to stop sidevalve from rotating.
- 10) Connect flexible hose from nozzle to sidevalve outlet. Screw the cover and handle onto the sidevalve ensuring that the handle is correctly aligned. If not, remove and turn the plastic vernier insert a few splines until the correct alignment has been achieved.
- 11) Unscrew the rosette until it meets the cover and fully tighten backnut and fibre washer up to underside of counter-top.
- 12) Connect the Hot & Cold water supplies to the side valve inlets.
- 13) **Important** - Check that flexible hoses are not twisted or kinked as this will restrict the flow.

#### Rinse

- 14) The rinse units require a 30mm diameter hole through the surface they are to be installed on. Assemble rinse unit socket ensuring the base seal is in place under body. Attach the tapered end of the flex to the rinse unit. Check that the Non-Return valve is fitted in the externally threaded end of the flex. If not, push the Non-return valve into the bore, ensuring that it is correctly orientated. Pass the flex through the socket, and screw the externally threaded end to the remaining hose at the base of the mixer tap.

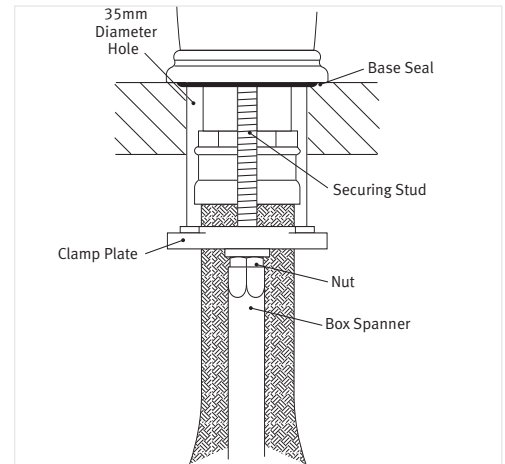
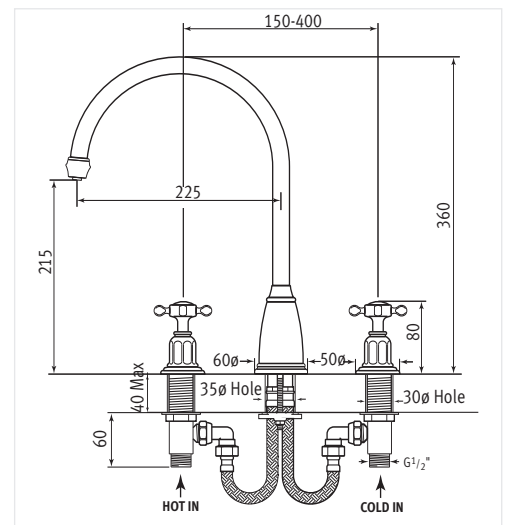
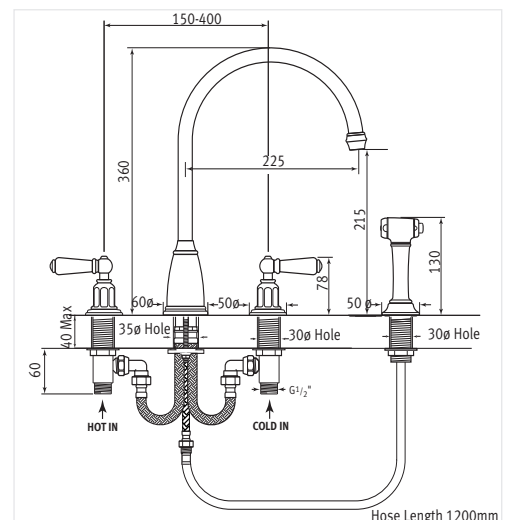

Figure 1. Installation of Centrebody



Athenian Three Hole Mixer with Crosshead Handles E.4370



Athenian Four Hole Mixer with Porcelain Lever and Rinse E.4376

**Before Use**

- 15) Turn on the Hot and Cold supplies to the tap.
- 16) Carefully check the installation for leaks.
- 17) If further building work is to be carried out in the vicinity, cover the tap with a plastic bag to avoid damaging the finish.

**Operation**

Ceramic disc valves are fitted as standard. Flow from FULLY OFF to FULLY ON is achieved by rotating the handles a quarter turn.

**Guarantee**

For written details of the product guarantee, please contact us at the address shown below.

**Spare Parts**

For maintenance and repairs, we recommend you employ a registered plumber. Before ordering spare parts, determine the correct reference number from the exploded diagram below. Quote this number, and where appropriate, the colour of your tap. For spares, please contact your local distributor or Perrin & Rowe.

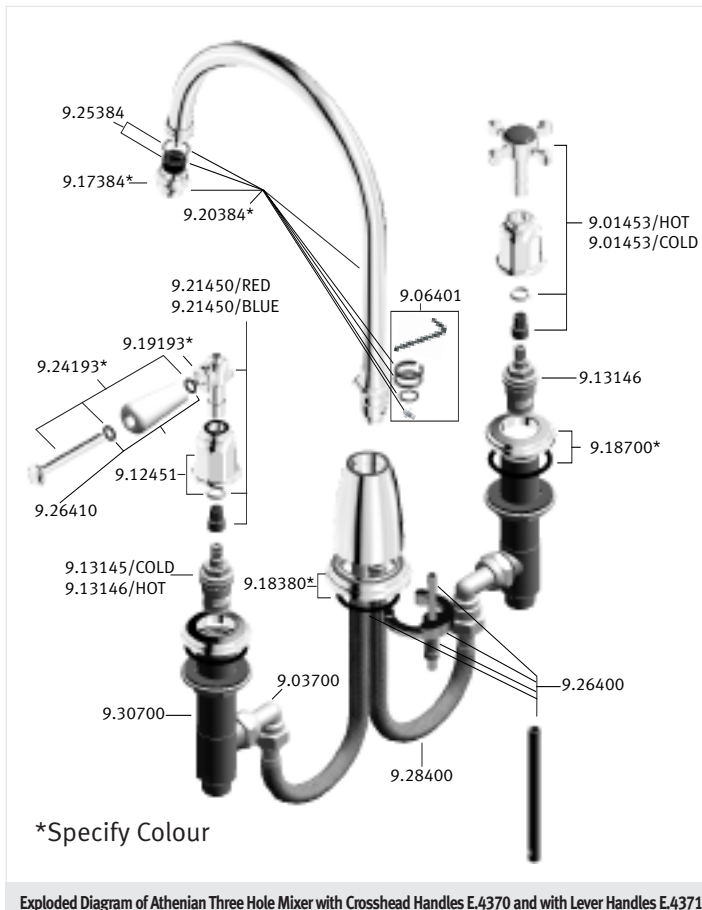

**Care & Maintenance**

Occasional cleaning with warm soapy water, followed by a polish with a soft cloth is all that is required to keep the plated finish in good condition.

**Do not use proprietary abrasive liquids, powders, or pads to clean the tap. You will damage the plated finish and void your guarantee.**

The aeration device fitted to the hot/cold water outlet may need occasional cleaning, especially in hard water areas. This is accomplished by unscrewing the outlet in an anti-clockwise direction, dismantling and leaving the inner screen mesh immersed overnight in vinegar or lemon juice.

**DO NOT use chemical descaling liquids for this purpose.**

Single flow spouts are fitted with an aerator as standard, a flow straightener is available on request.

