

TRALERT[®]

BETTER LIGHT - WORK SAFER

LED Marker lights



Tralert® your LED specialist

As European importer of exclusive LED vehicle light solutions, Tralert® is distinctive with its complete range of sustainable products, excellent service and professional technical support. Because of our specialization and focus we have grown into one of the largest suppliers in our industry in a short period of time. We represent various reputable manufacturers for the European market.

"It is our mission to make a contribution through the use of LED technology to deliver the safety and visibility of road users"

BETTER LIGHT - WORK SAFER

Extensive range of certified products

With our LED vehicle lighting we focus on both the 12V and the 24V market. Our product range includes:

- LED Work lights
- LED Flashers
- LED Rear lights
- LED Marker lights
- LED Interior lights
- LED Warning lights
- Arrow signs
- Harness systems

For the most up-to-date range, please visit our website: www.tralert.nl

Proven quality

With the Tralert® range you purchase proven quality. The products comply with the applicable standards such as European homologation (E-standards), have an IP56 to IP68 classification, EMC suppression, ECE-R10, ECE-R23 and ECE-R65, EN12352 and EN50293.

Quick delivery

All products are delivered from our logistics centre in Didam (The Netherlands). 95% of all products are available from stock, so that you have the products the next day. We deliver to:

- Truck & trailer part dealers (24V)
- Automotive (12V)
- Manufacturer of mobile roadblocks
- Bodyshops (1st mounting)
- Trailerbuilders
- Intralogistics companies
- Earth-moving manufacturers
- Manufacturers of agricultural machines
- Government



TRALERT®

BETTER LIGHT - WORK SAFER

Tralert® your LED specialist

Distribution support, Technical support

In addition to the professional sales team, we additionally support you with our expert technical department. This creates the possibility to act and develop immediately to customer requests and given suggestions. Many products we produce can be made with customized features on request.

Dealerships

Interested in becoming a dealer of the TRALERT® Portfolio?
Contact TRALERT® to see dealership opportunities.
We are capable to support you actively with sales, tailor-made marketing and product training.

Creating safer roads together.

We work with the TRALERT® Referral Policy for Dealers. International inquiries will be forwarded to the Dealer that controls that region.



Tralert® your LED specialist

In addition to the LED marker lights, Tralert® further offers numerous other products within the field of LED vehicle lights. Underneath, you will find a selection from our range LED solutions:

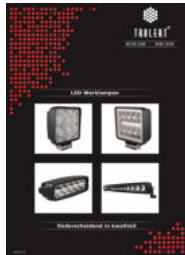

LED Work lights



LED Rear lights



LED Interior lights



LED Warning lights

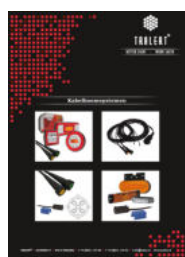

Wiring systems



**TRALERT®**

BETTER LIGHT - WORK SAFER

Tralert® your LED specialist

Tralert® offers a wide choice of Marker lights, these lights can be divided into the following subcategories:

- LED Marker lights
- LED Side indicators with marker light function
- LED Side indicators without marker light function
- LED Stalk lamps
- LED Number plate lights
- Reflectors

You will find all basic versions in this catalog. These basic range is already very wide, but do you have specific wishes regarding connectivity, cable length or other custom-made solutions? Let us know, we will check the possibilities and we will workout a proposal.

The basic versions are equipped with the following connectors & standard cables:

- The version without cable. This version can be connected by means of sliding connectors, these connectors are included. Versions without cable can also be produced with a cable on request, the length of this cable can be made to measure. This custom-made solution can not be ordered per piece but per multiple, the purchase number will be in consultation.
- The version with cable. Mostly the cables do have a length of 50cm. The length can, as with the previous option mentioned, also be custom made. Certain minimum purchase numbers also apply, these are determined in consultation.
- The version with a DC connector 0.75mm². This connector is a commonly used and is easy to install. This type of connector is often used with the Aspöck cable harnesses based on DC cables of 0.75mm². The versions in this catalog can then be exchanged 1 to 1 or used on the Aspöck cable harnesses. In addition, these connectors can also be used on the Tralert® cable harnesses.
- The version with a DC connector 1.5mm². This connector is also a commonly used and easy to install connector. This type of connector is often used with the Aspöck cable harnesses based on 1.5mm² DC cables.

If you still need a different connection, let us know. We can mount almost any type of connector for you.





TRALERT®

BETTER LIGHT - WORK SAFER

Index

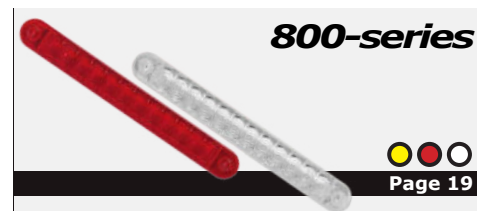
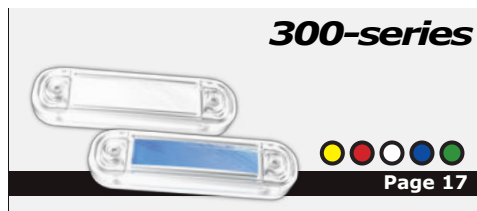
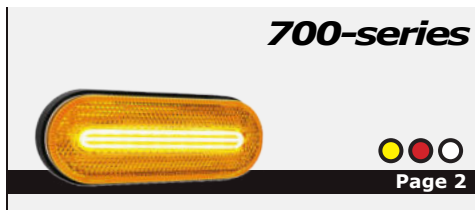



TRALERT®

BETTER LIGHT - WORK SAFER

Index



LED Marker lights 12/24v

1200-Series



Specifications	Description	1200-series LED marker lights, E-mark approved and equipped with NEON-light. Assembly screws are not visible.
	EMC suppressed	Yes
	Light colour	Amber / Red / White
	Reflector	Yes
	Size incl. bracket	125 x 60 x 24mm
	Size excl. bracket	123 x 80 x 38mm
	IP rate	Waterproof
	Current draw 12v	0,08A
	Current draw 24v	0,08A
	Warranty	2 year

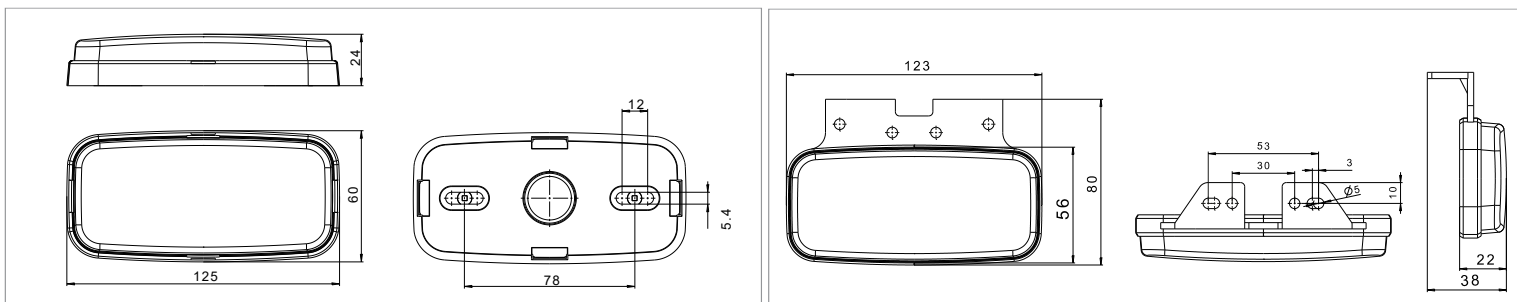

Amber side-marker light

- Amber side marker
- 12/24V (multivoltage)
- Excl. mounting bracket

Cable version (50cm):	DC 0,75mm ² connection	DC 1,5mm ² connection
MV-1200A	MV-1210A	MV-1220A



Red rear-marker light

- Red rear marker
- 12/24V (multivoltage)
- Excl. mounting bracket

Cable version (50cm):	DC 0,75mm ² connection	DC 1,5mm ² connection
MV-1200R	MV-1210R	MV-1220R



White front-marker light

- White front marker
- 12/24V (multivoltage)
- Excl. mounting bracket

Cable version (50cm):	DC 0,75mm ² connection	DC 1,5mm ² connection
MV-1200W	MV-1210W	MV-1220W

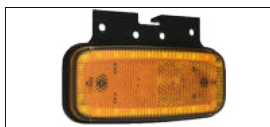

Amber side-marker light

- Amber side marker
- 12/24V (multivoltage)
- Incl. mounting bracket

Cable version (50cm):	DC 0,75mm ² connection	DC 1,5mm ² connection
MV-1250A	MV-1260A	MV-1270A



Red rear-marker light

- Red rear marker
- 12/24V (multivoltage)
- Incl. mounting bracket

Cable version (50cm):	DC 0,75mm ² connection	DC 1,5mm ² connection
MV-1250R	MV-1260R	MV-1270R



White front-marker light

- White front marker
- 12/24V (multivoltage)
- Incl. mounting bracket

Cable version (50cm):	DC 0,75mm ² connection	DC 1,5mm ² connection
MV-1250W	MV-1260W	MV-1270W



TRALERT®

BETTER LIGHT - WORK SAFER

LED Marker lights 12/24v

700-Series

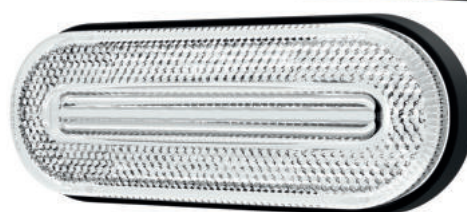
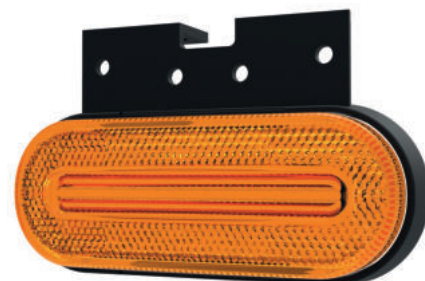
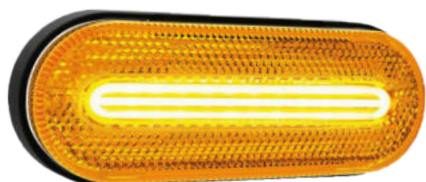

Specifications

Description	700-series LED marker lights, E-mark approved and equipped with NEON-light. Assembly screws are not visible.
EMC suppressed	Yes
Light colour	Amber / Red / White
Reflector	Yes
Size incl. bracket	126 x 51 x 26mm
Size excl. bracket	124 x 75 x 40mm
IP rate	Waterproof
Current draw 12v	0,08A
Current draw 24v	0,08A
Warranty	2 year

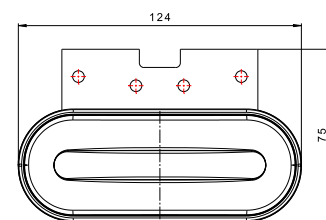
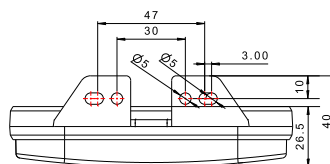
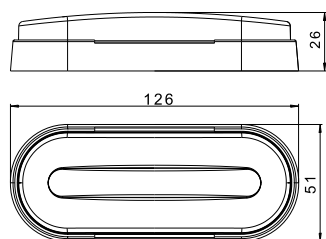
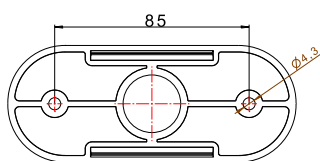

Amber side-marker light

- Amber side marker
- 12/24V (multivoltage)
- Excl. mounting bracket

Cable version (50cm):	DC 0,75mm ² connection	DC 1,5mm ² connection
M10MV-700A	M10MV-710A	M10MV-720A



Red rear-marker light

- Red rear marker
- 12/24V (multivoltage)
- Excl. mounting bracket

Cable version (50cm):	DC 0,75mm ² connection	DC 1,5mm ² connection
M10MV-700R	M10MV-710R	M10MV-720R



White front-marker light

- White front marker
- 12/24V (multivoltage)
- Excl. mounting bracket

Cable version (50cm):	DC 0,75mm ² connection	DC 1,5mm ² connection
M10MV-700W	M10MV-710W	M10MV-720W



Amber side-marker light

- Amber side marker
- 12/24V (multivoltage)
- Incl. mounting bracket

Cable version (50cm):	DC 0,75mm ² connection	DC 1,5mm ² connection
M10MV-750A	M10MV-760A	M10MV-770A



Red rear-marker light

- Red rear marker
- 12/24V (multivoltage)
- Incl. mounting bracket

Cable version (50cm):	DC 0,75mm ² connection	DC 1,5mm ² connection
M10MV-750R	M10MV-760R	M10MV-770R



White front-marker light

- White front marker
- 12/24V (multivoltage)
- Incl. mounting bracket

Cable version (50cm):	DC 0,75mm ² connection	DC 1,5mm ² connection
M10MV-750W	M10MV-760W	M10MV-770W

LED Marker lights 12/24v

EU38-Series



Specifications	Description	EU38series LED marker lights, E-mark approved and equipped with a black or white backplate. Assembly screws are not visible.
	EMC suppressed	Yes
	Light colour	Amber / Red / White
	Reflector	Yes
	Size incl. bracket	100 x 38 x 13mm
	Size excl. bracket	Horizontal: 100 x 60 x 33mm Vertical: 112,2 x 38 x 33mm
	IP rate	IP67
	Current draw 12v	0,01A
	Current draw 24v	0,01A
	Warranty	5 year

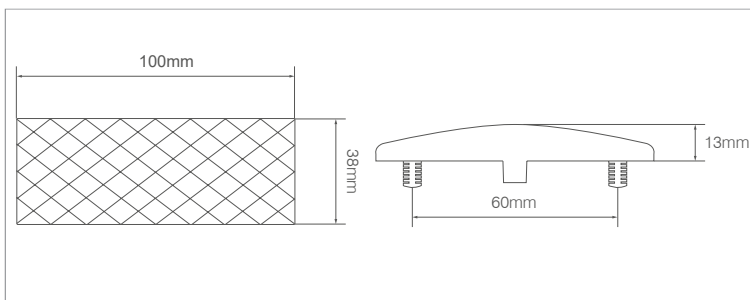

Optional mounting brackets

EU38BKT Horizontal mounting bracket

EU38BKTV Vertical mounting bracket



Amber side-marker light

- Amber side marker
- 12/24V (multivoltage)
- White housing

Cable version (35cm):	DC 0,75mm ² connection:	DC 1,5mm ² connection:
EU38AM	N/A	N/A

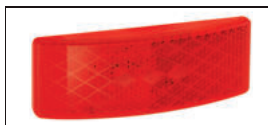

Red rear-marker light

- Red rear marker
- 12/24V (multivoltage)
- White housing

Cable version (35cm):	DC 0,75mm ² connection:	DC 1,5mm ² connection:
EU38RM	N/A	N/A

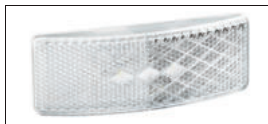

White front-marker light

- White front marker
- 12/24V (multivoltage)
- White housing

Cable version (35cm):	DC 0,75mm ² connection:	DC 1,5mm ² connection:
EU38WM	N/A	N/A



Amber side-marker light

- Amber side marker
- 12/24V (multivoltage)
- Black housing

Cable version (35cm):	DC 0,75mm ² connection:	DC 1,5mm ² connection:
EU38BAM	N/A	N/A



Red rear-marker light

- Red rear marker
- 12/24V (multivoltage)
- Black housing

Cable version (35cm):	DC 0,75mm ² connection:	DC 1,5mm ² connection:
EU38BRM	N/A	N/A



White front-marker light

- White front marker
- 12/24V (multivoltage)
- Black housing

Cable version (35cm):	DC 0,75mm ² connection:	DC 1,5mm ² connection:
EU38BWM	N/A	N/A



TRALERT®

BETTER LIGHT - WORK SAFER

LED Marker lights 12/24v

600-Series



Specifications

Description	600series LED marker lights, E-mark approved and available with and without a mounting bracket
EMC suppressed	Yes
Light colour	Amber / Red / White
Reflector	Yes
Size incl. bracket	110 x 54 x 16mm
Size excl. bracket	110 x 75 x 35mm
IP rate	Waterproof
Current draw 12v	0,05A
Current draw 24v	0,04A
Warranty	2 year

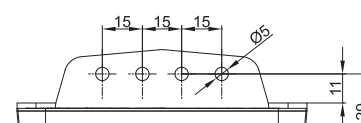
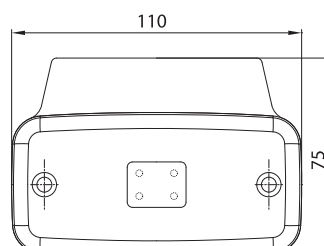
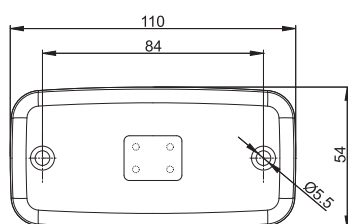

Amber side-marker light

- Amber side marker
- 12/24V (multivoltage)
- Excl. mounting bracket

Cable version (50cm): DC 0,75mm² connection: DC 1,5mm² connection:



Red rear-marker light

- Red rear marker
- 12/24V (multivoltage)
- Excl. mounting bracket

Cable version (50cm): DC 0,75mm² connection: DC 1,5mm² connection:



White front-marker light

- White front marker
- 12/24V (multivoltage)
- Excl. mounting bracket

Cable version (50cm): DC 0,75mm² connection: DC 1,5mm² connection:



Amber side-marker light

- Amber side marker
- 12/24V (multivoltage)
- Incl. mounting bracket

Cable version (50cm): DC 0,75mm² connection: DC 1,5mm² connection:



Red rear-marker light

- Red rear marker
- 12/24V (multivoltage)
- Incl. mounting bracket

Cable version (50cm): DC 0,75mm² connection: DC 1,5mm² connection:

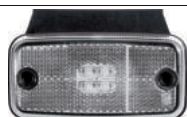

White front-marker light

- White front marker
- 12/24V (multivoltage)
- Incl. mounting bracket

Cable version (50cm): DC 0,75mm² connection: DC 1,5mm² connection:





TRALERT®

BETTER LIGHT - WORK SAFER

LED Marker lights 12/24v

900-Series



Specifications	Description	900-series LED Marker lights, with an E-mark and optional with extra mounting cover edge (included)
	EMC suppressed	Yes
	Light colour	Amber / Red / White
	Reflector	Yes
	Size incl. bracket	62 x 62 x 17,5mm
	Size excl. bracket	62 x 62 x 27mm
	IP rate	Waterproof
	Current draw 12v	0,03A
	Current draw 24v	0,01A
	Warranty	2 year

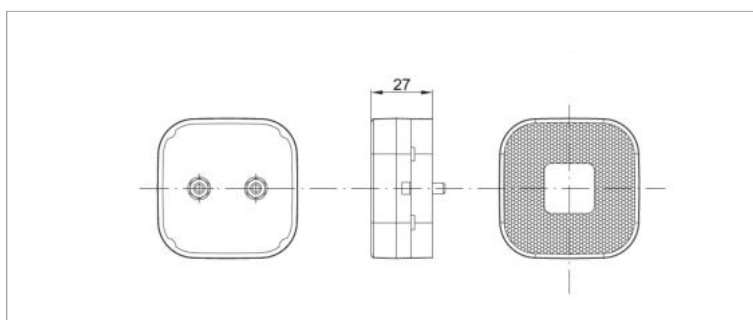
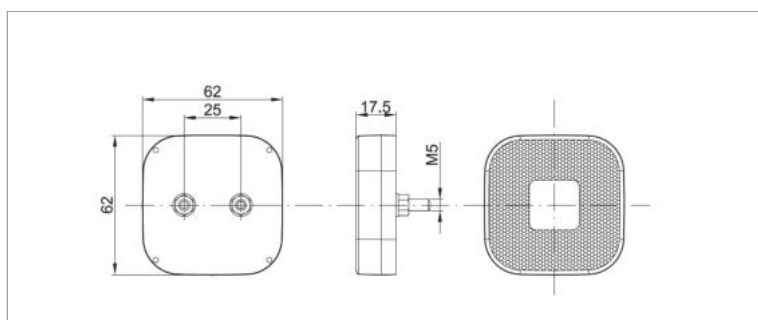
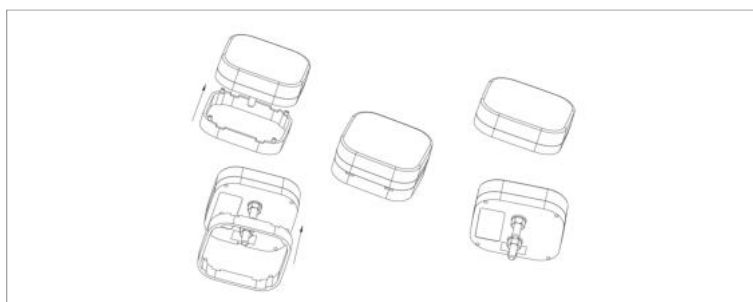

Amber side-marker light

- Amber side marker
- 12/24V (multivoltage)

Cable version (50cm):	DC 0,75mm ² connection:	DC 1,5mm ² connection:
M10MV-900A	N/A	N/A



Red rear-marker light

- Red rear marker
- 12/24V (multivoltage)

Cable version (50cm):	DC 0,75mm ² connection:	DC 1,5mm ² connection:
M10MV-900R	N/A	N/A



White front-marker light

- White front marker
- 12/24V (multivoltage)

Cable version (50cm):	DC 0,75mm ² connection:	DC 1,5mm ² connection:
M10MV-900W	N/A	N/A



TRALERT®

BETTER LIGHT - WORK SAFER

LED Marker lights 12/24v

44-Series



Specifications

Description	44 series LED Marker lights, with an E-marking and available with black and white housing
EMC suppressed	Yes
Light colour	Amber / Red / White
Reflector	Yes
Size incl. bracket	100 x 44 x 12mm
Size excl. bracket	118 x 65 x 32mm
IP rate	IP67
Current draw 12v	0,02A
Current draw 24v	0,03A
Warranty	5 year

Optional mounting bracket



44BKT

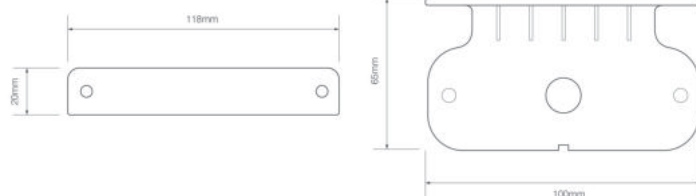
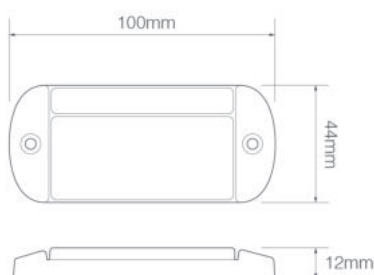

Amber side-marker light

- Amber side marker
- 12/24V (multivoltage)
- Black housing

Cable version (40cm): DC 0,75mm² connection: DC 1,5mm² connection:



Red rear-marker light

- Red rear marker
- 12/24V (multivoltage)
- Black housing

Cable version (40cm): DC 0,75mm² connection: DC 1,5mm² connection:



White front-marker light

- White front marker
- 12/24V (multivoltage)
- Black housing

Cable version (40cm): DC 0,75mm² connection: DC 1,5mm² connection:

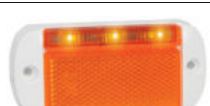

Amber side-marker light

- Amber side marker
- 12/24V (multivoltage)
- White housing

Cable version (40cm): DC 0,75mm² connection: DC 1,5mm² connection:



Red rear-marker light

- Red rear marker
- 12/24V (multivoltage)
- White housing

Cable version (40cm): DC 0,75mm² connection: DC 1,5mm² connection:



White front-marker light

- White front marker
- 12/24V (multivoltage)
- White housing

Cable version (40cm): DC 0,75mm² connection: DC 1,5mm² connection:



LED Marker lights 12/24v

100 & 150-Series



Specifications	Description	100-series LED Marker lights, with an E-marking and supplied with or without mounting bracket
	EMC suppressed	Yes
	Light colour	Amber / Red / White
	Reflector	Yes
	Size incl. bracket	130 x 32 x 14,5mm
	Size excl. bracket	100 x 50 x 32,5mm
	IP rate	Waterproof
	Current draw 12v	0,04A
	Current draw 24v	0,05A
	Warranty	2 year

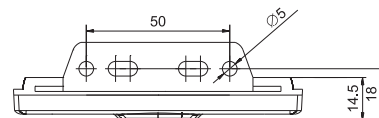
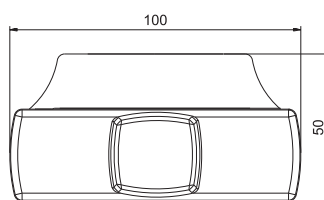
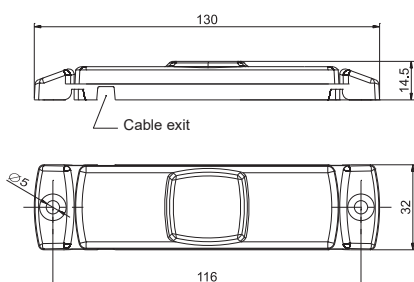

Amber side-marker light

- Amber side marker
- 12/24V (multivoltage)
- Excl. mounting bracket

Cable version (50cm):	DC 0,75mm ² connection:	DC 1,5mm ² connection:
M10MV-100A	M10MV-110A	M10MV-120A



Red rear-marker light

- Red rear marker
- 12/24V (multivoltage)
- Excl. mounting bracket

Cable version (50cm):	DC 0,75mm ² connection:	DC 1,5mm ² connection:
M10MV-100R	M10MV-110R	M10MV-120R



White front-marker light

- White front marker
- 12/24V (multivoltage)
- Excl. mounting bracket

Cable version (50cm):	DC 0,75mm ² connection:	DC 1,5mm ² connection:
M10MV-100W	M10MV-110W	M10MV-120W



Amber side-marker light

- Amber side marker
- 12/24V (multivoltage)
- Incl. mounting bracket

Cable version (50cm):	DC 0,75mm ² connection:	DC 1,5mm ² connection:
M10MV-150A	M10MV-160A	M10MV-170A



Red rear-marker light

- Red rear marker
- 12/24V (multivoltage)
- Incl. mounting bracket

Cable version (50cm):	DC 0,75mm ² connection:	DC 1,5mm ² connection:
M10MV-150R	M10MV-160R	M10MV-170R



White front-marker light

- White front marker
- 12/24V (multivoltage)
- Incl. mounting bracket

Cable version (50cm):	DC 0,75mm ² connection:	DC 1,5mm ² connection:
M10MV-150W	M10MV-160W	M10MV-170W



TRALERT®

BETTER LIGHT - WORK SAFER

LED Marker lights 12/24v

190-Series



Specifications

Description	190-series LED Marker lights, with an E-marking and optionally available with mounting bracket
EMC suppressed	Yes
Light colour	Amber / Red / White
Reflector	Yes
Size incl. bracket	130 x 32 x 14,5mm
Size excl. bracket	100 x 50 x 32,5mm
IP rate	Waterproof
Current draw 12v	0,04A
Current draw 24v	0,05A
Warranty	2 year



Optional mounting bracket

M10MS-100

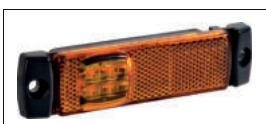
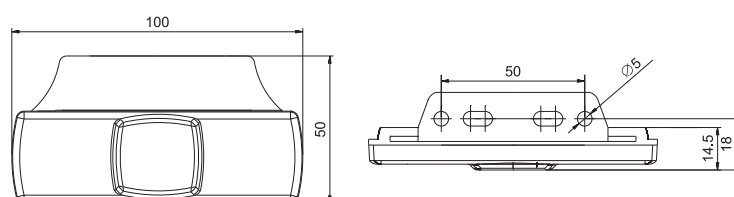
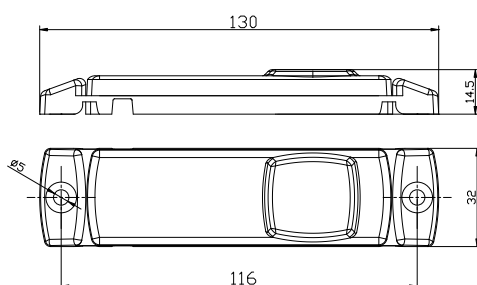

Amber side-marker light

- Amber side marker
- 12/24V (multivoltage)
- Excl. mounting bracket

Cable version (50cm): DC 0,75mm² connection: DC 1,5mm² connection:



Red rear-marker light

- Red rear marker
- 12/24V (multivoltage)
- Excl. mounting bracket

Cable version (50cm): DC 0,75mm² connection: DC 1,5mm² connection:



White front-marker light

- White front marker
- 12/24V (multivoltage)
- Excl. mounting bracket

Cable version (50cm): DC 0,75mm² connection: DC 1,5mm² connection:





TRALERT®

BETTER LIGHT - WORK SAFER

LED Marker lights 12/24v

129-Series



Specifications	Description	129-series LED Marker lights, with an E-marking and optionally available with mounting bracket
	EMC suppressed	Yes
	Light colour	Amber / Red / White
	Reflector	Yes
	Size incl. bracket	129 x 32 x 13mm
	Size excl. bracket	129 x 46 x 43mm
	IP rate	IP67
	Current draw 12v	0,01A
	Current draw 24v	0,01A
	Warranty	2 year

Optional mounting bracket

129BKT

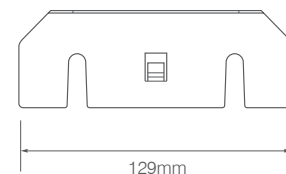
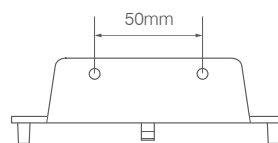
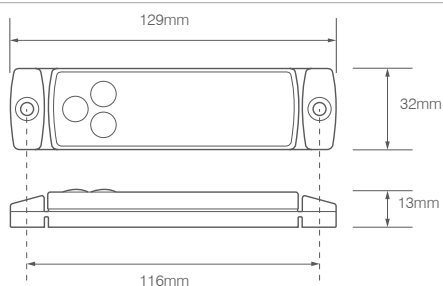

Amber side-marker light

- Amber side marker
- 12/24V (multivoltage)
- Excl. mounting bracket

Cable version (50cm kabel)	DC 0,75mm² connection:	DC 1,5mm² connection:
129AM	N/A	N/A

Red rear-marker light

- Red rear marker
- 12/24V (multivoltage)
- Excl. mounting bracket

Cable version (50cm kabel)	DC 0,75mm² connection:	DC 1,5mm² connection:
129RM	N/A	N/A

White front-marker light

- White front marker
- 12/24V (multivoltage)
- Excl. mounting bracket

Cable version (50cm kabel)	DC 0,75mm² connection:	DC 1,5mm² connection:
129WM	N/A	N/A



TRALERT®

BETTER LIGHT - WORK SAFER

LED Marker lights 12/24v

7922-Series



Specifications

Description	7922-series of LED Marker lights, with an E-marking and designed as recessed light
EMC suppressed	Yes
Light colour	Amber / Red / White / Blue / Green
Reflector	No
Size	79 x 22 x 18mm
Cut out size	45mm x 17mm
IP rate	IP67
Current draw 12v	0,04A
Current draw 24v	0,04A
Warranty	5 year

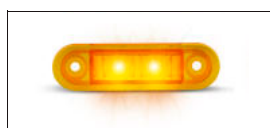
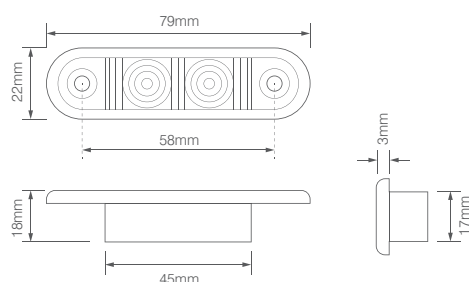

Amber side-marker light

- Amber side marker
- 12/24V (multivoltage)
- Recessed version, amber lens

Cable version (20cm):	DC 0,75mm ² connection:	DC 1,5mm ² connection:
7922AMB	N/A	N/A

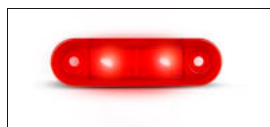

Red rear-marker light

- Red rear marker
- 12/24V (multivoltage)
- Recessed version, red lens

Cable version (20cm):	DC 0,75mm ² connection:	DC 1,5mm ² connection:
7922RMB	N/A	N/A



White front-marker light

- White front marker
- 12/24V (multivoltage)
- Recessed version, clear lens

Cable version (20cm):	DC 0,75mm ² connection:	DC 1,5mm ² connection:
7922WMB	N/A	N/A

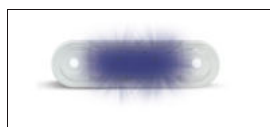

Blue decorative light

- Blue decorative light (Without E-mark)
- 12/24V (multivoltage)
- Recessed version, clear lens

Cable version (20cm):	DC 0,75mm ² connection:	DC 1,5mm ² connection:
7922BMB	N/A	N/A

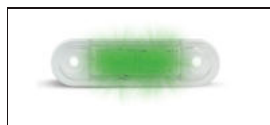

Green decorative light

- Green decorative light (Without E-mark)
- 12/24V (multivoltage)
- Recessed version, clear lens

Cable version (20cm):	DC 0,75mm ² connection:	DC 1,5mm ² connection:
7922GMB	N/A	N/A



TRALERT®

BETTER LIGHT - WORK SAFER

LED Marker lights 12/24v

1490 & 1491-Series



Specifications	Description	1491 & 1491-series LED Marker lights, with an E-marking and supplied with or without mounting bracket
	EMC suppressed	Yes
	Light colour	Amber / Red / White
	Reflector	Yes
	Size incl. bracket	110 x 40 x 25mm
	Size excl. bracket	110 x 47 x 65mm
	IP rate	IP67
	Current draw 12v	0,05A
	Current draw 24v	0,07A
	Warranty	5 year

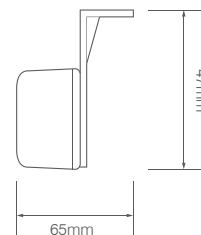
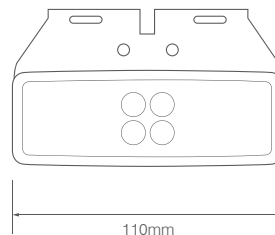
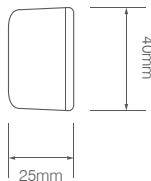
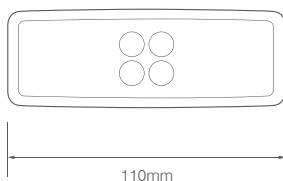

Amber side-marker light

- Amber side marker
- 12/24V (multivoltage)
- Excl. mounting bracket

Cable version (20cm):



DC 0,75mm² connection:



N/A

DC 1,5mm² connection:



N/A



Red rear-marker light

- Red rear marker
- 12/24V (multivoltage)
- Excl. mounting bracket

Cable version (20cm):



DC 0,75mm² connection:



N/A

DC 1,5mm² connection:



N/A



White front-marker light

- White front marker
- 12/24V (multivoltage)
- Excl. mounting bracket

Cable version (20cm):



DC 0,75mm² connection:



N/A

DC 1,5mm² connection:



N/A



Amber side-marker light

- Amber side marker
- 12/24V (multivoltage)
- Incl. mounting bracket

Cable version (20cm):



DC 0,75mm² connection:



N/A

DC 1,5mm² connection:



N/A



Red rear-marker light

- Red rear marker
- 12/24V (multivoltage)
- Incl. mounting bracket

Cable version (20cm):



DC 0,75mm² connection:



N/A

DC 1,5mm² connection:



N/A



White front-marker light

- White front marker
- 12/24V (multivoltage)
- Incl. mounting bracket

Cable version (20cm):



DC 0,75mm² connection:



N/A

DC 1,5mm² connection:



N/A



TRALEART®

BETTER LIGHT - WORK SAFER

LED Marker lights 12/24v

58-Series



Specifications

Description	58-series LED Marker lights, with an E-mark (excl. the green color)* and are available with a black or chrome bracket.
EMC suppressed	Yes
Light colour	Amber / Red / White / Green*
Reflector	No
Size incl. bracket	58 x 35 x 19mm
Size excl. bracket	N/A
IP rate	IP67
Current draw 12v	0,12A
Current draw 24v	0,07A
Warranty	5 year

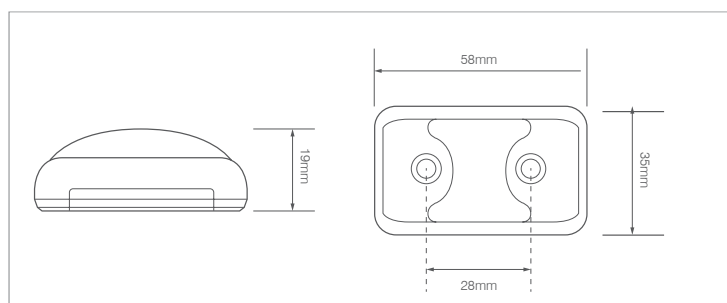

Amber side-marker light

- Amber side marker
- 12/24V (multivoltage)
- Black bracket

Cable version (40cm):	DC 0,75mm ² connection:	DC 1,5mm ² connection:
58AME-1	N/A	N/A



Red rear-marker light

- Red rear marker
- 12/24V (multivoltage)
- Black bracket

Cable version (40cm):	DC 0,75mm ² connection:	DC 1,5mm ² connection:
58RME	N/A	N/A



White front-marker light

- White front marker
- 12/24V (multivoltage)
- Black bracket

Cable version (40cm):	DC 0,75mm ² connection:	DC 1,5mm ² connection:
58WME	N/A	N/A



Green decorative light

- Green decorative light (without an E-mark)
- 12/24V (multivoltage)
- Black bracket

Cable version (40cm):	DC 0,75mm ² connection:	DC 1,5mm ² connection:
58GME	N/A	N/A



Amber side-marker light

- Amber side marker
- 12/24V (multivoltage)
- Chrome bracket

Cable version (40cm):	DC 0,75mm ² connection:	DC 1,5mm ² connection:
58CAME-1	N/A	N/A



Red rear-marker light

- Red rear marker
- 12/24V (multivoltage)
- Chrome bracket

Cable version (40cm):	DC 0,75mm ² connection:	DC 1,5mm ² connection:
58CRME	N/A	N/A



White front-marker light

- White front marker
- 12/24V (multivoltage)
- Chrome bracket

Cable version (40cm):	DC 0,75mm ² connection:	DC 1,5mm ² connection:
58CWME	N/A	N/A



Green decorative light

- Green decorative light (without an E-mark)
- 12/24V (multivoltage)
- Chrome bracket

Cable version (40cm):	DC 0,75mm ² connection:	DC 1,5mm ² connection:
58CGME	N/A	N/A

LED Marker lights 12/24v

35-Series

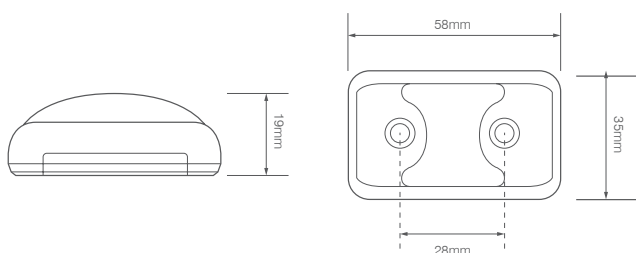

Specifications	Description	58-series LED Marker lights, with an E-mark (excl. the green color)* and are available with a black or chrome bracket.
	EMC suppressed	Yes
	Light colour	Red / White / Green* (the amber version is a side indicator)
	Reflector	No
	Size incl. bracket	58 x 35 x 19mm
	Size excl. bracket	Nvt
	IP rate	IP67
	Current draw 12v	0,10A
	Current draw 24v	0,04A
	Warranty	5 year

Red rear-marker light

- Red rear marker
- 12/24V (multivoltage)
- Black bracket

Cable version (40cm): DC 0,75mm² connection: DC 1,5mm² connection:



White front-marker light

- White front marker
- 12/24V (multivoltage)
- Black bracket

Cable version (40cm): DC 0,75mm² connection: DC 1,5mm² connection:



Green decorative light

- Green decorative light (without an E-mark)
- 12/24V (multivoltage)
- Black bracket

Cable version (40cm): DC 0,75mm² connection: DC 1,5mm² connection:



Red rear-marker light

- Red rear marker
- 12/24V (multivoltage)
- Chrome bracket

Cable version (40cm): DC 0,75mm² connection: DC 1,5mm² connection:



White front-marker light

- White front marker
- 12/24V (multivoltage)
- Chrome bracket

Cable version (40cm): DC 0,75mm² connection: DC 1,5mm² connection:



Green decorative light

- Green decorative light (without an E-mark)
- 12/24V (multivoltage)
- Chrome bracket

Cable version (40cm): DC 0,75mm² connection: DC 1,5mm² connection:





TRALERT®

BETTER LIGHT - WORK SAFER

LED Marker lights 12/24v

400-Series



Specifications

Description	400-series LED Marker lights, with an E-marking and is equipped with a clear lens and mounting bracket
EMC suppressed	Yes
Light colour	Amber / Red / White
Reflector	No
Size incl. bracket	N/A
Size excl. bracket	80 x 43 x 20mm
IP rate	Waterproof
Current draw 12v	0,02A
Current draw 24v	0,03A
Warranty	2 year

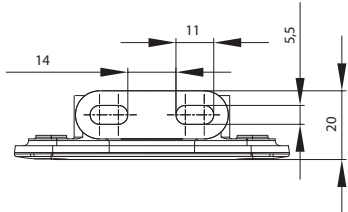
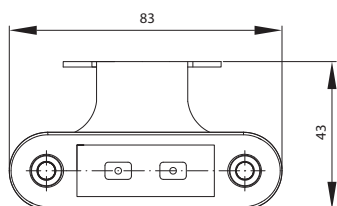

Amber side-marker light

- Amber side marker
- 12/24V (multivoltage)
- Incl. mountingbracket

Cable version (50cm): DC 0,75mm² connection: DC 1,5mm² connection:



Red rear-marker light

- Red rear marker
- 12/24V (multivoltage)
- Incl. mountingbracket

Cable version (50cm): DC 0,75mm² connection: DC 1,5mm² connection:



White front-marker light

- White front marker
- 12/24V (multivoltage)
- Incl. mountingbracket

Cable version (50cm): DC 0,75mm² connection: DC 1,5mm² connection:





TRALERT®

BETTER LIGHT - WORK SAFER

LED Marker lights 12/24v

200-Series



Specifications	Description	200-series of LED Marker lights, with an E-marking and designed as recessed light (excl. the green and blue color)*
	EMC suppressed	Yes
	Light colour	Amber / Red / White / Blue* / Green*
	Reflector	No
	Size	85 x 27 x 19mm
	Cut out size	46 x 17mm
	IP rate	Waterproof
	Current draw 12v	0,02A
	Current draw 24v	0,03A
	Warranty	2 year

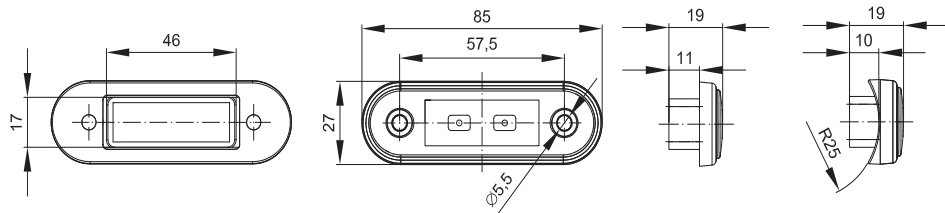

Optional mounting bracket



M10MS-200Z

Black mounting bracket suitable for mounting on round surfaces



M10MS-200Z

Transparent mounting bracket suitable for mounting on round surfaces



Amber side-marker light

- Amber side marker
- 12/24V (multivoltage)
- Recess mounted

Cable version (50cm):	DC 0,75mm ² connection:	DC 1,5mm ² connection:
M10MV-200A	M10MV-210A	M10MV-220A



Red rear-marker light

- Red rear marker
- 12/24V (multivoltage)
- Recess mounted

Cable version (50cm):	DC 0,75mm ² connection:	DC 1,5mm ² connection:
M10MV-200R	M10MV-210R	M10MV-220R



White front-marker light

- White front marker
- 12/24V (multivoltage)
- Recess mounted

Cable version (50cm):	DC 0,75mm ² connection:	DC 1,5mm ² connection:
M10MV-200W	M10MV-210W	M10MV-220W



Blue decorative light

- Blue decorative light (without an E-mark)
- 12/24V (multivoltage)
- Recess mounted

Cable version (50cm):	DC 0,75mm ² connection:	DC 1,5mm ² connection:
M10MV-200B	M10MV-210B	M10MV-220B



Green decorative light

- Green decorative light (without an E-mark)
- 12/24V (multivoltage)
- Recess mounted

Cable version (50cm):	DC 0,75mm ² connection:	DC 1,5mm ² connection:
M10MV-200G	M10MV-210G	M10MV-220G



TRALEART®

BETTER LIGHT - WORK SAFER

LED Marker lights 12/24v

500-Series



Specifications

Description	500-series LED Marker lights, with an E-marking and supplied with or without mounting bracket
EMC suppressed	Yes
Light colour	Amber / Red / White
Reflector	Nee
Size incl. bracket	80 x 18 x 23mm
Size excl. bracket	80 x 30 x 23mm
IP rate	Waterproof
Current draw 12v	0,02A
Current draw 24v	0,03A
Warranty	2 year

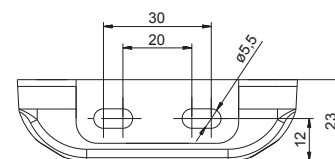
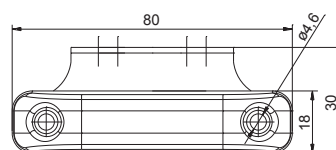
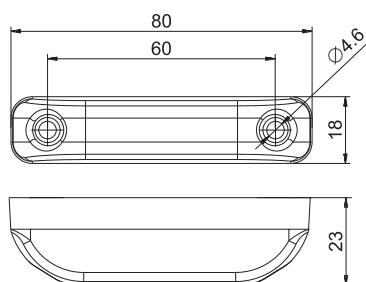

Amber side-marker light

- Amber side marker
- 12/24V (multivoltage)
- Excl. mounting bracket

Cable version (50cm):	DC 0,75mm ² connection:	DC 1,5mm ² connection:
M10MV-500A	M10MV-510A	M10MV-520A



Red rear-marker light

- Red rear marker
- 12/24V (multivoltage)
- Excl. mounting bracket

Cable version (50cm):	DC 0,75mm ² connection:	DC 1,5mm ² connection:
M10MV-500R	M10MV-510R	M10MV-520R



White front-marker light

- White front marker
- 12/24V (multivoltage)
- Excl. mounting bracket

Cable version (50cm):	DC 0,75mm ² connection:	DC 1,5mm ² connection:
M10MV-500W	M10MV-510W	M10MV-520W



Amber side-marker light

- Amber side marker
- 12/24V (multivoltage)
- Incl. mounting bracket

Cable version (50cm):	DC 0,75mm ² connection:	DC 1,5mm ² connection:
M10MV-550A	N/A	N/A



Red rear-marker light

- Red rear marker
- 12/24V (multivoltage)
- Incl. mounting bracket

Cable version (50cm):	DC 0,75mm ² connection:	DC 1,5mm ² connection:
M10MV-550R	N/A	N/A



White front-marker light

- White front marker
- 12/24V (multivoltage)
- Incl. mounting bracket

Cable version (50cm):	DC 0,75mm ² connection:	DC 1,5mm ² connection:
M10MV-550W	N/A	N/A

LED Marker lights 12/24v

300-Series

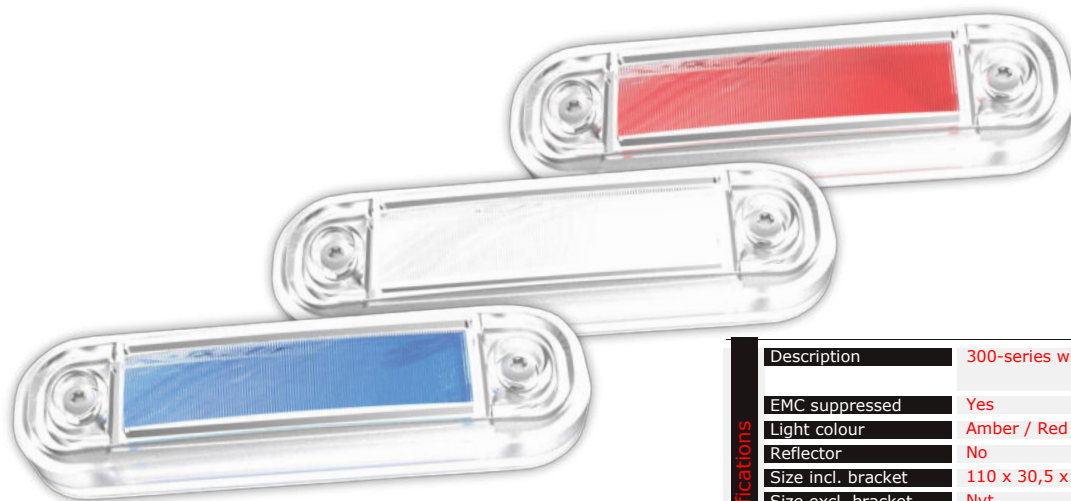

Specifications	Description	300-series with an E-marking (excl. the green and blue color)*
	EMC suppressed	Yes
	Light colour	Amber / Red / White / Blue* / Green*
	Reflector	No
	Size incl. bracket	110 x 30,5 x 18mm
	Size excl. bracket	Nvt
	IP rate	Waterproof
	Current draw 12v	0,08A
	Current draw 24v	0,08A
	Warranty	2 year

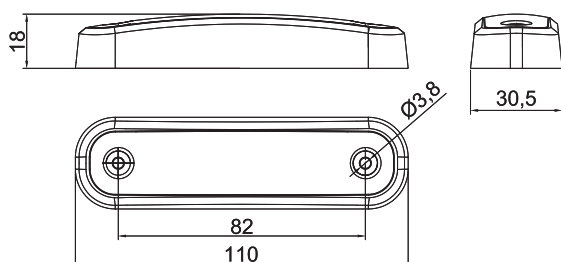

Optional mounting bracket

M10MS-300

Transparent mounting bracket suitable for mounting on round surfaces

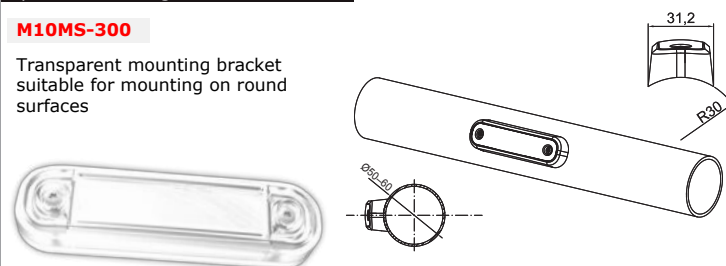

Amber side-marker light

- Amber side marker
- 12/24V (multivoltage)
- Transparante mounting bracket



Red rear-marker light

- Red rear marker
- 12/24V (multivoltage)
- Transparante mounting bracket



White front-marker light

- White front marker
- 12/24V (multivoltage)
- Transparante mounting bracket



Blue decorative light

- Blue decorative light (without an E-mark)
- 12/24V (multivoltage)
- Transparante mounting bracket



Green decorative light

- Green decorative light (without an E-mark)
- 12/24V (multivoltage)
- Transparante mounting bracket

Cable version (50cm):	DC 0,75mm ² connection:	DC 1,5mm ² connection:
 M10MV-300A	 N/A	 N/A

Cable version (50cm):	DC 0,75mm ² connection:	DC 1,5mm ² connection:
 M10MV-300R	 N/A	 N/A

Cable version (50cm):	DC 0,75mm ² connection:	DC 1,5mm ² connection:
 M10MV-300W	 N/A	 N/A

Cable version (50cm):	DC 0,75mm ² connection:	DC 1,5mm ² connection:
 M10MV-300B	 N/A	 N/A

Cable version (50cm):	DC 0,75mm ² connection:	DC 1,5mm ² connection:
 M10MV-300G	 N/A	 N/A



TRALERT®

BETTER LIGHT - WORK SAFER

LED Marker lights 12/24v

37-Series



Specifications

Description	37-series LED Marker lights, with an E-mark and are available with a black or chrome bracket.
EMC suppressed	Yes
Light colour	Amber / Red / White
Reflector	No
Size incl. bracket	70 x 35 x 20mm
Size excl. bracket	N/A
IP rate	Waterproof
Current draw 12v	0,04A
Current draw 24v	0,04A
Warranty	5 year

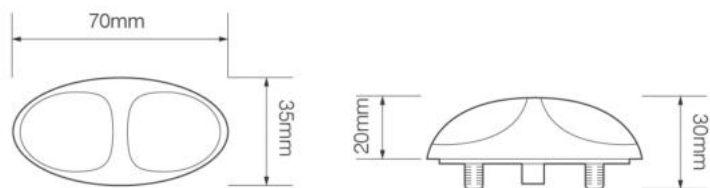

Amber side-marker light

- Amber side marker
- 12/24V (multivoltage)
- Black housing

Cable version (30cm): DC 0,75mm² connection: DC 1,5mm² connection:



Red rear-marker light

- Red rear marker
- 12/24V (multivoltage)
- Black housing

Cable version (30cm): DC 0,75mm² connection: DC 1,5mm² connection:



White front-marker light

- White front marker
- 12/24V (multivoltage)
- Black housing

Cable version (30cm): DC 0,75mm² connection: DC 1,5mm² connection:



Amber side-marker light

- Amber side marker
- 12/24V (multivoltage)
- Chrome housing

Cable version (30cm): DC 0,75mm² connection: DC 1,5mm² connection:



Red rear-marker light

- Red rear marker
- 12/24V (multivoltage)
- Chrome housing

Cable version (30cm): DC 0,75mm² connection: DC 1,5mm² connection:



White front-marker light

- White front marker
- 12/24V (multivoltage)
- Chrome housing

Cable version (30cm): DC 0,75mm² connection: DC 1,5mm² connection:





TRALEAT®

BETTER LIGHT - WORK SAFER

LED Marker lights 12/24v

800-Series

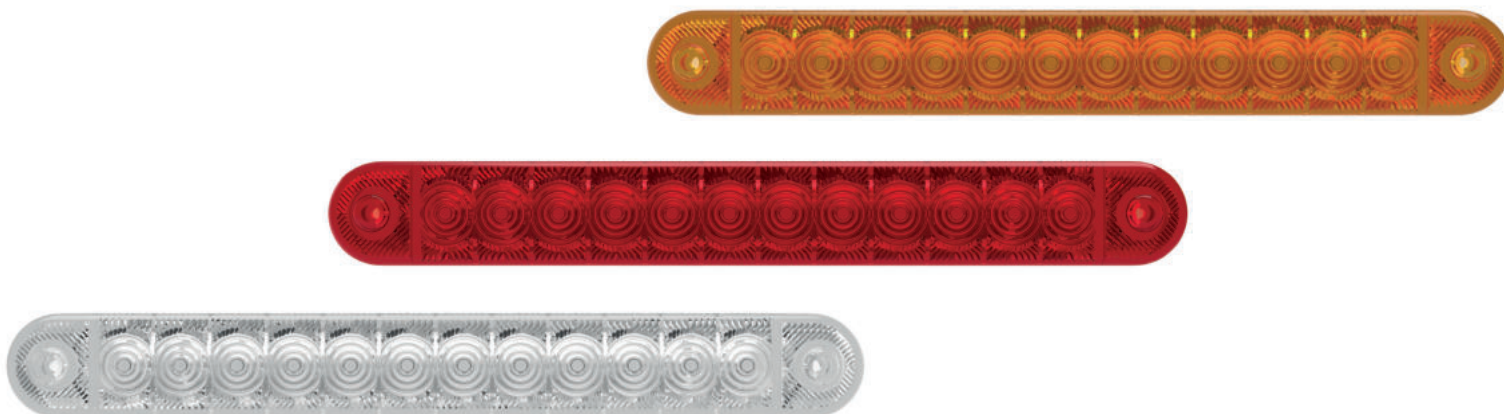

Specifications	Description	800-series of LED Marker lights, with an E-mark. The mounting can be done with screws and / or adhesive tape.
	EMC suppressed	Yes
	Light colour	Amber / Red / White
	Reflector	No
	Size incl. bracket	225 x 28 x 13mm
	Size excl. bracket	Nvt
	IP rate	Waterproof
	Current draw 12v	Amber: 0,05A Red: 0,03A White: 0,08A
	Current draw 24v	Amber: 0,05A Red: 0,03A White: 0,08A
	Warranty	2 year

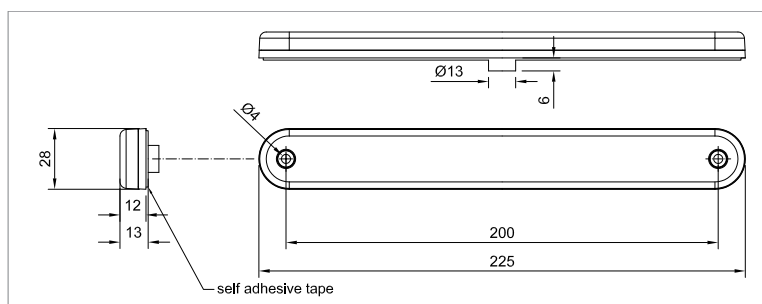

Amber side-marker light

- Amber side marker
- 12/24V (multivoltage)
- screws and / or adhesive tape

Cable version (50cm):	DC 0,75mm ² connection:	DC 1,5mm ² connection:
M10MV-800A	N/A	N/A

Red rear-marker light

- Red rear marker
- 12/24V (multivoltage)
- screws and / or adhesive tape

Cable version (50cm):	DC 0,75mm ² connection:	DC 1,5mm ² connection:
M10MV-800R	N/A	N/A

White front-marker light

- White front marker
- 12/24V (multivoltage)
- screws and / or adhesive tape

Cable version (50cm):	DC 0,75mm ² connection:	DC 1,5mm ² connection:
M10MV-800W	N/A	N/A



TRALERT®

BETTER LIGHT - WORK SAFER

LED Marker lights 12/24v

1300-Series



Specifications

Description	1300-series LED Marker lights, equipped with a E mark. Optionally available with a mounting bracket.
EMC suppressed	Yes
Light colour	Amber / Red / White
Reflector	Yes
Size incl. bracket	ø80 x 29mm
Size excl. bracket	111 x 83 x 59mm
IP rate	Waterproof
Current draw 12v	Amber: 0,04A Red: 0,03A White: 0,04A
Current draw 24v	Amber: 0,04A Red: 0,03A White: 0,04A
Warranty	2 year

Optional mounting bracket

MAC-1300

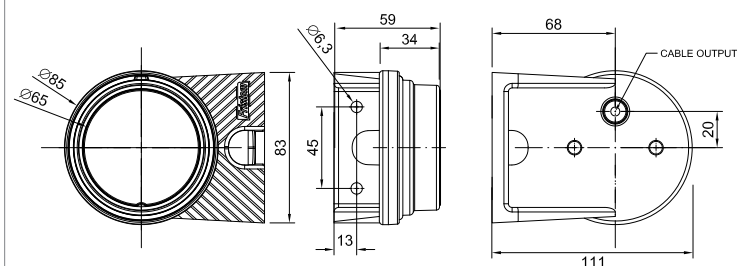
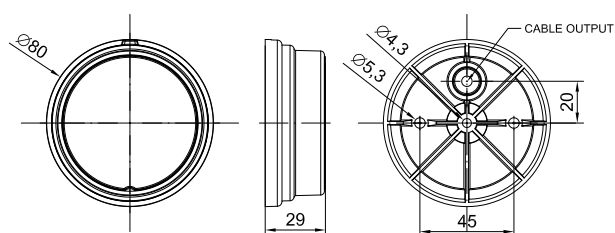

Amber side-marker light

- Amber side marker
- 12/24V (multivoltage)
- Excl. optional mounting bracket.

Cable version (50cm): DC 0,75mm² connection: DC 1,5mm² connection:



Red rear-marker light

- Red rear marker
- 12/24V (multivoltage)
- Excl. optionele mounting bracket.

Cable version (50cm): DC 0,75mm² connection: DC 1,5mm² connection:

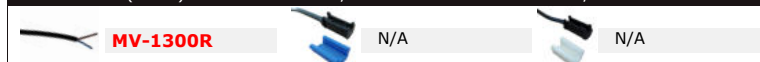

White front-marker light

- White front marker
- 12/24V (multivoltage)
- Excl. optionele mounting bracket.

Cable version (50cm): DC 0,75mm² connection: DC 1,5mm² connection:

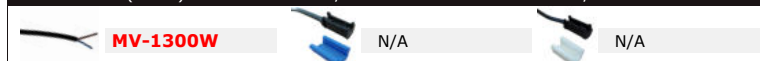



TRALET®

BETTER LIGHT - WORK SAFER

LED Marker lights 12/24v

1400-Series

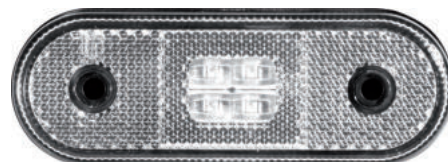
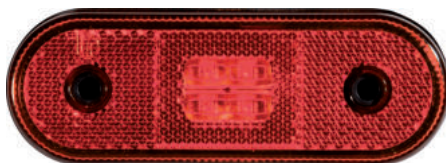

Specifications	Description	1400-series LED Marker lights, equipped with a E mark. Optionally available with a mounting bracket.	
	EMC suppressed	Yes	
	Light colour	Amber / Red / White	
	Reflector	Yes	
	Size incl. bracket	120 x 46 x 18mm	
	Size excl. bracket	120 x 67 x 35mm	
	IP rate	Waterproof	
	Current draw 12v	Amber: 0,04A	Red: 0,03A White: 0,04A
	Current draw 24v	Amber: 0,04A	Red: 0,03A White: 0,04A
	Warranty	2 year	

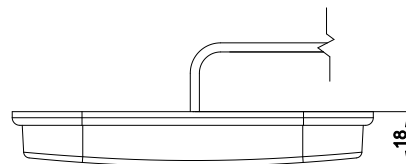
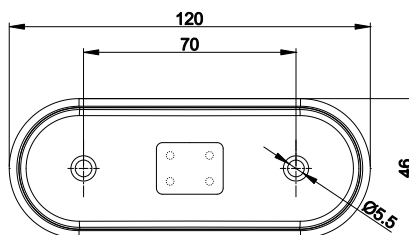

Optional mounting bracket

MAC-1400

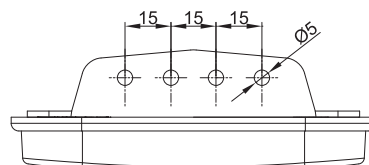
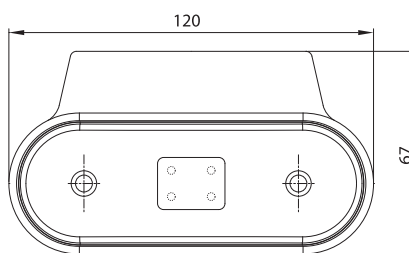

Amber side-marker light

- Amber side marker
- 12/24V (multivoltage)
- Excl. optionele mounting bracket.

Cable version (50cm):	DC 0,75mm ² connection:	DC 1,5mm ² connection:
MV-1400A	MV-1410A	MV-1420A

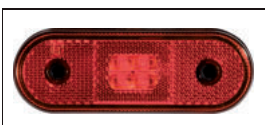

Red rear-marker light

- Red rear marker
- 12/24V (multivoltage)
- Excl. optionele mounting bracket.

Cable version (50cm):	DC 0,75mm ² connection:	DC 1,5mm ² connection:
MV-1400R	MV-1410R	MV-1420R

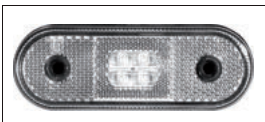

White front-marker light

- White front marker
- 12/24V (multivoltage)
- Excl. optionele mounting bracket.

Cable version (50cm):	DC 0,75mm ² connection:	DC 1,5mm ² connection:
MV-1400W	MV-1410W	MV-1420W

**TRALERT®**

BETTER LIGHT - WORK SAFER

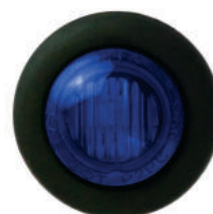
LED Marker lights 12/24v**181-Series**

Specifications

Description	181-series LED Recess Marker lights, with an E-mark (excl. the green and blue color)*
EMC suppressed	Yes
Light colour	Amber / Red / White / Blue* / Green*
Reflector	No
Size incl. bracket	ø28 x 25mm
Size excl. bracket	ø20mm
IP rate	IP67
Current draw 12v	0,03A
Current draw 24v	0,03A
Warranty	5 year

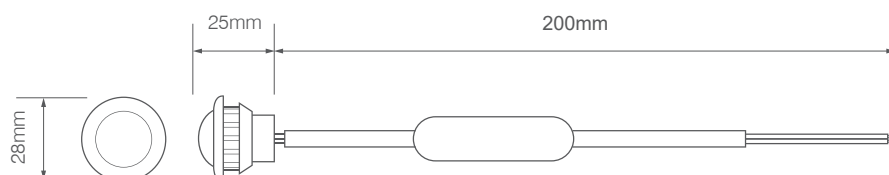

Optional chrome bezel

181C**Amber side-marker light**

- Amber side marker
- 12/24V (multivoltage)
- Optional with chrome bezel

Cable version (20cm): DC 0,75mm² connection: DC 1,5mm² connection:**Red rear-marker light**

- Red rear marker
- 12/24V (multivoltage)
- Optional with chrome bezel

Cable version (20cm): DC 0,75mm² connection: DC 1,5mm² connection:**White front-marker light**

- White front marker
- 12/24V (multivoltage)
- Optional with chrome bezel

Cable version (20cm): DC 0,75mm² connection: DC 1,5mm² connection:**Blue decorative light**

- Blue decorative light (without an E-mark)
- 12/24V (multivoltage)
- Optional with chrome bezel

Cable version (20cm): DC 0,75mm² connection: DC 1,5mm² connection:**Green decorative light**

- Green decorative light (without an E-mark)
- 12/24V (multivoltage)
- Optional with chrome bezel

Cable version (20cm): DC 0,75mm² connection: DC 1,5mm² connection:

LED Side Marker / Side Indicator Lamp 12/24v

Regulation 48 contains new guidelines on direction indicators; it stipulates that, for trailers and semi-trailers, three side indicator lamps must be located on the side of the vehicle, unless three side marker lamp with integrated Cat.5 indicator are fitted.

On pages 23 to 26 you will find our range of side indicators or flashing marker lights. These are available in various sizes and designs and are available as category 5 and category 6 indicators.

Below you will find important dates for when the new regulation comes into place as well as brief requirements:

From November 2017: New trailers that have yet to be type approved will have to meet the new requirements of regulation 48.06

From October 2020: ALL new built trailers must meet regulation 48.06



LED Side Marker / Side Indicator Lamp 12/24v

ZK-200 Series

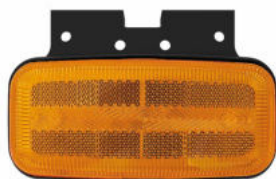

Inactive



Indicator illuminated

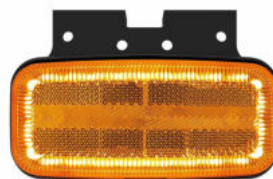

Side-marker illuminated

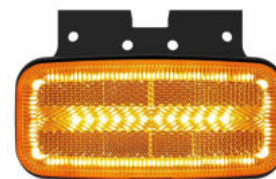

Side-marker and indicator illuminated

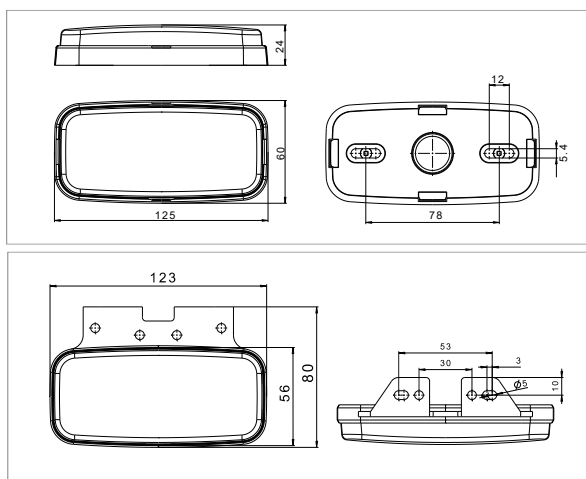

The ZK-200 series is an LED marker light including a Cat.5 side side-indicator. This model keeps the marker light active when the indicator is switched on.

Specifications	Description	ZK-200 series LED side marker with side indicator lamp (Cat 5.), provided with an E-mark
	EMC suppressed	Yes
	Light colour	Amber
	Reflector	Yes
	Size incl. bracket	125 x 60 x 24mm
	Size excl. bracket	123 x 80 x 36mm
	IP rate	Waterproof
	Current draw 12v	Indicator: 0,08A marker light: 0,08A
	Current draw 24v	Indicator: 0,08A marker light: 0,08A
	Warranty	2 year

Wire colour codes: ● Indicator ● Markerlight ○ Ground

LED side marker with side indicator lamp

- ZK-200 series LED side marker with side indicator lamp (Cat 5.)
- 12/24V (multivoltage)
- 50cm cable (3-core)
- Excl. mounting bracket

Cable version (50cm):

 **M10ZK-200**

LED side marker with side indicator lamp

- ZK-200 series LED side marker with side indicator lamp (Cat 5.)
- 12/24V (multivoltage)
- 50cm cable (3-core)
- Incl. mounting bracket

Cable version (50cm):

 **M10ZK-250**



TRALERT®

BETTER LIGHT - WORK SAFER

LED Side Marker / Side Indicator Lamp 12/24v

ZK-100 Series

The ZK-100 series is an LED marker light equipped with a Cat.5 side indicator. This model switches off the marker light as soon as the indicator is switched on. When the indicator is switched off, the marker light will automatically switched on again.

Specifications	Description	ZK-100 series LED side marker with side indicator lamp (Cat 5.), provided with an E-mark
	EMC suppressed	Yes
	Light colour	Amber
	Reflector	Yes
	Size incl. bracket	126 x 51 x 26mm
	Size excl. bracket	124 x 75 x 40mm
	IP rate	Waterproof
	Current draw 12v	Indicator: 0,08A marker light: 0,08A
	Current draw 24v	Indicator: 0,08A marker light: 0,08A
	Warranty	2 year

Wire colour codes: ● Indicator ● Marker light ○ Ground

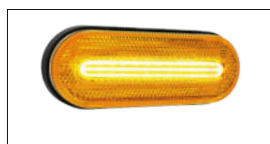
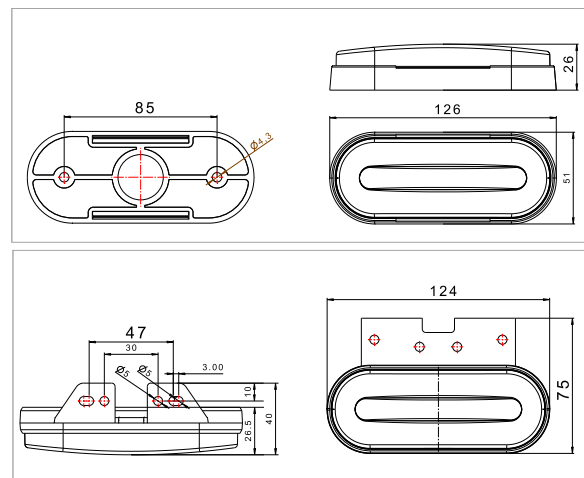

Side Marker / Side Indicator Lamp

- ZK-200 series LED side marker with side indicator lamp (Cat 5.)
- 12/24V (multivoltage)
- 50cm cable (3-core)
- Excl. mounting bracket

Cable version (50cm):

M102K-100

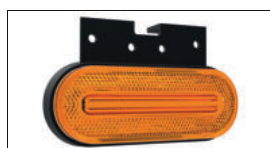

Side Marker / Side Indicator Lamp

- ZK-200 series LED side marker with side indicator lamp (Cat 5.)
- 12/24V (multivoltage)
- 50cm cable (3-core)
- Incl. mounting bracket

Cable version (50cm):

M102K-150

LED Side Marker / Side Indicator Lamp 12/24v

ZK-300 Series

The ZK-300 series is an LED marker light equipped with a Cat.5 side indicator. This model switches off the marker light as soon as the indicator is switched on. When the indicator is switched off, the marker light will automatically switched on again.

Specifications	Description	ZK-100 series LED side marker with side indicator lamp (Cat 5.), provided with an E-mark
	EMC suppressed	Yes
	Light colour	Amber
	Reflector	Yes
	Size incl. bracket	122 x 44 x 19mm
	Size excl. bracket	122 x 60,5 x 19mm
	IP rate	Waterproof
	Current draw 12v	Indicator: 0,12A marker light: 0,09A
	Current draw 24v	Indicator: 0,12A marker light: 0,09A
	Warranty	2 year

Wire colour codes: ● Indicator ● Marker light ○ Ground

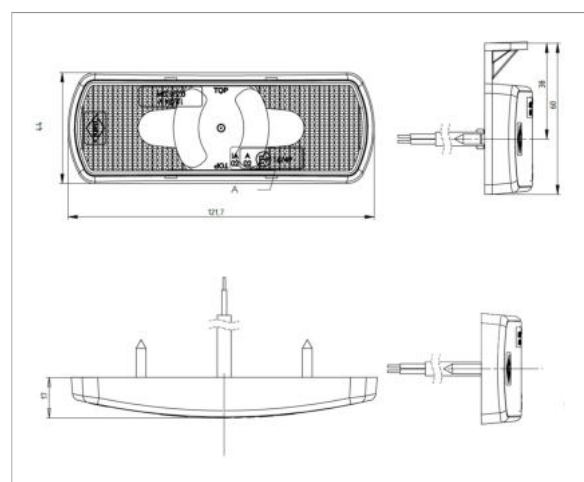

Side Marker / Side Indicator Lamp

- ZK-200 series LED side marker with side indicator lamp (Cat 5.)
- 12/24V (multivoltage)
- 50cm cable (3-core)
- Excl. mounting bracket

Cable version (50cm):

M142K-300



Side Marker / Side Indicator Lamp

- ZK-200 series LED side marker with side indicator lamp (Cat 5.)
- 12/24V (multivoltage)
- 50cm cable (3-core)
- Incl. mounting bracket

Cable version (50cm):

M142K-350



TRALEART®

BETTER LIGHT - WORK SAFER

LED Side Indicator 12/24v

58-series

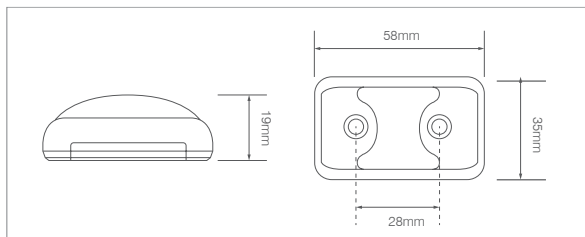

Specifications	Description	58-series LED Side Indicator (Cat 5.) without a marker light, with an E-mark approval
	EMC suppressed	Yes
	Light colour	Amber
	Reflector	No
	Size incl. bracket	58 x 35 x 19mm
	Size excl. bracket	N/A
	IP rate	IP67
	Current draw 12v	0,10A
	Current draw 24v	0,07A
	Warranty	5 year



Side Indicator

- Side Indicator
- 12/24V (multivoltage)
- Black housing

Cable version (40cm):

 **58AME**



Side Indicator

- Side Indicator
- 12/24V (multivoltage)
- Chrome housing

Cable version (40cm):

 **58CAME**

LED Side Indicator 12/24v

35-series

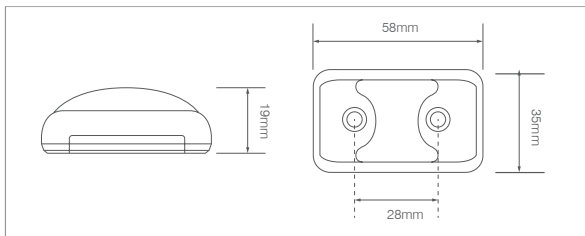

Specifications	Description	35-series LED Side Indicator (Cat 5.) without a marker light, with an E-mark approval
	EMC suppressed	Yes
	Light colour	Amber
	Reflector	No
	Size incl. bracket	58 x 35 x 19mm
	Size excl. bracket	N/A
	IP rate	IP67
	Current draw 12v	0,10A
	Current draw 24v	0,04A
	Warranty	5 year



Side Indicator

- Side Indicator
- 12/24V (multivoltage)
- Black housing

Cable version (40cm):

 **35AME**



Side Indicator

- Side Indicator
- 12/24V (multivoltage)
- Chrome housing

Cable version (40cm):

 **35CAME**



TRALERT®

BETTER LIGHT - WORK SAFER

LED Side Indicator 12/24v

77A-Series



Specifications

Description	79-series LED side indicator (Cat 6.) with an E-mark and available with amber and clear lens
EMC suppressed	Yes
Light colour	Amber
Reflector	No
Size incl. bracket	77 x 52 x 22mm
Size excl. bracket	Nvt
IP rate	IP67
Current draw 12v	0,02A
Current draw 24v	0,01A
Warranty	5 year

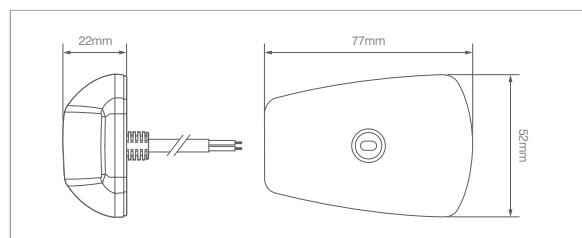

Side Indicator Cat. 6

- Side indicator
- 12/24V (multivoltage)
- Easy fit with 3M Tape and Plug
- Amber lens

Cable version (30cm):

77AMB



Side Indicator Cat. 6

- Side indicator
- 12/24V (multivoltage)
- Easy fit with 3M Tape and Plug
- Clear lens (chrome-look)

Cable version (30cm):

77ACMB

LED Side Indicator 12/24v

3102-series



Specifications

Description	3102-series LED side indicator (Cat 6.) with an E-mark and available with black or chrome housing
EMC suppressed	Yes
Light colour	Amber
Reflector	No
Size incl. bracket	150 x 88 x 30mm
Size excl. bracket	N/A
IP rate	IP67
Current draw 12v	0,02A
Current draw 24v	0,01A
Warranty	5 year

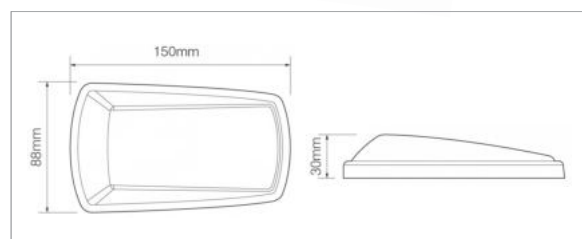

Side Indicator Cat. 6

- Side indicator
- 12/24V (multivoltage)
- Black housing

Cable version (19cm):

3102BM

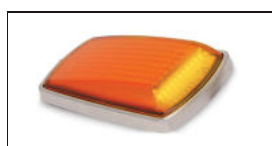

Side Indicator Cat. 6

- Side indicator
- 12/24V (multivoltage)
- Chrome housing

Cable version (19cm):

3102CM



TRALERT®

BETTER LIGHT - WORK SAFER

LED Stalk Marker Lamps 12/24v

- Available with a clear lens for an old school retro look and a frosted lens for a modern look
- Available with a short or long angled arm
- 50cm cable (2 x 0,75mm²)
- IP68 waterproof
- Multivoltage 12/24v
- The articles that have an article number ending in RW or A are provided with an E-marking and thus provided with the correct homologation to be used as a stalk lamp (RW extension) or as an indicator (A-extension). The lamps ending in RA do NOT have an E-mark, they are generally used for styling.
- Dimensions short version: $\varnothing 79 \times 107\text{mm}$
- Dimensions long version: 192,5 x 168 x 87mm
- 2 year warranty

Replacement parts

Replacement unit amber (clear / 5m. cable)

 **Art.nr** **MB-1010AM**

Replacement unit amber (frosted / 5m. cable)

 **Art.nr** **MB-1020AM**

Replacement unit red (clear / 5m. cable)

 **Art.nr** **MB-1010RM**

Replacement unit red (frosted / 5m. cable)

 **Art.nr** **MB-1020RM**

Replacement unit white (clear / 5m. cable)

 **Art.nr** **MB-1010WM**

Replacement unit white (frosted / 5m. cable)

 **Art.nr** **MB-1020WM**

Short arm replacement part

Art.nr **MB-1010ARM**

Long arm replacement part

Art.nr **MB-1011ARM**



Looks frosted lens



Looks clear lens

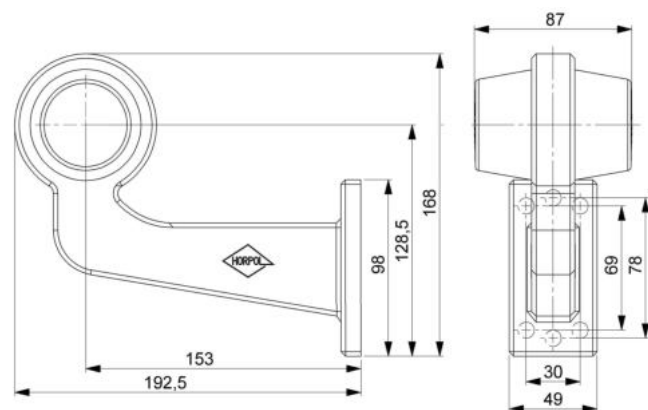
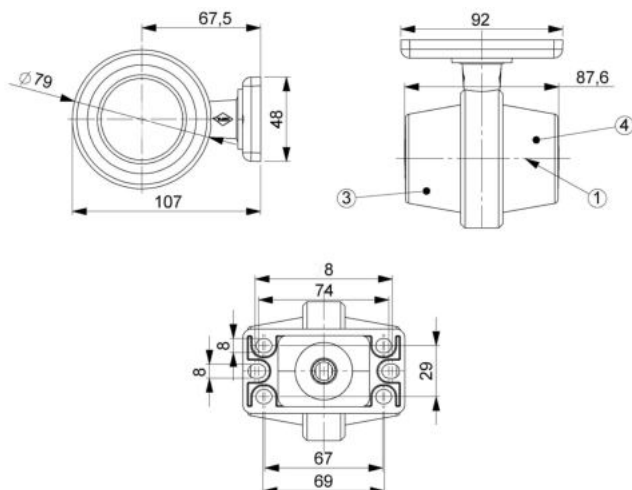



TRALERT®

BETTER LIGHT - WORK SAFER

MB-1000 Series

Clear



Stalk lamp short



- Stalk lamp with short arm
- 12/24V (multivoltage)
- Red / white with clear lenses

Article number: **MB-1010RW**

Frosted



Stalk lamp short



- Stalk lamp with short arm
- 12/24V (multivoltage)
- Red / white with frosted lenses

Article number: **MB-1020RW**

Clear



Stalk lamp left / angled



- Left stalk lamp with long angled arm
- 12/24V (multivoltage)
- Red / white with clear lenses

Article number: **MB-1011RW**

Frosted



Stalk lamp left / angled



- Left stalk lamp with long angled arm
- 12/24V (multivoltage)
- Red / white with frosted lenses

Article number: **MB-1021RW**

Clear



Stalk lamp right / angled



- Right stalk lamp with long angled arm
- 12/24V (multivoltage)
- Red / white with clear lenses

Article number: **MB-1012RW**

Frosted



Stalk lamp right / angled



- Right stalk lamp with long angled arm
- 12/24V (multivoltage)
- Red / white with frosted lenses

Article number: **MB-1022RW**

Clear



Indicator / Stalk lamp kort



- Indicator / Stalk lamp with short arm
- 12/24V (multivoltage)
- Amber with clear lenses

Article number: **MB-1010A**

Frosted



Indicator / Stalk lamp kort



- Indicator / Stalk lamp with short arm
- 12/24V (multivoltage)
- Amber with frosted lenses

Article number: **MB-1020A**

Clear



Indicator / Stalk lamp haaks



- Indicator / stalk lamp with long angled arm
- 12/24V (multivoltage)
- Amber with clear lenses

Article number: **MB-1013A**

Frosted



Indicator / Stalk lamp angled



- Indicator / stalk lamp with long angled arm
- 12/24V (multivoltage)
- Amber with frosted lenses

Article number: **MB-1023A**

Clear



Stalk lamp short



- Stalk lamp with short arm
- 12/24V (multivoltage)
- Red / amber with clear lenses

Article number: **MB-1010RA**

Frosted



Stalk lamp short



- Stalk lamp with short arm
- 12/24V (multivoltage)
- Red / amber with frosted lenses

Article number: **MB-1020RA**

Clear



Stalk lamp left / angled



- Left stalk lamp with long angled arm
- 12/24V (multivoltage)
- Red / amber with clear lenses

Article number: **MB-1011RA**

Frosted



Stalk lamp left / angled



- Left stalk lamp with long angled arm
- 12/24V (multivoltage)
- Red / amber with frosted lenses

Article number: **MB-1021RA**

Clear



Stalk lamp right / angled



- Right stalk lamp with long angled arm
- 12/24V (multivoltage)
- Red / amber with clear lenses

Artikelnummer: **MB-1012RA**

Frosted



Stalk lamp right / angled



- Right stalk lamp with long angled arm
- 12/24V (multivoltage)
- Red / amber with frosted lenses

Artikelnummer: **MB-1022RA**



TRALEAT®

BETTER LIGHT - WORK SAFER

LED Stalk Marker Lamps 12/24v

MB-145 Series



Specifications

Description	MB-145 series LED Stalk Marker Lamps with an E-mark approval
EMC ontstoord	Yes
Lichtkleuren	Amber / Red / White
Afmeting	190,3 x 126 x 37,5mm
IP-waarde	Waterproof
Stroomverbruik 12v	0,01A
Stroomverbruik 24v	0,01A
Garantie	2 year

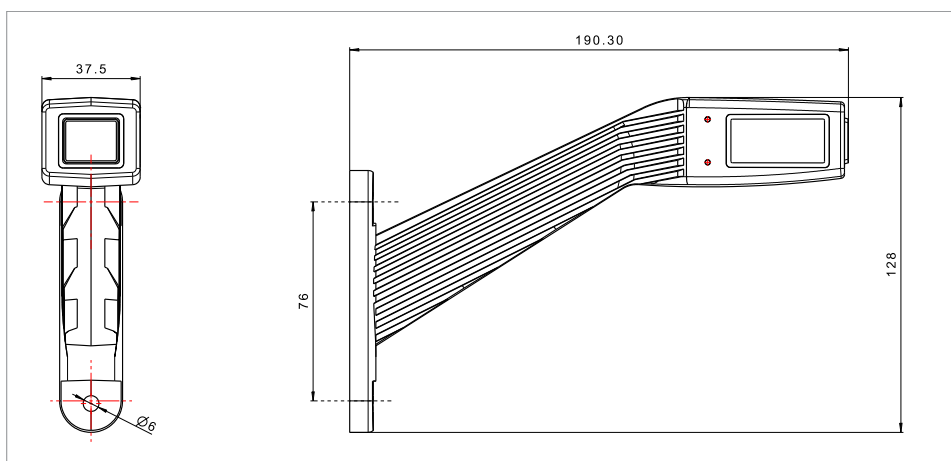
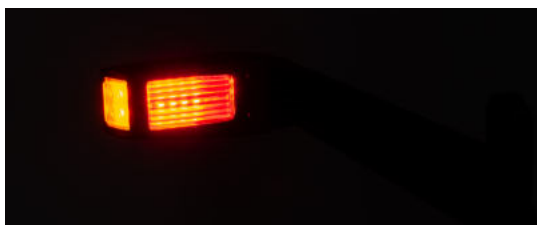

Left stalk marker lamp

- Left stalk lamp with slanting arm
- 12/24V (multivoltage)
- With red/white/amber light output

Right stalk marker lamp

- Right stalk lamp with slanting arm
- 12/24V (multivoltage)
- With red/white/amber light output

Cable version (30cm):



MB-1451

DC 0,75mm² connection:



N/A

DC 1,5mm² connection:



N/A



Cable version (30cm):



MB-1452

DC 0,75mm² connection:



N/A

DC 1,5mm² connection:



N/A





TRALERT®

BETTER LIGHT - WORK SAFER

LED Stalk Marker Lamps 12/24v

MB-100 Series

Specifications

Description	MB-100 series LED stalk marker lamps with an E-mark approval
EMC suppressed	Yes
Light colour	Red / white
Size	118 x 88 x 45mm
IP rate	Waterproof
Current draw 12v	0,04A
Current draw 24v	0,04A
Warranty	2 year

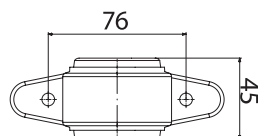
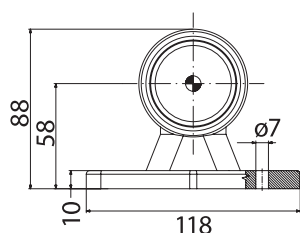

Stalk Lamps

- Universal stalk lamp with a short arm
- 12/24V (multivoltage)
- With Red/white light output

Cable version (20cm):

M10BV-100RW

DC 0,75mm² connection:

M10BV-110RW

DC 1,5mm² connection:

M10BV-120RW

LED Stalk Lamps 12/24v

MB-200 Series

Specifications

Description	MB-200 series LED stalk marker lamps with an E-mark approval
EMC suppressed	Yes
Light colour	Red / White
Size	118 x 130 x 45mm
IP rate	Waterproof
Current draw 12v	0,04A
Current draw 24v	0,04A
Warranty	2 year

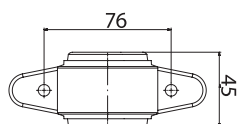
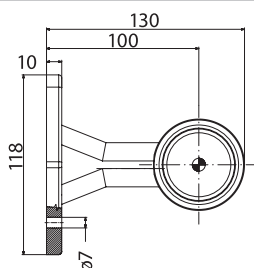

Stalk Lamps

- Universal stalk lamp with a short straight arm
- 12/24V (multivoltage)
- With Red/white light output

Cable version (20cm):

M10BV-200RW

DC 0,75mm² connection:

M10BV-210RW

DC 1,5mm² connection:

M10BV-220RW

LED Stalk Marker Lamps 12/24v

MB-300 Series



Specifications	Description	MB-300 series LED stalk marker lamps with an E-mark approval
	EMC suppressed	Yes
	Light colour	Red / white
	Size	118 x 133 x 45mm
	IP rate	Waterproof
	Current draw 12v	0,04A
	Current draw 24v	0,04A
	Warranty	2 year

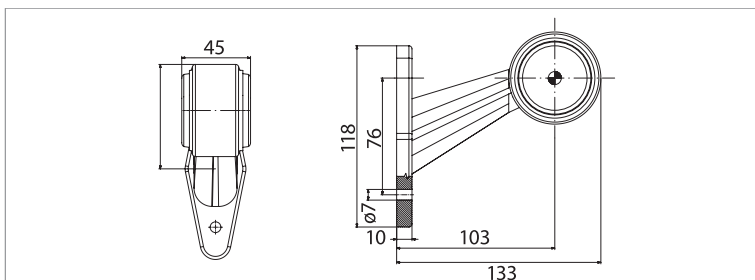

Left stalk lamp

- Left stalk lamp with a short slanting arm
- 12/24V (multivoltage)
- With Red/white light output



Right stalk lamp

- Right stalk lamp with a short slanting arm
- 12/24V (multivoltage)
- With Red/white light output

Cable version (20cm):	DC 0,75mm ² connection:	DC 1,5mm ² connection:
 M10BV-301RW	 M10BV-311RW	 M10BV-321RW

Cable version (20cm):	DC 0,75mm ² connection:	DC 1,5mm ² connection:
 M10BV-302RW	 M10BV-312RW	 M10BV-322RW

LED Stalk Marker Lamps 12/24v

MB-400 Series



Specifications	Description	MB-400 series LED stalk marker lamps with an E-mark approval
	EMC suppressed	Yes
	Light colour	Red / white
	Size	135 x 130 x 45mm
	IP rate	Waterproof
	Current draw 12v	0,04A
	Current draw 24v	0,04A
	Warranty	2 year

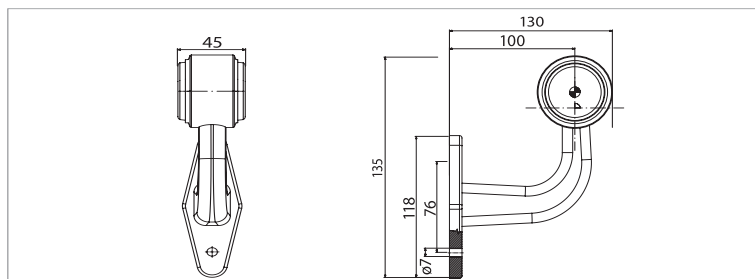

Left stalk lamp

- Left stalk lamp with a short angled arm
- 12/24V (multivoltage)
- With Red/white light output

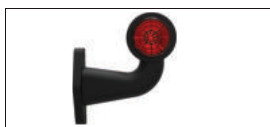

Right stalk lamp

- Right stalk lamp with a short angled arm
- 12/24V (multivoltage)
- With Red/white light output

Cable version (20cm):	DC 0,75mm ² connection:	DC 1,5mm ² connection:
 M10BV-401RW	 M10BV-411RW	 M10BV-421RW

Cable version (20cm):	DC 0,75mm ² connection:	DC 1,5mm ² connection:
 M10BV-402RW	 M10BV-412RW	 M10BV-422RW



TRALERT®

BETTER LIGHT - WORK SAFER

LED Stalk Marker Lamps 12/24v

MB-500 Series

Specifications

Description	MB-500 series LED stalk marker lamps with an E-mark approval
EMC suppressed	Yes
Light colour	Red / white
Size	194 x 135 x 45mm
IP rate	Waterproof
Current draw 12v	0,04A
Current draw 24v	0,04A
Warranty	2 year

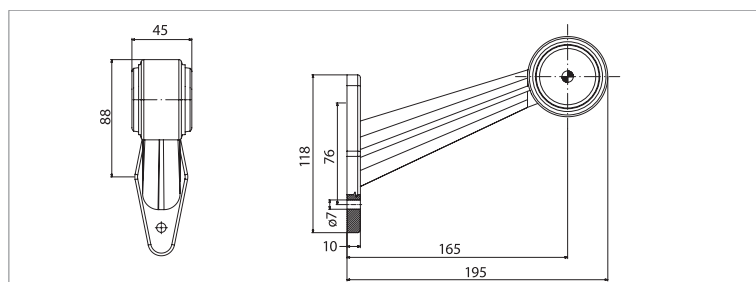

Left stalk lamp

- Left stalk lamp with a slanting arm
- 12/24V (multivoltage)
- With Red/white light output

Cable version (20cm):	DC 0,75mm ² connection:	DC 1,5mm ² connection:
M10BV-501RW	M10BV-511RW	M10BV-521RW

Right stalk lamp

- Right stalk lamp with a slanting arm
- 12/24V (multivoltage)
- With Red/white light output

Cable version (20cm):	DC 0,75mm ² connection:	DC 1,5mm ² connection:
M10BV-502RW	M10BV-512RW	M10BV-522RW

LED Stalk Marker Lamps 12/24v

MB-600 Series

Specifications

Description	MB-600 series LED stalk marker lamps with an E-mark approval
EMC suppressed	Yes
Light colour	Red / white
Size	135 x 175 x 45mm
IP rate	Waterproof
Current draw 12v	0,04A
Current draw 24v	0,04A
Warranty	2 year

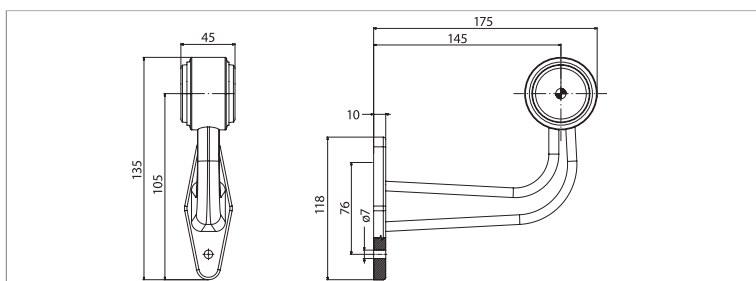

Left stalk lamp

- Left stalk lamp with a angled arm
- 12/24V (multivoltage)
- With Red/white light output

Cable version (20cm):	DC 0,75mm ² connection:	DC 1,5mm ² connection:
M10BV-601RW	M10BV-611RW	M10BV-621RW

Right stalk lamp

- Right stalk lamp with a angled arm
- 12/24V (multivoltage)
- With Red/white light output

Cable version (20cm):	DC 0,75mm ² connection:	DC 1,5mm ² connection:
M10BV-602RW	M10BV-612RW	M10BV-622RW



TRALERT®

BETTER LIGHT - WORK SAFER

LED Stalk Marker Lamps 12/24v

1004-Series



Specifications	Description	1004-series LED stalk marker lamps with an E-mark approval
	EMC suppressed	Yes
	Light colour	Red / white
	Size (short version)	166 x 193 x 66mm
	Size	101 x 82 x 66mm
	IP rate	IP67
	Current draw 12v	0,04A
	Current draw 24v	0,04A
	Warranty	5 year

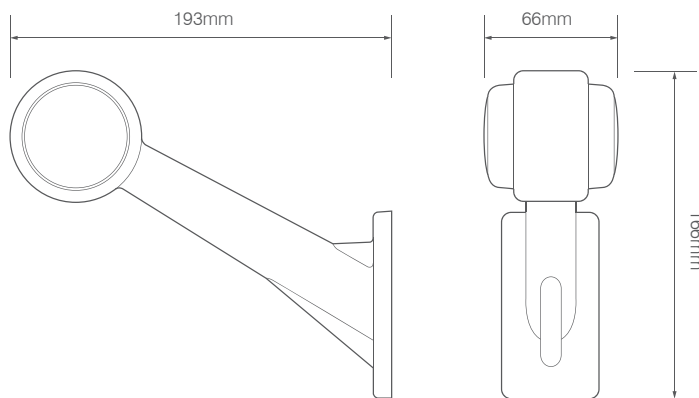
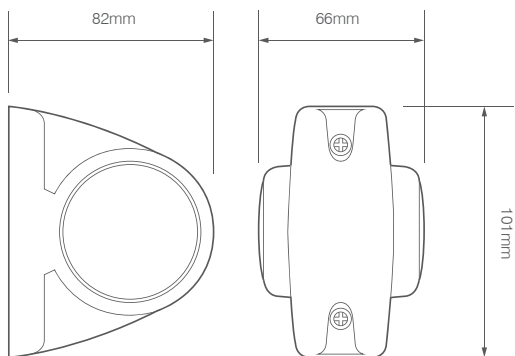

Stalk Marker Lamps

- Universal stalk lamp, short version
- 12/24V (multivoltage)
- With Red/white light output

Cable version (20cm):	DC 0,75mm ² connection:	DC 1,5mm ² connection:
1004RWM	N/A	N/A



Left Stalk Marker Lamps

- Left stalk lamp with a slanting arm
- 12/24V (multivoltage)
- With Red/white light output

Cable version (20cm):	DC 0,75mm ² connection:	DC 1,5mm ² connection:
1004LE	N/A	N/A



Right Stalk Marker Lamps

- Right stalk lamp with a slanting arm
- 12/24V (multivoltage)
- With Red/white light output

Cable version (20cm):	DC 0,75mm ² connection:	DC 1,5mm ² connection:
1004RE	N/A	N/A



TRALERT®

BETTER LIGHT - WORK SAFER

LED Stalk Marker Lamps 12/24v

1005-Series



Specifications

Description	1005-series LED stalk marker lamps with an E-mark approval
EMC suppressed	Yes
Light colour	Red / white / amber
Size (short version)	166 x 193 x 66mm
Size (long version)	101 x 82 x 66mm
IP rate	IP67
Current draw 12v	0,04A
Current draw 24v	0,04A
Warranty	5 year

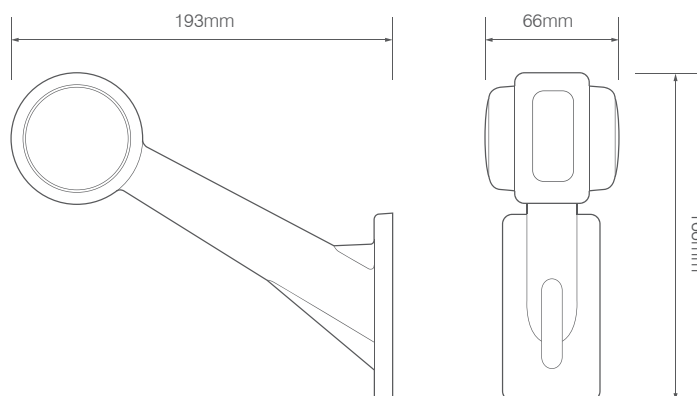
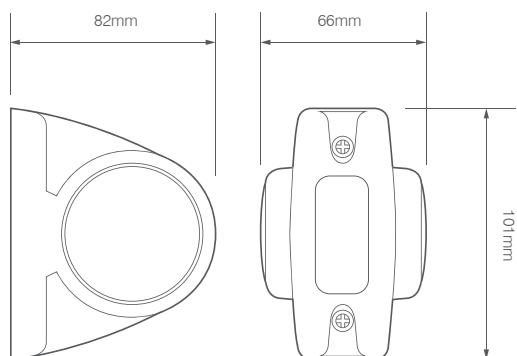

Stalk Lamps

- Left stalk lamp with, short version
- 12/24V (multivoltage)
- With Red/white/amber light output

Cable version (20cm):	DC 0,75mm ² connection:	DC 1,5mm ² connection:
1005RWM	N/A	N/A



Left Stalk Lamps

- Left stalk lamp with a slanting arm
- 12/24V (multivoltage)
- With Red/white/amber light output

Cable version (20cm):	DC 0,75mm ² connection:	DC 1,5mm ² connection:
1005LE	N/A	N/A



Right Stalk Lamps

- Right stalk lamp with a slanting arm
- 12/24V (multivoltage)
- With Red/white/amber light output

Cable version (20cm):	DC 0,75mm ² connection:	DC 1,5mm ² connection:
1005RE	N/A	N/A



TRALERT®

BETTER LIGHT - WORK SAFER

LED Front/Rear Marker Lamp 12/24v

37-Series

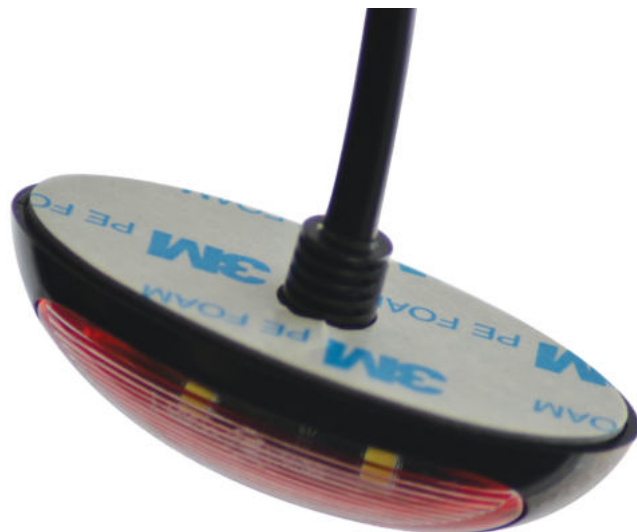

Specifications	Description	37-series LED Front/Rear marker lamp with an E-mark and are available with a black or chrome bracket.
	EMC suppressed	Yes
	Light colour	Red / White
	Size	70 x 35 x 20mm
	IP rate	IP67
	Current draw 12v	0,04A
	Current draw 24v	0,04A
	Warranty	5 year

Optional rubber bracket

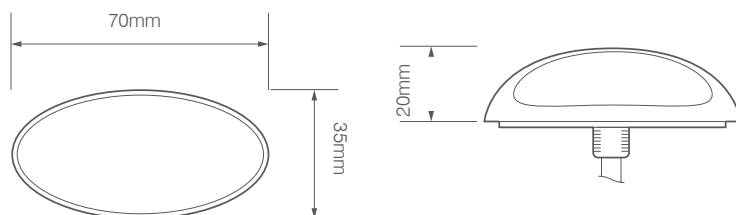

Front/Rear marker lamp

- Universal Front/Rear marker lamp
- 12/24V (multivoltage)
- Black housing
- With red/white light output

Cable version (30cm):	DC 0,75mm ² connection:	DC 1,5mm ² connection:
37RWM	N/A	N/A

Front/Rear marker lamp

- Universal Front/Rear marker lamp
- 12/24V (multivoltage)
- Chrome housing
- With red/white light output

Cable version (30cm):	DC 0,75mm ² connection:	DC 1,5mm ² connection:
37CRWM	N/A	N/A



TRALERT®

BETTER LIGHT - WORK SAFER

LED Front/Rear marker lamp 12/24v

1500-series

Specifications

Description	1500-series LED Front/Rear marker lamp with an E-mark and are available with and without a mounting bracket.
EMC suppressed	Yes
Light colour	Red / white & red / white / amber
Size 1	120 x 40 x 35mm
Size 2	150 x 40 x 35mm
Size 3	136 x 60 x 63mm
IP-rate	IP67
Current draw 12v	0,04A
Current draw 24v	0,04A
Warranty	2 year

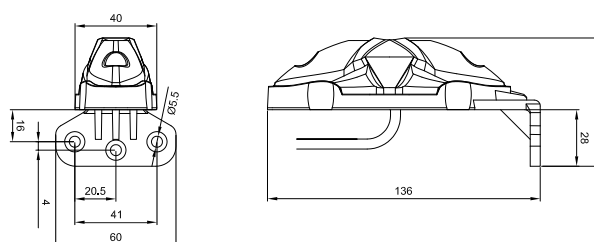
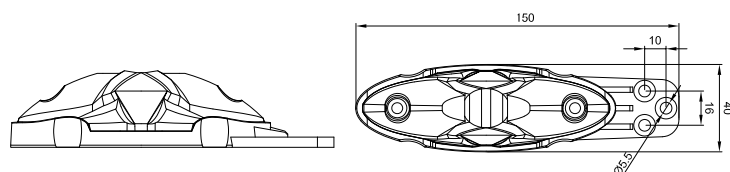
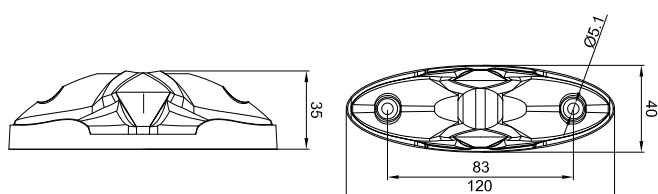

Front/Rear marker lamp

- Universal front/rear marker lamp
- Light colour red/white
- 12/24V (multivoltage)
- Without mounting bracket

Cable version (50cm): DC 0,75mm² connection: DC 1,5mm² connection:



Front/Rear marker lamp

- Universal front/rear marker lamp
- Light colour red/white/amber
- 12/24V (multivoltage)
- Without mounting bracket

Cable version (50cm): DC 0,75mm² connection: DC 1,5mm² connection:



Front/Rear marker lamp

- Universal front/rear marker lamp
- Light colour red/white
- 12/24V (multivoltage)
- With mounting bracket

Cable version (50cm): DC 0,75mm² connection: DC 1,5mm² connection:



Front/Rear marker lamp

- Universal front/rear marker lamp
- Light colour red/white/amber
- 12/24V (multivoltage)
- With mounting bracket

Cable version (50cm): DC 0,75mm² connection: DC 1,5mm² connection:



Front/Rear marker lamp

- Universal front/rear marker lamp
- Light colour red/white
- 12/24V (multivoltage)
- With mounting bracket

Cable version (50cm): DC 0,75mm² connection: DC 1,5mm² connection:



Front/Rear marker lamp

- Universal front/rear marker lamp
- Light colour red/white/amber
- 12/24V (multivoltage)
- With mounting bracket

Cable version (50cm): DC 0,75mm² connection: DC 1,5mm² connection:



LED Number Plate Lamp 12/24v

41BLM-Series



Item 41BLME1P contains a 1P connector. This connector fits some rear lights of LED Autolamps. An overview of these taillights can be found in the Tralert rear lights catalog. The suitable lamps contain this image.



Specifications	Description	De 41BLM-series has an E-mark and is available with 2 cable lengths.
	EMC suppressed	Yes
	Dimensions	70 x 40 x 42mm
	IP rate	IP67
	Current draw 12v	0,02A
	Current draw 24v	0,02A
	Warranty	5 year

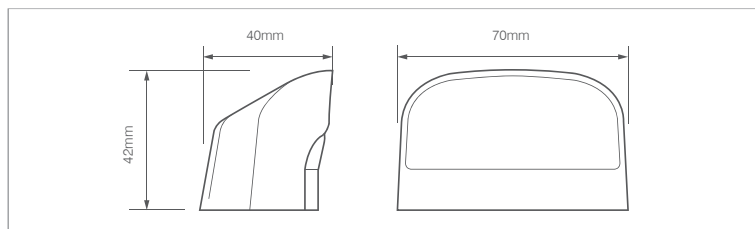

LED Number Plate Lamp

- Universal number plate lamp
- 12/24V (multivoltage)
- With 20cm cable

Cable version (20cm):	DC 0,75mm ² connection:	DC 1,5mm ² connection:
 41BLME	 N/A	 N/A

LED Number Plate Lamp

- Universal number plate lamp
- 12/24V (multivoltage)
- With 100cm cable incl. 1P-connector

Cable version (100cm):	DC 0,75mm ² connection:	DC 1,5mm ² connection:
 41BLM1P	 N/A	 N/A

LED Number Plate Lamp 12/24v

35BLM-Series



Item 41BLME1P contains a 1P connector. This connector fits some rear lights of LED Autolamps. An overview of these taillights can be found in the Tralert rear lights catalog. The suitable lamps contain this image.



Specifications	Description	De 35BLM-series has an E-mark and is available with 2 cable lengths and also available in chrome and black.
	EMC suppressed	Yes
	Dimensions	76x 30 x 41mm
	IP rate	IP67
	Current draw 12v	0,04A
	Current draw 24v	0,04A
	Warranty	5 year

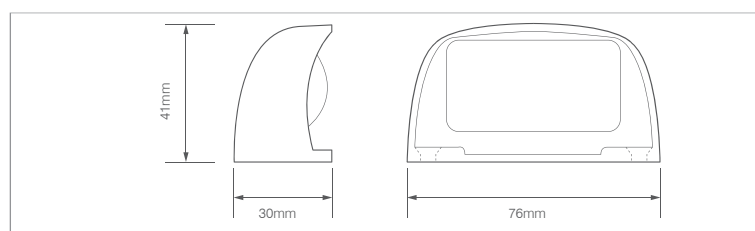

LED Number Plate Lamp

- Universal number plate lamp
- 12/24V (multivoltage)
- With 20cm cable
- Black housing

Cable version (20cm):	DC 0,75mm ² connection:	DC 1,5mm ² connection:
 35BLME	 N/A	 N/A

LED Number Plate Lamp

- Universal number plate lamp
- 12/24V (multivoltage)
- With 100cm cable incl. 1P-connector

Cable version (100cm):	DC 0,75mm ² connection:	DC 1,5mm ² connection:
 35BLME1P	 N/A	 N/A

LED Number Plate Lamp

- Universal number plate lamp
- 12/24V (multivoltage)
- With 20cm cable
- Chrome housing

Cable version (20cm):	DC 0,75mm ² connection:	DC 1,5mm ² connection:
 35CLME	 N/A	 N/A



TRALERT®

BETTER LIGHT - WORK SAFER

LED Number Plate Lamp 12/24v

KV-200 Series

Specifications

Description	De KV-200 series has an E-mark and is available with various connections.
EMC suppressed	Yes
Dimensions	100 x 55 x 55mm
IP rate	Waterproof
Current draw 12v	0,08A
Current draw 24v	0,08A
Warranty	2 year

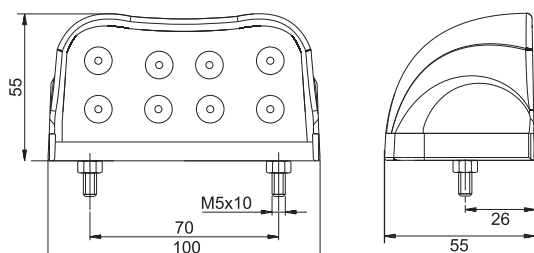

LED Number Plate Lamp

- Universal number plate lamp
- 12/24V (multivoltage)
- Connection by means of sliding connectors on the version without cable.

Zonder kabel: DC 0,75mm² connection: DC 1,5mm² connection:

M10KV-200

M10KV-210

M10KV-220

LED Number Plate Lamp 12/24v

KV-100 series

Specifications

Description	The KV-100 series has an E-marking, available with various connections and is also available with a red marker light
EMC suppressed	Yes
Dimensions	96 x 64 x 66mm
IP rate	Waterproof
Current draw 12v	0,04A / Incl. Red rear marker: 0,06A
Current draw 24v	0,04A / Incl. Red rear marker: 0,06A
Warranty	2 year

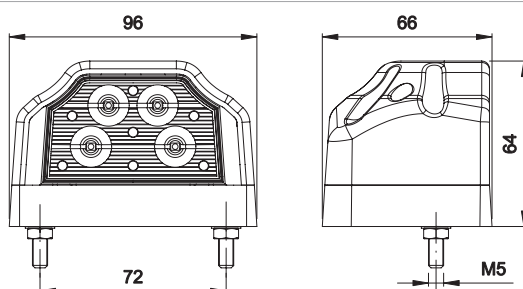

LED Number Plate Lamp

- Universal number plate lamp
- 12/24V (multivoltage)
- Black housing
- Connection by means of sliding connectors on the version without cable.

Zonder kabel: DC 0,75mm² connection: DC 1,5mm² connection:

M10KV-100

M10KV-110

M10KV-120

LED Number Plate Lamp

- Universal number plate lamp
- 12/24V (multivoltage)
- Incl. red rear marker light
- Connection by means of sliding connectors on the version without cable.

Zonder kabel: DC 0,75mm² connection: DC 1,5mm² connection:

M10KV-100R

M10KV-110R

M10KV-120R



TRALERT®

BETTER LIGHT - WORK SAFER

LED Number Plate Lamp 12/24v

KV-300 Series



Specifications	Description	The KV-300 series has an E-marking, available with various connections and is also available with a red marker light
	EMC suppressed	Yes
	Dimensions	83 x 40 x 30mm
	IP rate	Waterproof
	Current draw 12v	0,02A / Incl. Red rear marker: 0,06A
	Current draw 24v	0,02A / Incl. Red rear marker: 0,06A 2
	Warranty	year

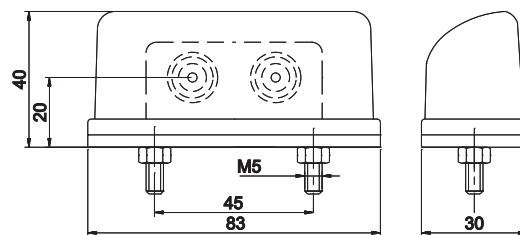

LED Number Plate Lamp

- Universal number plate lamp
- 12/24V (multivoltage)
- Excl. red rear marker

LED Number Plate Lamp

- Universal number plate lamp
- 12/24V (multivoltage)
- Incl. red rear marker

Cable version (50cm):	DC 0,75mm ² connection:	DC 1,5mm ² connection:
M10KV-300	M10KV-310	M10KV-320

Cable version (50cm):	DC 0,75mm ² connection:	DC 1,5mm ² connection:
M10KV-300R	N/A	N/A

LED Number Plate Lamp 12/24v

KV-300H Series



Specifications	Description	The KV-300H series has an E-marking, available with various connections and is also available with a red marker light
	EMC suppressed	Yes
	Dimensions	83 x 50 x 30mm
	IP rate	Waterproof
	Current draw 12v	0,02A / Incl. Red rear marker: 0,06A
	Current draw 24v	0,02A / Incl. Red rear marker: 0,06A
	Warranty	2 year

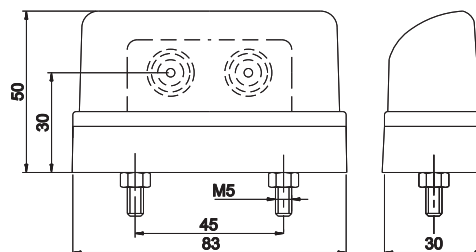

LED Number Plate Lamp

- Universal number plate lamp
- 12/24V (multivoltage)
- Excl. red rear marker

LED Number Plate Lamp

- Universal number plate lamp
- 12/24V (multivoltage)
- Incl. red rear marker

Cable version (50cm):	DC 0,75mm ² connection:	DC 1,5mm ² connection:
M10KV-300H	M10KV-310H	M10KV-320H

Cable version (50cm):	DC 0,75mm ² connection:	DC 1,5mm ² connection:
M10KV-300RH	N/A	N/A



TRALERT®

BETTER LIGHT - WORK SAFER

LED Number Plate Lamp 12/24v

1600-Series



Specifications

Description	1600-series LED number plate lamp is provided with a E-marking and available with various connection options
EMC suppressed	Yes
Size 1	112 x 47 x 49mm
Size 2	120,3 x 57 x 97mm
IP rate	Waterproof
Current draw 12v	0,04A
Current draw 24v	0,04A
Warranty	2 year

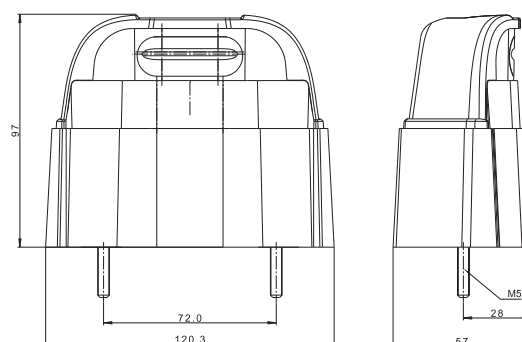
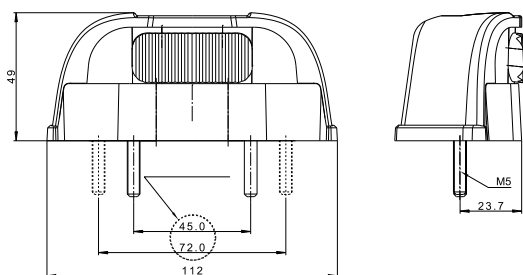

LED Number Plate Lamp

- Universal number plate lamp
- 12/24V (multivoltage)
- Low base housing with clear lens

Cable version (50cm): DC 0,75mm² connection: DC 1,5mm² connection:

MK-1600

MK-1610

MK-1620

LED Number Plate Lamp

- Universal number plate lamp
- 12/24V (multivoltage)
- Low base housing with frosted lens

Cable version (50cm): DC 0,75mm² connection: DC 1,5mm² connection:

MK-1630

MK-1640

MK-1650

LED Number Plate Lamp

- Universal number plate lamp
- 12/24V (multivoltage)
- High base housing with clear lens

Cable version (50cm): DC 0,75mm² connection: DC 1,5mm² connection:

MK-1670

MK-1680

MK-1690

LED Daytime Running light and indicator CAT-1 12/24v

780-Series

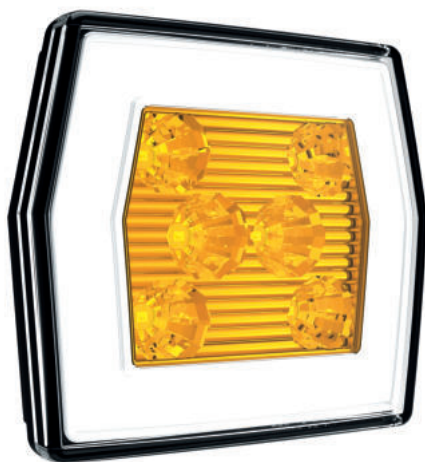

Specifications	Description	De 780-series is a daytime running light with a CAT-1 indicator and this lamp has an E-mark.
	EMC suppressed	Yes
	Dimensions	99,5 x 93 x 39,5mm
	IP rate	Waterproof
	Current draw 12v	Dagrijverl.: 0,13A / knipperlicht: 0,20A
	Current draw 24v	Dagrijverl.: 0,13A / knipperlicht: 0,10A
	Warranty	2 year

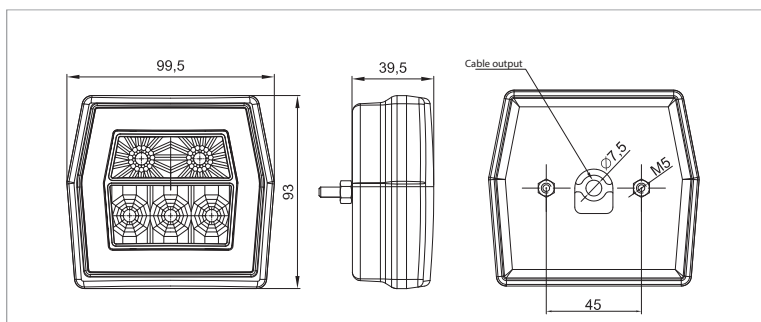

LED Daytime Running with indicator

- Universeel LED Daytime Running with indicator
- 12/24V (multivoltage)
- Available with 100cm cable or one 5-PIN bayonet connection

Cable version (100cm):	5-PIN's bayonetconnection
V10C2-780	V10C2-780B5

LED Daytime Running light and indicator 12 of 24v

80AW-Series



80AW lamps must be used in combination with DRLHOTDOG ! for approved use of daytime running lamp function

Specifications	Description	De 80AW series is a front indicator/front marker, and this lamp has an E-mark.
	EMC suppressed	Yes
	Dimensions	ø80 x 40mm
	IP rate	IP67
	Current draw 12v	Dayrunning: 0,03A / marker light: 0,03A / indicator: 0,32A
	Current draw 24v	Dayrunning: 0,03A / marker light: 0,02A / indicator: 0,15A
	Warranty	5 year

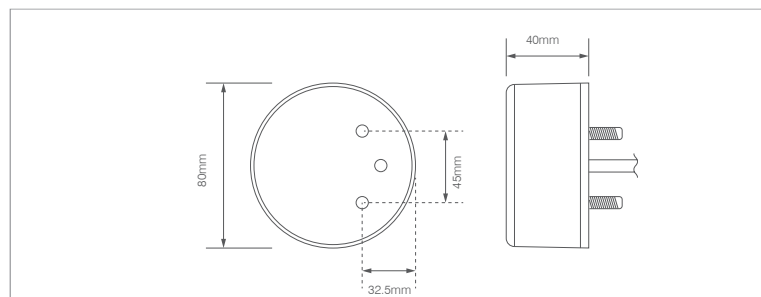

LED front indicator/front marker

- Universeel LED Daytime Running light and indicator
- 12 or 24v version

Cable version 12 volt (40cm):	Cable version 24 volt (40cm):
80AW12	80AW24



Daytime running lamp wiring component

- Wiring component for the 80AW12 & 80AW24
- This unit resets the daytime running lights by 50% in brightness when the indicator is switched on

Cable version:
DRL-HOTDOG



TRALERT®

BETTER LIGHT - WORK SAFER

LED Front marker light with indicator 12/24v

135-Series



Specifications

Description	135-series Front marker light with indicator, has an E-mark and is available in surface or recess mount
EMC suppressed	Yes
Light colours	White / amber
Size 135AWME	135 x 38 x 24mm
Size 135AWMGE	145 x 48mm
Cut out size 135AWMGE	133 x 36mm
IP rate	IP67
Current draw 12v	Front marker.: 0,02A / indicator: 0,27A
Current draw 24v	Front marker.: 0,01A / indicator: 0,15A
Warranty	5 year

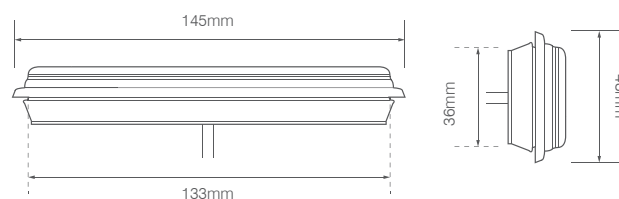
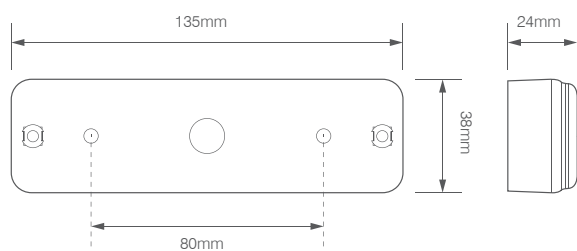

LED Front marker light with indicator

- Universal Front marker light with indicator
- 12/24V (multivoltage)
- Surface mount

Cable version (40cm):	DC 0,75mm ² connection:	DC 1,5mm ² connection:
135AWME	N/A	N/A



LED Front marker light with indicator

- Universal Front marker light with indicator
- 12/24V (multivoltage)
- Recess mount

Cable version (40cm):	DC 0,75mm ² connection:	DC 1,5mm ² connection:
135AWMGE	N/A	N/A

Reflectors



Triangular Reflex Reflector

- Triangular Reflex Reflector
- Screw fixing
- European homologation

Article number: **VRF-400R**

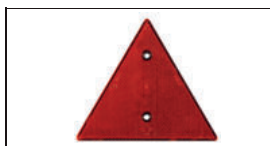

Triangular Reflex Reflector

- Triangular Reflex Reflector
- Screw or rivet fixing
- European homologation

Article number: **VRF-410R**

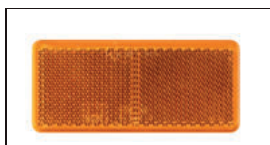
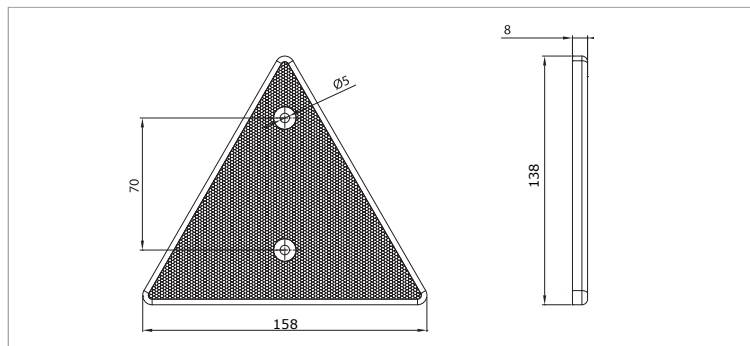

Reflector 90 x 40

- Amber rectangle reflector
- Strong 3M tape adhesive backing
- European homologation

Article number: **VRF-500A**

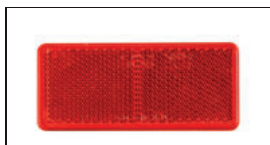
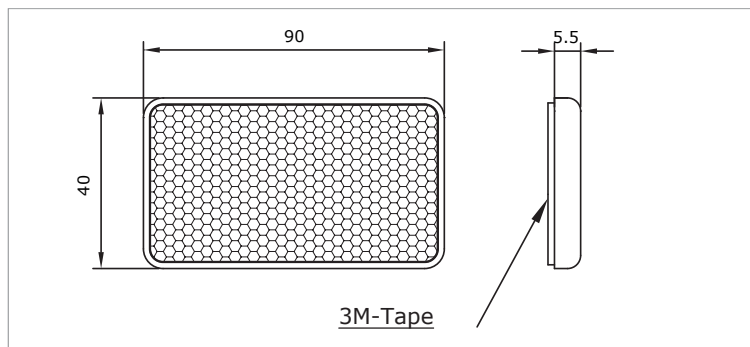

Reflector 90 x 40

- Red rectangle reflector
- Strong 3M tape adhesive backing
- European homologation

Article number: **VRF-500R**

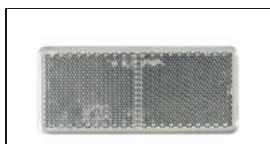

Reflector 90 x 40

- White rectangle reflector
- Strong 3M tape adhesive backing
- European homologation

Article number: **VRF-500W**

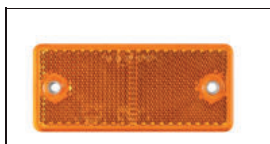

Reflector 90 x 40

- Amber rectangle reflector
- Screw or rivet fixing
- European homologation

Article number: **VRF-501A**

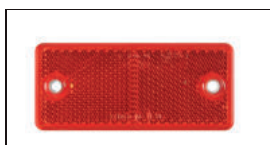
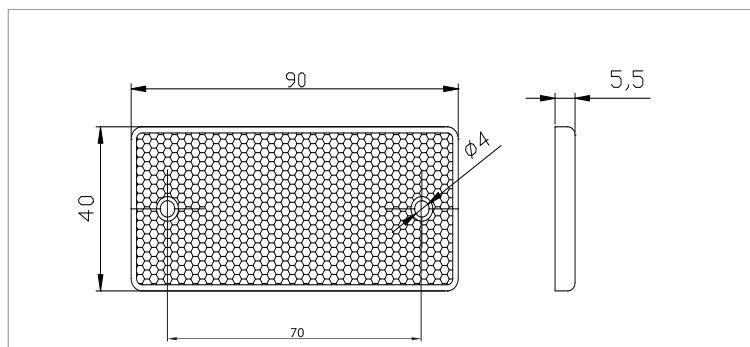

Reflector 90 x 40

- Red rectangle reflector
- Screw or rivet fixing
- European homologation

Article number: **VRF-501R**

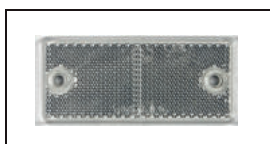

Reflector 90 x 40

- White rectangle reflector
- Screw or rivet fixing
- European homologation

Article number: **VRF-501W**



TRALERT®

BETTER LIGHT - WORK SAFER

Reflectoren

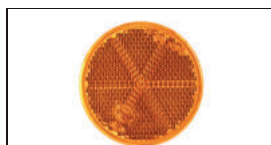

Reflector ø60



- Amber round reflector
- Strong 3M tape adhesive backing
- European homologation

Article number: **VRF-100A**

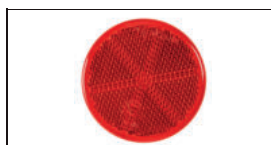

Reflector ø60



- Red round reflector
- Strong 3M tape adhesive backing
- European homologation

Article number: **VRF-100R**

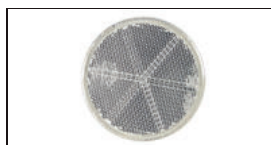

Reflector ø60



- White round reflector
- Strong 3M tape adhesive backing
- European homologation

Article number: **VRF-100W**

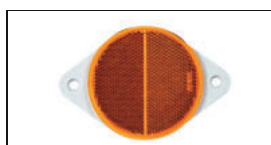

Reflector ø78



- Amber round reflector
- Screw or rivet fixing
- European homologation

Article number: **VRF-200A**

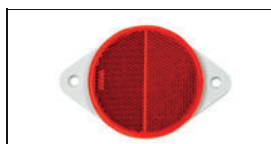

Reflector ø78



- Red round reflector
- Screw or rivet fixing
- European homologation

Article number: **VRF-200R**



Reflector ø78



- White round reflector
- Screw or rivet fixing
- European homologation

Article number: **VRF-200W**

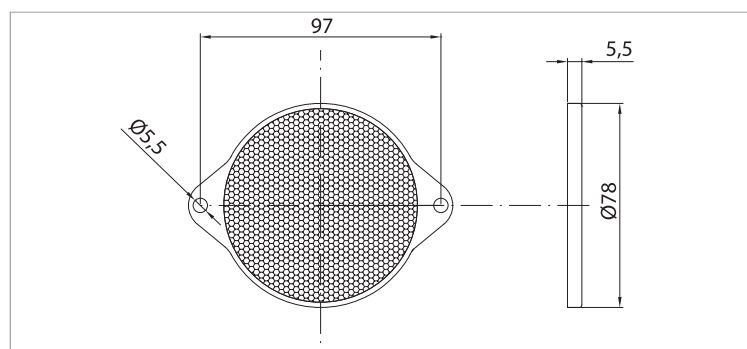
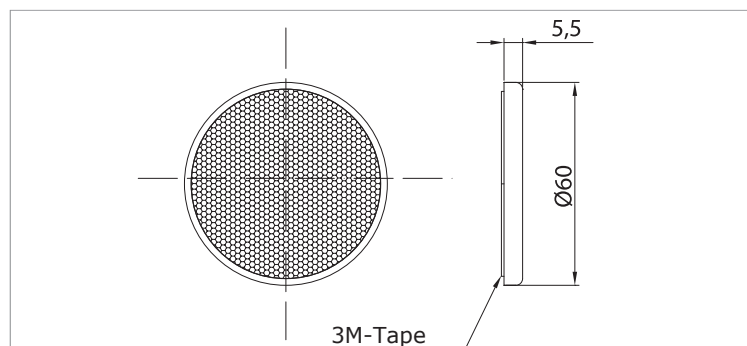



LED WORK LIGHTS



LED FLASHERS



LED REAR LIGHTS



LED MARKER LIGHTS



LED INTERIOR LIGHTS



LED WARNING LIGHTS



HARNESS SYSTEMS

Your supplier: