

Installation and Use Manual for Shower Set

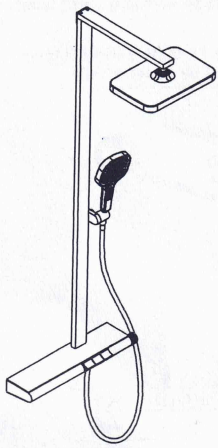

Installation considerations

1. Please check the list of standard accessories provided in the product packaging after opening it, and make sure that all the necessary parts are included. If any parts are missing, please contact the seller immediately.
2. The installation dimensions of the embedded pipes must match the basic installation dimensions of this product.
3. The main part of the faucet has been tested and debugged by the factory, do not disassemble it yourself, so as not to affect the performance.
4. The faucet connected with cold and hot water pipes must pay special attention to: hot water on the left and cold water on the right.
5. Before installing the faucet, please be sure to remove the impurities and sludge in the embedded pipe first, so as not to clog and affect the water function!
6. After installation, please open the water source, and then check whether the connection is tightly connected to ensure that there is no leakage.
7. Shower hose can not be over-bent, ensure that the hose is not deformed after installation.
8. The dimensions indicated in this manual are mm, all pictures are for reference only, please refer to the actual object.

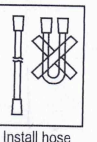
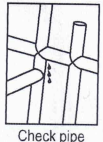

Executive standard: non-constant temperature shower: GB 18145, GB 28378
Thermostatic shower: QB/T 5418

Technical parameters:

Nominal diameter: DN15 Medium temperature: 4-85°C

Nominal pressure: 1.0MPa

Working pressure: 0.1-0.4MPa

Use medium: Drinking water, tap water

Flow rate (Q) : dynamic pressure 0.1±0.01MPa

Q≥6.0 (L/min) (without shower)

4.0≤Q≤9.0 (L/min) (with shower)

Shower water efficiency grade index (L/min)

Type	Flow		
	Level 1	Level 2	Level 3
Handheld shower	≤4.5	≤6.0	≤7.5
Fixed shower			≤9.0

Tools required:

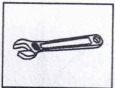

Adjustable wrench



Hex wrench

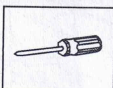

Screwdriver

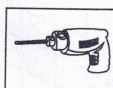

Hammer drill



Sealing belt

Note: When the water pressure is lower than 0.1MPa, please install a booster pump, and when the water pressure is higher than 0.5MPa, please install a pressure reducing valve. When the hot and cold water pressure exceeds 0.2MPa, please install a booster pump or pressure reducing valve to ensure hot and cold water. The pressure is balanced and within the range of 0.2MPa.

Warm reminder

1. It is recommended that faucets be installed two months after the house is renovated.
2. It is advised not to install faucets in environments with strong corrosive substances. If installation is necessary, the surface of the faucet should be cleaned regularly to prevent corrosion, otherwise, the service life of the faucet will be shortened.
3. Due to the precision components contained within the product, please install a front filter at the water intake end before the water supply. Otherwise, any damage caused to the product by the water pipes or water quality is not the responsibility of the company.

Product maintenance precautions:

- In order to protect the surface of the product, please clean the product regularly or regularly;
- Wash with clean water often, wipe dry with soft cotton cloth;
- Do not use detergents containing coarse particles such as detergent or polishing powder or nylon brush to avoid wearing the product.
- Because the acid detergent can erode the coating, it should not be used. If you have washed the tiles with acidic detergent, you should immediately wash the tiles and utensils fully to avoid the detergent flowing to the surface of the product and eroding the coating of the product.
- If extensive cleaning is required, follow the following procedures:
 1. Use clean water and soft cloth to remove surface dirt and scale film as far as possible
 2. Use any of the following cleaning agents to remove surface dirt and scale film:
 - Mild liquid cleaners, colorless glass cleaners, non-abrasive and fully bath soluble powder cleaners (and mix as directed), non-abrasive polish.
- After cleaning, please remove all cleaning agent with clean water and wipe dry with soft cotton cloth.

Parts List

No.	Name	Qty
1	Shower hose	1
2	Rain shower	1
3	Hand shower	1
4	Check valve	1
5	Shower holder assembly	1
6	Spirit level	1
7	Curved feet	1
8	Body assembly	1
9	Shower hose	1
10	Assembly bag	1
11	Specification	2

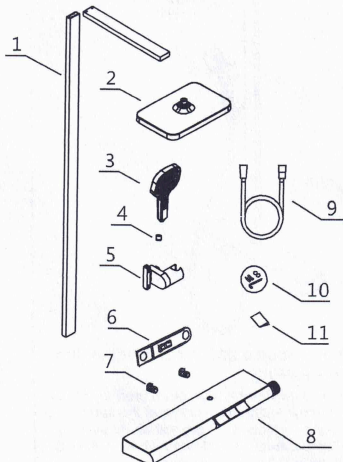

Check valve installation precautions

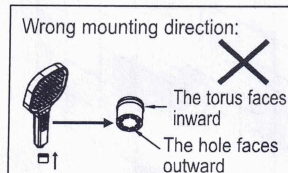
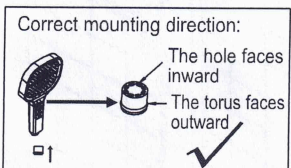

Warm reminder:
If the check valve is inverted, the shower will not discharge water. Please adjust the installation direction of the check valve.

Installation steps

1) Flushing pipe line

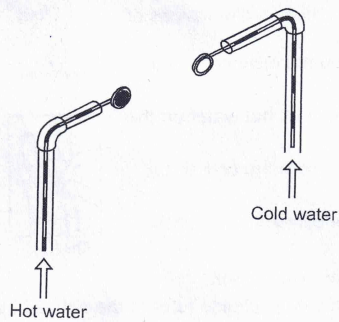

1. The embedded pipe must be flushed before installing the faucet.

2) Install curved feet

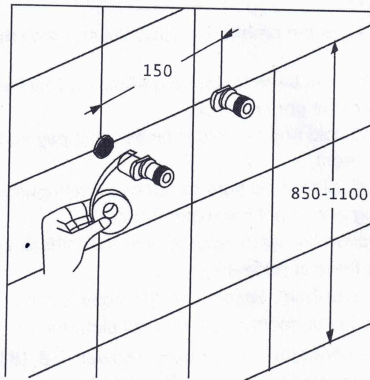

2. Before installation, please confirm that the center distance on the wall is 150 ± 10 mm. Water intake holes in the range of 850-1100 above the ground; Wrap the raw material belt Curved foot, installed in the inlet pipe.

3) Adjust the use of curved feet and spirit level

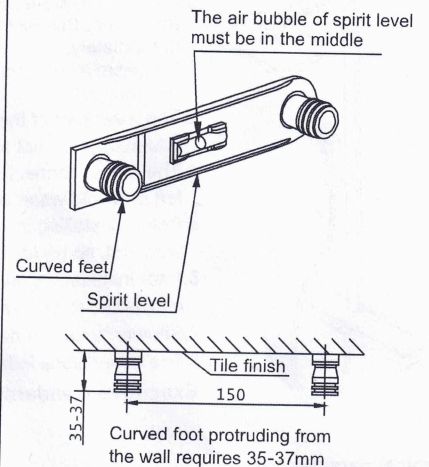

3. After the curved foot is installed in the water inlet pipe, adjust it and set the level to two Bend the foot, the bubble in the middle of the level to the middle position is level. Mounting body

4) Mounting body

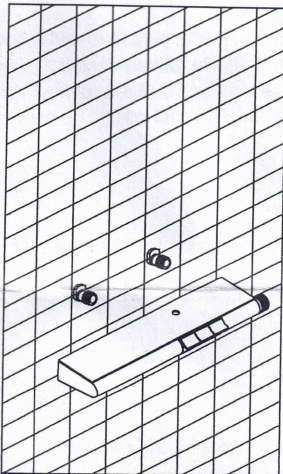

4. Stick the faucet body to the wall, and then put the screw into the hole of the main body In the position, use a wrench to tighten the screw on the bending foot, please pay attention to installation When bending foot locking screw must not exceed the water inlet hole inside the hole, to prevent safety The rubber ring of the curved foot was scratched during installation.

5) Mounting fixed holder

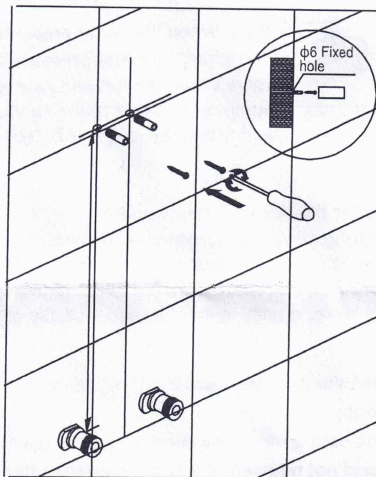

5. According to the size of the shower tube, attach the fixed seat of the shower tube to the wall. According to the size of the shower tube, attach the fixed seat of the shower tube to the wall, and fasten with screws., and fasten with screws.

6) Install shower hose

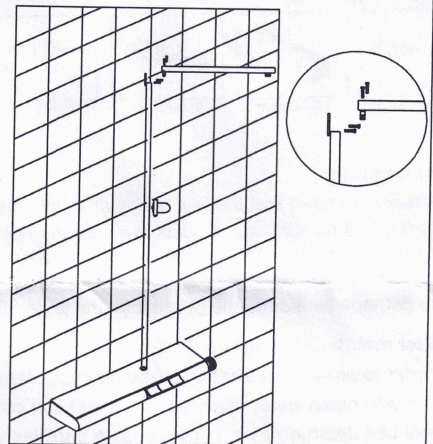

6. Insert the shower tube into the main body and cover the groove on the shower tube to the shower tube fixing block on; After adjusting the fixed position of the shower tube, then lock the screws on both sides with a wrench.

7) Install other accessories

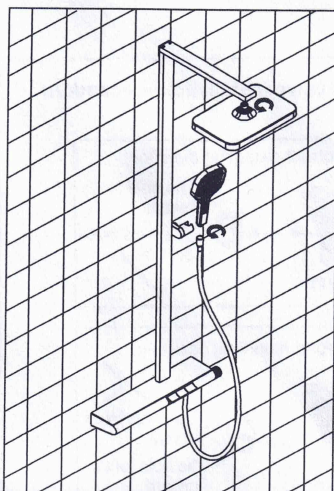

7. Connect the top spray shower, hand shower, spray gun and hose to the main body. Tear the double-sided adhesive sticker at the bottom of the glass panel, align the glass panel, and lock it with nuts.

8) Check the pipe line

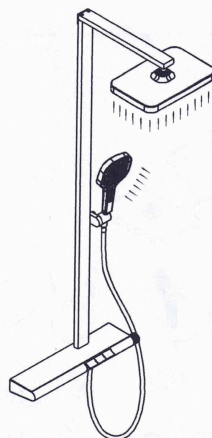

8. Turn on the water source and check whether the connections are leaking

Note: If the product is a constant temperature product, make sure that the hot and cold water are running at the same time when the water is tested, otherwise there will be no water or dripping when the temperature control hand wheel is turned on at 40°C when there is only cold or hot water.