

ADUROS MART ERIA

USER MANUAL DIMMER

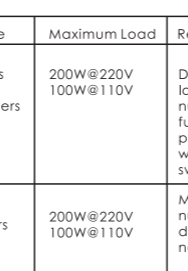

Compatible Load Types

Load Symbol	Load Type	Maximum Load	Remarks
	LED lamps with transformers	200W@220V 100W@110V	Due to variety of LED lamp designs, maximum number of LED lamps is further dependent on power factor result when connected to switch.
	LED drivers	200W@220V 100W@110V	Maximum permitted number of drivers is 200W divided by driver nameplate power rating.
	Incandescent lighting, HV Halogen lamps	300W@220V 200W@110V	
	Low voltage halogen lighting with electronic transformers	200W@220V 100W@110V	

1. Switch off the main power.

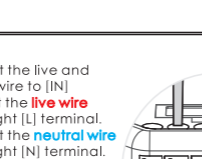

2. Ceiling installation
Remove the existing lighting:
Detach the existing lighting
and disconnect the wires.
Do not exceed the maximum
load of 300W.



2A. Connect the live and neutral wire to [IN] connect the **live wire** to the right [L] terminal. Connect the **neutral wire** to the right [N] terminal. Tighten the clamping screws.

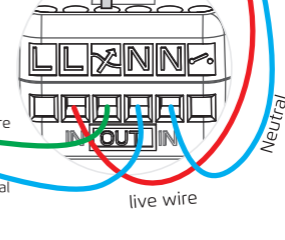

2B. Connect the 2 wires to "out" 2 wires to the inner [L] and [N] contact. Tighten the clamping screws.

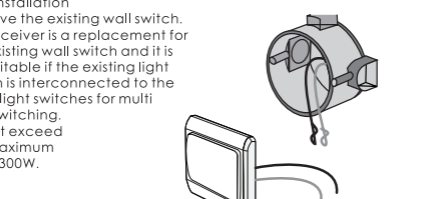

3. Wall installation
Remove the existing wall switch.
This receiver is a replacement for
the existing wall switch and it is
not suitable if the existing light
switch is interconnected to the
other light switches for multi
way switching.
Do not exceed
the maximum
load: 300W.

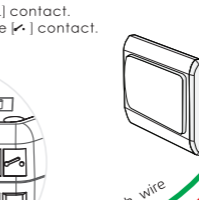

3A. Connect the live wire and switch wire:
Connect the **live wire** to the [L] contact.
Connect the **switch wire** to the [L-] contact.
Tighten the clamping screws.

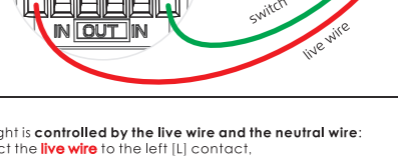

3B. If the light is **controlled by the live wire and the neutral wire**:
Connect the **live wire** to the left [L] contact,
Connect the **neutral wire** to the left [N] or right [N]
connect the **switch wire** to the [L-].



3C. **Risk of shock!** be careful do not touch any exposed wiring.
Switch on the main power to continue.

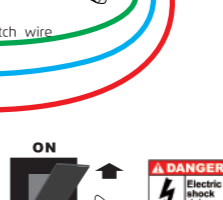

Connect with the ERIA hub

4A. Download the Adurosmart App from the Apple App Store or from Google Play or go to <http://adurosmart.com/adurosmart-app/>



4B. If you have a **third party ZigBee compatible hub** then **proceed to step 11**.

5. Open the Adurosmart Eria APP.

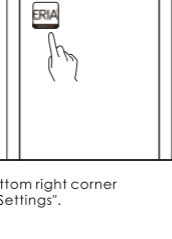

6. On the bottom right corner press on "Settings".

7. Select "Devices"

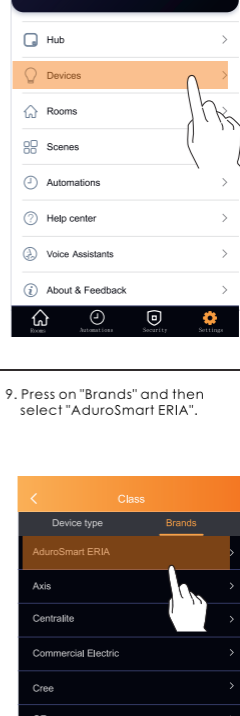
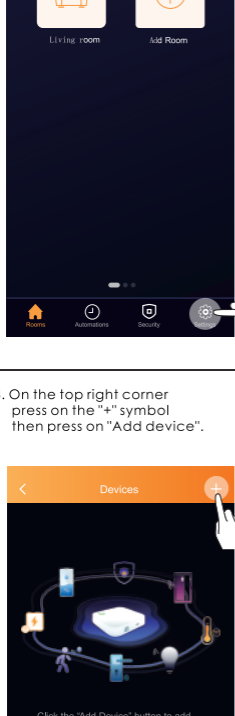

8. On the top right corner press on the "+" symbol then press on "Add device".

9. Press on "Brands" and then select "AduroSmart ERIA".

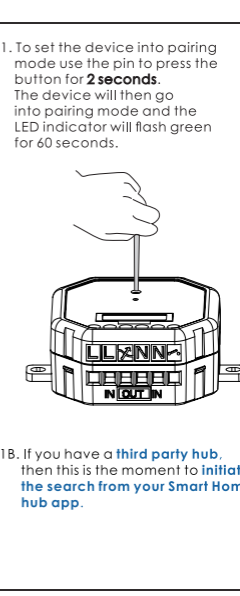
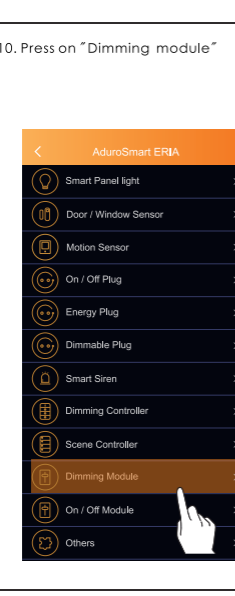

10. Press on "Dimming module"

11. To set the device into pairing mode use the pin to press the button for **2 seconds**. The device will then go into pairing mode and the LED indicator will flash green for 60 seconds.

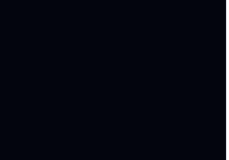

11B. If you have a **third party hub**, then this is the moment to **initiate the search from your Smart Home hub app**.

12. Proceed by pressing on "Search" to allow the ERIA hub to find the module, the LED indicator on the hub will **flash green** this indicates that the hub is searching for new devices.

13. Once the dimmer module has been found it will show in your search results press on "Done" to complete the process.

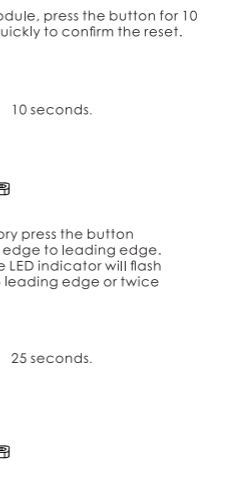
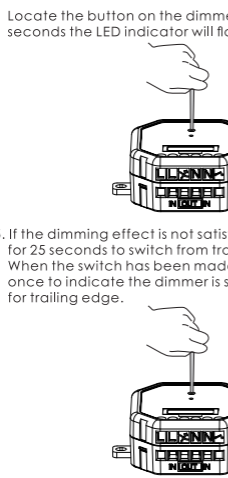

14. Troubleshoot

If you are still not able to connect your device then follow below instructions to reset the dimming relay.

Locate the button on the dimmer module, press the button for 10 seconds the LED indicator will flash quickly to confirm the reset.



10 seconds.

15. If the dimming effect is not satisfactory press the button for 25 seconds to switch from trailing edge to leading edge. When the switch has been made, the LED indicator will flash once to indicate the dimmer is set to leading edge or twice for trailing edge.



25 seconds.

NEED HELP? CALL US

For troubleshoots, instruction video's or more information please visit us at www.adurosmart.com/faq

Chat with one of our support agents at www.adurosmart.com

The Netherlands: +31 523687532
Support@Adurosmart.eu



www.adurosmart.com/manuals/dimmingmodule