

# ADUOSMART ERIA

## USER MANUAL SMART LED STRIP (U)

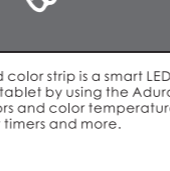

The Adurosmart extended color strip is a smart LED strip that you can control with your smart-phone or tablet by using the Adurosmart app and Adurosmart hub you can change colors and color temperatures, control individual lights or a room full of lights, set timers and more.

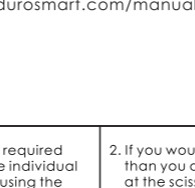

[www.adurosmart.com/manuals/strip/u](http://www.adurosmart.com/manuals/strip/u)

1. Extend the strip to the required size by connecting the individual strips with each other using the connectors.

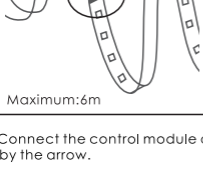

Maximum: 6m

2. If you would like to shorten the strip than you are able to cut the strip at the scissor symbol.

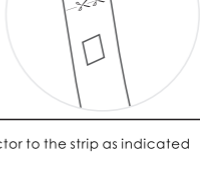

3. Connect the control module and connector to the strip as indicated by the arrow.

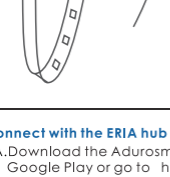

### Connect with the ERIA hub

4A. Download the Adurosmart App from the Apple App Store or from Google Play or go to <http://adurosmart.com/adurosmart-app/>

Android



IOS

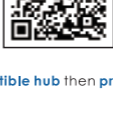

4B. If you have a **third party ZigBee compatible hub** then **proceed to step 11**.

5. Open the Adurosmart Eria APP.

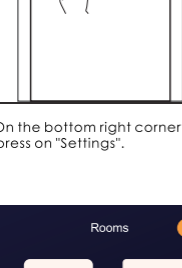

6. On the bottom right corner press on "Settings".

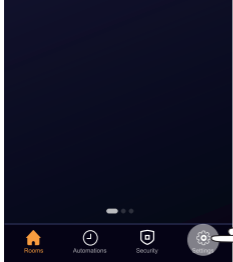

7. Select "Devices".

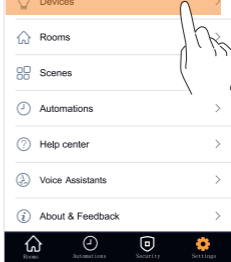

8. On the top right corner press on the "+" symbol then press on "Add device".

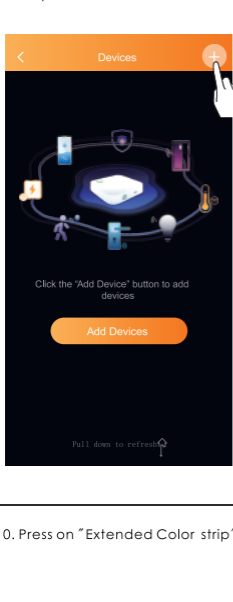

9. Press on "Brands" and then select "AduroSmart ERIA".

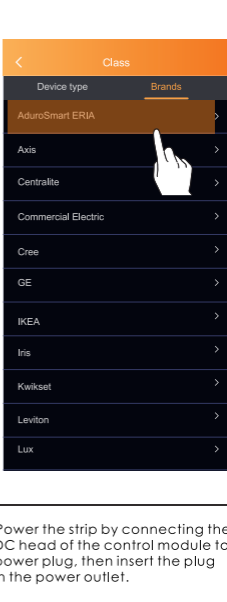

10. Press on "Extended Color strip"

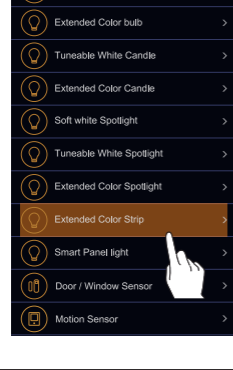

11. Power the strip by connecting the DC head of the control module to power plug, then insert the plug in the power outlet.

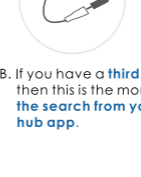

After powering the strip will enter pairing mode for **60 seconds**.

11B. If you have a **third party hub**, then this is the moment to **initiate the search from your Smart Home hub app**.

12. Proceed by pressing on "Search" to allow the ERIA hub to find the strip, the LED indicator on the hub will **flash green** this indicates that the hub is searching for devices.

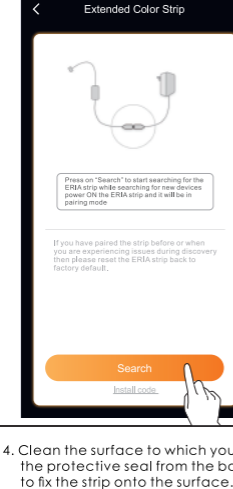

13. When the strip has been found and paired successfully it will **turn green** and it will show up in your search results, press on "Done" to complete the process.



14. Clean the surface to which you want to attach the strip on and remove the protective seal from the back of the strip then use the adhesive back to fix the strip onto the surface.



### 15. Troubleshoot

If the Adurosmart strip is not recognized by your smart home hub then follow the below procedure to reset the strip back to factory default.

Disable and enable the power to the strip 5 times so that it turns ON/OFF 5 times. The strip will then flash 3 times to confirm the reset. Power the strip ON and proceed with step 11.

## NEED HELP? CALL US

For troubleshoots, instruction video's or more information please visit us at [www.adurosmart.com/faq](http://www.adurosmart.com/faq)

Chat with one of our support agents at [www.adurosmart.com](http://www.adurosmart.com)

The Netherlands: +31 523687532  
Support@Adurosmart.eu