



### CONDITIONS DE TRAVAIL

Pression de service ≤ 400 bar  
 Température -30°C à 120°C  
 Vitesse ≤ 0,5 m/s  
 Fluides huiles minérales

### MATIERES

Anneau de pied résine acétale  
 Chevron intermédiaire NBR toilé  
 Anneau de tête NBR toilé  
 Bague anti-extrusion résine acétale

### MONTAGE

Sur piston en plusieurs pièces

### AVANTAGES

Bonne résistance aux hautes températures  
 pour conditions de travail difficiles : coups de bélier, flexions importantes, mauvais états de surface, ...

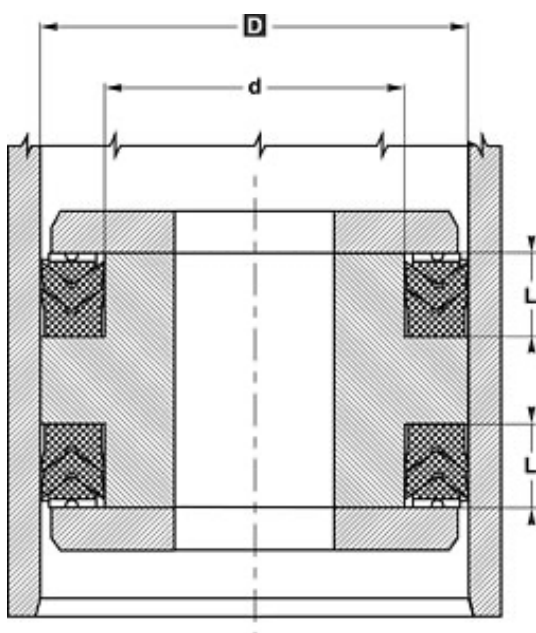

### 10CH3

ARTICLE	D	d	L
10CH3-030	30.00	20.00	9.30
10CH3-032	32.00	20.00	10.90
10CH3-040	40.00	25.00	11.50
10CH3-045	45.00	30.00	11.50
10CH3-050	50.00	35.00	11.50
10CH3-055	55.00	40.00	11.50
10CH3-060	60.00	45.00	11.50
10CH3-063	63.00	48.00	13.00
10CH3-065	65.00	50.00	13.00
10CH3-070	70.00	50.00	15.20
10CH3-080	80.00	60.00	15.20

### 10CH3

ARTICLE	D	d	L
10CH3-115	115.00	95.00	21.20
10CH3-125	125.00	100.00	25.80
10CH3-140	140.00	115.00	25.80
10CH3-150	150.00	120.00	29.00
10CH3-160	160.00	130.00	29.00
10CH3-180	180.00	150.00	31.50
10CH3-200	200.00	170.00	33.50
10CH3-220	220.00	190.00	33.50
10CH3-225	225.00	195.00	33.50
10CH3-240	240.00	210.00	33.50
10CH3-250	250.00	220.00	33.50

<b>10CH3-090</b>	90.00	70.00	21.20
<b>10CH3-100</b>	100.00	80.00	21.20
<b>10CH3-110</b>	110.00	90.00	21.20

<b>10CH3-275</b>	275.00	245.00	33.50
<b>10CH3-300</b>	300.00	270.00	33.50

<b>10CH3/NEO</b>				
<b>ARTICLE</b>	<b>D</b>	<b>d</b>	<b>L</b>	<b>h</b>
<b>10CH</b> 375325/NEO (1+3+1)	95.25	82.55	21.72	3.71
<b>10CH</b> 425350/NEO (1+3+1)	107.95	88.90	31.00	4.90
<b>10CH</b> 450350/NEO (1+3+1)	114.30	88.90	35.32	6.55
<b>10CH</b> 450375/NEO (1+3+1)	114.30	95.25	25.40	5.00
<b>10CH</b> 450387/NEO (1+3+1)	114.30	98.42	26.59	4.34
<b>10CH</b> 500400/NEO (1+3+1)	127.00	101.60	32.15	5.82

<b>10CH3/NEO</b>				
<b>ARTICLE</b>	<b>D</b>	<b>d</b>	<b>L</b>	<b>h</b>
<b>10CH</b> 500425/NEO (1+3+1)	127.00	107.95	30.00	4.52
<b>10CH</b> 590472/NEO (1+3+1)	150.00	120.00	44.00	7.50
<b>10CH</b> 600500/NEO (1+3+1)	152.40	127.00	38.63	6.48
<b>10CH</b> 826708/NEO/B (131)	210.00	180.00	32.97	5.99
<b>10CH</b> 875750/NEO (1+3+1)	222.25	190.50	50.00	7.57
<b>10CH</b> 1102984/B/NEO (131)	280.00	250.00	32.97	5.99