

WELCOME TO GNU COUNTRY • WELCOME TO GNU COUNTRY • WELCOME TO GNU COUNTRY

I PRAY TO THE SUN IT HELPS ME HAVE FUN
HEADSPACE BY FOREST BAILEY

GNU

24/25



IT'S BEAUTIFUL DAY IN GNU COUNTRY

UL DAY IN GNU COUNTRY



It may be dark and stormy...but it's always a beautiful day in **Gnu Country**. It snowed overnight but the sun is breaking through the clouds. School and work were cancelled and **your whole crew is going up**. There's a new jump in the park and it's **two for one hot dog day in the lodge**. But, best of all you've got your **Gnu snowboard made with zero hazardous waste in the USA**. The art on the top speaks to you and the technology under anticipates **the mountain**. You've got **this day to live it up and you've got the best board to go live**. Stop in at the **gift shop** and pick yourself up a hand painted **"IT'S A BEAUTIFUL DAY IN GNU COUNTRY"** cheugy coffee mug, or a 69-dollar hoodie. **See you on the slops!**

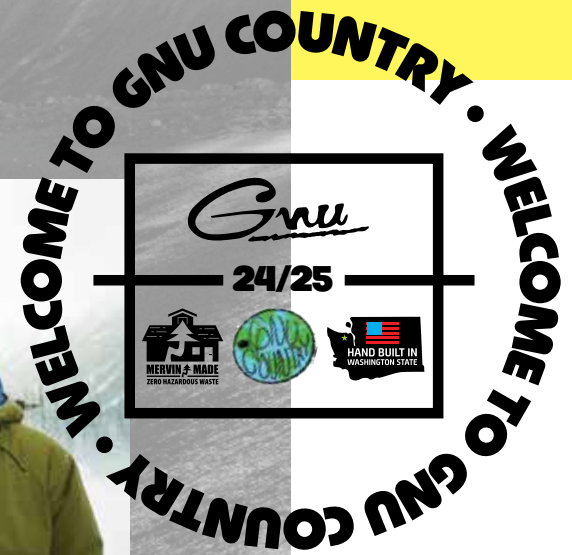



DO YOU LIKE-A THE JUICE?





Green



MERVIN MADE
ZERO HAZARDOUS WASTE

WE BUILD OUR OWN DAMN BOARDS.

MIKE OLSON

WELCOME TO GNU COUNTRY. WELCOME TO GNU COUNTRY.

GNU

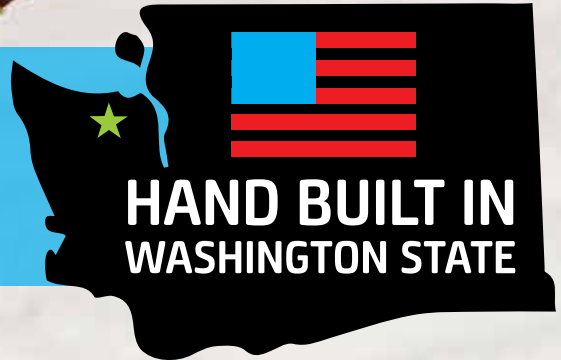
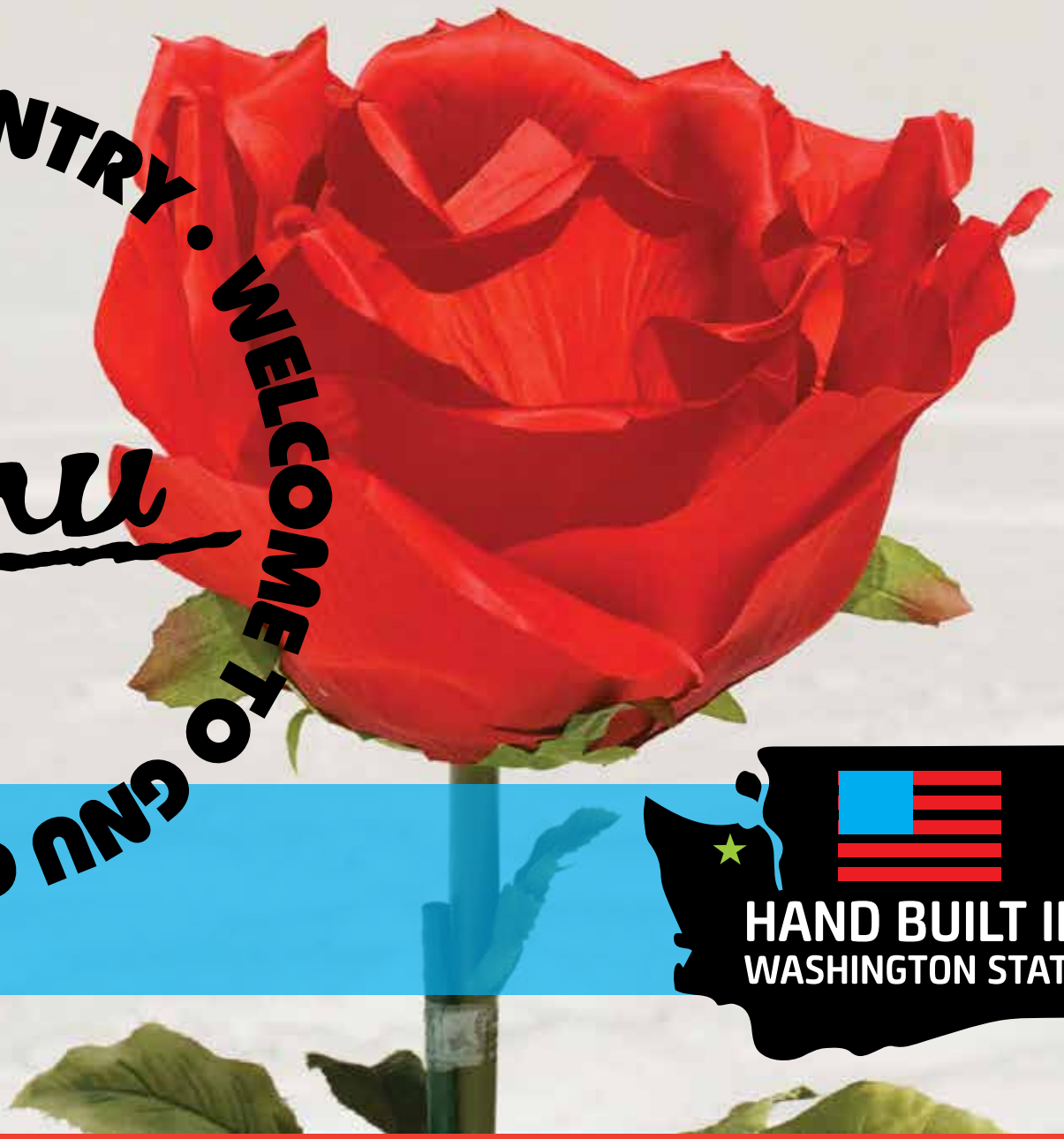



FOREST BAILEY • JAMIE ANDERSON

CANNON CUMMINS • MAX WARBINGTON

BARRETT CHRISTY • NAIMA ANTOLIN • TEMPLE CUMMINS

MASATO TODA • GUS WARBINGTON • PETER CERULO • ELLIE WEILER • MICHAEL MCDANIEL

BRENDAN SULLIVAN • MARKUS RUSTAD • ARI MORRONE • JULIAN GLUCK

ISABELLA GOMEZ • DEREK CONTI • CALVIN GREEN

FSC CERTIFIED ECO WOODS



HAND BUILT IN WASHINGTON STATE

WE BUILD OUR OWN DAMN BOARDS 

ECO MATERIALS

- FSC CERTIFIED ECO WOODS
- LOW VOC RESIN SYSTEMS
- BIO TOP SHEETS

ECO PROCESS

- WATER BASED SUBLIMATION
- WATER BASED SOLVENTS
- WATER CLEANSSED FINISHING SYSTEMS
- NO TOXIC LACQUER COATINGS

ECO POWER

- WIND POWER
- WATER POWER

ECO RECYCLING

- WOOD SAWDUST TO SOIL
- RECYCLED WOOD
- RECYCLED PLASTICS



ECO COUNTRY

MERVIN MADE VIDEO HERE!



FACTORY USA VIBES SINCE 1977!





CONTOURS BANANA IS TECHNOLOGY

BNA

THE ORIGINAL ROCKER/CAMBER HYBRID CONTOURS. UNREAL CONTROL.

PATENT #7823892 #8511704

NEW! SOMETHING GNU

HYBRID C2 DIRECTIONAL Perfect All Terrain Contour
PERFECTION CONTROL / PRECISION / FLOAT

foot foot

CAMBER ROCKER CAMBER

The perfect rocker / camber hybrid, rips everything

HYBRID ORIGINAL BANANA THE BEST CONTOUR TO LEARN ON
PROGRESSION EASY / JIBBY / FLOATY

foot foot

MILD CAMBER ROCKER MILD CAMBER

Day 1 to Pro

HYBRID C2 Perfect All Terrain Contour
PERFECTION CONTROL / PRECISION / FLOAT

VARIATIONS:

foot foot

CAMBER ROCKER CAMBER

The perfect rocker / camber hybrid, rips everything

C3 CAMBER Aggressive All Terrain Contour
AGGRESSION CONTROL / PRECISION / POWER

foot foot

CAMBER MILD ROCKER CAMBER

Camber engineered for snowboarding

HYBRID C2'
 Easy Riding
 All Terrain Contour

HYBRID C2'
 Xtreme Riding
 All Terrain Contour

ENGINEERED FOR SNOWBOARDING:

- Full contact and control in all conditions
 "Awesome Everywhere"

ROCKER BETWEEN YOUR FEET / CAMBER OUTSIDE OF YOUR FEET.

- Central rocker builds in carve, edge hold and float
- Outboard camber builds in pop, stability and control

Performance hybrid bottom contours engineered for snowboarding. Snowboarding is done with two feet on one board in a sideways stance. Banana Technology combines mild rockers between your feet with varying amounts of camber to the contact points to maximize edge contact, control and hold in a sideways stance. The rocker brings to life the middle of your board that, with traditional ski camber is a low pressure "dead zone", while also adding float, improving carving and power. The cambers out to the tip and tail fine tune the pressure map, add pop, tip and tail stability, precision and control.

AWESOME TURNING
ASYM AWESOME
 BALANCE THROUGH ASYMMETRY

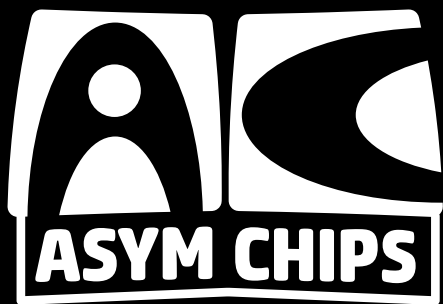

3-D Delightwood Asym Chip
 Riders Choice & RC C3



Gnu



- Precision control
- Steeper activation angle

- Power
- Lower activation angle

ASYM Level 1 Asym Sidecut

ASYM Sidecut: Deeper sidecut on heelside (power side).

ASYM Level 1

MENS Recess

ASYM Level 2 Asym Sidecut & Contact

ASYM Sidecut: Deeper sidecut on heelside (power side).

ASYM Contact: Asymmetric contact angles longer toe side contact (finesse side) and shorter heelside contact (power side).

ASYM Level 2

MENS Riders Choice / RC C3 / Finest
WOMENS Pro Choice / Ladies Choice

GLITE



FSC CERTIFIED ECO WOODS CONSTRUCTION

3 Performance levels of environmentally friendly, aerospace composite construction, hand laminated into Gnu's core constructions.

WE BUILD OUR OWN DAMN BOARDS.

GLITE 1 CONSTRUCTION

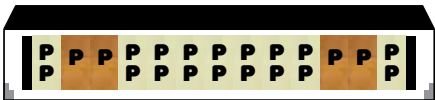

LIGHT & EASY

WOOD TYPES
 PP = Poplar: Easy riding
 P = Paulownia: Lighter

GLITE 1

CORE: FSC Certified Poplar + Paulownia Core Light, Strong And Poppy
GLASS: Tri-Ax/Bi-Ax Glass | TOP: Eco Sublimated Poly Top | BASE: Eco Sublimated Co-Ex Base
SIDEWALL & TIPS/TAILS: UHMW

MENS: Recess / Young Money / Money / C MONEY/ GWO / Antigravity
WOMENS: Gloss / Gloss C / B-Nice

GLITE 2 CONSTRUCTION



LIGHT & SPEEDY

WOOD TYPES
 A = Aspen: Light lively
 P = Paulownia: Lighter

GLITE 2

FSC Certified Aspen + Paulownia Core Light, Strong And Poppy
GLASS: Tri-Ax/Bi-Ax Glass | TOP: Eco Sublimated Poly Top | BASE: Sintered Base
SIDEWALL & TIPS/TAILS: UHMW

MENS: Finest / Head Space / 4x4 / Gremlin
WOMENS: Velvet / Frosting

GLITE 3 CONSTRUCTION



**LIGHTEST, SPEEDY,
& MOST POPPY**

WOOD TYPES
 A = Aspen: Light lively
 P = Paulownia: Lighter

GLITE 3 CARBON

FSC Certified Aspen + Paulownia Core Lightest, Stronger And Most Poppy
GLASS: Tri-Ax/Bi-Ax Glass + Carbon Power Bands | TOP: Eco Sublimated Poly Top or Bio Beans (Jamie Anderson pro models)
BASE: Sintered Base | SIDEWALL & TIPS/TAILS: UHMW

III CARBON POWER BANDS Add pop, response and extend board performance life

MENS: Riders Choice / RC C3 / Hyper / Banked Country / Something GNU
WOMENS: Ladies Choice / Pro Choice / Barrett / Free Spirit



NAIMA COUNTRY



MAGNE-TRACTION®
EDGE HOLD ADVANTAGE



MAGNE-TRACTION®

DEEPEST SERRATIONS
BETWEEN THE FEET

MILD SERRATION

ENTRY SERRATION

**7 SERRATED
STEAK KNIFE
TECHNOLOGY**

7 strategically located and sized
edge serrations provide unreal edge
hold and control in all conditions.

PRO MAG

A CUMMINS ORIGINAL "TEETH IN THE TAIL"

TEMPLE CUMMINS

EXCLUSIVE FEATURED ON

Banked Country•
Banked Country Split Board•
By Temple & Cannon Cummins

Barrett•
Barrett Split Board•
By Barrett Christy

DIRECTIONAL SERRATED EDGE TECH

TEETH IN THE TAIL!

Combination of radial entry side-cut and strategically located edge serrations provide smooth entry and powerful "fin like" edge hold in the tail.



WELCOME TO GNU COUNTRY • WELCOME TO GNU COUNTRY • WELCOME TO GNU COUNTRY •

GNU

MENS

PARK, FREESTYLE ALL MOUNTAIN, ALL MOUNTAIN



BRENDAN SULLIVAN

MONEY COUNTRY



WELCOME TO GNU COUNTRY • WELCOME TO GNU COUNTRY • WELCOME TO GNU COUNTRY •

Gnu

MONEY / YOUNG MONEY



FREESTYLE / PARK / TWIN SHAPE

- Freestyle fun and passionate progression
- Plays in the park rips the resort
- Amazing quality, performance and price

A perfect twin park preferring board that shreds the whole mountain. Featuring a snappy C2 rocker camber hybrid contour, sustainable fast growing wood core and eco sublimated graphics. All the shred bling without the crypto sting. The Money and the Young Money are our gifts to snowboarding's past, present and future.

TERRAIN TYPES



RIDER ABILITY



FLEX SCALE



**HYBRID
C2°**

Easy Riding All Terrain Contour



CORE: G LITE 1 FSC Certified Poplar + Paulownia Core: Light, Strong And Poppy

GLASS: Tri-Ax/Bi-Ax Glass: Strong And Poppy

TOP: Eco Sublimated Poly Top: Tough And Environmentally Nice.

BASE: Knife Cut Co-Ex Base: Fast, Tough And Holds Wax

SIDEWALL & TIPS/TAI LS: UHMW: Tough And Fast

MONEY

LENGTH	CONTACT LENGTH	SIDE CUT	NOSE WIDTH	WAIST WIDTH	TAIL WIDTH	STANCE MIN-MAX/SET BACK
144	110cm	7.9	27.9	24.2	27.9	19"-24" / 0"
148	113cm	8	28.6	24.7	28.6	19"-24" / 0"
152	115cm	8.1	29.3	25.3	29.3	20.25"-25"/0"
154	116cm	8.1	29.5	25.4	29.5	20.25"-25"/0"
156	117cm	8.2	29.6	25.5	29.6	20.25"-25"/0"
159	119cm	8.2	29.8	25.6	29.8	20.25"-25"/0"
150 w*	113cm	8	29.9	26	29.9	20.25"-25"/0"
154 w*	116cm	8.1	30.3	26.2	30.3	20.25"-25"/0"
158 w*	119cm	8.2	30.9	26.6	30.9	20.25"-25"/0"

YOUNG MONEY

LENGTH	CONTACT LENGTH	SIDE CUT	NOSE WIDTH	WAIST WIDTH	TAIL WIDTH	STANCE MIN-MAX/SET BACK
130	97cm	7.1	26.1	23	26.1	17.5"-20.75"/0"
135	100cm	7.4	26.8	23.2	26.8	17.5"-20.75"/0"
140	103cm	7.7	27	23.4	27	17.75"-22.5" / 0"



Art: TREVOR YARDLEY-JONES
@trevoryj



WE BUILD OUR OWN DAMN BOARDS

NEW!
C MONEY
NEW!



FREESTYLE / PARK / TWIN SHAPE

- Cambered freestyle and progression
- Pops in the park rips the resort
- Amazing quality, performance and price

A perfect cambered twin park preferring board that shreds the whole mountain. Featuring a poppy C3 cambered contour, sustainable fast growing wood core and eco sublimated graphics. All the shred bling without the crypto sting. The C Money is pop you can buy and guaranteed to take your freestyle game to the next level.

TERRAIN TYPES



RIDER ABILITY



FLEX SCALE



C³ CAMBER

Aggressive All Terrain Contour



CORE: G LITE 1 FSC Certified Poplar + Paulownia Core: Light, Strong And Poppy

GLASS: Tri-Ax/Bi-Ax Glass: Strong And Poppy

TOP: Eco Sublimated Poly Top: Tough And Environmentally Nice.

BASE: Knife Cut Co-Ex Base: Fast, Tough And Holds Wax

SIDEWALL & TIPS/TAILS: UHMW: Tough And Fast

MONEY

LENGTH	CONTACT LENGTH	SIDE CUT	NOSE WIDTH	WAIST WIDTH	TAIL WIDTH	STANCE MIN-MAX/SET BACK
144	110cm	7.9	27.9	24.2	27.9	19"-24" / 0"
148	113cm	8	28.6	24.7	28.6	19"-24" / 0"
152	115cm	8.1	29.3	25.3	29.3	20.25"-25"/0"
154	116cm	8.1	29.5	25.4	29.5	20.25"-25"/0"
156	117cm	8.2	29.6	25.5	29.6	20.25"-25"/0"
159	119cm	8.2	29.8	25.6	29.8	20.25"-25"/0"
150 w*	113cm	8	29.9	26	29.9	20.25"-25"/0"
154 w*	116cm	8.1	30.3	26.2	30.3	20.25"-25"/0"
158 w*	119cm	8.2	30.9	26.6	30.9	20.25"-25"/0"



Art: TREVOR YARDLEY-JONES
 @trevoryj



WE BUILD OUR OWN DAMN BOARDS



I PRAY TO THE SUN, IT HELPS ME HAVE FUN
HEADSPACE BY FOREST BAILEY

37U

HEAD SPACE

By FOREST BAILEY



FREESTYLE / PARK / TWIN SHAPE

- Forest's cambered pill creative freestyle vehicle
- Streetwise, rips the resort, toys with the park
- Technology unites your mind body and board

A classic pill freestyle shape from his beautiful mind. The C3 cambered Head Space is Forest's twin freestyle mind expansion tool. A proven street slayer, rips any freestyle situation you might encounter at your home resort or out there with the crew. Magne-Traction® edge control, FSC certified eco core, sintered eco sublimated base. Find your feet with a board that knows anything and everything is possible.

TERRAIN TYPES



RIDER ABILITY



FLEX SCALE



C³ CAMBER

Aggressive All Terrain Contour



CORE: G LITE 2 FSC Certified Aspen + Paulownia Core: Light, Strong And Poppy

GLASS: Tri-Ax/Bi-Ax Glass: Strong And Poppy

TOP: Eco Sublimated Poly Top: Tough And Environmentally Nice.

BASE: Eco Sublimated Sintered Base: Fast, Tough And Holds Wax

SIDEWALL & TIPS/TAI LS: UHMW: Tough And Fast

LENGTH	CONTACT LENGTH	SIDE CUT	NOSE WIDTH	WAIST WIDTH	TAIL WIDTH	STANCE MIN-MAX/SET BACK
146	110 cm	7.7	28.3	24.7	28.3	19"-24"/ 0"
149	112 cm	7.8	29.1	25	29.1	20.25"-25"/ 0"
152	113 cm	8	29.4	25	29.4	20.25"-25"/ 0"
155	115 cm	8.2	29.7	25.4	29.7	20.25"-25"/ 0"
158	117 cm	8.3	30	25.5	30	20.25"-25"/ 0"
155W*	115 cm	8.2	30.5	26.4	30.5	20.25"-25"/ 0"

*WIDE



Board art: Forest Bailey
@forestbailey



WE BUILD OUR OWN DAMN BOARDS



FREESTYLE / ALL MOUNTAIN / ASYM TWIN SHAPE

- Fun, easy riding freestyler
- Built to rip everything at your local resort
- Progression enhancing, fatigue reducing asymmetry

Strap in and fire up your imagination and let intuitive easy riding asymmetric geometries, ultra grippy serrated edge control technology and lightweight environmentally friendly construction take your mountain exploration to new heights. Designed and hand built by shred parents to make radical progression fast, easy and fun.

TERRAIN TYPES



RIDER ABILITY



FLEX SCALE



THE BEST CONTOUR TO LEARN ON



ASYM LEVEL 1



CORE: G LITE 1 FSC Certified Poplar + Paulownia Core: Light, Strong And Poppy

GLASS: Tri-Ax/Bi-Ax Glass: Strong And Poppy

TOP: Eco Sublimated Poly Top: Tough And Environmentally Nice.

BASE: Eco Sublimated Co-Ex Base: Fast, Tough And Holds Wax

SIDEWALL & TIPS/TAILS: UHMW: Tough And Fast

LENGTH	CONTACT LENGTH	SIDE CUT	NOSE WIDTH	WAIST WIDTH	TAIL WIDTH	STANCE MIN-MAX/SET BACK
100	68 cm	5.7	21.2	19.2	21.2	12.5"-14.5"/ 0"
110	75 cm	6.5	23.3	21	23.3	14.5"-17.5"/ 0"
120	85 cm	6.7	24.5	21.5	24.5	16"-19.25"/ 0"
125	90 cm	6.8	25	22.5	25	17.5"-21"/ 0"

MAGNE-TRACTION®
EDGE HOLD ADVANTAGE

AWESOME TURNING
ASYM AWESOME
BALANCE THROUGH ASYMMETRY



Board art: Jessa Gilbert
@jessagilbert



GWO
(GNU WORLD ORDER)

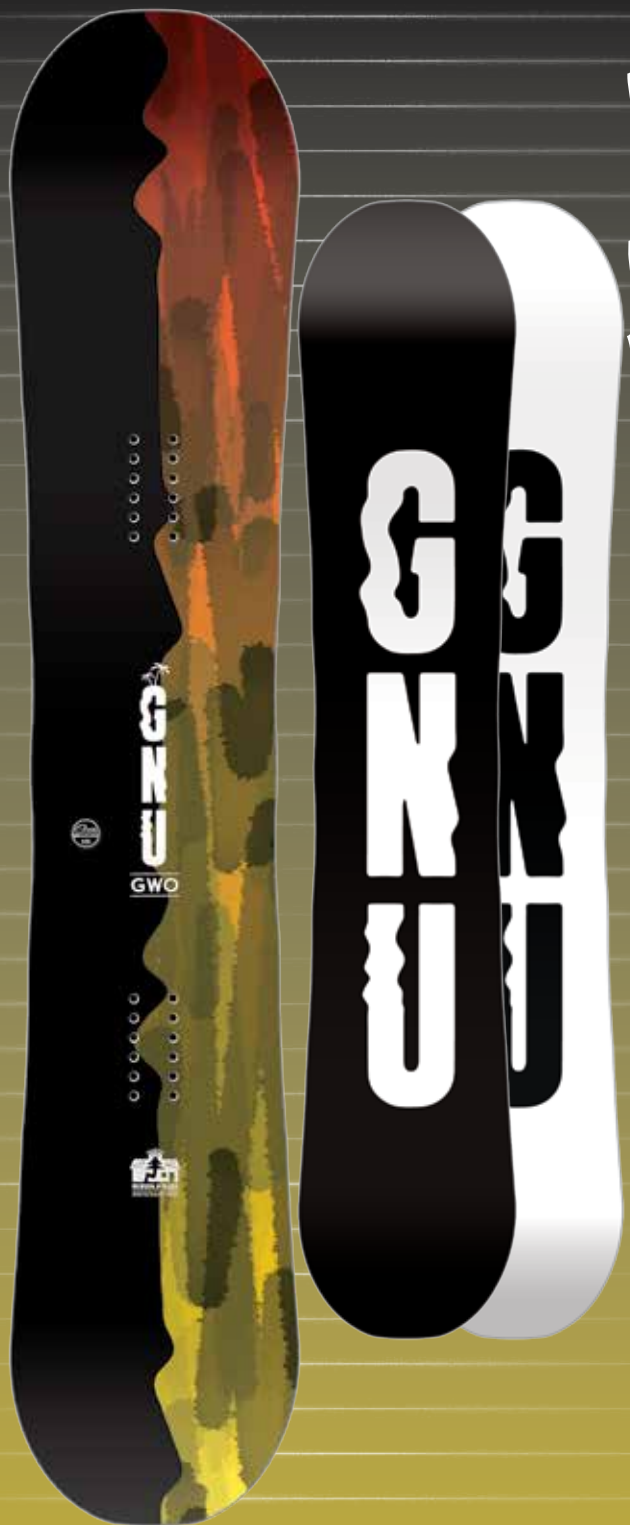

FREESTYLE / ALL MOUNTAIN / TWIN SHAPE

- The perfect freestyle minded snowboard
- Rips everything you can see from the chair and loves a rope tow
- Amazing American craftsmanship, performance and value

Fun, easy to ride and packed with performance features the GWO (GNU NEW WORLD ORDER) is the culmination of decades of all terrain freestyle resort focused snowboard design. A ready for everything, catch free, carvy, floaty BTX Hybrid contour. Magne-Traction® serrated edges offer effortless edge hold on ice and hardpack. Lively, poppy, long lasting eco-friendly construction with a fast low maintenance base.

TERRAIN TYPES



RIDER ABILITY



FLEX SCALE



THE BEST CONTOUR TO LEARN ON



CORE: G LITE 1 FSC Certified Poplar + Paulownia Core: Light, Strong And Poppy

GLASS: Tri-Ax/Bi-Ax Glass: Strong And Poppy

TOP: Eco Sublimated Poly Top: Tough And Environmentally Nice.

BASE: Eco Sublimated Co-Ex Base: Fast, Tough And Holds Wax

SIDEWALL & TIPS/TAILS: UHMW: Tough And Fast

LENGTH	CONTACT LENGTH	SIDE CUT	NOSE WIDTH	WAIST WIDTH	TAIL WIDTH	STANCE MIN-MAX/SET BACK
147	109 cm	8	28.1	24.2	28.1	17"-22" / 0"
150	111 cm	8.1	28.2	24.5	28.2	19.24"-24" / 0"
153	114.5 cm	8.2	28.9	24.8	28.9	20.25"-25" / 0"
156	119 cm	8.2	29.8	25.4	29.8	20.25"-25" / 0"
159	121 cm	8.3	30.2	25.5	30.2	20.25"-25" / 0"
156 w*	119 cm	8.3	31.1	26.7	31.1	20.25"-25" / 0"
159 w*	121 cm	8.3	31.2	26.7	31.2	20.25"-25" / 0"
162 w*	122 cm	8.4	31.4	26.7	31.4	20.25"-25" / 0"

*WIDE



Board Art: Gnu Snowboards
@gnusnowboards



WE BUILD OUR OWN DAMN BOARDS



MAX WARBINGTON



WELCOME TO GNU COUNTRY · WELCOME TO GNU COUNTRY · WELCOME TO GNU COUNTRY

GNU

JAM



FINEST

By Max Warbington



FREESTYLE / ALL MOUNTAIN / ASYM TWIN SHAPE

- Max Warbington's fine tuned "can do" snowboard
- Freestyle's all terrain with the crew
- Max's art eco-sublimated on top and into a rugged sintered base

The Finest Gnu ever made! Max's ASYM C2x freestyle stick has been fine tuned in pursuit of freestyle progression and perfection. Guaranteed to add depth to your park performance and freestyle freedom to your deep snow game. Grab your crew, feed the animals and go boardin! Absolute control in all terrain is built in.

TERRAIN TYPES



RIDER ABILITY



FLEX SCALE



HYBRID
C2^x

Xtreme Riding All Terrain Contour

ASYM LEVEL 2



CORE: G LITE 2 FSC Certified Aspen + Paulownia Core: Light, Strong And Poppy

GLASS: Tri-Ax/Bi-Ax Glass: Strong And Poppy

TOP: Eco Sublimated Poly Top: Tough And Environmentally Nice.

BASE: Eco Sublimated Sintered Base: Fast, Tough And Holds Wax

SIDEWALL & TIPS/TAELS: UHMW: Tough And Fast

LENGTH	CONTACT LENGTH	SIDE CUT	NOSE WIDTH	WAIST WIDTH	TAIL WIDTH	STANCE MIN-MAX/SET BACK
148	110 cm	8 / 7.9	28.4	24.8	28.4	19.24"-24" 0"
151	111 cm	8.1 / 7.8	28.8	25	28.8	20.25"-25" 0"
154	113 cm	8.1 / 7.8	29.1	25.1	29.1	20.25"-25" 0"
157	116 cm	8.2 / 7.9	29.7	25.5	29.7	20.25"-25" 0"
159	118 cm	8.3 / 8.0	29.9	25.7	29.9	20.25"-25" 0"
155 w*	114 cm	8.1 / 7.8	30.4	26.2	30.4	20.25"-25" 0"

*WIDE

MAGNE-TRACTION
EDGE HOLD ADVANTAGE

AWESOME TURNING
ASYM AWESOME
BALANCE THROUGH ASYMMETRY



Board art: Max Warbington
@69max420



WE BUILD OUR OWN DAMN BOARDS

RIDERS CHOICE



FREESTYLE / ALL MOUNTAIN / ASYM TWIN SHAPE

- A board for riders by riders
- Poppy powerful 3-D Asym Chip power platforms
- Intuitive Asym advantage maximizes performance

New 3-D Delightwood Asym Chip construction on proven Asym geometries distribute energy to your edges and elevate pop, power and performance. The Gnu Squad had a heavy hand in this one combining; asymmetry, slightly wider widths that rail and float with C2 Hybrid contours that pop, slide, carve and lift. All laminated into an eco-minded construction with poppy carbon that is built to blast and last. It's quite possibly the best snowboard we have ever made!

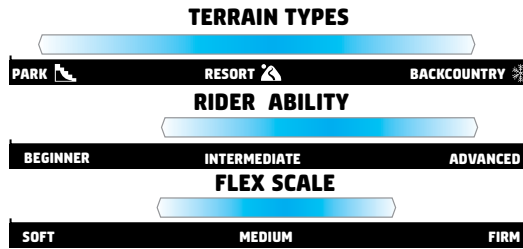

CORE: G LITE 3 FSC Certified Aspen + Paulownia Core Lightest, Stronger And Most Poppy

GLASS: Tri-Ax/Bi-Ax Glass + Carbon Power Bands: Strong And Poppy

TOP: Eco Sublimated Poly Top: Tough And Environmentally Nice

BASE: Sintered Knife-Cut Base: Fast, Tough And Holds Wax

SIDEWALL & TIPS/TAILS: UHMW: Tough And Fast

LENGTH	CONTACT LENGTH	SIDE CUT	NOSE WIDTH	WAIST WIDTH	TAIL WIDTH	STANCE MIN-MAX/SET BACK
151.5	113 cm	7.9 / 8.2	29.2	25.1	29.2	20"-26"/ 0"
154.5	116 cm	7.7 / 8.1	29.3	25.2	29.3	20.25"-25"/ 0"
157.5	119 cm	7.8 / 8.2	29.9	25.5	29.9	20.25"-25"/ 0"
159.5	120 cm	7.9 / 8	30	25.6	30	20.25"-25"/ 0"
161.5	122 cm	8 / 8.4	30.2	25.8	30.2	20.25"-25"/ 0"
155 W*	116 cm	7.7 / 8.1	30.7	26.5	30.7	20.25"-25"/ 0"
158 W*	119 cm	7.8 / 8.2	31.2	26.8	31.2	20.25"-25"/ 0"
162 W*	122 cm	8 / 8.4	31.3	26.8	31.3	20.25"-25"/ 0"

*WIDE

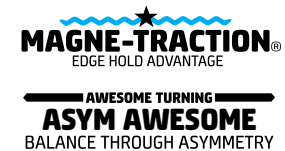

WE BUILD OUR OWN DAMN BOARDS

RC C3



FREESTYLE / ALL MOUNTAIN / ASYM TWIN SHAPE

- Cambered freestyle for our riders by our riders
- Poppy powerful 3-D Asym Chip power platforms
- Intuitive Asym advantage maximizes performance

Contest contenders, progression technicians and camber lovers this one's for you!

New 3-D Delightwood Asym Chip construction on proven Asym geometries distribute energy to your edges and elevate pop, power and performance. Built on a poppy high performance C3 Camber chassis with a lively Aspen / Paulownia core. This beast of choice is performance enhanced with ultra responsive Carbon Power Bands and a rugged fast knife cut sintered base. Add the eco sublimated poly top and the RC C3 is quite possibly the best freestyle snowboard we have ever made!

TERRAIN TYPES



RIDER ABILITY



FLEX SCALE



Aggressive All Terrain Contour

ASYM LEVEL 2



CORE: G LITE 3 FSC Certified Aspen + Paulownia Core Lightest, Stronger And Most Poppy

GLASS: Tri-Ax/Bi-Ax Glass + Carbon Power Bands: Strong And Poppy

TOP: Eco Sublimated Poly Top: Tough And Environmentally Nice

BASE: Sintered Knife-Cut Base: Fast, Tough And Holds Wax

SIDEWALL & TIPS/TAILS: UHMW: Tough And Fast

LENGTH	CONTACT LENGTH	SIDE CUT	NOSE WIDTH	WAIST WIDTH	TAIL WIDTH	STANCE MIN-MAX/SET BACK
154.5	116 cm	7.7 / 8.1	29.3	25.2	29.3	20.25"-25" / 0"
157.5	119 cm	7.8 / 8.2	29.9	25.5	29.9	20.25"-25" / 0"
159.5	120 cm	7.9 / 8.0	30	25.6	30	20.25"-25" / 0"
158 W*	119 cm	7.8 / 8.2	31.2	26.8	31.2	20.25"-25" / 0"
162 W*	122 cm	8 / 8.4	31.3	26.8	31.3	20.25"-25" / 0"

*WIDE



AWESOME TURNING
ASYM AWESOME
BALANCE THROUGH ASYMMETRY



Board art: Eric Kenney
@heavyslime_



WE BUILD OUR OWN DAMN BOARDS

ANTIGRAVITY



ALL MOUNTAIN / DIRECTIONAL SHAPE

- Directional camber freeride perfection
- Rips the resort top to bottom
- Radical quality, performance and price

Gnu has been rooted in weightless fun since forever. The directional C3 Antigravity honors our ethos by ignoring the past and being perfectly designed for modern snowboarding good times. An easy riding one board quiver with a feel good sustainable wood core, Magne-Traction® serrated edges, an eco-sublimated low maintenance base and proven all terrain geometries. Radical!

TERRAIN TYPES



RIDER ABILITY



FLEX SCALE



C³ CAMBER

Aggressive All Terrain Contour

TEXTURED TOP SHEET



CORE: G LITE 1 FSC Certified Poplar + Paulownia Core: Light, Strong And Poppy

GLASS: Tri-Ax/Bi-Ax Glass: Strong And Poppy

TOP: Eco Sublimated Poly Top: Tough And Environmentally Nice.

BASE: Eco Sublimated Co-Ex Base: Fast, Tough And Holds Wax

SIDEWALL & TIPS/TAI LS: UHMW: Tough And Fast

LENGTH	CONTACT LENGTH	SIDE CUT	NOSE WIDTH	WAIST WIDTH	TAIL WIDTH	STANCE MIN-MAX/SET BACK
150	106cm	8	28.8	25	28.5	18.5"-23.25"/1"
153	108cm	8	29.2	25.2	29	19.25"-24" /1"
156	111cm	8	29.7	25.5	29.4	20.5"-25"/1"
159	113cm	8.1	30.1	25.7	29.7	20.5"-25"/1"
162	116cm	8.1	30.3	25.8	30	20.5"-25"/1"
159 w*	113cm	8.1	31.1	26.7	30.7	20.5"-25"/1"
162 w*	116cm	8.1	31.3	26.8	31	20.5"-25"/1"

*WIDE



Board art: Shawn Bishop
@sbishbish



WE BUILD OUR OWN DAMN BOARDS



WELCOME TO GNU COUNTRY . WELCOME TO GNU COUNTRY .

GNU

LISTEN TO GREMLIN

GREMLIN

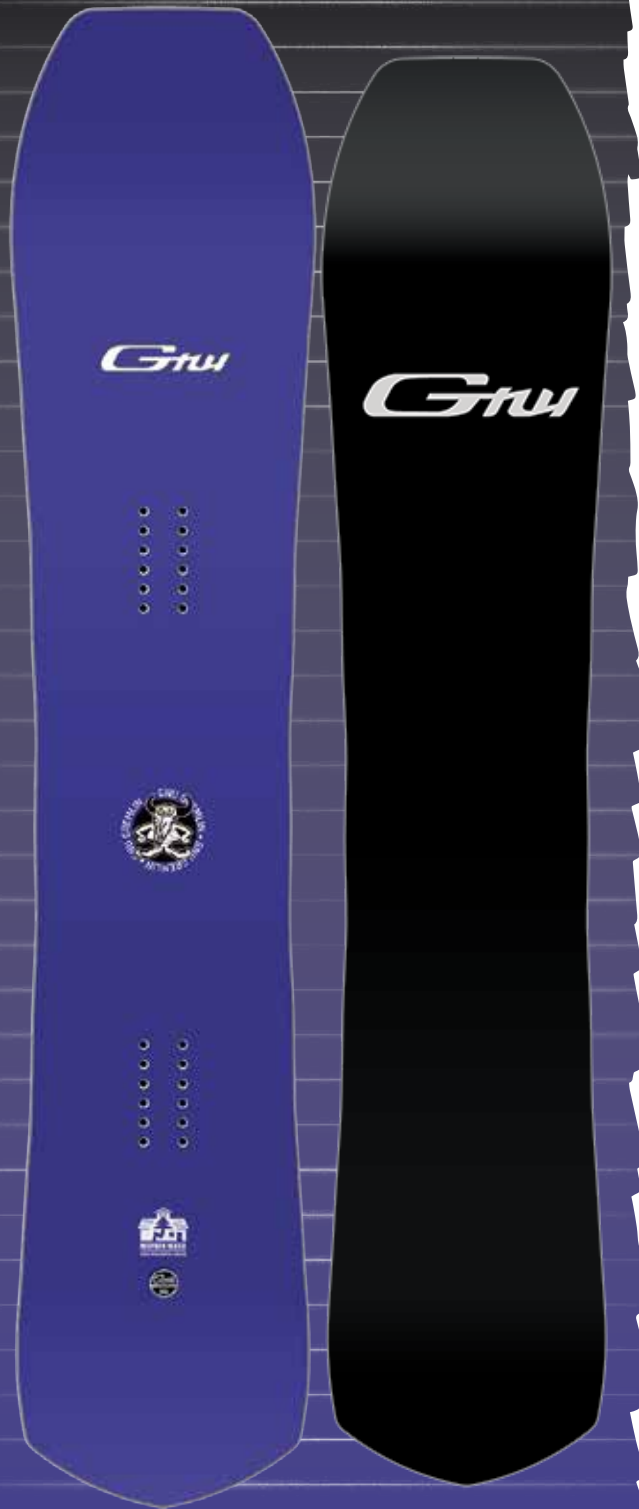

ALL MOUNTAIN / DIRECTIONAL SHAPE

- Take over any mountain
- Loves pow, eats hardpack and ice
- Camber, Magne-Traction®, sintered, self centered
- Mild volume Shift. Ride this board 2 cm shorter than your normal board

The Gremlin. A one board quiver for advanced snowboarder's looking to get more attention from the chair and in the bar. Floaty nose sniffs out powder, camber body pops over skiers and ropelines. Sintered base scratches rocks and crushes people who didn't know you were racing them to the bottom. The only snowboard on the planet that tells the truth...lies are to hard to remember when fire burns. A great idea that should have never been...Grab a Gremlin!

TERRAIN TYPES



RIDER ABILITY



FLEX SCALE



CAMBER

Aggressive All Terrain Contour



CORE: G LITE 2 FSC Certified Aspen + Paulownia Core: Light, Strong And Poppy

GLASS: Tri-Ax/Bi-Ax Glass: Strong And Poppy

TOP: Eco Sublimated Poly Top: Tough And Environmentally Nice.

BASE: Sintered Knife-Cut Base: Fast, Tough And Holds Wax

SIDEWALL & TIPS/TAILS: UHMW: Tough And Fast

NEW-->

LENGTH	CONTACT LENGTH	SIDE CUT	NOSE WIDTH	WAIST WIDTH	TAIL WIDTH	STANCE MIN-MAX/SET BACK
144	102 cm	6.6	30	25.5	28.8	18.5"-23.25"/ 2"
148	104 cm	6.8	30.3	25.8	29.1	18.5"-23.25"/ 2"
152	106 cm	7	30.9	26.1	29.7	19.25"-24"/ 2"
155	108 cm	7.2	31.3	26.4	30.1	19.25"-24"/ 2"
158	110 cm	7.5	32.1	27	30.8	19.25"-24"/ 2"
161	112 cm	7.7	32.6	27.5	31.3	19.25"-24"/ 2"



Art: Gnu Gift Shop
@gnusnowboards



WE BUILD OUR OWN DAMN BOARDS

HYPER

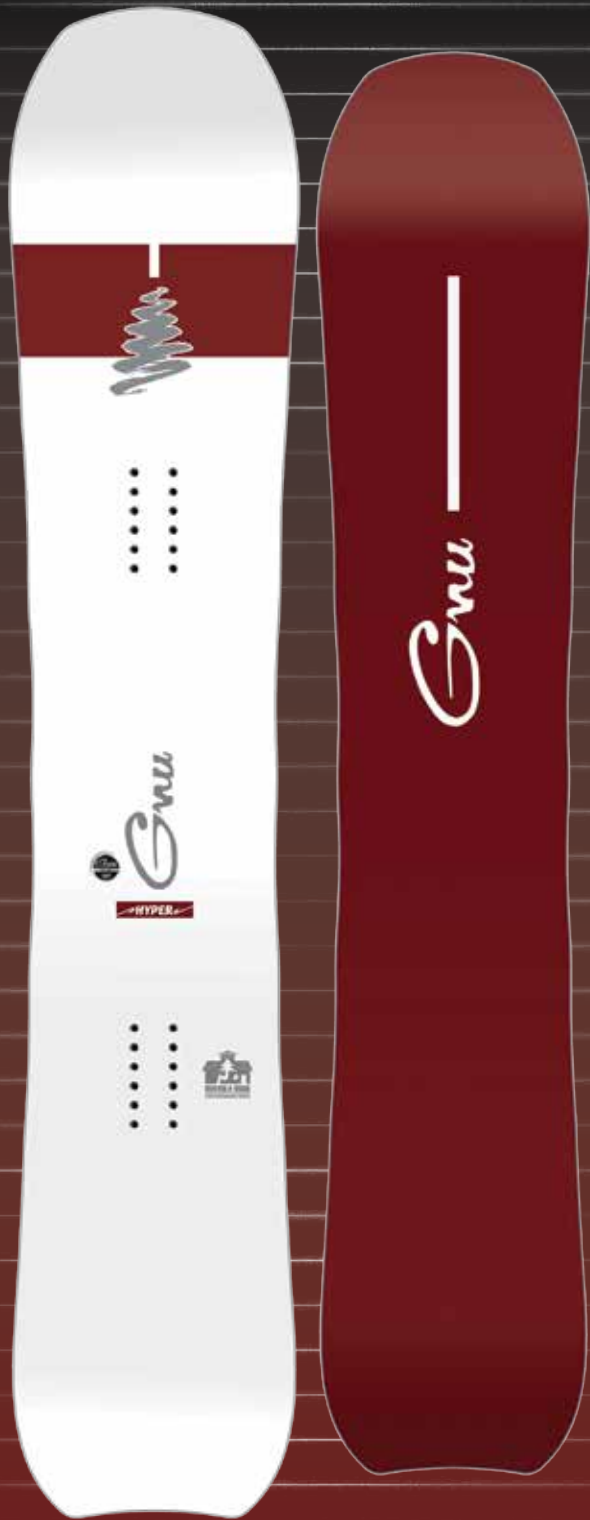

ALL MOUNTAIN / DIRECTIONAL SHAPE

- Freestyling freeride snowboard
- Carbon power bands: Radical response and pop
- FSC certified core flies, floats, pops and lasts

Simple elegance...the perfect freestylers all mountain board. An eco friendly wood core rides smooth and stable. Carbon Power Bands ensure long lasting precision and pop. The C2 Hybrid contour, floaty nose and tapered directional shape settle nicely into things when conditions get soft. Magne-Traction® and a refined side cut make this an effortless carver on hardpack and ice. Less is radical!

TERRAIN TYPES



RIDER ABILITY



FLEX SCALE



**HYBRID
C2^x**

Xtreme Riding All Terrain Contour



CORE: G LITE 3 FSC Certified Aspen + Paulownia Core Lightest, Stronger And Most Poppy

GLASS: Tri-Ax/Bi-Ax Glass + Carbon Power Bands: Strong And Poppy

TOP: Eco Sublimated Poly Top: Tough And Environmentally Nice

BASE: Sintered Knife-Cut Base: Fast, Tough And Holds Wax

SIDEWALL & TIPS/TAILS: UHMW: Tough And Fast

LENGTH	CONTACT LENGTH	SIDE CUT	NOSE WIDTH	WAIST WIDTH	TAIL WIDTH	STANCE MIN-MAX/SET BACK
NEW--> 151	111 cm	8	28.8	24.7	28.2	20.25"-25" 1.5"
154	113 cm	8.1	29.4	25	28.8	20.25"-25" 1.5"
157	115 cm	8.2	29.7	25.3	29.3	20.25"-25" 1.5"
160	117 cm	8.3	30.8	25.6	29.9	20.25"-25" 1.5"
159W*	117 cm	8.3	31.1	26.7	30.3	20.25"-25" 1.5"

WIDE



Art: Gnu future Gift Shop
@gnusnowboards



WE BUILD OUR OWN DAMN BOARDS



4x4 By FOREST BAILEY

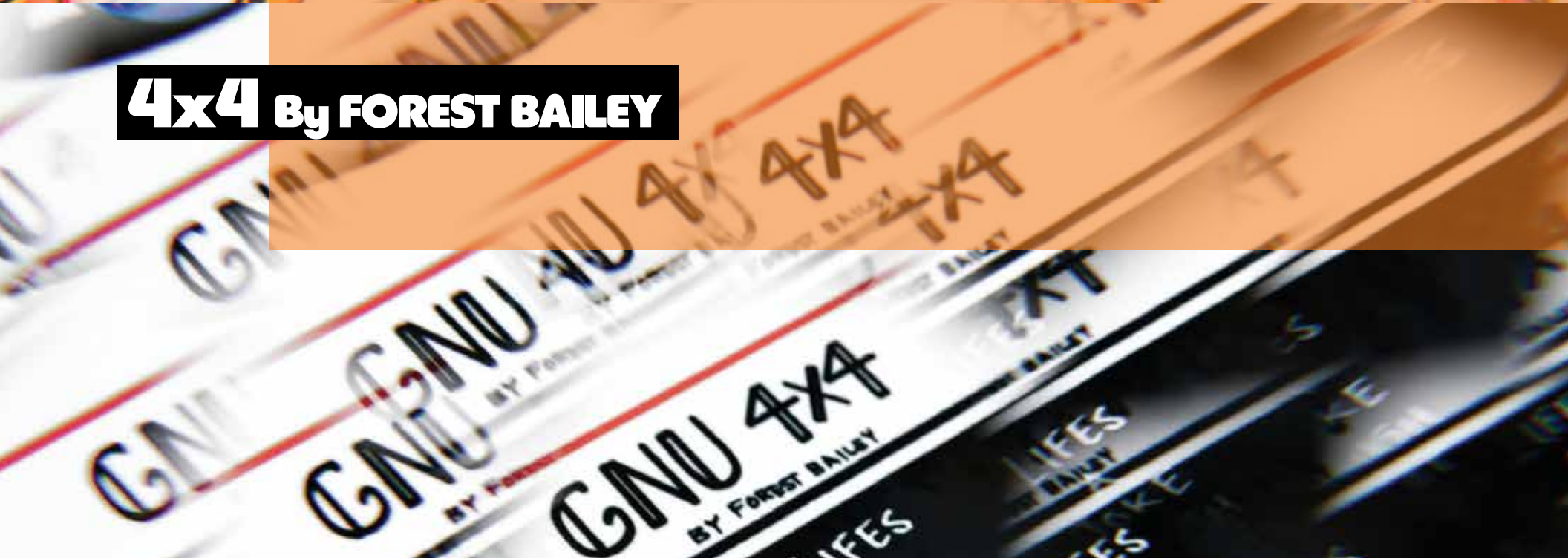

4x4 By Forest Bailey



ALL MOUNTAIN / DIRECTIONAL SHAPE

- Forest Bailey's directional ATV
- Freestyle the entire mountain
- A street master's big mountain stick

Forest Bailey is a complete rider...his skateboard roots put him in the streets, his mastery of east coast ice makes him an amazing carver and his love of all things wild put him in the big mountains. A decade of board design experience and experiments went into this magical floaty nosed, zero taper angle, freestyle focused directional ATV. Head Space the streets and 4x4 the wilds. Forest Bailey's two board quiver is built to stack clips for the complete all terrain master part.

TERRAIN TYPES



RIDER ABILITY



FLEX SCALE



C³AMBER

Aggressive All Terrain Contour



CORE: G LITE 2 FSC Certified Aspen + Paulownia Core: Light, Strong And Poppy

GLASS: Tri-Ax/Bi-Ax Glass: Strong And Poppy

TOP: Eco Sublimated Poly Top: Tough And Environmentally Nice.

BASE: Sintered Sublimated

SIDEWALL & TIPS/TAILS: UHMW: Tough And Fast

LENGTH	CONTACT LENGTH	SIDE CUT	NOSE WIDTH	WAIST WIDTH	TAIL WIDTH	STANCE MIN-MAX/SET BACK
157	119 cm	8.4	29.7	25.5	29.7	19.24"-24"/1"
160	121 cm	8.4	30	25.7	30	19.24"-24"/1"



Board art: Forest Bailey
@forestbailey



WE BUILD OUR OWN DAMN BOARDS

NEW!

SOMETHING G-NOSE?



NEW!

SOMETHING GNU

NEW!



ALL MOUNTAIN FREERIDE / DIRECTIONAL SHAPE

- Gnu's innovative carving / floating historical future flash
- Deep carving progressive sidecut (Drifty snowboards aren't delicious)
- Floaty easy entry resort carving pow slayer

A great leap forward for mankind...Gnu was credited by TWS mag as being the first brand to market deep carving sidecuts intended for resort hardpack terrain which was a critical step as snowboards evolved from finned backcountry powder designs only to modern all terrain "directional device" resort atvs. Something Gnu takes the inspiration of Mike Olsons early 80s' finless designs and adds in all we have learned over the past 40 years of Gnu board building. Fine tuned progressive sidecuts provide forgiving turn entry and finlike hold in the tail allowing deep powerful trenced carving on hardpack and ice. A long smooth tip entry floats the pow effortlessly on those special days and the swallow tail and taper settles nicely adding even more control and float. A modern directional C2 contour works in harmony with tip and entry sidecut for easy turn entry and the tight shorter camber adds hold in the tail for radical resort power carving. "Drifty Snowboards aren't delicious...business casual in the front power party in the back!

TERRAIN TYPES



RIDER ABILITY



FLEX SCALE



HYBRID
C2 DIRECTIONAL

Perfect All Terrain Contour



CORE: G LITE 3 FSC Certified Aspen + Paulownia Core: Light, Strong And Poppy

GLASS: Tri-Ax/Bi-Ax Glass: Strong And Poppy

TOP: Eco Sublimated Poly Top: Tough And Environmentally Nice.

BASE: Sintered Knife-Cut Base: Fast, Tough And Holds Wax

SIDEWALL & TIPS/TAILS: UHMW: Tough And Fast

LENGTH	CONTACT LENGTH	SIDE CUT	NOSE WIDTH	WAIST WIDTH	TAIL WIDTH	STANCE MIN-MAX/SET BACK
156	108 cm	6.66/6	31	25.3	29.8	17.75"-22.5"/4"
161	112 cm	6.66/6	31.8	26.1	30.5	17.75"-22.5"/4"

MAGNE-TRACTION®
EDGE HOLD ADVANTAGE



MERVIN MADE
ZERO HAZARDOUS WASTE



HAND BUILT IN
WASHINGTON STATE

Creative Vision: Pete Saari
@turtletater



WE BUILD OUR OWN DAMN BOARDS

WELCOME TO GNU COUNTRY · WELCOME TO GNU COUNTRY · WELCOME TO GNU COUNTRY

GNU

BM*GW

Axtion



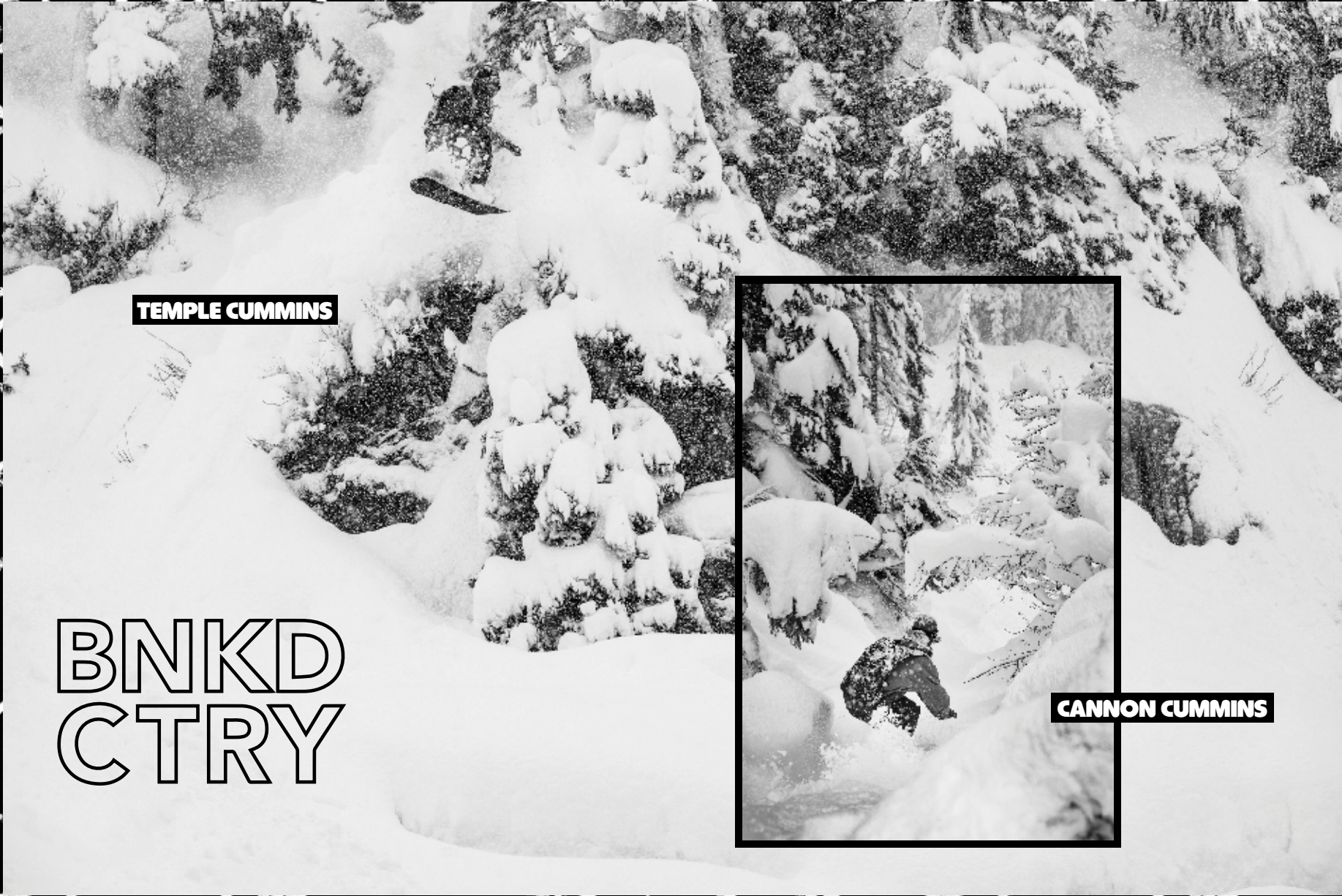

TEMPLE CUMMINS

BNKD CTRY



CANNON CUMMINS

BANKED COUNTRY

By Temple & Cannon Cummins



ALL MOUNTAIN / DIRECTIONAL SHAPE

- Temple and Cannon's father/son ultra refined design
- Carbon Power Bands: Radical response and pop
- New, fast, positive Directional Progressive Magne-Traction® technology

The ultimate resort shred stick for advanced rippers who constantly watch the weather and score ridiculous amounts of pow but, rip everyday regardless of the conditions. Designed by legendary freestyle minded resort Billy Goater Temple Cummins and his skateboard influenced son Cannon this fantasy father son project is a refined high performance ATV with one eye on float, the other eye on fly and the third eye on more Baker Banked Slalom gold duct tape. A big floaty nose, a powerful responsive construction, directional camber set back 1.5", mild taper angle, a nice new switch friendly tail and exclusive all new directional progressive Magne-Traction®. Banked Country is what you want to ride and where you want to be.

TERRAIN TYPES



RIDER ABILITY



FLEX SCALE



C³ CAMBER

Aggressive All Terrain Contour



CORE: G LITE 3 FSC Certified Aspen + Paulownia Core Lightest, Stronger And Most Poppy

GLASS: Tri-Ax/Bi-Ax Glass + Carbon Power Bands: Strong And Poppy

TOP: Eco Sublimated Poly Top: Tough And Environmentally Nice

BASE: Sintered Knife-Cut Base: Fast, Tough And Holds Wax

SIDEWALL & TIPS/TAELS: UHMW: Tough And Fast

LENGTH	CONTACT LENGTH	SIDE CUT	NOSE WIDTH	WAIST WIDTH	TAIL WIDTH	STANCE MIN-MAX/SET BACK
155	112 cm	8.2	29.4	25.3	29.2	19"-24"/ 1.5"
159	114 cm	8.3	29.6	25.4	29.4	20"-25"/ 1.5"
162	116 cm	8.4	29.8	25.5	29.6	20"-25"/ 1.5"
160 W*	114 cm	8.3	30.8	26.5	30.6	20"-25"/ 1.5"
163 W*	116 cm	8.3	31.2	26.8	31	20"-25"/ 1.5"

*WIDE



Board art: Cannon Cummins
@cannoncummins



WE BUILD OUR OWN DAMN BOARDS



BANKED COUNTRY
SPLIT

WELCOME TO GNU COUNTRY • WELCOME TO GNU COUNTRY •
GNU
TEMPLE CUMMINS

PROMAG

2
YEAR
GRAPHIC

BANKED COUNTRY SPLIT
By Temple & Cannon Cummins

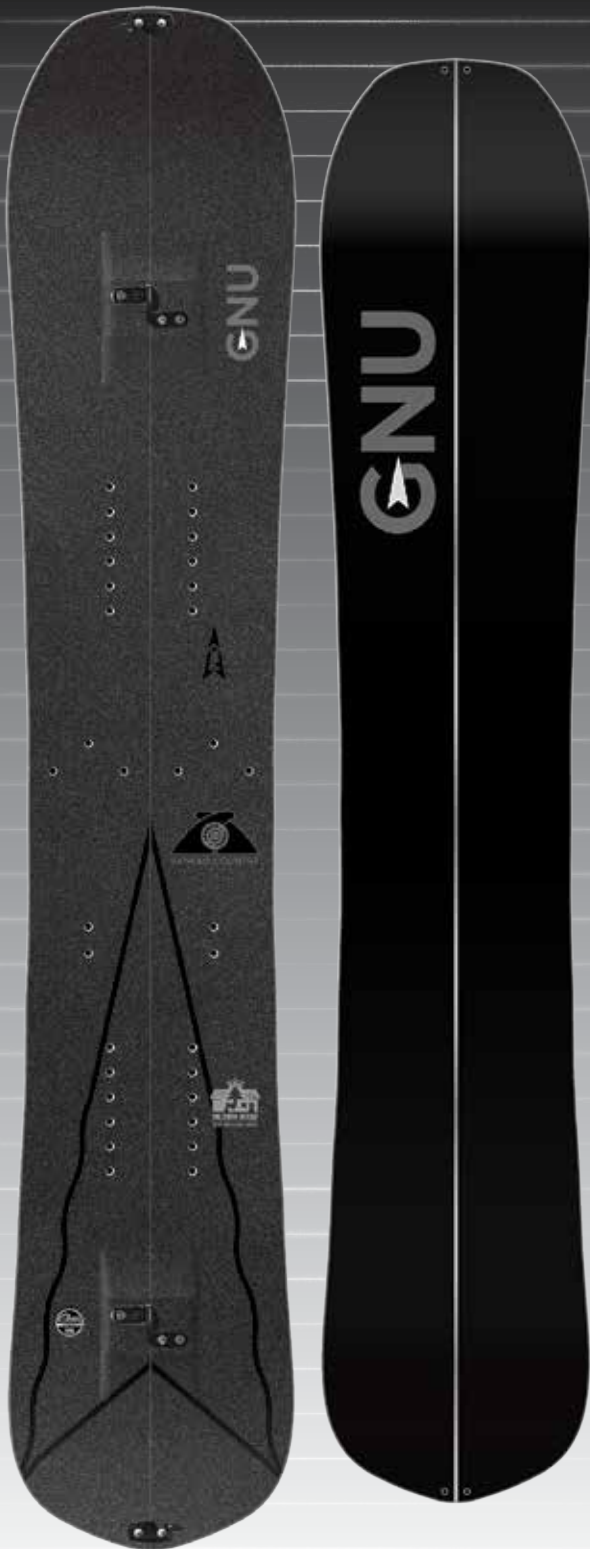

ALL MOUNTAIN FREERIDE / DIRECTIONAL SPLIT BOARD

- Temple and Cannon's lightweight directional pow slayer split
- Pillows, steeps and everything else out there
- Progressive Magne-Traction®, Karakoram Ultra Clips, and Carbon Power Bands for radical response and pop

Temple and Cannon's Banked Country split is a magical metamorphosis...their refined resort carving pow slaying machine has transformed into a lightweight climbing, powder and adrenalin access tool. A radically refined directional geometry/shape that includes a floaty nose, mild taper, Banked Slalom winning side cut and their unique Progressive "teeth in the tail" Magne-Traction® for quiet turn entry and unbelievable hook up in the tail to finish. A lightweight Paulownia core make this an effortless climber and floaty smooth rider. Karakoram Ultra Clips lock it all together for a solid board feel and speedy smooth transitions. Highly refined, heavily tested by the boys and you know this is the right stick when you are in Banked Country.

TERRAIN TYPES



RIDER ABILITY



FLEX SCALE



C³ CAMBER

Aggressive All Terrain Contour



- CORE:** FSC Certified 95% Paulownia with Aspen structure beams
- GLASS:** Tri-Ax/Bi-Ax with carbon power bands and insert reinforcement
- TOP:** Eco-Sublimated Poly Top: Tough And Environmentally Nice
- BASE:** Sintered Knife-Cut: Fast, Tough And Holds Wax
- SIDEWALLS:** UHMW: Tough And Fast
- TIP/TAIL:** Ultralight thin tip UHMW

LENGTH	CONTACT LENGTH	SIDE CUT	NOSE WIDTH	WAIST WIDTH	TAIL WIDTH	STANCE MIN-MAX/SET BACK
155	112 cm	8.2	29.4	25.3	29.2	19"- 24"/ 1.5"
159	114 cm	8.3	29.6	25.4	29.4	20"- 25"/ 1.5"
162	116 cm	8.4	29.8	25.5	29.6	20"- 25"/ 1.5"



Art: Gnu Art Store
@gnusnowboards



WE BUILD OUR OWN DAMN BOARDS

GLOSS



FREESTYLE / PARK / TWIN SHAPE

- True twin park focused style stick
- For easy progression and effortless flare
- Understated glam with underpriced tech

The Gloss is a twin freestyle board for playful park fun or all mountain freestyle action. It's got a blunted twin shape, a friendly flex, and a C2e camber hybrid contour, the perfect rocker/-camber hybrid. The Gloss puts a shine on your moves, with Magne-Traction® for catch-free edge control. understated glam, effortless style, underpriced tech, and unreal snowboarding!

TERRAIN TYPES



RIDER ABILITY



FLEX SCALE



HYBRID
C2^e

Easy Riding All Terrain Contour



CORE: G LITE 1 FSC Certified Poplar + Paulownia Core: Light, Strong And Poppy

GLASS: Tri-Ax/Bi-Ax Glass: Strong And Poppy

TOP: Eco Sublimated Poly Top: Tough And Environmentally Nice.

BASE: Knife Cut Co-Ex Base: Fast, Tough And Holds Wax

SIDEWALL & TIPS/TAILS: UHMW: Tough And Fast

LENGTH	CONTACT LENGTH	SIDE CUT	NOSE WIDTH	WAIST WIDTH	TAIL WIDTH	STANCE MIN-MAX/SET BACK
136	103cm	7.8	26.1	22.6	26.1	17"-22" / 0"
140	105cm	7.9	27.2	23.3	27.2	17"-22" / 0"
144	107cm	8	27.6	23.5	27.6	18.5"-23.5" / 0"
148	110cm	8.1	27.9	23.9	27.9	18.5"-23.5" / 0"

MAGNE-TRACTION
EDGE HOLD ADVANTAGE



Art: Sara Philips
@philllips



WE BUILD OUR OWN DAMN BOARDS

GLOSS C

NEW!

NEW!



FREESTYLE / PARK / TWIN SHAPE

- Cambered True twin park focused style stick
- Tech progression and effortless flare
- Understated glam with underpriced tech

The Gloss-C is a cambered twin freestyle board for serious park fun or all mountain freestyle action. It's got a blunted twin shape, a friendly flex, and C3 camber contour specifically designed for snowboarding. The Gloss-C puts a shine on your moves, with Magne-Traction® for catch-free edge control. understated glam, effortless style, underpriced tech, and unreal snowboarding!

TERRAIN TYPES



RIDER ABILITY



FLEX SCALE



C³ CAMBER

Aggressive All Terrain Contour



CORE: G LITE 1 FSC Certified Poplar + Paulownia Core: Light, Strong And Poppy

GLASS: Tri-Ax/Bi-Ax Glass: Strong And Poppy

TOP: Eco Sublimated Poly Top: Tough And Environmentally Nice.

BASE: Knife Cut Co-Ex Base: Fast, Tough And Holds Wax

SIDEWALL & TIPS/TAILS: UHMW: Tough And Fast

LENGTH	CONTACT LENGTH	SIDE CUT	NOSE WIDTH	WAIST WIDTH	TAIL WIDTH	STANCE MIN-MAX/SET BACK
136	103cm	7.8	26.1	22.6	26.1	17"-22" / 0"
140	105cm	7.9	27.2	23.3	27.2	17"-22" / 0"
144	107cm	8	27.6	23.5	27.6	18.5"-23.5" / 0"
148	110cm	8.1	27.9	23.9	27.9	18.5"-23.5" / 0"



Art: Sara Philips
@philllips



WE BUILD OUR OWN DAMN BOARDS

B-NICE



FREESTYLE / ALL MOUNTAIN / TWIN SHAPE

- Nice and easy riding twin
- Freestyle progression on the whole mountain
- Magne-Traction® for enhanced edge control

The B-Nice is a twin all mountain board with an approachable shape, softer flex, and our Original Banana Hybrid contour for catch-free progression. Even if your friends aren't nice or the terrain is hammered, the B-Nice will smooth out any drama and make your day a little more playful. Magne-Traction® adds predictable edge-control to the long list of this board's niceties. A lot of tech for a nice price, the B-Nice lives up to its name.

TERRAIN TYPES



RIDER ABILITY



FLEX SCALE



THE BEST CONTOUR TO LEARN ON



CORE: G LITE 1 FSC Certified Poplar + Paulownia Core: Light, Strong And Poppy

GLASS: Tri-Ax/Bi-Ax Glass: Strong And Poppy

TOP: Eco Sublimated Poly Top: Tough And Environmentally Nice.

BASE: Eco Sublimated Co-Ex Base: Fast, Tough And Holds Wax

SIDEWALL & TIPS/TAILS: UHMW: Tough And Fast

LENGTH	CONTACT LENGTH	SIDE CUT	NOSE WIDTH	WAIST WIDTH	TAIL WIDTH	STANCE MIN-MAX/SET BACK
133	101 cm	7.5	25.8	22.5	25.8	17"-22" / 0"
139	103 cm	7.6	26.1	22.6	26.1	17"-22" / 0"
142	106 cm	7.7	27	23.2	27	17.75"-22.5"/0"
145	108 cm	7.8	27	23.4	27	17.75"-22.5"/0"
148	112 cm	7.9	28	24	28	18.5"-23.5"/0"
151	114 cm	8	28.3	24.3	28.3	18.5"-23.5"/0"
154	116 cm	8.1	28.7	24.6	28.7	18.5"-23.5"/0"



Art: Gnu Gift Shop
@gnusnowboards



WE BUILD OUR OWN DAMN BOARDS

WELCOME TO GNU COUNTRY · WELCOME TO GNU COUNTRY · WELCOME TO GNU COUNTRY

GNU



VELVET

NAIMA ANTOLIN



VELVET

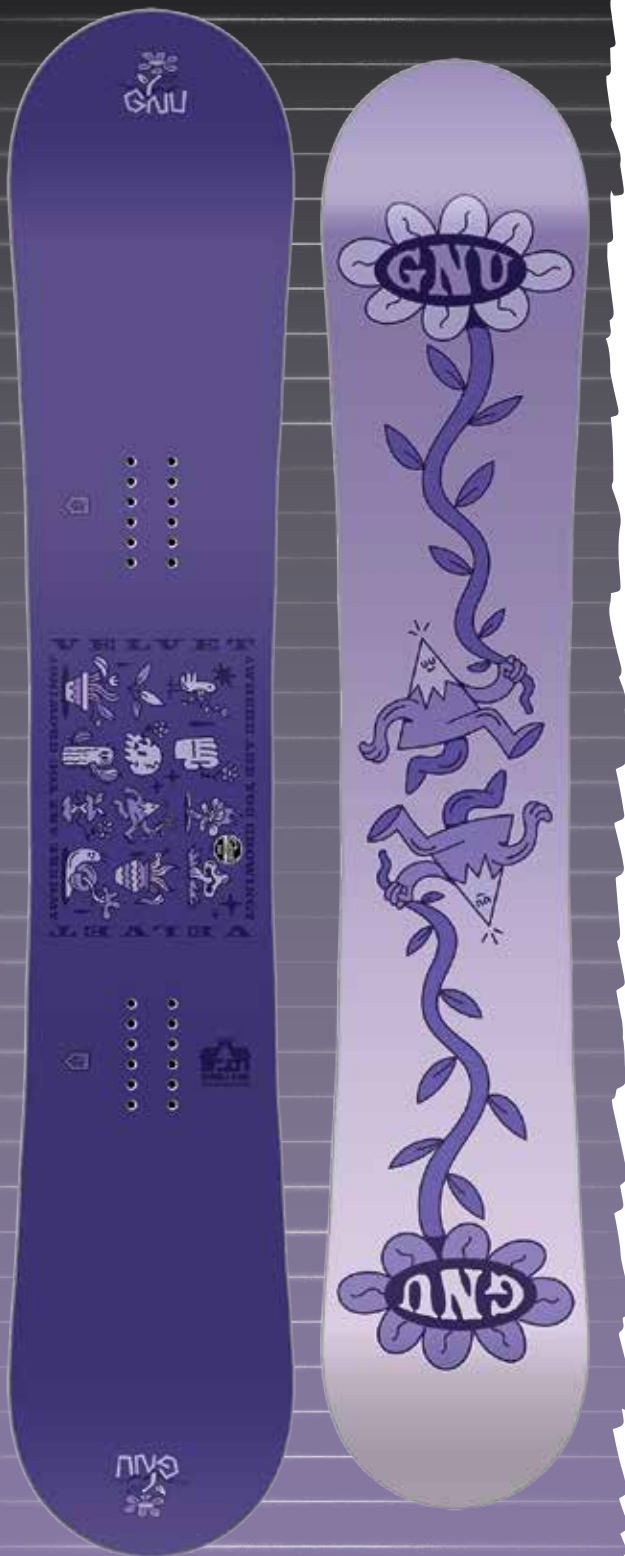

ALL MOUNTAIN / FREESTYLE / TWIN SHAPE

- Twin for freestyle progression
- The entire mountain is your creative playground
- Environmentally comfy FSC Certified wood core and a sintered base

The Velvet is the choice of Gnu team riders who approach the whole mountain like their park. It's snappy flex and hybrid C2 contour work in synergy for pop and stability. It features intuitive geometry, and Magne-Traction®, so it is catch-free and responsive. The eco sublimated plant-based graphics give this ride a down to earth vibe. The Velvet is comfortable in any conditions and as balanced in the park as it is in banked slaloms or street sessions. Design conceptualized by Naima Antolin and designed by Hannah Eddy.

TERRAIN TYPES



RIDER ABILITY



FLEX SCALE



**HYBRID
C2**

Perfect All Terrain Contour



CORE: G LITE 2 FSC Certified Aspen + Paulownia Core: Light, Strong And Poppy

GLASS: Tri-Ax/Bi-Ax Glass: Strong And Poppy

TOP: Eco Sublimated Poly Top: Tough And Environmentally Nice.

BASE: Eco Sublimated Sintered Base: Fast, Tough And Holds Wax

SIDEWALL & TIPS/TAILS: UHMW: Tough And Fast

LENGTH	CONTACT LENGTH	SIDE CUT	NOSE WIDTH	WAIST WIDTH	TAIL WIDTH	STANCE MIN-MAX/SET BACK
139	103 cm	7.9 / 7.6	26.1	22.6	26.1	17"-22" / 0"
143	105 cm	8 / 7.7	27.2	23.5	27.2	18.5"-23.5" / 0"
147	107 cm	8.1 / 7.8	27.6	23.9	27.6	18.5"-23.5" / 0"
150	110 cm	8.2 / 7.9	27.9	23.9	27.9	19.24"-24" / 0"
153	113 cm	8.3 / 8	28.1	24.1	28.1	19.24"-24" / 0"



Art: Hannah Eddy
@hannaheddyart



WE BUILD OUR OWN DAMN BOARDS



JAMIE ANDERSON

JA COLLECTION

LADIES CHOICE

By Jamie Anderson



FREESTYLE / ALL MOUNTAIN / ASYM TWIN SHAPE

- Jamie Anderson's asym twin fun freestyle choice
- Carves, flies and floats the whole mountain
- Knife cut sintered base and carbon power bands

The Ladies Choice has secured its place in snowboarding history with over a decade of collaboration with the most decorated female snowboarder, Jamie Anderson. Her balance between progression and playfulness is reflected in the progressive asym technology and a C2x camber hybrid contour, perfectly tuned for freestyle flow. Bringing Jamie's eco-minded sensibility to our construction materials and process, the Ladies Choice is built with a sustainably harvested FSC certified wood core and water-based inks. Eco sublimated graphics by Sarah King continue the decade + partnership with this all-mountain freestyle work of art. Ride the Ladies Choice and channel some JA magic!

TERRAIN TYPES



RIDER ABILITY



FLEX SCALE



HYBRID
C2^x

Xtreme Riding All Terrain Contour

ASYM LEVEL 2



CORE: G LITE 3 FSC Certified Aspen + Paulownia Core Lightest, Stronger And Most Poppy

GLASS: Tri-Ax/Bi-Ax Glass + Carbon Power Bands: Strong And Poppy

TOP: Eco Sublimated Bio Beans: Tough And Environmentally Nice

BASE: Sintered Knife-Cut Base: Fast, Tough And Holds Wax

SIDEWALL & TIPS/TAILS: UHMW: Tough And Fast

LENGTH	CONTACT LENGTH	SIDE CUT	NOSE WIDTH	WAIST WIDTH	TAIL WIDTH	STANCE MIN-MAX/SET BACK
139.5	103 cm	7.8 / 7.6	26.1	22.6	26.1	17"-22"/ 0"
142.5	107 cm	8.0 / 7.7	27	23.2	27	18.5"-23.5"/0"
145.5	109 cm	8.1 / 7.8	27.9	24	27.9	18.5"-23.5"/0"
148.5	111 cm	8.2 / 7.9	28	24.2	28	18.5"-23.5"/0"
151.5	114 cm	8.3 / 8.0	28.5	24.4	28.5	19.24"-24"/ 0"
153.5	116 cm	8.3 / 8.0	28.6	24.4	28.6	19.24"-24"/ 0"

MAGNE-TRACTION®
EDGE HOLD ADVANTAGE

AWESOME TURNING
ASYM AWESOME
BALANCE THROUGH ASYMMETRY



Board art: Sarah King
@sarahkingart



WE BUILD OUR OWN DAMN BOARDS

PRO CHOICE

By Jamie Anderson



ALL MOUNTAIN / FREESTYLE / ASYM TWIN SHAPE

- Jamie Anderson's asym twin choice for power freestyle moves
- Carves, flies and floats the whole mountain
- Knife cut sintered base and carbon power bands

Jamie Anderson continues to set the bar high for herself, and in the process, she has redefined what is possible for the world's best female snowboarders. She is a pro, in every sense of the word, and the Pro Choice is her choice for big days chasing big dreams. The C3 camber dominant contour, asymmetry and Magne-Traction® ensure pop and stability. Our most premium materials, construction and eco-sublimated art by Sarah King add up to a board that is as pro-earth as it is pro-performance.

TERRAIN TYPES



RIDER ABILITY



FLEX SCALE



C³ CAMBER

Aggressive All Terrain Contour

ASYM LEVEL 2



CORE: G LITE 3 FSC Certified Aspen + Paulownia Core Lightest, Stronger And Most Poppy

GLASS: Tri-Ax/Bi-Ax Glass + Carbon Power Bands: Strong And Poppy

TOP: Eco Sublimated Bio Beans: Tough And Environmentally Nice

BASE: Sintered Knife-Cut Base: Fast, Tough And Holds Wax

SIDEWALL & TIPS/TAIls: UHMW: Tough And Fast

LENGTH	CONTACT LENGTH	SIDE CUT	NOSE WIDTH	WAIST WIDTH	TAIL WIDTH	STANCE MIN-MAX/SET BACK
145.5	109 cm	8.1 / 7.8	27.9	24	27.9	18.5"-23.5"/0"
148.5	111 cm	8.2 / 7.9	28	24.2	28	18.5"-23.5"/0"
151.5	114 cm	8.3 / 8.0	28.5	24.4	28.5	19.24"-24"/0"

MAGNE-TRACTION®
EDGE HOLD ADVANTAGE

AWESOME TURNING
ASYM AWESOME
BALANCE THROUGH ASYMMETRY



Board art: Sarah King
@sarahkingart



WE BUILD OUR OWN DAMN BOARDS

FROSTING



ALL MOUNTAIN / DIRECTIONAL

- Directional C2 camber hybrid, perfect all terrain contour
- Friendly flex for float and flow
- Sintered base and eco-friendly construction

The Frosting is a sweet directional C2 camber hybrid board, built for all mountain adventures. It packs enough power to boost confidence in any terrain, magne-traction® for stable edge-control, and a friendly flex that floats in the pow and maneuvers with ease. Eco sublimated art with water based inks and a sintered base are ingredients for a frosting that is far superior to the other sugary confections on the market.

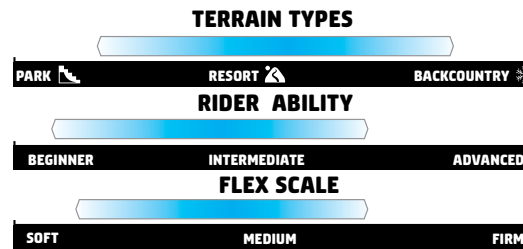

HYBRID C2
Perfect All Terrain Contour



CORE: G LITE 2 FSC Certified Aspen + Paulownia Core: Light, Strong And Poppy

GLASS: Tri-Ax/Bi-Ax Glass: Strong And Poppy

TOP: Eco Sublimated Poly Top: Tough And Environmentally Nice.

BASE: Eco Sublimated Sintered Base: Fast, Tough And Holds Wax

SIDEWALL & TIPS/TAI LS: UHMW: Tough And Fast

LENGTH	CONTACT LENGTH	SIDE CUT	NOSE WIDTH	WAIST WIDTH	TAIL WIDTH	STANCE MIN-MAX/SET BACK
143	108 cm	7.7	27.7	24	27.5	17"-22" / 1"
146	110 cm	7.8	27.9	24.1	27.7	18"-23" / 1"
149	112 cm	7.9	28.1	24.3	27.9	18"-23" / 1"
152	114 cm	8	28.5	24.4	28.3	18.5"-23.5" / 1"



Art: Corinne Weidmann
@corinne.weidmann



WE BUILD OUR OWN DAMN BOARDS

WELCOME TO GNU COUNTRY • WELCOME TO GNU COUNTRY • WELCOME TO GNU COUNTRY

GNU

PROMAG

BARRETT CHRISTY



Barrett

Barrett B4BC

www.barrettbc.com

Barrett B4BC

BOARDING FOR BREAST CANCER

BARRETT

By Barrett Christy

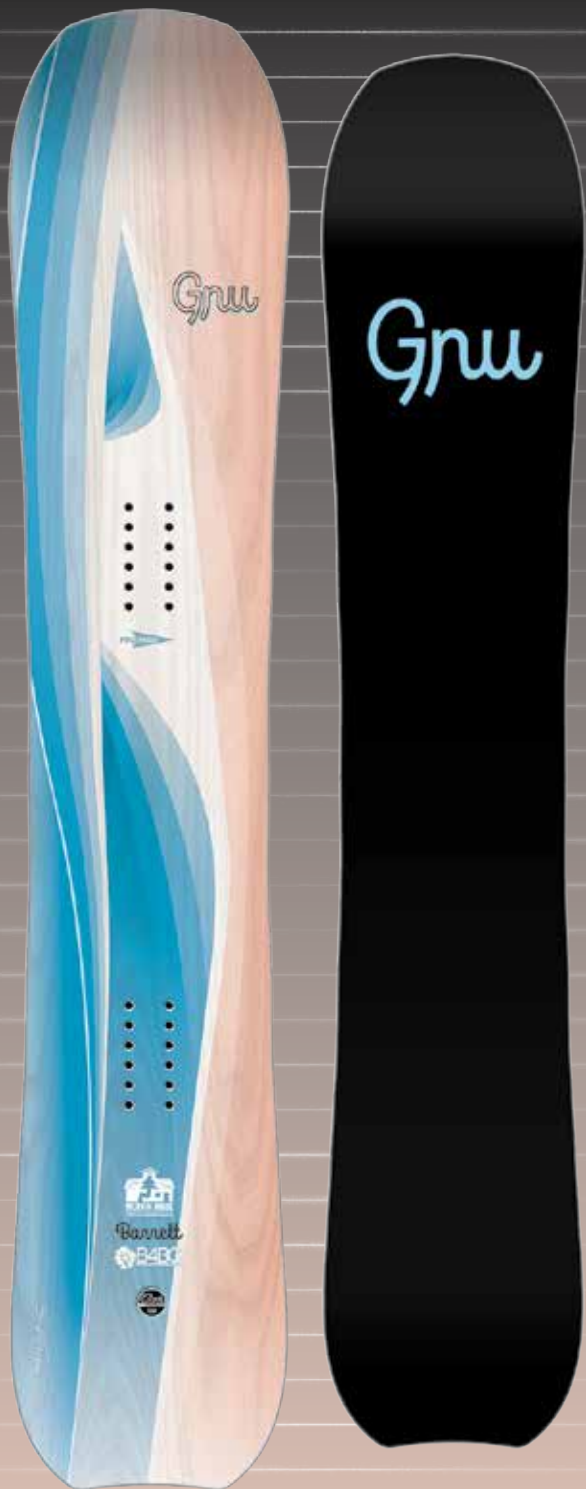

ALL MOUNTAIN / DIRECTIONAL SHAPE

- Barrett's pro model evolution for the directional revolution
- All Terrain camber dominant power player
- Progressive Magne-Traction® and Carbon Power Bands: Radical response and pop

The award-winning Barrett is the pinnacle of all mountain design. 25+ years of women's board design heritage has culminated in the Barrett. Camber perfection for stability and control, Carbon strips for light-weight snap and edge-to-edge torsional precision. Progressive Magne-traction® because edge control is the foundation for everything awesome in snowboarding. The evolution of Barrett's model is premium performance perfection in a pretty package. A portion of proceeds from the sale of this board is donated to Boarding for Breast Cancer @b4bc to support youth focused education, health and wellness programs.

TERRAIN TYPES



RIDER ABILITY



FLEX SCALE



C³ CAMBER

Aggressive All Terrain Contour



Portion of sales benefits



CORE: G LITE 3 FSC Certified Aspen + Paulownia Core Lightest, Stronger And Most Poppy

GLASS: Tri-Ax/Bi-Ax Glass + Carbon Power Bands: Strong And Poppy

TOP: Eco Sublimated Poly Top: Tough And Environmentally Nice

BASE: Sintered Knife-Cut Base: Fast, Tough And Holds Wax

SIDEWALL & TIPS/TAILS: UHMW: Tough And Fast

LENGTH	CONTACT LENGTH	SIDE CUT	NOSE WIDTH	WAIST WIDTH	TAIL WIDTH	STANCE MIN-MAX/SET BACK
146	110 cm	8	27.8	24.1	27.5	17"-22"/1.5"
149	113 cm	8.1	28.1	24.3	27.8	18"-23"/1.5"
152	116 cm	8.1	28.6	24.5	28.2	18"-23"/1.5"
155	118 cm	8.1	29.1	24.8	28.8	18"-23"/1.5"



Art: Shaun Thomas
@shaunthomasart



WE BUILD OUR OWN DAMN BOARDS

BARRETT SPLIT

2 YEAR GRAPHIC

By Barrett Christy

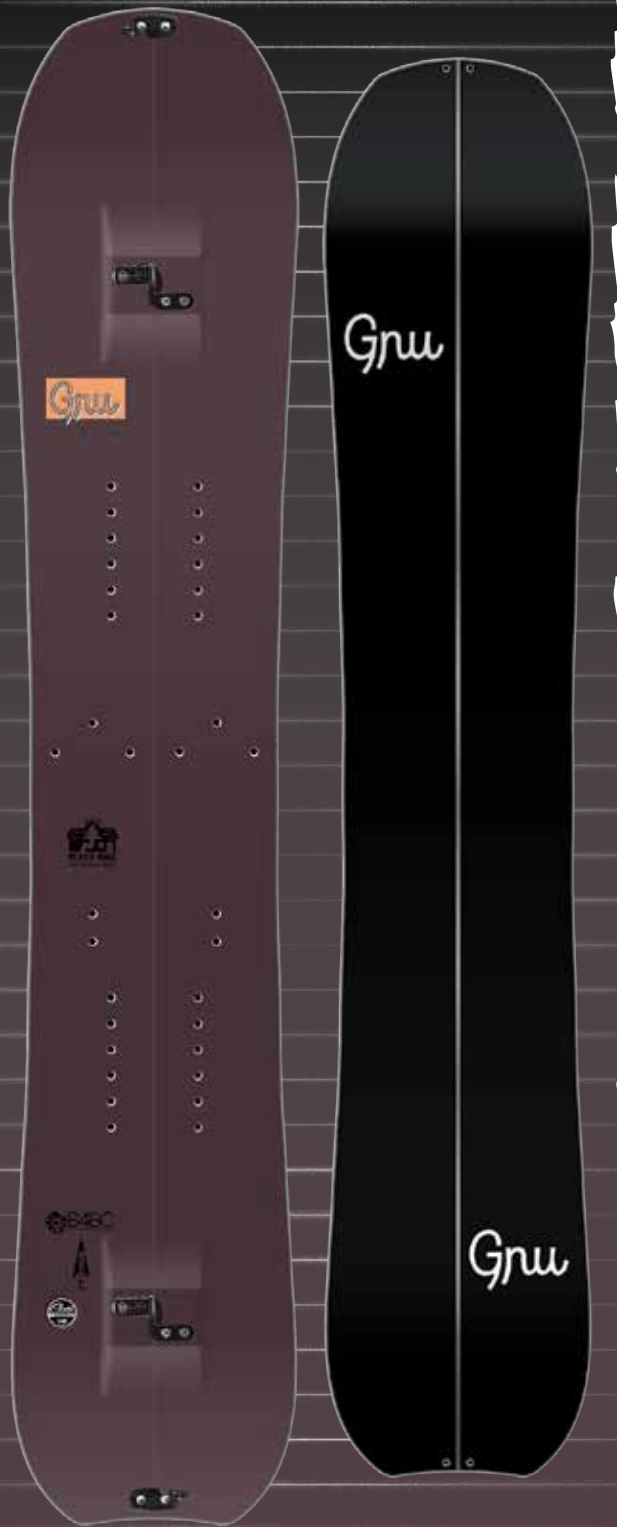

ALL MOUNTAIN FREERIDE / DIRECTIONAL SPLIT BOARD

- Barrett's lightweight directional pow slayer split
- Perfect for powder meadows or first descents
- Progressive Magne-Traction®, Karakoram Ultra Clips, and Carbon Power Bands for radical response and pop

Barrett took her refined all terrain directional pow slaying resort ripper and turned it into the ultimate back to nature retreat stick. A floaty nose keeps you on top of things, the cambered body and light weight Paulownia core ensures great skin traction for easy climbing and pop and power in all that powder. Keeping it in the family, Barrett is using Progressive Magne-Traction® technology like the Banked Country for guaranteed smooth, quiet entry turns and amazing hook-up in the tail.

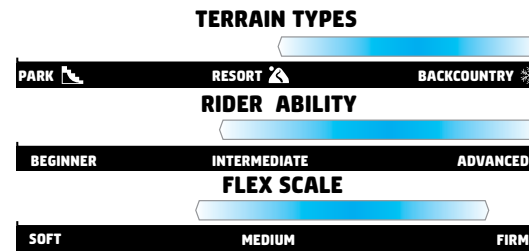

- CORE:** FSC Certified 95% Paulownia with Aspen structure beams
- GLASS:** Tri-Ax/Bi-Ax with carbon power bands and insert reinforcement
- TOP:** Eco-Sublimated Poly Top: Tough And Environmentally Nice
- BASE:** Sintered Knife-Cut: Fast, Tough And Holds Wax
- SIDEWALLS:** UHMW: Tough And Fast
- TIP/TAIL:** Ultralight thin tip UHMW

LENGTH	CONTACT LENGTH	SIDE CUT	NOSE WIDTH	WAIST WIDTH	TAIL WIDTH	STANCE MIN-MAX/SET BACK
149	113 cm	8.1	28.1	24.3	27.8	18"-23"/1.5"
152	116 cm	8.1	28.6	24.5	28.2	18"-23"/1.5"

NEW-->



Art: Gnu Gift Shop
@gnusnowboards



WE BUILD OUR OWN DAMN BOARDS

FREE SPIRIT

By Jamie Anderson



UNREAL ALL MOUNTAIN / DIRECTIONAL SHAPE

- Directional C3 floaty powerhouse
- Slightly volume shifted design with a freestyle spirit
- Carbon Power Bands: Radical response and pop

Jamie Anderson's Free Spirit continues to evolve. The Free Spirit model can chase big dreams on big mountains or whimsical wishes on mellow pow days. When she rides this board Jamie lives life to the fullest, with no limitations, no judges, and no boundaries. It's a floaty pow board with a freestyle spirit, capable of stomping big landings and navigating variable terrain with effortless ease. Whether shredding the resort, backcountry, Natural Selection courses, or AK lines the C3 camber dominant contour, Magne-Traction®, tail taper and snappy flex make this board a perfect choice for any spirit quest.

TERRAIN TYPES



RIDER ABILITY



FLEX SCALE



C³ CAMBER

Aggressive All Terrain Contour



CORE: G LITE 3 FSC Certified Aspen + Paulownia Core Lightest, Stronger And Most Poppy

GLASS: Tri-Ax/Bi-Ax Glass + Carbon Power Bands: Strong And Poppy

TOP: Eco Sublimated Bio Beans: Tough And Environmentally Nice

BASE: Sintered Knife-Cut Base: Fast, Tough And Holds Wax

SIDEWALL & TIPS/TAELS: UHMW: Tough And Fast

LENGTH	CONTACT LENGTH	SIDE CUT	NOSE WIDTH	WAIST WIDTH	TAIL WIDTH	STANCE MIN-MAX/SET BACK
148	97 cm	6	31	25.5	29.3	19.24"-24"/ 3"
153	102 cm	6	31.2	25.5	29.5	19.24"-24"/ 3"



Board Art: Sarah King
@sarahkingart



WE BUILD OUR OWN DAMN BOARDS



Gnu

SPEED/IN

FASTER / EASIER / SMARTER / MULTI ENTRY

24/25



How to change pressure on your ankle quickly

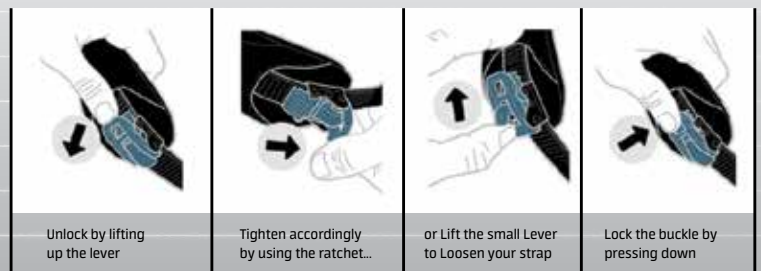

UNIQUE TECHNOLOGY

- 1. **Reclining Highback** - Rear Entry Advantage
 - 2. **Auto Open Ankle Strap** - Opens Auto *MAGICALLY!*
 - 3. **Auto Lever** - Simplified Entry
 - 4. **Cable Redirection** - Unimpeded Movement
- Lifetime Baseplate Warranty**

Gnu's unique speed entry binding system is the ultimate in performance, speed, ease and comfort. Fits any snowboard boot. Set your bindings up once and one lever gets you in and out with amazing ease all season long. Enjoy more time riding and smiling and less time fiddling and sitting. Hit the pressure release button in the lift line for max comfort and circulation as you float up to the top for another epic run... Unreal Bindings!

HOW TO SPEED/IN

Gnu

SPEED/IN

**SPEED ENTRY BINDING SYSTEM
FASTER, EASIER, SMARTER**



Lightweight,
performance and
strength in an
incredibly fast
binding system!

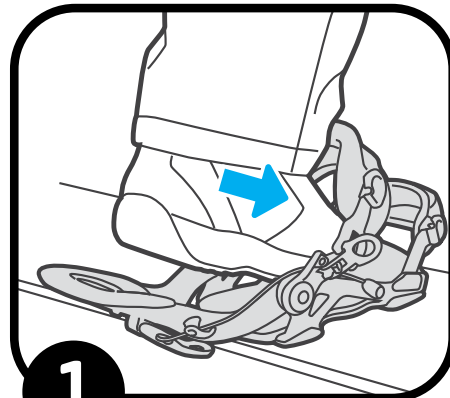

SPEED In

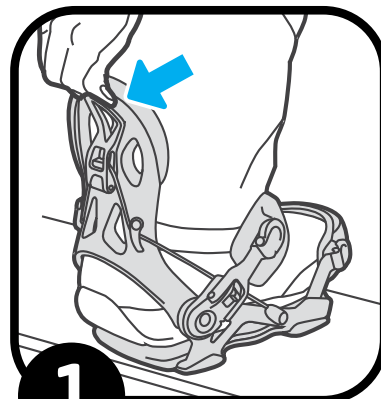
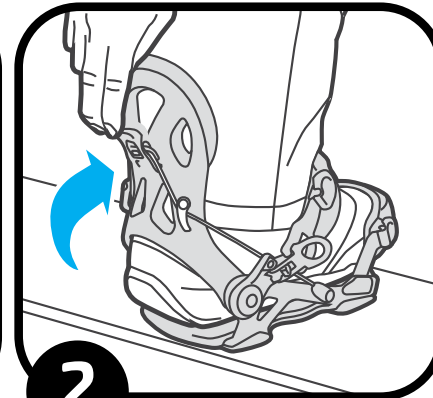

SPEED Out

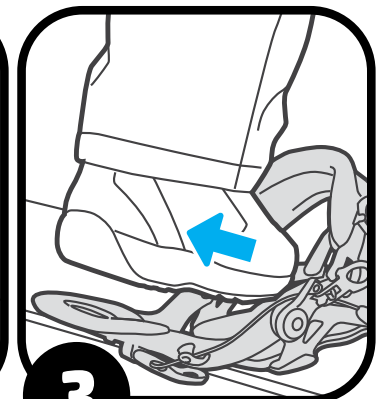
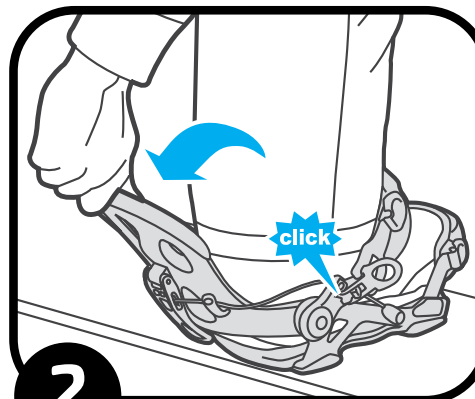



UNIQUE/KEY TECHNOLOGY

Duplex Ankle Strap

- Ultra-light.
- Flip strap to change flex response.
- Two Straps in one

Strategically cored single injection construction is made with pliable TPU creating a comfortable and lightweight strap. Flip-able design enables a soft or stiff response for rider customization. Softer flexing side has extra large coring and smaller surface area. Stiffer flexing side has reduced coring and taller surface to lean into for more response.

CORE TECHNOLOGY BENEFIT	BENEFIT - Concise	BENEFIT - Description
Reclining Highback	Rear Entry Advantage	Makes enter and exit incredibly fast and easy, with one hand.
Auto Open System	Works like Magic. Opens Auto-"Magically"	Upper strap opens auto-"magically"when highback reclines for a quick, easy and extra large entry and exit zone.
Auto Lever	Simplified Entry	Only one click to apply the right amount of pressure. No more fumbling with ratchet buckles.
Pressure Relief Button	Warm, Happy Feet	Can be pressed manually to relax ankle strap pressure on front after run while boots remains secure in binding. Increased blood flow keeps feet comfortable and warm.
Ankle Strap - Micro Buckle	Quickly Adjust Tension	Rider can adjust strap tension while on the go. Tighten a couple clicks for a big hit or loosen for different terrain. Release strap for additional exit and entry space in steep terrain.
Ankle & Toe Strap - Micro Buckle	Multi-Entry Option	Micro Buckles on both straps enable you to open and close both straps in traditional way in case you need that option.
Cable Redirection	Unimpeded Movement	Ensures maximum freedom of movement of boot. Reduces strain when closing highback.
Toe Cup Wrap Strap	Precision Fit and Response	Secures boot in place for a perfect fit each time. Wrap design provides more support and response while eliminating wedge and cinch pressure.
Highback Rotation	Custom Support	Highbacks can be rotated laterally to find the custom support angles that work for your style of riding.

CHEETER

SPEED/IN
MENS

PULL A FAST ONE AND BEAT THE CROWD

- FT4 Baseplate - Predictable Performance
- ERGO-X Highback - Smoother entry and exit
- Thin Fit Toe strap - Ultra thin and light, wraps like second skin

On top of the innovative speed entry technology, asymmetric highbacks add support to your natural riding stance for control while the FT-4 Nylon Baseplate provides a smooth ride and vibration absorption for a full riding days comfort.

RESPONSE: RELAXED / ALL AROUND / AGGRESSIVE

RIDING STYLE: ALL MOUNTAIN

S (US M 4-7), **M** (US M 7-10), **L** (US M 10-12), **XL** (US M 12-14)

Disk: 4x4, Channel. Fiber Reinforced Polymer

Colorways: Black and White

4/10
FLEX



BLACK



WHITE



PSYCH

SPEED/IN
MENS

ULTRA-LIGHT FREESTYLE MOBILITY AND QUICKNESS TO BLOW YOUR MIND

- Hyper Cored Aluminum Baseplate - Light & Responsive
- ERGO-X Highback - Smoother entry and exit
- Complex Toe Cup Strap with Micro Buckle - Oversize with soft textiles and foam
- Canting

Not only do you get in and out of your bindings faster, the ultra-light aluminum chassis and highback enable you to maneuver quicker with less fatigue. The asymmetric highback design allows mobility to get out over you board and support to ride away clean. This combo is forgiving in freestyle terrain and flows on mountain.

RESPONSE: RELAXED / ALL AROUND / AGGRESSIVE

RIDING STYLE: ALL MOUNTAIN - FREESTYLE

S (US M 5-7), **M** (US M 7-9), **L** (US M 9-11), **XL** (US M 12-14)

Disk: 4x4. Fiber Reinforced Polymer

Colorways: Black and White

6/10
FLEX



WHITE



BLACK

FREEDOM

SPEED/IN
MENS

BREAKOUT ON THE POWER AND SPEED MACHINE

- Hyper Cored Baseplate with extra footbed dampening and a heel shock pod
- Alu Heelcup reinforced highback for response and precision at speed
- Canting

Extra supportive ankle straps and responsive highback with aluminum heelcup for riding in turbo mode. The aluminum chassis is ultra-light and sensitive for precision input in advanced terrain. Heel shock pads and a chassis enveloped by an EVA pad smooth out the shocks and vibration from hard landings and firm terrain.

RESPONSE: RELAXED / ALL AROUND / AGGRESSIVE

RIDING STYLE: ALL MOUNTAIN

S (US M 5-7M), **M** (US M 7-9), **L** (US M 9-11), **XL** (US M 12-14)

Disk: 4x4, Channel. Forged Aluminum

Colorway: Black

8/10
FLEX



BLACK

B♥REAL

SPEED/IN
WOMENS

DO MORE OF WHAT YOU CAME FOR

- FT4 Baseplate - Predictable Performance
- ERGO-X Highback - Smoother entry and exit
- Thin Fit Toe strap - Ultra Thin and light, wraps like second skin.

In addition to the practical speed-entry system you will become one with your binding supported by Asymmetric Highbacks that duplicate a natural riding stance and the predictable, smooth ride of the FT-4 Nylon Baseplate.

RESPONSE:  **RELAXED** / ALL AROUND / AGGRESSIVE

RIDING STYLE: ALL MOUNTAIN

S (US W 5-7), **M** (US W 7-9), **L** (US W 9-11)

Disk: 4x4, Channel. Fiber Reinforced Polymer

Colorway: White

4/10
FLEX



WHITE

FANTAST

SPEED/IN
WOMENS

LEAVE THE CROWD BEHIND AND RIDE

- Hyper Cored Aluminum Baseplate - Light & Responsive
- ERGO-X Highback - Smoother entry and exit
- Complex Toe Cup Strap with Micro Buckle - Oversize with soft textiles and foam

An aluminum chassis provides feedback to navigate with precision while the lightweight attributes increases response and reduces fatigue. Enveloped in a supportive ankle strap with a compression window for max comfort the full EVA wrapped footbed with large heel shock pad keeps your feet happy all day long.

RESPONSE: RELAXED / ALL AROUND / AGGRESSIVE

RIDING STYLE: ALL MOUNTAIN - FREESTYLE

S (US W 5-7), **M** (US W 7-9), **L** (US W 9-11)

Disk: 4x4. Fiber Reinforced Polymer

Colorway: Black

6/10
FLEX



MENS



BLACK



WHITE

Gnu

SPEED/IN

FASTER / EASIER / SMARTER / MULTI ENTRY

24/25



WHITE

CHEETER➔



BLACK

PSYCH



BLACK

➔**FREEDOM**➔

WOMENS



WHITE

B♥REAL



BLACK

FANTAST

APPAREL

WELCOME TO GNU COUNTRY · WELCOME TO GNU COUNTRY · WELCOME TO GNU COUNTRY ·
GNU



COZY COUNTRY



24/25

APPAREL



FLOWER CAP
GREY - UNSTRUCTURED 5 PANEL
EMBROIDERED LOGO



NORDIC BEANIE
BLACK - JERSEY KNIT, FINE GAUGE
100% ACRYLIC



GWOOSH SOCK
CYAN/MAGENTA - 58% ACRYLIC /
30% NYLON / 10% POLYESTER /
2% SPANDEX
S - US 7-9, M - 9-11, L 11-13



DISCONNECT LONGSLEEVE TEE
BLACK - 100% ORGANIC COTTON
FRONT CHEST SCREEN PRINT
M / L / XL / XXL



MONEY TEE
WHITE - 100% ORGANIC COTTON
FRONT CHEST SCREEN PRINT
M / L / XL / XXL



SHRED SCIENCE TEE
BLACK - 60% RECYCLED COTTON /
40% RECYCLED POLYESTER
BACK PRINT, CHEST POCKET PRINT
M / L / XL / XXL



SCIENCE TEE
ORANGE - 50% UPCYCLED COTTON /
50% UPCYCLED PET
S / M / L / XL / XXL



WORLD PULLOVER HOODIE
LIGHT GREY HEATHER - 54% RECYCLED COTTON /
40% RECYCLED POLYESTER /
6% RECYCLED RAYON
M / L / XL / XXL



GNU SCRIPT DIE-CUT STICKER
BLACK or WHITE
8" (203mm) WIDE

GNU

EARLY 24/25 RELEASE



NEW

SOMETHING GNU ALL MOUNTAIN FREERIDE / DIRECTIONAL SHAPE

ALL MOUNTAIN



156 ww 25.3
161 ww 26.1
Waist Width*

HYBRID
C2 DIRECTIONAL
GLITE 3
CONSTRUCTION
CARBON
MAGNE-TRACTION
EDGE HOLD ADVANTAGE

NEW

C MONEY FREESTYLE / PARK / TWIN SHAPE

FREESTYLE / PARK



144 ww 24.2
148 ww 24.7
152 ww 25.3
154 ww 25.4
156 ww 25.5
159 ww 25.6

150 WIDE ww 26
154 WIDE ww 26.2
158 WIDE ww 26.6
Waist Width*

CAMBER
GLITE 1
CONSTRUCTION
MAGNE-TRACTION
EDGE HOLD ADVANTAGE

Creative vision PETE SAARI @turtleater

Art by TREVOR YARDLEY-JONES @trevoryj

HYPER ALL MOUNTAIN / DIRECTIONAL SHAPE

ALL MOUNTAIN



151 ww 24.7
154 ww 25
157 ww 25.3
160 ww 25.6

159 WIDE ww 26.7
Waist Width*

HYBRID
C2
GLITE 3
CONSTRUCTION
CARBON
MAGNE-TRACTION
EDGE HOLD ADVANTAGE

NEW

GLOSS C FREESTYLE / PARK / TWIN SHAPE

FREESTYLE / PARK



136 ww 22.6
140 ww 23.3
144 ww 23.5
148 ww 23.9
Waist Width*

CAMBER
GLITE 1
CONSTRUCTION
MAGNE-TRACTION
EDGE HOLD ADVANTAGE

Art by Vintage GNU @gnusnowboards

Art by SARA PHILLIPS @philllips

FREESTYLE / PARK

YOUNG MONEY
TWIN SHAPE



HYBRID C2
GLITE1

MAGNE-TRACTION

130 ww* 23
135 ww* 23.2
140 ww* 23.4
waist width*

Art: TREVOR YARDLEY-JONES
@trevoryj

MONEY
TWIN SHAPE



HYBRID C2
GLITE1

MAGNE-TRACTION

144 ww* 24.2
148 ww* 24.7
152 ww* 25.3
154 ww* 25.4
156 ww* 25.5
159 ww* 25.6

WIDES
150 ww* 26
154 ww* 26.2
158 ww* 26.6
waist width*

Art: TREVOR YARDLEY-JONES
@trevoryj

NEW! **C MONEY**
TWIN SHAPE



CAMBER
GLITE1

MAGNE-TRACTION

144 ww* 24.2
148 ww* 24.7
152 ww* 25.3
154 ww* 25.4
156 ww* 25.5
159 ww* 25.6

WIDES
150 ww* 26
154 ww* 26.2
158 ww* 26.6
waist width*

Art: TREVOR YARDLEY-JONES
@trevoryj

HEAD SPACE By Forest Bailey
TWIN SHAPE



CAMBER
GLITE2

MAGNE-TRACTION

146 ww* 24.7
149 ww* 25
152 ww* 25
155 ww* 25.4
158 ww* 25.5

WIDES
155 ww* 26.4
waist width*

Art: Forest Bailey
@forestbailey



FREESTYLE / ALL MOUNTAIN

RECESS
ASYM TWIN SHAPE

2
YEAR GRAPHIC



HYBRID BANANA
ASYM LEVEL 2
GLITE1

MAGNE-TRACTION

TEXTURED TOP SHEET

100 ww* 19.2
110 ww* 21
120 ww* 21.5
125 ww* 22.5
waist width*

Art: Jessa Gilbert
@jessagilbert

GWO
TWIN SHAPE



HYBRID BANANA
GLITE1

MAGNE-TRACTION

147 ww* 24.2
150 ww* 24.5
153 ww* 24.8
156 ww* 25.4
159 ww* 25.5

WIDES
156 ww* 26.7
159 ww* 26.7
162 ww* 26.7

Art: Gnu Art Dept.
@gnusnowboards

FINEST - By Max Warbington
ASYM TWIN SHAPE



HYBRID C2
ASYM LEVEL 2
GLITE2

MAGNE-TRACTION

148 ww* 24.8
151 ww* 25
154 ww* 25.1
157 ww* 25.5
159 ww* 25.7

WIDES
155 ww* 26.2
waist width*

Art: Max Warbington
@69max420

RIDERS CHOICE
ASYM TWIN SHAPE



HYBRID C2
ASYM LEVEL 2
GLITE3 CARBON

MAGNE-TRACTION

151.5 ww* 25.1
154.5 ww* 25.2
157.5 ww* 25.5
159.5 ww* 25.6
161.5 ww* 25.8

WIDES
155 ww* 26.5
158 ww* 26.8
162 ww* 26.8

waist width*
Art: Eric Kenney
@heavyslime_

RC C3
ASYM TWIN SHAPE



CAMBER
ASYM LEVEL 2
GLITE3 CARBON

MAGNE-TRACTION

154.5 ww* 25.2
157.5 ww* 25.5
159.5 ww* 25.6

WIDES
158 ww* 26.8
162 ww* 26.8

waist width*
Art: Eric Kenney
@heavyslime_

BANKED COUNTRY SPLITS
DIRECTIONAL SHAPE

By Temple & Cannon Cummins



CAMBER
PROMAG

SPLIT CONSTRUCTION

155 ww* 25.3
159 ww* 25.4
162 ww* 25.5
waist width*

Art: Gnu Art Dept.
@gnusnowboards

ALL MOUNTAIN

ANTIGRAVITY
DIRECTIONAL SHAPE



CAMBER
GLITE1

MAGNE-TRACTION

TEXTURED TOP SHEET

150 ww* 25
153 ww* 25.2
156 ww* 25.5
159 ww* 25.7
162 ww* 25.8

WIDES
159 ww* 26.7
162 ww* 26.8
waist width*

Art: Shawn Bishop
@sbishbsh

GREMLIN
DIRECTIONAL SHAPE



CAMBER
GLITE2

MAGNE-TRACTION

144 ww* 25.5
148 ww* 25.8
152 ww* 26.1
155 ww* 26.4
158 ww* 27
161 ww* 27.5

waist width*
Art: Gnu Art Dept.
@gnusnowboards

HYPER
DIRECTIONAL SHAPE

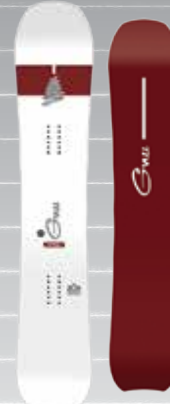

HYBRID C2
GLITE3 CARBON

MAGNE-TRACTION

151 ww* 24.7 **NEW!**
154 ww* 25
157 ww* 25.3
160 ww* 25.6

WIDES
159 ww* 26.7
waist width*

Art: Gnu Art Dept.
@gnusnowboards

4x4 By Forest Bailey
DIRECTIONAL SHAPE



CAMBER
GLITE2

MAGNE-TRACTION

157 ww* 25.5
160 ww* 25.7
waist width*

Art: Forest Bailey
@forestbailey

SOMETHING GNU **NEW!**
ALL MOUNTAIN FREERIDE/DIRECTIONAL SHAPE



HYBRID C2 DIRECTIONAL
GLITE3 CARBON

MAGNE-TRACTION

156 ww* 25.3
161 ww* 26.1
waist width*

Creative vision
@turletater

BANKED COUNTRY
DIRECTIONAL SHAPE

By Temple & Cannon Cummins



CAMBER
GLITE3 CARBON

PROMAG

155 ww* 25.3
159 ww* 25.4
162 ww* 25.5
WIDE
160 ww* 26.5
163 ww* 26.8

waist width*
Art: Cannon Cummins
@cannon_cummins

FREESTYLE / PARK

GLOSS
TWIN SHAPE



HYBRID C2
GLITE1

MAGNE-TRACTION
136 ww* 22.6
140 ww* 23.3
144 ww* 23.5
148 ww* 23.9
waist width*
Art: Sara Phillips
@sphilipps

NEW! **GLOSS C**
TWIN SHAPE



CAMBER
GLITE1

MAGNE-TRACTION
136 ww* 22.6
140 ww* 23.3
144 ww* 23.5
148 ww* 23.9
waist width*
Art: Sara Phillips
@sphilipps

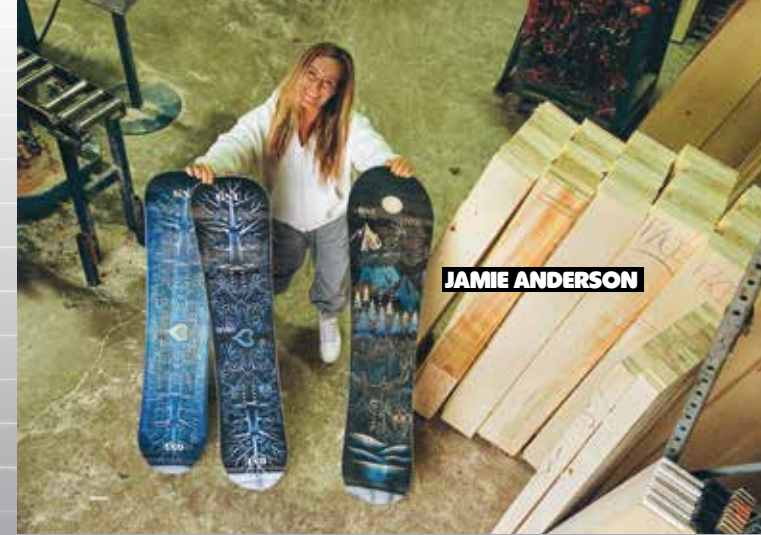

B-NICE
TWIN SHAPE



HYBRID BANANA
GLITE1

MAGNE-TRACTION
133 ww* 22.5
139 ww* 22.6
142 ww* 23.2
145 ww* 23.4
148 ww* 24
151 ww* 24.3
154 ww* 24.6
waist width*
Art: Gnu Art Dept.
@gnusnowboards

VELVET
TWIN SHAPE

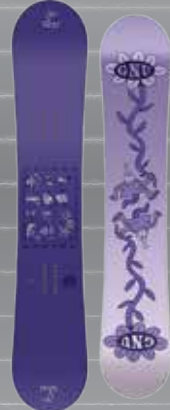

HYBRID C2
GLITE2

MAGNE-TRACTION
139 ww* 22.6
143 ww* 23.5
147 ww* 23.9
150 ww* 23.9
153 ww* 24.1
waist width*
Art: Hannah Eddy
@hannaheddyart

LADIES CHOICE By Jamie Anderson
ASYM TWIN SHAPE



HYBRID C2
ASYM Level 2
GLITE3 CARBON

MAGNE-TRACTION
139.5 ww* 22.6
142.5 ww* 23.2
145.5 ww* 24
148.5 ww* 24.2
151.5 ww* 24.4
153.5 ww* 24.4
waist width*
Art: Sarah King
@sarahkingart

PRO CHOICE By Jamie Anderson
ASYM TWIN SHAPE



CAMBER
ASYM Level 2
GLITE3 CARBON

MAGNE-TRACTION
145.5 ww* 24
148.5 ww* 24.2
151.5 ww* 24.4
waist width*
Art: Sarah King
@sarahkingart

FREESTYLE / ALL MOUNTAIN

FROSTING
DIRECTIONAL

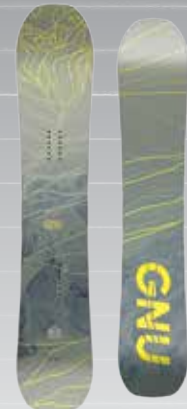

HYBRID C2
GLITE2

MAGNE-TRACTION
143 ww* 24
146 ww* 24.1
149 ww* 24.3
152 ww* 24.4
waist width*
Art: Corinne Weidmann
@corinne.weidmann

BARRETT By Barrett Christy
DIRECTIONAL SHAPE



CAMBER
GLITE3 CARBON

PRO MAG
BABC
Portion of sales benefits
146 ww* 24.1
149 ww* 24.3
152 ww* 24.5
155 ww* 24.8
waist width*
Art: Shaun Thomas
@shaunthomasart

BARRETT SPLIT By Barrett Christy
DIRECTIONAL SHAPE



CAMBER
PRO MAG
BABC

Portion of sales benefits
SPLIT CONSTRUCTION
149 ww* 24.3
152 ww* 24.5 **NEW!**
waist width*
Art: Gnu Art Dept.
@gnusnowboards

FREE SPIRIT By Jamie Anderson
DIRECTIONAL SHAPE



CAMBER
GLITE3 CARBON

MAGNE-TRACTION
148 ww* 25.5
153 ww* 25.5
waist width*
Art: Sarah King
@sarahkingart

ALL MOUNTAIN

WE'RE NOT ALL
MEANT TO BE
COWBOYS!

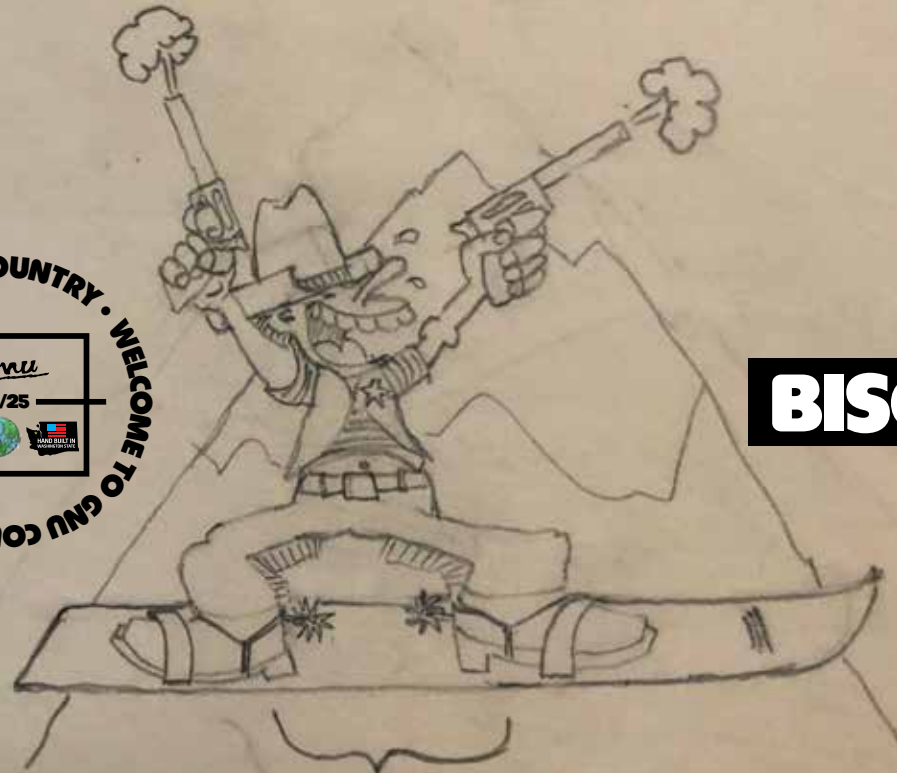

≥ 28" = Stinkbug

HEAD 2005



QUIT COWBOY

BISCUIT COWBOY

