

OPERATING INSTRUCTION

LED WALL LAMP

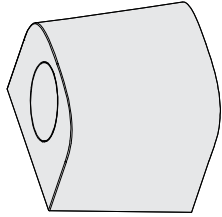

MULTI BOX

IP44



MAIN TECHNICAL DATA
 Model: SMD2935
 Light source: LED SMD2935
 Working temperature: -25°C—+50°C

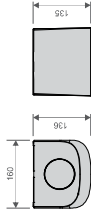

CAUTION

1. The product must be installed by professional technicians and power supply must be cut off before installation.
2. Please do not touch the lamp body or the LED chip, if there are any dirt on the lamp, please clean it with alcohol swabs or a soft cloth. Please do not touch the lamp body or the LED chip, if there are any dirt on the lamp, please clean it with alcohol swabs or a soft cloth.
3. Don't touch LED while installing or maintaining.
4. The light source of this luminaire is replaceable, and it must be operated by professional technicians when power supply is cut off in advance.

TECHNICAL INFORMATION

Code	Input Voltage	LED Type	Input Power	Lumen (lm)	With Sockets	IP
125018	110V	SMD2935	11W	400 LM / 800 LM	Yes	IP44
125019	100V	SMD2935	10W	400 LM / 800 LM	Yes	IP44

125018 is dimmable
 125019 is with photocell (dusk/dawn sensor)
 Parameter tolerance: ±10%
 CCT: 4000K

MAINTENANCE

1. Cut off the main power first.
2. Don't use chemical reagent to clean lamp.

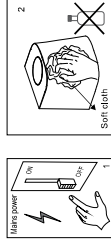

2

UP LIGHT AND COLOUR TEMPERATURE SETTING



- Up light and down light ON.
- Only down light ON.

DESCRIPTION OF PHOTOCELL FUNCTION

- Automatically turn on lights at dusk and off at dawn.
- Adjustable switching On/Off ambient light level.



Setting

By selecting the combination of the DIP switches, switching ON/OFF lux level can be set as requirement.

1	2	3	4	5	6	7	8	9	10
ON	ON	ON	ON	OFF	OFF	OFF	OFF	OFF	OFF
ON	ON	ON	ON	ON	ON	ON	ON	ON	ON
ON	ON	ON	ON	ON	ON	ON	ON	ON	ON
ON	ON	ON	ON	ON	ON	ON	ON	ON	ON
ON	ON	ON	ON	ON	ON	ON	ON	ON	ON
ON	ON	ON	ON	ON	ON	ON	ON	ON	ON
ON	ON	ON	ON	ON	ON	ON	ON	ON	ON
ON	ON	ON	ON	ON	ON	ON	ON	ON	ON
ON	ON	ON	ON	ON	ON	ON	ON	ON	ON

When ambient light level is below 'ON' lux level, sensor automatically switches on lights.
 When ambient light level is over 'OFF' lux level, it switches off lights.

MOUNTING

1. Remove the shell of product.
2. Pull in the power cord through the gasket.
3. Mount the base to the wall with screws.
4. Connect the power cord on the terminal correctly.
5. Check the waterproof strip is intact then assemble the shell of product.

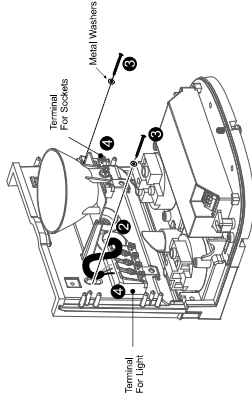
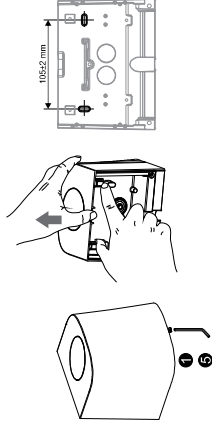

3

CABLE CONNECTION

PHOTOCELL VERSION

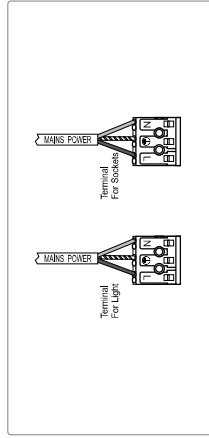

TRIAC VERSION

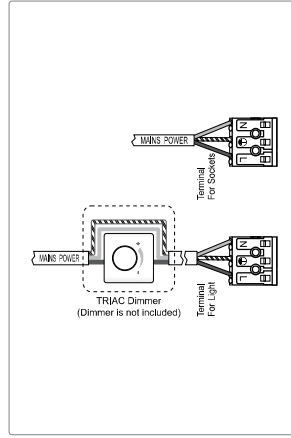

1. Remove the shell of product.

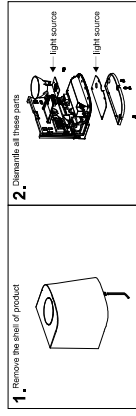

3. Disconnect the control gear.

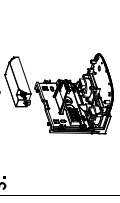

4. The control gear and the light source.

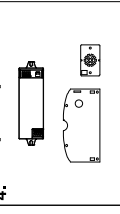

Replaceable (LED only) light source by a professional

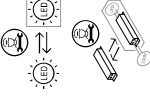

Replaceable control gear by a professional

This product contains a light source of energy efficiency class **D**. Please note, the control gear in this product is not intended to operate in no-load mode.

Environmental protection: Waste electrical products should not be disposed of with household waste. Please recycle where facilities exist. Check with your local authority or retailer for recycling advice.

5