

PLEASE CHECK WITH REMOTE RECEIVER LIST AND REMOTE CONTROLLER LIST

REMOTE RECEIVER LIST

ITEMS	TECHNICAL DATA
PA-GE1-015ROP	Electronic switch for adaptor: - With Single Schuko DIN 49440-1 Socket; 16A,250V~; - With plug DIN 49441-R1, 16A 250V~; - With Dimmer Max 300W~ - With RF receiver ASK 433.92MHz; - With shutter; - IP44 Ambient temperature: 0-35°C IP Class: IP44, pollution degree 4 Protection class: for class I or II appliance Operation cycles: 1E4 Circuit disconnection: Micro Insulation material: PT1175 and Glow wire level 750°C

REMOTE CONTROLLER LIST

ITEMS	TECHNICAL DATA
SD-UND-RF1	Transmitter Battery 3V CR2032; Frequency: 433.92 MHz +/- 150KHz Transmission Range: approx. 30M at open area; Transient power: 10dBm 4 groups control + one group all ON/all OFF.

FEATURES

No wiring, easy operation, just plug and use.
67 million codes, self program function.
Receiver has 5 memory settings, no memory loss forever.
Green LED indicator for POWER ON and PROGRAMMING SETTINGS.

INSTALLATION

Controller (Receiver):
Just plug-in receiver into wall outlet, indicator on receiver should light on.
Connect lamp plug [fig 1] into receiver

Remote Control (Transmitter):
Remote control up to 30meters in open area [fig. 2]

OPERATION TRANSMITTER

ON button – control receiver ON
ON button – control Dimmer
OFF button – switches OFF all function
GROUP button – ALL ON or ALL OFF at the same time

OPERATION ON/OFF RECEIVER

Press transmitter button ON to switch on.
Press transmitter button ON again to Dimmer.(circle dimmer by press ON)
Press transmitter button OFF to switch off.

Figure 1

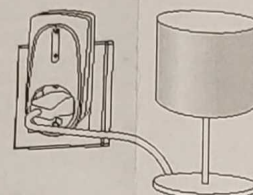
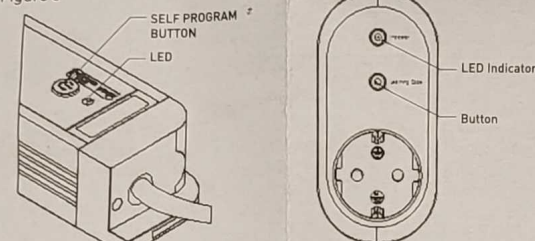

Figure 3



HOW TO LINK A CODE

To start program your transmitter with the receiver
Receiver plugged on power (fig. 1).
Bring the transmitter near the receiver, push the self program button on receiver once (fig. 2).
Receiver LED will blink slowly, press transmitter selected ON button.
Receiver connected lamp will blink twice, code is confirmed and LED stops blinking.

RECEIVER HAS 5 MEMORY SETTINGS

Self program function receiver has 5 memory settings.
It can be programmed as to your requirement for scene setting. It can be programmed to switch on at one time individually or programmed with different combinations switching at same time.
This means one receiver can be programmed into max. 5 different combination to the transmitter button.

It is not suggested to program ON/OFF receivers and dimmer receivers to the same control button on the transmitter or more than 1 dimmer receiver to the same control button.

TO CHANGE OR DELETE CODE

Individual delete:
Push the self button once, LED will blink slowly (fig. 2).
Press selected OFF button on transmitter, programmed memory is deleted.
Receiver connected lamp will blink twice for confirmation.
Repeat step for re-setting.

ALL MEMORY DELETE:

Push the self program button till LED blinks continuously.
Release and push once again.
Receiver connected lamp will blink twice for confirmation
ALL PROGRAMMED MEMORY WILL BE DELETED FROM RECEIVER.

FAULT FINDING

No activation:
Check battery polarity or running out of battery of the remote control
Check code program successful

Figure 2

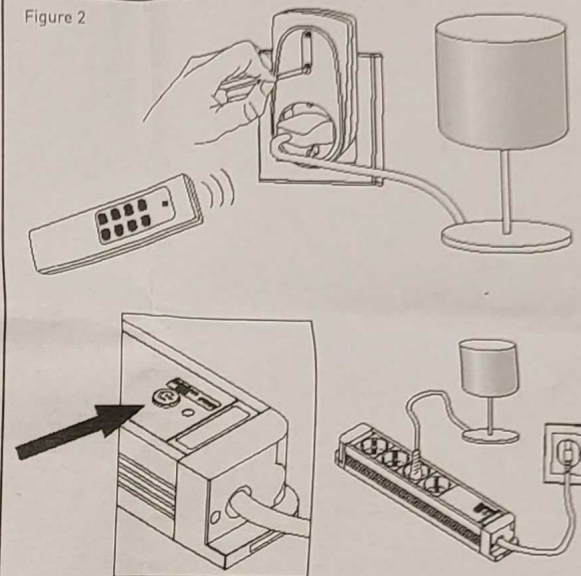

CAUTION

Do not place two receivers near each others.
The distance should be above 1meter.

WARNING!

Do not overload.
Do not use in damp places like patios and cellars or near flammable liquids such as solvents or paints.



DISPOSING OF THE PACKAGE

The package consists of cardboard and respectively labelled plastics that can be recycled. Provide these materials for recycling



DISPOSAL OF THE PRODUCT (WEEE DIRECTIVE 2012/19/EU)

This electrical appliance cannot be disposed of with domestic waste. Consumers are obligated to hand over electrical appliances to the manufacturer, the point of sale or a public collection point set up free of charge, based on resource conservation and environmental protection. Before the device is discharged, installed batteries or accumulators must be removed and disposed of separately.