



**HetTuinstel.nl**  
Quality products

# **Installatie-handleiding**

Pergola's (Vierkant / Rechthoek)

## 1.A. Fixing to a foundation element

**Visual reference:** Base Plate A for fixing to a foundation element.

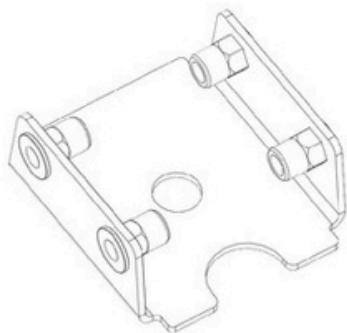

**A.1** Fix the supplied threaded rod (M16) to the concrete footing. Screw the first nut along the threaded rod.

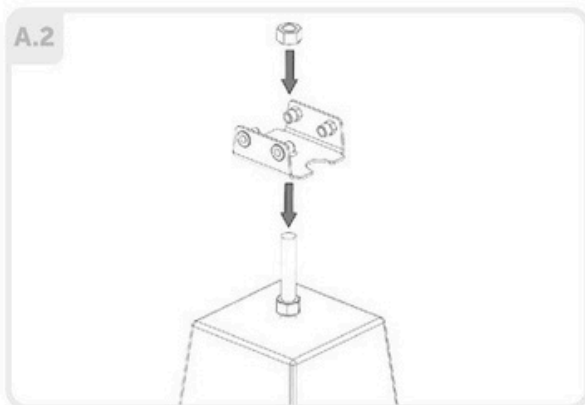

**A.2** Place the base plate along the threaded rod on top of the nut. Use this nut to adjust the height as needed. Secure the base plate by tightly screwing a second nut on top of it.

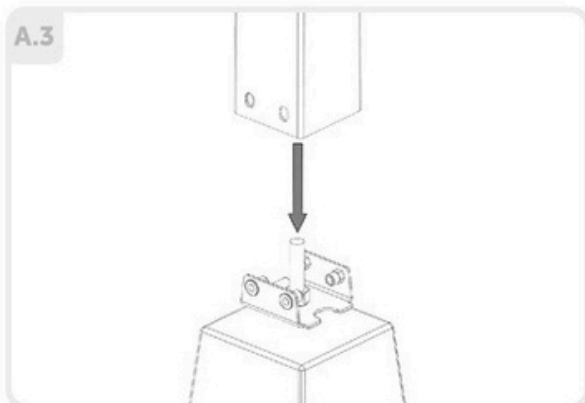

**A.3** Slide the support over the base plate; ensure the screw holes on both parts face the same direction.

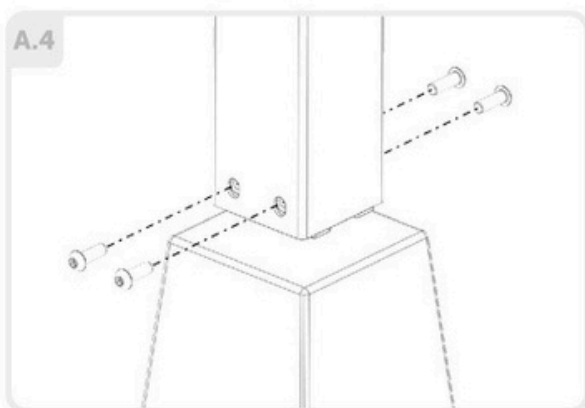

**A.4** Use the supplied bolts to fix the support to the base plate.

## 1.B. Fixing at ground level

**Visual reference:** Base Plate B for fixing at ground level.

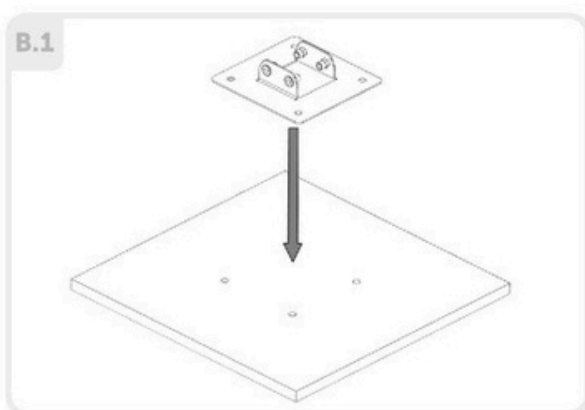
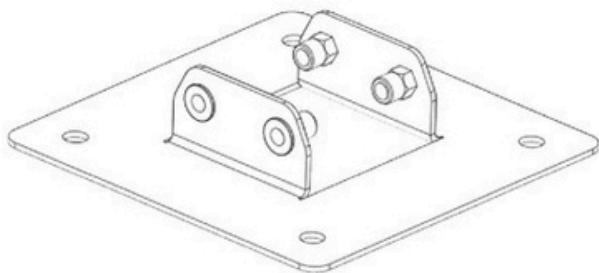

- B.1** Place Base Plate B on a flat and stable surface, such as a concrete tile.  
Prepare the surface by drilling holes according to the holes of the base plate (hole diameter = 12mm).

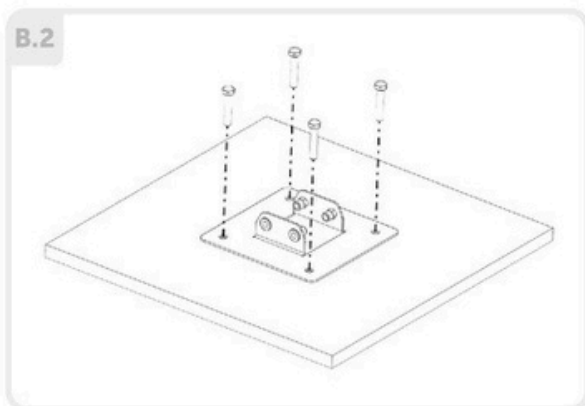

- B.2** Secure the base plate to the surface using screws or bolts.

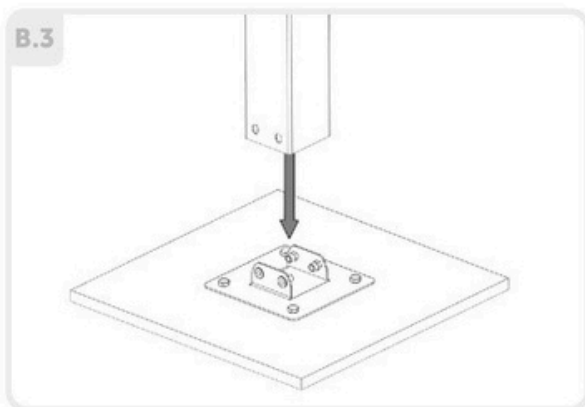

**B.3** Slide the support over the base plate; ensure the screw holes on both parts face the same direction.

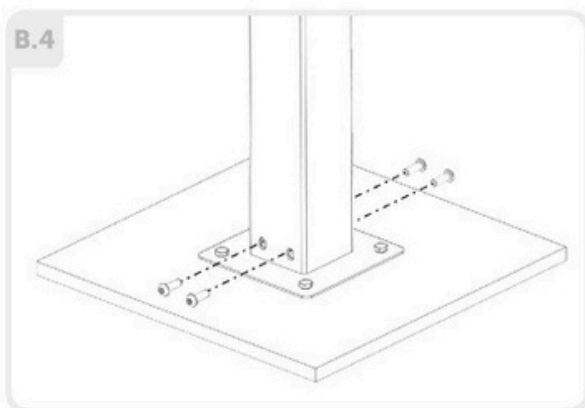

**B.4** Fix the support to the base plate using the supplied bolts.

## 2. Preparing the girder

2.1



**2.1** Insert the corner piece into the girder. Make sure the screw holes line up.

2.2

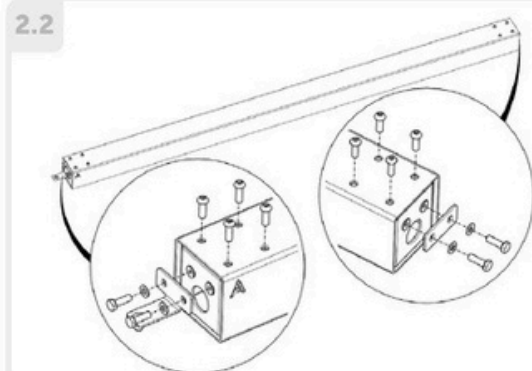

**2.2** Fix the corner pieces to the girder. Then attach the locking plates to the corner pieces. It is recommended to place a locking plate with lip on one side of the girder, and a locking plate without lip on the other side.

2.3

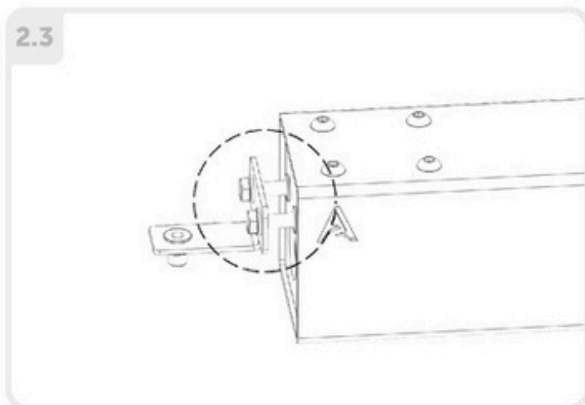

**2.3** **Note!** Leave a small gap between the locking plates and the corner pieces. This space is needed to place the girder onto the supports.

### 3. Placing the girder on the support

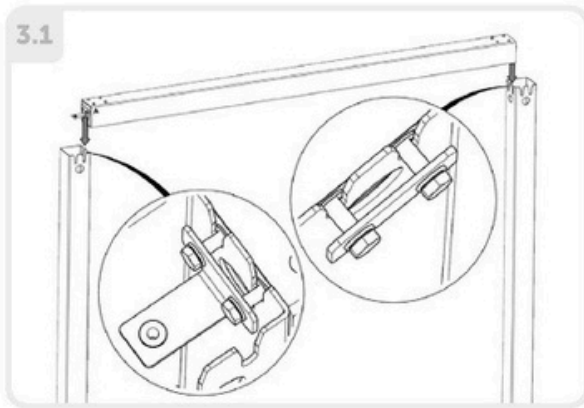

- 3.1** Place the girder onto the supports. Make sure the lip of each support fits between the locking plate and corner piece of the girder. The bolts on the girder should slide fully into the slots on the support.

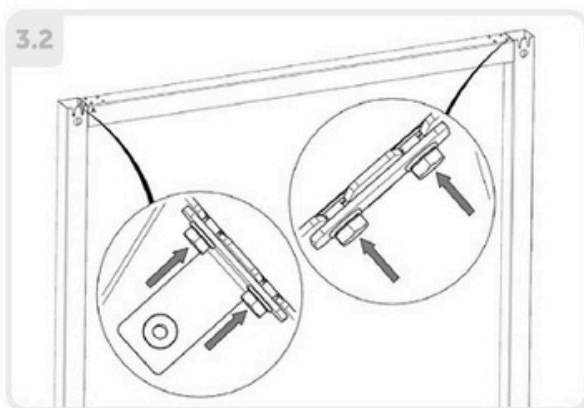

- 3.2** Tighten all bolts so the girder is securely locked to the supports.



- 3.3** Repeat these steps for the remaining girders and supports.

**Note!** Make sure each support has one locking plate with lip.

3.4

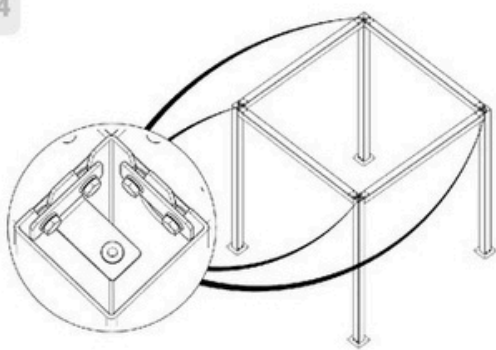

**3.4** **Note!** Make sure each support has one locking plate with lip.

3.5

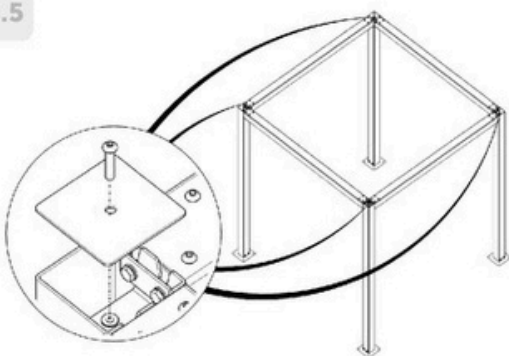

**3.5** Place the cover plates over the supports and fix them to the locking plates.



## 4. Installing the attachment eye

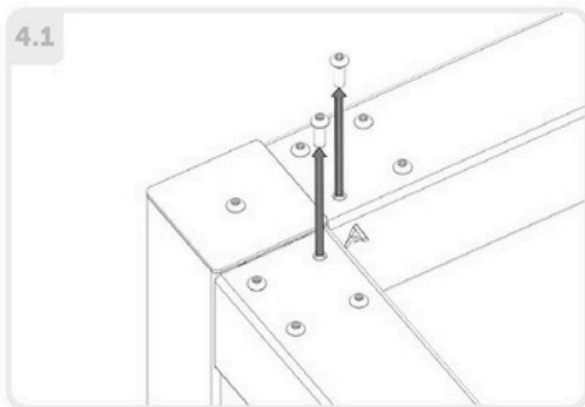

**4.1** **Note!** Only install the attachment eye after the pergola has been fully assembled. Do not install it during assembly.

Remove the two bolts from the inner corner of the girder.

## 5. Extras

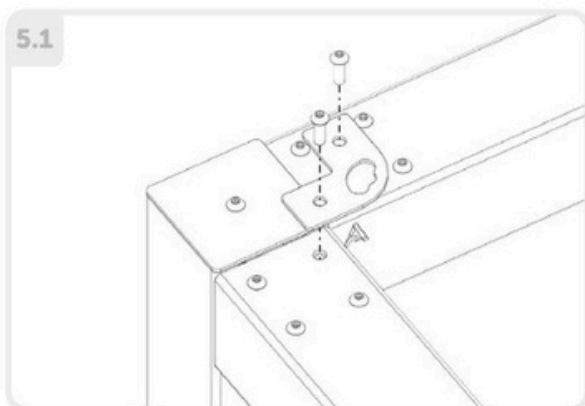

**5.1** Mounting eye for shade cloth.

Place the attachment eye and fix it by putting the two bolts back in place.