

specifications

RF7.UBR.2.D6

ReFlex Series, 6 Drawer, Underbench Fridge

Project: _____

Item No: _____

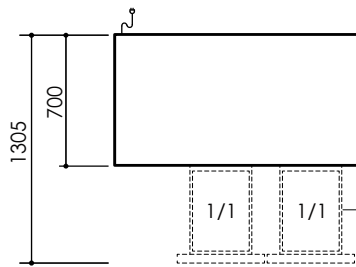

Fully extendable drawers suitable for 100mm deep gastronorm pans. The pan top lip maximum height should be no more than 5mm.

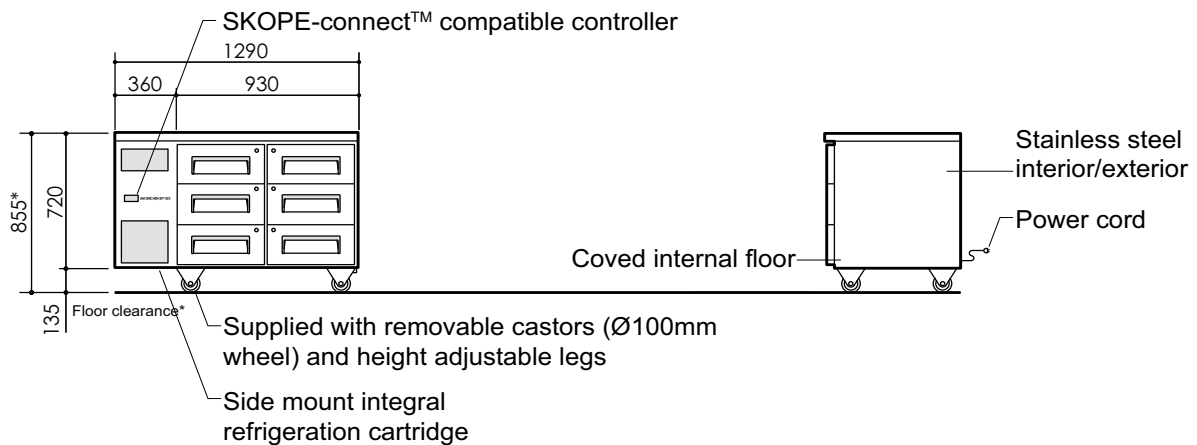

CABINET

| | |
|----------|---|
| Drawers | 6 × fully extendable, refrigerated, stainless steel drawers with individual key locks. 2-banks of full drawers including stainless steel sheet base and sides. Fits GN1/1, 100mm deep pan as an insert (supplied separately). The pan top lip maximum height should be no more than 5mm. |
| Worktop | Total thickness 45mm (0.7mm 304 AISI stainless steel over insulating cyclopentane foamed core) |
| Material | 304 AISI stainless steel interior and exterior |

PERFORMANCE

| | |
|--------------------------|---|
| Max. ambient temp. | 40°C |
| Temperature range | 1°C to 4°C (adjustable with SKOPE-connect -2°C to 10°C) |
| GEMS class | 4M1 |
| GEMS energy consumption | 2.37 kWh/24h |
| GEMS annual running cost | \$260 p.a. (@ \$0.30/kWh) |

ELECTRICAL

| | |
|---------------------------------|---|
| Electrical safety climate class | 5 |
| Interior lighting | n.a. |
| Power cord | Supplied with 2.6m, 10 Amp plug and lead |
| Power supply | 220-240 Volts a.c. 50 Hz, single phase supply |
| Current draw | 2.0 Amps (includes unit 1.5 Amps) |

REFRIGERATION

| | |
|---------------------------|---|
| Controller | SCS Connect (SKOPE-connect™ compatible) |
| Connectivity interface | Bluetooth® wireless technology |
| Refrigeration system | Side mounted, integral, removable refrigeration cartridge (part number ULKCNI-0040) |
| Refrigerant | R290 / 80g (natural refrigerant) |
| Nominal capacity | 450 Watts |
| Heat rejection (Avg/peak) | 100 Watts/105 Watts |
| Drainage | No plumbing required |

DIMENSIONS

| | External | Internal |
|--------------|-------------------|----------|
| Height | 855mm* | 570mm |
| Width | 1290mm | 820mm |
| Depth | 700mm | 530mm |
| Floor area | 0.9m ² | |
| Weight | 142kg | |
| Gross volume | 248L | |
| Net volume | 90L | |

* With supplied castors fitted. See height variation below

Height variation

| | |
|---------------------------------|---------------|
| Supplied castors | 855mm |
| Supplied height adjustable legs | 865mm - 905mm |
| No castors or legs | 720mm |

Dimensional tolerances

Before installing this cabinet allow the following dimensional tolerances:

| Linear dimensions | Overall cabinet dimensions | |
|-------------------|-----------------------------|------------------|
| Less than 1 metre | ±5mm | |
| More than 1 metre | -5mm to +10mm | |
| | Length of multiple cabinets | |
| | At each joint | At each end wall |
| Less than 1 metre | ±5mm | +15mm |
| More than 1 metre | -5mm to +10mm | +15mm |

Ventilation requirements

| | |
|--------|--------------|
| Top | Not required |
| Sides | Not required |
| Back | Not required |
| Bottom | Not required |

SKOPE Industries Limited reserve the right to alter specifications without notice. Copyright © 2020

PSS0671 Rev. 2.2 May 2021

SKOPE INDUSTRIES LIMITED

Australian Freephone: 1800 121 535, New Zealand Freephone: 0800 947 5673
Email: skope@skope.com, Website: www.skope.com

