

AUTEL®

Email: sales@autel.com

Web: www.autel.com

www.maxitpms.com

PROGRAMMABLE UNIVERSAL TPMS SENSOR MX-SENSOR

433MHz/315MHz Metal Valve
(Screw-in)



Take 433MHz sensor as an example in this manual.

⚠ CAUTION: Do Not race with the vehicle on which the Clamp-in MX-Sensor is mounted, and always keep the drive speed under 240 km/h.

WARRANTY

AUTEL guarantees that the sensor is free from material and manufacturing defects for a period of twenty-four (24) months or for 24,000 miles, whichever comes first. AUTEL will at its discretion replace any merchandise during the warranty period. The warranty shall be void if any of the following occurs:

1. Improper installation of products
2. Improper usage
3. Induction of defect by other products
4. Mishandling of products
5. Incorrect application
6. Damage due to collision or tire failure
7. Damage due to racing or competition
8. Exceeding specific limits of the product

SAFETY INSTRUCTIONS

⚠ Before installing the sensor, read the installation and safety instructions carefully. For reasons of safety and for optimal operation, we recommend that any maintenance and repair work be carried out by trained experts only, in accordance with the guidelines of the vehicle manufacturer. The valves are safety-relevant parts which are intended for professional installation only. Failure to do so may result in the failure of the TPMS sensor. AUTEL does not assume any liability in case of faulty or incorrect installation of the product.

CAUTION

- The TPMS sensor assemblies are replacement or maintenance parts for vehicles with factory installed TPMS.
- Make sure to program the sensors by AUTEL sensor programming tools by the specific vehicle make, model and year before installation.
- Do not install programmed TPMS sensors in damaged wheels.
- In order to guarantee optimal function, the sensors may only be installed with original valves and accessories provided by AUTEL.
- Upon completing the installation, test the vehicle's TPMS following the procedures described in the original manufacturer's user guide to confirm proper installation.

EXPLODED VIEW OF SENSOR

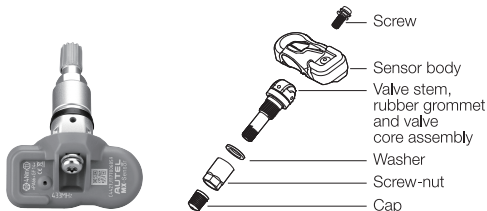

Technical data of the sensor

Weight of sensor without valve	18.5 g
Dimensions	approx. 55.1*29.4*21.8 mm
Max. pressure range	800 kPa

⚠ CAUTION: Each time a tire is serviced or dismantled, or if the sensor is removed or replaced, it is mandatory to replace the rubber grommet, washer, nut and valve core with our parts to ensure proper sealing. It is mandatory to replace the sensor if it is externally damaged. Correct sensor nut torque: 4 Newton-meters

INSTALLATION GUIDE

- ▲ IMPORTANT:** Before operating or maintaining this unit, please read these instructions carefully and pay extra attention to the safety warnings and precautions. Use this unit correctly and with care. Failure to do so may cause damage and/or personal injury and will void the warranty.

1 Loosening the tire

Remove the valve cap and core and deflate the tire.
Use the bead loosener to unseat the tire bead.

▲ CAUTION: The bead loosener must be facing the valve.

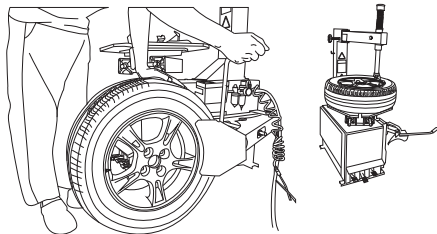

3 Dismounting the sensor

Remove the fastening screw and the sensor from the valve stem with a screwdriver, and then loosen the nut to remove the valve.

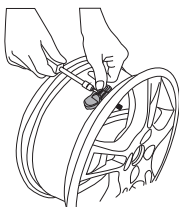

4 Mounting sensor and valve

Slide the valve stem through the valve hole of the rim. Tighten the screw-nut with 4,0 Nm with the help of the positioning pin. Assemble the sensor and the valve stem together by screw. Hold the sensor body against the rim and tighten the screw.

Step 1

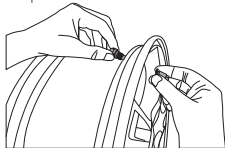

Step 2

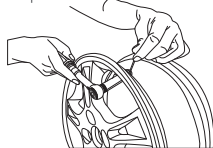

2 Dismounting the tire

Clamp the tire onto the tire changer, and adjust the valve at 1 o'clock relative to the tire separation head. Insert the tire tool and lift the tire bead onto the mounting head to dismount the bead.

▲ CAUTION: This starting position must be observed during the whole dismounting process.

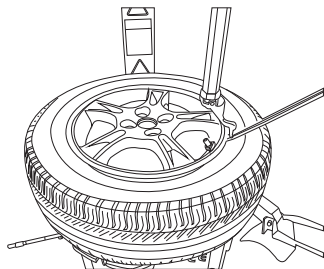

Step 3

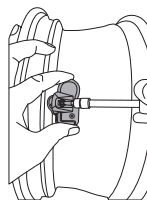

Step 4

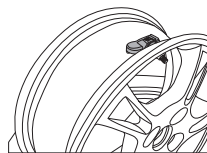

5 Mounting the tire

Place the tire on the rim, make sure that the valve faces the separation head at an angle of 180°. Mount the tire over the rim.

▲ CAUTION: The tire should be mounted to the wheel using tire changer manufacturer's instructions.

