

**AUTOOL**<sup>®</sup>

**AUTOOL SPT101**  
Spark Plug Tester  
User Manual

**AUTOOL**<sup>®</sup>

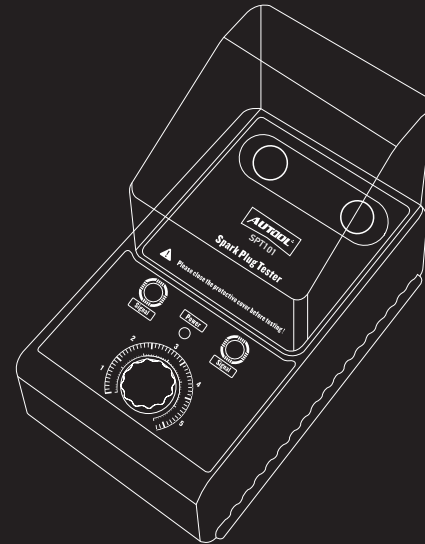

**深圳市偶然科技有限公司**

深圳市光明新区长春南路中鹏程工业园

📍 Shenhua Innovation Park, Baoan, Shenzhen, China

🌐 [www.autooltech.com](http://www.autooltech.com)

✉ [aftersale@autooltech.com](mailto:aftersale@autooltech.com)

☎ +86-400 032 0988 / +86-755-27807580

FC CE RoHS  
Made in China



[www.autooltech.com](http://www.autooltech.com)

## Trademark

AUTOOL Technology Co, Ltd. has registered its trademarks in different countries, the trademark is **AUTOOL®**. With regard to the other trademark, service logo, domain, icon and company name mentioned in this manual, they shall all belong to AUTOOL and its other affiliated company, in other countries without the registration yet of these trademark, service logo, domain name, icon and company name of AUTOOL, here we announce they are owned by AUTOOL. Any company or person shall not use the trademark, service logo, domain name, icon and company name of AUTOOL before getting approved by AUTOOL with written certificates. Please visit our website [www.autooltech.com](http://www.autooltech.com) or email at [aftersale@autooltech.com](mailto:aftersale@autooltech.com) to contact us.

## Caution

Up to 1000V voltage will be generated during test, Please close the protective cover before testing!

## Car Spark Plug Test Principle

In automobile ignition system, the high-voltage ignition coil generates a high-voltage, and the spark plug diverts it form high -tension ignition coil into the cylinder engine, spark between the spark plug electrodes will ignite the mixture, The Detector could tell the good spark plugs from the bad by the strength of the spark.

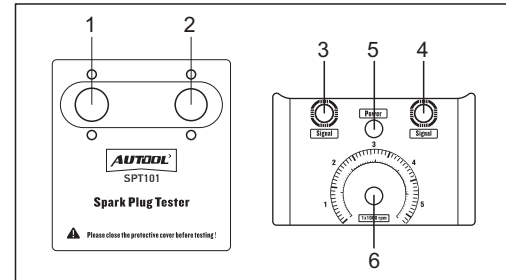

Fig.01

1-Spark Plug Socket; 2-Spark Plug Socket; 3- HV ( High Voltage Indicator ); 4-HV ( High Voltage Indicator ); 5-Power Indicator; 6- Switch;

## Instruction

- Place the Spark Plug into tester socket 1 or 2.
- Close up the protective cover , then plug in the adaptor to the side socket , connect the tester to power supply.
- Turn the switch 6 clockwise to power on tester, indicator 5 will light up green.
- Continue to turn the switch 6 clockwise, you can adjust the working frequency between 1000rpm to 6000rpm/min, The higher the frequency is set, the stronger the spark strength is.

## **Instruction**

- Unit Size: 145\*110\*85 mm (5.7\*4.4\*3.4 inch);
- Unit Weight: 354 g ( 0.8 lb ) ( Not including Power Adapter);
- Power Adapter : input 100-240V AC ; output 12V 1A DC;

## **Include**

Spark Plug Tester : x1; Power Adapter : x1; User Manual : x1;

## **Warranty Service**

There are 3 years' warranty for AUTOOL product main unit and 1 year warranty for the accessories since the day the customers have received the product parcel.

## **Warranty Access**

- Repair or replace the equipment will be done according to the specific fault conditions;
- We guarantee that all replacement parts, accessories or equipment are brand new;
- When there is a product breakdown that can not be solved within 90 days, customer should provide video and pictures as proof, we will bear the freight cost and provide customer the accessories in need to replace. After receiving the product for more than 90 days, the customer shall bear the freight cost, we will provide the accessory for free to replace.

## **Warranty Access**

- Product is bought through non-official AUTOOL purchase channel.
- Product failure is caused by incorrect use of the product, use for other wrong purpose or human factors.

Disclaimer: The AUTOOL Technology Co, Ltd. reserves the right to change product designs and specifications without prior notice. The physical appearance and color may differ from those shown in the instruction manual. Please refer to the actual product. If you have any question, please contact the dealer or the Autool service center. The company have the final explanation right of product and shall not bear any consequences due to misunderstanding.