

Vgate iCar Pro BT3.0



Quick Start Guide
Android

How do I know whether my vehicle is OBDII compliant?

1996 or newer model year vehicle sold in the United States. United States legislation requires all cars and light trucks model year (MY) 1996 and newer to be OBD2 compliant.

2001 or newer model year gasoline vehicle sold in the European Union. 2004 or newer model year diesel vehicle sold in the European Union

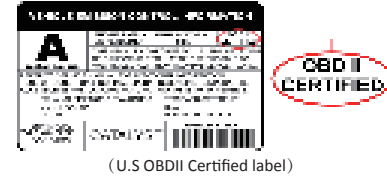

What OBDII Protocols does iCar Pro BT3.0 support?

- √ SAE J1850 PWM
- √ ISO 14230-4 KWP
- √ SAE J1850 VPW
- √ ISO 15765-4 CAN
- √ ISO 9141-2

What is the best OBDII app works great with iCar Pro BT3.0?

We recommend OBD AUTO DOCTOR app. iCar Pro series are well tested with this app. Scan below QR Code to get the free version(in-app upgrade to Pro)

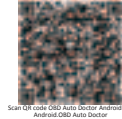

1. Download OBD II app and install <Android>

- √ Torque Lite < Most popular. Lite version is free>
- √ OBD Auto Doctor < Excellent Free app, Upgrade to Pro in-app >
- √ OBD Fusion < Excellent 3rd party app >



2. Plug iCar Pro BT3.0 adapter to DLC (OBDII Diagnostic Link Connector)

The OBDII DLC is usually located under instrument panel (Dash) on the driver side.

If you want to know more about DLC, Please visit : [https://en.wikipedia.org/wiki/Data_link_connector_\(automotive\)](https://en.wikipedia.org/wiki/Data_link_connector_(automotive))

3. Turn vehicle ignition to Key On, Engine Off position

LED indicator status

- √ RED : Power indicator. Light will on
- √ GREEN : OBD indicator . Blink once
- √ BLUE: Bluetooth indicator . Blink once

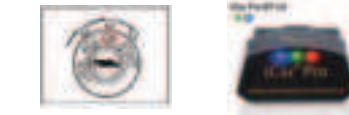

Automatically OBD device wake up and Super Power Saving on iCar Pro series

- √ Allow the user to leave the iCar Pro in OBD Socket without unplug and plug operation . Super low power consumption < sleep mode > is low to "2.7ma" level.
- √ Automatically wake up function to power on iCar Pro every time when you are start with key on engine off (KOE0) position. The device wake up speed is fast to "ms" level . Allow user to start the diagnostic operation more quickly.

Troubleshooting note:

- ◆ No LED lighting?
- √ Please check blown fuses on the vehicle
- √ The adapter is improperly installed. Please remove it from DLC port and plug it again.

4. How to pair iCar Pro BT3.0 to your device (use OBD Auto Doctor)

- Step 1:
- √ Enable Bluetooth on your Android Phone or Pad.

- √ Turn on Bluetooth, Enable visibility
- √ Select Bluetooth device as " V-LINK" to pair. Enter password "1234"
- √ Get Paired

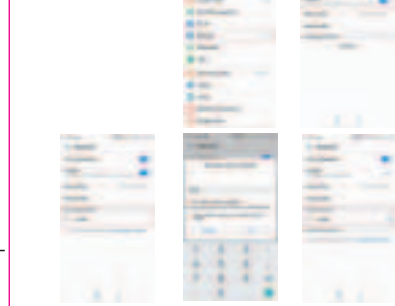

Step 2: Configure connectivity setting on the OBD Auto Doctor

- √ Run OBD Auto Doctor app
- √ Tap Extras button on status page
- √ Tap Connectivity in the setting menu to select connection type
- √ Select adapter type to Bluetooth. Device name showing "V-LINK"
- √ Back to Status page, click to start connect
- √ Initial adapter and connecting to vehicle . Bluetooth indicator LED (BLUE) and OBD data indicator (GREEN) keep blinking while system connecting. It will take about 30 seconds to connect
- √ Connected. All LED indicators lights on while sync data from vehicle

Troubleshooting note:

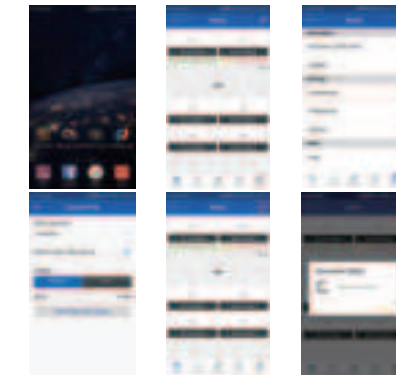

4. What parameters and sensors does iCar Pro BT3.0 support?

iCar Pro BT3.0 supports the standard OBDII parameters (PIDs) as defined in SAE J1979 AUG2014(OBD AUTO DOCTOR app) .The actual list of available parameters is vehicle specific. Your vehicle must have those sensors to work with app. Different OBDII app might support different list of parameters and sensors. Please refer to : <https://www.obdautodoctor.com/obd-parameters>

Supported Parameters (NOT FULL LIST):

PID	Sensors
\$01	Monitor status since DTCs Cleared
\$02	DTC that caused required freeze frame data storage
\$03	Fuel system status
\$04	Calculated load value
\$05	Engine coolant temperature
\$06, \$08	Short term fuel trim
\$7, \$9	Long term fuel trim
\$10	Air flow rate from mass air flow sensor
\$11	Absolute throttle position
.....	
\$0A	Fuel pressure
\$0B	Intake manifold absolute pressure
\$0C	Engine RPM
\$0D	Vehicle speed sensor
\$0E	Ignition timing advance for #1 Cylinder
\$0F	Intake air temperature

5. How to read and understand OBD Codes ?

P0123

Throttle Position Sensor/Switch A Circuit High Input

P- Powertrain (Engine & Transmission/Gearbox)

0- Generic OBD Code

1- Fuel & Air metering

2 & 3 -- Fault description: Throttle Position Sensor (TPS) / Switch A Circuit High Input

(When the PCM sees a voltage that is higher than the normal upper limit, P0123 will set) . User can internet the OBD Code meaning and know the possible causes)

More description please visit here : <https://www.obd-codes.com/p0123>



Need Help?

Please email to us anytime: info@obd2solution.cn
We will take response within 12 hours.

Thank you for your purchase!

If you like Vgate iCar Pro BT3.0 , please post your review on.

Product Upgrade:

Website: <http://www.vgatemail.com/downloadcenter>
To upgrade the product, please download the upgrade package and user manual of the corresponding model.



FCC Warning:

Any Changes or modifications not expressly approved by the party responsible for compliance could void the user's authority to operate the equipment.

This device complies with part 15 of the FCC Rules. Operation is subject to the following two conditions:

- (1) This device may not cause harmful interference, and
- (2) this device must accept any interference received, including interference that may cause undesired operation.

Note: This equipment has been tested and found to comply with the limits for a Class B digital device, pursuant to part 15 of the FCC Rules. These limits are designed to provide reasonable protection against harmful interference in a residential installation. This equipment generates uses and can radiate radio frequency energy and, if not installed and used in accordance with the instructions, may cause harmful interference to radio communications. However, there is no guarantee that interference will not occur in a particular installation. If this equipment does cause harmful interference to radio or television reception, which can be determined by turning the equipment off and on, the user is encouraged to try to correct the interference by one or more of the following measures:

- Reorient or relocate the receiving antenna.
 - Increase the separation between the equipment and receiver.
 - Connect the equipment into an outlet on a circuit different from that to which the receiver is connected.
 - Consult the dealer or an experienced radio/TV technician for help.
- This transmitter must not be co-located or operating in conjunction with any other antenna or transmitter.
- This equipment complies with FCC radiation exposure limits set forth for an uncontrolled environment. This equipment should be installed and operated with minimum distance 20cm between the radiator & your body.