

Ultrasonic cleaner, Manual

SA-4670



Leuchtturm



Coins



Watches



Spectacles



Jewelry

Specifications

Dimensions: 165 x 232 x 126 mm.

Tank internal dimensions: 152 x 92 x 52 mm.

Contents: 600 ml

Voltage: 220 V

Ultrasonic power: 35 W

Frequency: 43 Khz

Time: 90 sec - 6 min.

Index

1. Specifications
2. Index
3. Function and parts
Tips and warnings
4. User Manual
Cleaning
5. Time setting
Cleaning

Function and parts

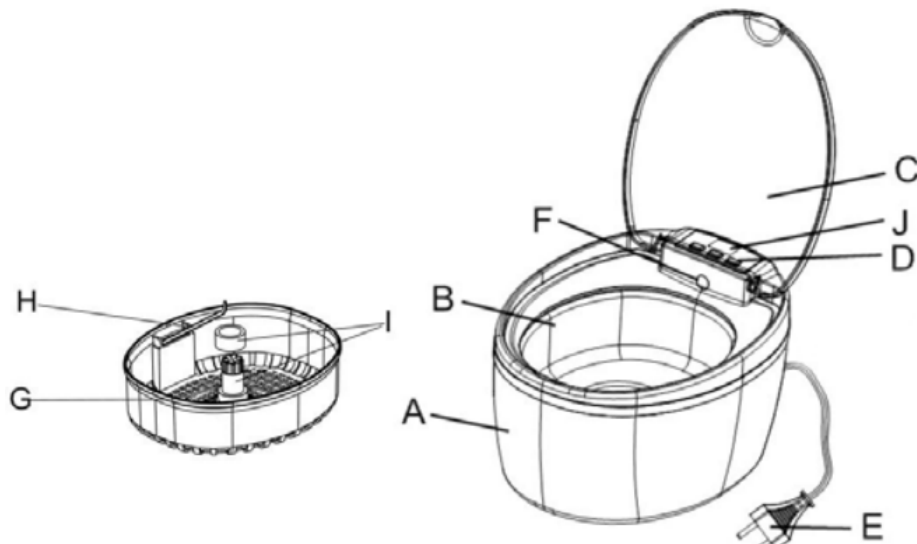

- A. Housing
- B. Cleaning container
- C. Lid
- D. On/Off
- E. Power supply plug 220v
- F. Lighting
- G. Cleaning container
- H. Holder for smaller items
- I. Holder for 1 or 2 CD/DVD, with separation ring
- J. LED display

Tips and warnings

- Under no circumstances should the appliance be used if damage has occurred, for example to the plug or cord.
- Not suitable for children under 18 years of age.
- Do not leave the ultrasonic cleaner in water; do not touch the plug with wet hands. Keep the device away from heat sources. Use the device only in a dry place.
- Plug in only when the appliance is full.
- Do not fill with corrosive or aggressive liquids.
- Do not leave unattended during use
- When not in use, unplug the machine, empty the water tank and store it in a dry place.
- Do not unplug with wet hands.
- Store in a dry place.

User Manual

1. Connect the device
2. Open the lid
3. Pour water, possibly with detergent, into the stainless steel tank of the ultrasonic cleaner. Always ensure maximum fill level.
4. Place the objects to be cleaned in the tank. Make sure that the objects to be cleaned are suitable for ultrasonic cleaning and for the e.v.t. cleaning fluid (see instructions of the fluids).
5. Set the timer. 90 seconds to 480 seconds
6. Switch On/Off to On
7. To pause or clean in between, press On again. The machine resumes cleaning from the paused point and continues with the remaining time.
8. If the result is not satisfactory, you can repeat the cycle again.
9. After finishing, clean everything and store dry

Cleaning

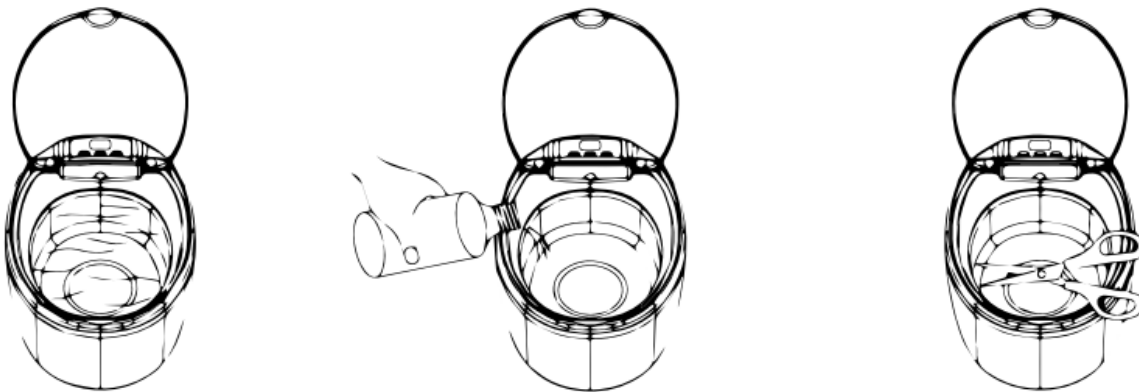

Normal cleaning

Use plain water for normal cleaning (the water should cover the item but not exceed the MAX mark).

Improved cleaning

For improved cleaning results, add a few drops of the coin cleaning bath.

Partial cleaning

To clean parts of large objects, the unit can be used with the lid open, as shown in the figure

Time setting



Cleaning

Cleaning Watch Bands: The watch strap holder (located on the cleaning basket) can be used to clean metal watch straps. Fold down the holder and attach the watch strap to the holder with the watch side up. Then place the cleaning basket in the holder. After cleaning, remove the bracelet and dry it.

Jewelry cleaning: Place the jewelry in the cleaning basket and place the basket in the container filled with water. After cleaning, remove the basket and dry the jewelry with a clean, dry cloth.

Cleaning CDs/DVDs: The CD/DVD insert can be used to clean 2 CDs or DVDs at the same time. Place the CD/DVD insert in the center of the cleaning basket. After cleaning, remove the CD or DVD and dry it.

Coin cleaning: use the matching cleaning agent.

Your supplier

