

808071 black
808072 white



arditi GMBH

L I G H T I N G I N N O V A T I O N

Arditi GmbH • Leischstraße 17
27432 Ebersdorf • GERMANY
info@arditi.de • www.arditi.de

Product introduction

VBA-RCS6 is a convenient controller(Built in battery) for CASAMBI wireless, long-range network. The controller includes 6 buttons that can be configured for 4 presets and 2 dimmers.

_ 4 preset buttons can control a scene or an animation or simply one luminaire, one luminaire group or all lamps together if so desired.

_ “+” and “-” implement the assigned action on/off or dim up/down, once tap “+” or “-” for the assigned action on or off, long press for the assigned action continuous dimming up or down.

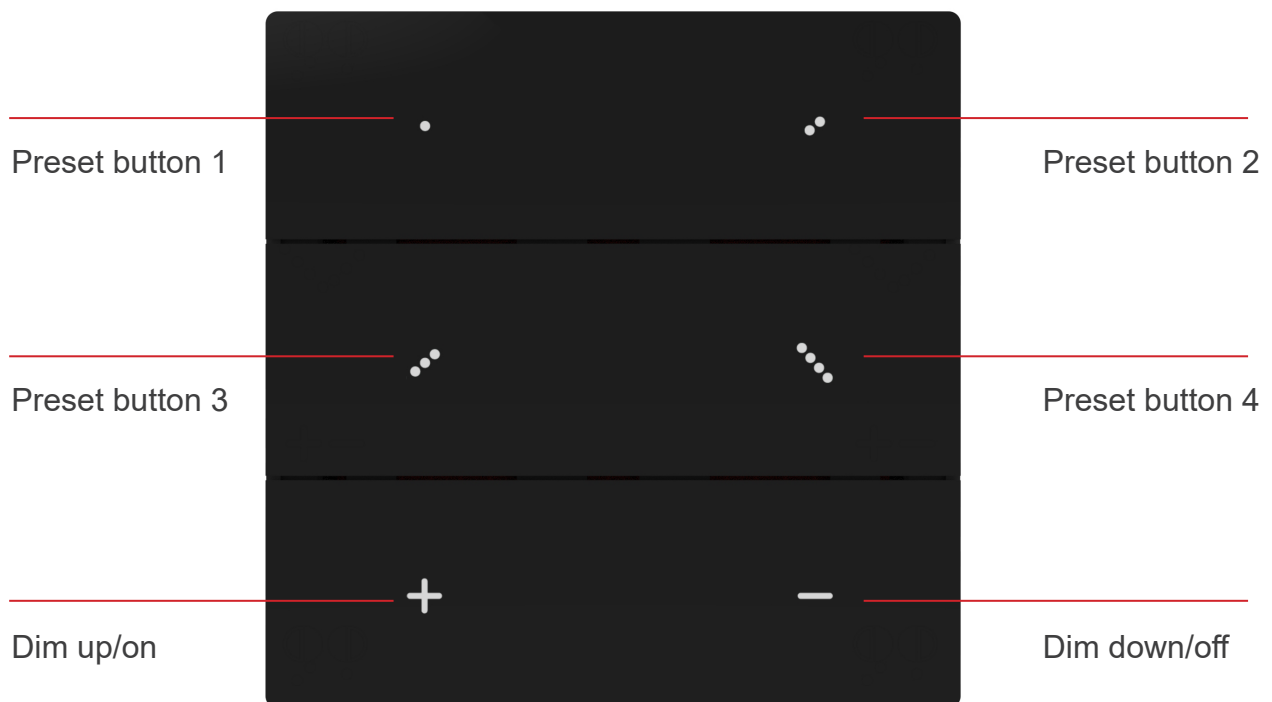

Technical data

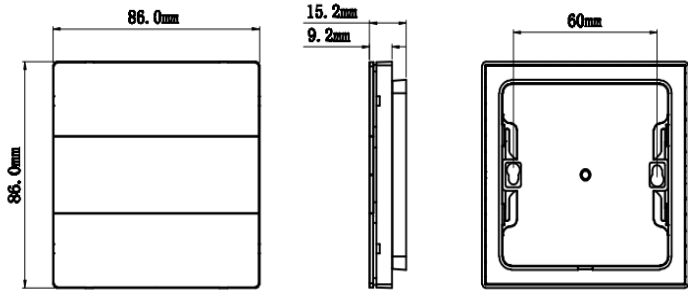
Input	<ul style="list-style-type: none"> • Voltage: 3VDC • Battery Type: CR2032 Lithium Coin Cell
Operating conditions	<ul style="list-style-type: none"> • Operating temperature: 0°C ~ +40°C • Storage temperature: -20°C ~ +50°C • Max. relative humidity: 0...65%, non-cond.
Radio Characteristics	<ul style="list-style-type: none"> • Operating frequencies: 2.402~2.480 Ghz • Maximum output power: +7 dBm
Mechanical data	<ul style="list-style-type: none"> • Dimensions: 86 x 86 x 15.2mm  <p>The mechanical drawings show three views of the device: a front view with dimensions 86.0mm width and 86.0mm height; a side view with dimensions 15.2mm total thickness and 9.2mm for the main body; and a top view with a width of 60mm.</p> <ul style="list-style-type: none"> • Weight: 80g • Degree of protection: IP20 (indoor use only)
Certifications	<ul style="list-style-type: none"> • CE

LED Indications

On preset buttons(when any 2 preset buttons be pressed):

If the device is paired: white LEDs stays on 20s.

If the device is unpaired: white LEDs flashes through the buttons for 20s.

Pair the device into network

Step 1: To pair VBA-RCS6, press any 2 preset buttons (for example, buttons 1 and 3), then it will be seen in “nearby devices”.

Step 2: If it is unpaired, pair it into your desired network before the white LEDs off.

Step 3: If it is paired in others’ network, unpair it first (follow the steps in **Figure 1**), tap “unpair device” → “Start” in the app, when the progress bar appears, tap any one of the button, then unpaired success. Repeat step 2 to pair it into network.



Make sure that the device has at least one of the white LEDs on during the unpairing. You will need to perform the unpairing steps before the switch turns itself off (no LEDs on), which happens automatically, if it is not used for about 20s.



If the white LEDs flashes through the buttons for longer than 30s when no button is being pressed, it is advised to remove and reinsert the battery to prevent unnecessary battery drain.

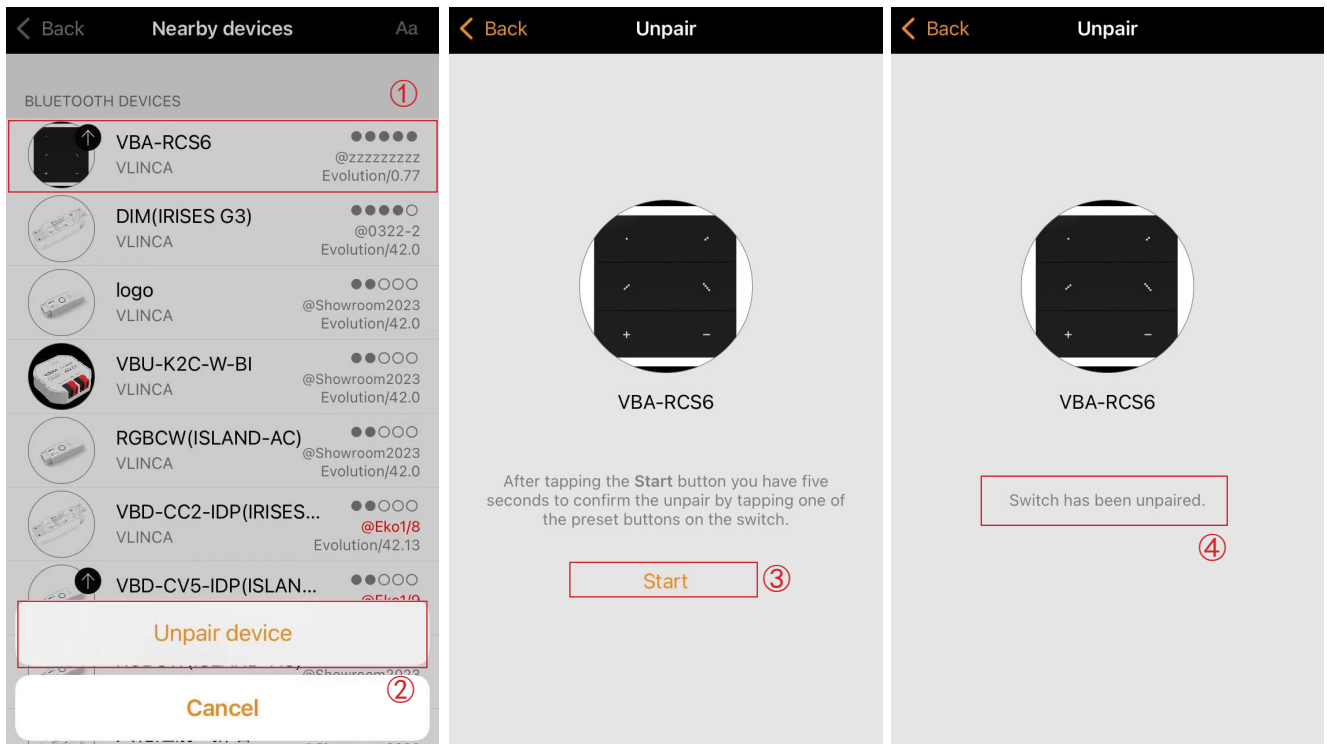

Figure 1

Electrical information

After the device is paired into network, it will now be visible in the Switches tab. Press any key, the remaining power of the device will display(as in Figure 2).

Note: The remaining power is for reference only.

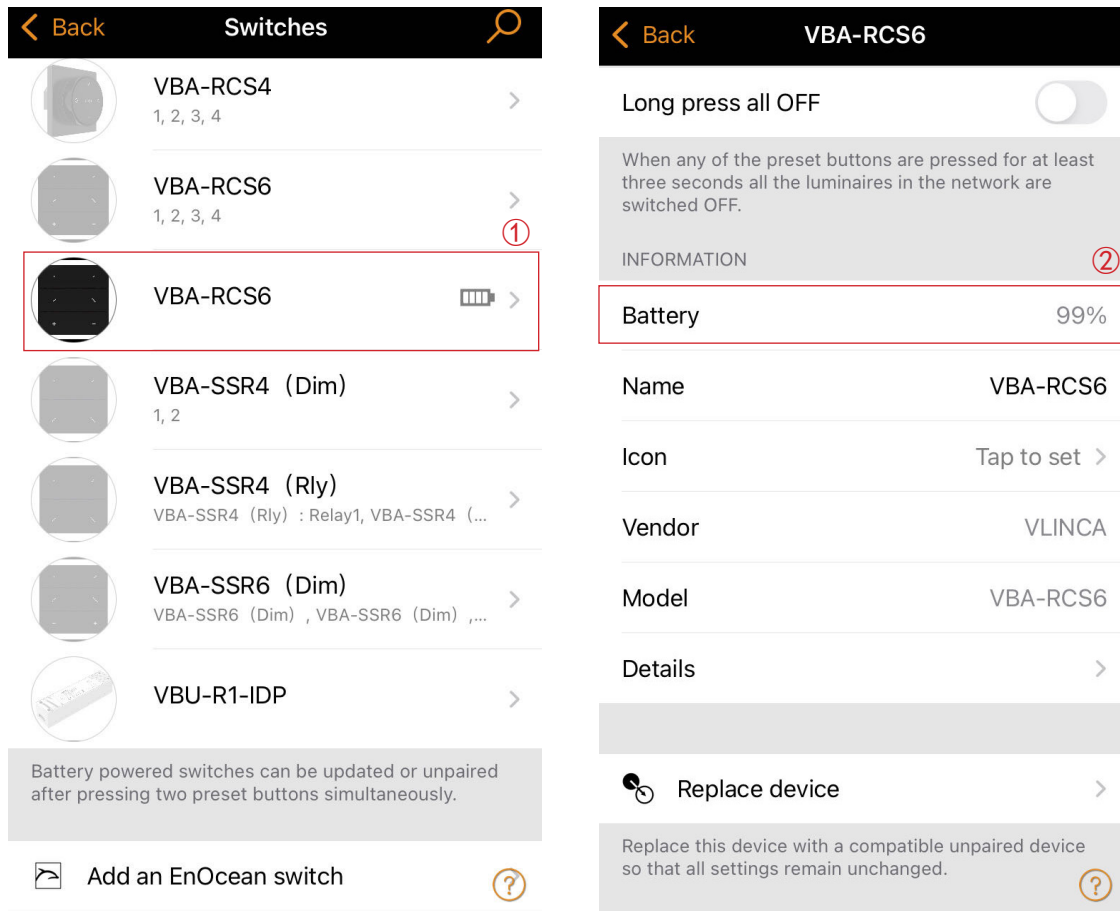

Figure 2

Configure VBA-RCS6

1 configuration: deactivate the Use toggle and Long press all off functions(as in Figure 3).

When Use toggle and Long press all off functions are both deactivated, it will only allow the preset button to activate the assigned action.

“+” and “-” control the assigned action on/off or dim up/down.

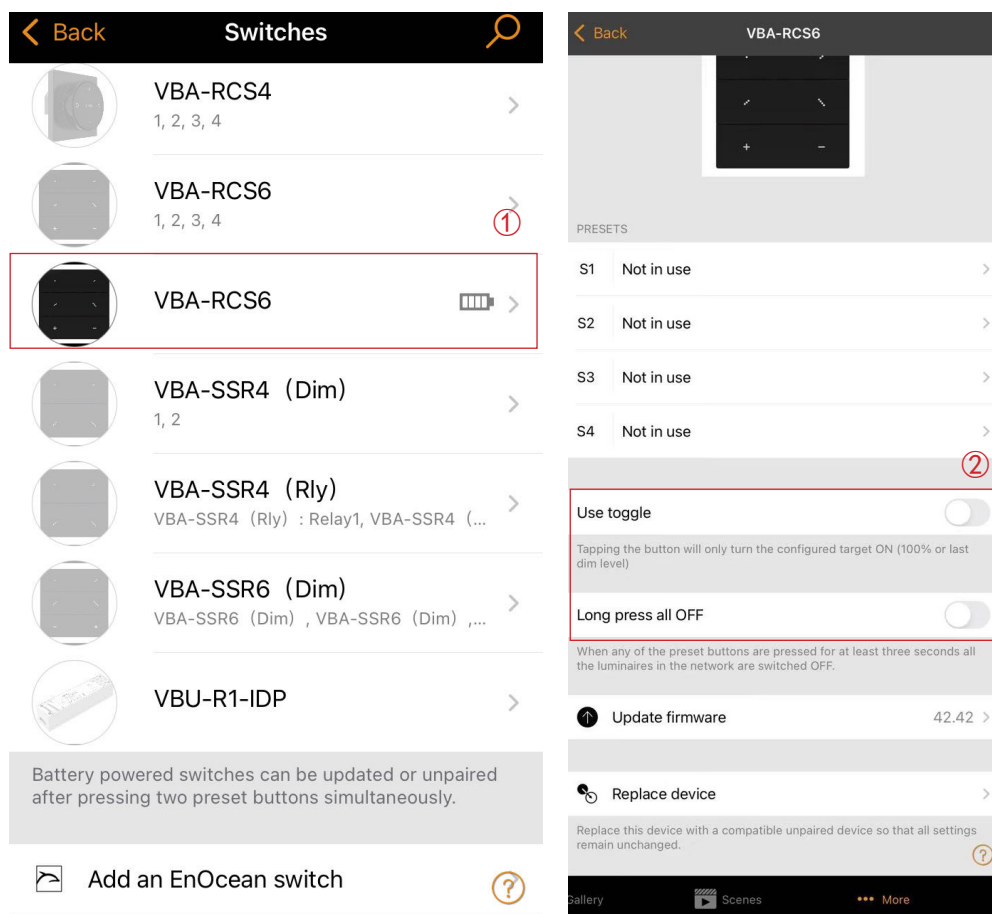

Figure 3

2 configuration example: configure 4 preset buttons to control 4 scenes.

_ Configure button 1&2&3&4 to control 4 scenes, as in Figure 4.

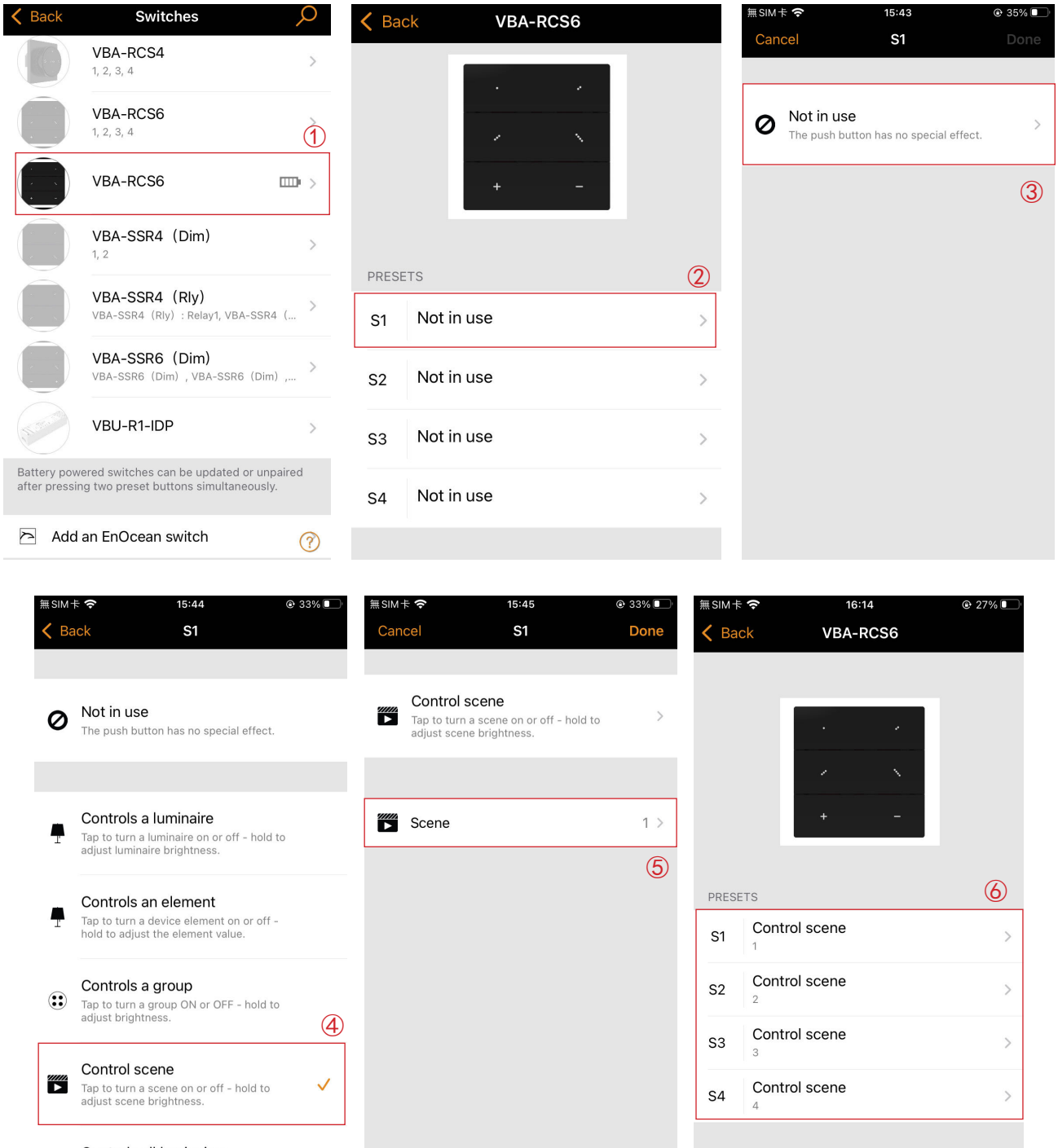

Figure 4

Battery replacement

Slide and remove back cover, and replace the old battery. The battery type is CR2032. Always replace the battery with the same type, reinstall the battery lid cover. Properly dispose of the old battery at your nearest hazardous waste collection site.

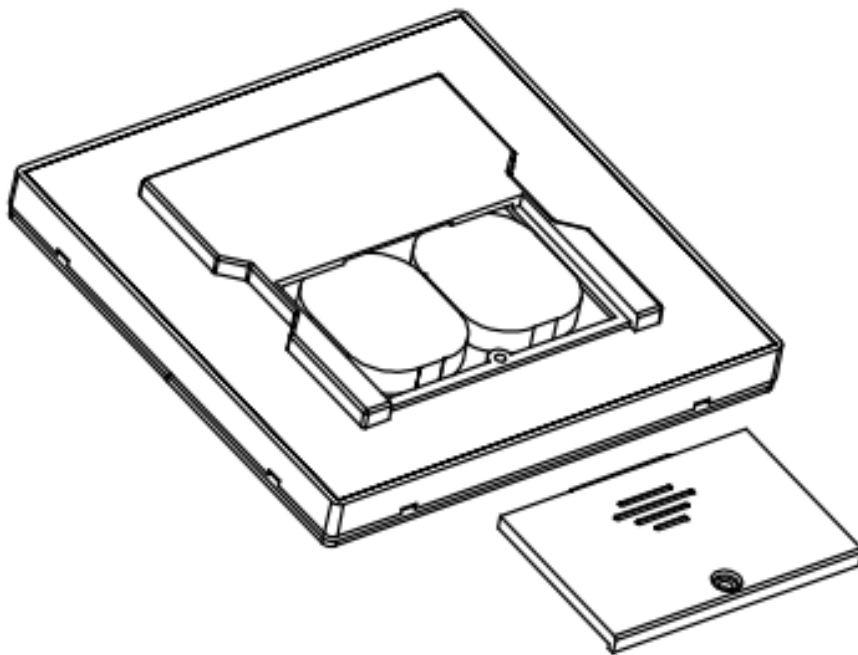

Figure 5

